



ISLE OF MAN GOVERNMENT: GENERAL REGISTRY

ASYLUM PLANS: PARISH OF BALLAUGH

Originals monotone

1:23

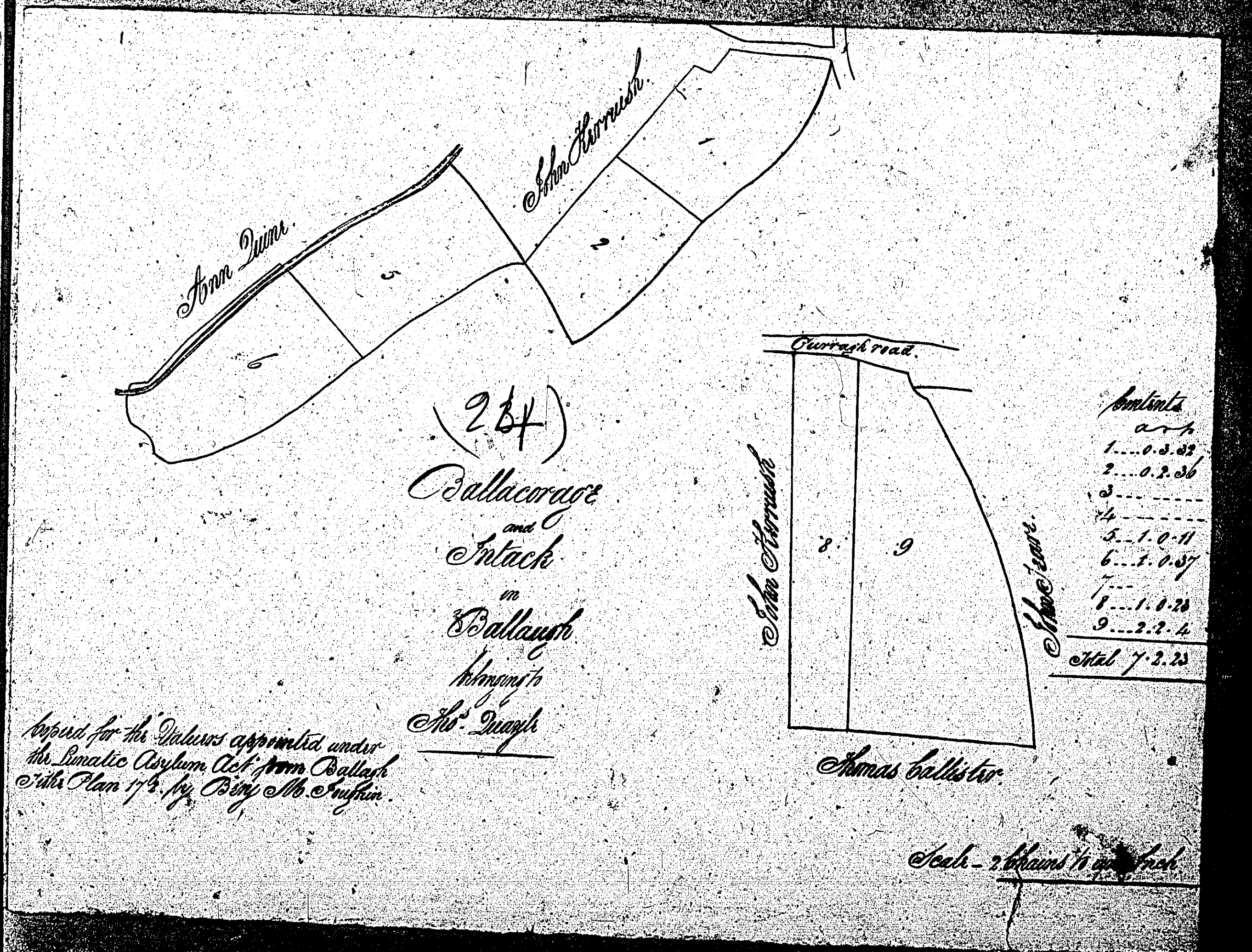
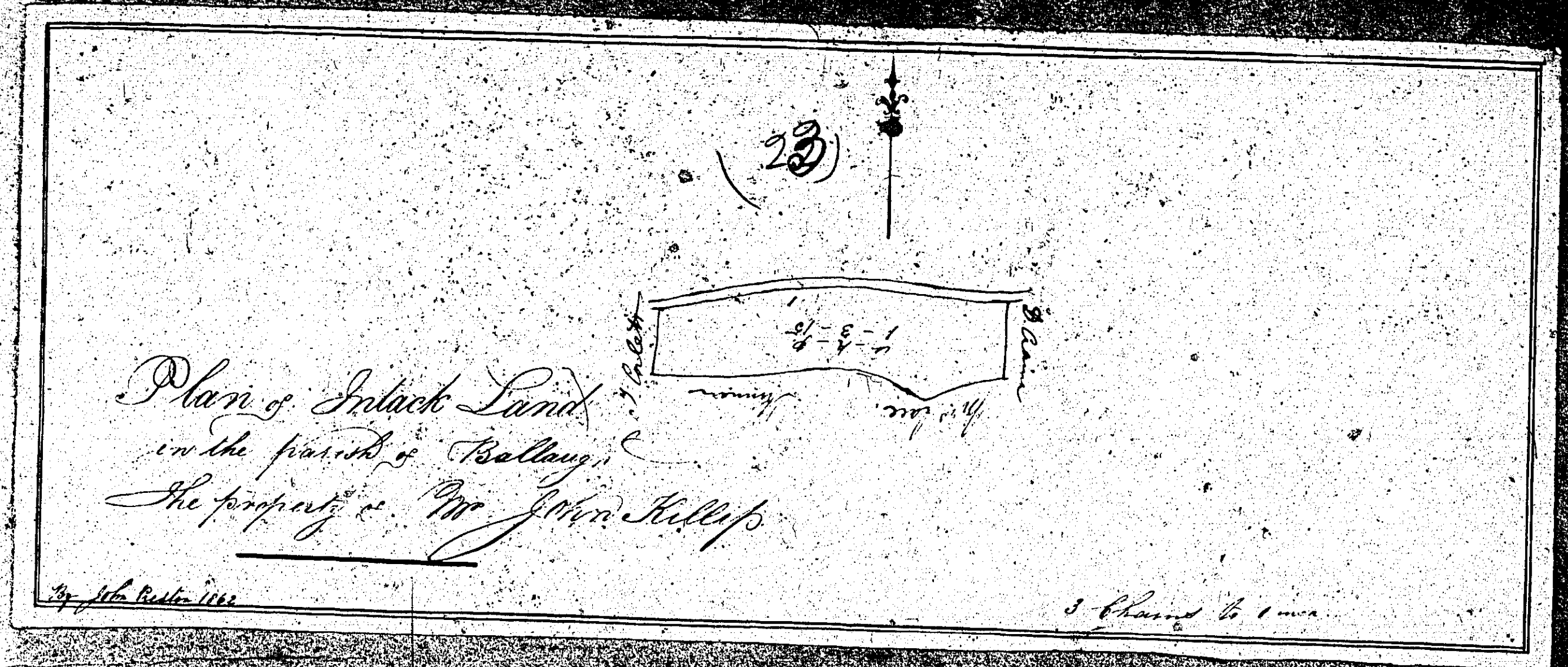

ISLE OF MAN GOVERNMENT: GENERAL REGISTRY  
ASYLUM PLANS: PARISH OF BALLAUGH

Original coloured

1:23

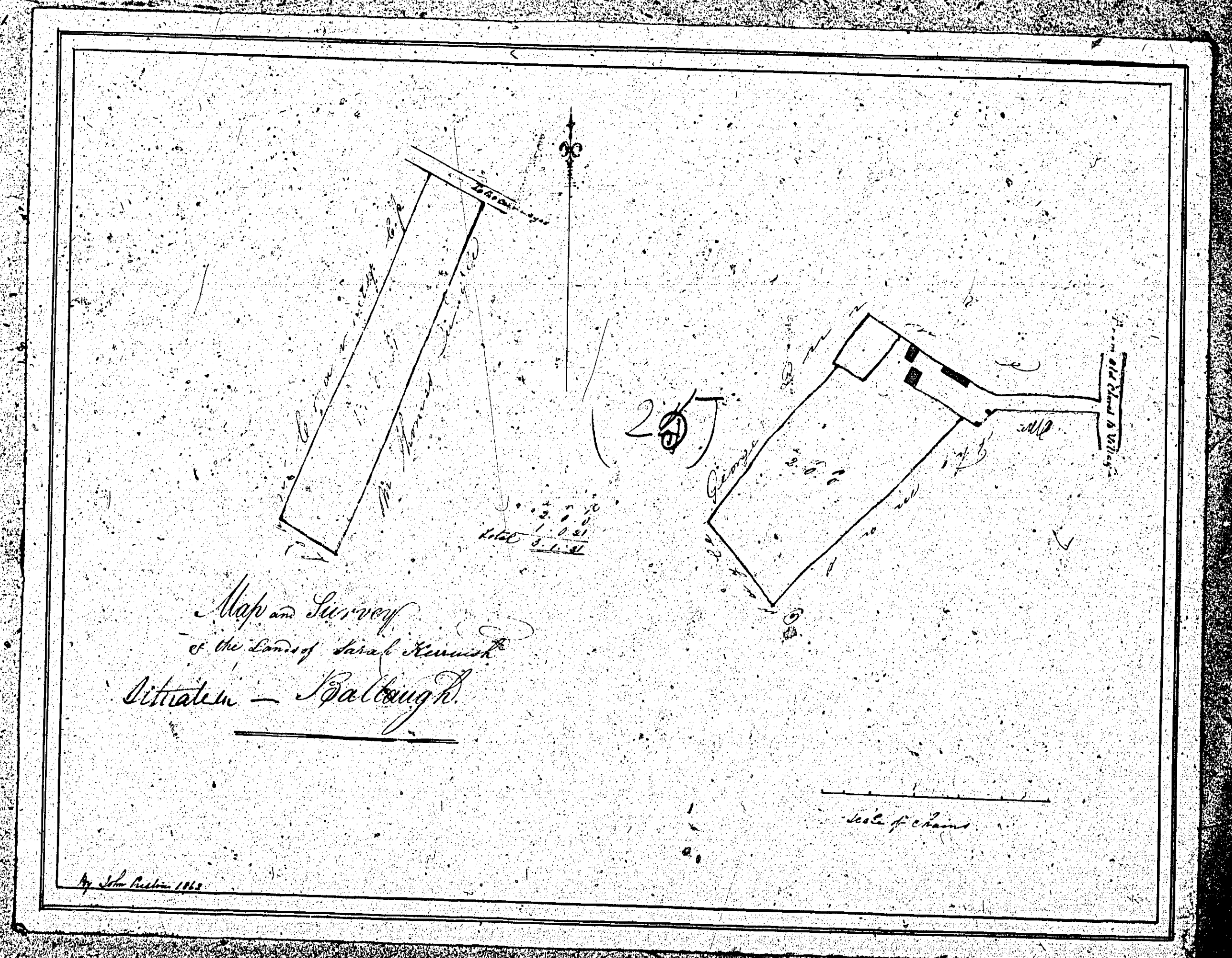

ISLE OF MAN GOVERNMENT: GENERAL REGISTRY

ASYLUM PLANS: PARISH OF BALLAUGH

Original coloured

1:23

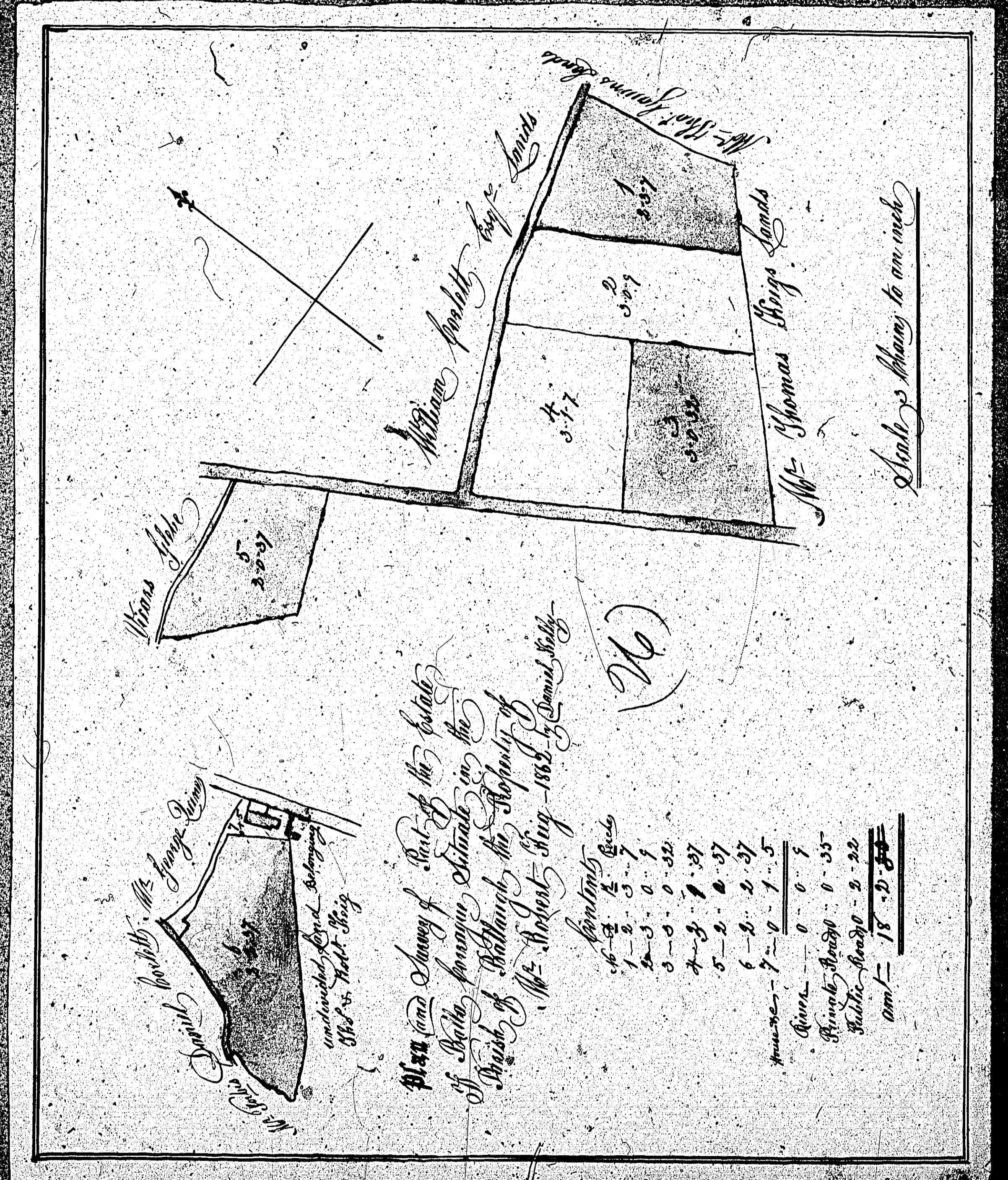

ISLE OF MAN GOVERNMENT: GENERAL REGISTRY

ASYLUM PLANS: PARISH OF BALLAUGH

Originals coloured

1:23

Plan and Survey of a Piece of undivided  
Land Part of the Quarterland of  
Balla, Conaugh, Situate in the  
Parish of Ballaugh the Property of  
Messrs. Tho<sup>s</sup> King & Robert King - 4<sup>th</sup> Sept 1822

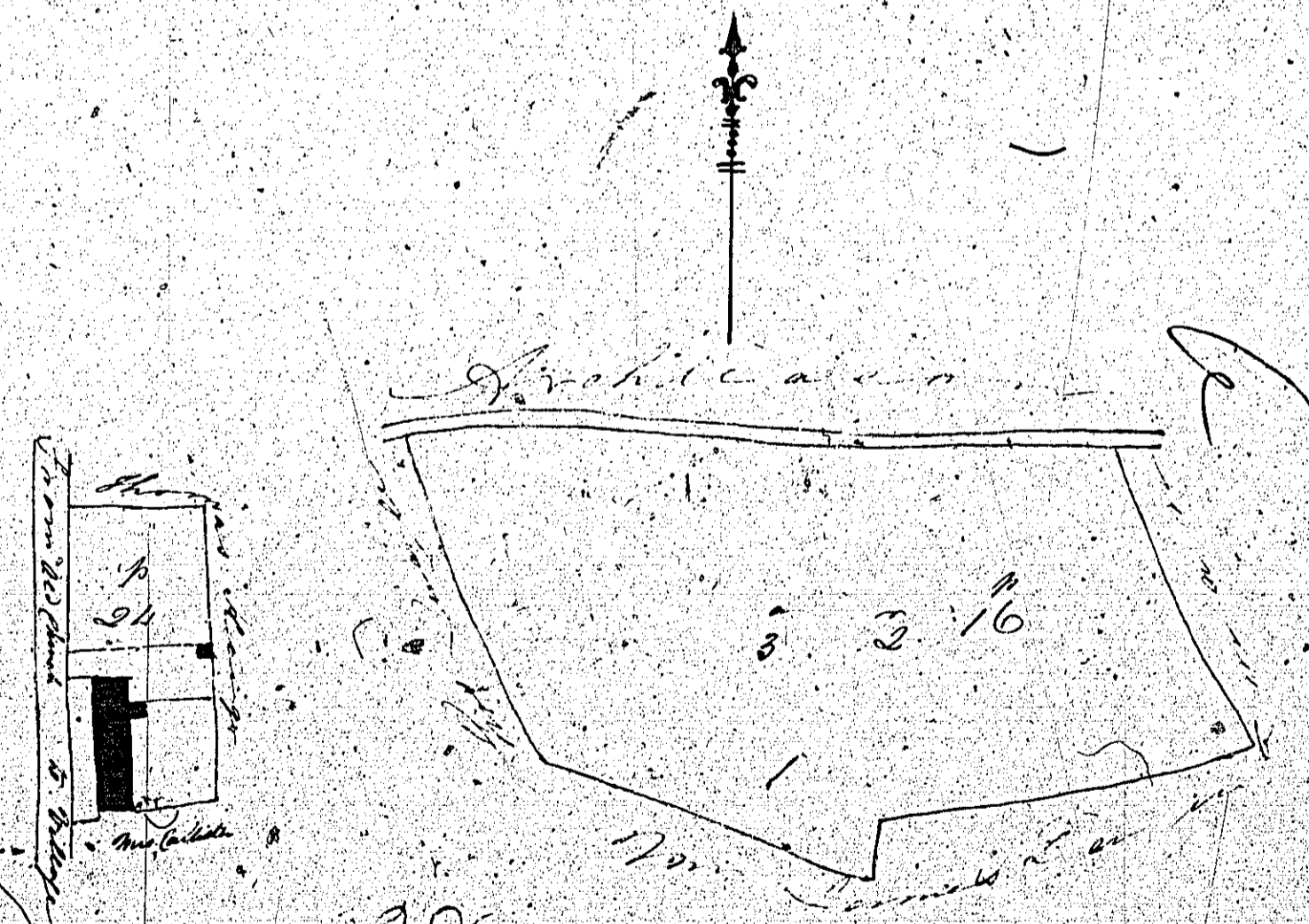
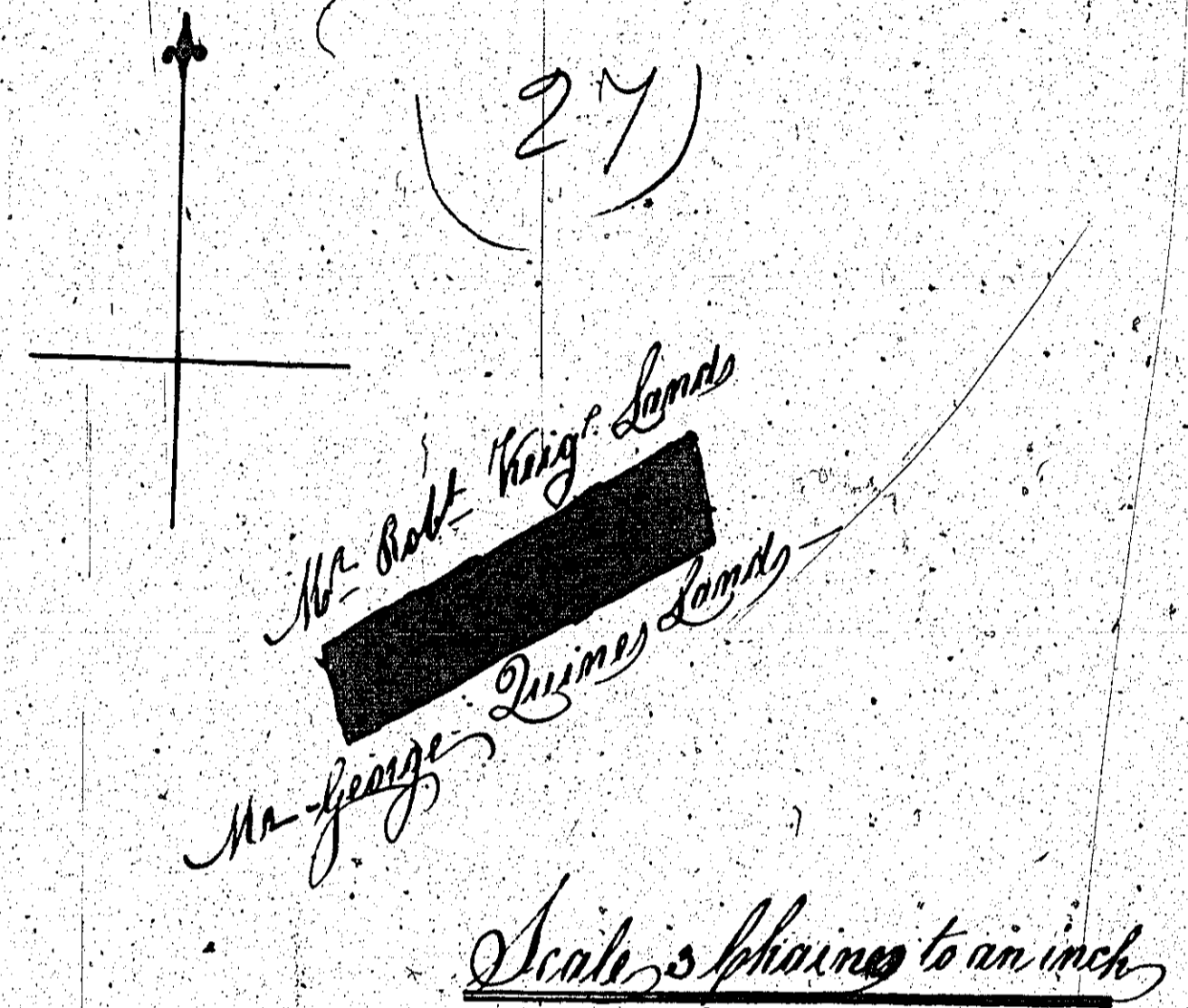

(28)  
Map of  
part of the Quarterland of Ballaugh  
with a Cottage and Garden in Ballaugh  
in the Parish of Ballaugh  
the Property of John Brown

3	3	16
3	3	16
6	6	32

ISLE OF MAN GOVERNMENT: GENERAL REGISTRY

ASYLUM PLANS: PARISH OF BALLAUGH

Original coloured

1:23

*Plan and Survey*  
*of Tenthredin's Island*  
*in the parish of Ballaugh*  
*the property of Mr Thomas Curran*

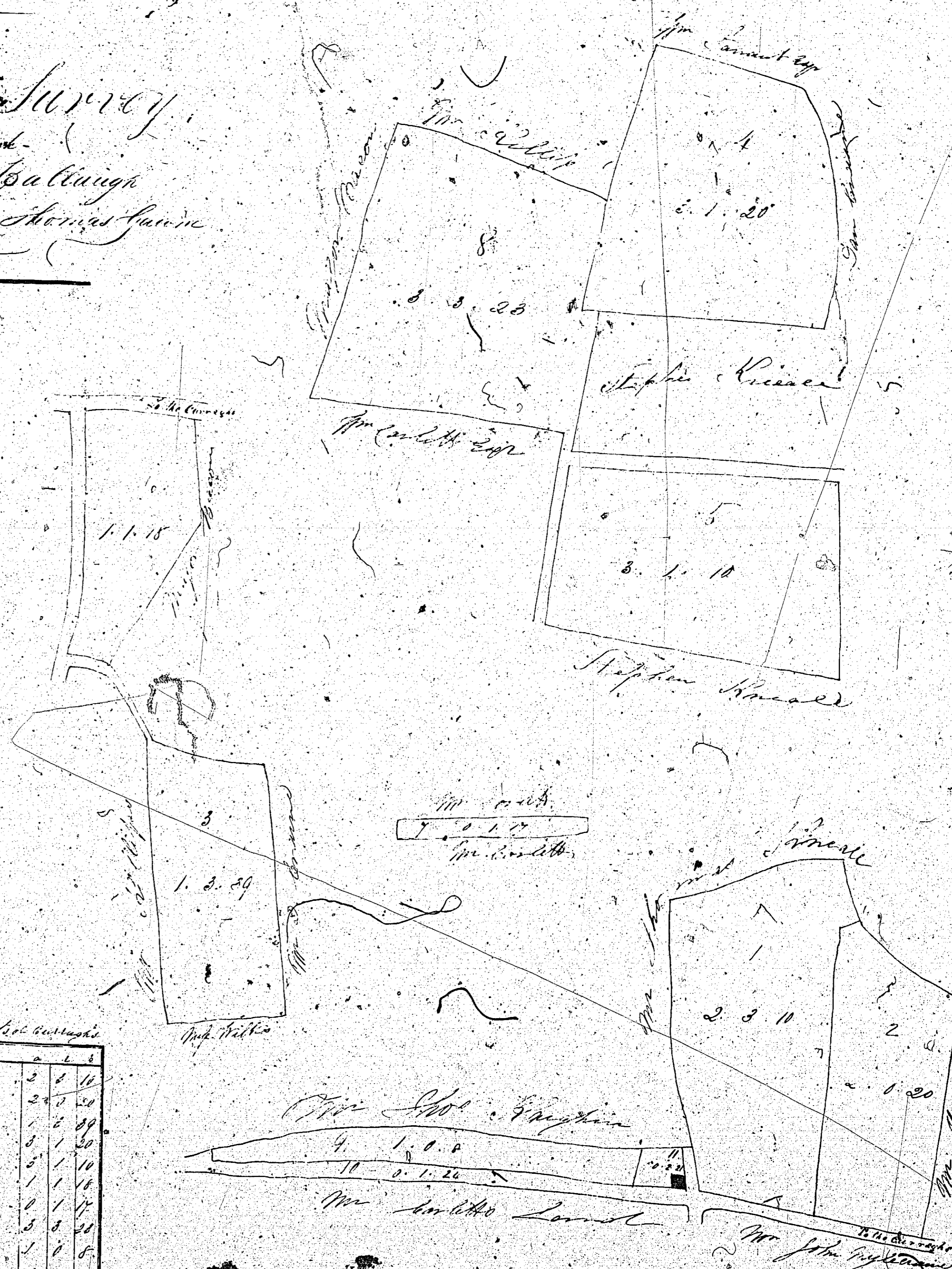

*Contents*

1	1	1	1
2	1	3	4
3	3	1	4
4	3	2	5
5	1	1	2
6	1	1	2
7	3	3	6
8	2	0	2
9	4	2	6
10	2	2	4
11	0	1	1
Total	20	1	27
Area of survey	21	1	10
Area of the whole	41	2	17

*Contents of survey*

1	2	2	10
2	2	1	3
3	1	2	3
4	1	1	2
5	1	1	2
6	1	1	2
7	3	3	6
8	2	0	2
9	4	2	6
10	2	2	4
11	0	1	1
Total	21	1	10

*John P. Curran*

*John P. Curran*