

START

APP 1

1. 23

Isle of Man Government: General Registry

**PLANS DEPOSITED IN THE
ROLLS OFFICE
UNDER THE
LUNATIC ASYLUM ACT
1860**

**Bell & Howell, Micromedia Division,
Telford Road, Bicester, Oxon, OX6 0UP**

March 1998

NOTES

The plans have been filmed in their bound state

This will have caused some image distortion particularly where large plans go into the binding gutter and/or have been folded

Many of the larger plans are damaged.

Where plans are coloured this has been noted; 'monochrome' indicates a single ink colour which may be black, brown or blue

START OF VOLUME

There is no plan
numbered

1

ISLE OF MAN GOVERNMENT: GENERAL REGISTRY

ASYLUM PLANS: PARISH OF ANDREAS

Original monotone

1:23

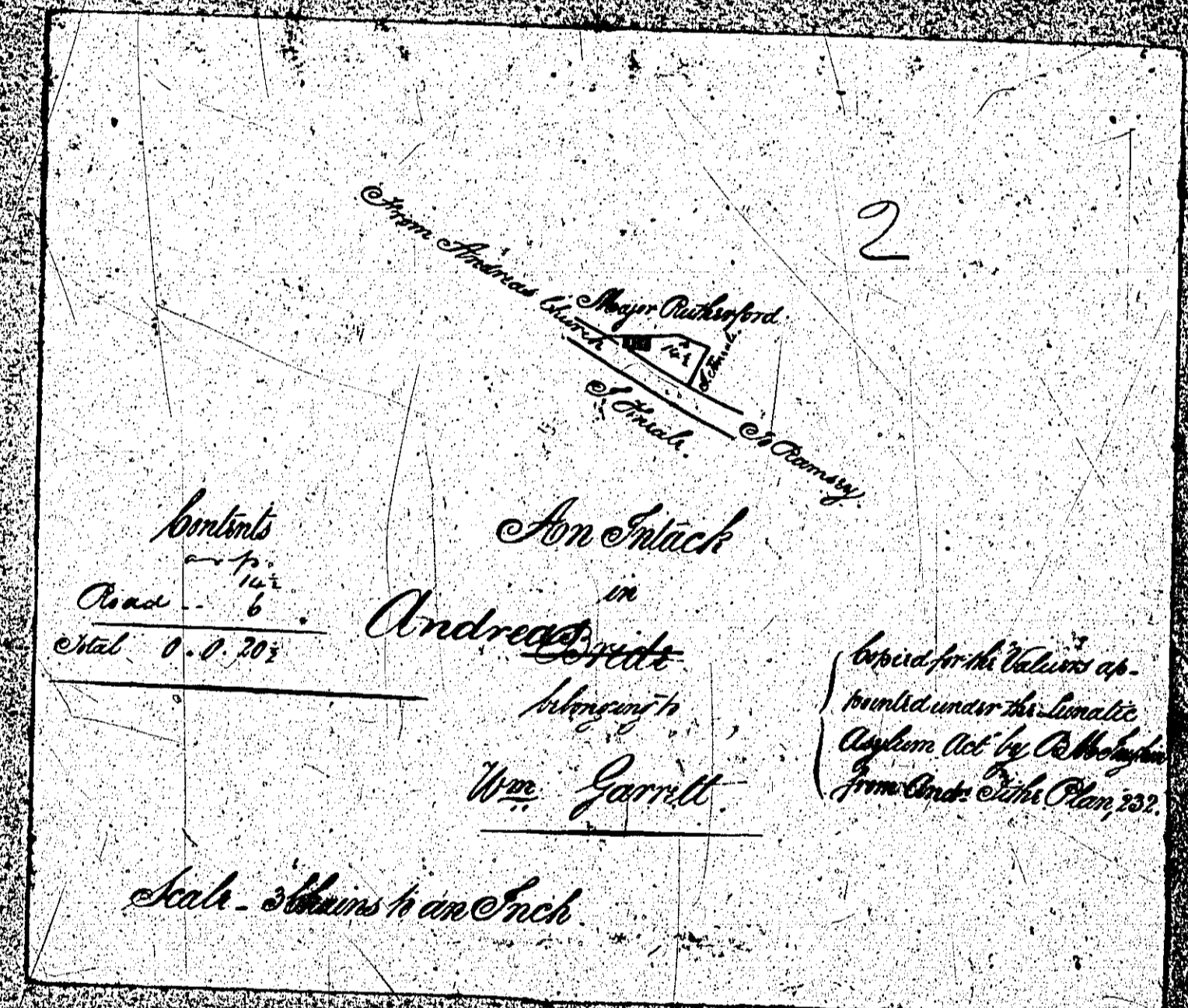

80



MAP
and Survey of
REGABY-BEG
in the Parish of Andreas
the Property of
Mr. William Smeale

Contents

Fields	87. 1. 9 $\frac{1}{2}$
Gardens & Casements	2. 2. 6 $\frac{1}{2}$
Roads on the property	1. 3. 8 $\frac{1}{2}$
Public Road	91. 2. 26 $\frac{1}{2}$
Total	93. 3. 24 $\frac{1}{4}$

ISLE OF MAN GOVERNMENT: GENERAL REGISTRY

ASYLUM PLANS: PARISH OF ANDREAS

Original monotone

1:23

ISLE OF MAN GOVERNMENT: GENERAL REGISTRY

ASYLUM PLANS: PARISH OF ANDREAS

Original monotone

1:23

6
MAP
(and Survey of)
part of the Quarterland of
REGABY &c.
in the Parish of Andreas
the Property of
Mr John Corlett.

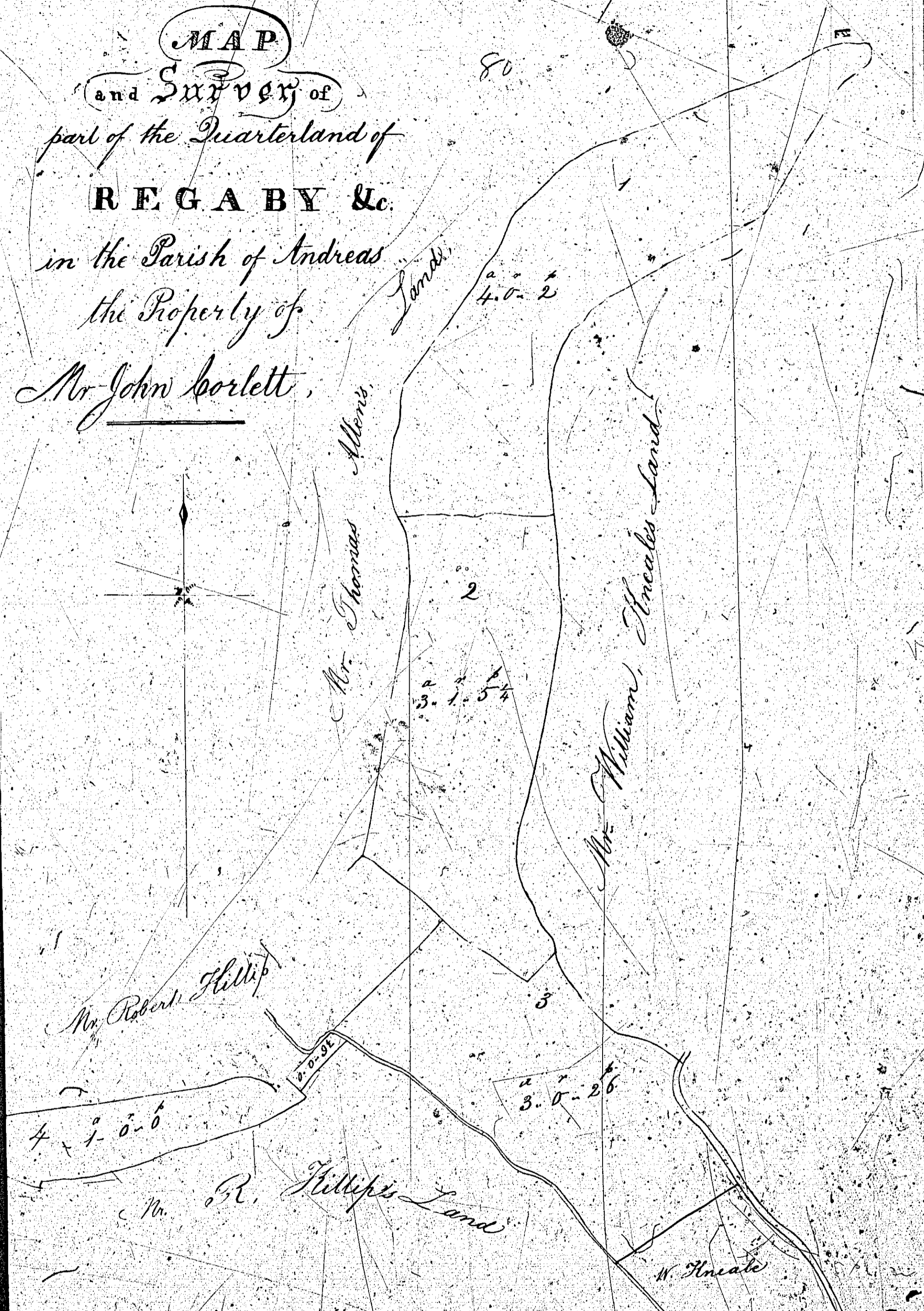

Contents		
No	A	R P
1	14	0.2
2	3	1.5 $\frac{1}{4}$
3	3	0.26
4	1	0.5 $\frac{3}{4}$
Total	11	2.2 $\frac{3}{4}$

Scale of 2 chains to one Inch