

Measurement of a Field.
Part of Marina Estate in the
Parish of Onchan, the property of
John Patman.
Douglas, Isle of Man, 1840.

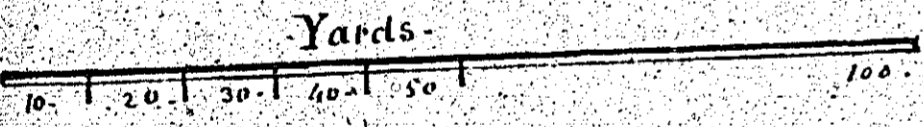

M^{rs} Harrison

M^{rs} Harrison

John Patman
A. R. P.
8 - 2 - 6

M^{rs} Stuart

Part in town

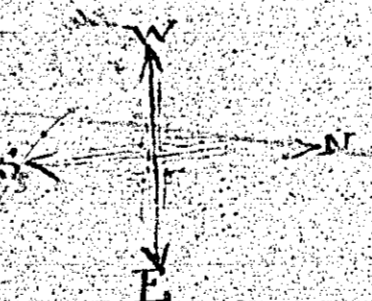

Love Lane

157

Pinch Road

Road to Villa Marina

M^{rs} Duff, Colonel Shaw, Marina House

Part in town

Villa Marina

Miss Dutton

Blackley Race

not used

Plan 152.

Part of
The Land of Mallagay
Situate in the
Parish of Incham
The property of
Sir M^r. O'Neale
July 10th 1788

Two Chains to an Inch.

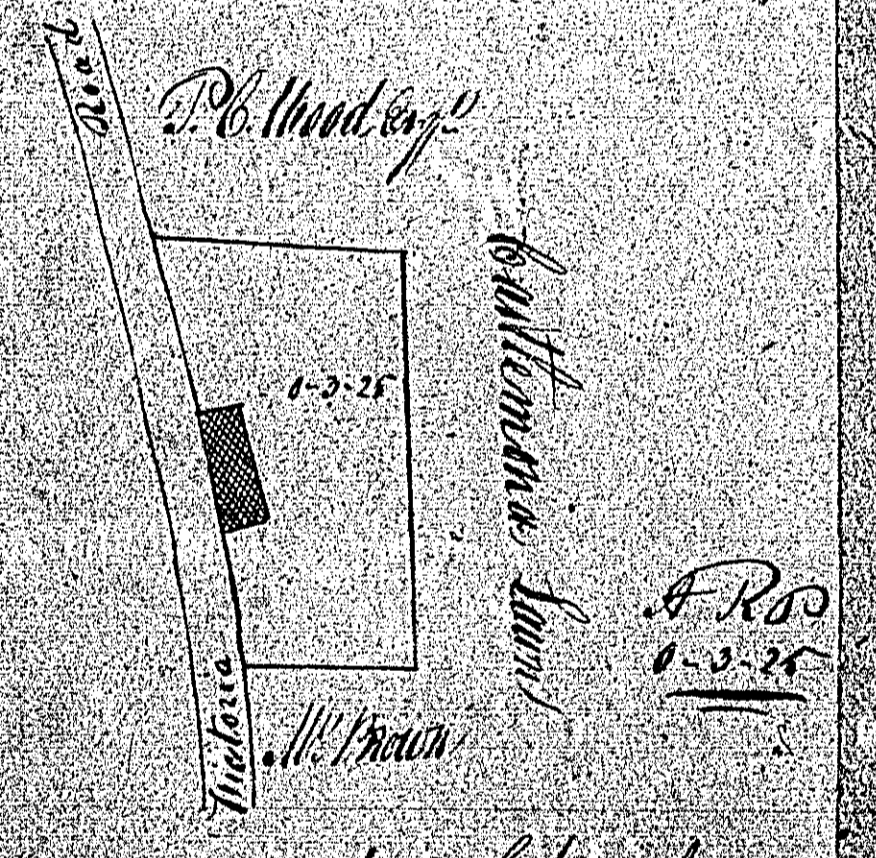

Joseph Wake Survey

Survey

153

Measurement of two Houses & grounds belonging thereto
 Nos 7 & 8 in Strathallan Crescent Parish of Cinchan,
 Douglas Bay Isle of Man the property of John Patnam.
 748 square yards. December 3. 1840.

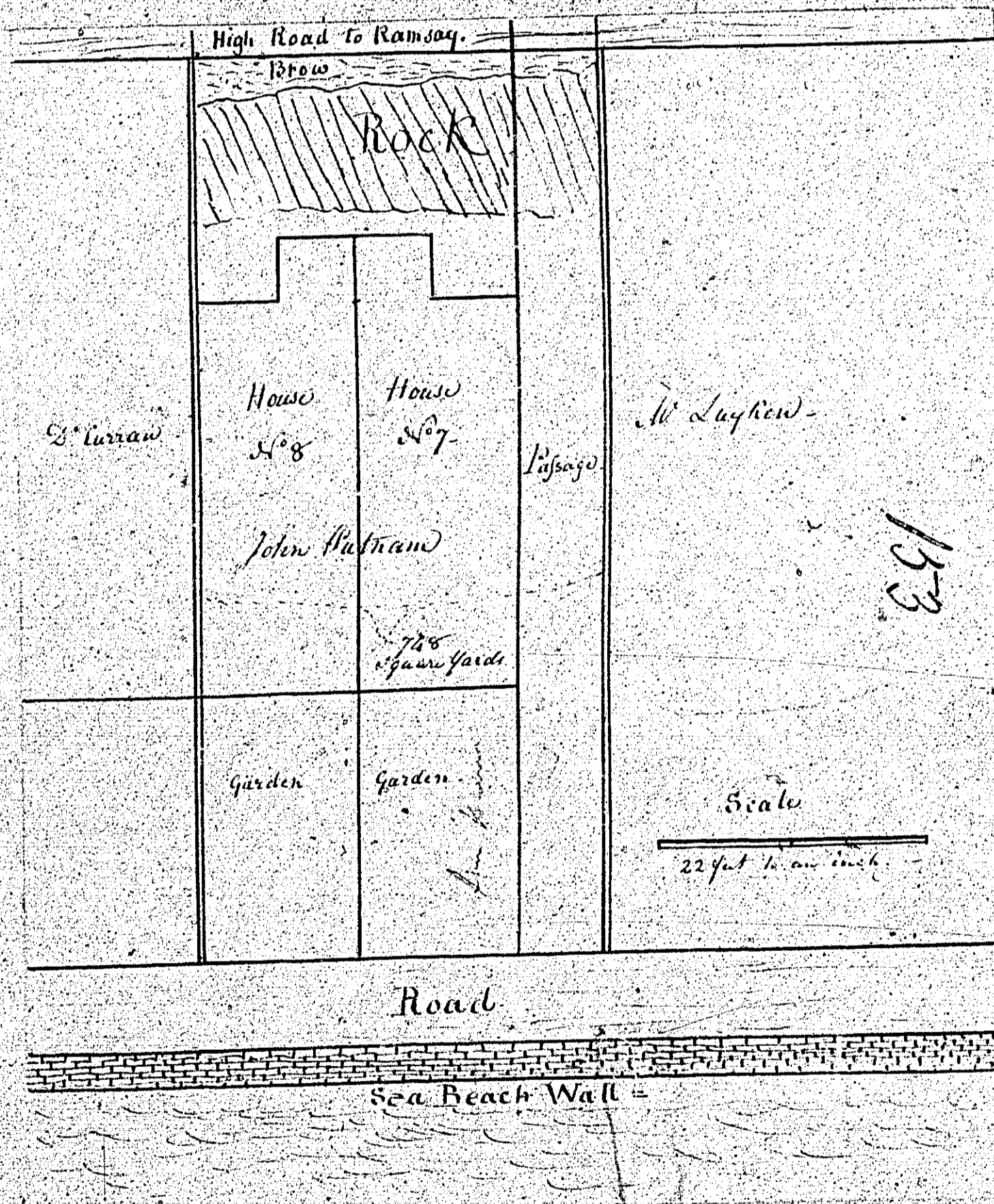

157

157.

Plan
of the
Estate
of
Ballag
in the
Parish of Onchan
belonging to
Mr. Edmund Dume
1829

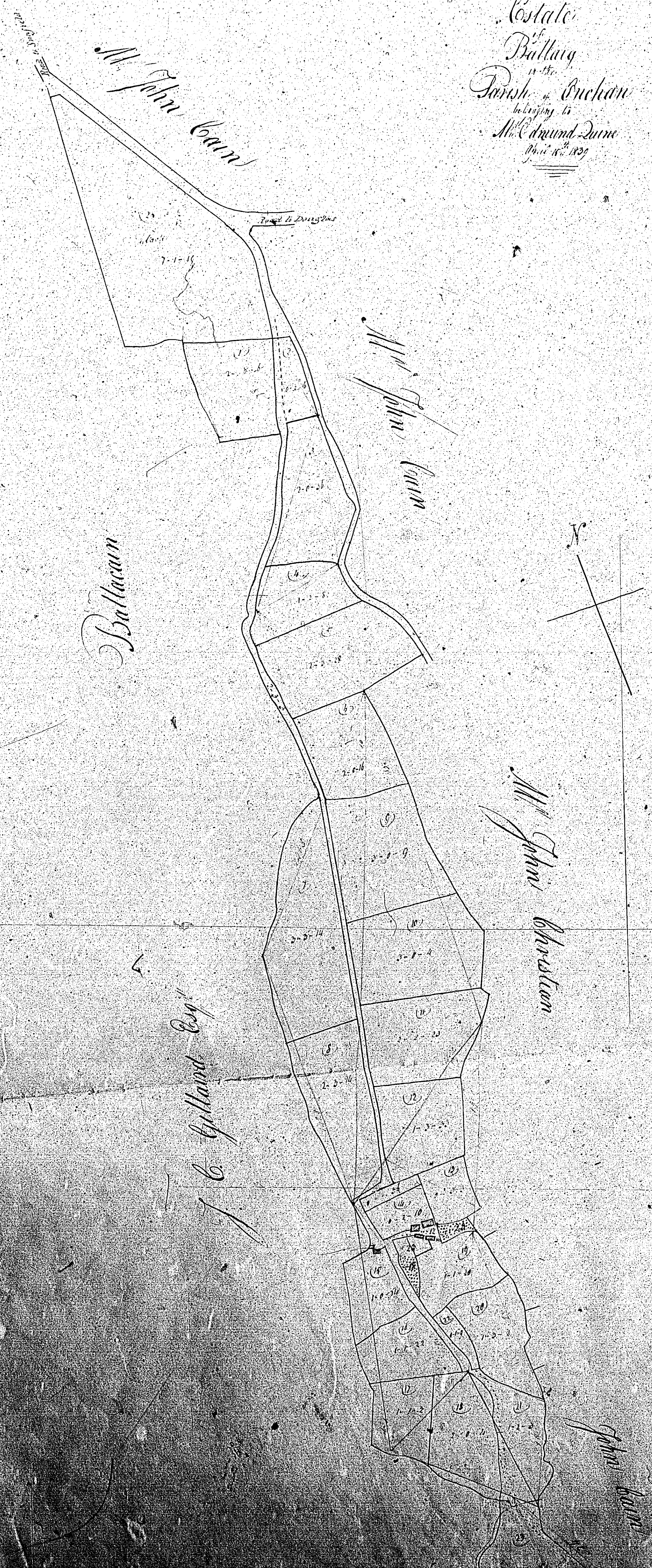

ISLE OF MAN GOVERNMENT: GENERAL REGISTRY

TITHE PLANS: PARISH OF ONCHAN

Original coloured (decorative)

1:30

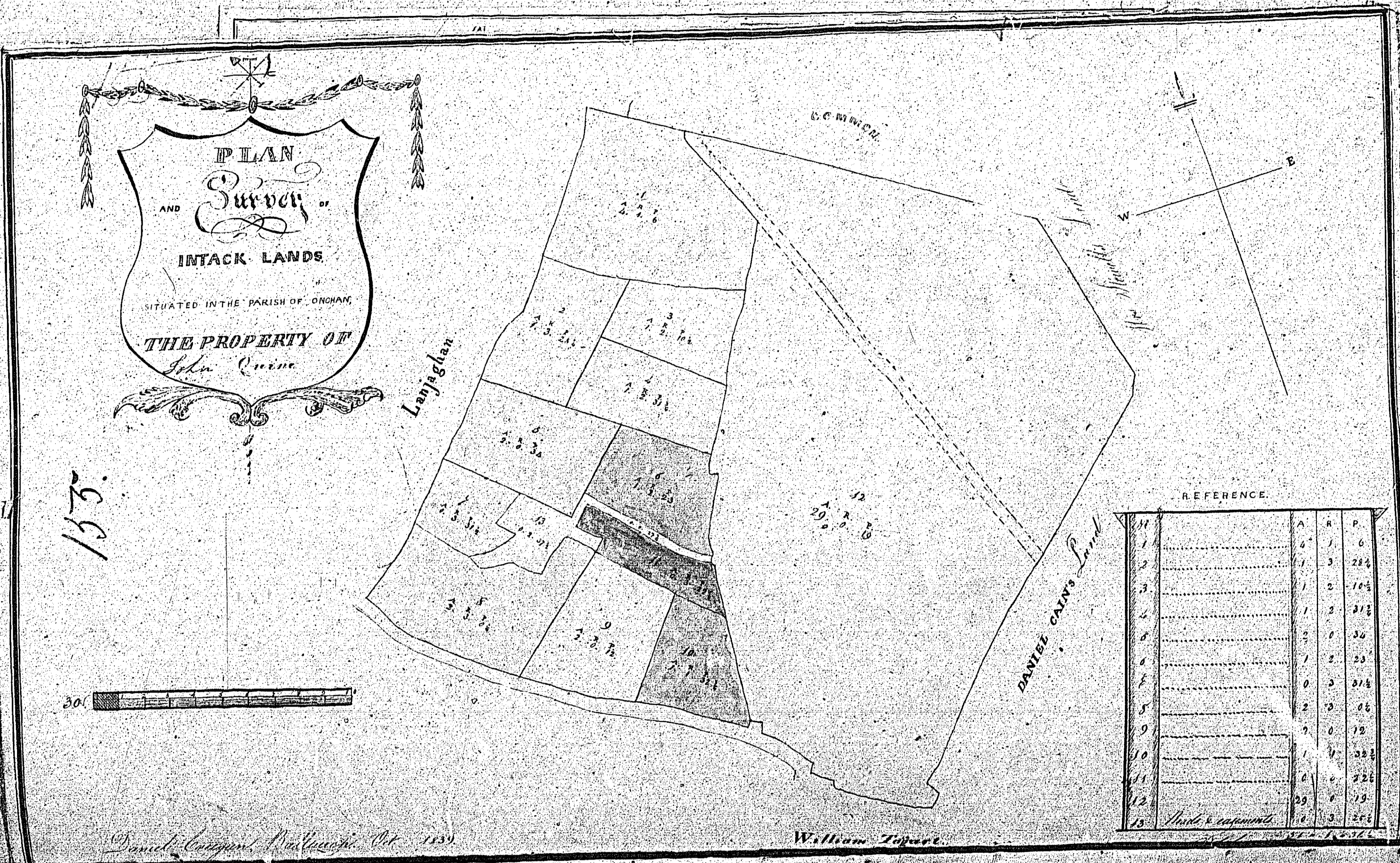

ISLE OF MAN GOVERNMENT: GENERAL REGISTRY
 TITHE PLANS: PARISH OF ONCHAN
 Original coloured 1:30

