

Plan of House Gardens
Situate in the
Parish of Cuschan
The Property of
M^{rs} W^m Driff
Jan^y 22^d 1811

75

(Villa Marina - Bexley)

Two Acres, & so Forth

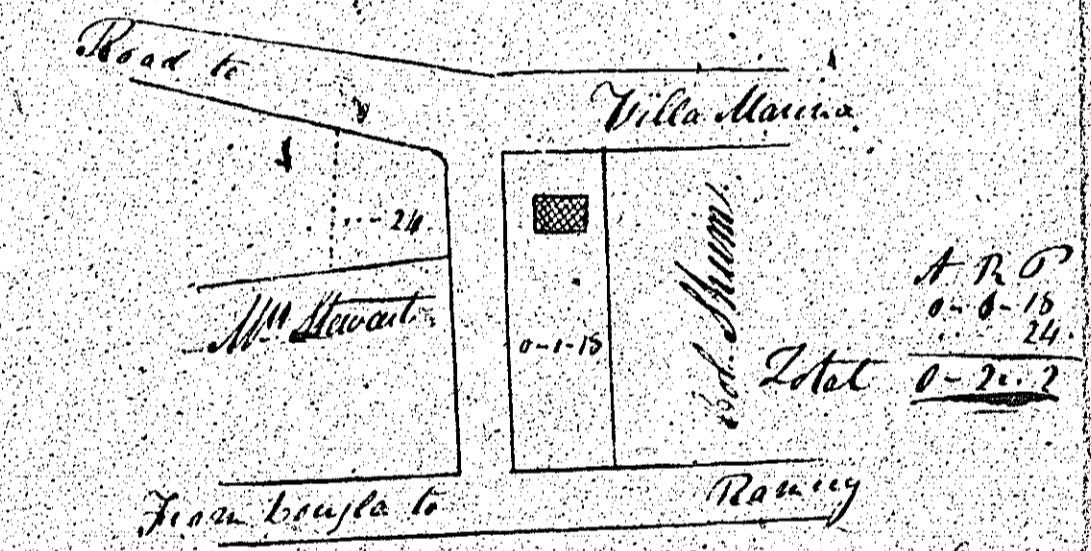

Joseph Blake Survey

Survey

BALLAQUAYLE

in Ordnance

The Property of Sir George Drumheller

April, 1840.

76.

W. L. R. F. 59

No.	Contents.	Acres.
1	1	1.60
2	2	0.29
3	3	1.34
4	4	1.36
5	5	2.21
6	6	3.22
7	7	3.22
8	8	3.22
9	9	3.22
10	10	3.22
11	11	3.22
12	12	3.22
13	13	3.22
14	14	3.22
15	15	3.22
16	16	3.22
17	17	3.22
18	18	3.22
19	19	3.22
20	20	3.22
21	21	3.22
22	22	3.22
23	23	3.22
24	24	3.22
25	25	3.22
26	26	3.22
27	27	3.22
28	28	3.22
29	29	3.22
30	30	3.22
31	31	3.22
32	32	3.22
33	33	3.22
34	34	3.22
35	35	3.22
36	36	3.22
37	37	3.22
38	38	3.22
39	39	3.22
40	40	3.22
41	41	3.22
42	42	3.22
43	43	3.22
44	44	3.22
45	45	3.22
46	46	3.22
47	47	3.22
48	48	3.22
49	49	3.22
50	50	3.22
51	51	3.22
52	52	3.22
53	53	3.22
54	54	3.22
55	55	3.22
56	56	3.22
57	57	3.22
58	58	3.22
59	59	3.22
60	60	3.22
61	61	3.22
62	62	3.22
63	63	3.22
64	64	3.22
65	65	3.22
66	66	3.22
67	67	3.22
68	68	3.22
69	69	3.22
70	70	3.22
71	71	3.22
72	72	3.22
73	73	3.22
74	74	3.22
75	75	3.22
76	76	3.22
77	77	3.22
78	78	3.22
79	79	3.22
80	80	3.22
81	81	3.22
82	82	3.22
83	83	3.22
84	84	3.22
85	85	3.22
86	86	3.22
87	87	3.22
88	88	3.22
89	89	3.22
90	90	3.22
91	91	3.22
92	92	3.22
93	93	3.22
94	94	3.22
95	95	3.22
96	96	3.22
97	97	3.22
98	98	3.22
99	99	3.22
100	100	3.22

*Proportion of Public Roads 3.0.50
Or River 2.1.34*

Robertson & McGill Surveyors.

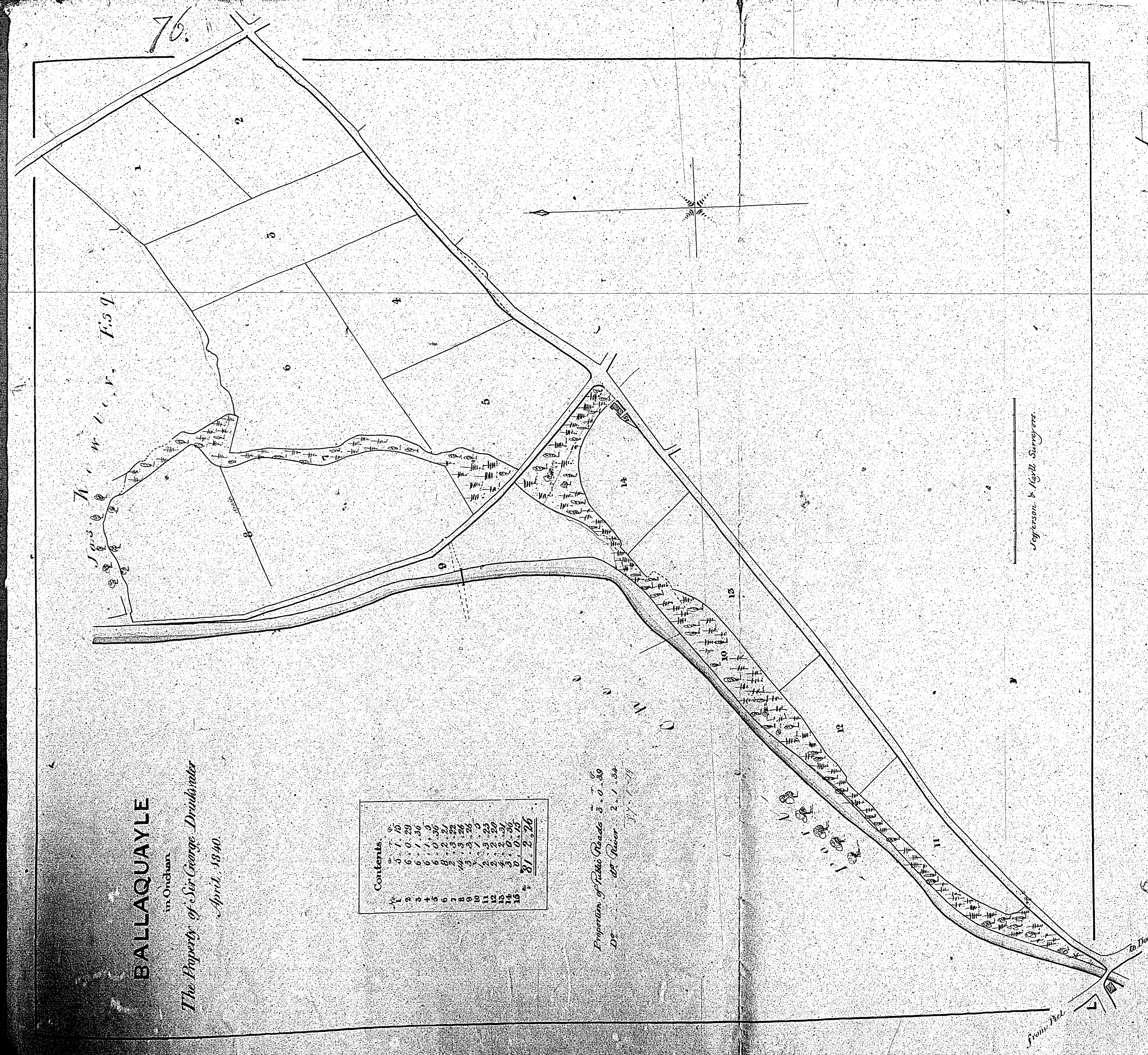

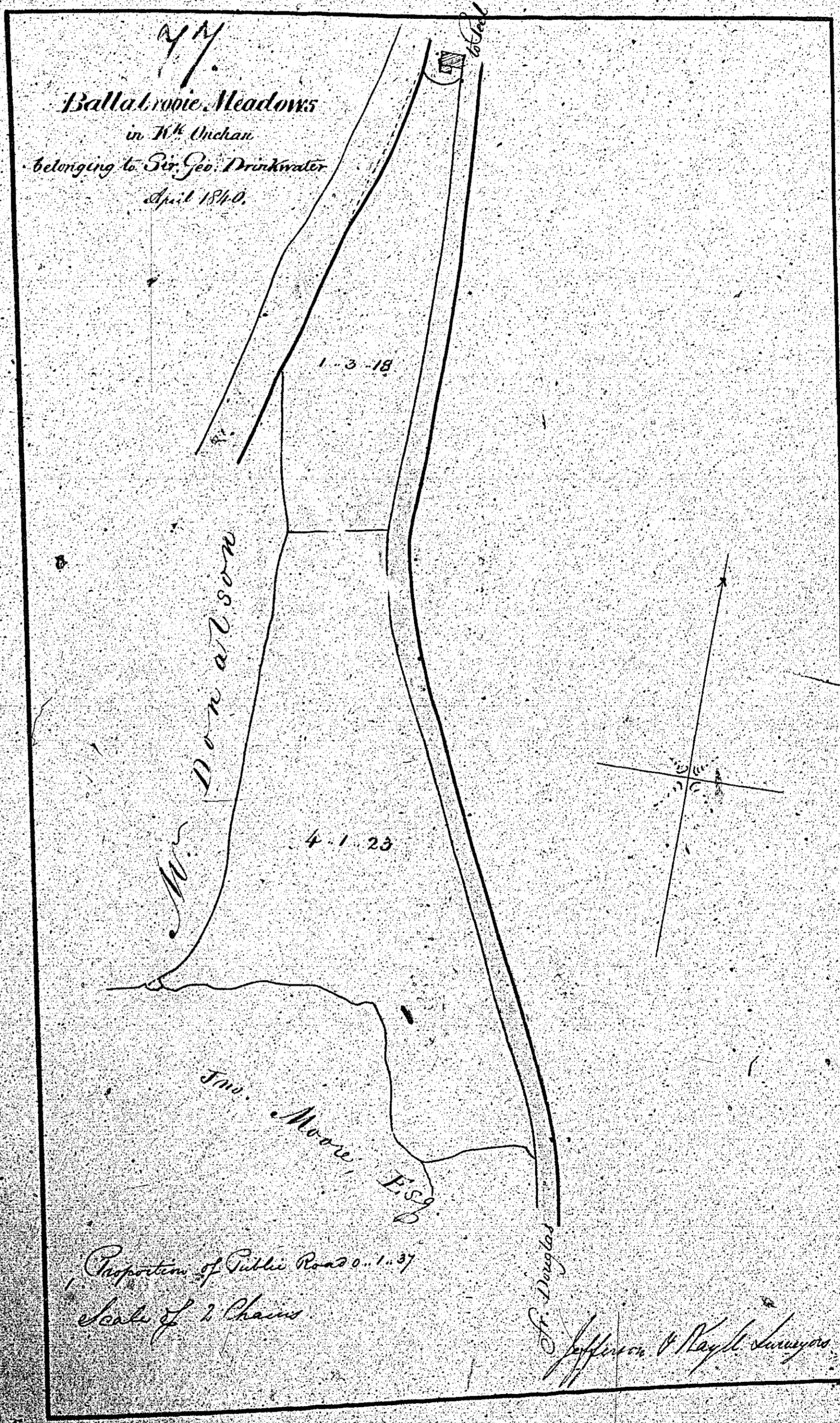

Reference
A & B

1	2	11
2	1	11
3	1	11
4	1	11
5	1	11
6	1	11
7	1	11
8	1	11
9	1	11
10	1	11
11	1	11
12	1	11
13	1	11
14	1	11
15	1	11
16	1	11
17	1	11
18	1	11
19	1	11
20	1	11
21	1	11
22	1	11
23	1	11
24	1	11
25	1	11
26	1	11
27	1	11
28	1	11
29	1	11
30	1	11
31	1	11
32	1	11
33	1	11
34	1	11
35	1	11
36	1	11
37	1	11
38	1	11
39	1	11
40	1	11
41	1	11
42	1	11
43	1	11
44	1	11
45	1	11
46	1	11
47	1	11
48	1	11
49	1	11
50	1	11
51	1	11
52	1	11
53	1	11
54	1	11
55	1	11
56	1	11
57	1	11
58	1	11
59	1	11
60	1	11
61	1	11
62	1	11
63	1	11
64	1	11
65	1	11
66	1	11
67	1	11
68	1	11
69	1	11
70	1	11
71	1	11
72	1	11
73	1	11
74	1	11
75	1	11
76	1	11
77	1	11
78	1	11
79	1	11
80	1	11
81	1	11
82	1	11
83	1	11
84	1	11
85	1	11
86	1	11
87	1	11
88	1	11
89	1	11
90	1	11
91	1	11
92	1	11
93	1	11
94	1	11
95	1	11
96	1	11
97	1	11
98	1	11
99	1	11
100	1	11

Scale of 1 Chain

Jefferson & Neyle Surveyors

There are no plans
numbered 78 or 79

Handwritten notes on the left edge of the right page, including the word "Plans" and other illegible cursive text.

Reference

1	2	3	4	5
6	7	8	9	10
11	12	13	14	15
16	17	18	19	20
21	22	23	24	25
26	27	28	29	30
31	32	33	34	35
36	37	38	39	40
41	42	43	44	45
46	47	48	49	50
51	52	53	54	55
56	57	58	59	60
61	62	63	64	65
66	67	68	69	70
71	72	73	74	75
76	77	78	79	80
81	82	83	84	85
86	87	88	89	90
91	92	93	94	95
96	97	98	99	100

Handwritten signature at the bottom of the table.

Plan
 of the
 Estate
 of
 Kerdoo
 in the
 Parish of Brechan
 belonging to
 Mr. Charles Moore
 by
 Mr. Robt. Boyle
 April 6. 1779

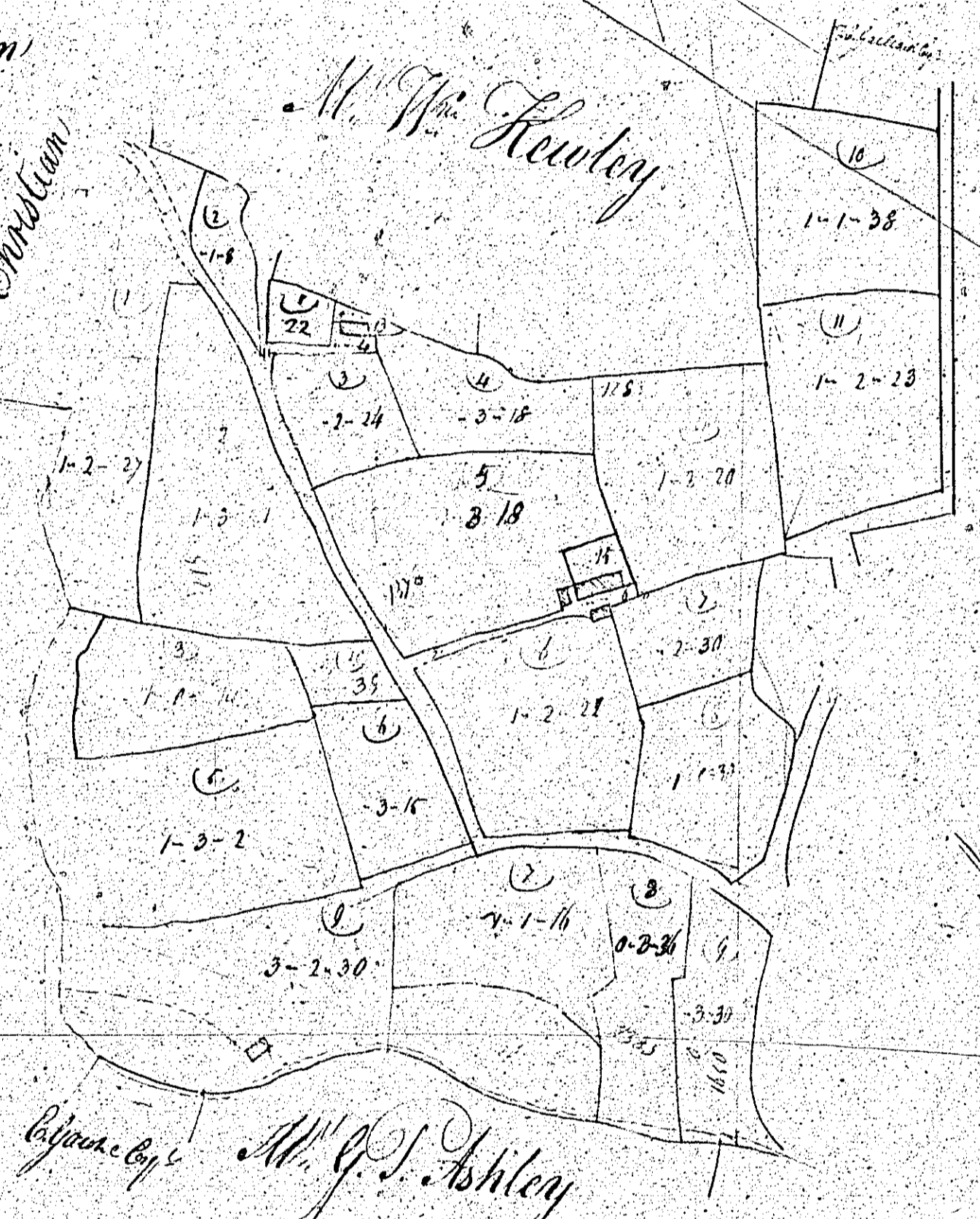

Reference
 of A. B. 70

1	1-1-38
2	1-2-23
3	1-2-27
4	1-2-28
5	1-2-29
6	1-2-30
7	1-3-2
8	1-3-14
9	1-3-15
10	1-3-16
11	1-3-17
12	1-3-18
13	1-3-19
14	1-3-20
15	1-3-21
16	1-3-22
17	1-3-23
18	1-3-24
19	1-3-25
20	1-3-26
21	1-3-27
22	1-3-28
23	1-3-29
24	1-3-30
25	1-3-31
26	1-3-32
27	1-3-33
28	1-3-34
29	1-3-35

Joseph Blake Surveyor

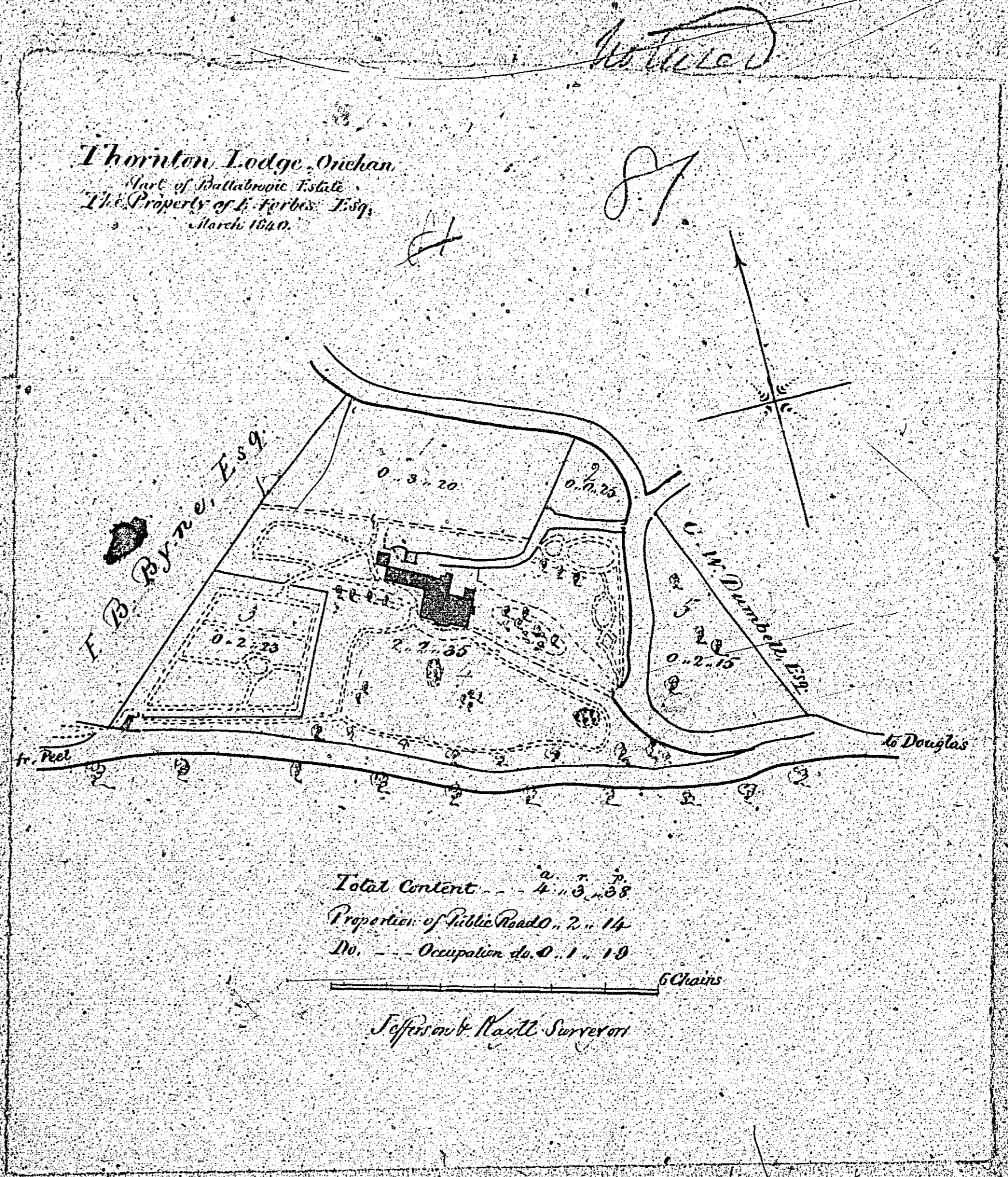

*Received Capt. Murray's account of 5/16/20
 for 1000 lbs*