

Plan of Garden  
part of the land of  
Bathachursey  
in the  
Parish of Crochan  
belonging to  
Mr. Basil Gordon  
April 10<sup>th</sup> 1812

45

John Gordon

From Douglas to

C. Gordon

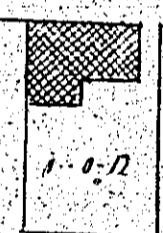

M. Gordon

J. O. P.

One acre & a half

Joseph Blake Surveyor

46. N  
Man. Gordon  
parish of  
Bullachisky  
in the  
parish of Cuckan  
to be given to  
Mr. the Currier  
April 2<sup>o</sup> 1740

John. Franks Esq<sup>r</sup>

John Douglas Esq<sup>r</sup> Henry

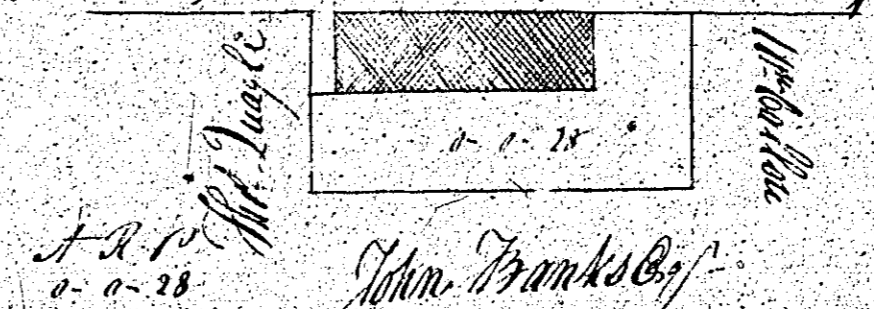

John. Franks Esq<sup>r</sup>

Seal of the parish to be taken

Joseph Blake Esq<sup>r</sup>

47  
Plan of Garden  
part of the land of  
Mullachundy  
in the  
Parish of Dromon  
belonging to  
W. Child & Co  
April 12<sup>th</sup> 1810

A.P. 15  
1-0-12

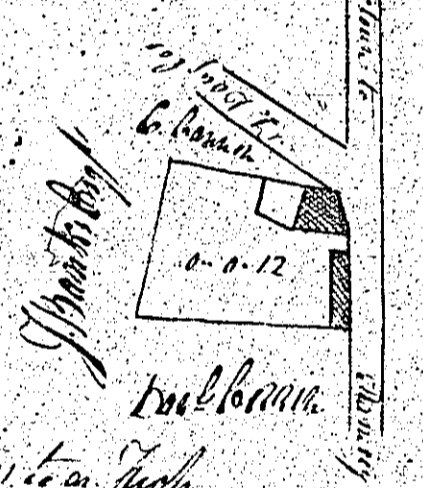

Scale of 1 Chain to an Inch  
Joseph Blake Survey

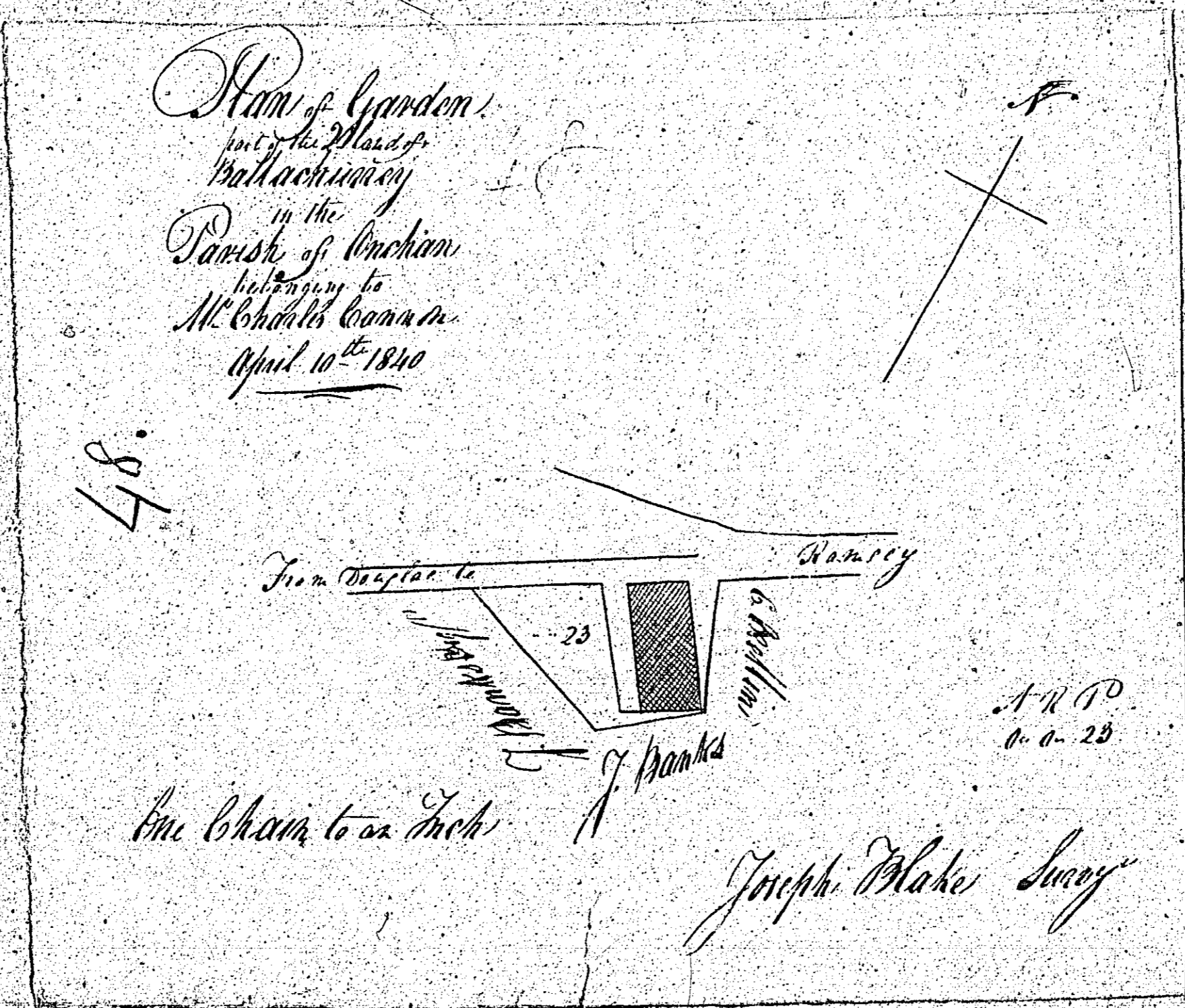

ISLE OF MAN GOVERNMENT: GENERAL REGISTRY

TITHE PLANS: PARISH OF ONCHAN

Original monotone

1:30

King's House & Yard  
 Part of the Land of  
 Pottacherry 49  
 Parish of Enchan  
 The property of  
 Michael Connor  
 1740

A Spittal & 1/2

Road to                      Rowrey  
 100                      100  
 100                      100

John Killian  
 One Chain to the Inch      Joseph Blake Surveyor

50.

Plan of Garden  
with the site of  
Ballachury  
in the  
Parish of Inchon  
situated in  
the County of  
Dublin  
April 17th 1750

J. Banks Esq.

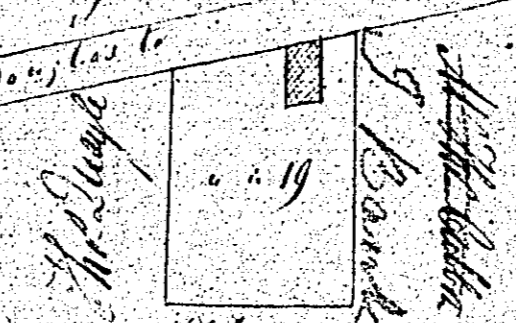

Total of  
6.0.0

Scale of 1 Inch

Joseph Blake del.