

Plan
 of
 Bullaskelly
 in the
 Parish
 of
 Unchan
 according to
 Mr. Tho. Cannell
 July 9. 1839.

14.

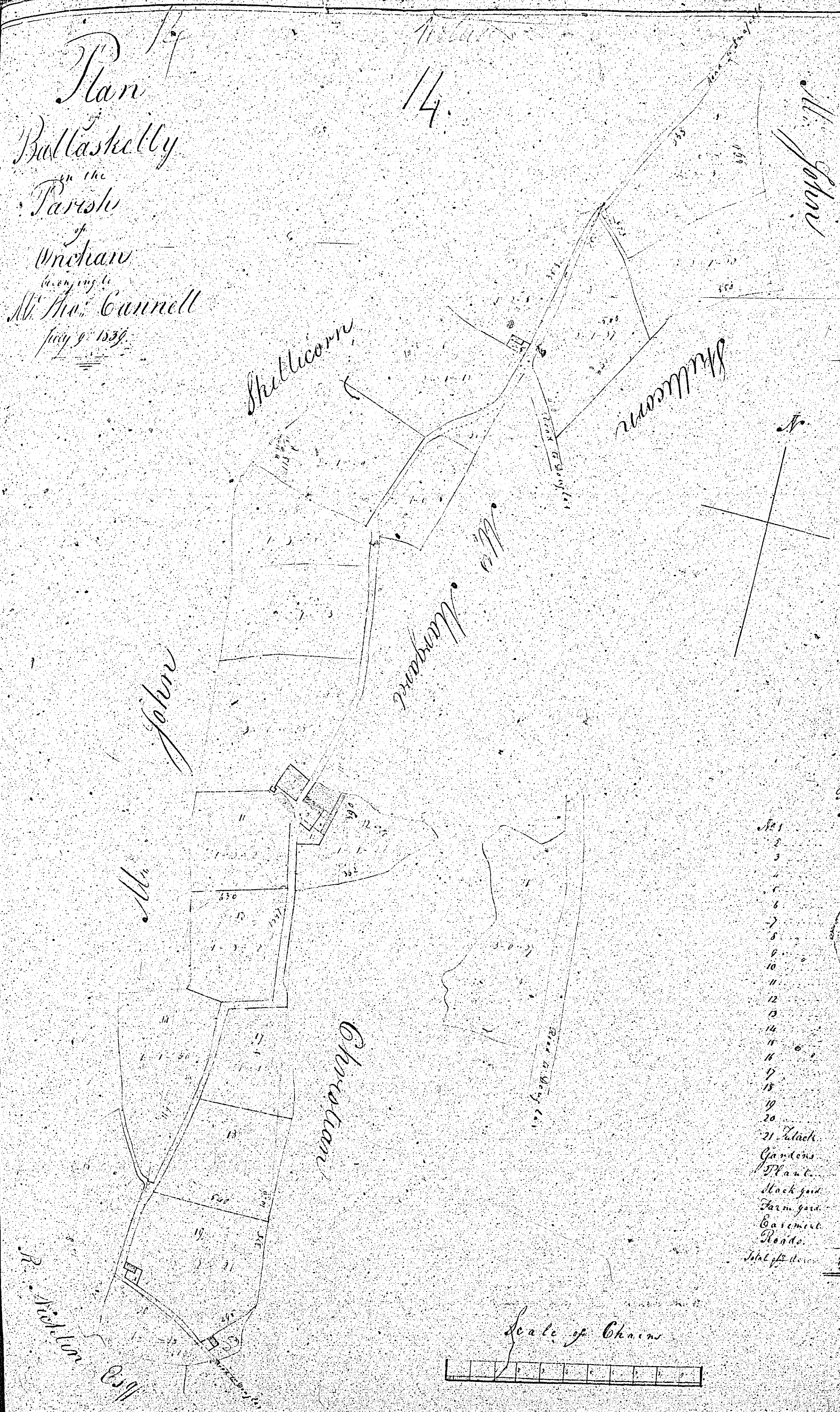

	Reference	R	P
1	2	3	36
2	2	1	26
3	2	1	31
4	1	2	15
5	2	2	18
6	1	1	21
7	1	0	14
8	1	3	18
9	2	1	22
10	1	3	25
11	1	3	2
12	1	3	22
13	1	3	25
14	1	1	30
15	2	2	19
16	3	2	23
17	1	1	31
18	2	1	1
19	2	2	21
20	1	1	18
21	3	3	37
Gardens			37
Plant.			10
Black gnd.			12
Farm gnd.			8
Basement			36
Roads	1	1	2
Sub off. d.	47	1	28

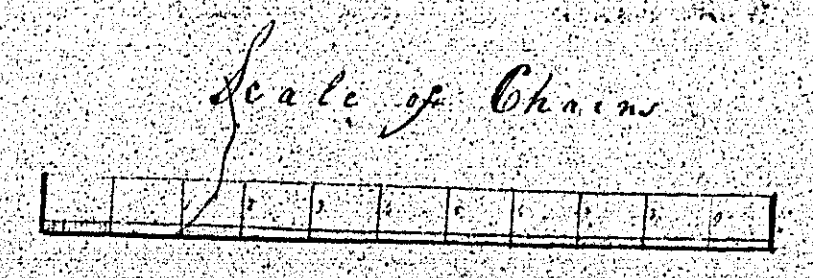

Joseph Blake Surveyor 1839

Plan
of the
Estate
Begrade
Parish in the
County of Anchan
M^r Thomas Christian
May 13th 1837

15

M^r John Cain

M^r John Christian

M^r Edm^d Christian

M^r John Christian

M^r Robert Bostell

M^r John Cannell

M^r John Cannell

Scale of Chains

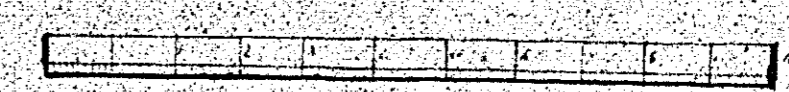

Distance
1
2
3
4
5
6
7
8
9
10
11
12
13
14
15
16
17
18
19
20
21
22
23
24
25
26
27
28
29
30
31
32
33
34
35
36
37
38
39
40
41
42
43
44
45
46
47
48
49
50
51
52
53
54
55
56
57
58
59
60
61
62
63
64
65
66
67
68
69
70
71
72
73
74
75
76
77
78
79
80
81
82
83
84
85
86
87
88
89
90
91
92
93
94
95
96
97
98
99
100

John Blake

Plan
of the
Estate
Bequeathed
to the
Marquis of Anchar
by
Mr. John Cornhill
April 1753

18.

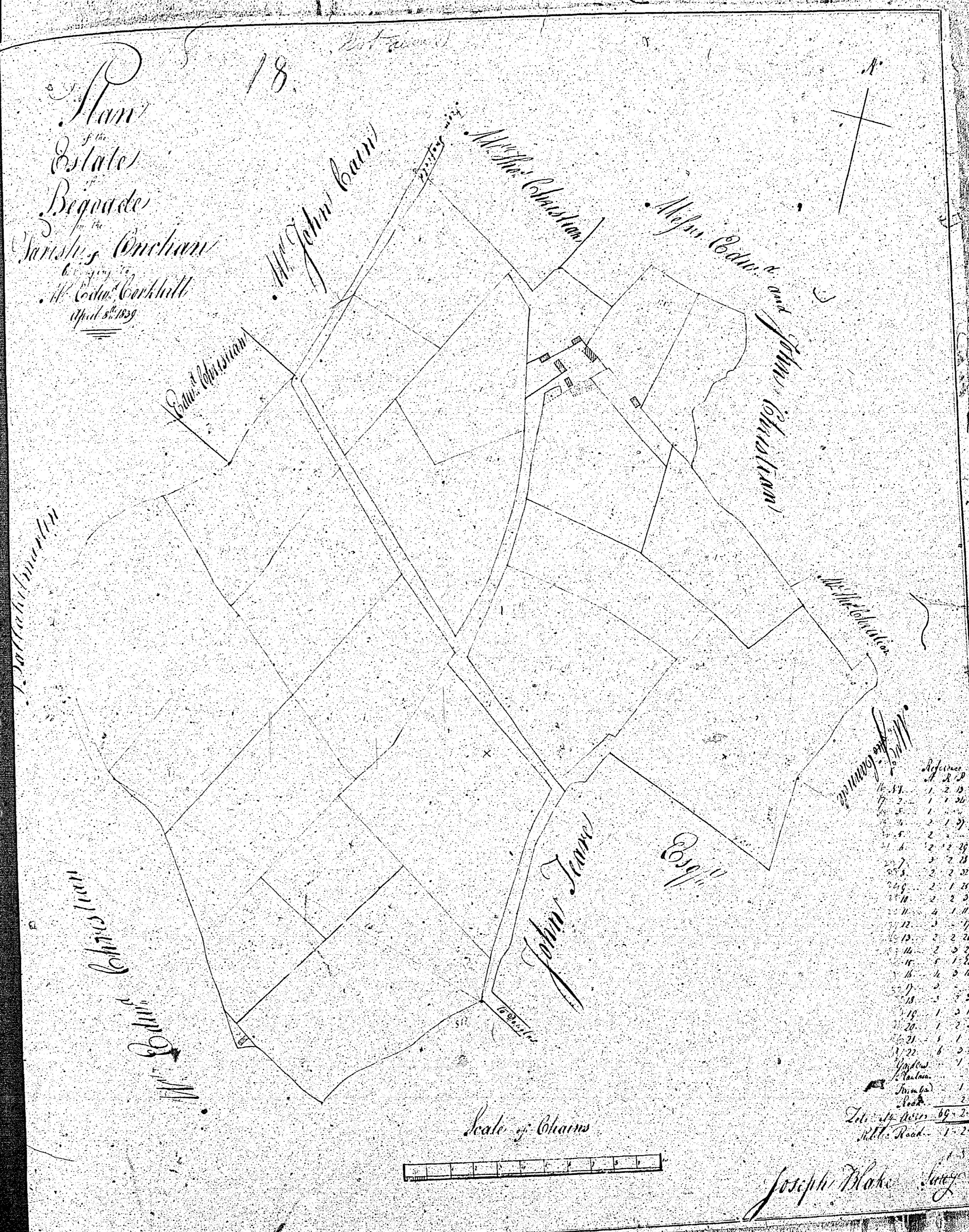

Joseph Wake Survey

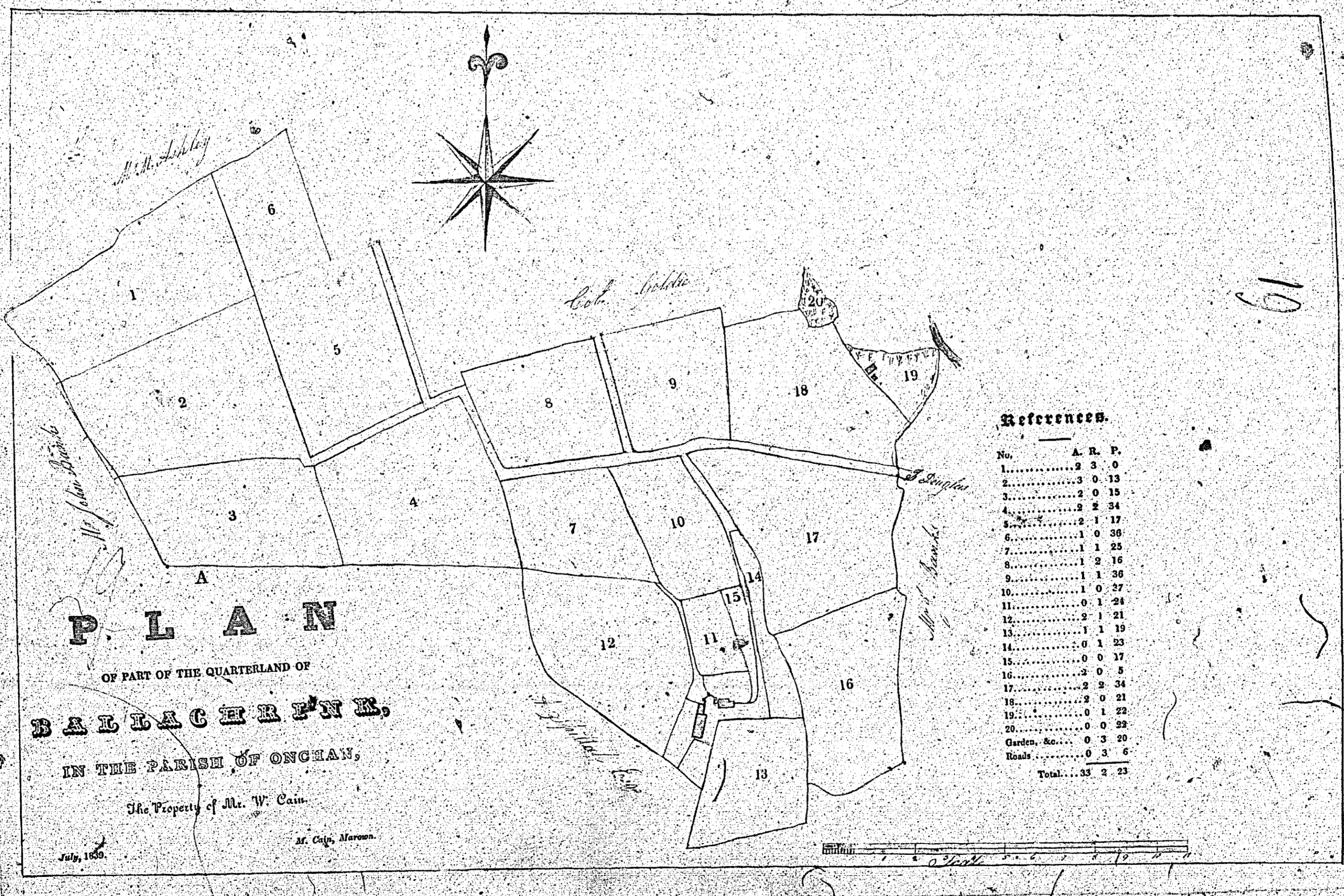

P L A N
 OF PART OF THE QUARTERLAND OF
BALLACHERYNE,
 IN THE PARISH OF ONCHAN.

The Property of Mr. W. Carr.

July, 1850.

M. C. G. A. A. A.

References.

No.	A.	R.	P.
1.....	2	3	0
2.....	3	0	15
3.....	2	0	15
4.....	3	2	34
5.....	2	1	17
6.....	1	0	36
7.....	1	1	25
8.....	1	2	16
9.....	1	1	26
10.....	1	0	27
11.....	0	1	24
12.....	2	1	21
13.....	1	1	19
14.....	1	0	23
15.....	0	0	17
16.....	2	0	5
17.....	2	0	24
18.....	2	0	21
19.....	0	1	22
Garden, &c.....	0	3	20
Roads.....	0	3	6
Total.....	35	2	23

61

Plan
 of
 THE SOUTH-EAST PART
 OF
 BALLIG QUARTERLAND
 The Property of
 MR JOHN CAIN
 In the Parish of
 KIRK-ON-CHAN
 1839.

Reference

1	Thomas O'Connell
2	The Duke
3	John Martin
4	James Martin
5	James O'Connell
6	John O'Connell
7	James O'Connell
8	James O'Connell
9	James O'Connell
10	James O'Connell
11	James O'Connell
12	James O'Connell
13	James O'Connell
14	James O'Connell
15	James O'Connell
16	James O'Connell
17	James O'Connell
18	James O'Connell
19	James O'Connell
20	James O'Connell
21	James O'Connell
22	James O'Connell
23	James O'Connell
24	James O'Connell
25	James O'Connell
26	James O'Connell
27	James O'Connell
28	James O'Connell
29	James O'Connell
30	James O'Connell
31	James O'Connell
32	James O'Connell
33	James O'Connell
34	James O'Connell
35	James O'Connell
36	James O'Connell
37	James O'Connell
38	James O'Connell
39	James O'Connell
40	James O'Connell
41	James O'Connell
42	James O'Connell
43	James O'Connell
44	James O'Connell
45	James O'Connell
46	James O'Connell
47	James O'Connell
48	James O'Connell
49	James O'Connell
50	James O'Connell

*Map as the Road account
was private property*

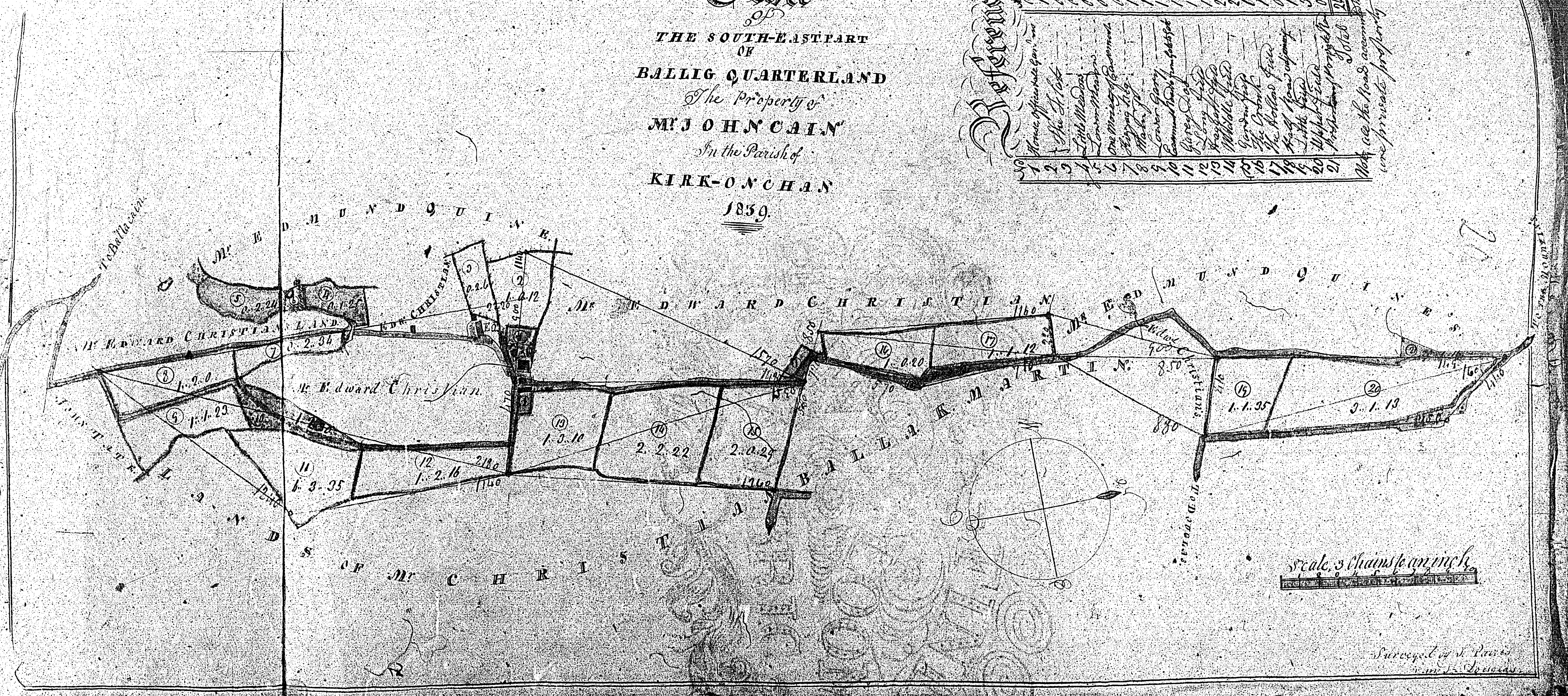

Surveyed by J. Cain