



Plan
 of part of the Estates of
 Ballakermeen and Ballabrookie,
 in the Parish of Onchan,
 the property of
 C. Bacon Esq.
 Scale 2 1/2 Chains to an Inch.

Ballakermeen copied from
 a plan by John Lewis 1799
 Ballabrookie reduced from
 a plan by Mel in 1835
 Pitt Rivers
 12 June 1860

Ballakermeen		Ballabrookie	
No.	T. R. P.	No.	T. R. P.
1	0.1.23	20	1.3.8
2	0.3.34	21	1.0.2
3	2.1.33	22	5.0.36
4	1.1.25		Total 5.0.6
5	3.0.14		
6	1.2.20		
7	3.2.33		
8	3.0.28		
9	5.0.23		
10	1.3.30		
11	2.1.13		
12	1.1.32		
13	2.0.20		
14	0.3.28		
15	0.0.34		
16	1.3.28		
17	1.1.20		
18	1.3.7		
19	0.3.37		
20	2.1.13		
21	1.1.32		
22	2.0.20		
	0.3.25		
	0.0.34		
	1.3.25		
	1.1.20		
	2.1.7		
	2.1.7		
	5.0.6		

Tithes Collected
 J. R. P.
 Ballakermeen 5.0.3
 Ballabrookie 5.0.6
 Grand Total 10.0.9

ISLE OF MAN GOVERNMENT: GENERAL REGISTRY
 TITHE PLANS: PARISH OF ONCHAN
 Original coloured (decorative) 1:30

10.

Ground plan
Dwelling Houses & Offices on
Kearns Terrace
Situate in the
District of Onchan
the property of
Wm. Christian
1850

W. Christian

Wm. Christian

	Date			
2	8	5	2	0
-	6	-	6	-
-	-	-	-	-

Kearns Terrace Road

Wm. Christian
1850

Wm. Christian
Onchan to an Inch
Joseph Blake Survey

11.

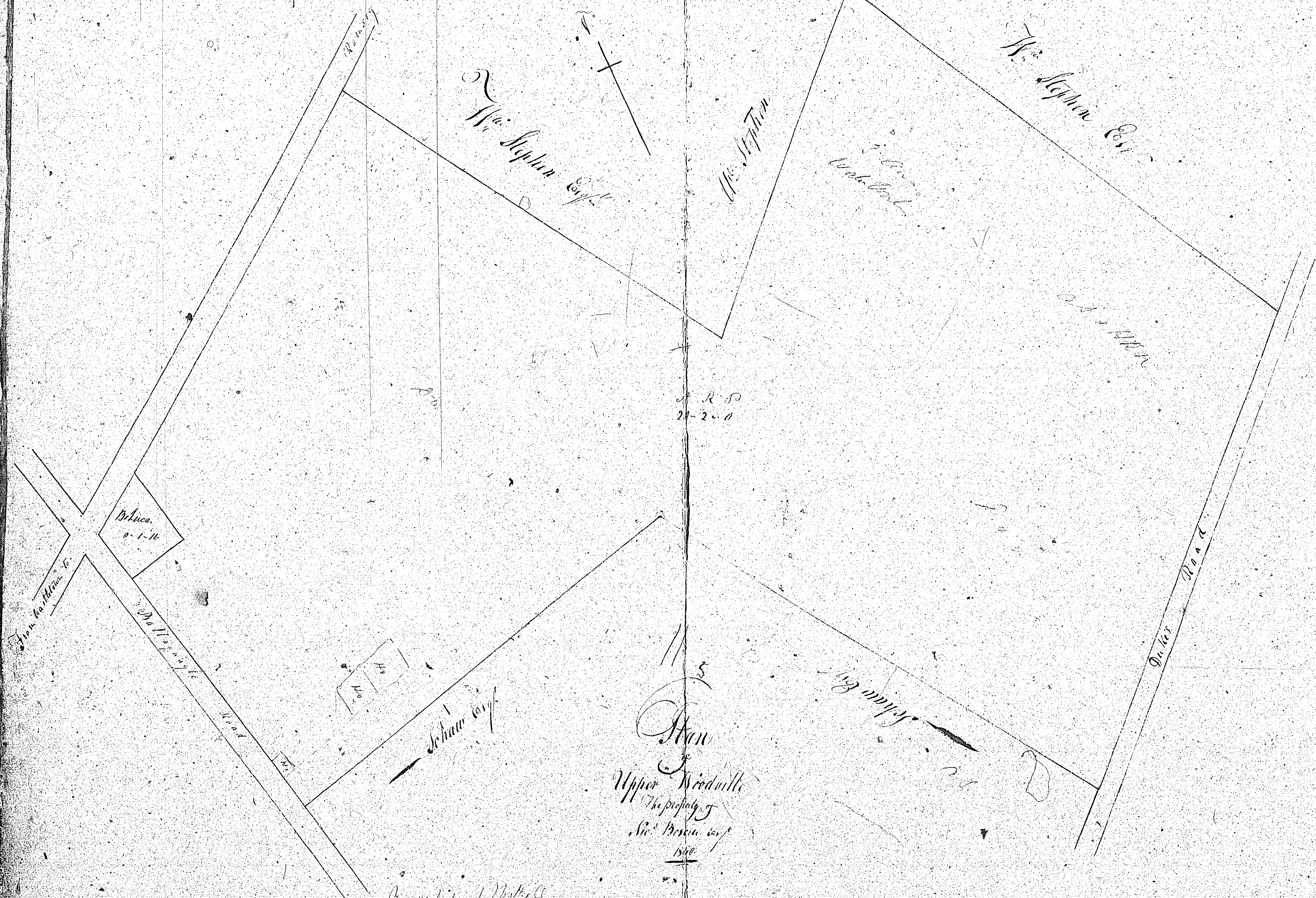

The
 Upper Woodville
 The property of
 Sir
 1800

Messrs. H. & J. Pittell

One Chain to a Inch

Joseph Blake Survey

W. Shaw

Not used

Ground plan of Dwelling & out 1/2 garden
(2 Land Ballagayle)
Situate in the
Parish of Cuckan 13
the property of
Mr. W. Shaw
1422-1841

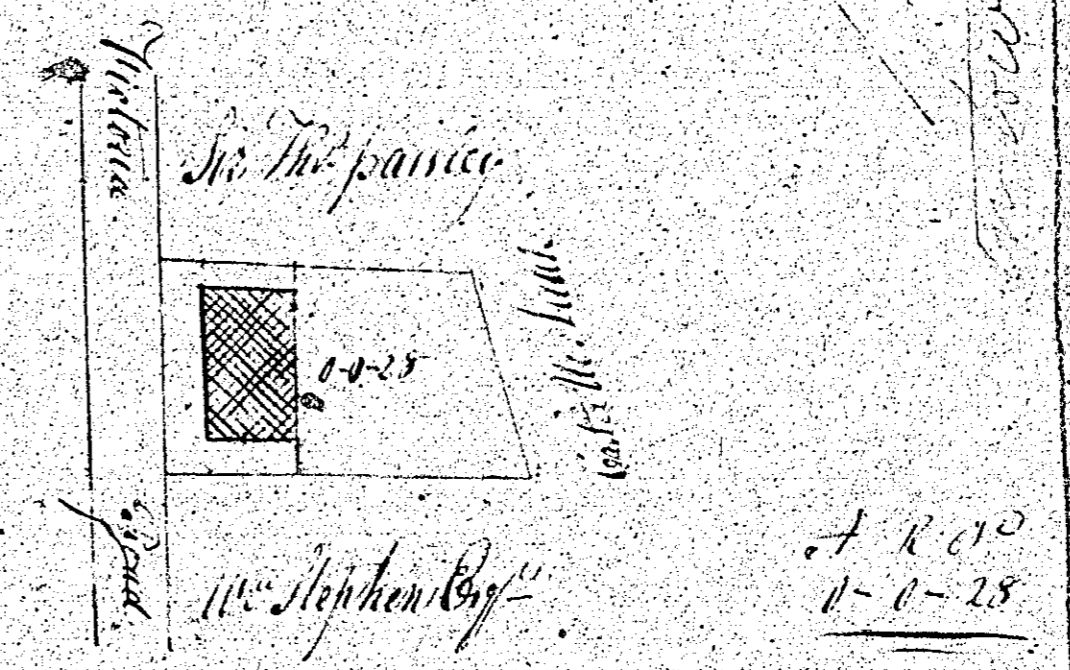

One Chain to an Inch

Joseph Blake Survey

Reference	A	R	P
1	3	34	
2	1	22	
3	1	37	
4	2	18	
5	1	26	
6	1	16	
7	1	18	
8	2	22	
9	1	28	
10	1	3	
11	1	22	
12	1	3	
13	2	21	
14	1	18	
15	2	27	
16	1	12	
17	1	12	
18	1	16	
19	1	2	
20	1	24	