

A Plan & Survey of Part of
 Ballaghionex in the Parish of
 Michael The Property of
 Mr. J. Oates BY P. Kelly
 Aug^r 1838

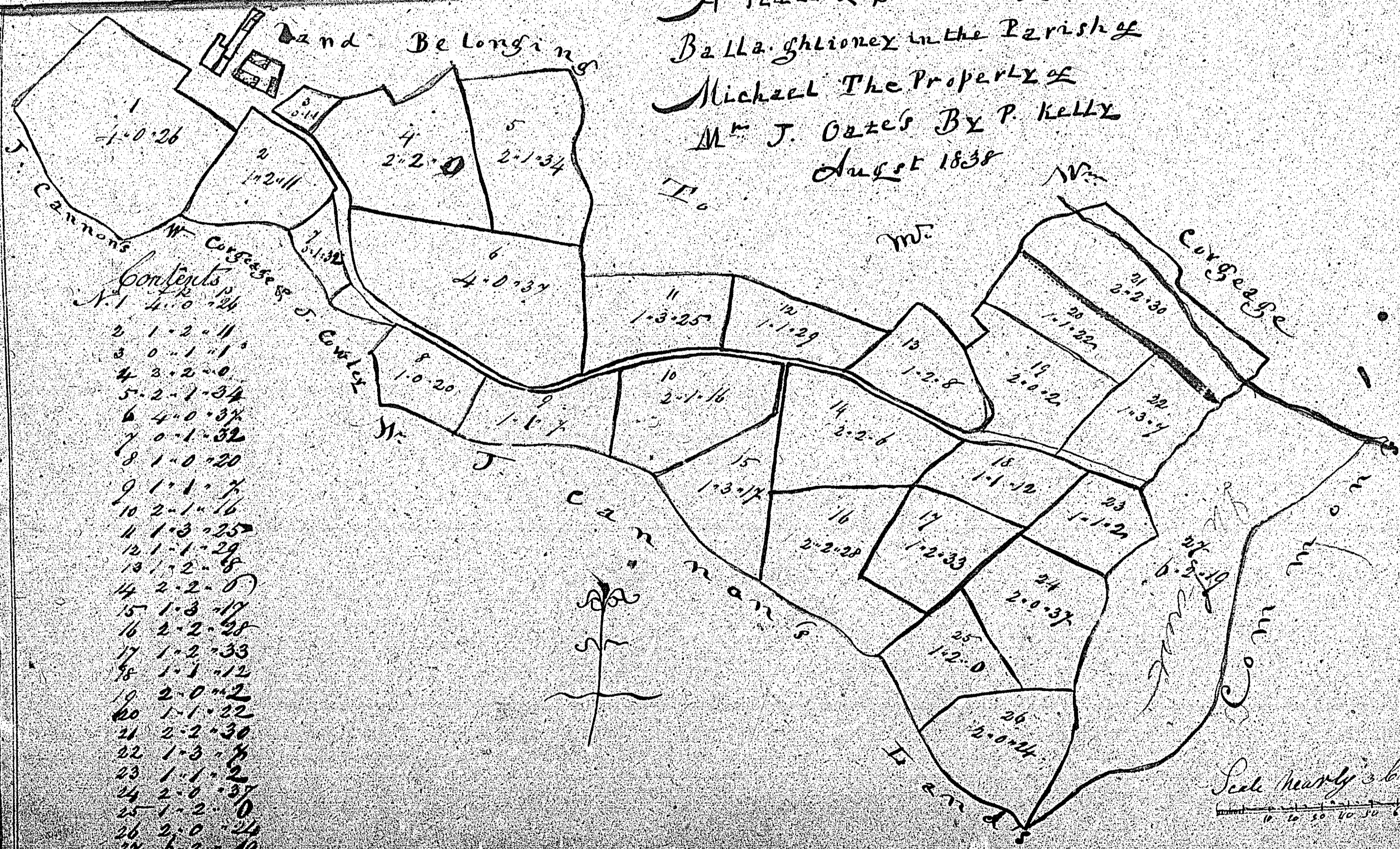

Land Belongings

Parcel No.	Date
1	1-0-26
2	1-2-11
3	2-2-0
4	2-1-34
5	4-0-37
6	1-3-25
7	1-1-29
8	1-0-20
9	2-1-16
10	1-2-8
11	2-2-1
12	1-1-30
13	2-0-2
14	1-3-7
15	2-2-1
16	1-1-12
17	1-1-22
18	1-2-33
19	1-1-12
20	2-0-2
21	1-1-22
22	2-2-30
23	1-3-7
24	1-1-12
25	2-0-2
26	1-1-22
27	2-2-30
28	1-3-7
29	1-1-12
30	2-0-2
31	1-1-22

20
 5/11

143
 See nearly's plan from Incht
 0 10 20 30 40 50 60 70 80 90

A Plan and Survey
 of intact Lands
 in the Parish of Michael
 the Property of
 Mr. Wm. Quayle By P. Kelly, m. m. o. n. s.
 August 29 1839

Contents

No. 1	3.3.21
2	3.2.35
3	1.1.55
4	3.1.2
5	5.2.9
Total	10.3.23

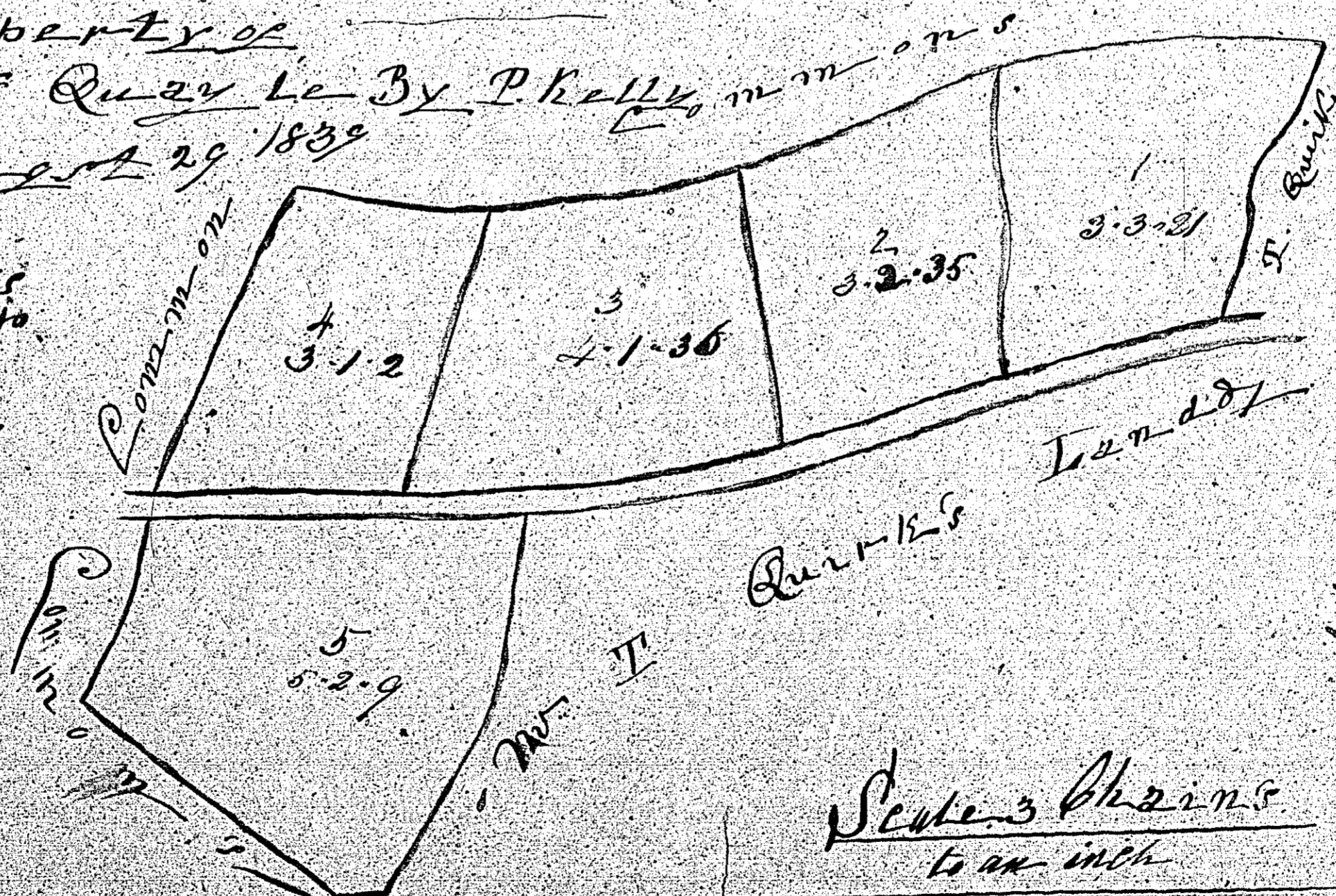

Scale 3 Chains
 to an inch

147

A Plan or Survey of Part of the Tithings
 and the Parish of Michael the Apocryphal
 of the W. County of Wick. Ireland
 Michael 1839

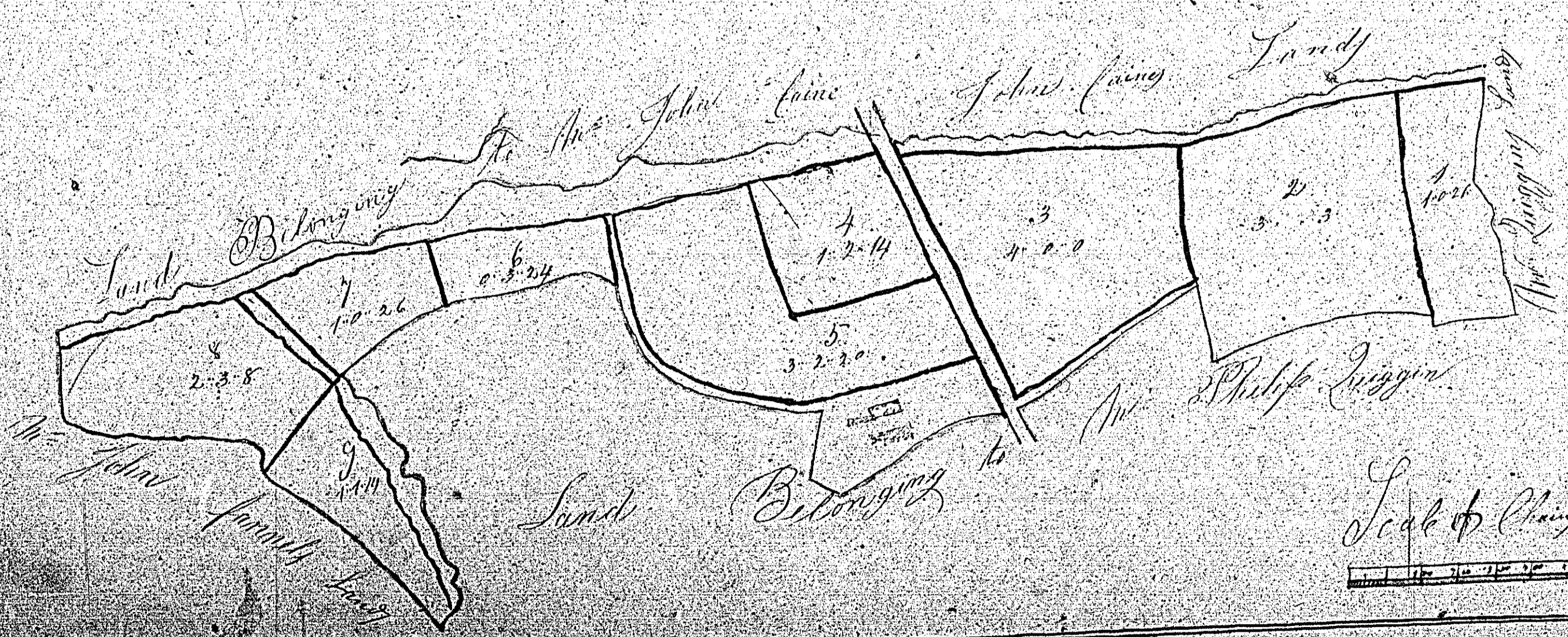
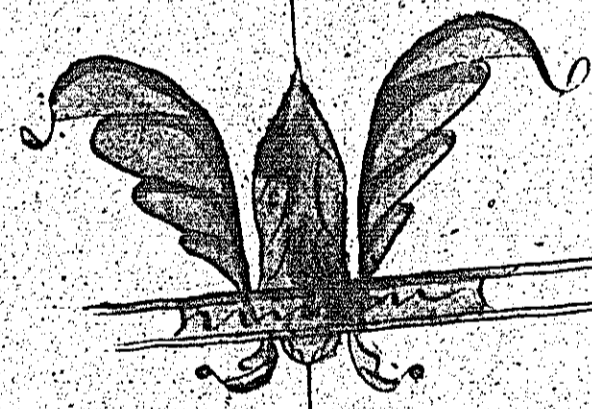

Contents			
No	A	R	0
1	1	0	26
2	3	3	33
3	1	0	6
4	1	2	14
5	3	2	30
6	5	3	24
7	1	0	26
8	2	3	8
9	1	1	14
Waste Soil	3	1	12
Water Ways	0	1	56
Wastage	8	3	26
Total	25	0	39

145

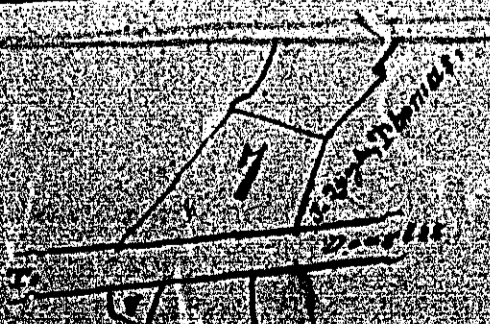

Contents

No of R ^{ts}	Acres	Roods	Furlongs
1	0	2	34
2	2	3	2
3	2	0	11
4	0	2	36
5	1	0	0
6	1	0	14
7	2	1	11
8	0	1	38
9	2	0	20
10	1	2	26
11	2	3	27
12	2	0	15
13	2	1	17
14	1	3	30
15	2	0	1
16	3	0	26
17	3	1	26
18	1	3	15
Total	34	2	20

A Plan & Survey of Part of
 Balla Chain in the parish of Michael
 the property of Mr. John Quayle
 By Patrick Kelly 1838

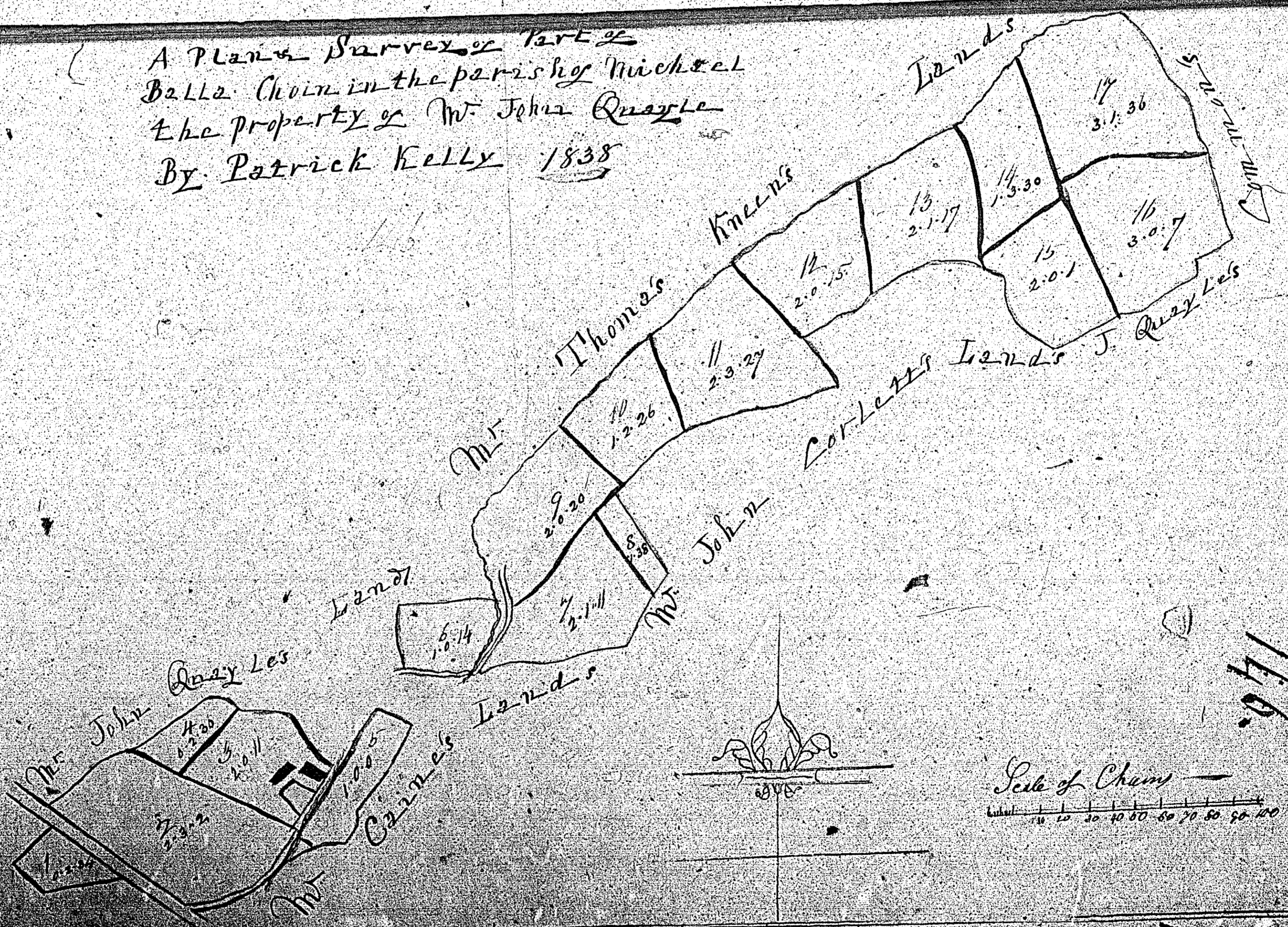

146.

ISLE OF MAN GOVERNMENT: GENERAL REGISTRY

TITHE PLANS: PARISH OF MICHAEL

1.30

147 Original monotone

148 Original coloured

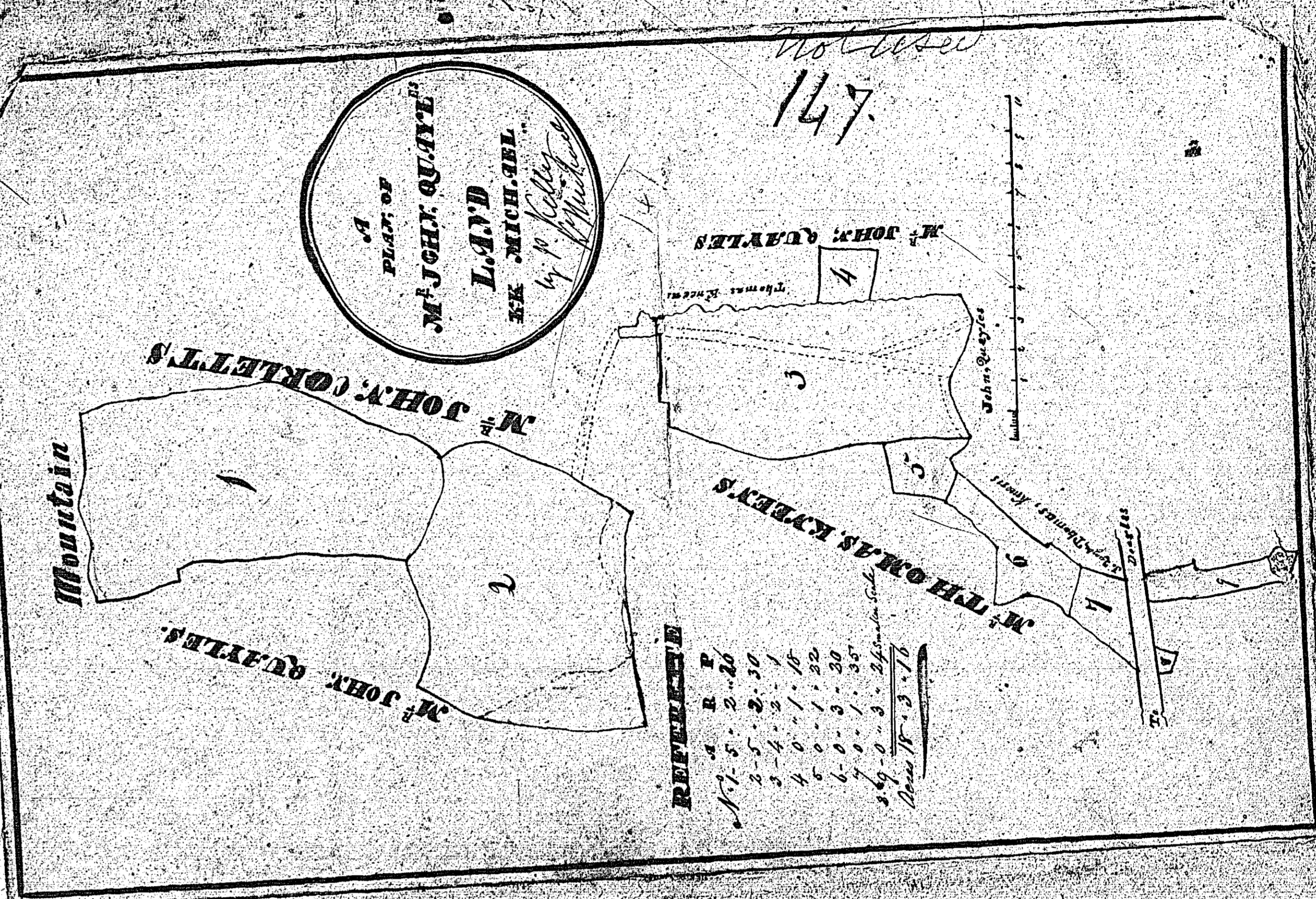

ISLE OF MAN GOVERNMENT: GENERAL REGISTRY

TITHE PLANS: PARISH OF MICHAEL

Originals coloured

1:30

149
Adam & Susan

CAMMALL

in the Parish of Michael & Property of

Mr J. O'Connell

By Patrick Kelly & Co Surveyors 1840

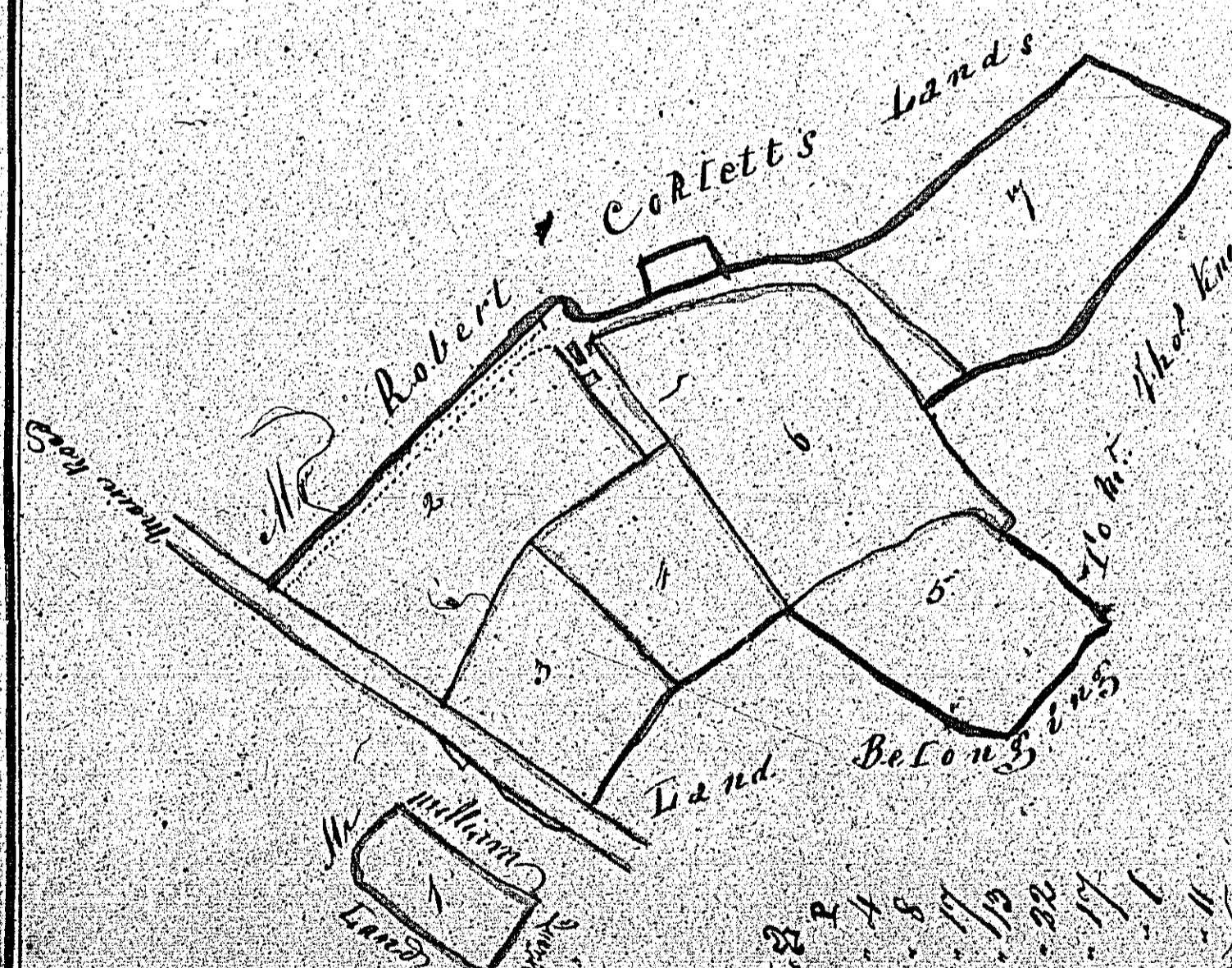

1	1-0-0
2	1-0-0
3	1-0-0
4	1-0-0
5	1-0-0
6	1-0-0
7	1-0-0
8	1-0-0
9	1-0-0
10	1-0-0
11	1-0-0
Total	11-0-0

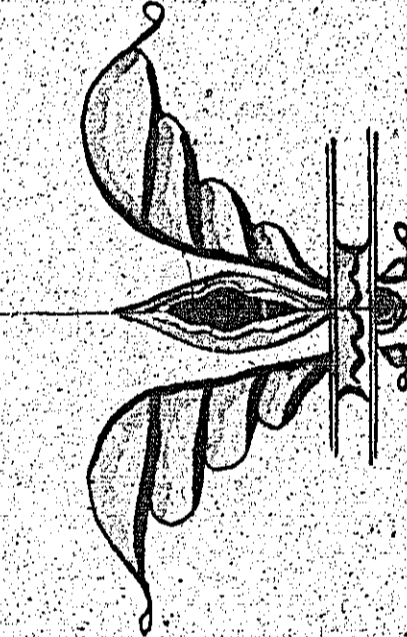
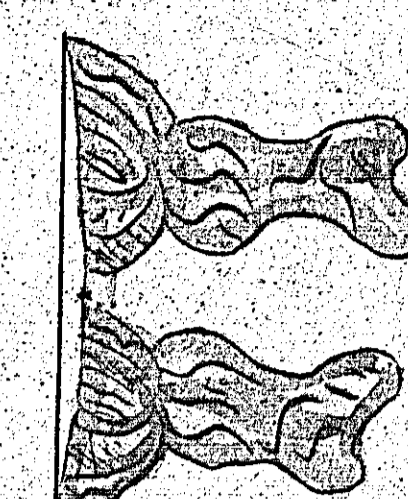

W ——— E
 1 inch = 100 feet

149

Scale of Chains

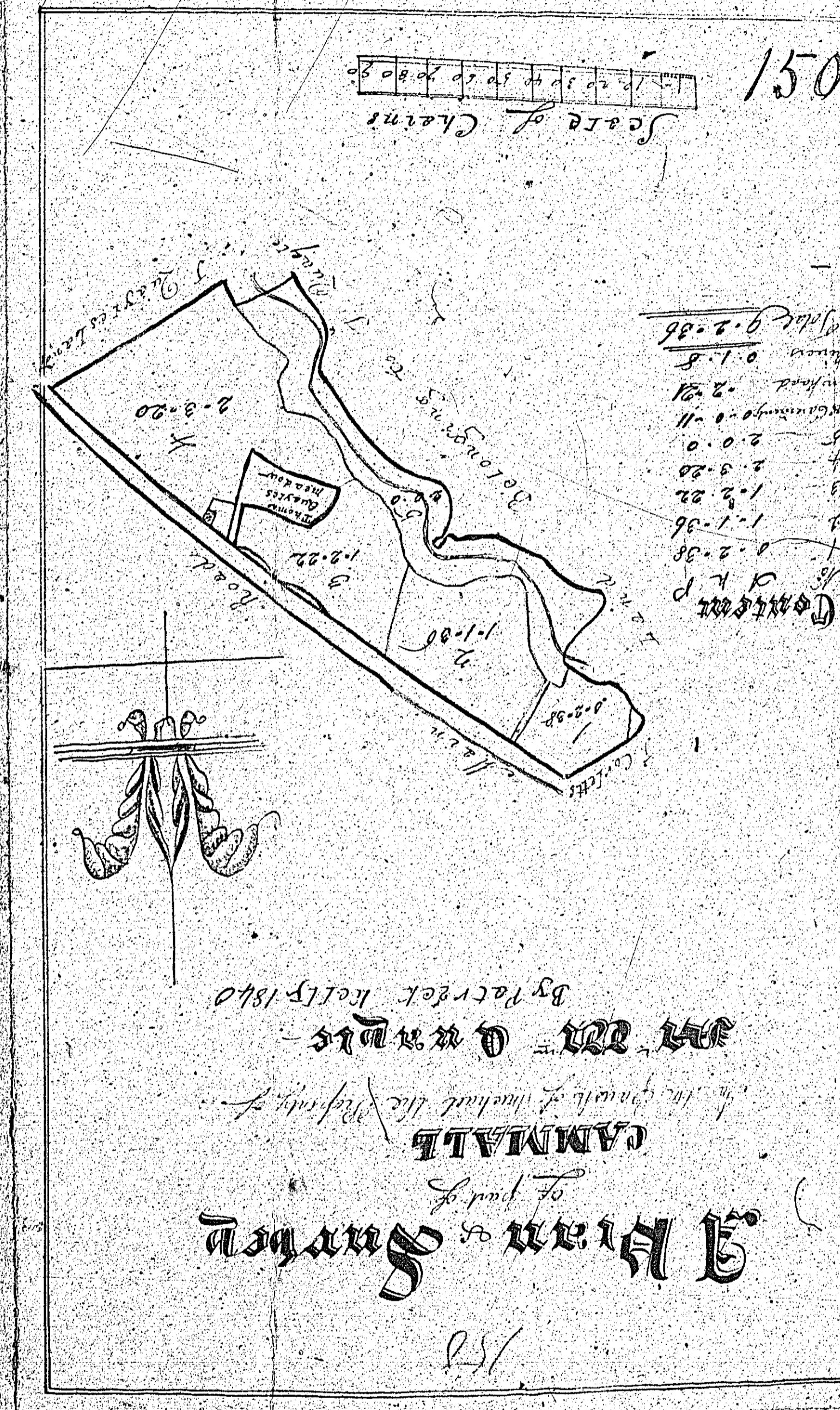

Adam & Susan
CAMMALL
 in the Parish of Michael & Property of
Mr J. O'Connell
 By Patrick Kelly & Co Surveyors 1840

150

1	1-0-0
2	1-0-0
3	1-0-0
4	1-0-0
5	1-0-0
6	1-0-0
7	1-0-0
8	1-0-0
9	1-0-0
10	1-0-0
11	1-0-0
Total	11-0-0