

Wm. P. Kelly and Survey 19.

of Part of
Balla-Meanaugh in the
Parish of Michael the property of
Mr. J. Caine By
P. Kelly Sep: 6th 1840

Contents

No.	A.	R.	P.
1	3	2	0
2	1	2	30
3	1	1	5
4	1	0	17
5	1	0	27
6	1	2	25
7	2	0	25
8	1	2	34
9	1	2	12
10	1	1	34
11	0	0	34
12	1	1	0
13	1	2	3
14	1	2	24
15	0	0	22
16	0	0	5
17	1	3	2
18	1	0	0
19	0	0	18

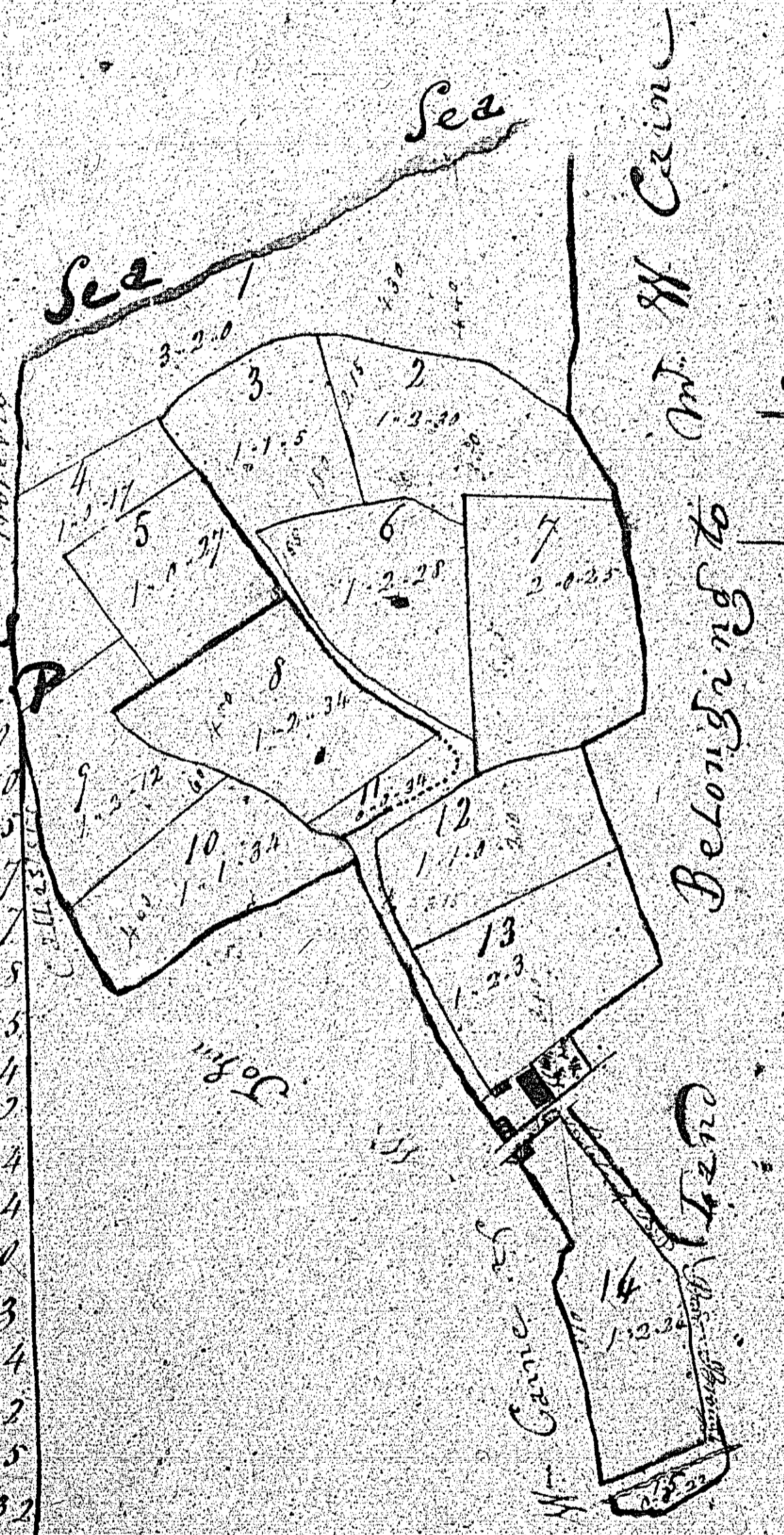

Scale 3 Chains to an Inch

20.

of a part of the
Ballamearagh
& other parcels of land
in the Parish of

MR MICHAEL
Belonging to
MR W^m CAINE



1	1	0	0
2	1	0	0
3	1	0	0
4	1	0	0
5	1	0	0
6	1	0	0
7	1	0	0
8	1	0	0
9	1	0	0
10	1	0	0
11	1	0	0
12	1	0	0
13	1	0	0
14	1	0	0
15	1	0	0
16	1	0	0
17	1	0	0
18	1	0	0
19	1	0	0

By John Crown 1840

Scale 3 Chains to an Inch



Contents

No.	Acres	Roods	Pence
1	11	3	21
2	1	2	34
3	1	3	13
4	1	2	34
5	1	2	17
6	0	2	23
7	0	2	27
8	2	0	6
9	1	0	12
10	1	0	18
11	0	3	33
12	0	3	53
13	1	0	14
14	0	3	34
15	1	0	21
16	1	0	21
17	0	2	38
18	0	2	38
19	0	2	38
20	0	2	38
21	0	2	38
22	0	2	38
23	0	2	38
24	0	2	38
25	0	2	38
26	0	2	38
27	0	2	38
28	0	2	38
29	0	2	38
30	0	2	38
31	0	2	38
32	0	2	38
33	0	2	38
34	0	2	38
35	0	2	38
36	0	2	38
37	0	2	38
38	0	2	38
39	0	2	38
40	0	2	38
41	0	2	38
42	0	2	38
43	0	2	38
44	0	2	38
45	0	2	38
46	0	2	38
47	0	2	38
48	0	2	38
49	0	2	38
50	0	2	38

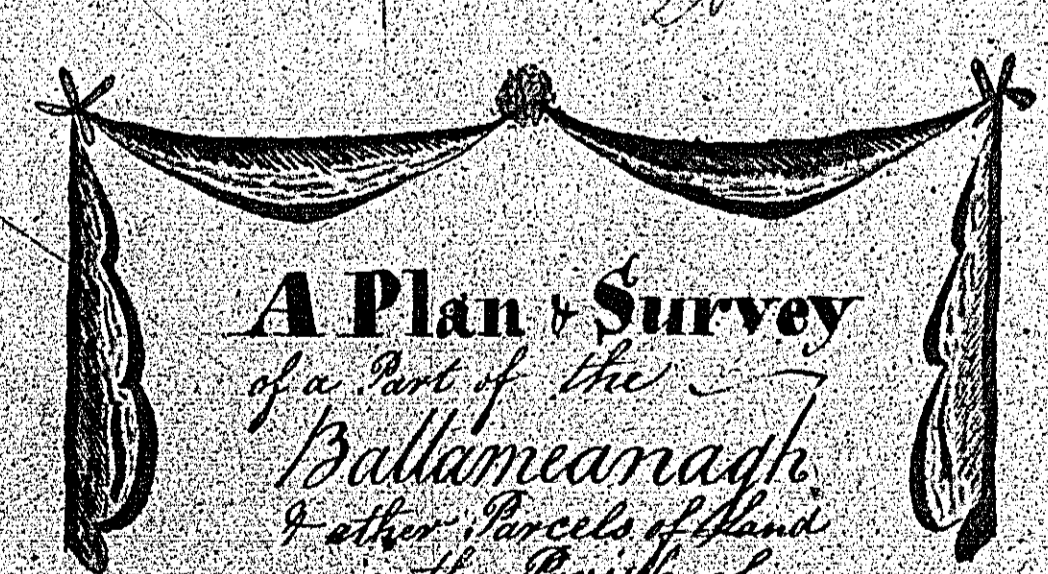

A Plan & Survey
of a Part of the
Ballameanagh
& other Parcels of Land
in the Parish of
KK MICHAEL
Belonging to
Mr W^m Caine

John Gravin 1804

ISLE OF MAN GOVERNMENT: GENERAL REGISTRY

TITHE PLANS: PARISH OF MICHAEL

- 22 Original coloured (decorative) 1.30
- 23 Original coloured (decorative)
- 24 Original coloured (decorative)
- 25 Original coloured (decorative)
- 26 Original monotone
- 27 Original monotone
- 28 Original monotone
- 29 Original monotone
- 30 Original coloured (decorative)

Plan and Survey of a piece of land in the Parish of Michael the property of Mr. John Cairns by P. Kelly Michael 1840

24.

Content
1-2-3-4-5
6-7-8-9-10
11-12-13-14-15-16-17-18-19

Scale & Chain to an Inch

A Plan & Survey of a house & Garden in the Parish of Michael the property of Mr. Thomas Cairns by P. Kelly Michael 1840

25.

Content & Perches
Road 3
11 Perches
Scale & Chain to an Inch

Plan & Survey of a house & Garden in the Parish of Michael the property of Mr. Cairns by P. Kelly Michael 1840

28.

Content
1-2-3-4-5-6-7-8-9-10-11-12-13-14-15-16-17-18-19-20-21-22-23-24-25-26-27-28-29-30-31-32-33-34-35-36-37-38-39-40-41-42-43-44-45-46-47-48-49-50-51-52-53-54-55-56-57-58-59-60-61-62-63-64-65-66-67-68-69-70-71-72-73-74-75-76-77-78-79-80-81-82-83-84-85-86-87-88-89-90-91-92-93-94-95-96-97-98-99-100

Scale & Chain to an Inch

A Plan & Survey of a house & Garden in the Parish of Michael the property of Mr. Cairns by P. Kelly Michael 1840

26.

Content & Perches
Scale & Chain to an Inch

A Plan and Survey of a house & Garden in the Parish of Michael the property of Mr. Cairns by P. Kelly Michael 1840

29.

Content & Perches
Scale & Chain to an Inch

A Plan & Survey of a house & Garden in the Parish of Michael the property of Mr. Cairns by P. Kelly Michael 1840

27.

Content
Scale & Chain to an Inch

A Plan & Survey of a house & Garden in the Parish of Michael the property of Mr. Cairns by P. Kelly Michael 1840

30.

Content & Perches
Scale & Chain to an Inch

A Plan of a house & Garden in the Parish of Michael the property of Mr. Cairns by P. Kelly Michael 1840

22.

A Plan & Survey of a house & Garden in the Parish of Michael the property of Mr. Cairns by P. Kelly Michael 1840

23.

A Plan & Survey of Houses
 Gardens Casements &c in Glen-whillen
 Mr. Michael the property of - as follows
 per Reference
 P. Kelly Michael
 1840

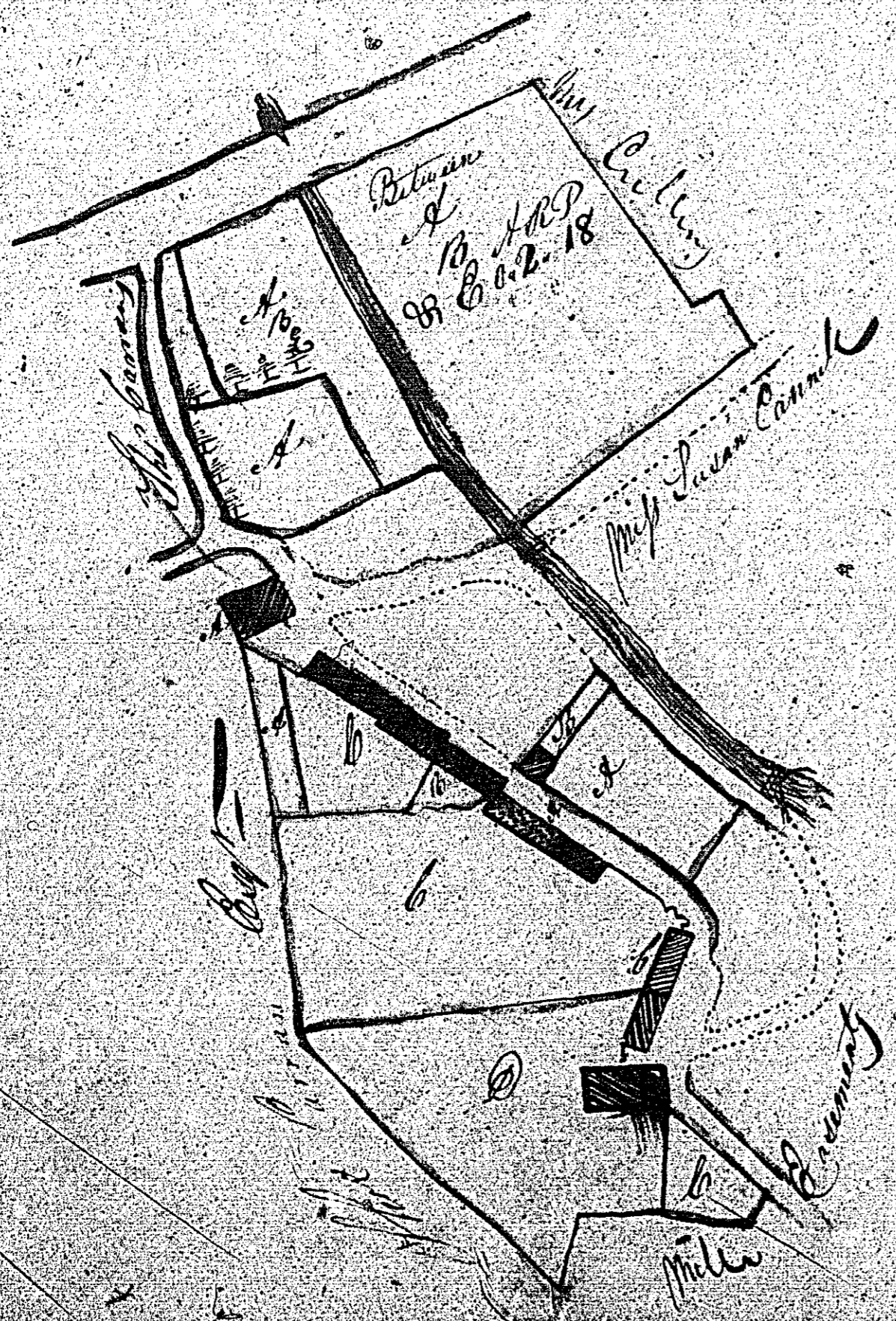

A	0.0.29	Marquet Caine
B	0.0.9	Rachy Jane Kelly
C	0.1.25	John Caine
D	0.1.0	Wm Kelly
E	-	Susan Connell

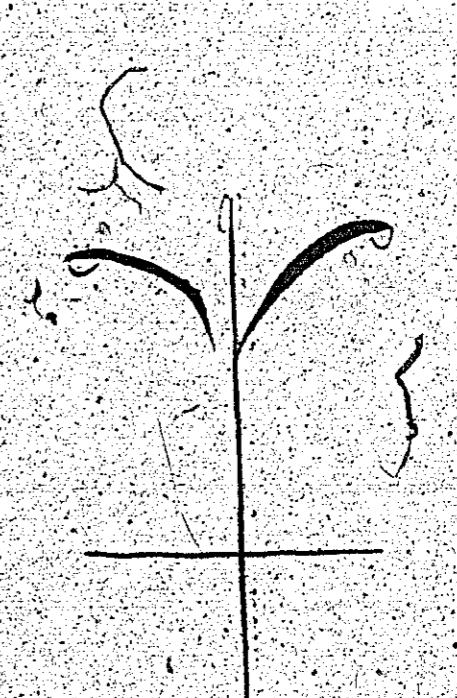

Scale of Chain to an Inch

31432

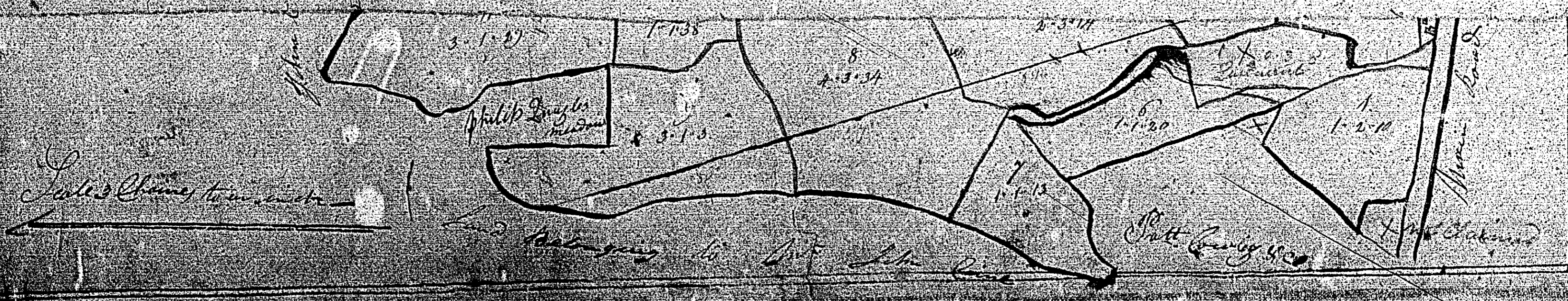

Contents -

No.	Acres	sq. Roods	sq. Perches
1	1	2	10
2	2	2	28
3	1	1	0
4	1	1	28
5	2	3	14
6	1	1	20
7	1	1	13
8	4	2	34
9	3	1	3
10	1	1	38
11	3	1	29
12	4	0	14
13	1	3	28
14	2	0	25
15	4	1	11
16	3	3	2
17	3	1	18
18	3	3	24
19	5	0	8
Public	4	1	22
James Bell's	3	39	
Total	58	21	4

A Plan & Survey of part of the
 Pargunoo and part of Britta - Sea
 In the parish of Michael the property of
 Mr John Cairn By Patrick Kelly
 December 2nd 1839

