

90.



ISLE OF MAN GOVERNMENT: GENERAL REGISTRY

TITHE PLANS: PARISH OF MAUGHOLD

Original coloured (decorative)

1:30

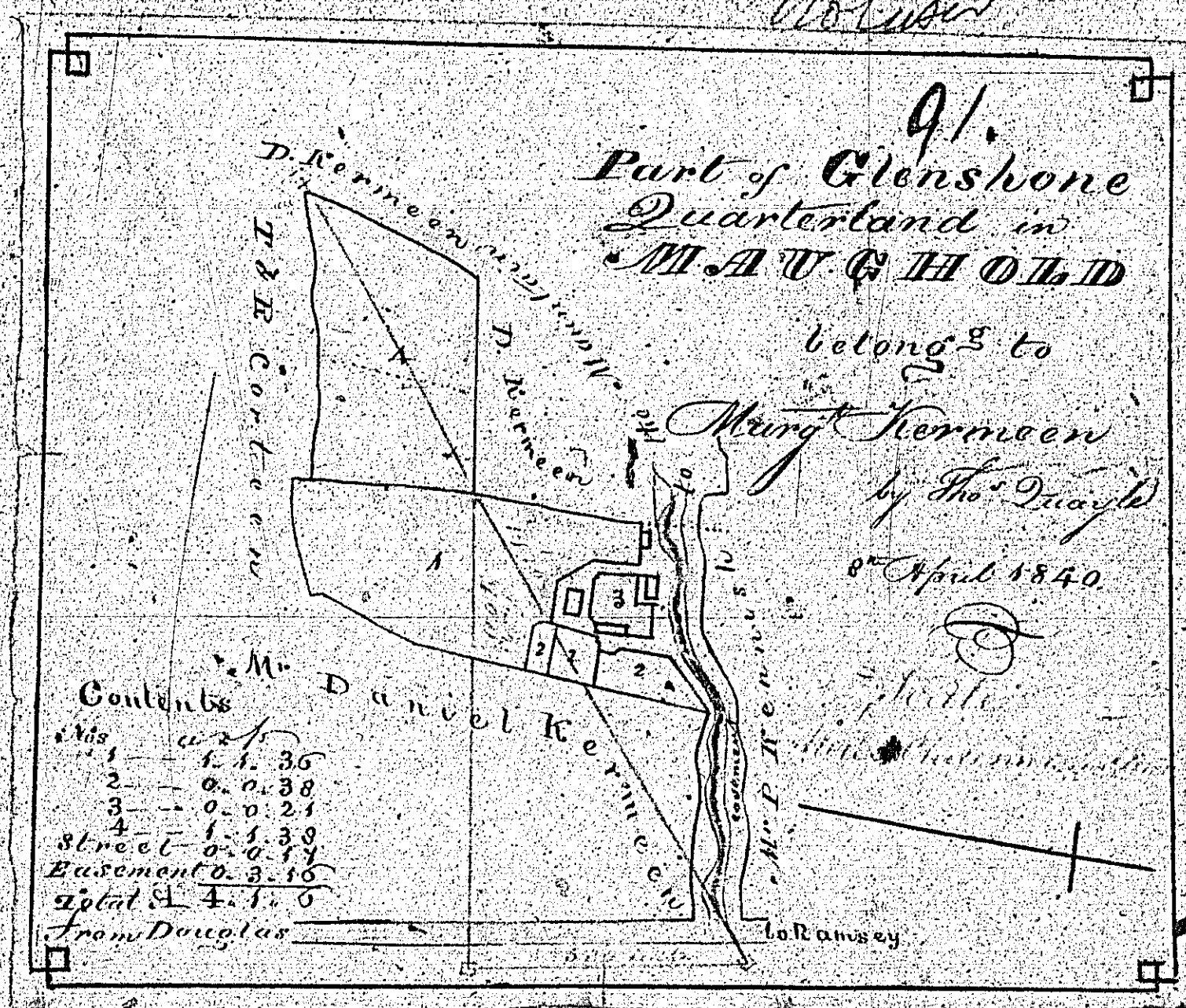

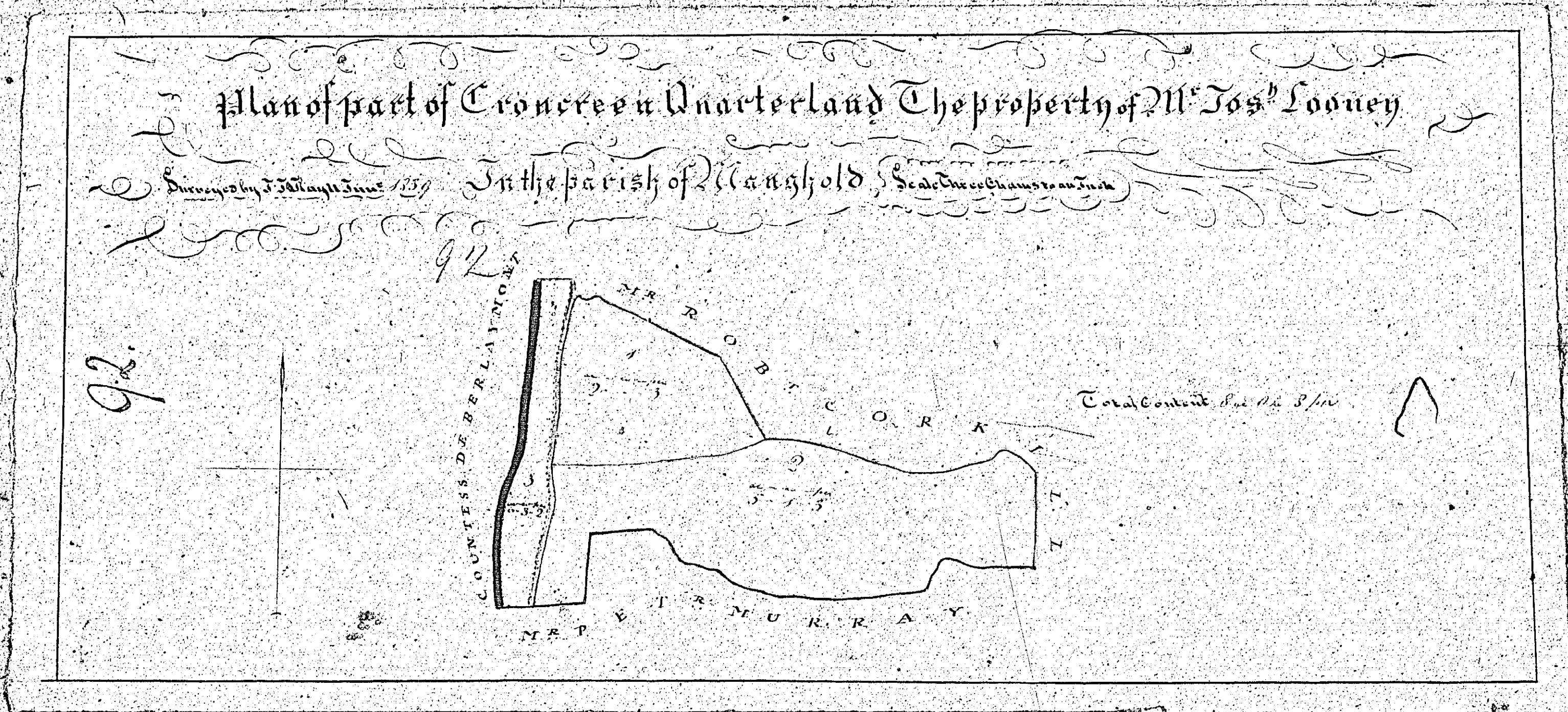

ISLE OF MAN GOVERNMENT: GENERAL REGISTRY

TITHE PLANS: PARISH OF MAUGHOLD

Original coloured

1:30

Plan of part of Mallacreggan Quarter  
 The Property of Sir John Coode Esq. Mangrove  
 Surveyed by J. J. Hall June 1850

93.

Contents

1	2	3	4
5	6	7	8
9	10	11	12
13	14	15	16
17	18	19	20
21	22	23	24
25	26	27	28
29	30	31	32
33	34	35	36
37	38	39	40
41	42	43	44
45	46	47	48
49	50	51	52
53	54	55	56
57	58	59	60
61	62	63	64
65	66	67	68
69	70	71	72
73	74	75	76
77	78	79	80
81	82	83	84
85	86	87	88
89	90	91	92
93	94	95	96
97	98	99	100

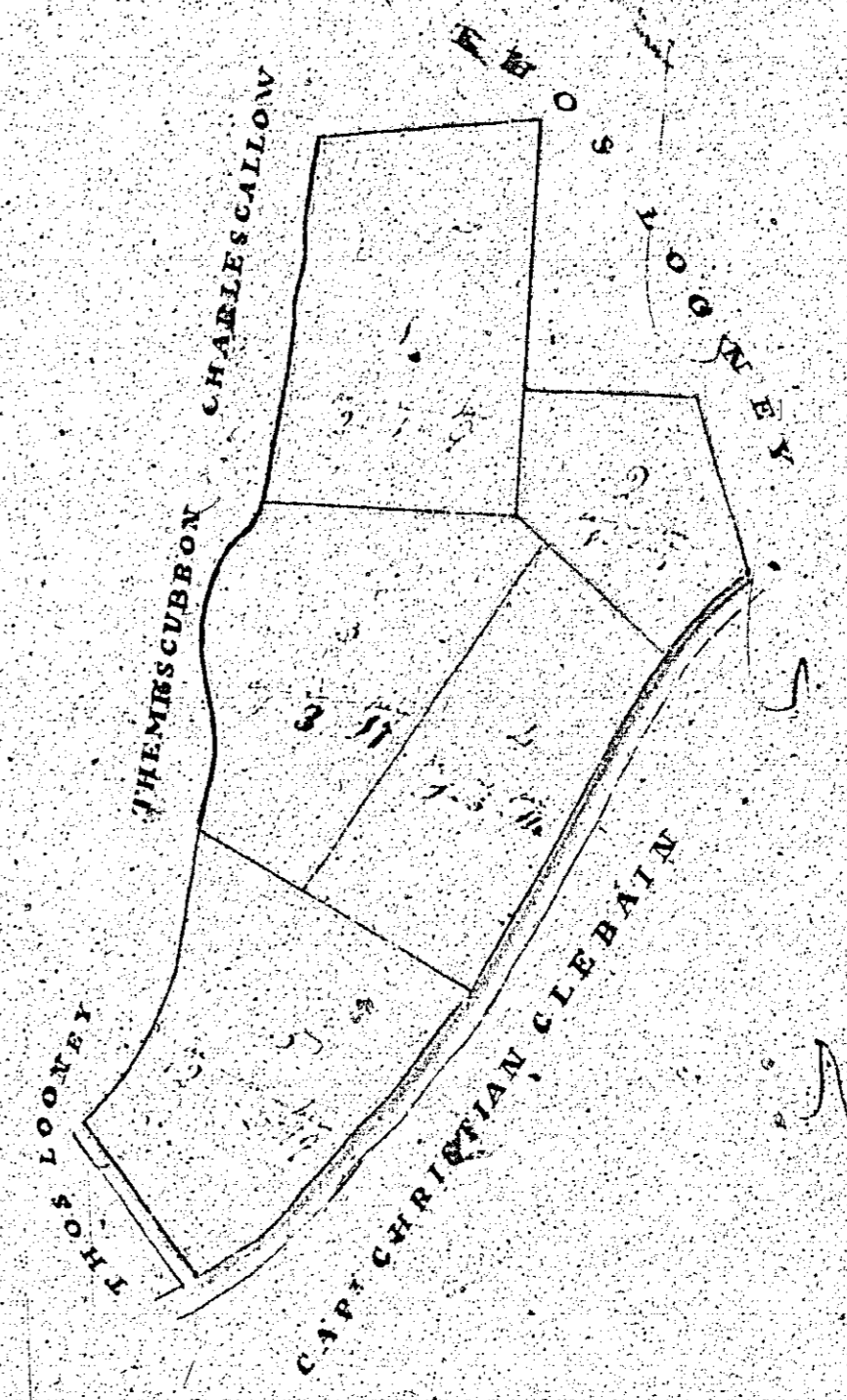

Scale Three Chains or Inch

A plan and survey of part of Ballycilly and  
Ballycraggan in the parish of the property of Wm. Lenny  
By Thomas Lenny July 15 1839

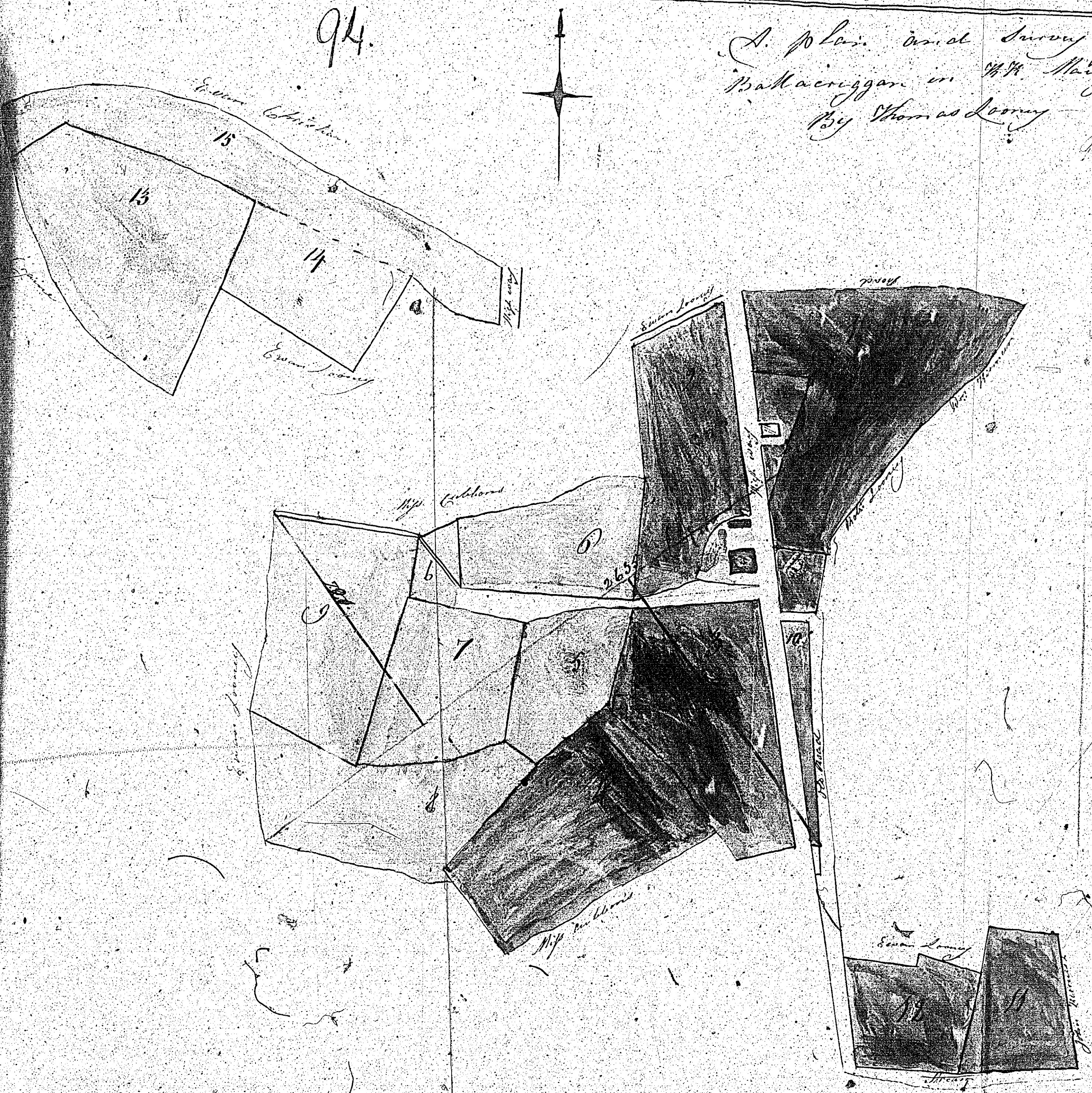

1	1	10
2	1	0
3	1	0
4	2	3
5	1	0
6	1	0
7	1	2
8	2	1
9	2	0
10	0	0
gn. O. m.	19	2
road yard	-	22
Roads	1	3
	21	8
11		20
12	1	3
Road	1	3
Road	2	0
	24	0
13	2	1
14	1	1
15	2	2
30.0.32	29	3
Road	2	1
	27	2

Plan of Separate parcels of Land the property of

95

M<sup>r</sup> Evan Looney in the parish of Maughold

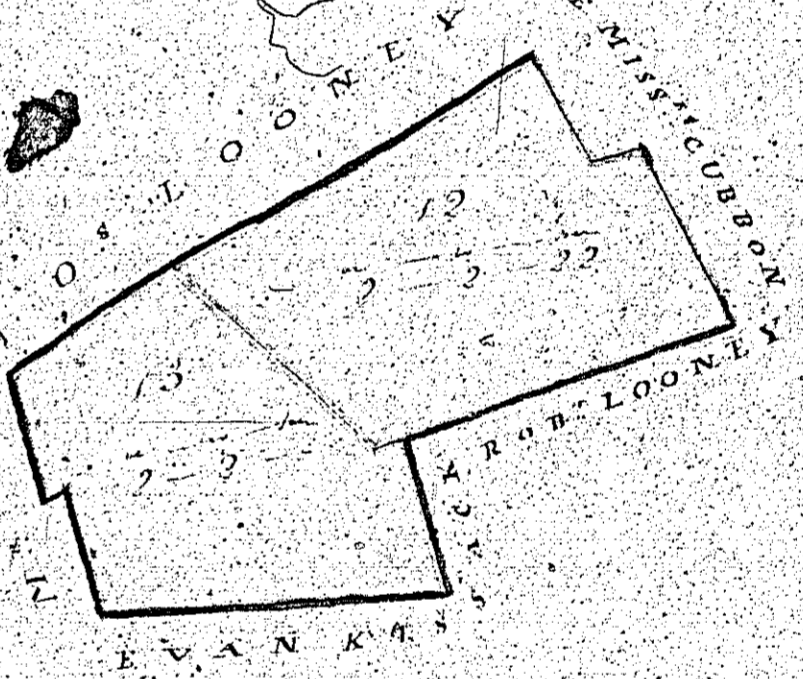
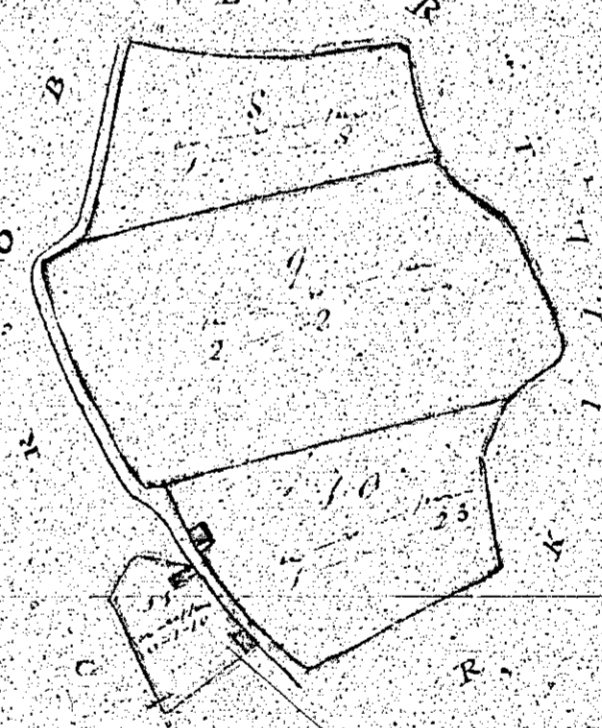
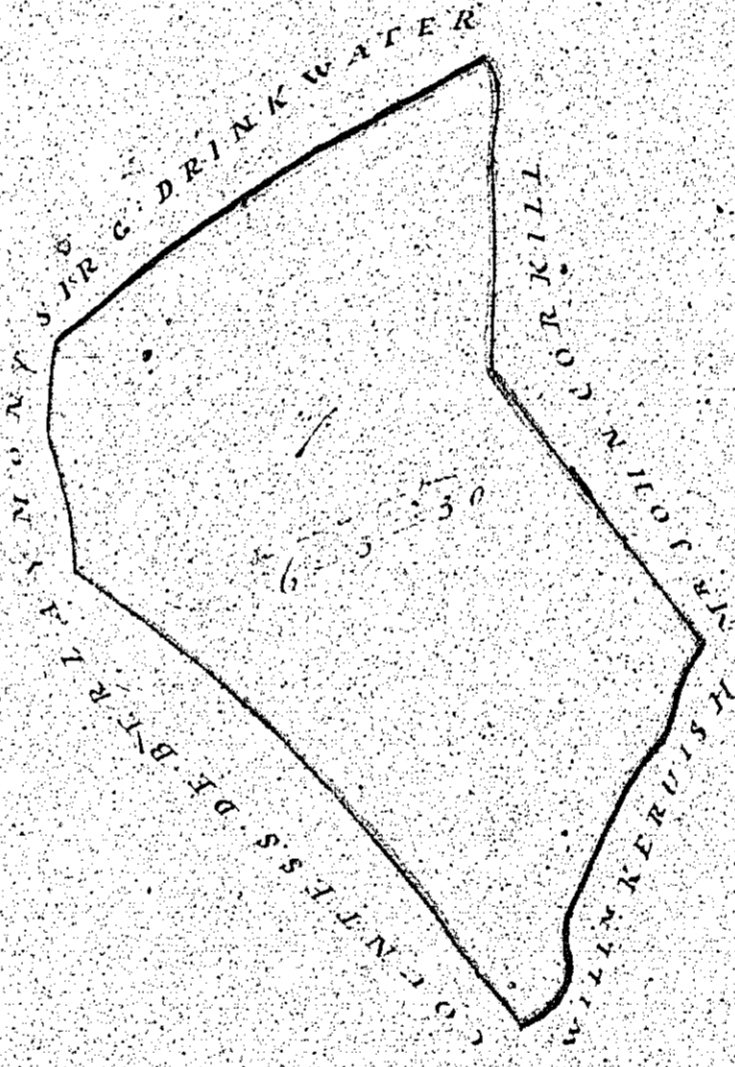
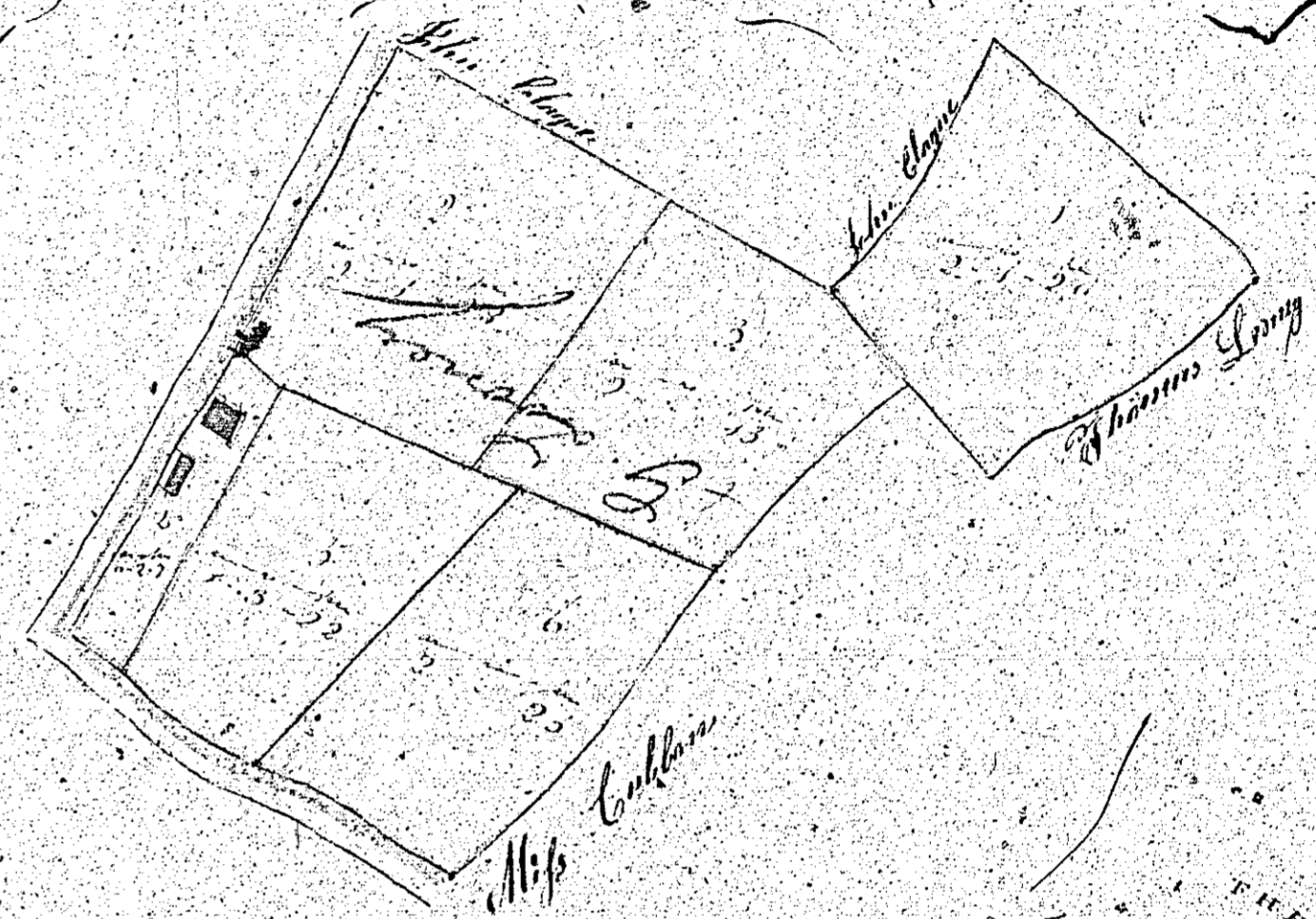

Total Contents

10.0.0	10.0.0	10.0.0	10.0.0
10.0.0	10.0.0	10.0.0	10.0.0
10.0.0	10.0.0	10.0.0	10.0.0
10.0.0	10.0.0	10.0.0	10.0.0
10.0.0	10.0.0	10.0.0	10.0.0
10.0.0	10.0.0	10.0.0	10.0.0
10.0.0	10.0.0	10.0.0	10.0.0
10.0.0	10.0.0	10.0.0	10.0.0
10.0.0	10.0.0	10.0.0	10.0.0
10.0.0	10.0.0	10.0.0	10.0.0

Scale three Chances to an Inch