

40

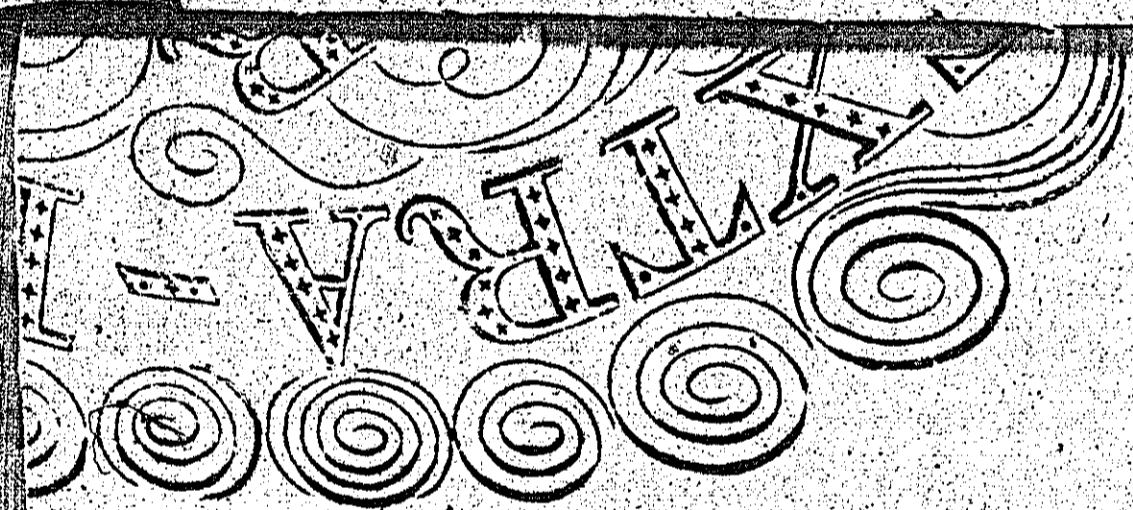

ISLE OF MAN GOVERNMENT: GENERAL REGISTRY
 TITHE PLANS: PARISH OF MAUGHOLD
 Original coloured 1:30

Plan
BALLASKEIG MOAR
 (SITUATE IN THE PARISH
 OF **MAVONCHOLA**)
 THE
 PROPERTY
 OF **G. W. Dumbell Esq.**

Scheme to the Plan

1	2	3	4	5	6	7	8	9	10	11	12	13	14	15	16	17	18	19	20	21	22	23	24	25	26	27	28	29	30	31	32	33	34	35	36	37	38	39	40	41	42	43	44	45	46	47	48	49	50	51	52	53	54	55	56	57	58	59	60	61	62	63	64	65	66	67	68	69	70	71	72	73	74	75	76	77	78	79	80	81	82	83	84	85	86	87	88	89	90	91	92	93	94	95	96	97	98	99	100
---	---	---	---	---	---	---	---	---	----	----	----	----	----	----	----	----	----	----	----	----	----	----	----	----	----	----	----	----	----	----	----	----	----	----	----	----	----	----	----	----	----	----	----	----	----	----	----	----	----	----	----	----	----	----	----	----	----	----	----	----	----	----	----	----	----	----	----	----	----	----	----	----	----	----	----	----	----	----	----	----	----	----	----	----	----	----	----	----	----	----	----	----	----	----	----	----	----	----	-----

Total 90. 1. 6

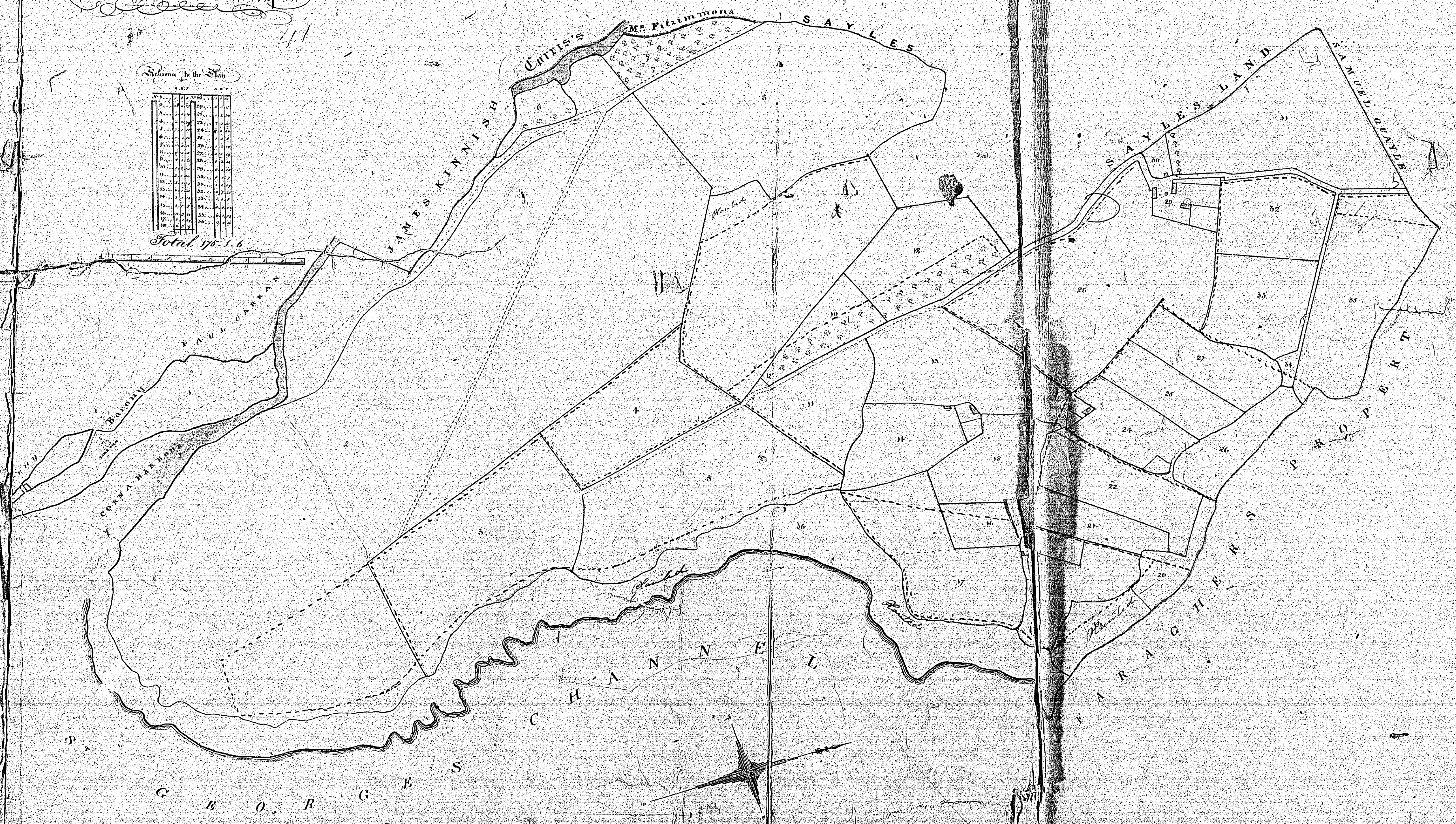

Plan
 of
MAGHER-E-KEW
 in the Parish of
MAUGHOLD
 the Property of
 Sir George Drinkwater Kent.

Scale $1\frac{1}{2}$ Chains to One Inch

Contents
 Fields above H. Road 39. 0. 13
 Do. below H. Road 52. 1. 6
 Grass & Gardens &c 2. 3. 8
Total 96. 2. 12 1/2

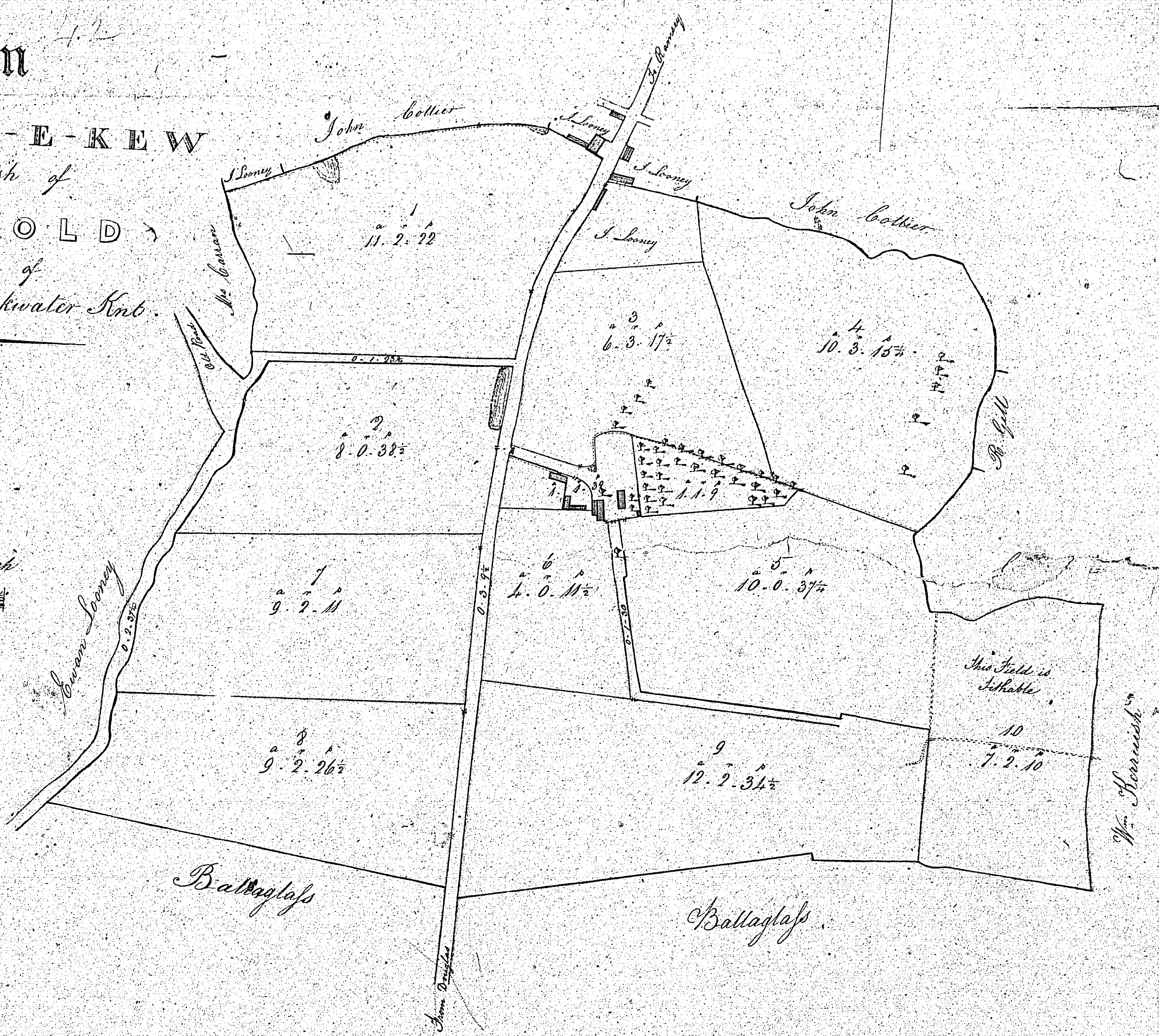

ISLE OF MAN GOVERNMENT: GENERAL REGISTRY
 TITHE PLANS: PARISH OF MAUGHOLD
 Original coloured

1:30

F
 G
 H
 I
 J
 K
 L
 M
 N
 O
 P
 Q
 R
 S
 T
 U
 V
 W
 X
 Y
 Z

Krosby
the property of
Edmund Faragher
Maughold 43
By *James Faragher*
Shirburnlee July 22. 1784

No	A	R	D
1	1	0	27
2	0	3	26
3	1	2	15
4	1	1	1
5	6	1	14
6	2	3	6
7	1	3	36
8	3	1	39
9	4	2	39
10	3	1	9
11	1	1	15
12	1	3	22
13	0	1	19
14	1	3	27
15	1	1	13
16	0	1	14
17	2	3	15
18	0	3	5
19	1	2	14
20	5	1	2
21	26	1	5
<i>Garden</i>	<i>8</i>	<i>6</i>	<i>14</i>
	<i>88</i>	<i>9</i>	<i>216</i>
<i>Head and buildings</i>	<i>9</i>	<i>1</i>	<i>24</i>
<i>Two gill plantations</i>	<i>0</i>	<i>3</i>	<i>0</i>
<i>Two wood and meadows</i>	<i>0</i>	<i>3</i>	<i>0</i>
<i>Total</i>	<i>64</i>	<i>23</i>	<i>24</i>
	<i>70</i>	<i>2</i>	<i>3</i>

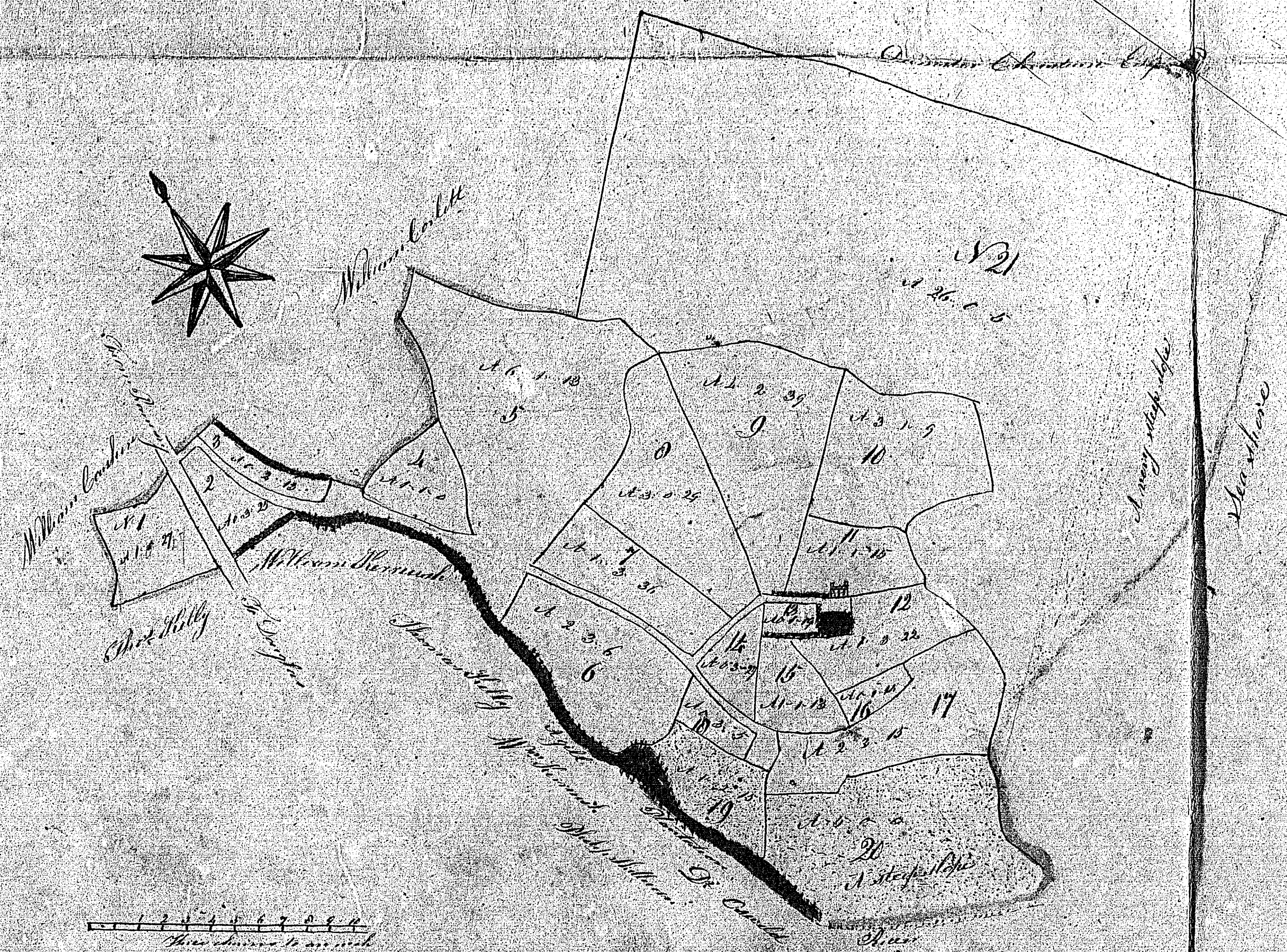

43

ISLE OF MAN GOVERNMENT: GENERAL REGISTRY
TITHE PLANS: PARISH OF MAUGHOLD
Original coloured 1:30

PARK MOOR

Maughold, 44

The Property of Jas. Fred. Esq.

July 1839.

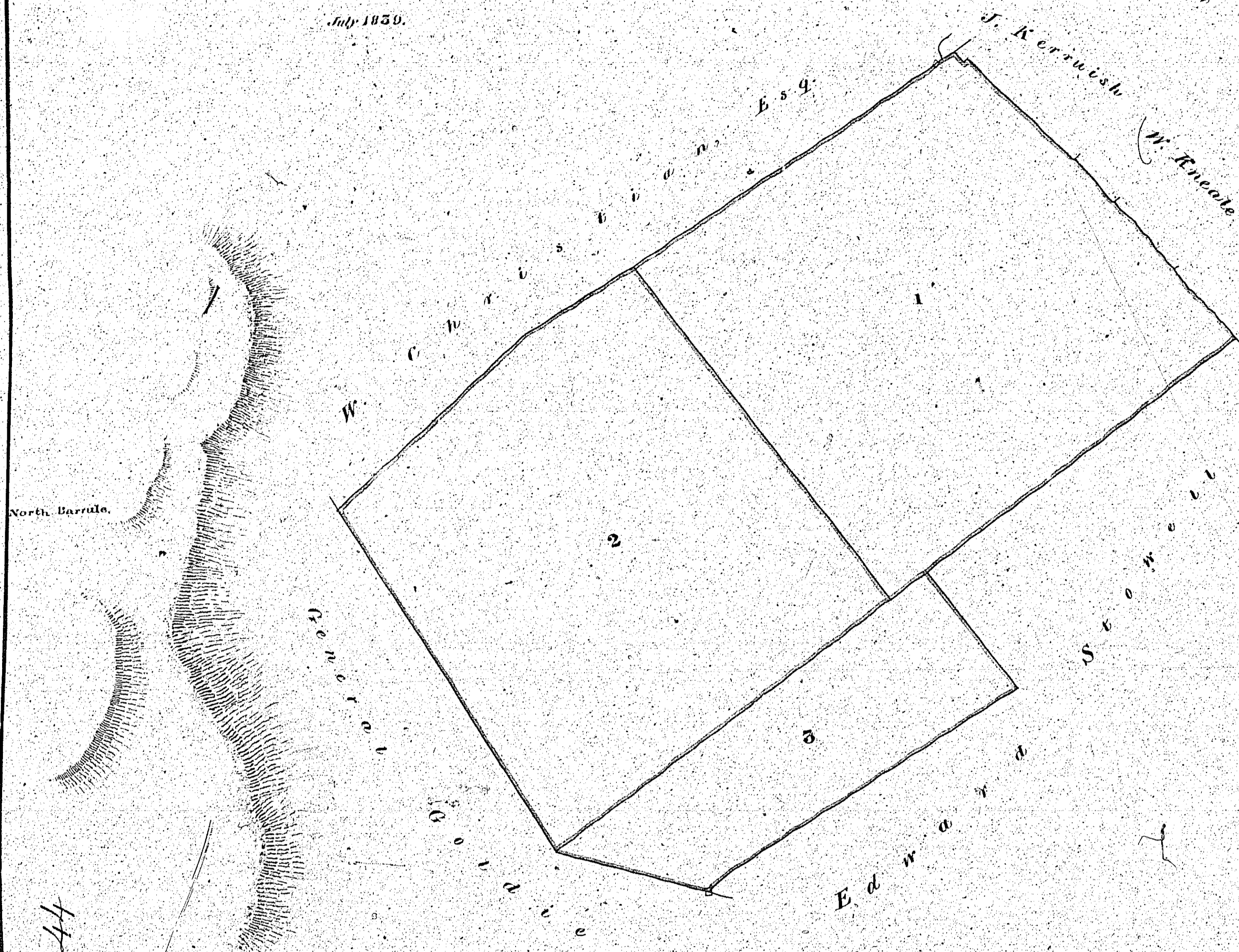

Contents.

No. 1	24. 2. 7
2	21. 1. 16
3	7. 0. 10
Total	40. 3. 33

Surveyed by Alexander & J. G. Gerson.

ISLE OF MAN GOVERNMENT: GENERAL REGISTRY

TITHE PLANS: PARISH OF MAUGHOLD

Original coloured (decorative)

1:30

Not used

45

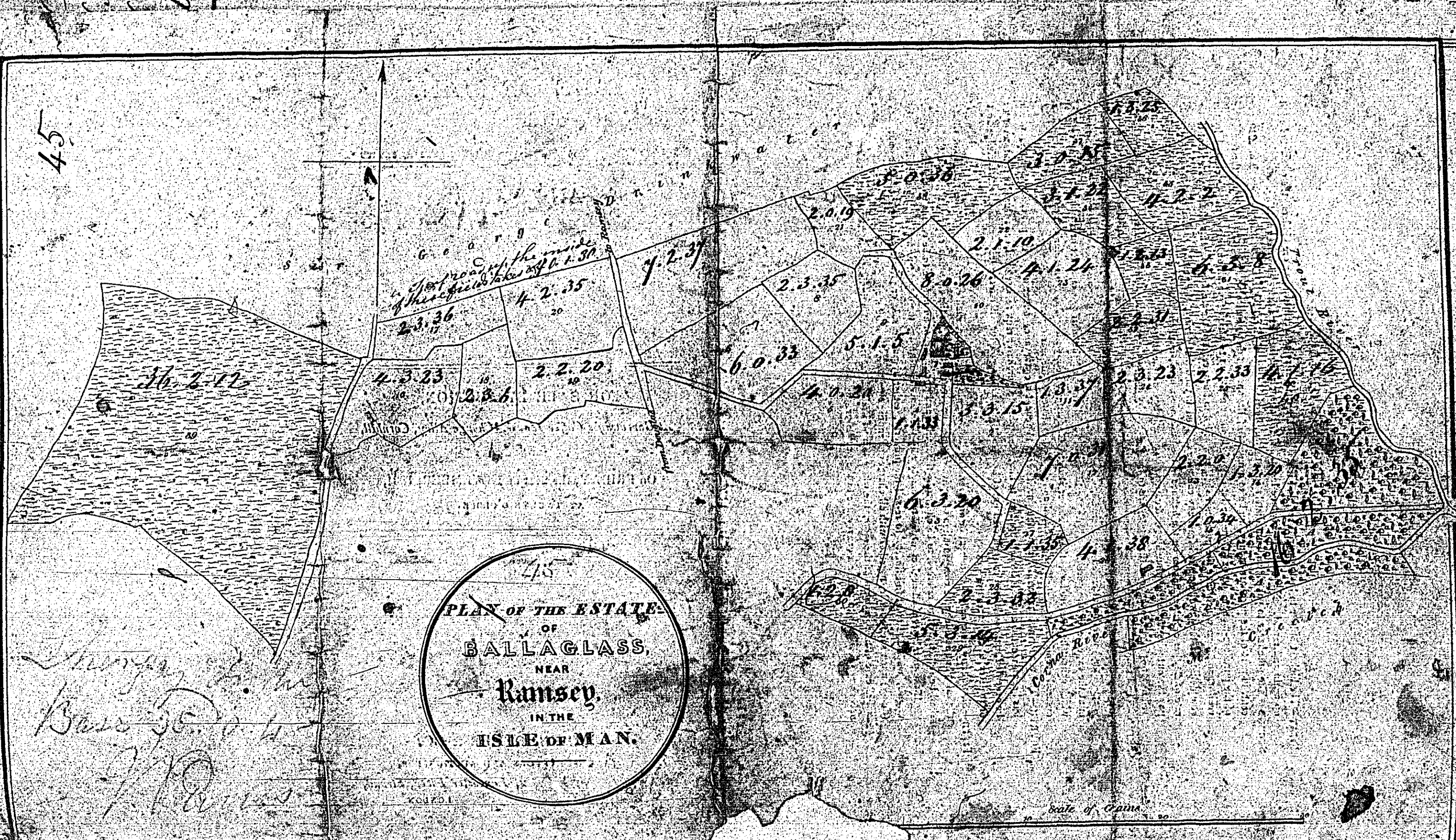

REFERENCE	A	R	P
1	1	3	7
2	3	3	15
3	6	3	20
4	1	0	33
5	4	0	20
6	6	1	33
7	2	3	37
8	2	3	35
9	5	1	5
10	1	3	26
11	1	0	37
12	2	0	31
13	4	3	20
14	1	3	34
15	3	3	33
16	1	3	36
17	2	3	36
18	2	3	36
19	2	2	20
20	2	2	35
21	2	1	19
22	2	1	11
23	2	1	24
24	2	3	23
25	2	2	33
26	1	1	38
27	1	3	39
28	3	3	14
29	3	2	8
30	2	3	8
31	6	3	31
32	3	3	15
33	3	1	22
34	4	2	22
35	1	3	18
36	1	3	18
37	3	0	36
38	3	0	36
39	3	2	19
40	2	2	32
41	2	2	22

ISLE OF MAN GOVERNMENT: GENERAL REGISTRY

TITHE PLANS: PARISH OF MAUGHOLD

Original monotone, marked

1:30