

28  
 Plan  
 of a Part of the  
**CORRANEE**  
 in the parish of Naugholte  
 the Property of  
 Mr. Wm. Callow

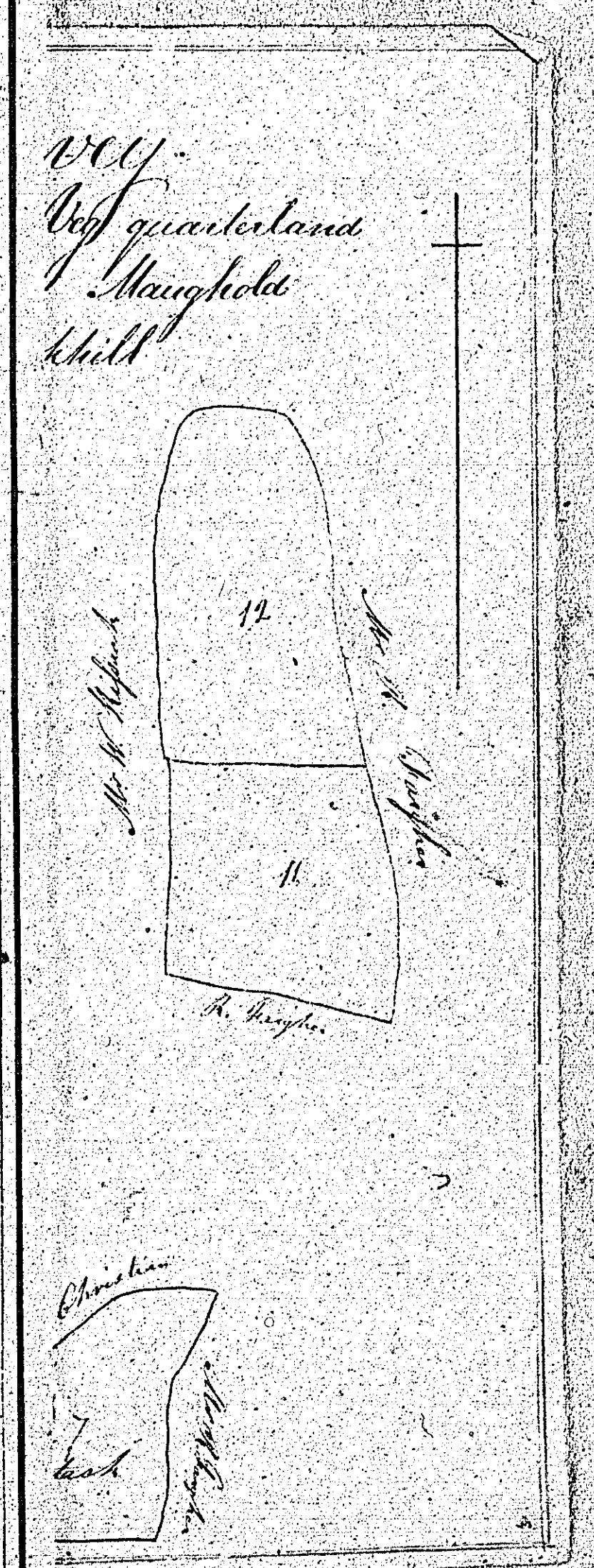
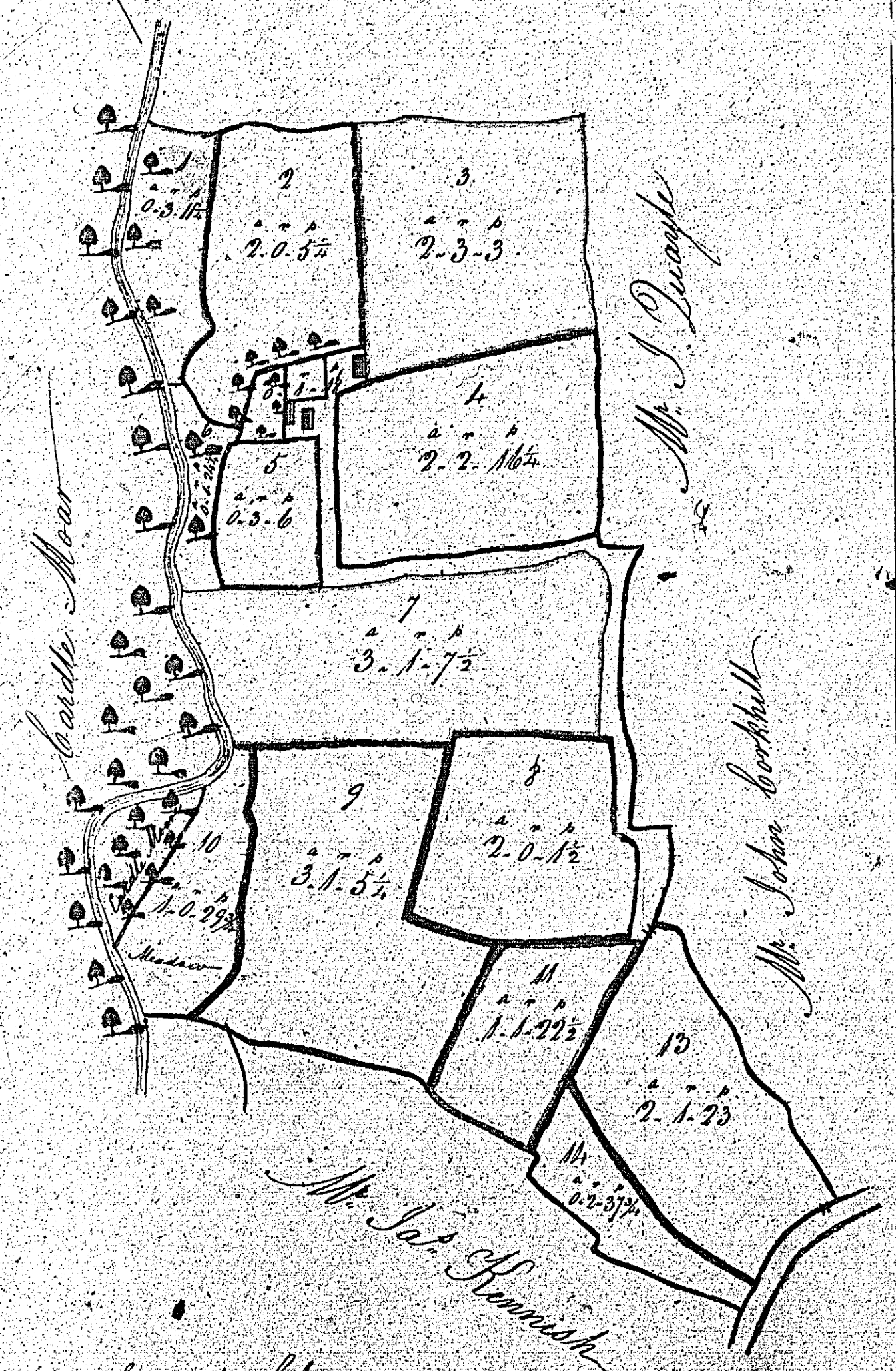

Scale of 3 Chains  
 to One Inch

Contents

Fields	= 24. 0. 33 1/2
Roads & Paddocks	= 0. 3. 39 1/2
Total	= 25. 0. 33

J. Cowell  
 Surveyor 1839



W. W. Wood

29

# A Plan and Survey of land in Ballagorey Bog quarterland of Maughold

belonging to Mr. Thomas Corbett

by John Brown

Aug 5 1839

1	2
2	3
3	4
4	5
5	6
6	7
7	8
8	9
9	10
10	11
11	12
12	13
13	14
14	15
15	16
16	17
17	18
18	19
19	20
20	21
21	22
22	23
23	24
24	25
25	26
26	27
27	28
28	29
29	30
30	31
31	32
32	33
33	34
34	35
35	36
36	37
37	38
38	39
39	40
40	41
41	42
42	43
43	44
44	45
45	46
46	47
47	48
48	49
49	50
50	51
51	52
52	53
53	54
54	55
55	56
56	57
57	58
58	59
59	60
60	61
61	62
62	63
63	64
64	65
65	66
66	67
67	68
68	69
69	70
70	71
71	72
72	73
73	74
74	75
75	76
76	77
77	78
78	79
79	80
80	81
81	82
82	83
83	84
84	85
85	86
86	87
87	88
88	89
89	90
90	91
91	92
92	93
93	94
94	95
95	96
96	97
97	98
98	99
99	100

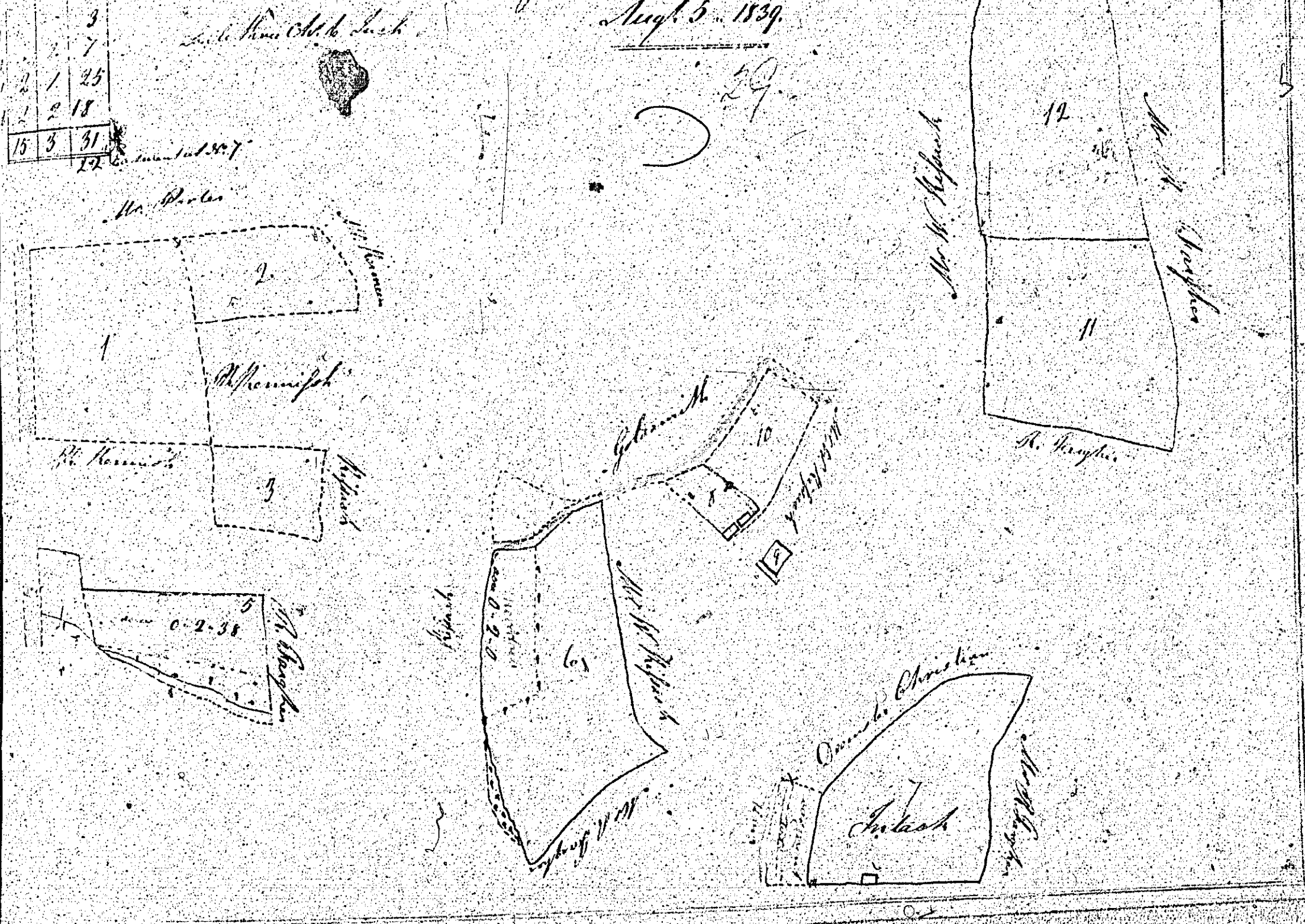



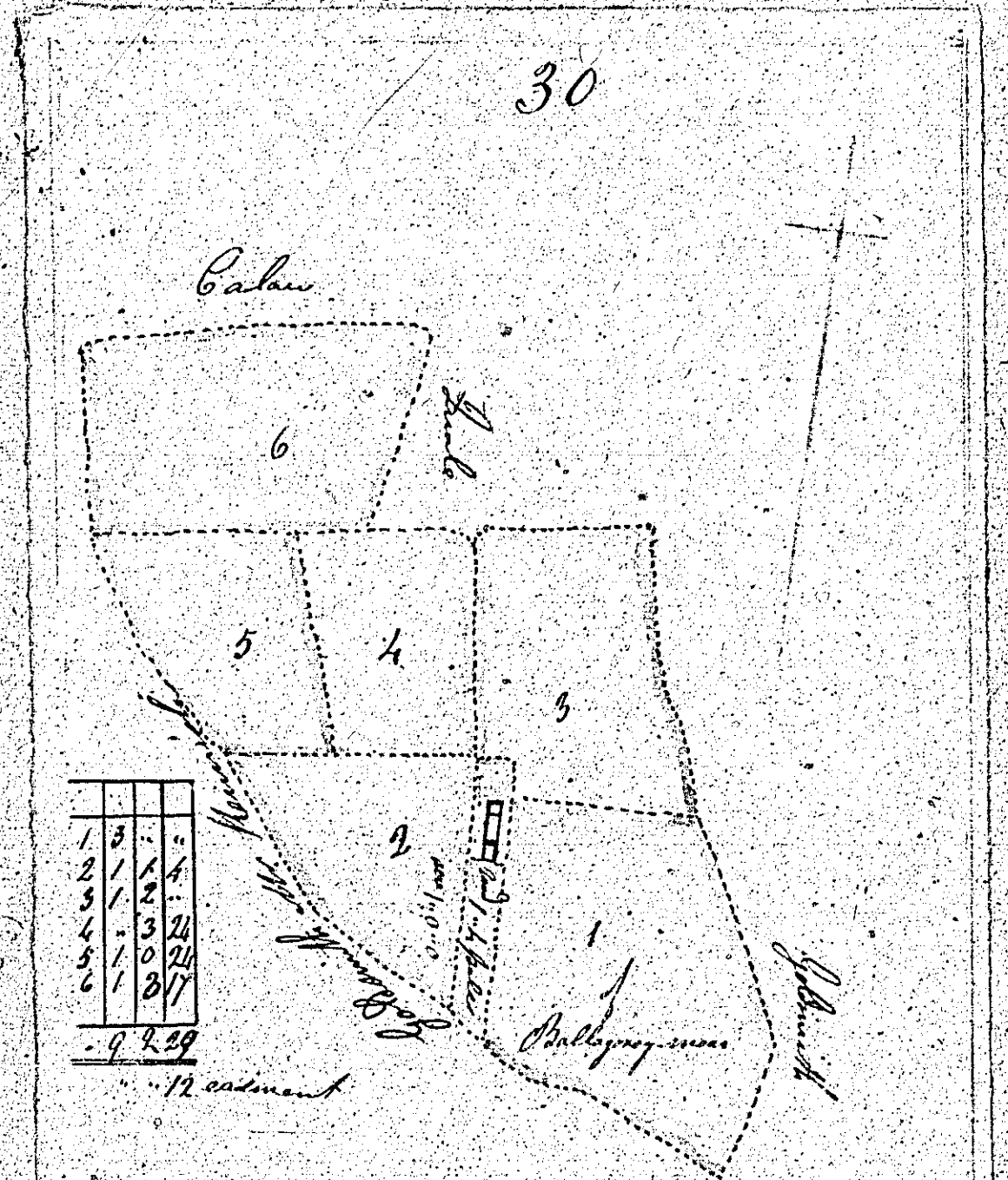

31

*A Plan and Survey  
of the Estate of John Cookhill  
including his mother's widowright  
in the Bullgrove Quarterlands  
Naughold  
by John Power  
London July 8<sup>th</sup> 1839*



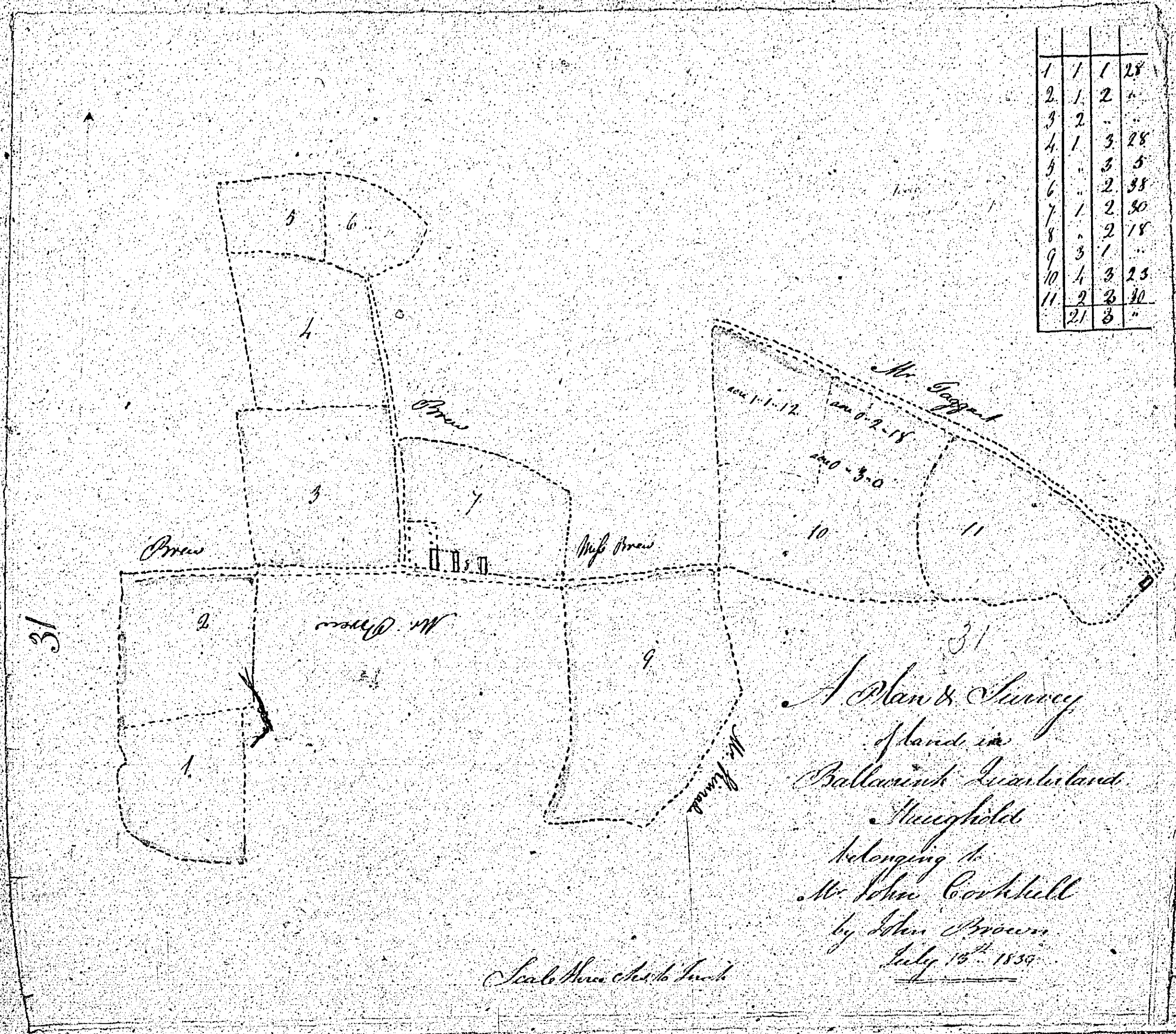

1	1	28
2	1	2
3	2	..
4	1	3
5	..	3
6	..	2
7	1	2
8	..	2
9	3	1
10	4	3
11	2	3
21	3	..

ISLE OF MAN GOVERNMENT: GENERAL REGISTRY  
 TITHE PLANS: PARISH OF MAUGHOLD  
 Original coloured (decorative) 1:30





THALLOO QUÉN

in Maughold

The Property of JOHN CORLETT.



No.	Contents	Acres	Roods	Poles
1	18	0	0	2
2	18	0	0	2
3	2	36	0	0
4	3	13	0	0
5	3	13	0	0
6	3	13	0	0
7	2	5	0	21
8	2	5	0	21
9	2	5	0	21
10	2	5	0	21
11	2	5	0	21
12	2	5	0	21
13	2	5	0	21
14	2	5	0	21
15	2	5	0	21
16	2	5	0	21
17	2	5	0	21
18	2	5	0	21
19	2	5	0	21
20	2	5	0	21
21	2	5	0	21
22	2	5	0	21
23	2	5	0	21
24	2	5	0	21
25	2	5	0	21
26	2	5	0	21
27	2	5	0	21
28	2	5	0	21
29	2	5	0	21
30	2	5	0	21
31	2	5	0	21
32	2	5	0	21
33	2	5	0	21
Total		39	1	13
		65	0	30
		39	1	13
		104	2	0

Population of Public House 0, 5, 35  
Ditto 0, 1, 9

\* The Road and River in Nos. 1 not included in the quantity given.

Surveyed by Messrs. Messers. & Co. of Glasgow.

ISLE OF MAN GOVERNMENT: GENERAL REGISTRY  
TITHE PLANS: PARISH OF MAUGHOLD  
Original coloured

1:30



*Ballasloe*  
 Maughold.  
 Belonging to Rob<sup>t</sup> Corkill  
 July 1839.

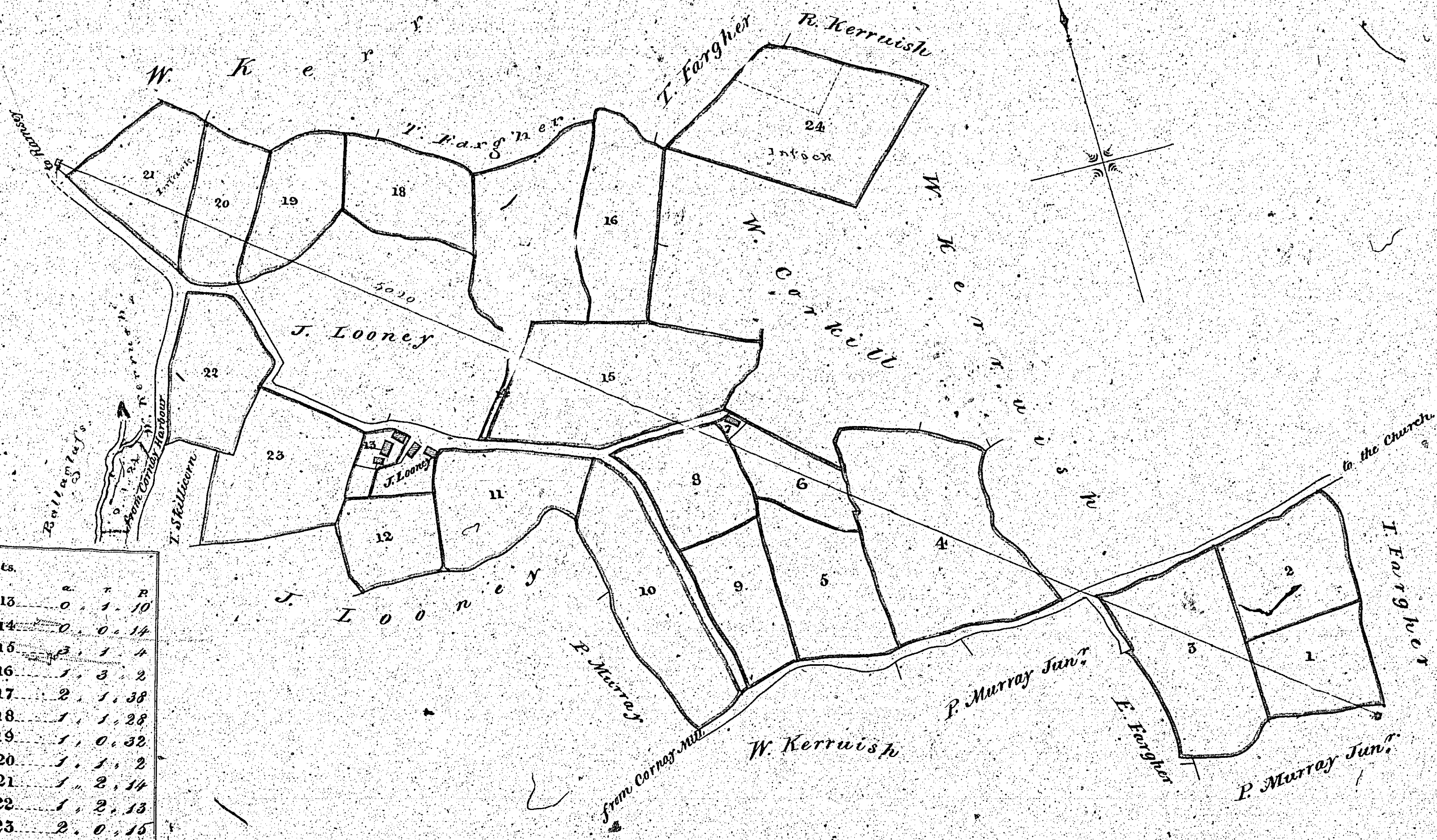

33

Contents.	
No. 1	2
1	13
2	14
3	15
4	16
5	17
6	18
7	19
8	20
9	21
10	22
11	23
12	24
19	20
Total	

0 1 2 3 4 5 6 7 8 9 10 Chains  
 Merryweather & Jefferys Surveyors.

Proportion of Public Roads 1.0.59

colored yellow joint holders  
 R. Corhill and W. Kerruish.

ISLE OF MAN GOVERNMENT: GENERAL REGISTRY  
 TITHE PLANS: PARISH OF MAUGHOLD  
 Original coloured 1:30