

Plan  
 of part of the Estate  
 of *Boothyrommy*  
 IN TACK LAND  
 in the Parish of *Malaw*  
 the property of  
 M<sup>rs</sup> ANNE SKELLY

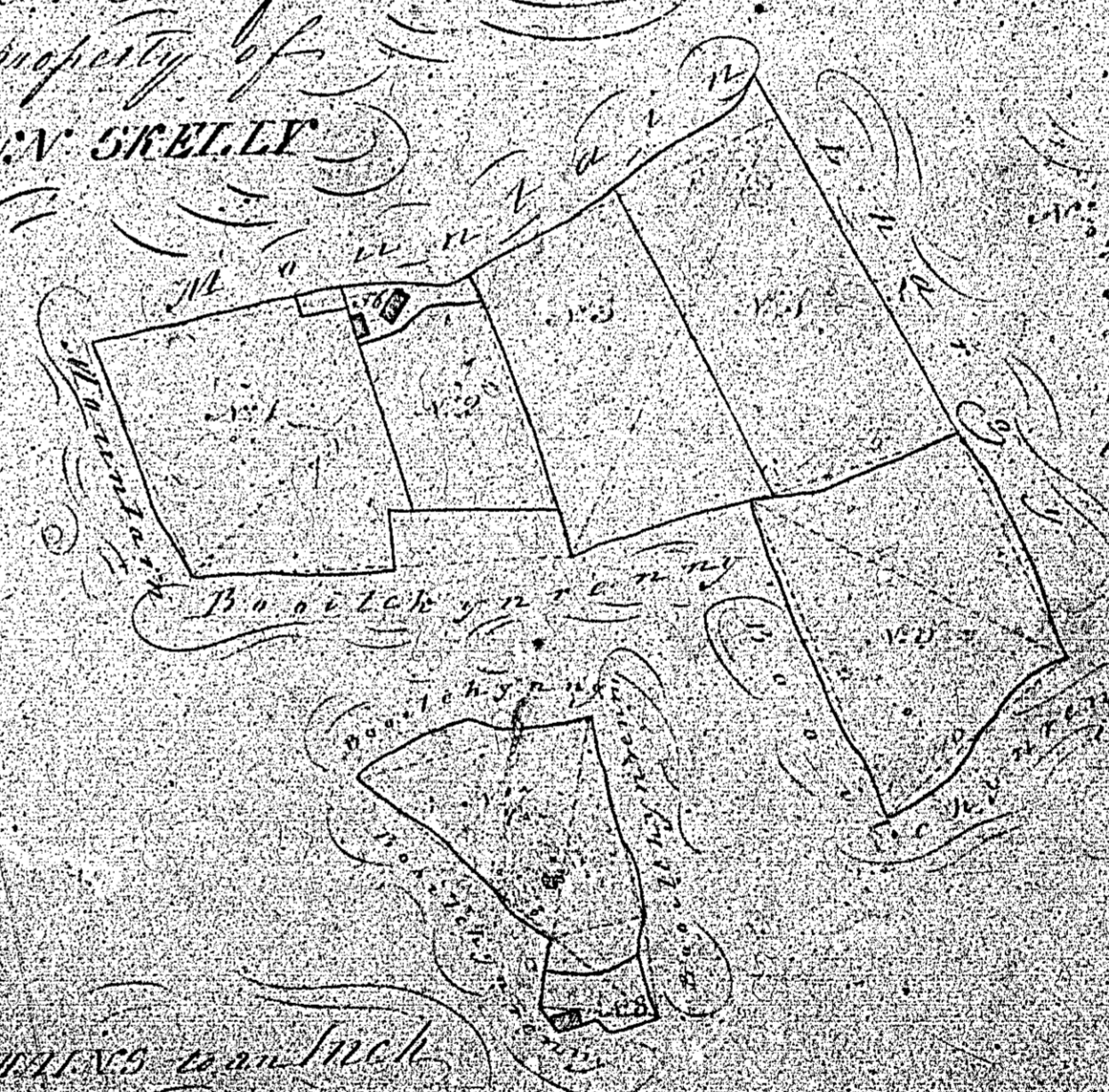

Contents

1	1. 5. 00
2	0. 5. 00
3	1. 2. 50
4	1. 10. 00
5	2. 0. 00
6	0. 0. 20
7	1. 1. 00
8	0. 0. 00
Total	50. 0. 50

Scale 3 chains to an Inch

The Clerk Surveyor

Plan  
 of the  
**GILLEN**  
 or of the ESTATE of  
 Cordaman  
 in the  
 Parish of Malen  
 The Property  
 of  
**M<sup>r</sup> W<sup>m</sup> TIGGART**

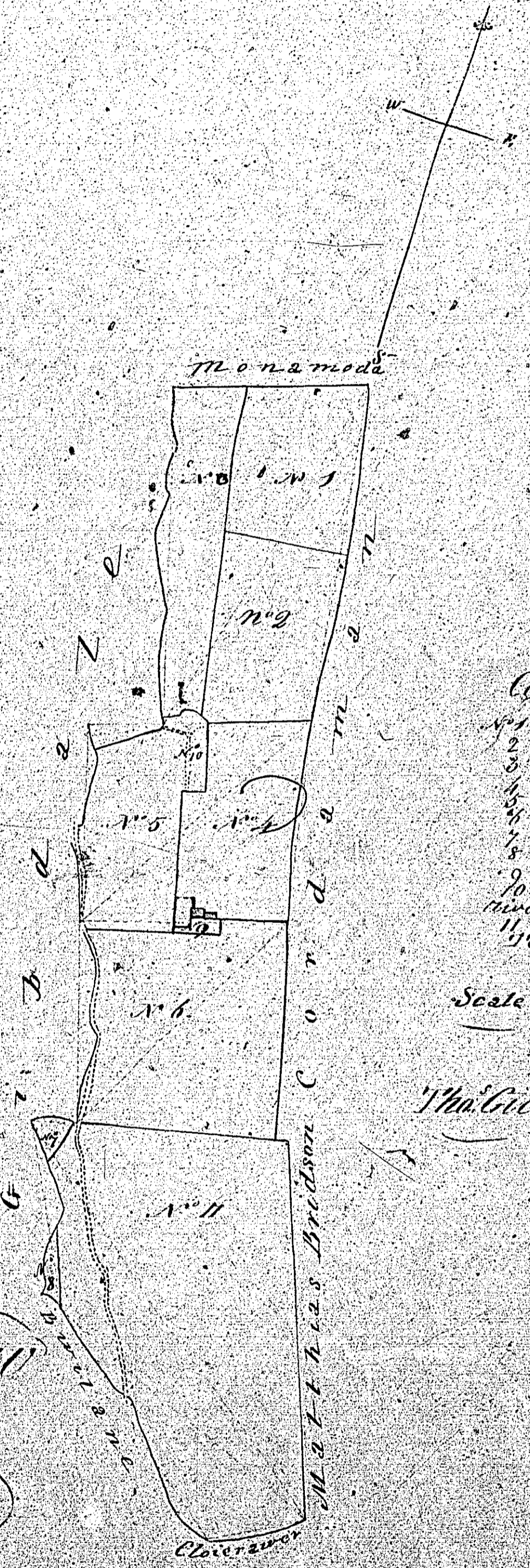

*Contents*

1	1. 2. 3.
2	1. 2. 3.
3	1. 2. 3.
4	1. 2. 3.
5	1. 2. 3.
6	1. 2. 3.
7	1. 2. 3.
8	1. 2. 3.
9	1. 2. 3.
10	1. 2. 3.
11	1. 2. 3.
Total	1. 2. 3.

Scale - 3 Chains to an  
 Inch  
 The Clerk Surveyor 1810

109

The two following plans are  
numbered 110

*Plan*  
*GILL*  
*OF THE*  
*CO*  
*PARIS*  
*NEW*

110

*A*  
**PLAN and Survey of Part of BALOWN**  
in the Parish of MALEW belonging to  
**Mr THO<sup>s</sup> TEAR**  
*April 29<sup>th</sup> 1840.*

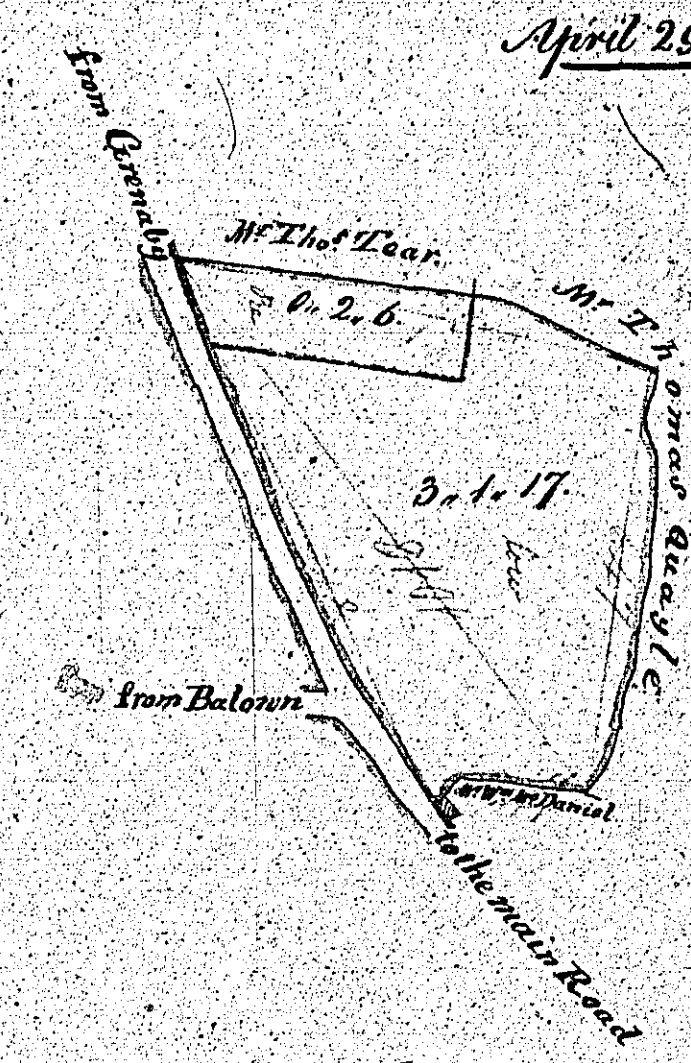
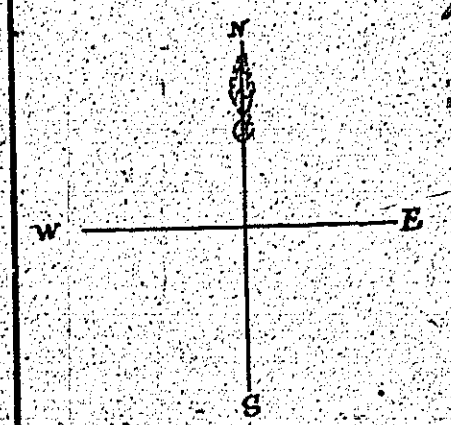

By **Wm Cowley**  
*Schoolmaster*  
**Ballasalla**

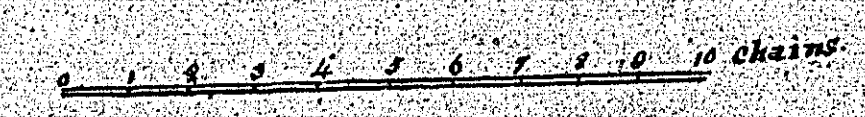

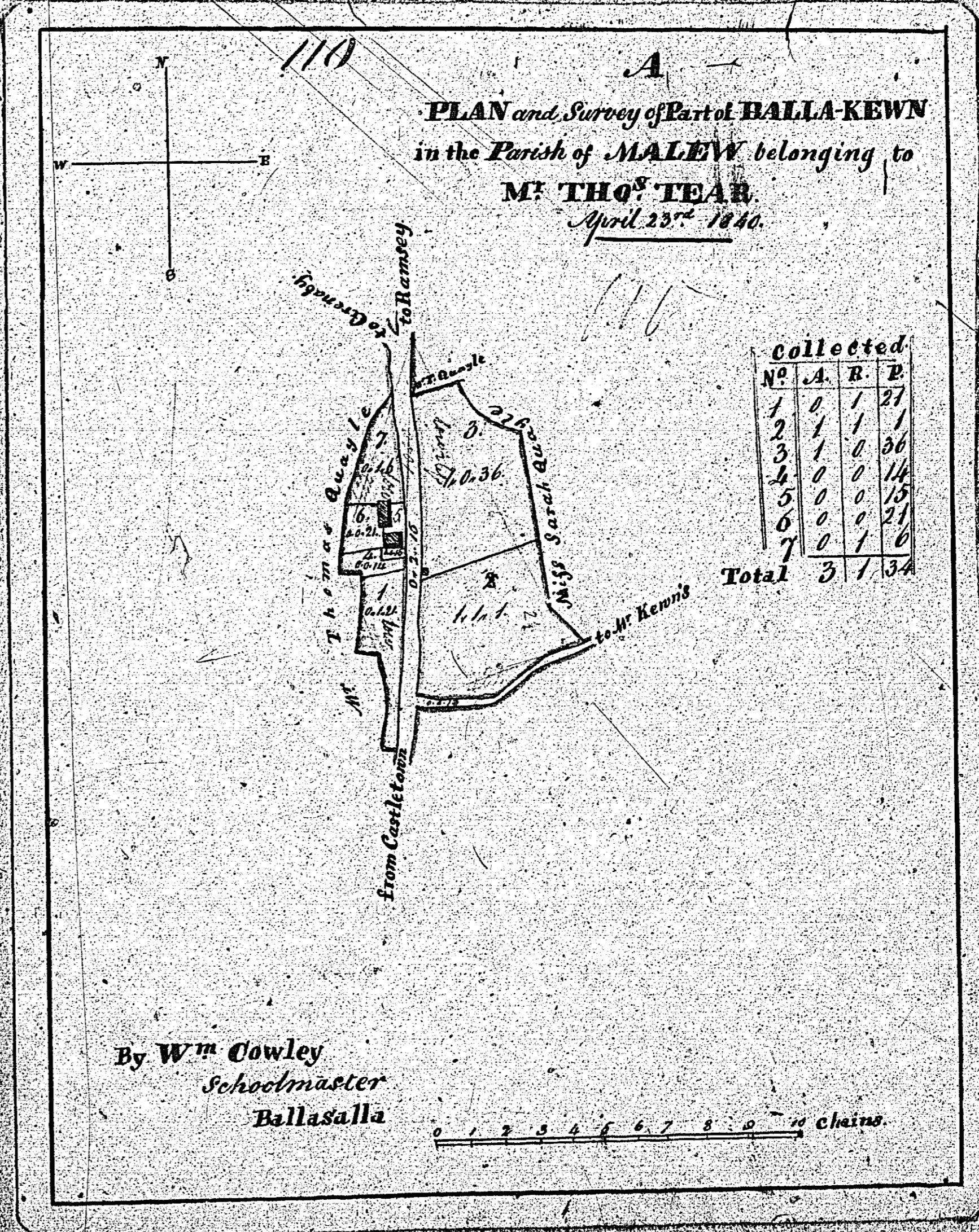

Plan III  
of the Estate  
Balla-Gilbert  
Parish of Malew  
Mr. Willm. Suggart  
Proprietor  
Drogheda

Paying tithes to the Parish of Arbray

Contents

1.	1.	0.	9
2.	1.	2.	22
3.	1.	2.	27
4.	1.	2.	5
5.	1.	0.	0
6.	1.	3.	9
7.	1.	2.	16
8.	1.	2.	17
9.	2.	0.	10
10.	1.	2.	24
11.	3.	3.	30
12.	3.	3.	20
13.	2.	1.	3
14.	2.	3.	3
15.	1.	2.	30
16.	4.	1.	5
17.	13.	2.	10
18.	2.	0.	10
19.	0.	1.	33
20.	0.	2.	16
21.	0.	3.	25
22.	0.	0.	27
23.	0.	2.	37
24.	0.	1.	35
25.	0.	3.	25
Total			69. 0. 34

10. 1. 30 stable land

18. 2. 0  
Waste ground A. B.  
road B. C.  
road D. E.  
road F. G.  
Stables and gardens  
house and outbuildings  
misc. etc.

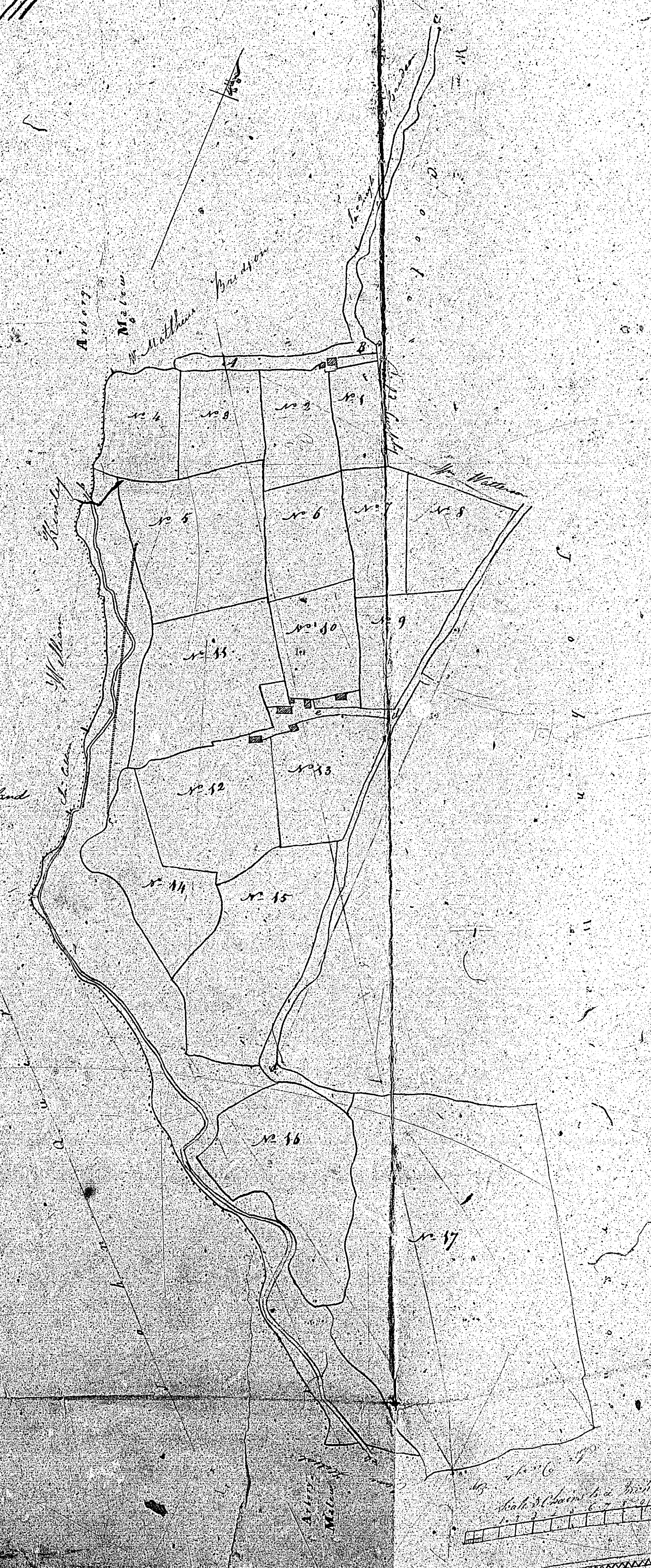

Surveyed April 1840  
John Bullen Surveyor

