

How Mr. Radcliffe

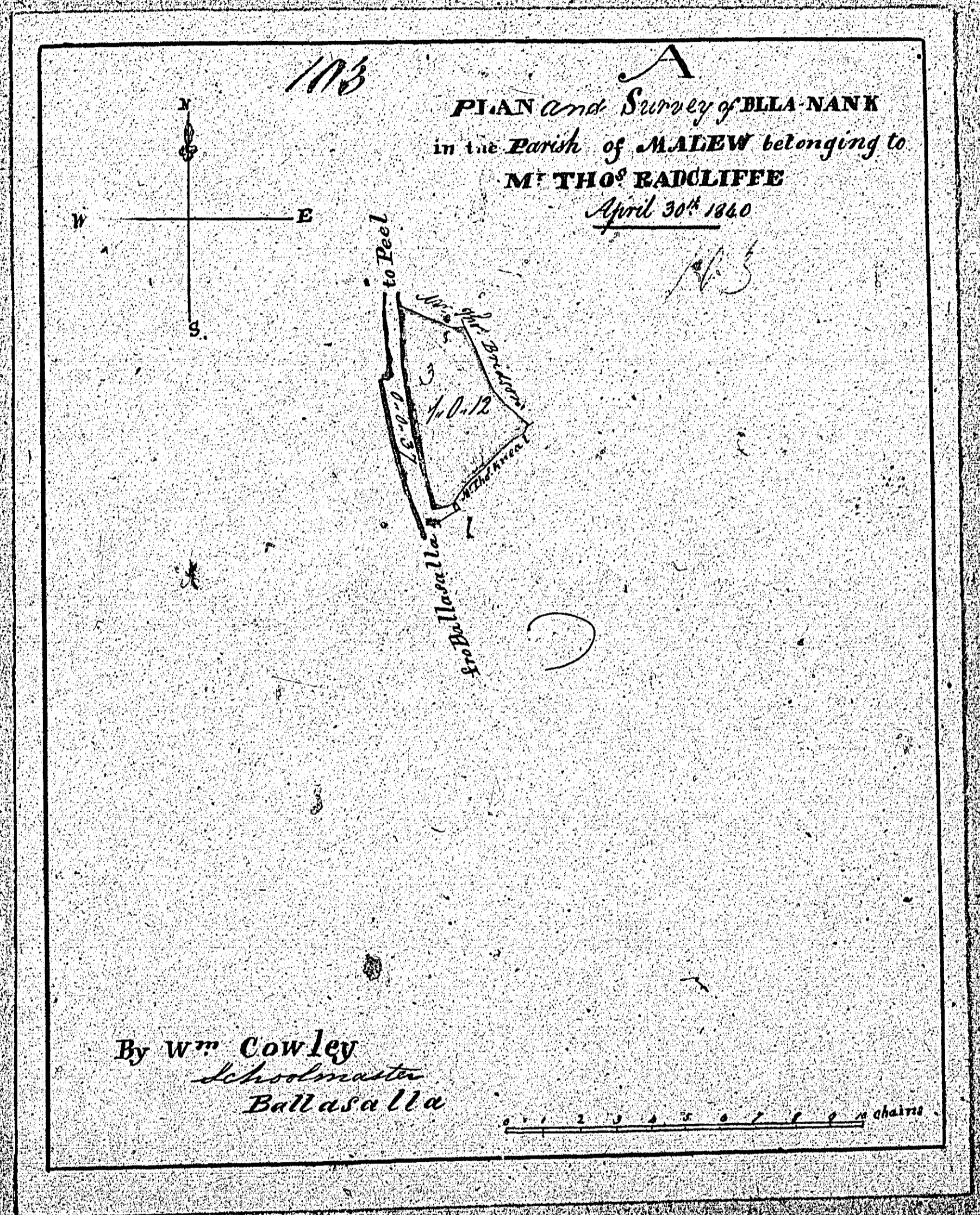

Robert Shimm

104

— A —

PLAN and Survey of Part of BALLA JOHN VARK
 in the Parish of MALEW belonging to
MR ROBERT SHIMMIN
 April 18th 1840.

104

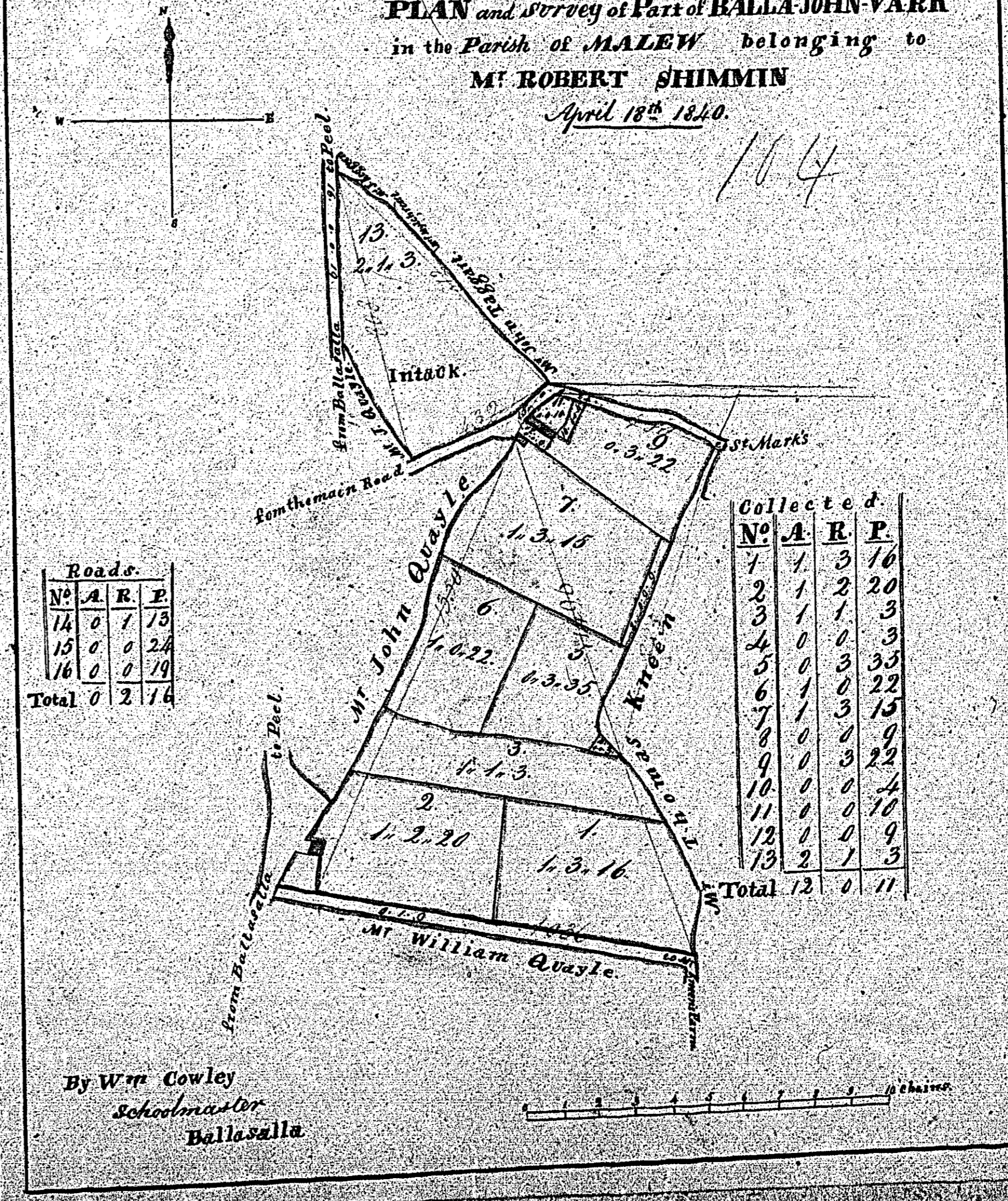

By W^m Cowley
 Schoolmaster
 Ballasalla

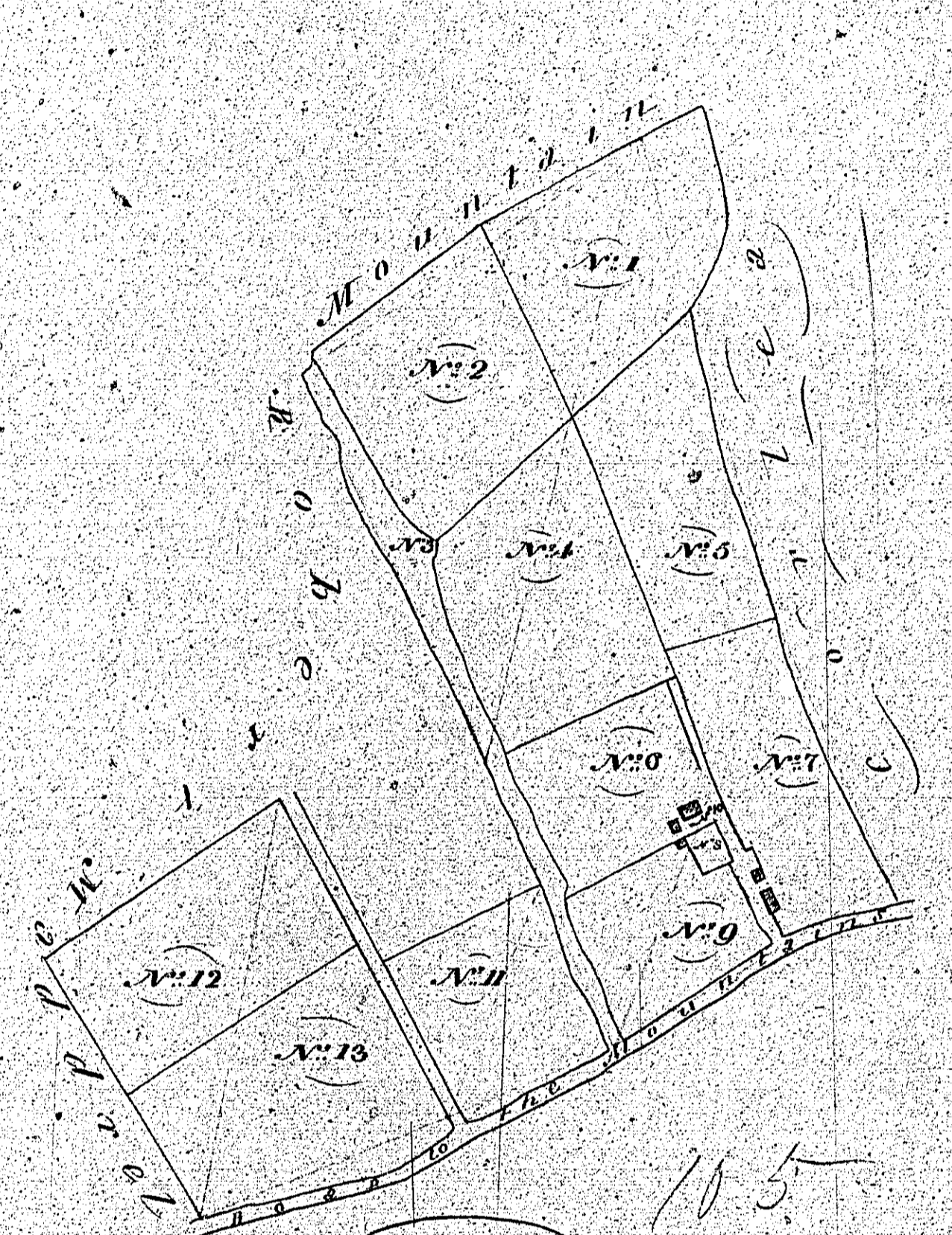

105

Contents	
N.1	1. 2. 20
2	1. 3. 10
3	0. 2. 28. 6/12
4	1. 3. 30
5	1. 1. 36
6	1. 0. 2
7	1. 1. 16
8	0. 0. 10. 6/12. Garden
9	0. 3. 33
10	0. 0. 24. 6/12. House
11	1. 1. 0
12	1. 3. 2
13	1. 2. 27
<hr/>	
10	5. 21

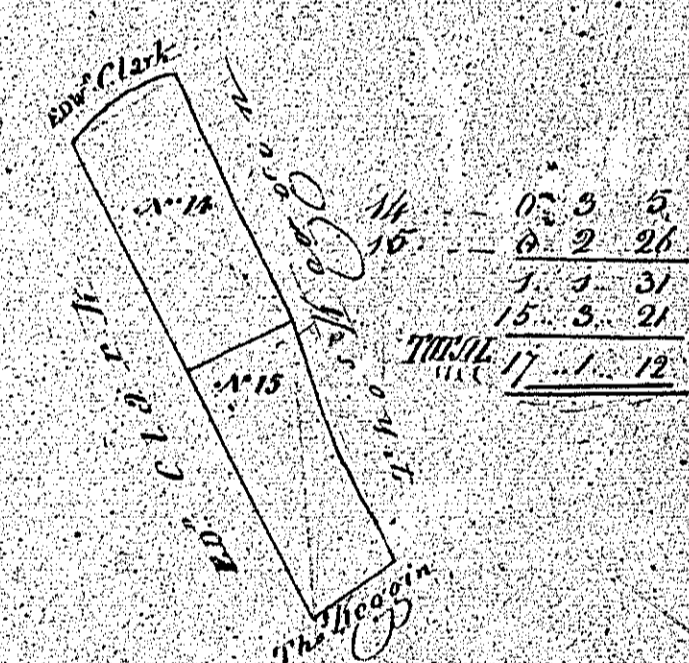

N.14	0. 5. 5
N.15	0. 2. 26
<hr/>	
15. 5. 21	
<hr/>	
17. 1. 12	

105

Plan and Survey
OF PREMISES
in the Parish of Malton
Settled Land
THE PROPERTY OF
M. Edw. Shelley

THOS GICK SURVEYOR 1840
SCALE - 3 Chains to an Inch

116

- A -

PLAN and Survey of an INTACK
in the Parish of MALEW belonging to
M^r ROBERT SHIMMIN
April 18th 1840.

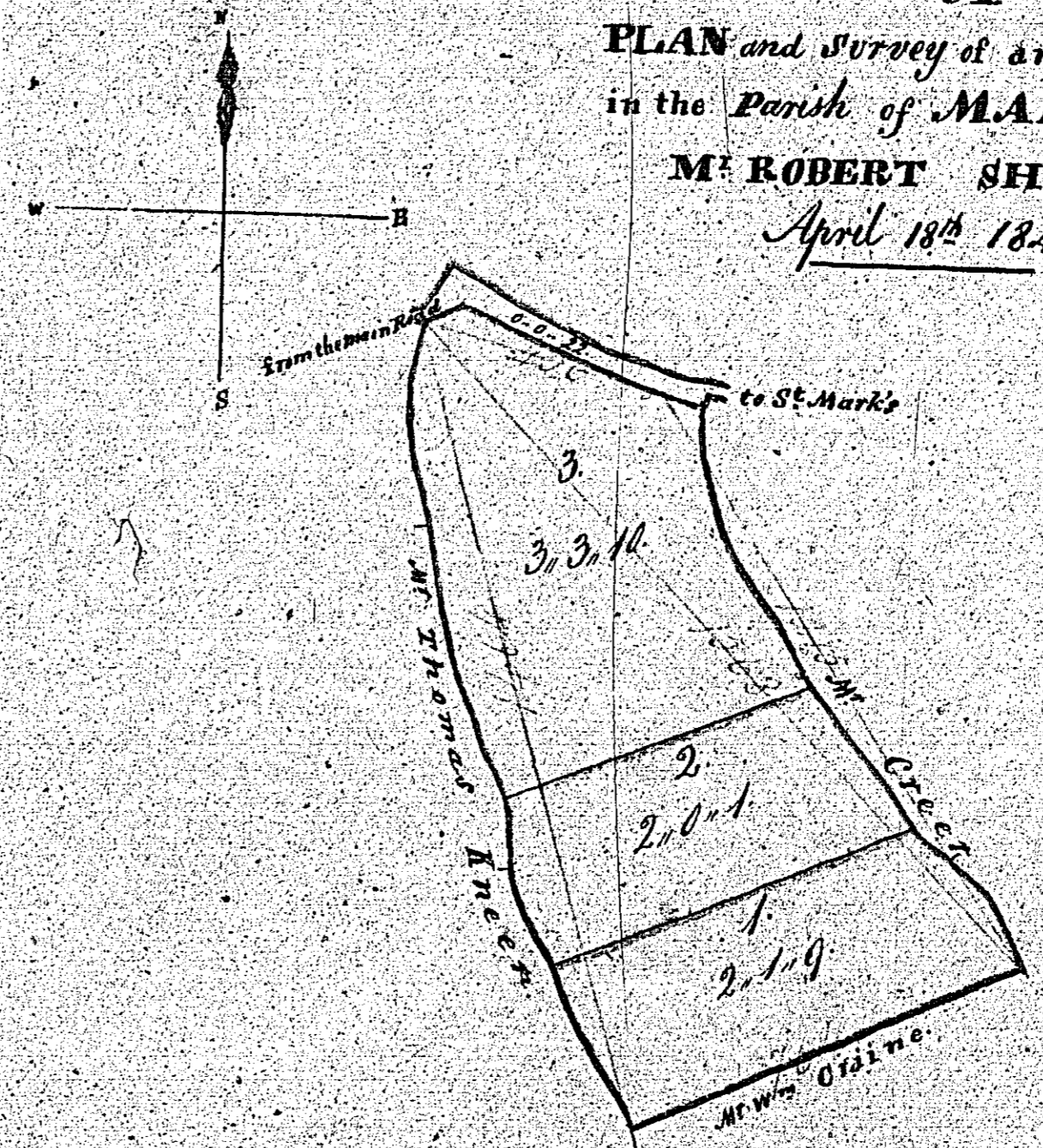

Collected			
No	A	R	P.
1	2	7	9
2	2	0	1
3	3	3	10
Total	8	0	20

By W^m Cowley
Schoolmaster
Ballasally



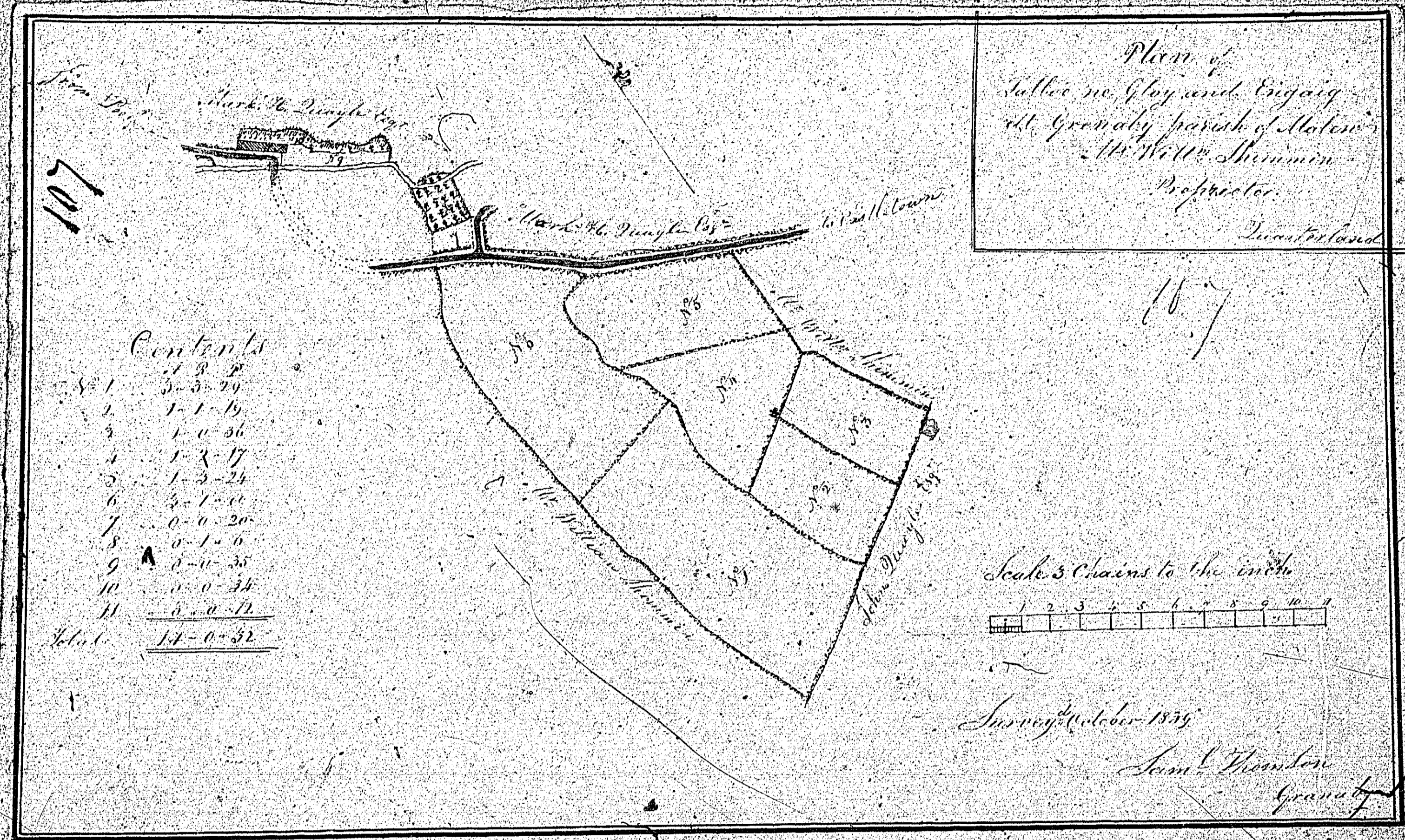

ISLE OF MAN GOVERNMENT: GENERAL REGISTRY
 TITHE PLANS: PARISH OF MALEW
 Original coloured (decorative) 1:30