

Plot of Long in the new town

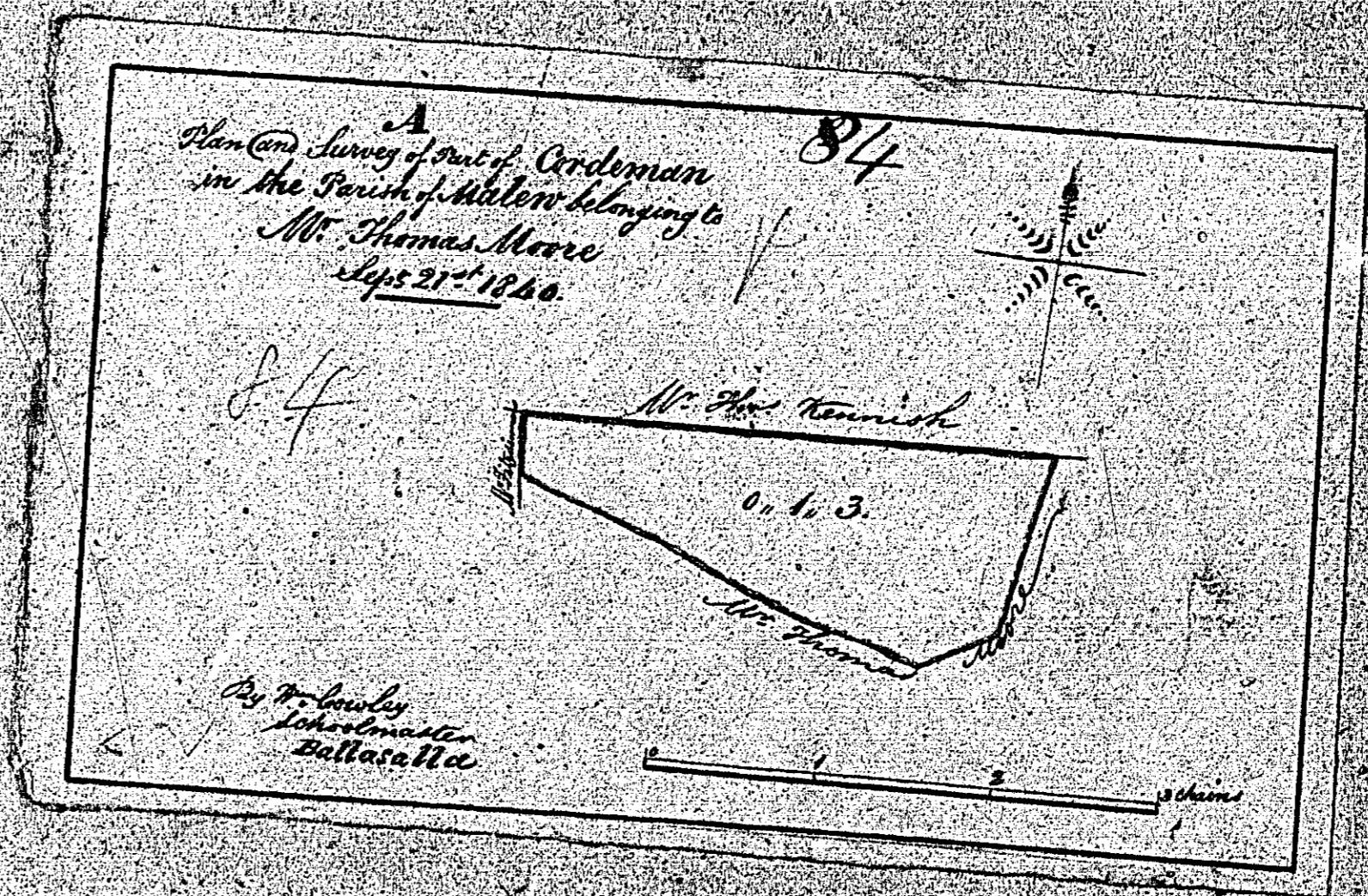

A
Plot of Long of one of the
in the Parish of St. Andrew's
Mt. Thomas, N. C.
Sept 21st 1780.

84

84

Plot of Long

0.1.3

By J. Lewis
Surveyor
Baltimore

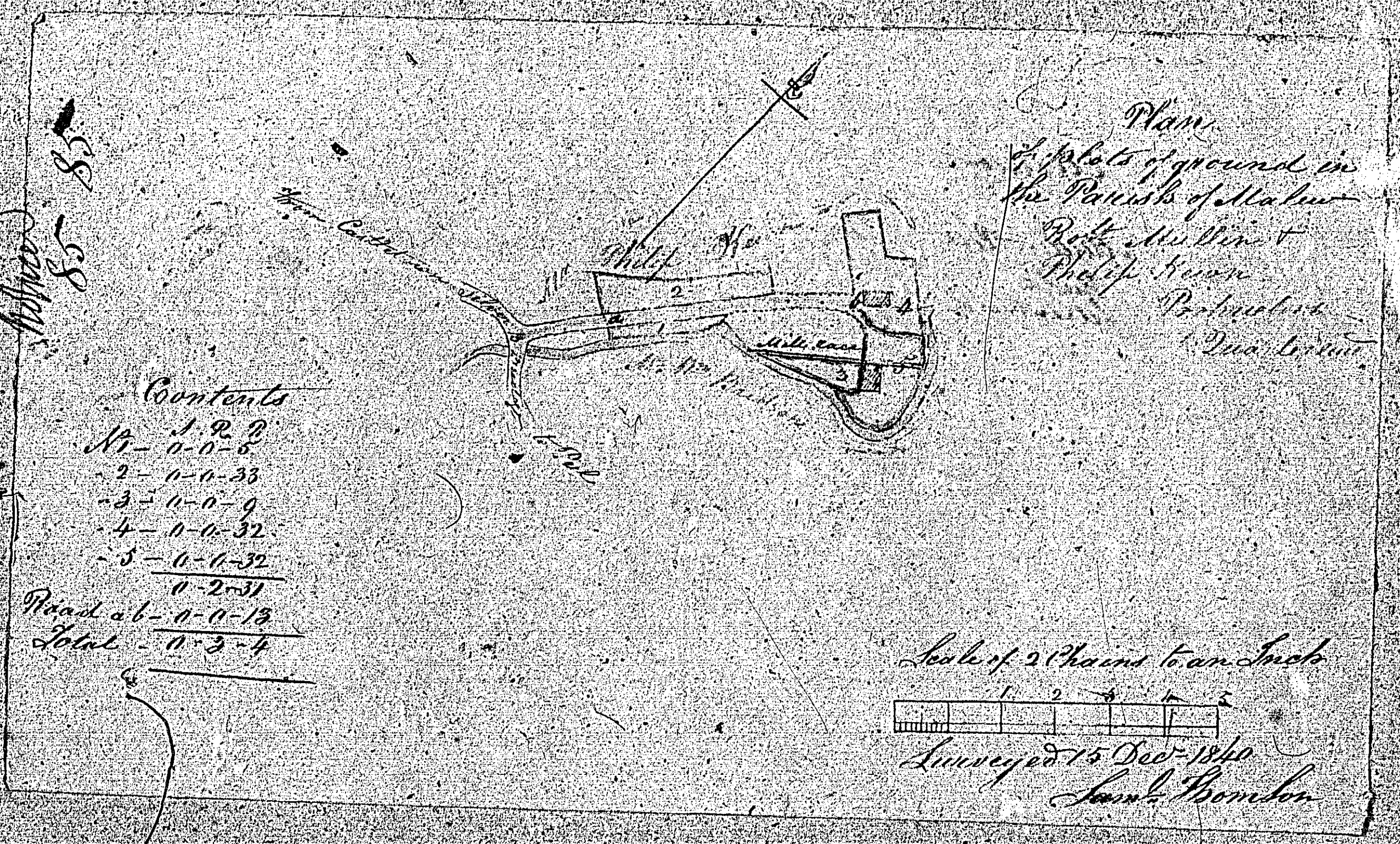

ISLE OF MAN GOVERNMENT: GENERAL REGISTRY
 TITHE PLANS: PARISH OF MALEW
 Original coloured (decorative), faint 1:30

*Plans & Survey
of
Langness and South Islands
in the Parish of Melton*

86

THE PROPERTY OF

John & Edmund Gordon

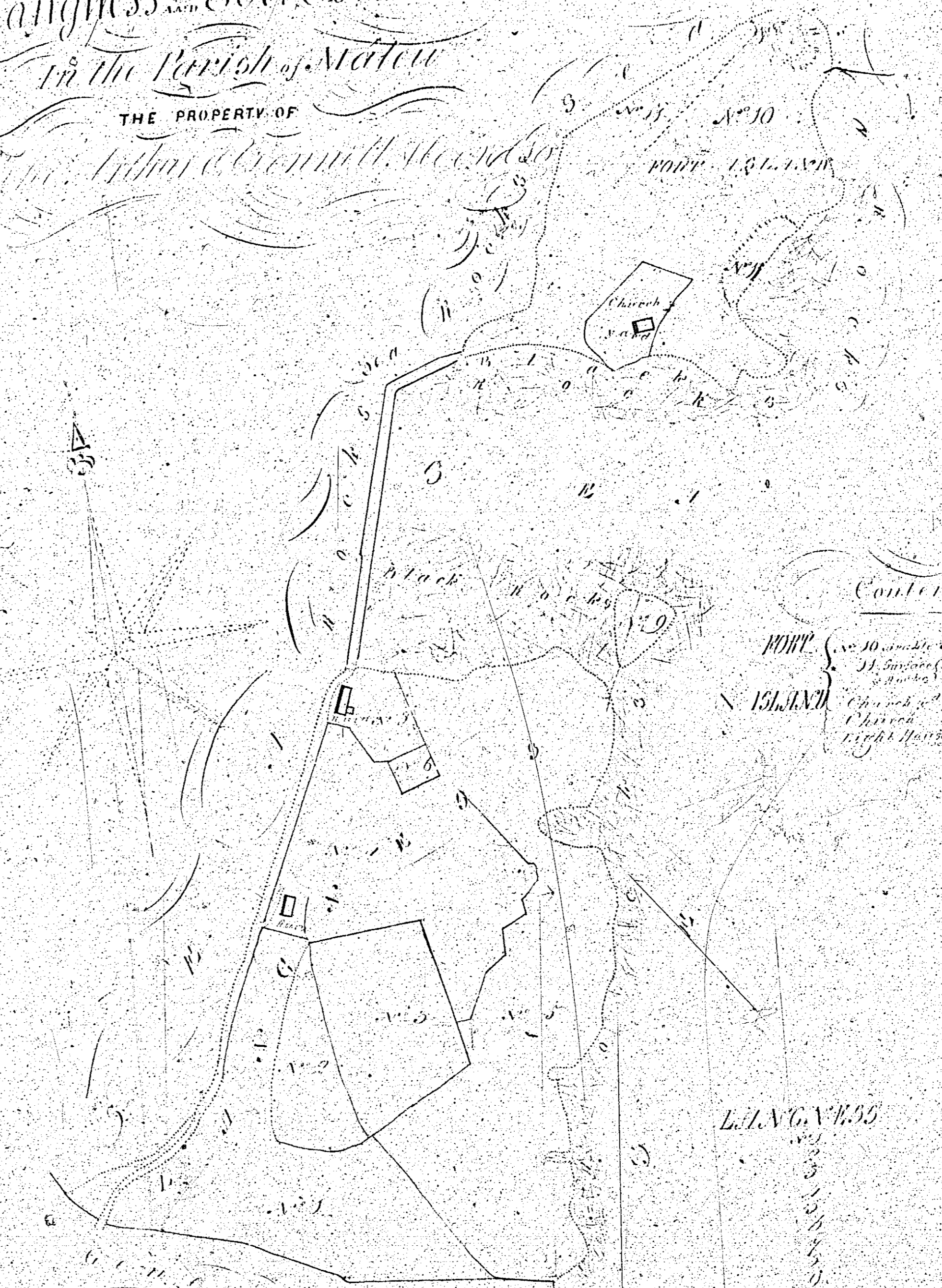

Contents

10 acres	1 11 0
11 acres	1 20 0
12 acres	0 30 0
Church	2 30 0
Church	0 15 0
Right Hand	0 15 0
	1 1 13

Latin

1	1 11 0
2	1 20 0
3	0 30 0
4	2 30 0
5	0 15 0
6	0 15 0
7	0 15 0
8	0 15 0
9	0 15 0
10	0 15 0
Total	1 1 13

General Grid

Scale 3 Chains to an Inch

2
36

Chas (179) 1795



Deck & gunway, Intack, Stairs
 Property of Eleanor Nelson
 of New Bedford

1	0.3.11
2	1.1.0
3	1.5.3
4	1.0.3
5	0.3.10
6	1.1.6
7	1.1.7
8	5.1.30
13.1.30	
Stairs	0.6.20
Gunway	0.0.6
Intack	1.1.16

Surveyed by Lt. Col. of Artillery
 April 20th 1850

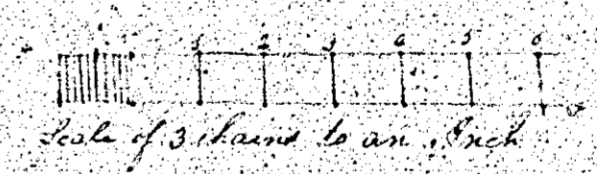

2
36

Thad Van
Chas. C. C.

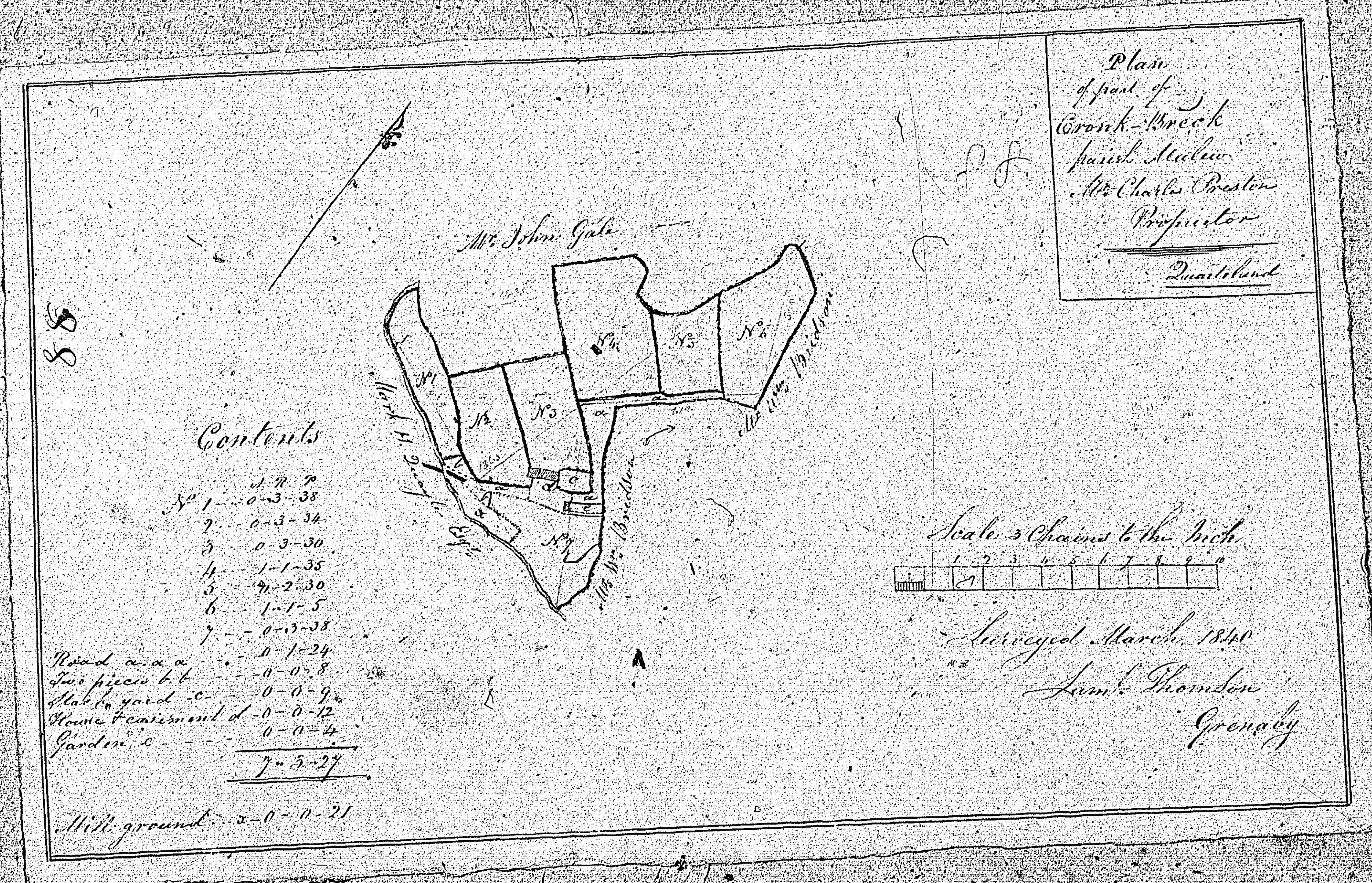

ISLE OF MAN GOVERNMENT: GENERAL REGISTRY
 TITHE PLANS: PARISH OF MALEW
 Original coloured (decorative) 1:30