

PREVIOUS IMAGE REPEATED

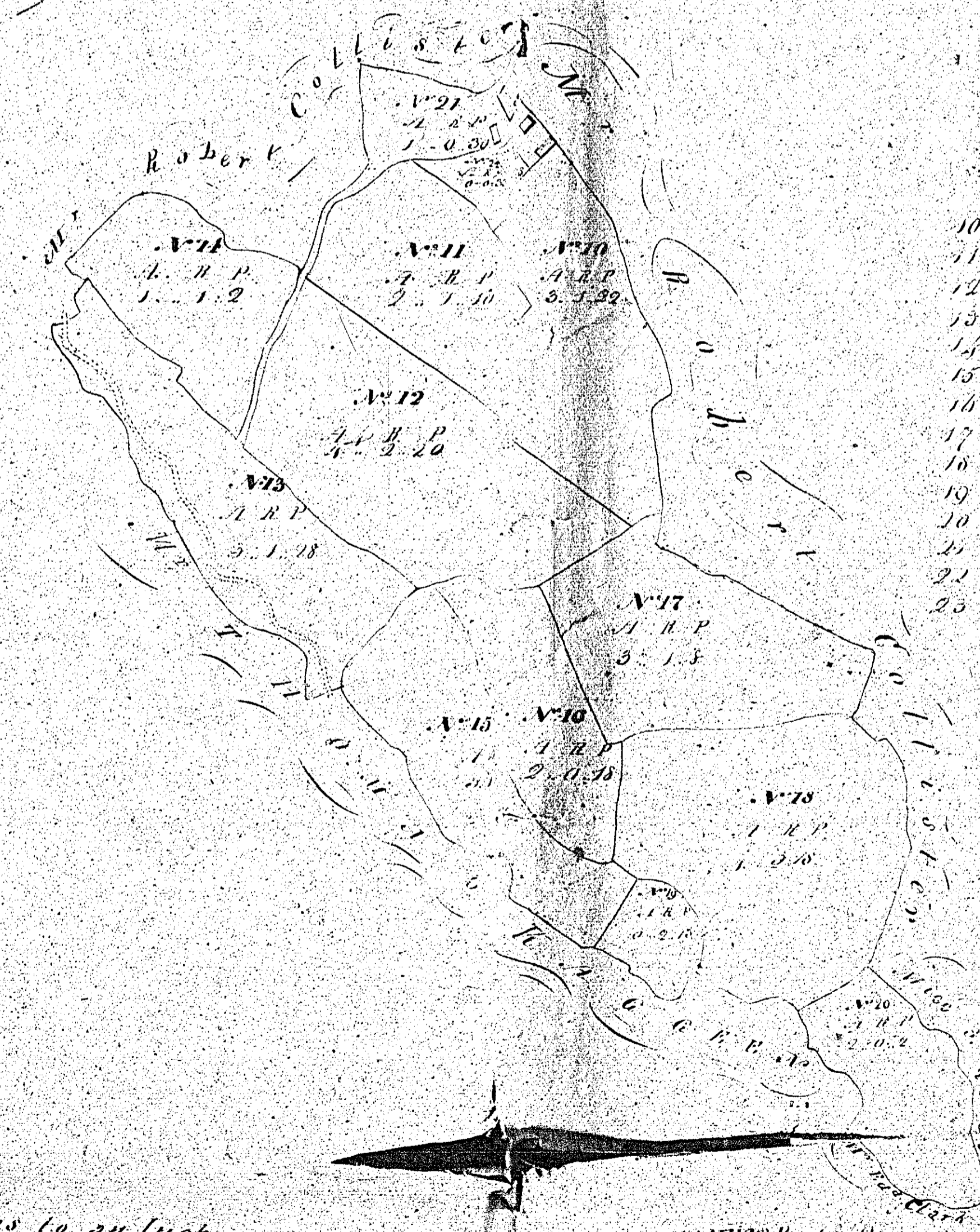
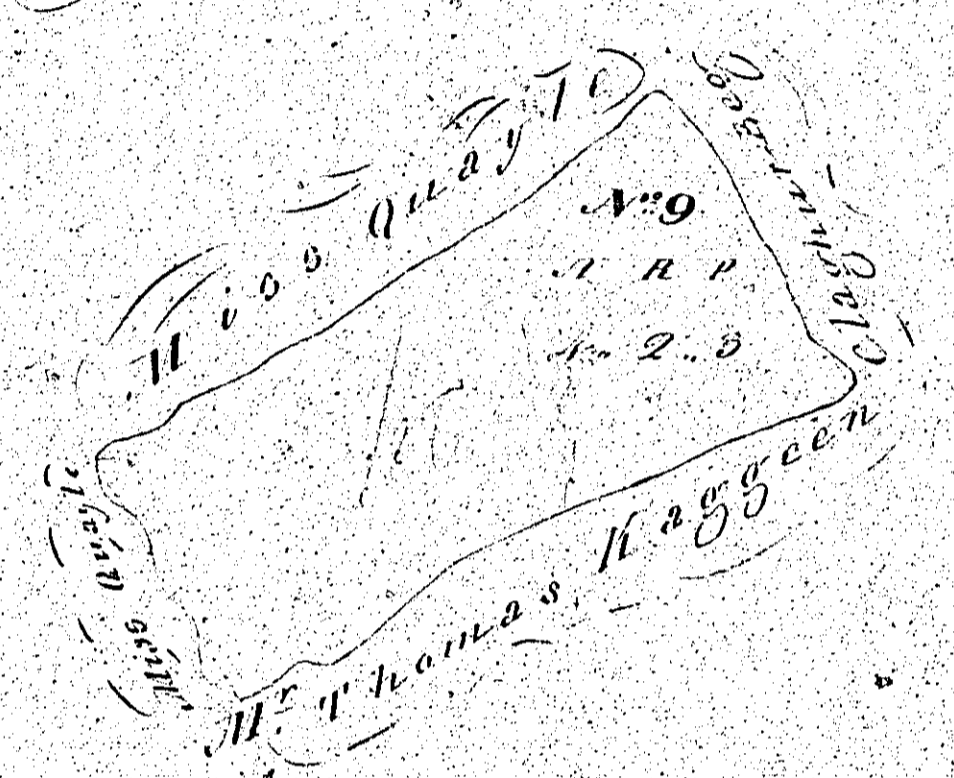
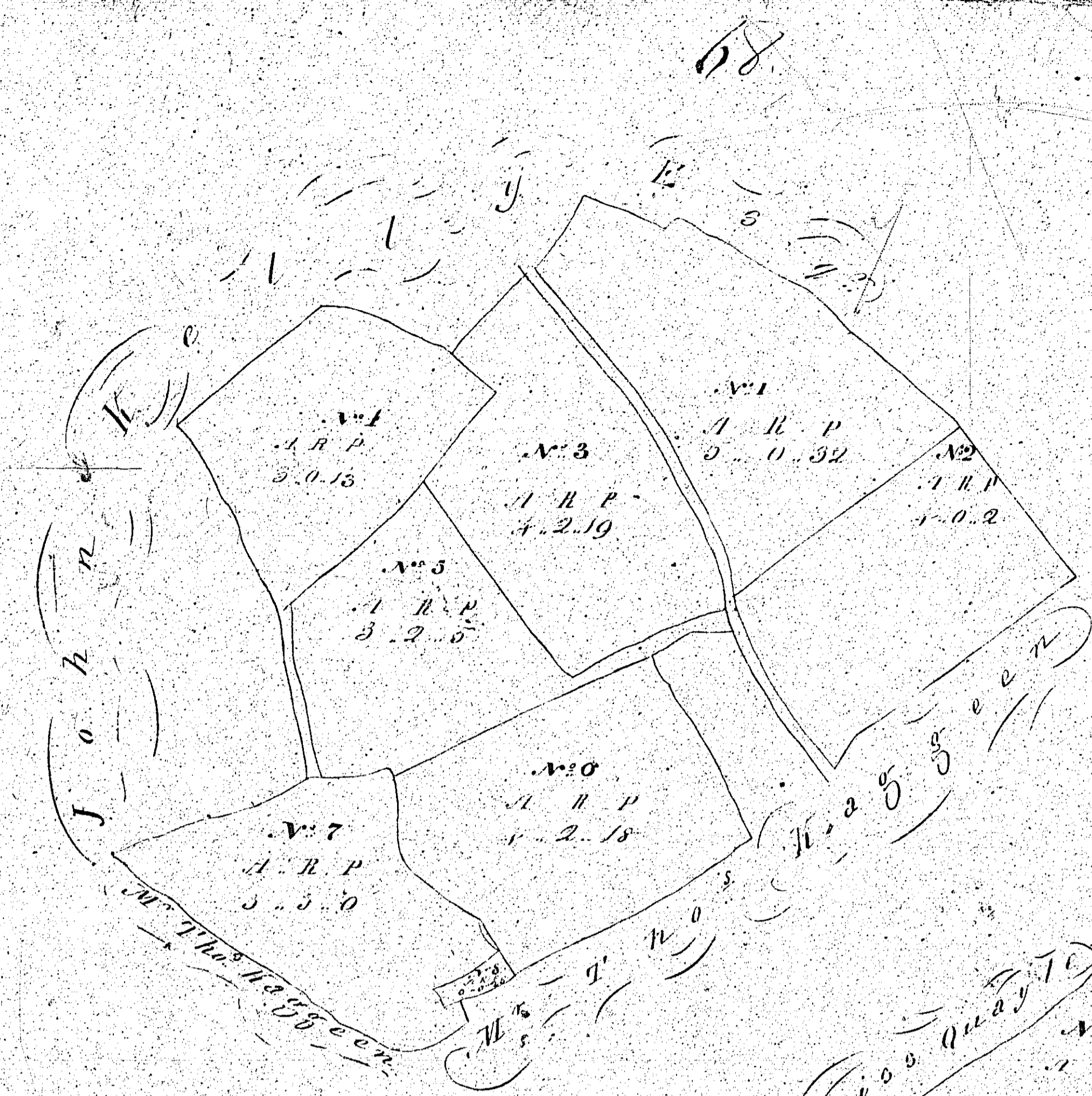

**CONTENTS**

1	1 0 0
2	3 0 25
3	1 0 2
4	1 2 19
5	3 0 15
6	3 2 5
7	1 2 18
8	3 3 0
9	0 0 25
Roads	0 1 0
<b>Total</b>	<b>29 0 34</b>

*Plan and Survey*  
 OF PART OF THE ESTATE OF  
**CLAGHUR BEG**  
 In the Parish of Malew  
 THE PROPERTY  
 of  
*Mr. Matthias Kelly*

SCALE 3 Chains to an Inch

THE CLERK SURVEYOR 1850

10	3 1 22
11	2 1 10
12	1 2 20
13	2 1 28
14	1 1 2
15	3 1 7
16	2 0 18
17	3 1 3
18	1 3 18
19	0 2 13
20	1 0 2
21	0 0 20
22	0 0 35
23	0 0 38
Waters	0 0 38
Roads	0 0 38
<b>Total</b>	<b>60 2 54</b>

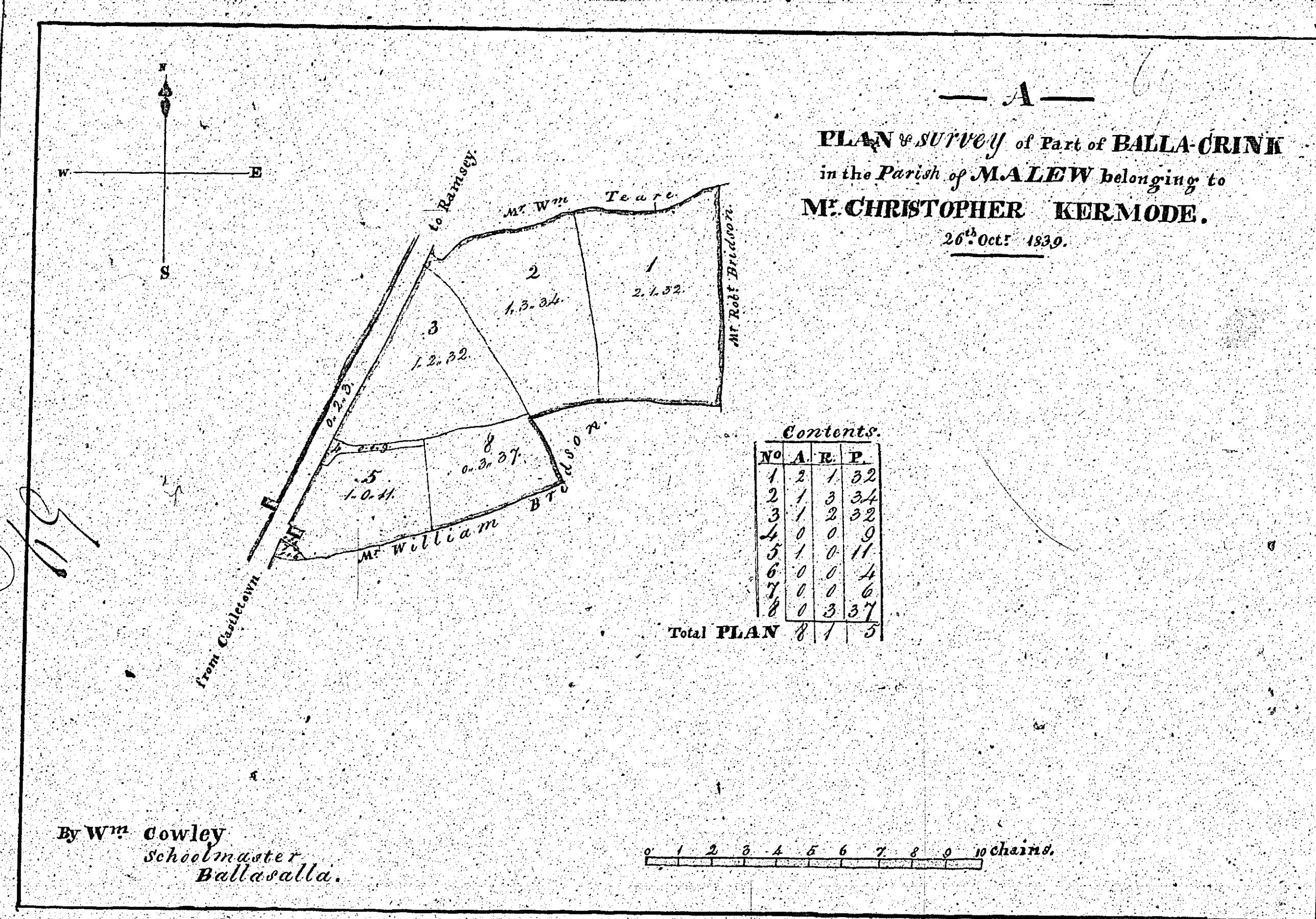

*Witnessed at Ballavalla*

Plan 70  
 of the  
 Estate of Ballacree  
 in the  
 Parish of Malin  
 in the  
 County of Tyrone  
 May 18 1848

70

Geo. Duayle Esq.

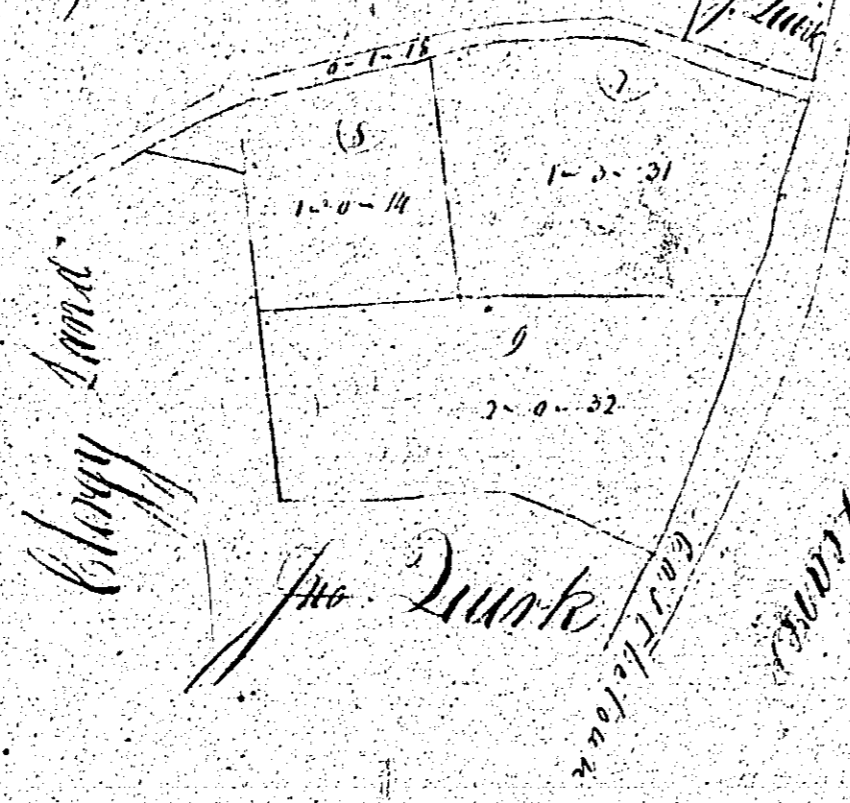

Scale Chains

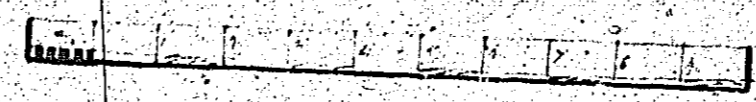

Reference	Area
1	1 1/2
2	1 1/2
3	1 1/2
4	1 1/2
5	1 1/2
6	1 1/2
7	1 1/2
8	1 1/2
9	1 1/2
10	1 1/2
Total	15 1/2

Joseph Blake Esq.

72

71

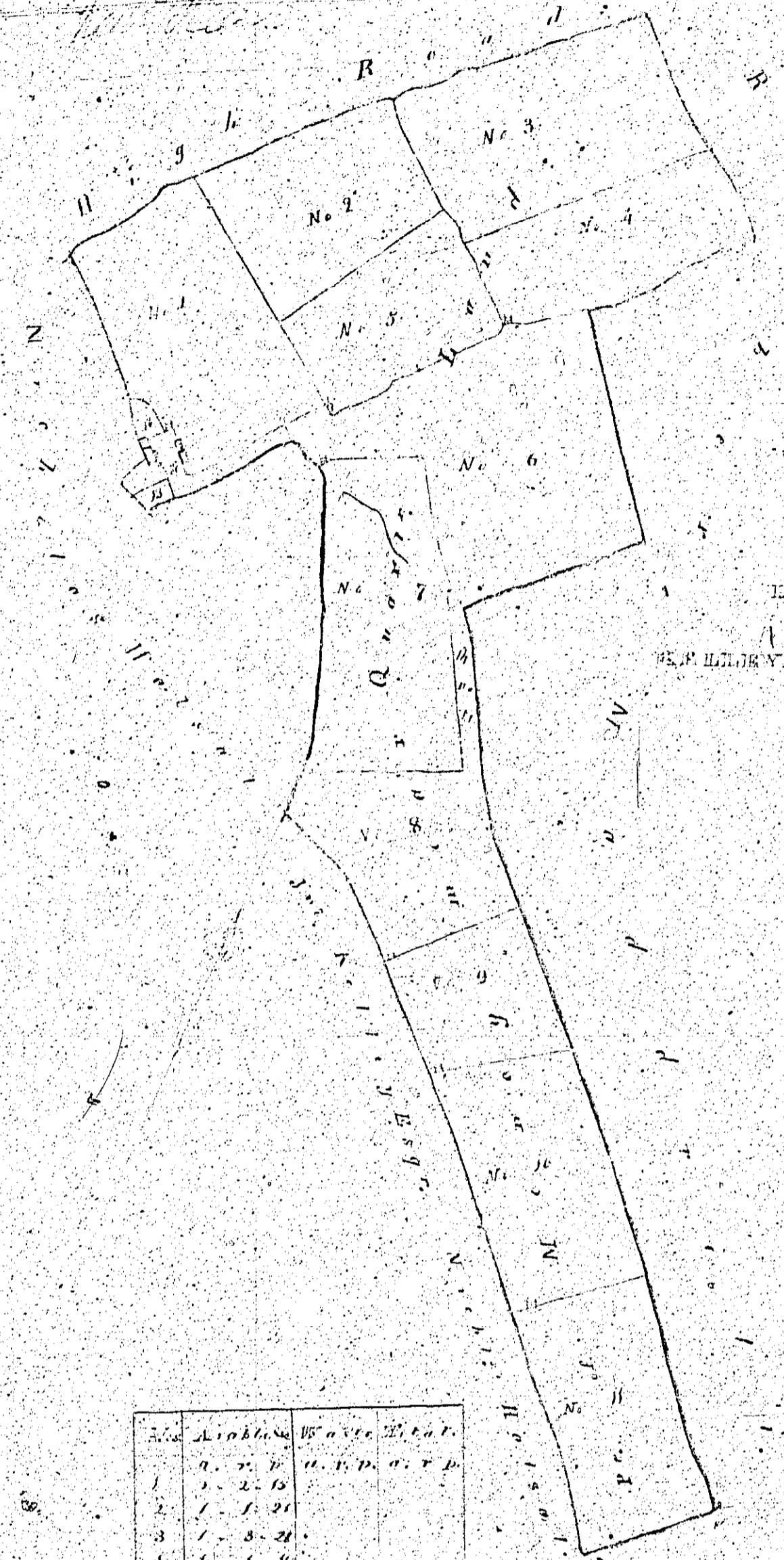

DEPT. OF THE INTERIOR  
 GEOLOGICAL SURVEY  
 WASHINGTON, D. C.  
 1880

No.	Area	Perch	Sq. Rods	Sq. Feet
1	1.2	32	128	1280
2	1.5	32	160	1600
3	1.8	32	192	1920
4	2.1	32	224	2240
5	2.4	32	256	2560
6	2.7	32	288	2880
7	3.0	32	320	3200
8	3.3	32	352	3520
9	3.6	32	384	3840
10	3.9	32	416	4160
11	4.2	32	448	4480
12	4.5	32	480	4800
13	4.8	32	512	5120
14	5.1	32	544	5440
Total	36.0	32	1152	11520



From a Survey taken by Wm. H. Dutton in 1840.

Plan & Survey  
of the Estate of the  
Gortea  
in the Parish of Malen  
the property  
of John Kelly Esq

Contents

1	0	0
2	1	0
3	1	25
4	1	30
5	1	10
6	1	15
7	1	20
8	2	1
9	1	22
10	1	20
11	1	10
12	1	25
13	0	10
14	0	0
15	0	3
16	0	3
17	0	17
18	1	2
19	1	10
20	1	1
21	0	25
22	1	5
23	1	1
24	0	10
25	0	0
26	0	0
27	0	3
28	0	10
29	0	10
30	0	10
31	0	10
32	0	10
33	0	10
34	0	10
35	0	10
36	0	10
37	0	10
38	0	10
39	0	10
40	0	10
41	0	10
42	0	10
43	0	10
44	0	10
45	0	10
46	0	10
47	0	10
48	0	10
49	0	10
50	0	10
51	0	10
52	0	10
53	0	10
54	0	10
55	0	10
56	0	10
57	0	10
58	0	10
59	0	10
60	0	10
61	0	10
62	0	10
63	0	10
64	0	10
65	0	10
66	0	10
67	0	10
68	0	10
69	0	10
70	0	10
71	0	10
72	0	10
73	0	10
74	0	10
75	0	10
76	0	10
77	0	10
78	0	10
79	0	10
80	0	10
81	0	10
82	0	10
83	0	10
84	0	10
85	0	10
86	0	10
87	0	10
88	0	10
89	0	10
90	0	10
91	0	10
92	0	10
93	0	10
94	0	10
95	0	10
96	0	10
97	0	10
98	0	10
99	0	10
100	0	10

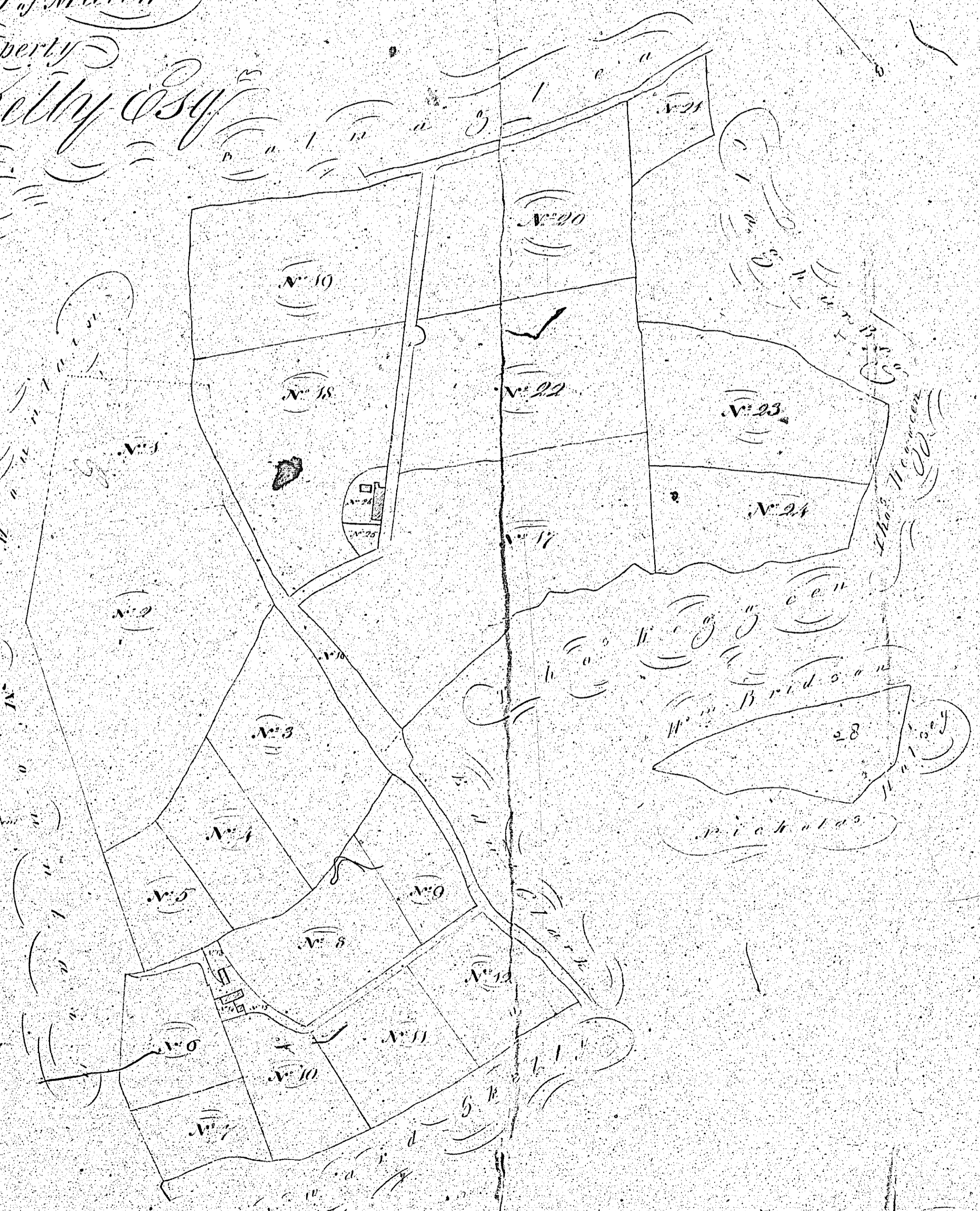

Scale 3 Chains per Inch

The Green