

PLAN

BILLAJUREI

*North from N.W.*  
40

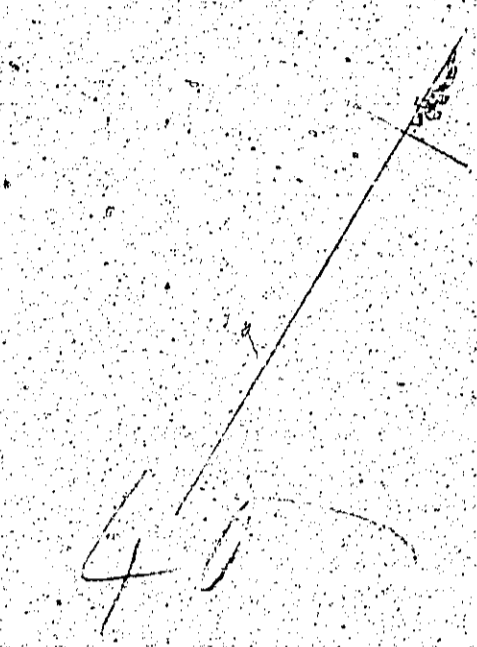

*Westons*

No.	1	2
	0-3-20	1-1-13
	2-0-55	

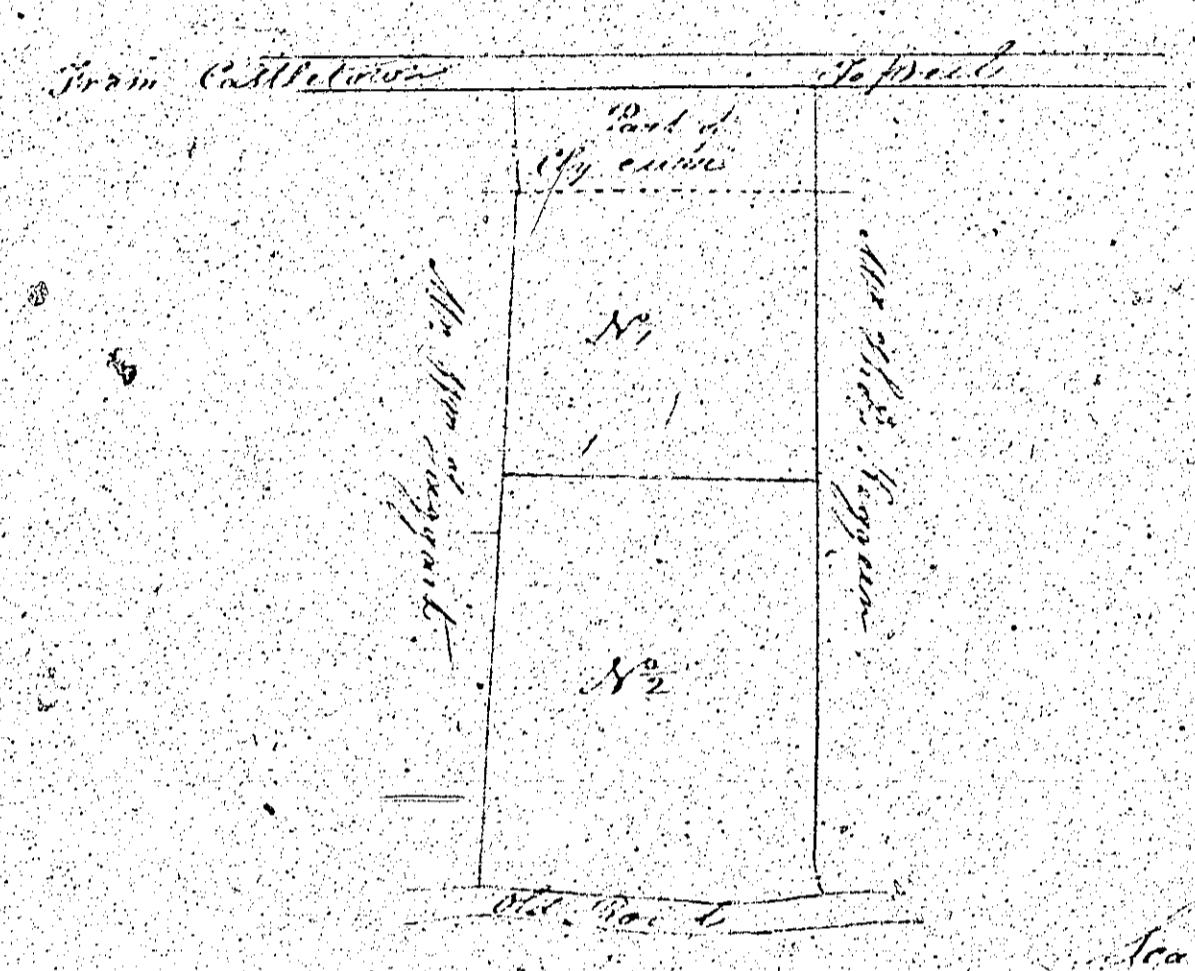

Plan  
of Plot of grounds in the  
Parish of St. Andrew the  
Property of Mr Wm Chatterton  
In Leases

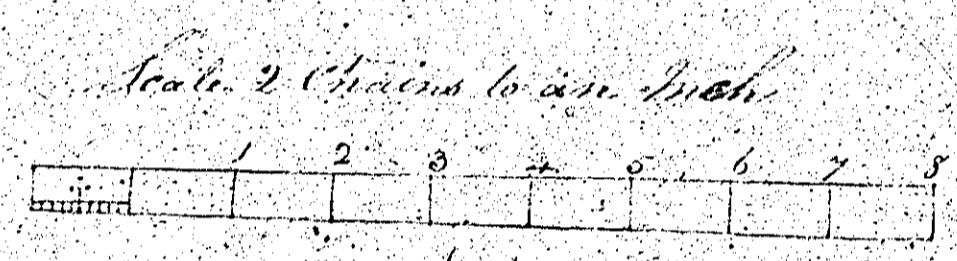

Surveyed January 1841  
James Thomson  
Surveyor

41

CORDAMAN

in Malew

The Property of M<sup>rs</sup> Davidson

April 1840.

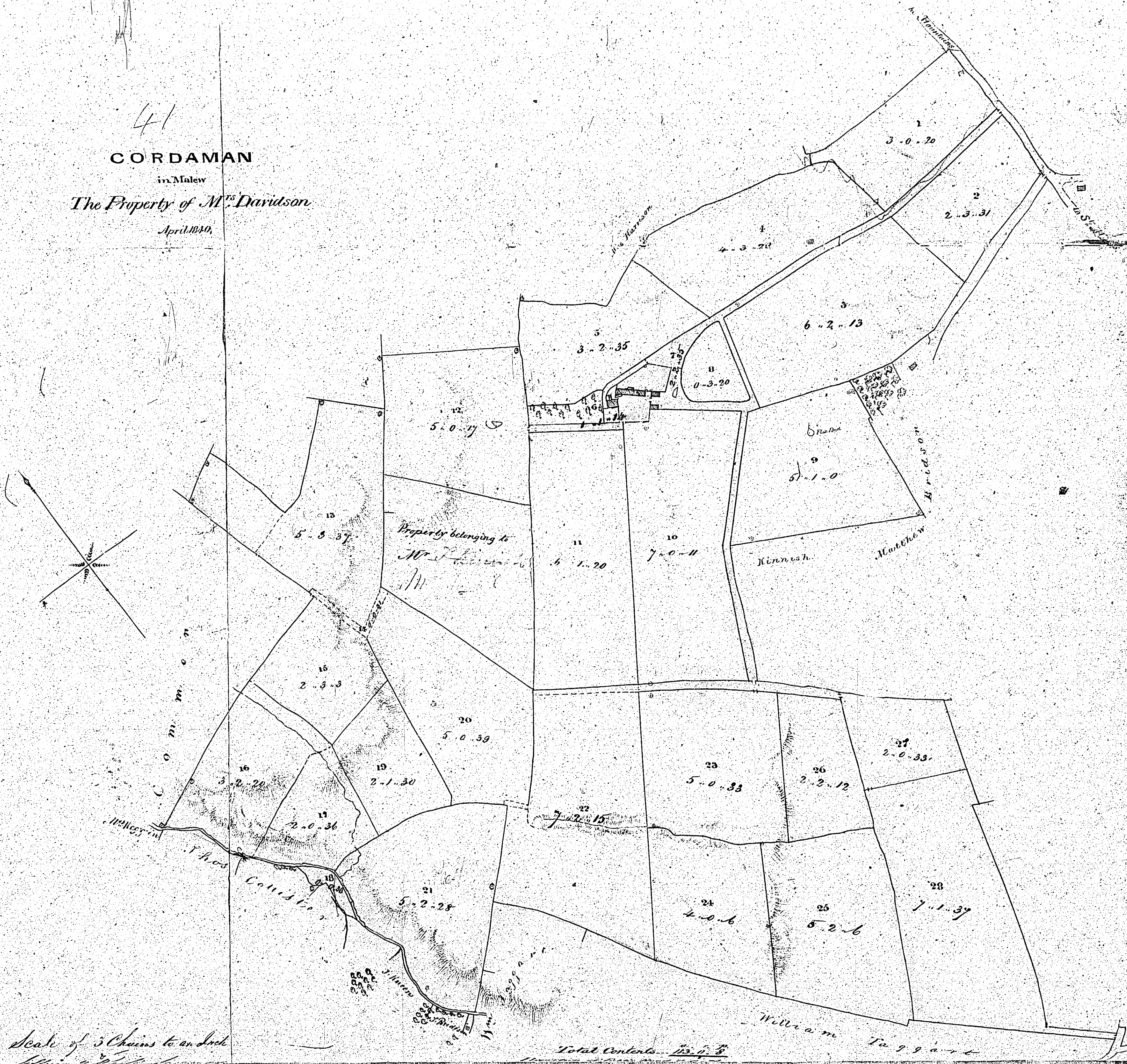

Scale of 5 Chains to an Inch

Total Contents 132 1/2

William Taggart

PLAN

BALLJERRY  
The property of  
Sir George Sackville  
Lyttelton in the Parish of  
St. Helen  
1740

42

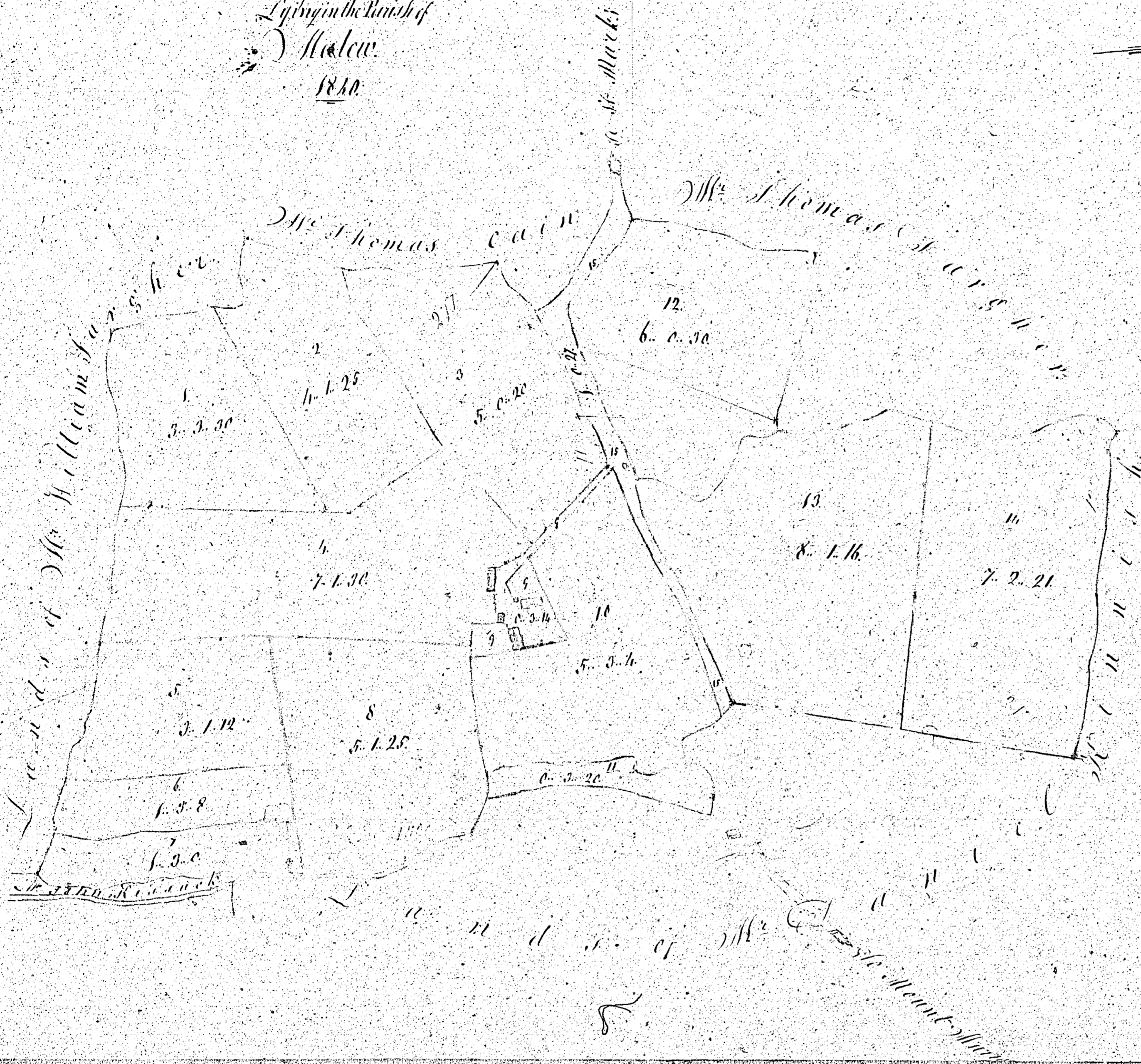

Contents

1	1	1
2	1	25
3	1	20
4	1	30
5	1	22
6	1	38
7	1	30
8	1	28
9	1	34
10	1	34
11	1	20
12	6	30
13	8	18
14	7	24
15	42	15
Total	71	22

Scale of three Chains to an inch

CLOSEVANE  
in Malew  
The Property of W<sup>m</sup> Duff Esq  
May 1840.

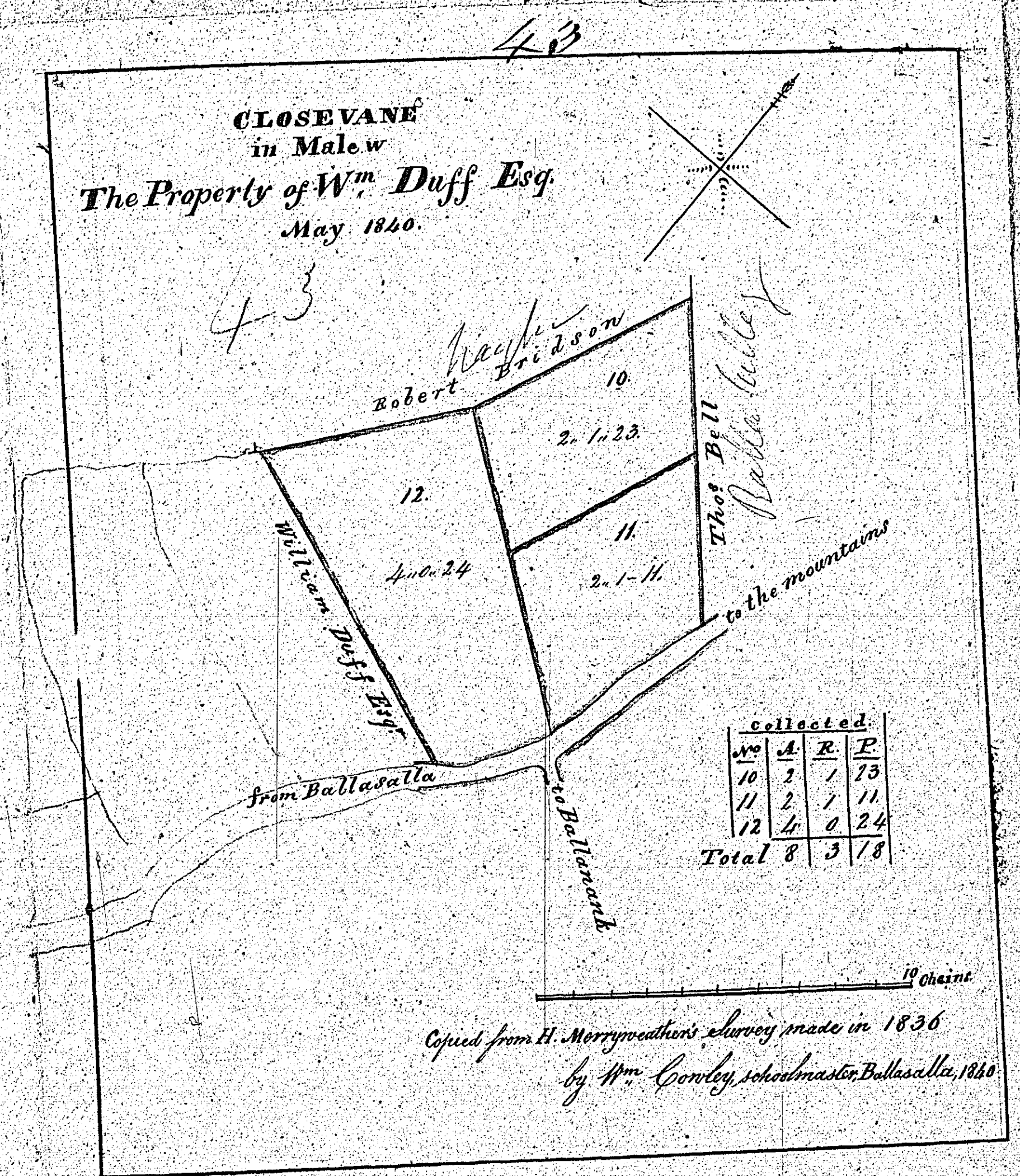

Copied from H. Merryweather's survey made in 1836  
by W<sup>m</sup> Conley, schoolmaster, Ballasalla, 1840

Wm Duff Esq

Wm Duff Esq

Wm Duff Esq

44

PLAN  
of Part of the Estate of  
Mrs. Beckett  
situate toward  
the property of  
M<sup>r</sup>. JAMES DORRAN

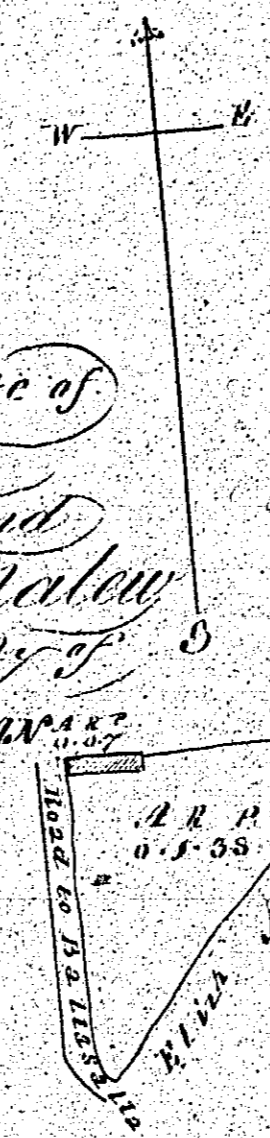

CONTENTS  
A. 1. 93  
House 0. 0. 7  
Total 0. 1. 93

Wm. Beckett

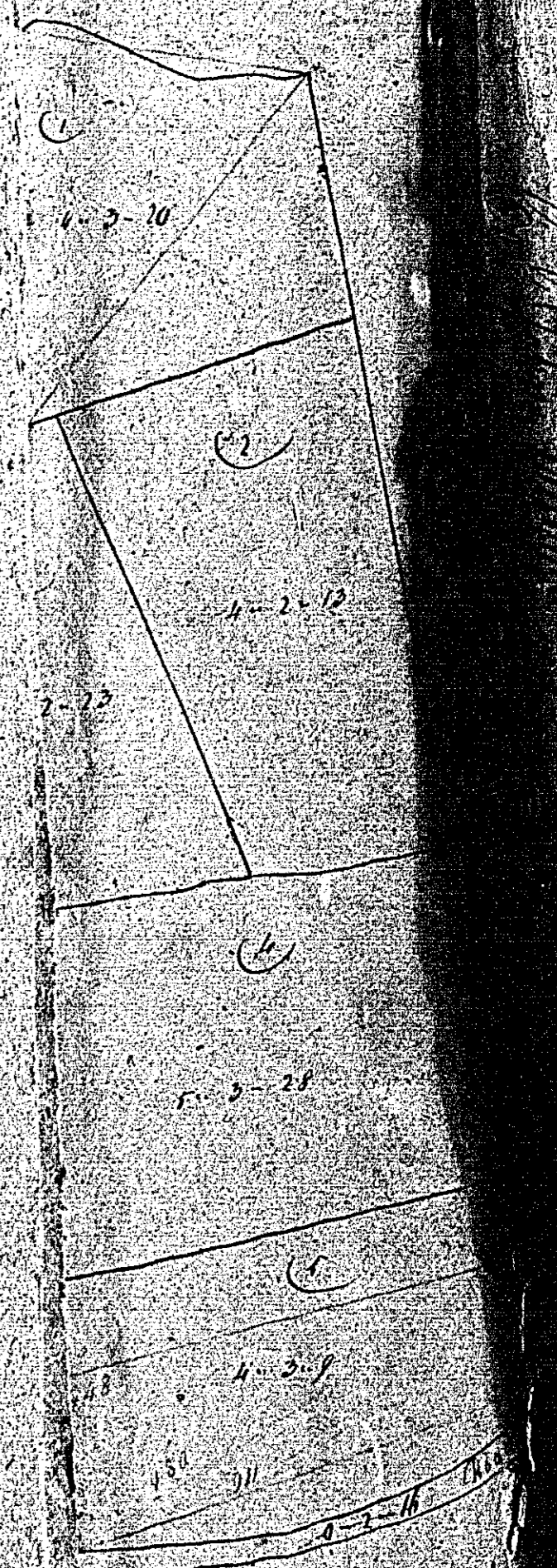

M<sup>r</sup>. N. Howley

Joseph

45

A  
Plan & Survey of BALLAKILLEY  
in the Parish of MALEW, belonging to  
Mr Joseph Fisher.  
May 3<sup>d</sup> 1840.

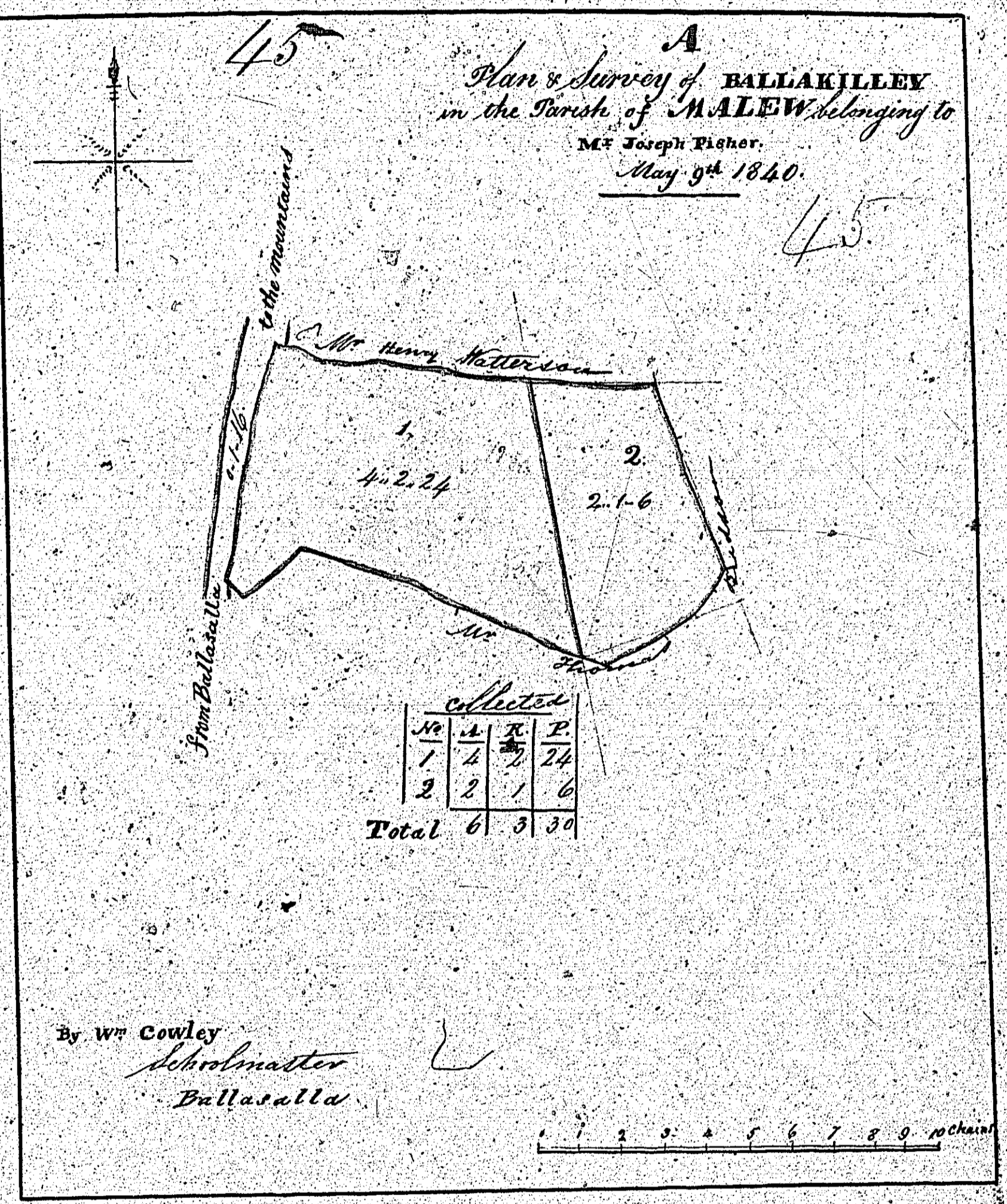

Wm Cowley

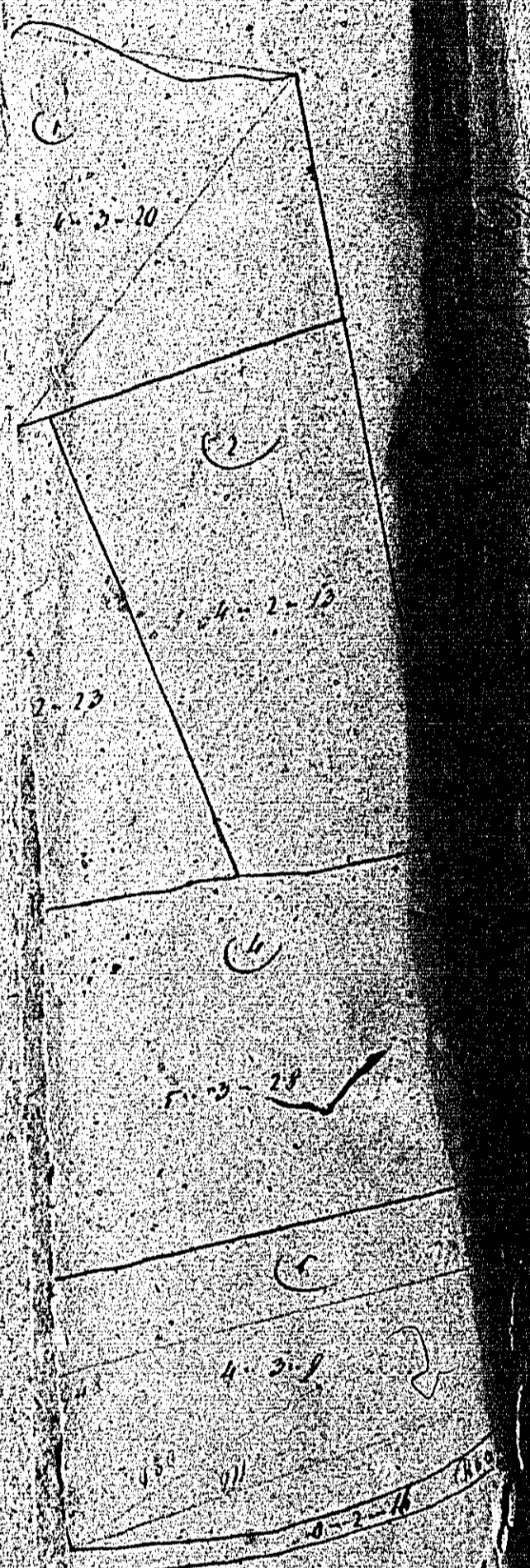

Wm Cowley

Wm Cowley