

Not used

196.

*Billings Sub*

*M. Dasher*

*1. 0.2.31*

*2. 1.2.14*

*3. 0.1.18*

*4. 0.1.12*

*5. 1.3.2*

*6. 0.2.38*

*7. 0.1.19*

*8. 0.1.18*

*9. 0.2.22*

*10. 0.2.36*

*Reference*

*1. 0.2.31*

*2. 1.2.14*

*3. 0.1.18*

*4. 0.1.12*

*5. 1.3.2*

*6. 0.2.38*

*7. 0.1.19*

*8. 0.1.18*

*9. 0.2.22*

*10. 0.2.36*

*Scale of 1000*

*All Plans Survey of*  
*William's Land in the*  
*Parish of Lenox Co*  
*Property of Michael Dink*  
*by Michael Dink Michael*  
*July 11 1789*  
*House of Commons*  
*State of Virginia*







198  
The property  
of John Dure

Wotton  
198.

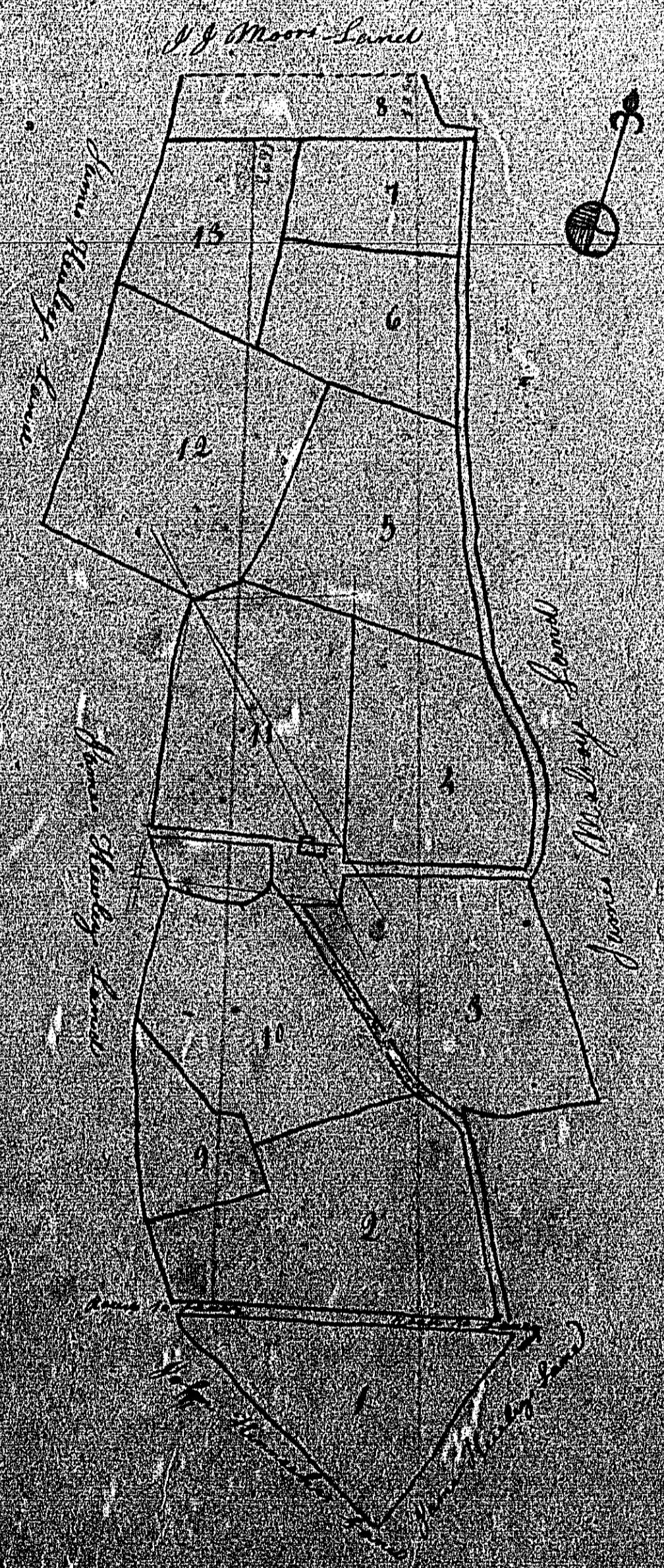

198

Surveyed  
by  
John Dure



199.  
 Survey  
 of the Estate of  
 Bellamilgyn  
 Kirk Sconer  
 the property of  
 Mr. Thomas Quayle

No.	A.	R.	P.
1	2		32
2	2		
3	1		14
4	4	1	1
5	2	1	3
6	1	2	10
7	1	3	15
8	2		12
9	1		28
10	2	1	36
11	2	3	56
12	2	1	4
13	10	3	6
14	3		19
15	3	3	28
16	2	2	36
17	1	1	1
18	3	1	8
19	2	3	3
20	2	2	2
21	2		2
22	1	2	24
23	9		2
24	2		24
25	3	2	27
26	1	3	5
Sum	74	1	17
	77	0	38
Point of public road	3		28

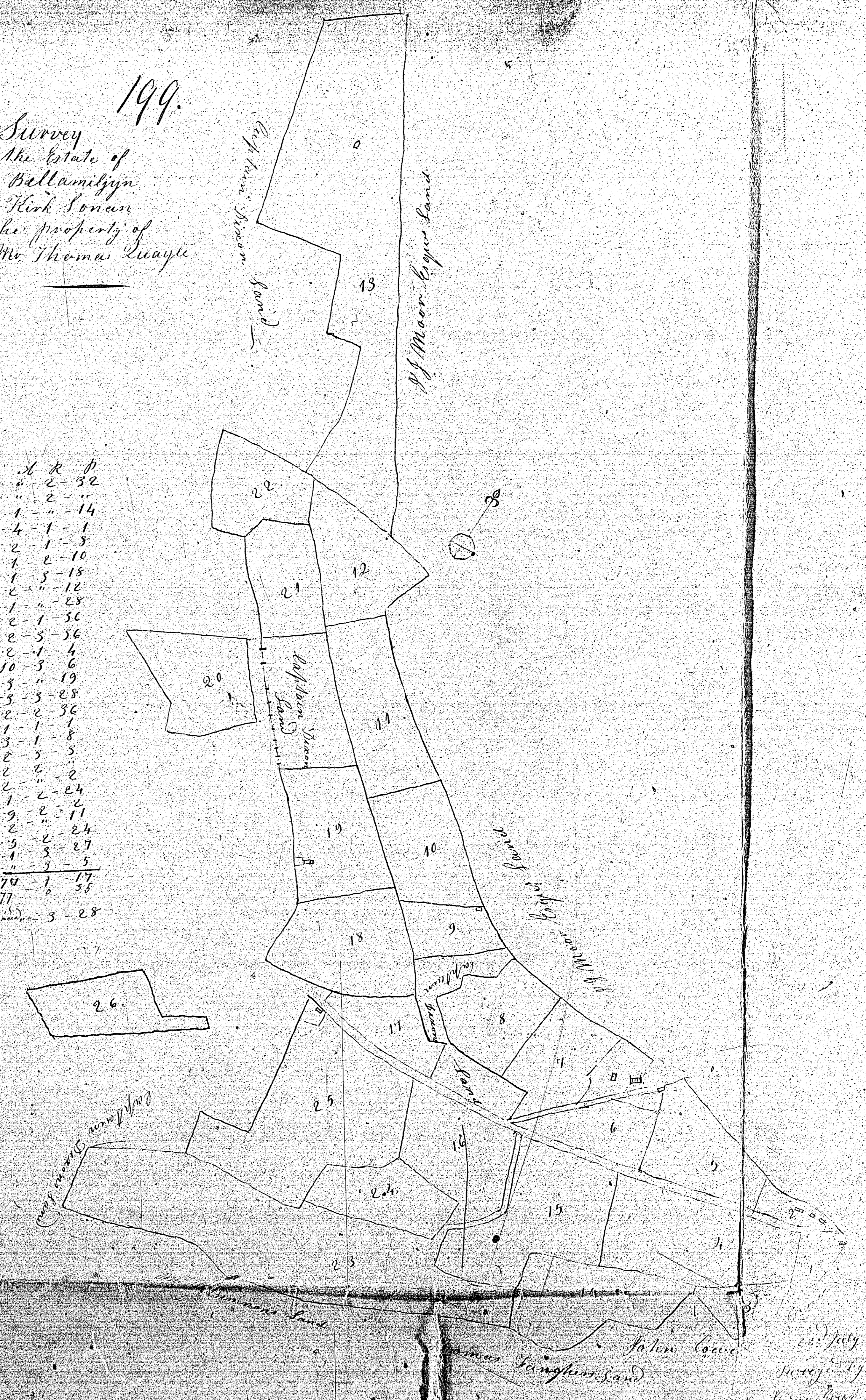

20 July 1839  
 Surveyed by  
 James Gray  
 Kirk Sconer



200.

Survey  
of the Estate of  
Brindell  
Hirk Lonan  
the property of  
Mr John Deay

1	2	4	24
2	2	1	17
3	3	1	36
4	1	1	20
5	1	1	24
6	1	1	36
7	1	1	32
8	2	3	2
9	1	3	38
10	1	1	1
11	3	5	4
12	4	2	28
13	2	1	4
14	1	1	3
15	1	3	29
16	1	3	31
17	2	2	31
18	2	1	18
19	2	1	37
20	3	1	1
Total			43-3-16
and	Barment	1	12
East of the	Public Road	1	36

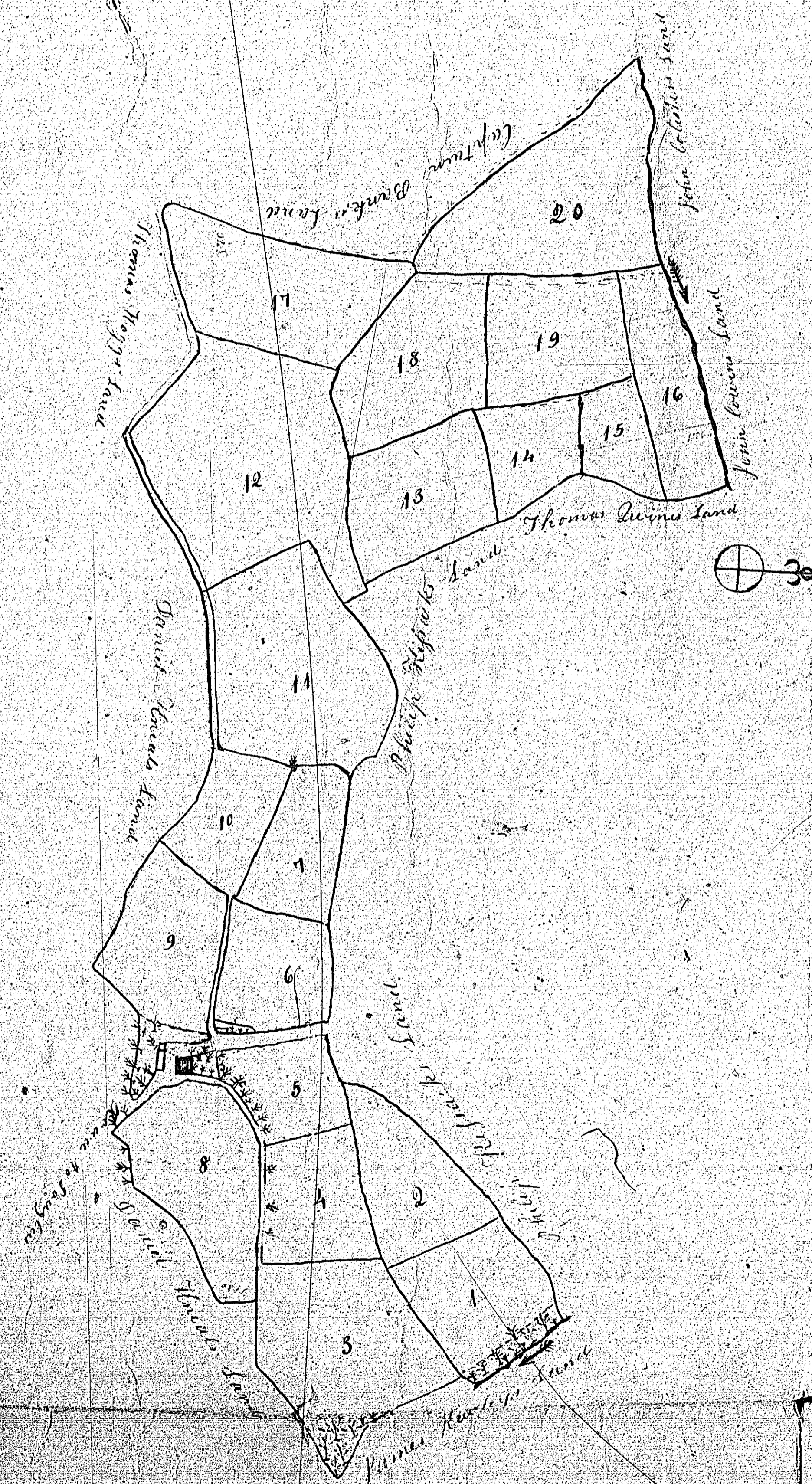

17th June 1849  
Surveyed by me  
James Gray  
Hirk Lonan



*A Plan or Survey of  
 Village Lands in the  
 Parish of Tenon the property  
 of Mr John Quirk by  
 Patrick Kelly August 6 1839*

		References	
		P.	R.
1	0. 3. 24		
2	1. 0. 19		
3	0. 1. 16		
4	0. 2. 33		
5	0. 3. 17		
6	0. 2. 17		
7	0. 1. 10		
8	0. 7. 4		
9	0. 2. 11		
10	0. 1. 31		
11	0. 3. 1		
12	0. 1. 1		
13	0. 1. 16		
14	0. 1. 20		

*Scale of 1/4 inch = 100 feet*