

186

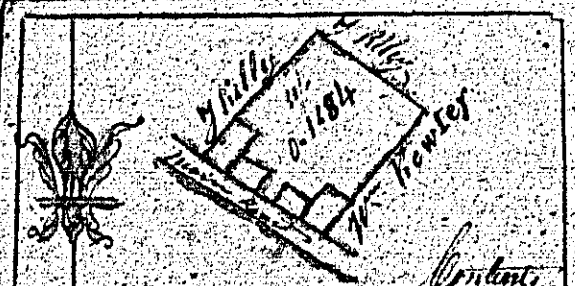

183.

North	4. 12. 30
West	0. 1. 34
East	0. 0. 20
South	0. 2. 16

A Plan & Survey of a part  
of Village Land in the parish  
of Kenyon the property of  
Mr. John Stone  
by Peter Reddy July 22<sup>nd</sup> 1787  
Leeds: J. Chisney



Baron 184.



1844  
**Plan of**  
**BALLAMAINAGH MOAR**

Prepared by  
 Mr. John Bagg - CO

Scale of 2 inches  
 to 1 mile

Contents  
 Acres 189. 1. 12  
 Barren 1. 1. 18  
 Roads 1. 0. 22  
 Total 186. 3. 12

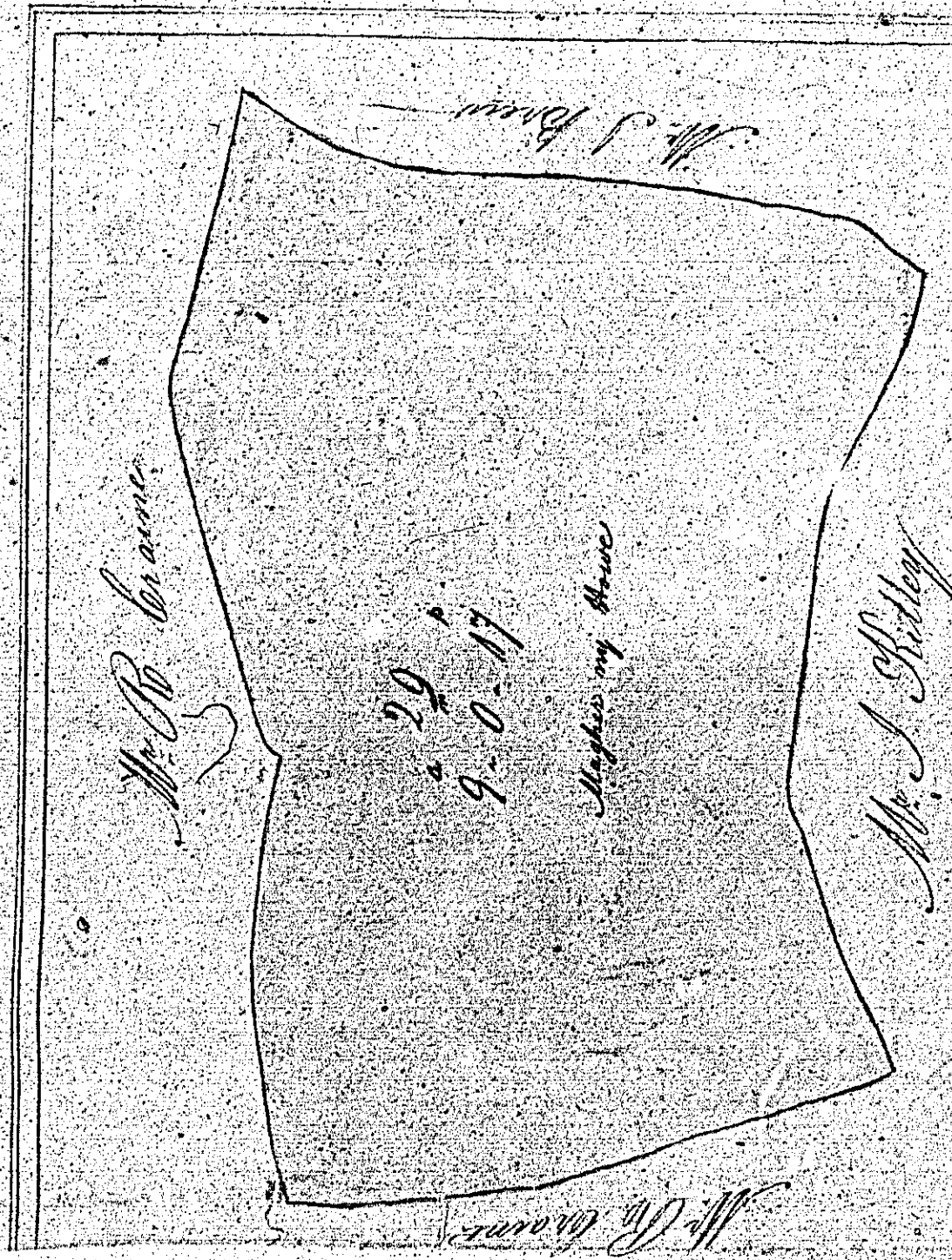



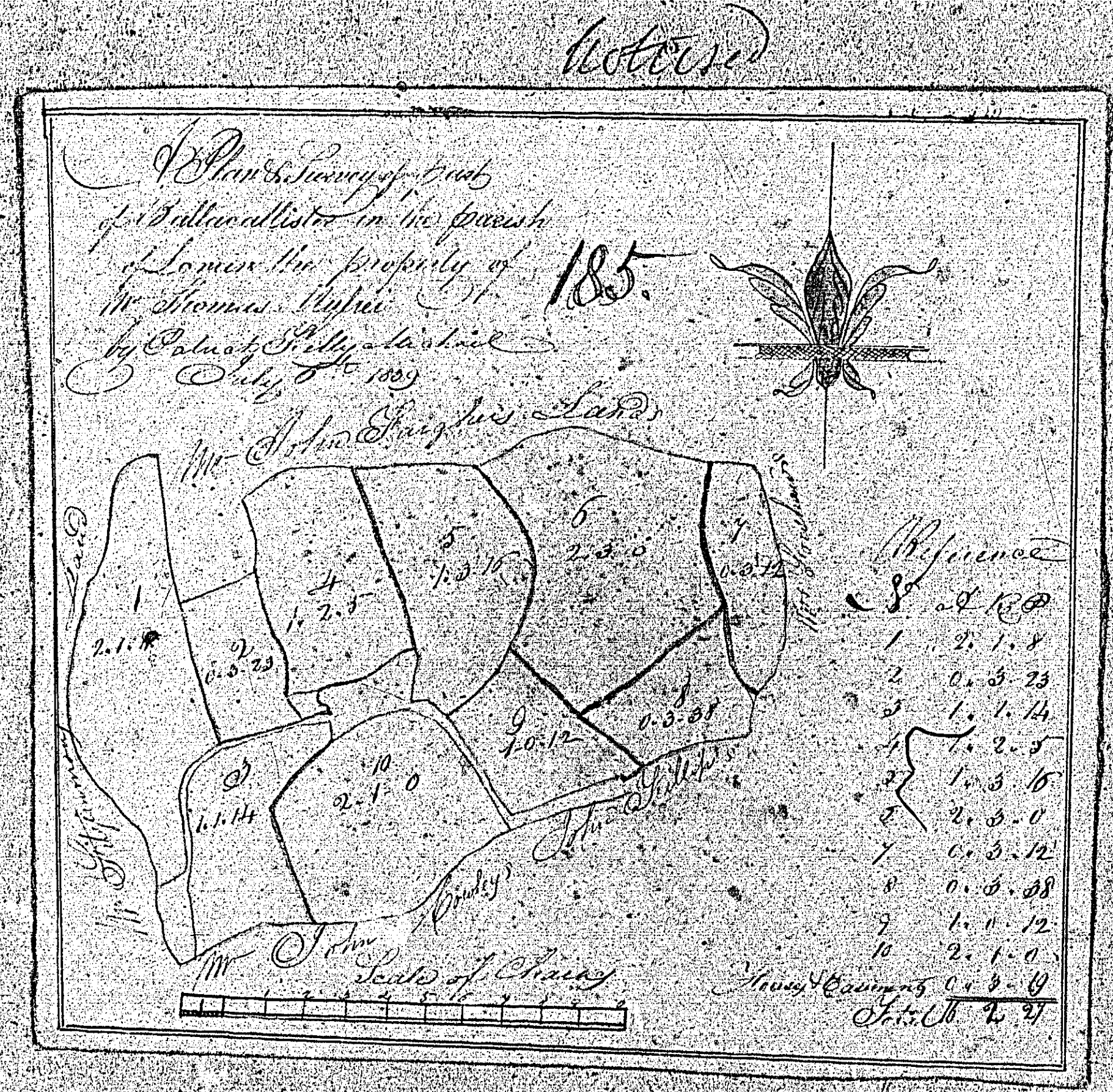

*Reference*  
*1700*  
*1 2.1.14*  
*2 0.5.08*  
*3 1.2.5*  
*4 7.3.16*  
*5 2.3.0*  
*6 1.2.5*  
*7 9.0.12*  
*8 0.5.08*  
*9 1.1.14*  
*10 2.1.0*  
*11 0.5.08*  
*12 1.1.12*  
*13 2.1.0*  
*John Black*  
*July 185*



186.  
 A Plan & Survey of a part  
 of Ballakilly in the Parish of  
 Lona, the property of Mr Thomas McClellan  
 by Patrick Kelly Michael  
 July 20 1867

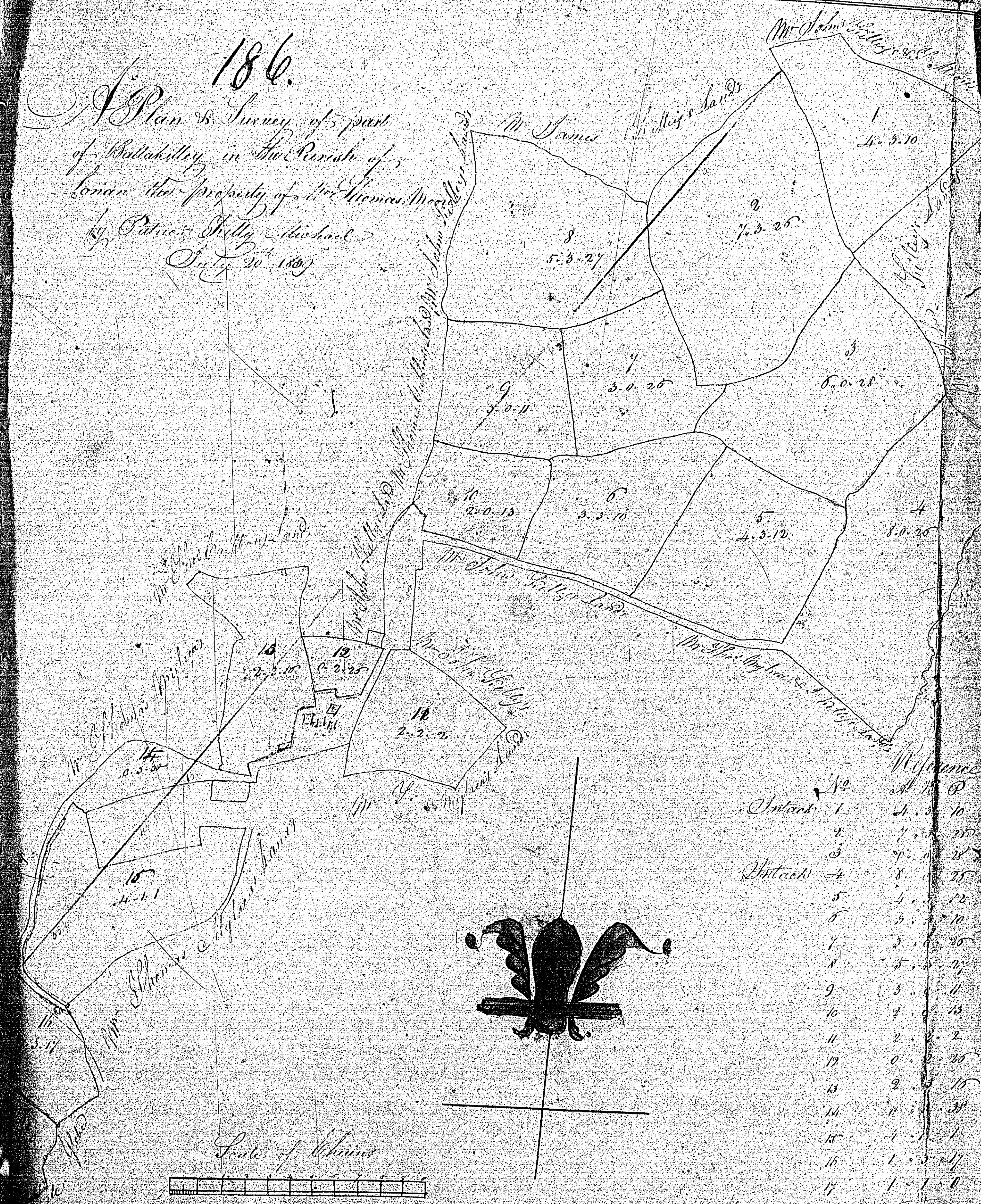

Plot No.	Reference
1	4.3.10
2	7.3.25
3	7.10.24
4	8.0.25
5	4.3.12
6	3.3.10
7	3.0.25
8	5.3.27
9	3.0.11
10	2.0.13
11	2.0.2
12	0.0.25
13	2.0.15
14	1.0.27
15	1.0.1
16	1.0.27
17	1.0.0
18	2.2.2
House & Outbuildings	1.0.15
Road	1.0.1
Great Meadow	66.0.31

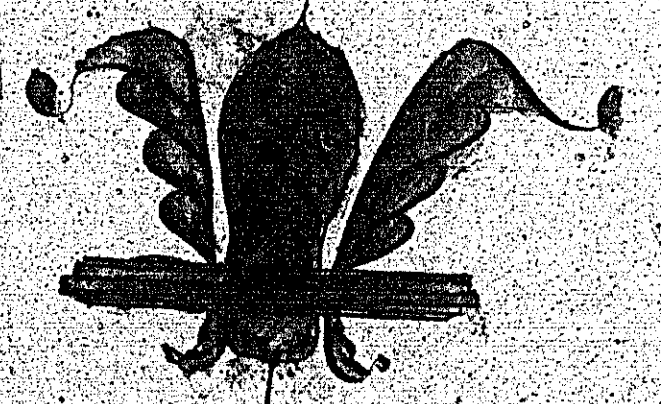
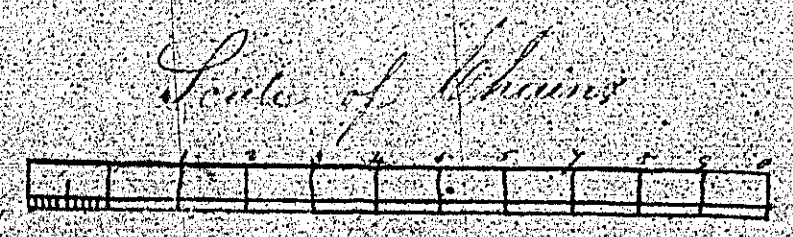



The two following plans are  
both numbered 187



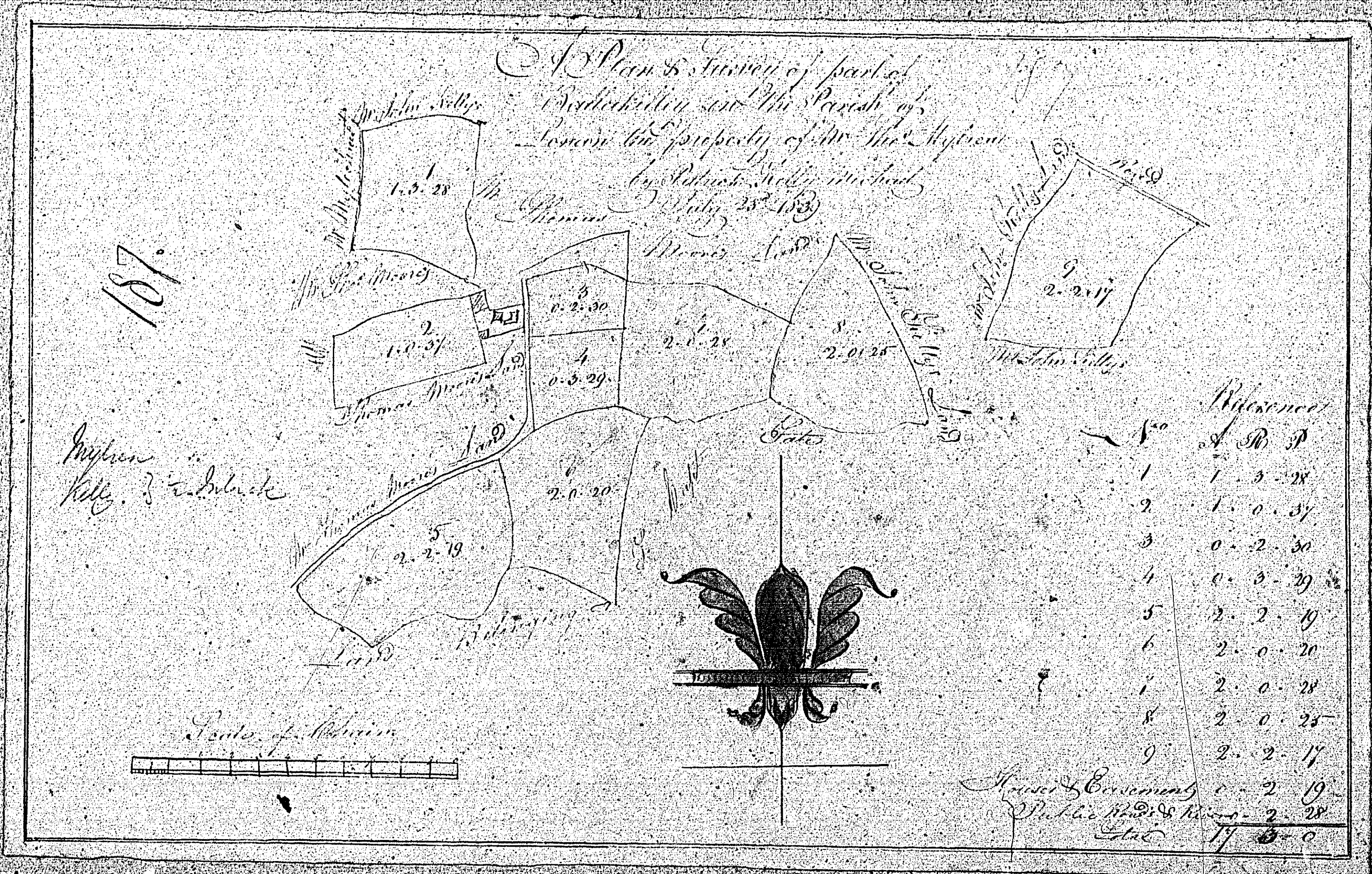

ISLE OF MAN GOVERNMENT: GENERAL REGISTRY

TITHE PLANS: PARISH OF LONAN

Original coloured (decorative)

1:30