

No. 130
 A Plan & Survey of
 Part of the Township of
 Lower Canada
 by John Hickey
 July 10th 1839

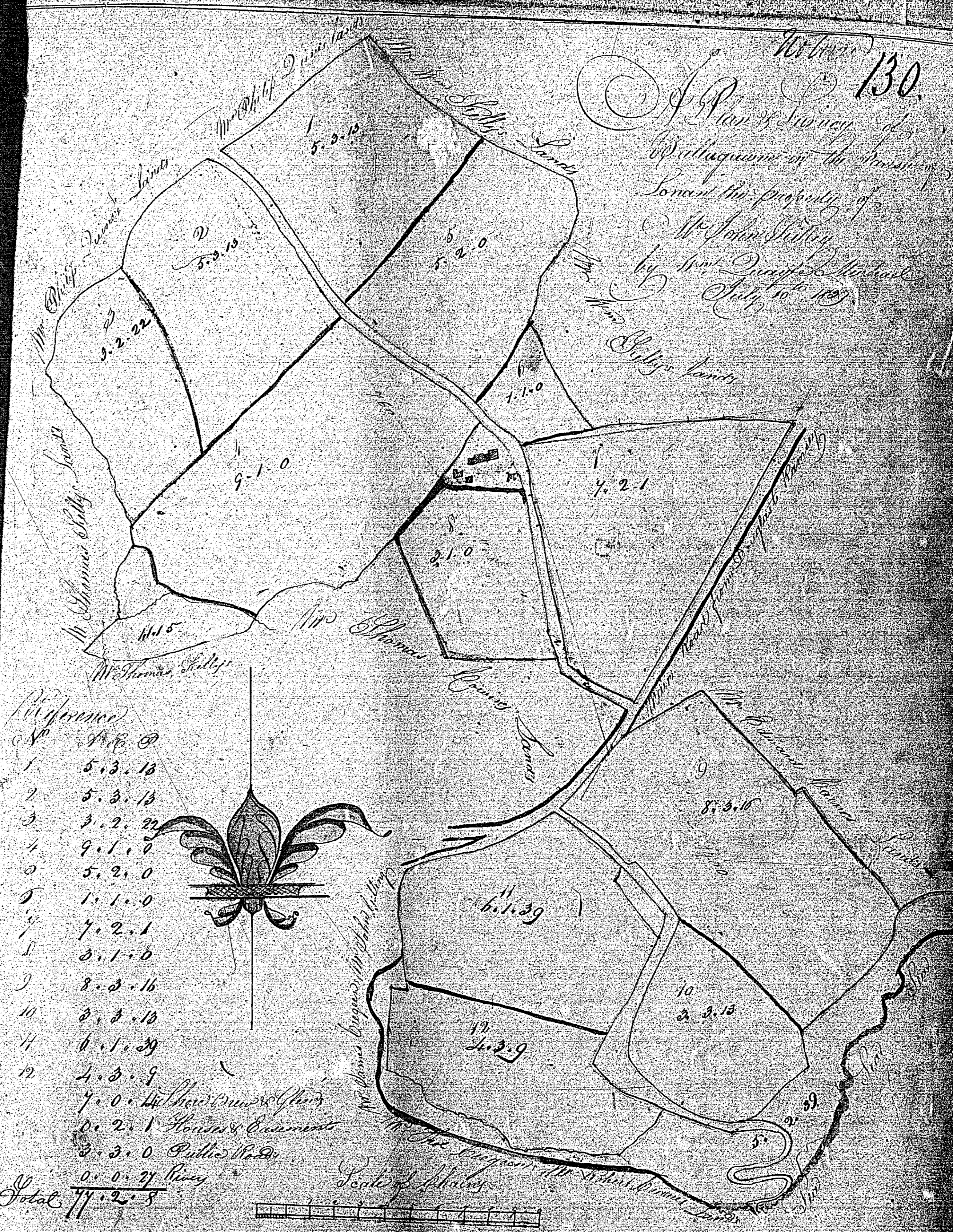

Reference

No	4.8.0
1	5.3.18
2	5.3.18
3	3.2.22
4	9.1.0
5	5.2.0
6	1.1.0
7	7.2.1
8	3.1.0
9	8.2.16
10	2.3.13
11	4.1.29
12	4.2.9
	7.0.0
	0.2.1
	3.3.0
	0.0.27
Total	77.2.8

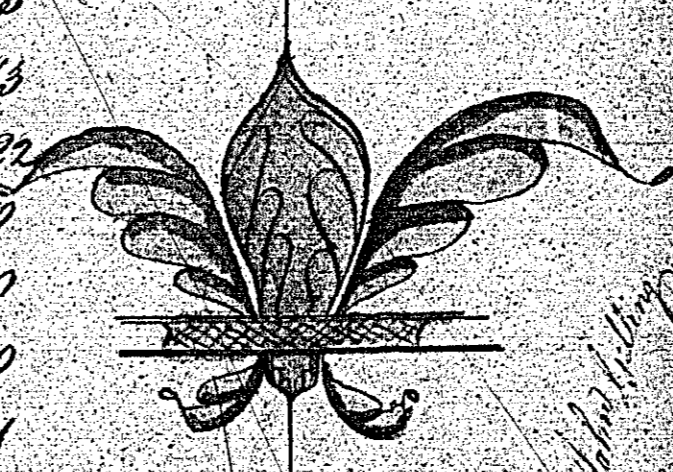

132

Survey
of the estate of
Franklin
Rich known
the property of
Mr John Kinnell

By
G. Cowley



132

	Acres	Rods	Faths
1	6	2	1
2	4	1	8
3	2	2	9
4	3	3	10
5	4	1	22
6	5	0	2
7	6	0	24
8	3	0	35
9	3	0	4
10	3	2	11
11	1	1	3
12	1	3	1
13	2	2	5
14	12	3	
15	1	1	1
16	0	1	1
Total	4		
	64		
	63		

1	0.2.1	8	1.0.0.20
2	0.2.1	8	1.0.0.20
3	0.2.1	8	1.0.0.20
4	0.2.1	8	1.0.0.20
5	0.2.1	8	1.0.0.20
6	0.2.1	8	1.0.0.20
7	0.2.1	8	1.0.0.20
8	0.2.1	8	1.0.0.20
9	0.2.1	8	1.0.0.20
10	0.2.1	8	1.0.0.20
11	0.2.1	8	1.0.0.20
12	0.2.1	8	1.0.0.20
13	0.2.1	8	1.0.0.20
14	0.2.1	8	1.0.0.20
15	0.2.1	8	1.0.0.20
16	0.2.1	8	1.0.0.20
17	0.2.1	8	1.0.0.20
18	0.2.1	8	1.0.0.20
19	0.2.1	8	1.0.0.20
20	0.2.1	8	1.0.0.20

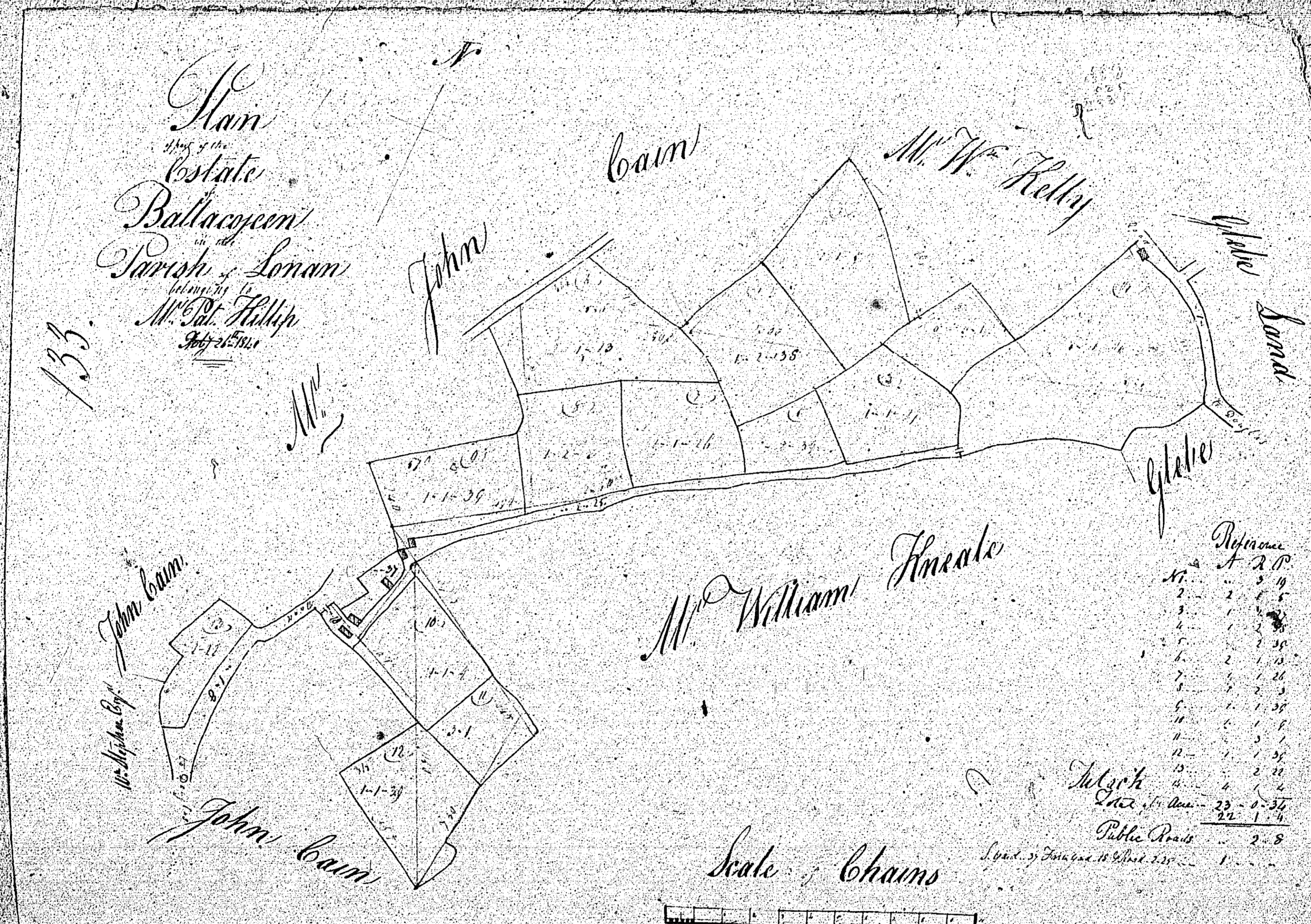

ISLE OF MAN GOVERNMENT: GENERAL REGISTRY
 TITHE PLANS: PARISH OF LONAN
 Original coloured (decorative) 1:30

2.2.26

134.

A Plan & Survey of
Ballacrygan in the Parish of
St. Leger in the County of
Wexford the property of
Mr. John Sillie
by James Douglas Mackenzie
July 30th 1839

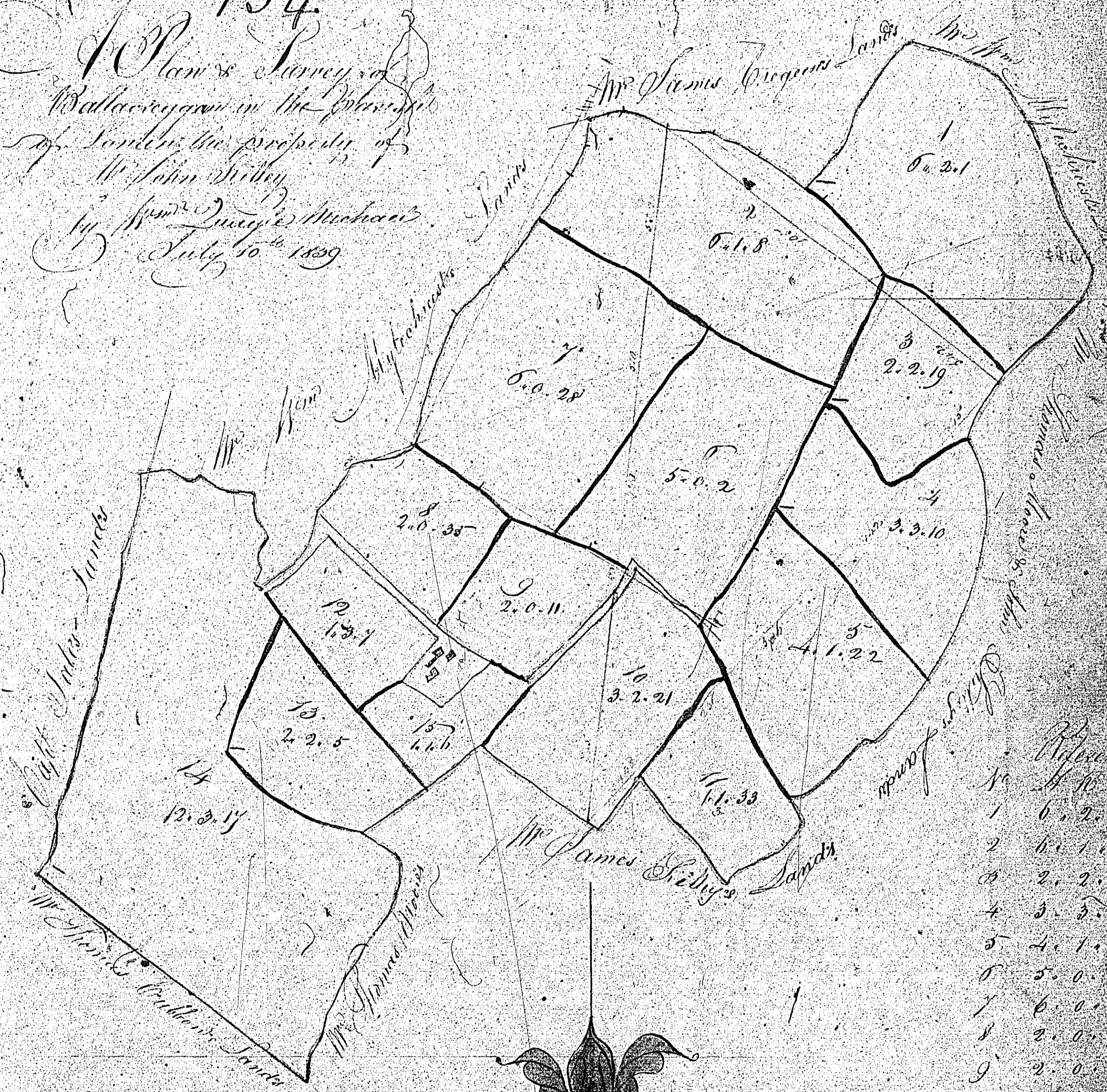

No.	Acres	Roods	Furlongs
1	6	2	1
2	6	1	8
3	2	2	19
4	3	3	10
5	4	1	22
6	5	0	2
7	6	0	28
8	2	0	35
9	2	0	11
10	3	2	21
11	1	1	14
12	1	3	1
13	2	2	3
14	12	0	14
15	1	1	1

Scale of Chains

James Douglas Mackenzie
Public Surveyor
St. Leger, Wexford
63

