

Noted

A Plan and Survey of
A part of Cleevehampton
in the parish of Lincrore
the property of John Pearce
taken Feb 5th 1859
By Thos. Hemmick

316.

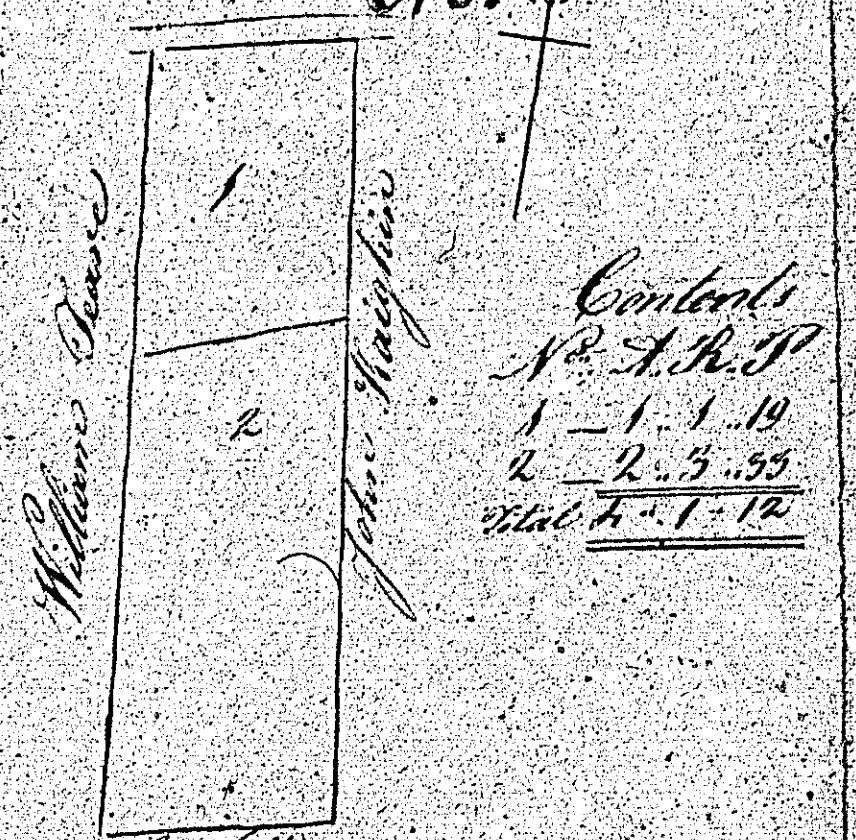

Controls
N^o 1. 1. 19
2. 2. 3. 55
Total 4. 1. 12

Attest
A scale of 5 Christian Inchs

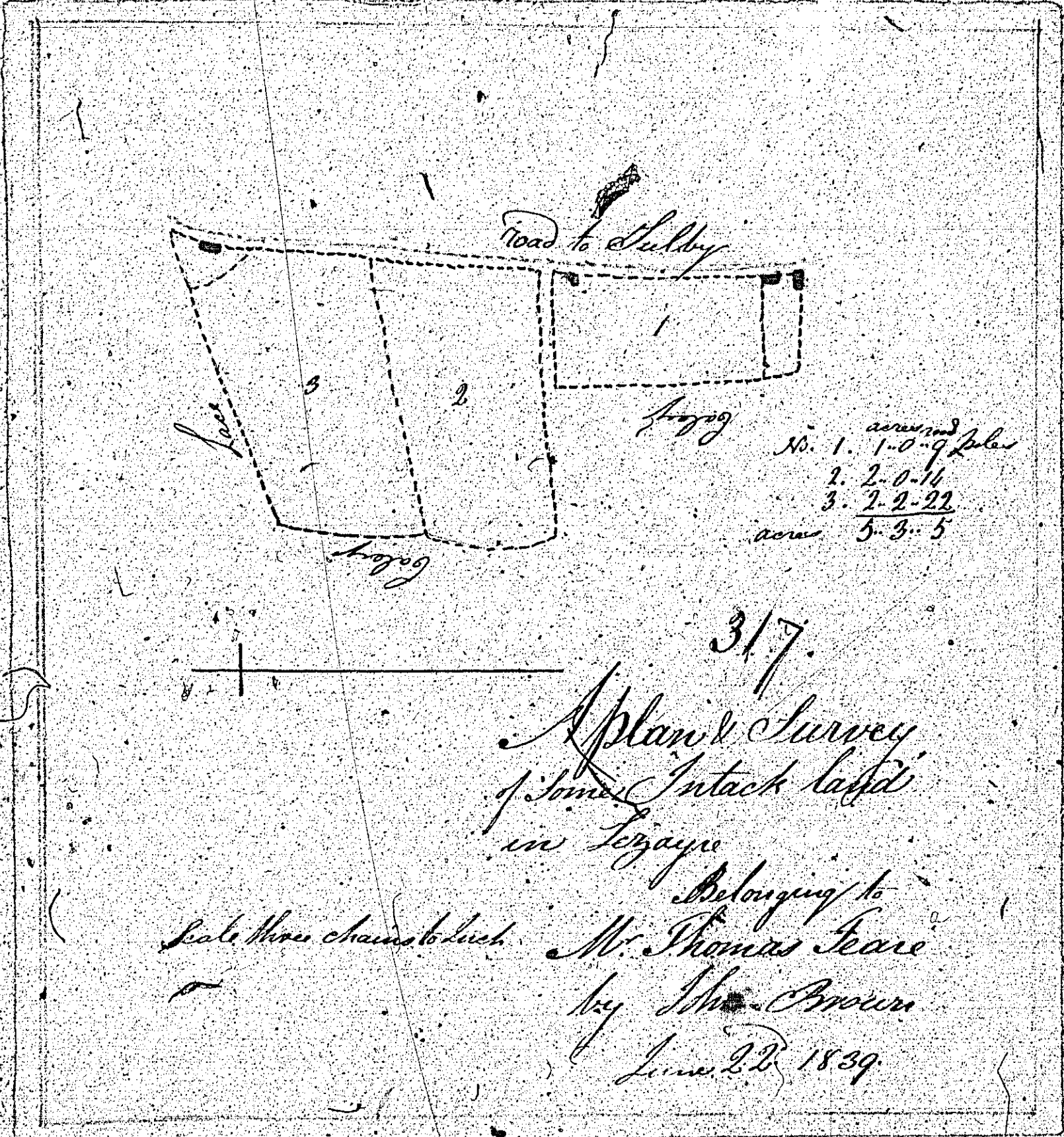

317.

*A plan & Survey
of some Intack lands
in Legaye*

*Belonging to
M^r. Thomas Seare
by John Brown
June 22^d 1839*

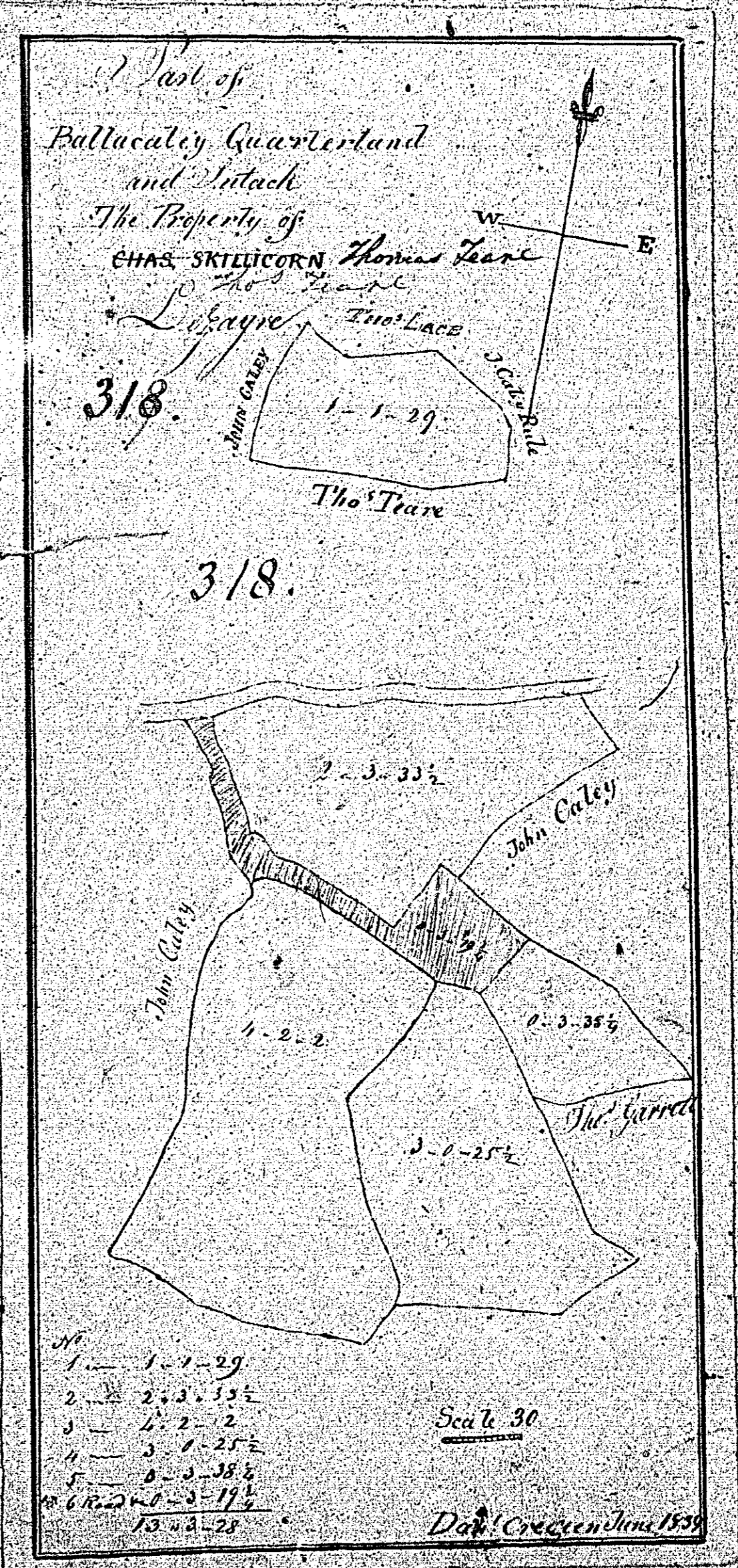

Map and Survey of meadow the property of
Daniel Star of Windsor part of No. 1000 taken
by John Sibley June 1839.

319.



John Williams
Land

John Star
Land

Scale of one Chain to an Inch

The W. Rev. John G. ...

Witnessed

320 320

Map and Survey of a part of
Ball's bank in the parish of ...
the property of Philip ...

N. ... line



S. ... line

Scale of 1 chain to an Inch
J. ...

Noticed
321.

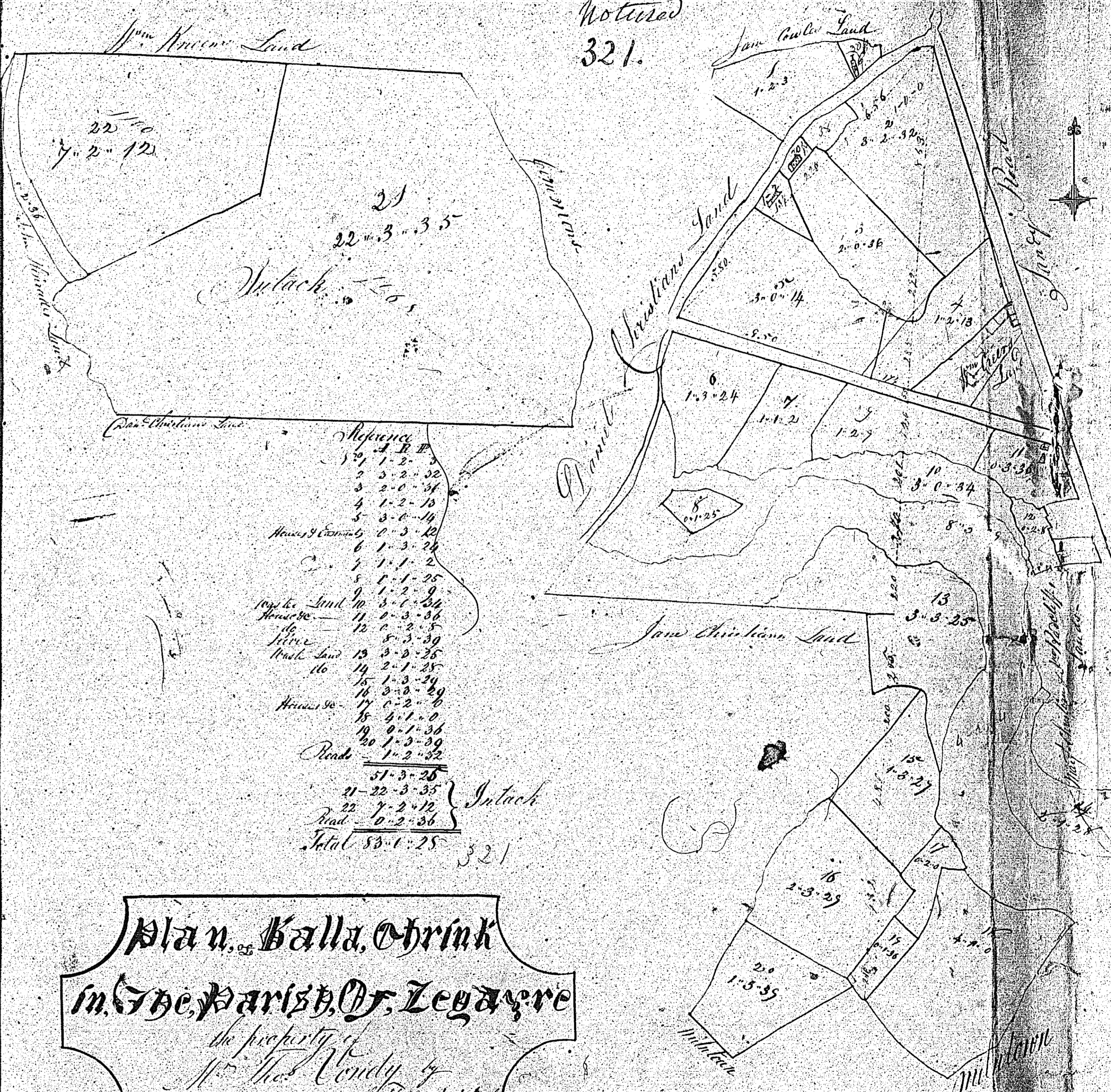

22-1-10
7-2-12

21
22-3-35
Intack

Reference	Measure
1	1-2-3
2	3-2-30
3	2-0-34
4	1-2-10
5	3-0-14
6	1-3-20
7	1-1-2
8	1-1-25
9	1-1-24
10	1-2-30
11	1-2-5
12	5-3-30
13	3-0-35
14	2-1-25
15	1-3-24
16	3-0-29
17	0-2-6
18	4-1-0
19	0-1-36
20	1-3-39
21	1-2-32
22	51-3-25
23	21-22-3-35
24	7-2-12
25	0-2-36
Total	58-1-25

Plan of Balla Chrink
in the Parish of Legare
the property of
Mrs. Thos. Condy by
Blair & Co. Surveyors
May 26th 1809

Scale Chains to an inch