

Notice

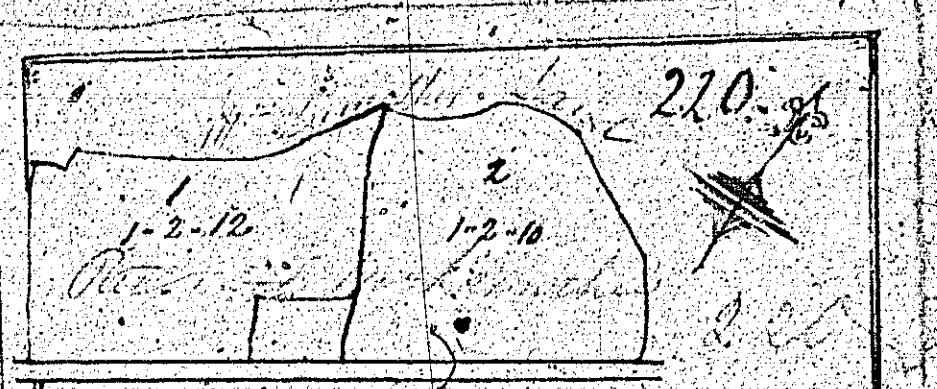

Map of the Coast of the Bay of Islands 220.

1-2-10 1-2-10

Rungeat low tide

Low tide by 1/2 p.m.

Water depth 1.5-16

May 15 1859

John W. Johnson

1-2-10

1-3-10

1-4-10

1-5-10

1-6-10

1-7-10

1-8-10

1-9-10

1-10-10

1-11-10

1-12-10

1-13-10

1-14-10

1-15-10

1-16-10

1-17-10

1-18-10

1-19-10

1-20-10

1-21-10

1-22-10

1-23-10

1-24-10

1-25-10

1-26-10

1-27-10

1-28-10

1-29-10

1-30-10

Notar

*A Plan and survey of a
part of Clostrayle in the
parish of Lezayre the
party of Thomas Rogers
taken July 24th 1869
by Abner Tompkins*

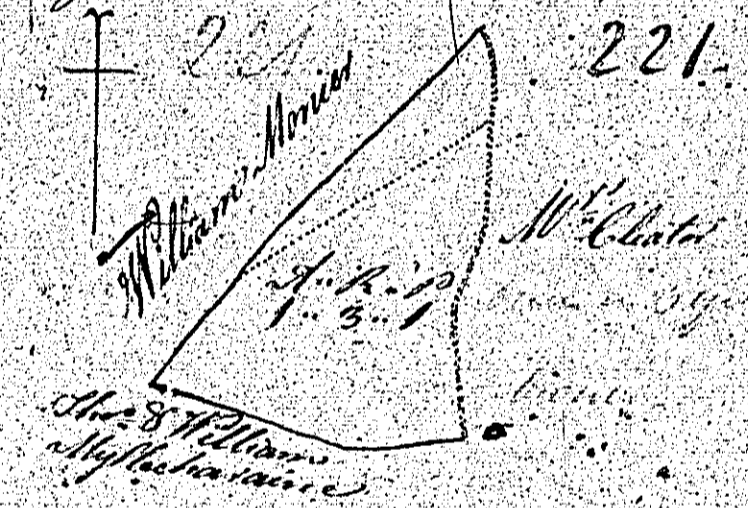

A scale of 5 Chaires to an Inch

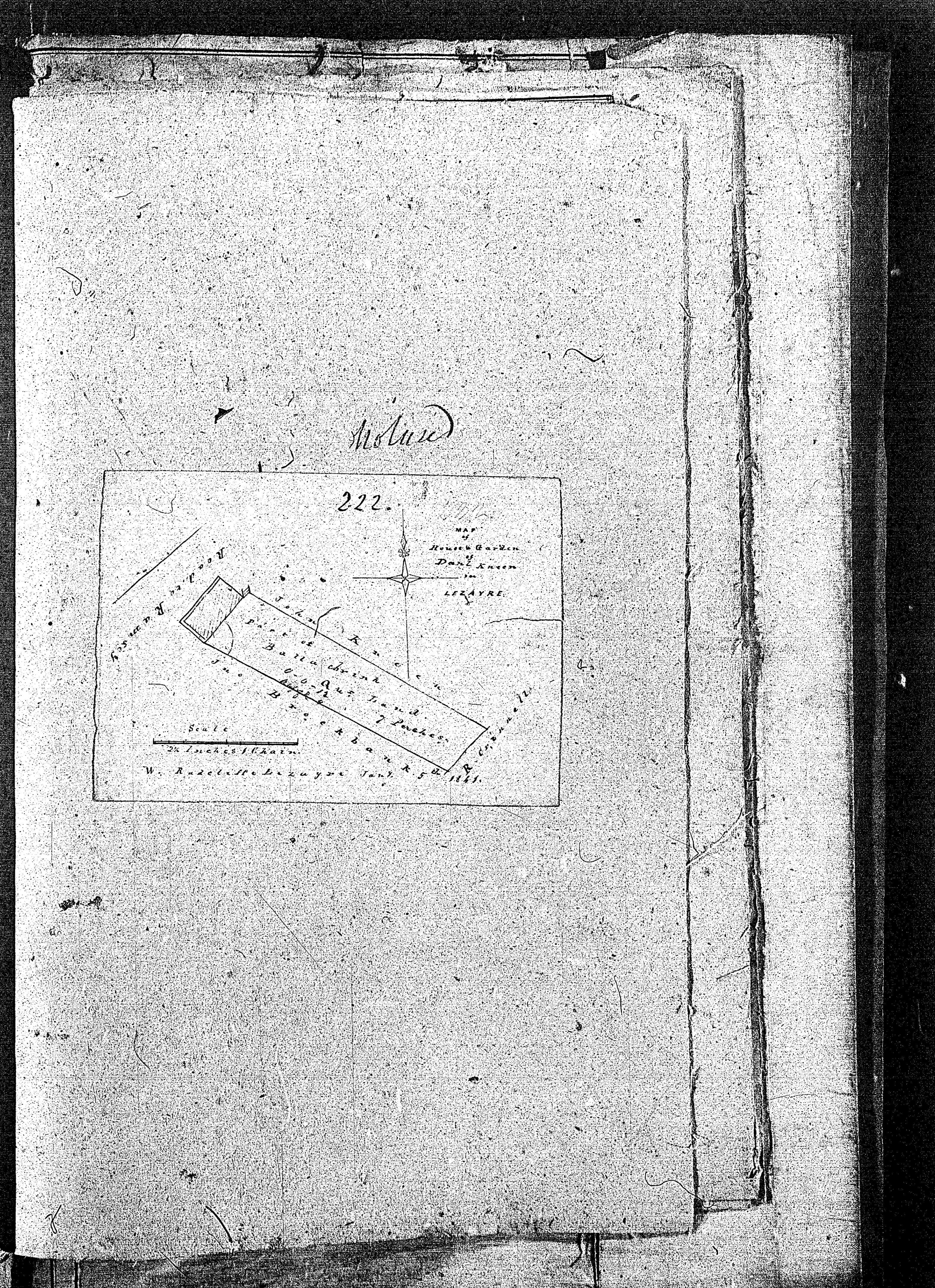

In Forest
indicated

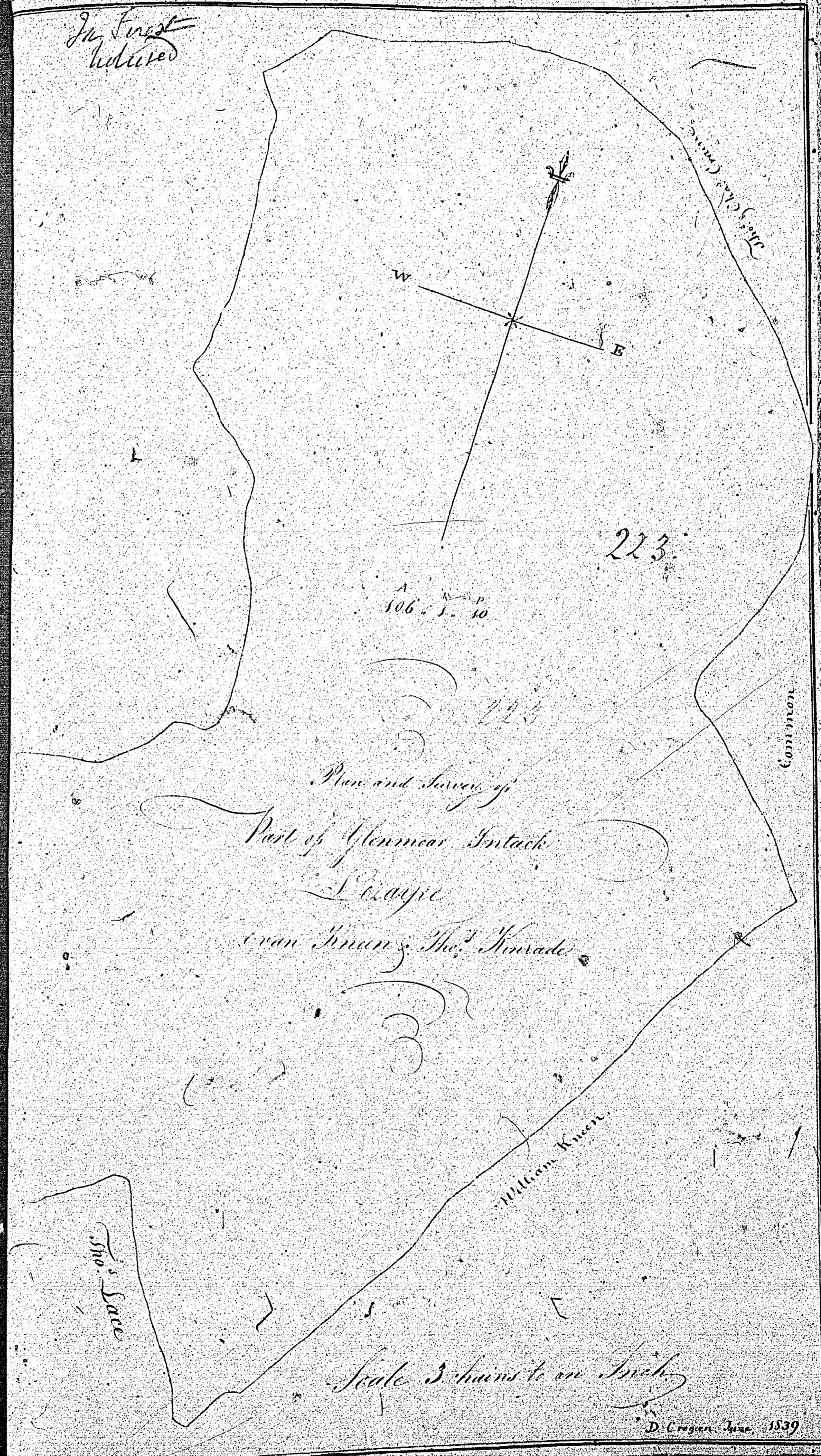

Plan and Survey of

Part of Glenmear, Lintack,

Co. Wick,

Ireland, by Thos. Knerr

Scale 3 chains to an Inch

D. Croghan, June 1839

Noticed

