

135.

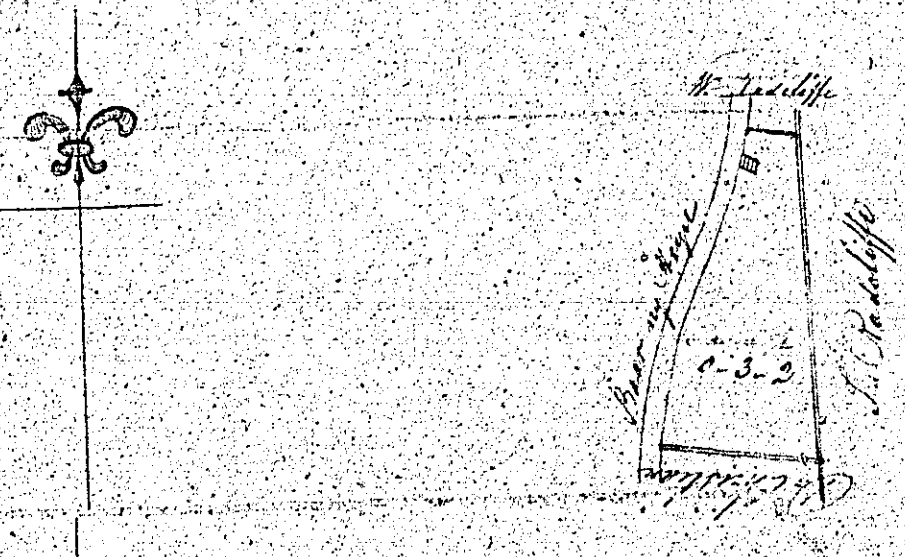

Recd of an Inlet
 in the hands of
 the Property of
 Mr. J. Smith
 of London
 25 June 1834
 John Smith

Contents
 2 - 5 - 4
 1 - 5 - 10
 1 - 5 - 10
 1 - 5 - 10

John Smith to an end

Noted

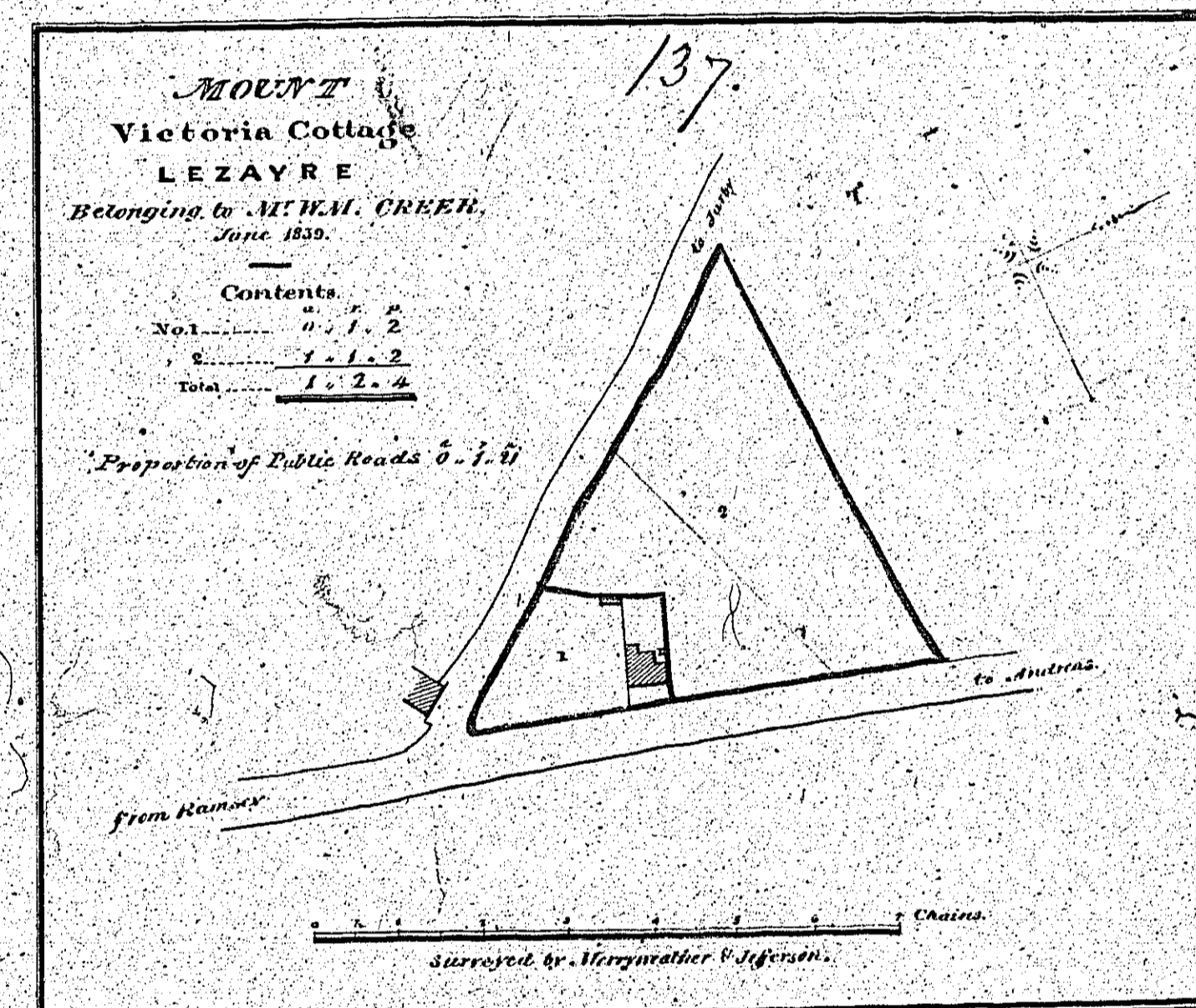

1-2-4
2-1-2
3-3-4
2-1-2
1-2-4

W. 138

138

138

Plan of a parcel of
lands
in the Parishes of
Andreas & Scaur
the property of
Mrs. C. Brellen

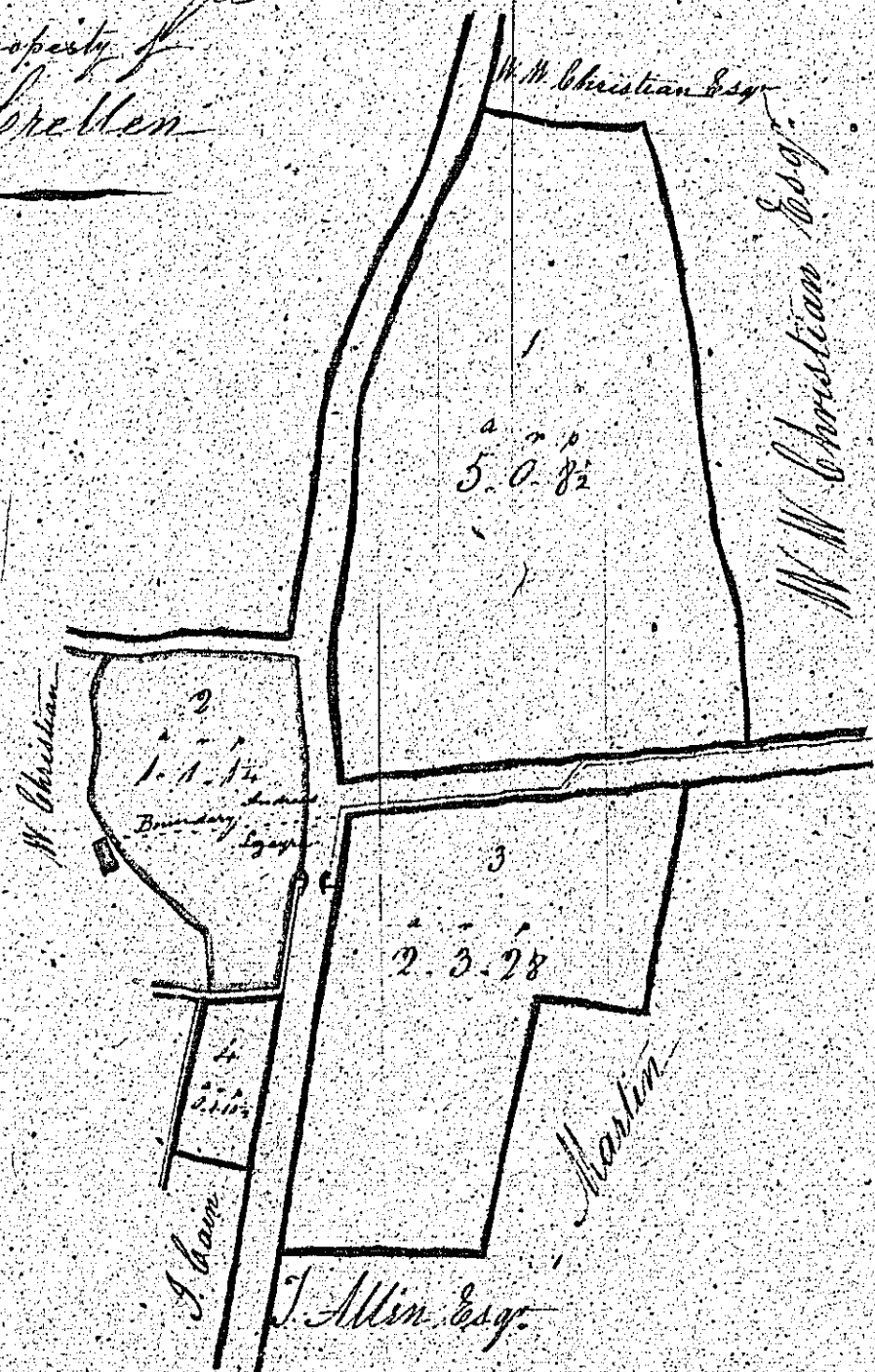
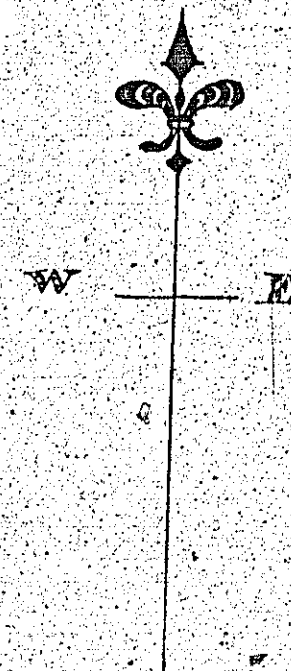

Contents
Fields 9. 2. 82
Bosch 0. 5. 39
Totals 10. 7. 12

Scale of 3 chains
to one Inch

J. Bowell Surveyor
1839

bound
1 of
2

139.

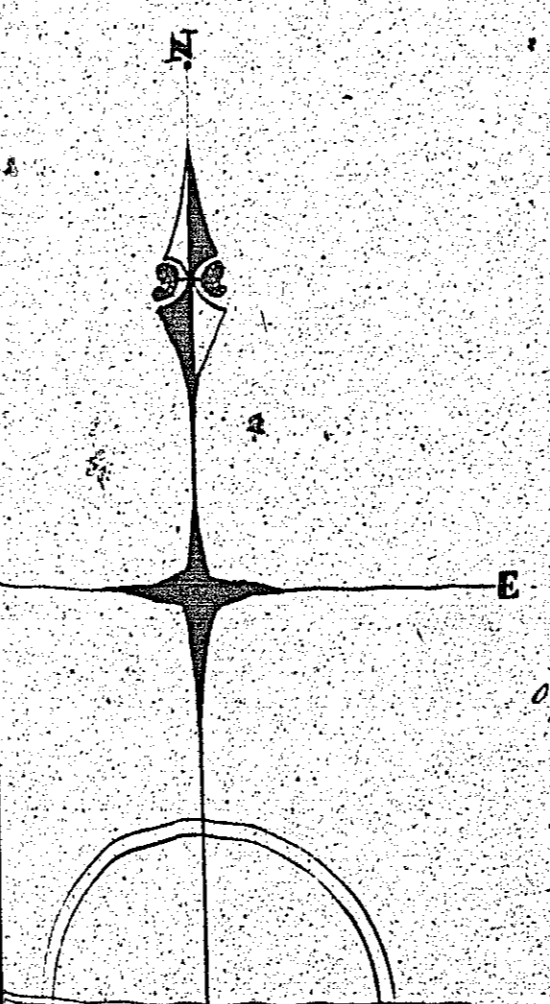

Contents	a	r	b
1 House & garden	0	3	33
2	5	0	4
3	2	3	28
4	1	1	30
5	0	3	12
6	2	1	28
7	2	0	7
8	0	1	38
9	1	3	35
10	1	1	26
Total	27	2	38

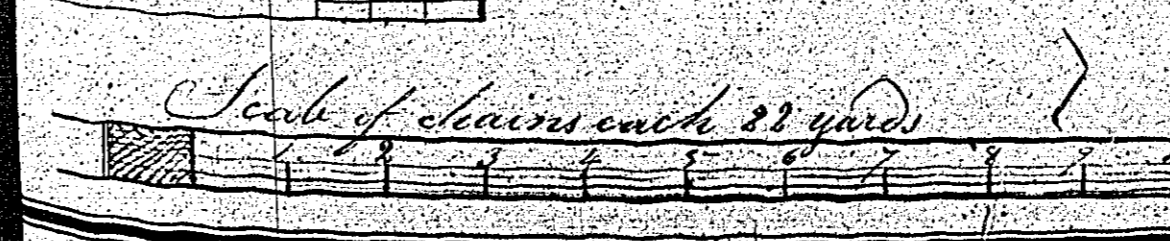

MAP
 and **Survey** of
 part of **Parlaghteragh Quarterland**
 Situate in the parish of
L. C. T. & P. E.
 the property of
Mr. Patrick Crizzall
 by **Thomas Cairnes Junr 1839**

Not used

140
Part of Mullachink in the
Parish of Saggart Belonging to
Robert Crommel
Surveyed 27th June 1839
by John H. Powell

1	0	1	22
2	0	0	18
3	0	0	13
4	1	1	36
5	0	0	10
6	1	3	24
7	1	1	38
8	5	1	24
Total	10	3	13

Proportion of road 0.0.20

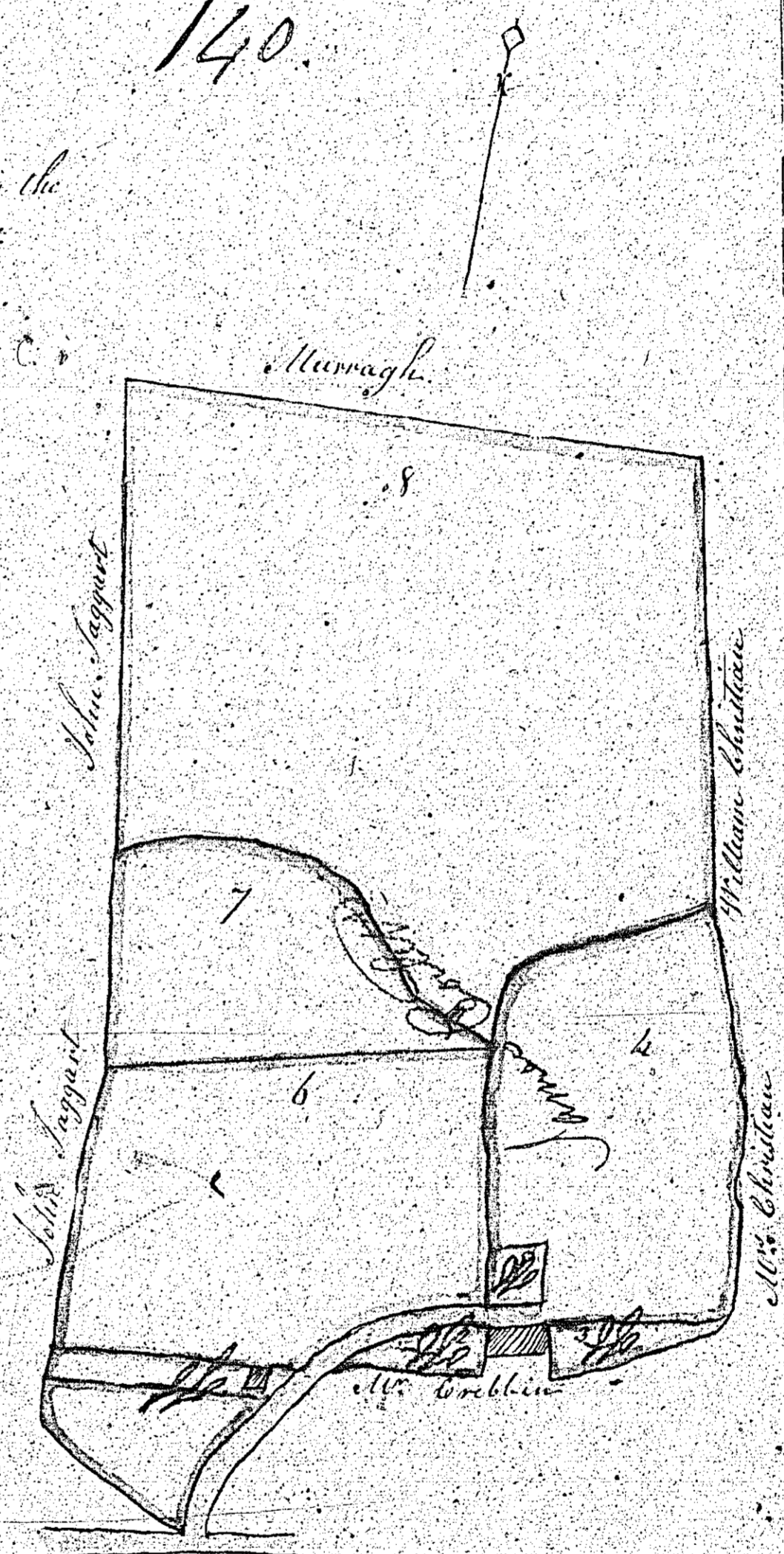

Scale of Chains