

100000

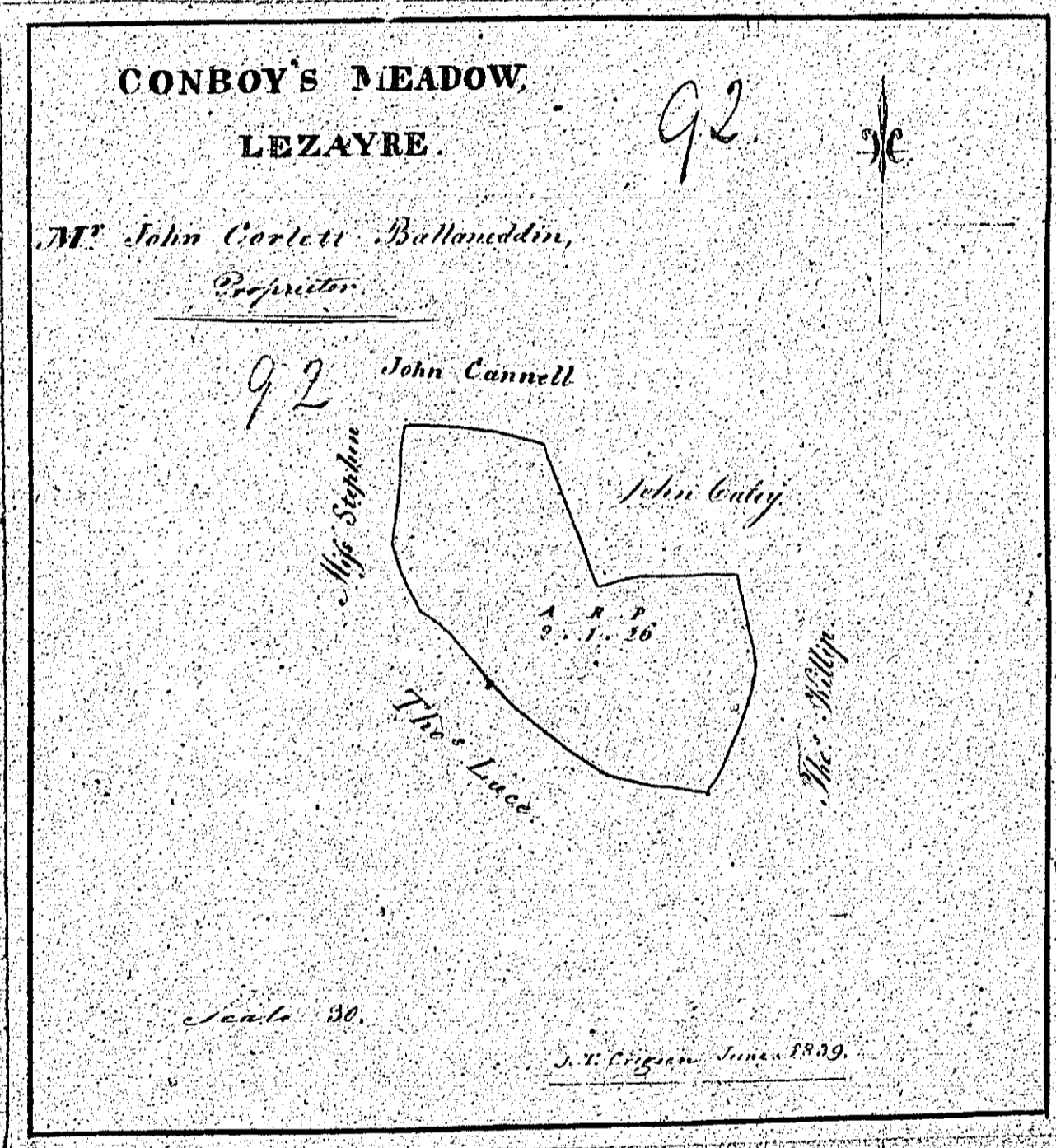

*A Plan and survey of A part
of Clove Lough in the parish
of Lough the property of John
Cottell taken July 8th 1839
By John Hermisk*

John Wade

*Mary Wynn J. R. P.
5. 2. 35*

John Cobitt

Mr. C. C. C.

William Kelly

James Lane Post of Mullagh

A scale of 3 chains to an inch

Not used

1. Plan and survey of the
the House and garden
the property of William Child
and also of the House
and garden adjoin the same
the property of Mrs Child
by Wm. Young July 12 1809



94.

		sq	R	P
1	Wm Child's			
	garden			38
	House			7
	Garden & House			30
2				
3	Mrs Child's			1
	garden			7



Noticed

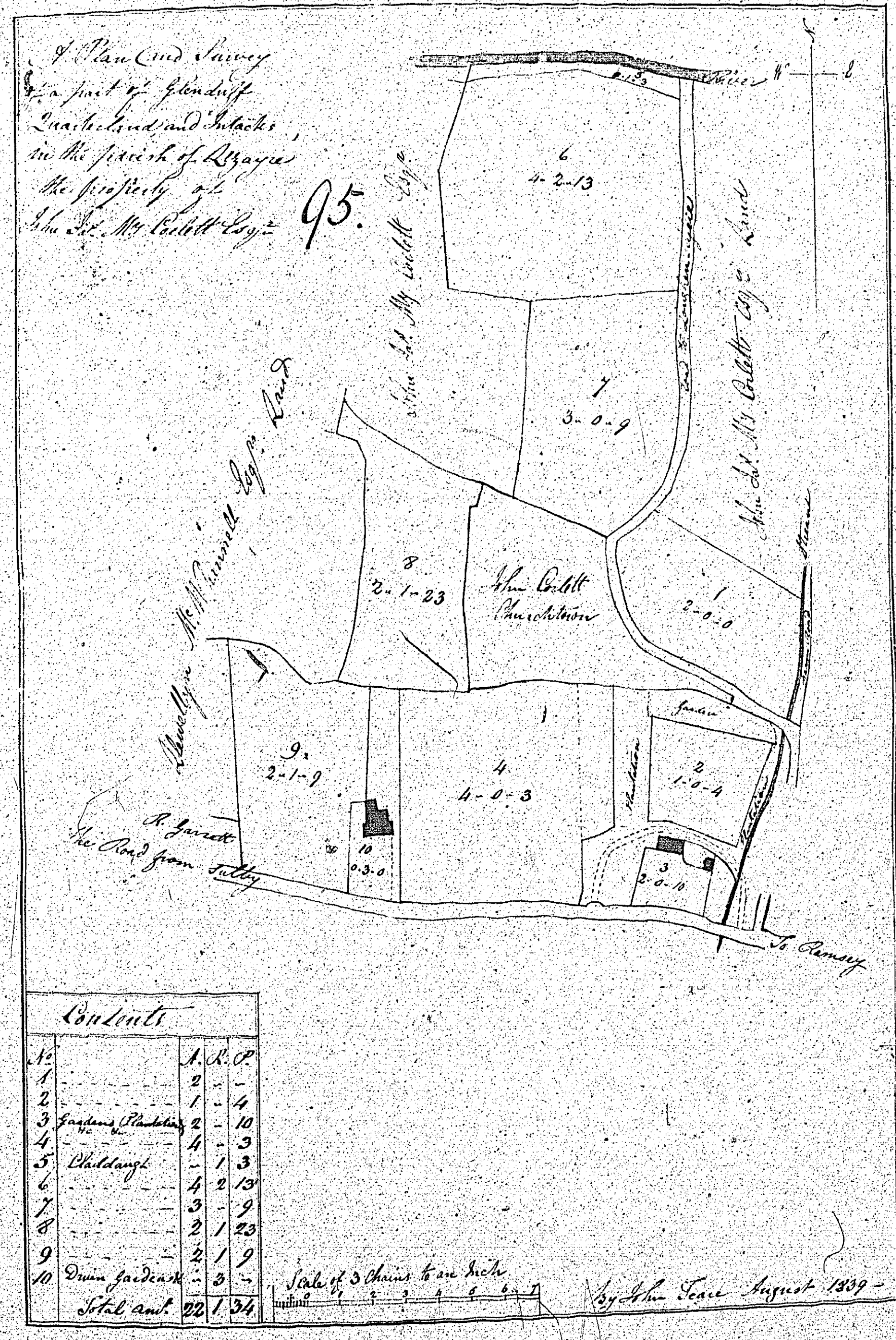

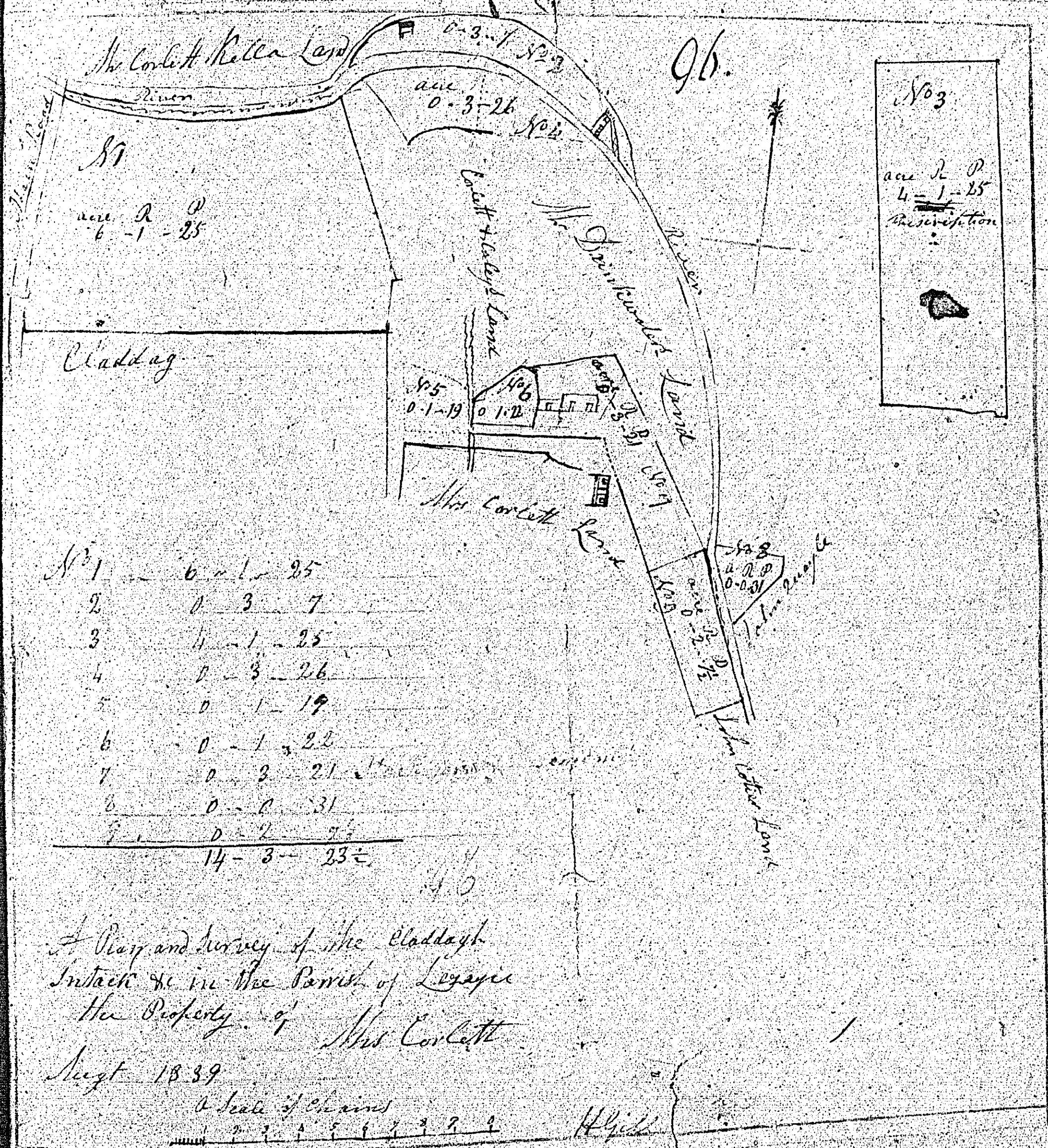

The Corlett River Land

96.

89
acre R. P.
6-1-25

103
acre R. P.
4-1-25
Description

Claddagh

1	6-1-25
2	0-3-7
3	4-1-25
4	0-3-26
5	0-1-19
6	0-1-22
7	0-2-21
8	0-0-31
9	0-2-7
14-3-23	

A Plan and Survey of the Claddagh
Situate in the Parish of Liscappin
The Property of Mrs Corlett
Sept 1839

A Scale of Chains
1 2 3 4 5 6 7 8 9 10

H. Hill