

Plan of Thomas Quayles Property July 84.

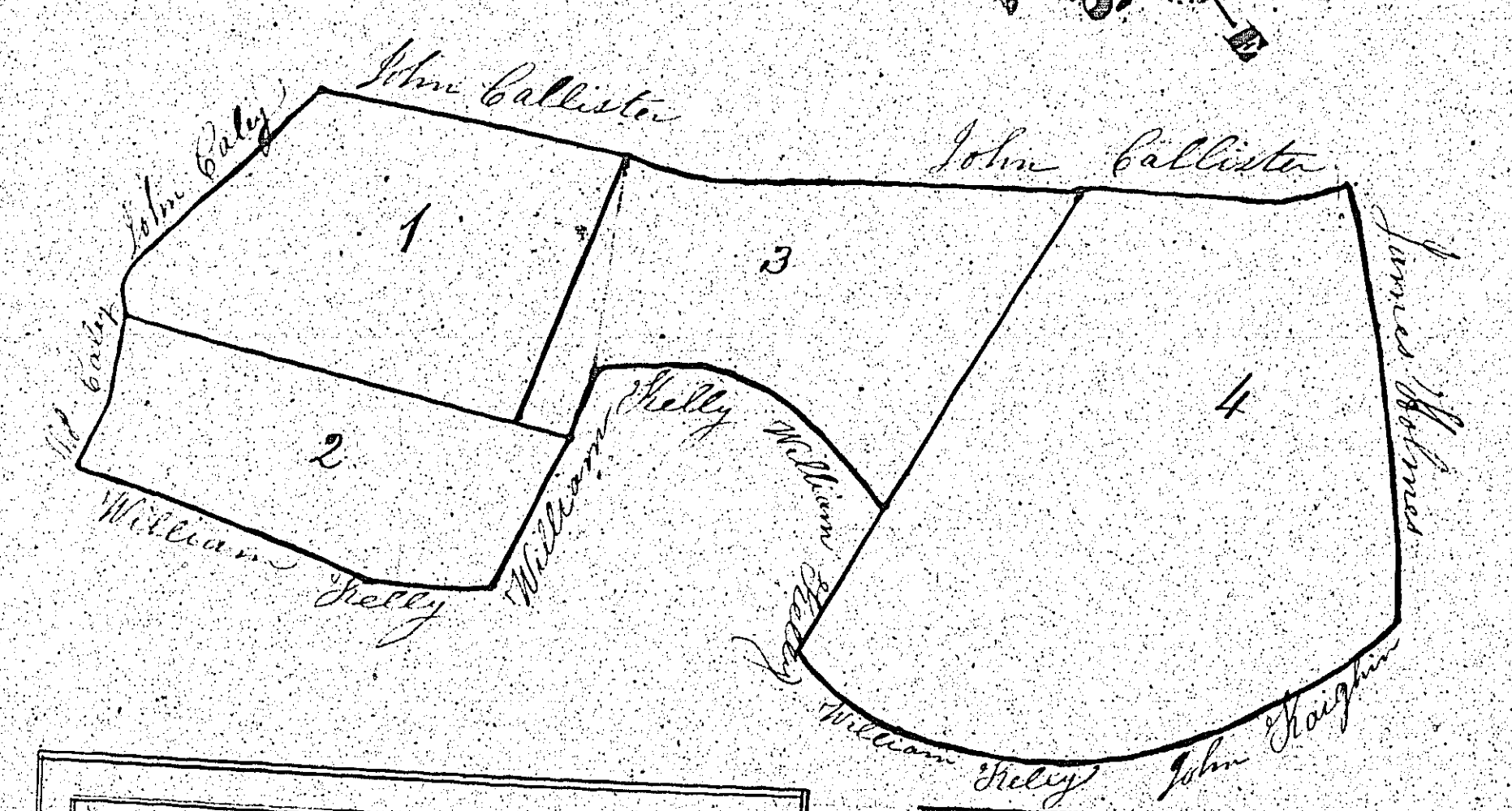

A Plan and Survey of a Parcel of Land Called Cross-Croft being of no Quarterland but all Situate in the Parish of Jucly the Property of Thomas Quayle

References

	A	R	P
No. 1	1	1	16
No. 2	1	0	9
No. 3	1	1	34
No. 4	3	2	11
Acres	7	1	30

This property has been surveyed twice to have the work more correct and the Calculations thereof is made up by Logarithms by Samuel Kelly October 10th 1840



ANCES

R	P
2	35
1	22
0	20
2	6
2	1
3	35
2	29
1	38
1	1
0	30
5	17
1	38
1	15

Samuel Kelly is Surveyor and the work is made by Logarithms July 18th 1840

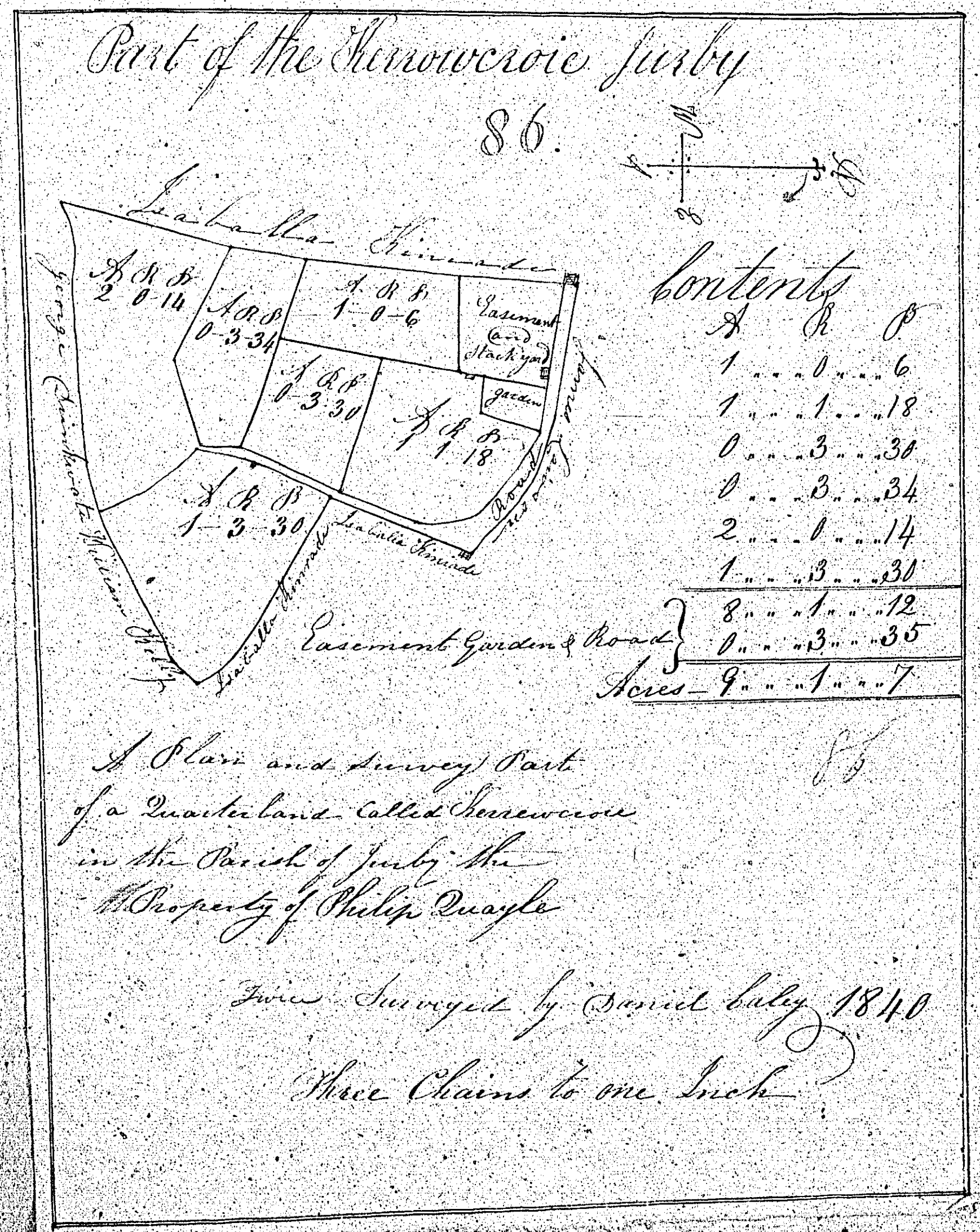
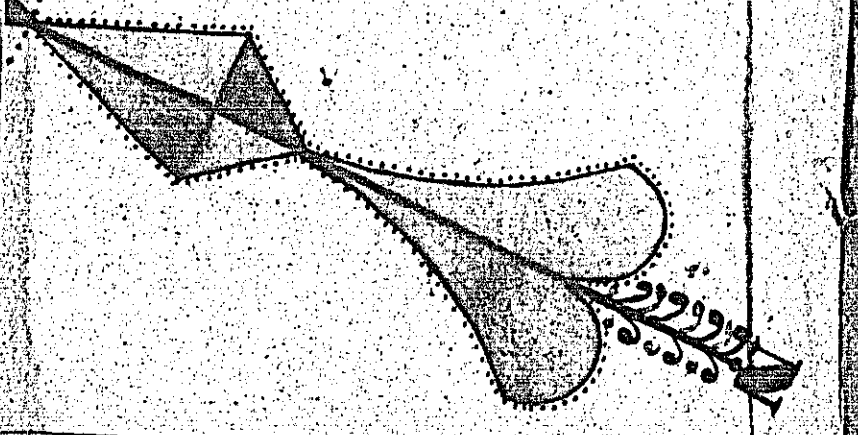

ANCES

A	B	P
2	0	35
1	0	22
0	0	20
2	0	6
2	0	1
3	0	30
2	0	29
1	0	38
1	0	1
0	0	30
3	0	17
1	0	38
1	0	15

*Daniel Saly is Surveyor
work correct and the
is made by Logarithms
Juby East Schoolmaster
18-1840*

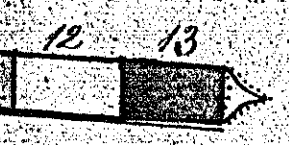

A Plan and Survey of a part of
the Quarterland of Henricraile and a
parcel of land called Black Bayle in
the parish of Stuby the property of
William Quay taken September 28. 1840
by Daniel Taylor

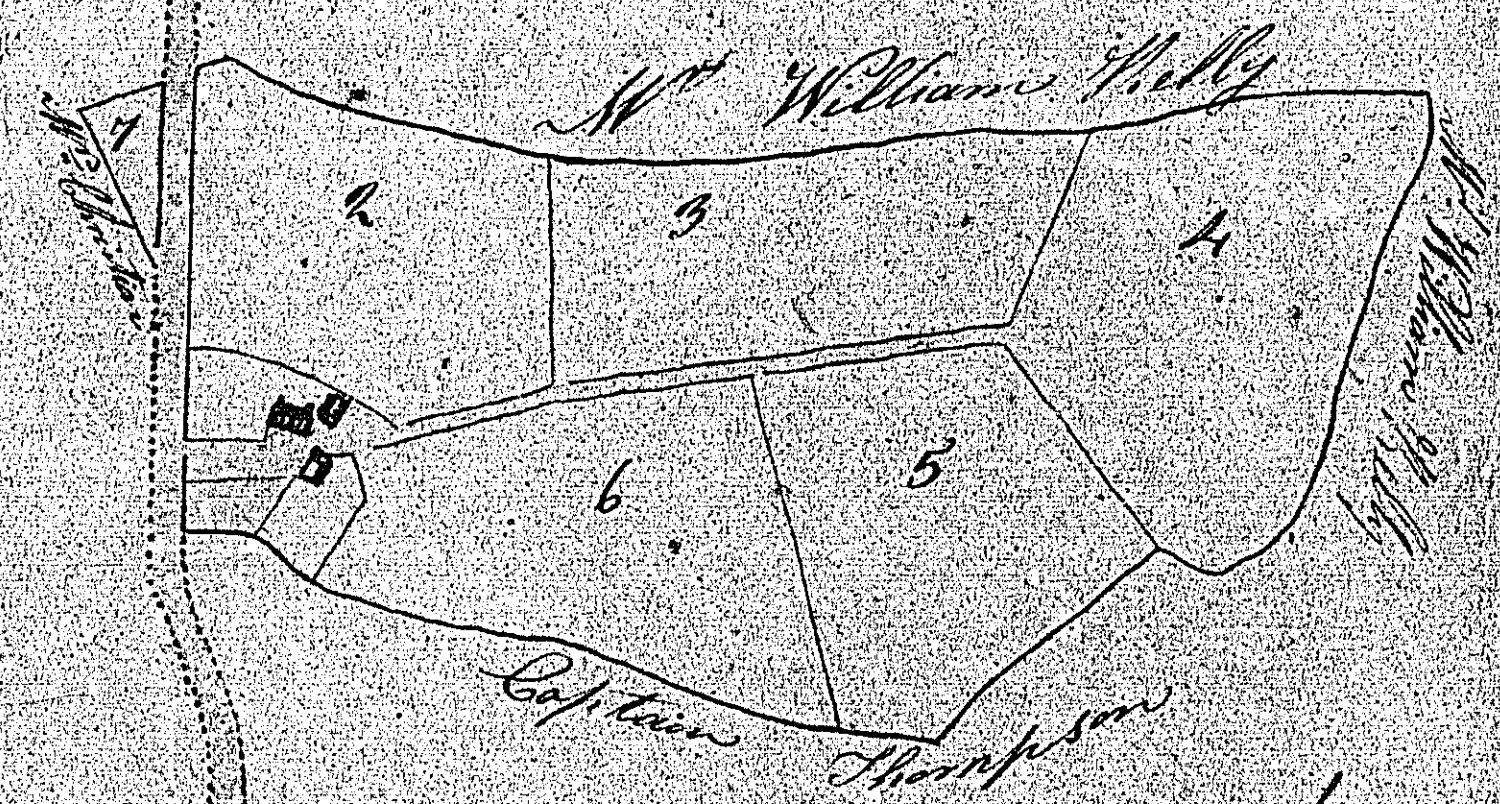
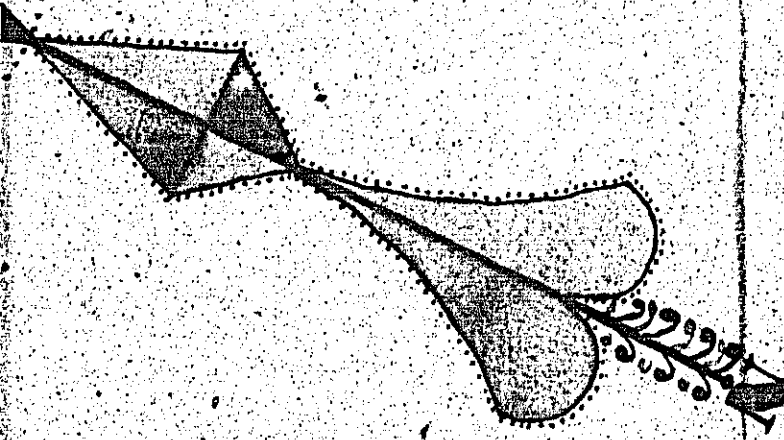

ANCES

R	P
2	35
1	22
0	20
2	6
2	1
3	35
2	29
1	38
1	1
0	30
3	77
1	38
1	15

Contents

No.	Ac.	R.	P.
1	1	1	15
2	4	1	11
3	2	1	35
4	4	3	25
5	2	1	17
6	2	2	8
7	0	0	27
Head garden & Enclosure	0	4	36
8	1	0	9
9	2	1	35
10	2	2	9
Total	21	0	21

Daniel Taylor is Surveyor
work correct and the
lies made by Legation
Stuby East Schoolmaster
Decr 18. 1840

A scale of 3 chains to an inch

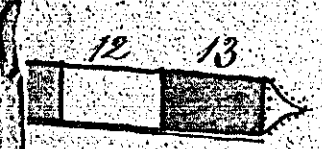

86
87
88
89
90
91
92
93
94
95
96
97
98
99
100

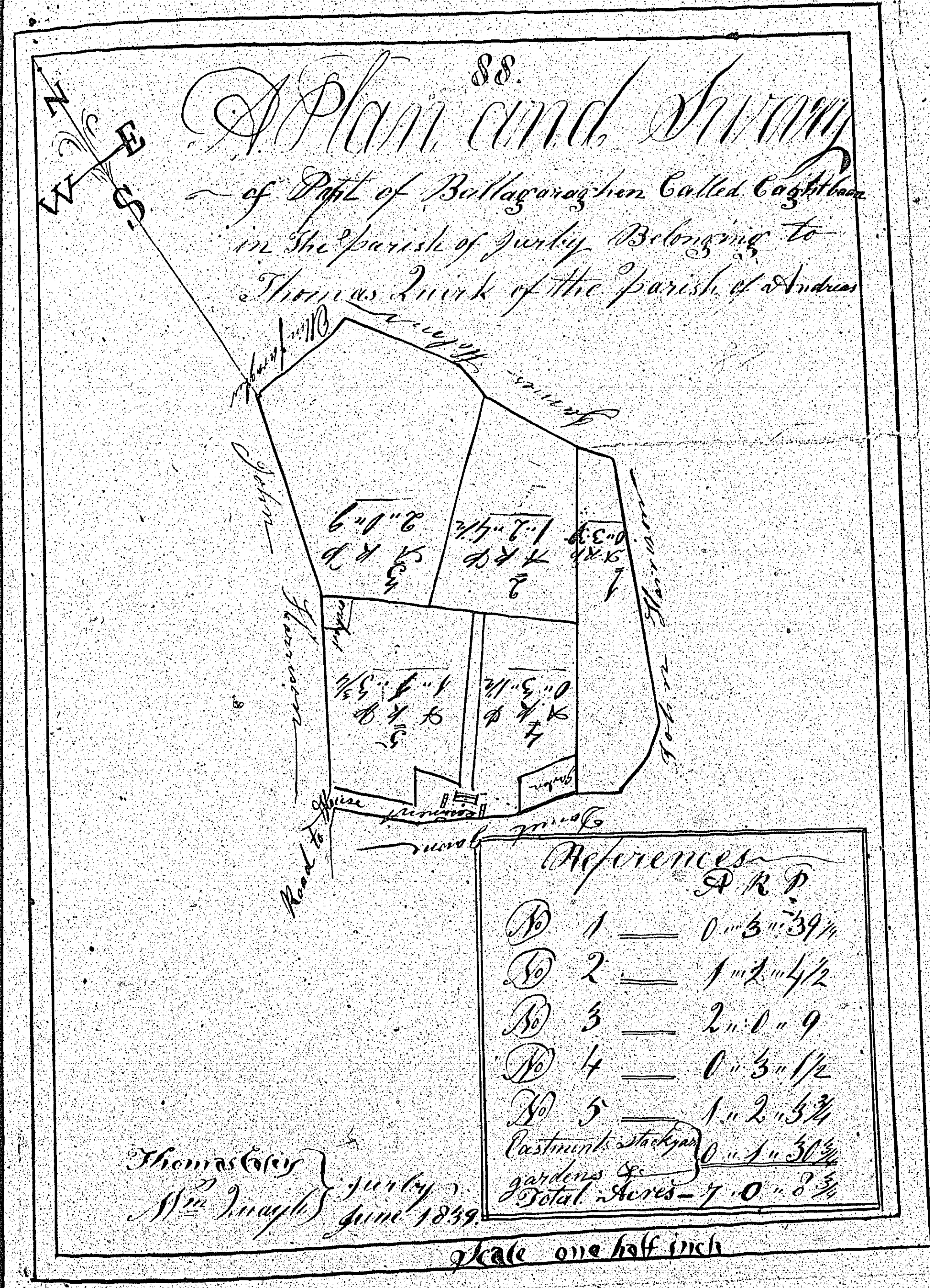
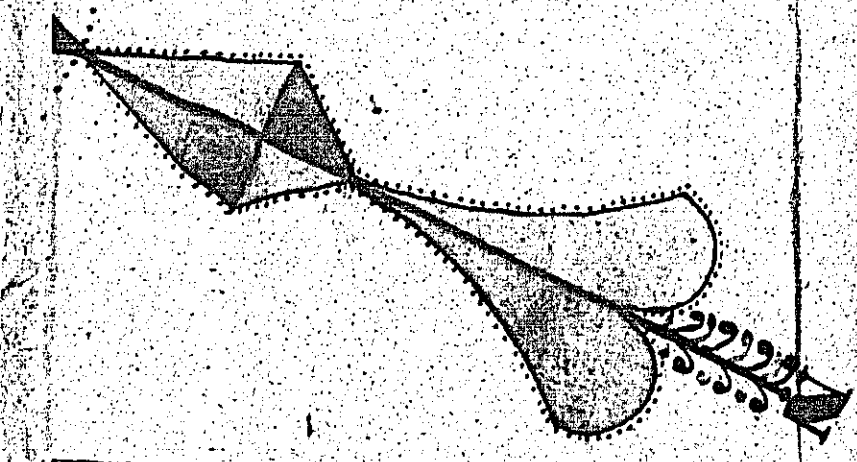

ACRES	
R	P
2	35
1	22
0	20
2	6
2	1
3	35
2	29
1	38
1	1
0	30
3	17
1	38
1	10

Daniel Sayle is Surveyor
work correct and the
is made by logarithms
Jurby East Schoolmaster
Dec 18-1840

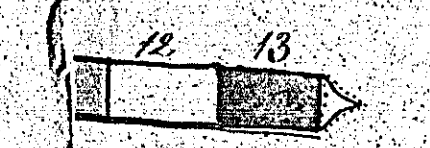

100
90
80
70
60
50
40
30
20
10
0

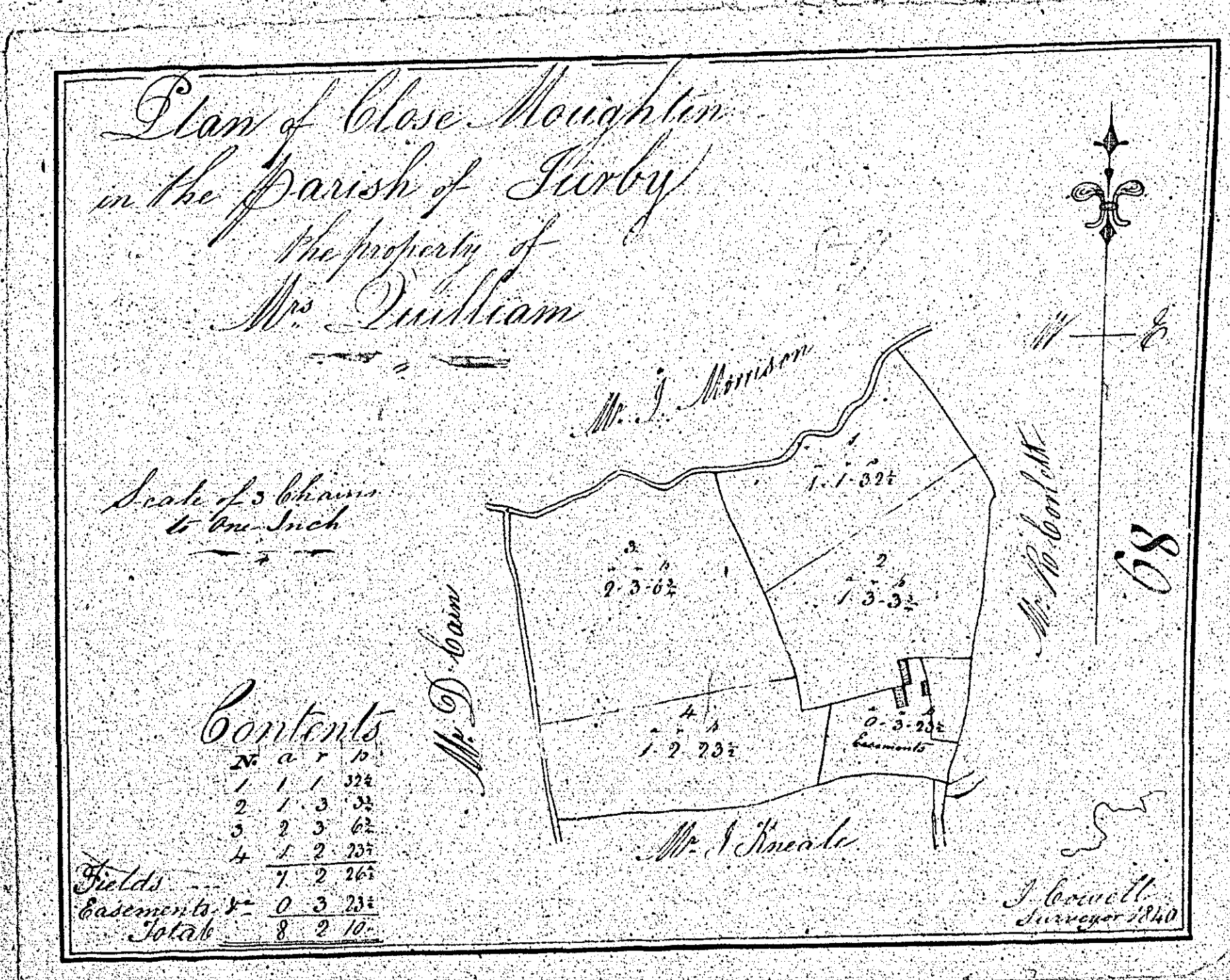

*James Lloyd, Esq. Surveyor
and Counsel at Law
has measured and surveyed the
above described premises
for Mr. Durbiam
18th 1840*

ANCES
R-P

1	22
2	35
3	20
4	6
5	1
6	35
7	29
8	38
9	1
10	50
11	11
12	38
13	15

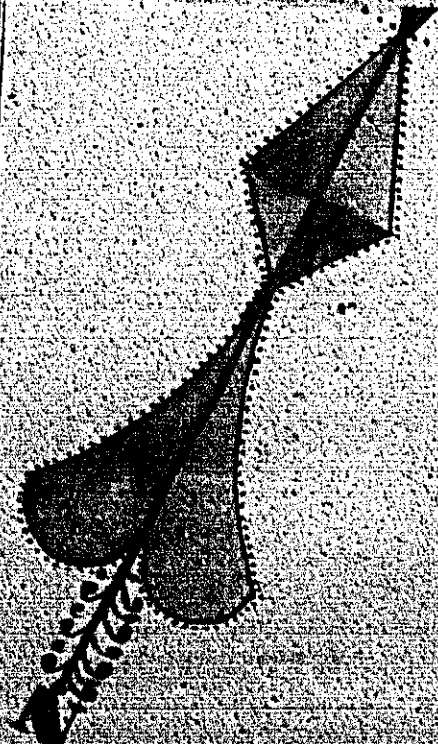

1840