

PLAN OF JAMES LAWSON'S ESTATE

74

No. 1000

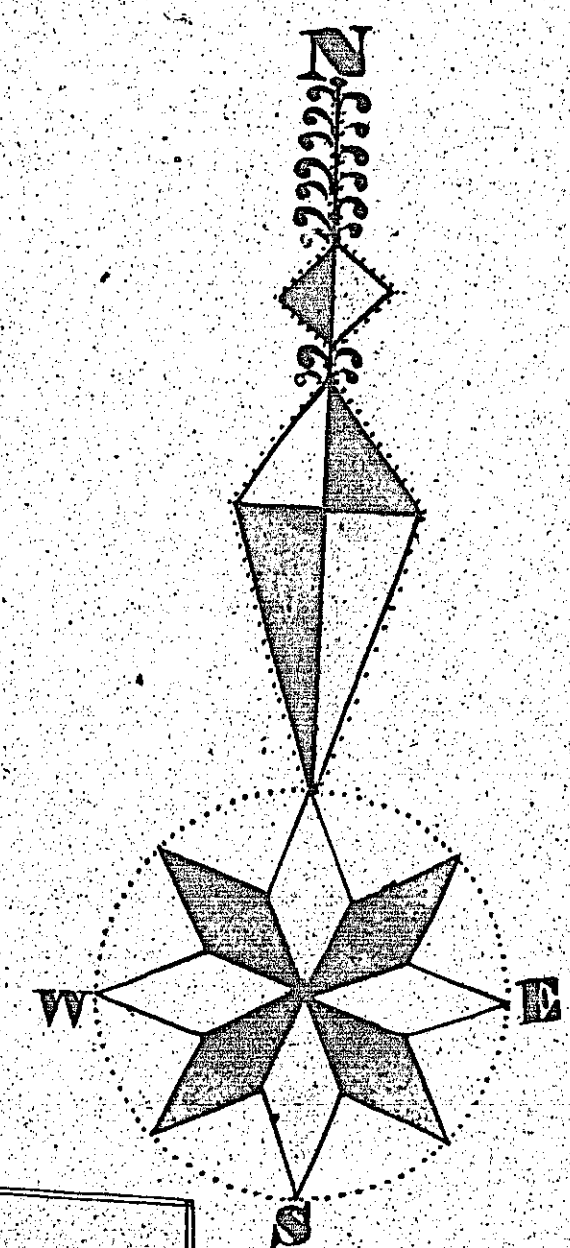
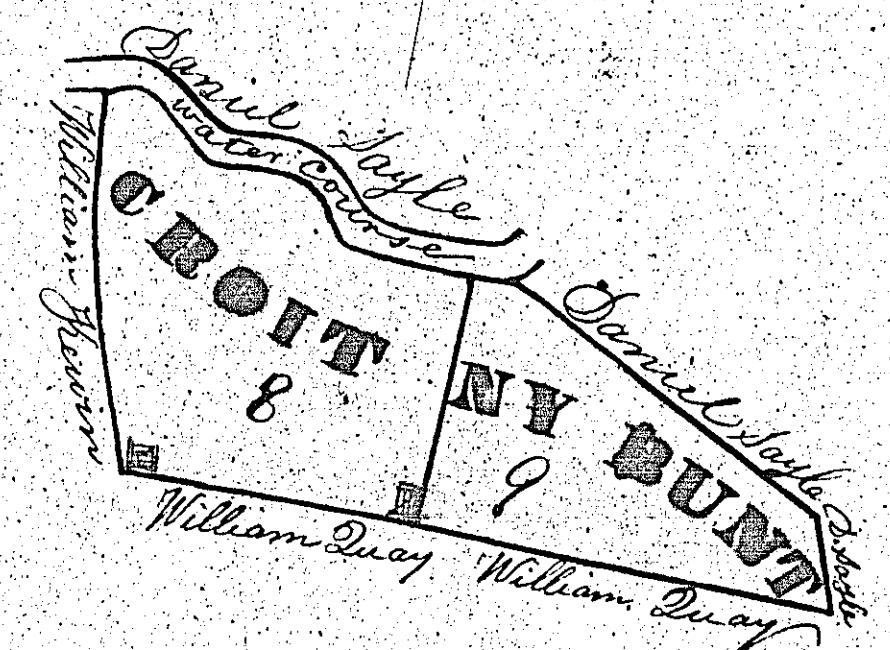
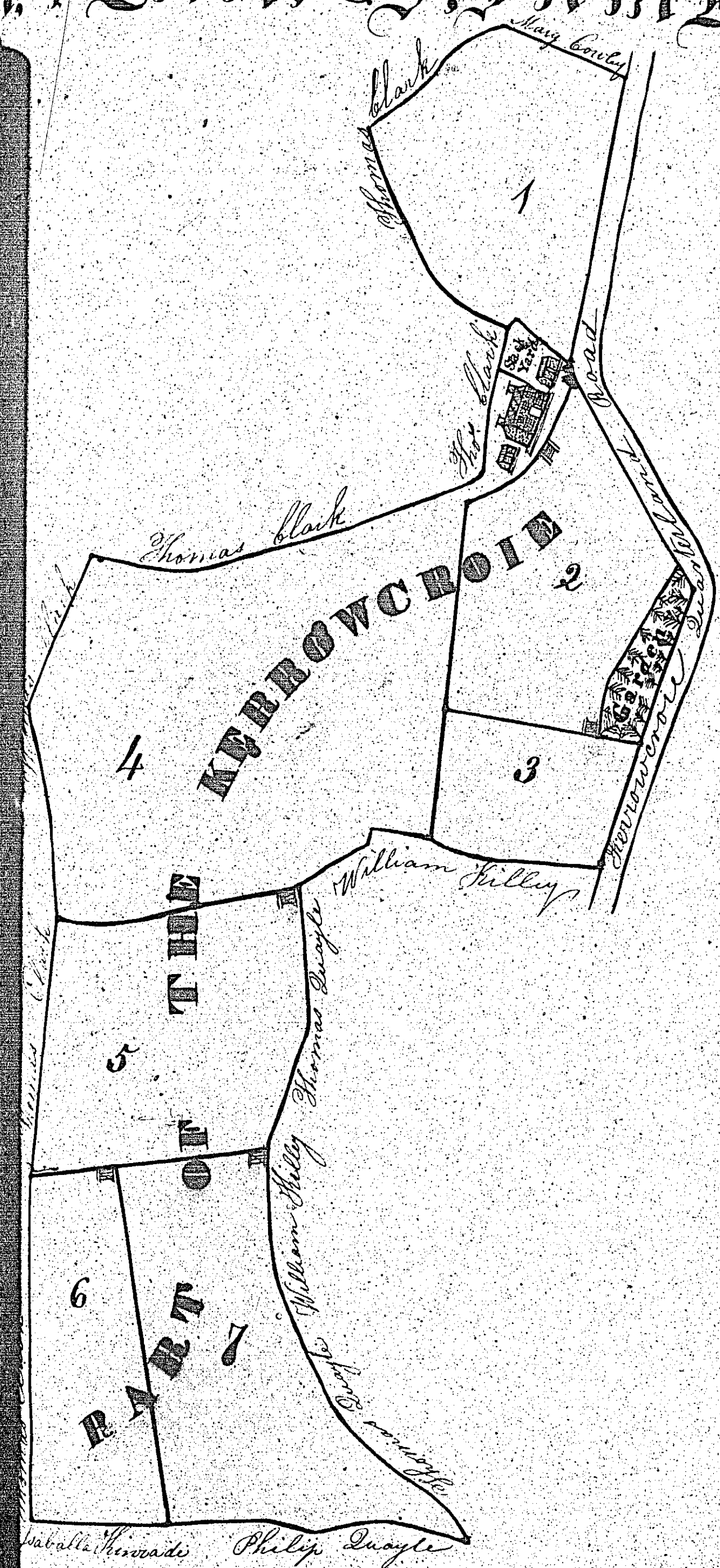

REFERENCES

A—R—P	
No. 1	1...3...2
No. 2	1...3...10
No. 3	0...3...00
No. 4	4...0...24
No. 5	2...0...15
No. 6	1...1...31
No. 7	1...2...26
13...2...16 26	
0...1...34	
14...0...10	
1...3...16	
15...3...26 36	

A Plan and Survey of Part of the Quaitland called Thorowcroft And another parcel of Land called Croit by Bunt being part of the Quaitland called Thorow-kneale both in the parish of Juby the property of James Lawson

The Property of James Lawson is surveyed twice to have the work more Correct And the Calculations thereof is made up by Logarithms September 7-1840 by Daniel Sully July Post schoolmaster

Half Inch Scale

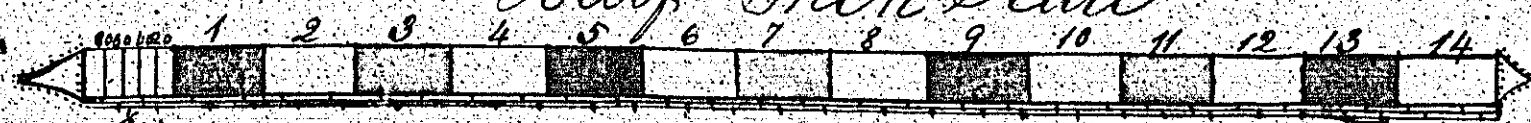

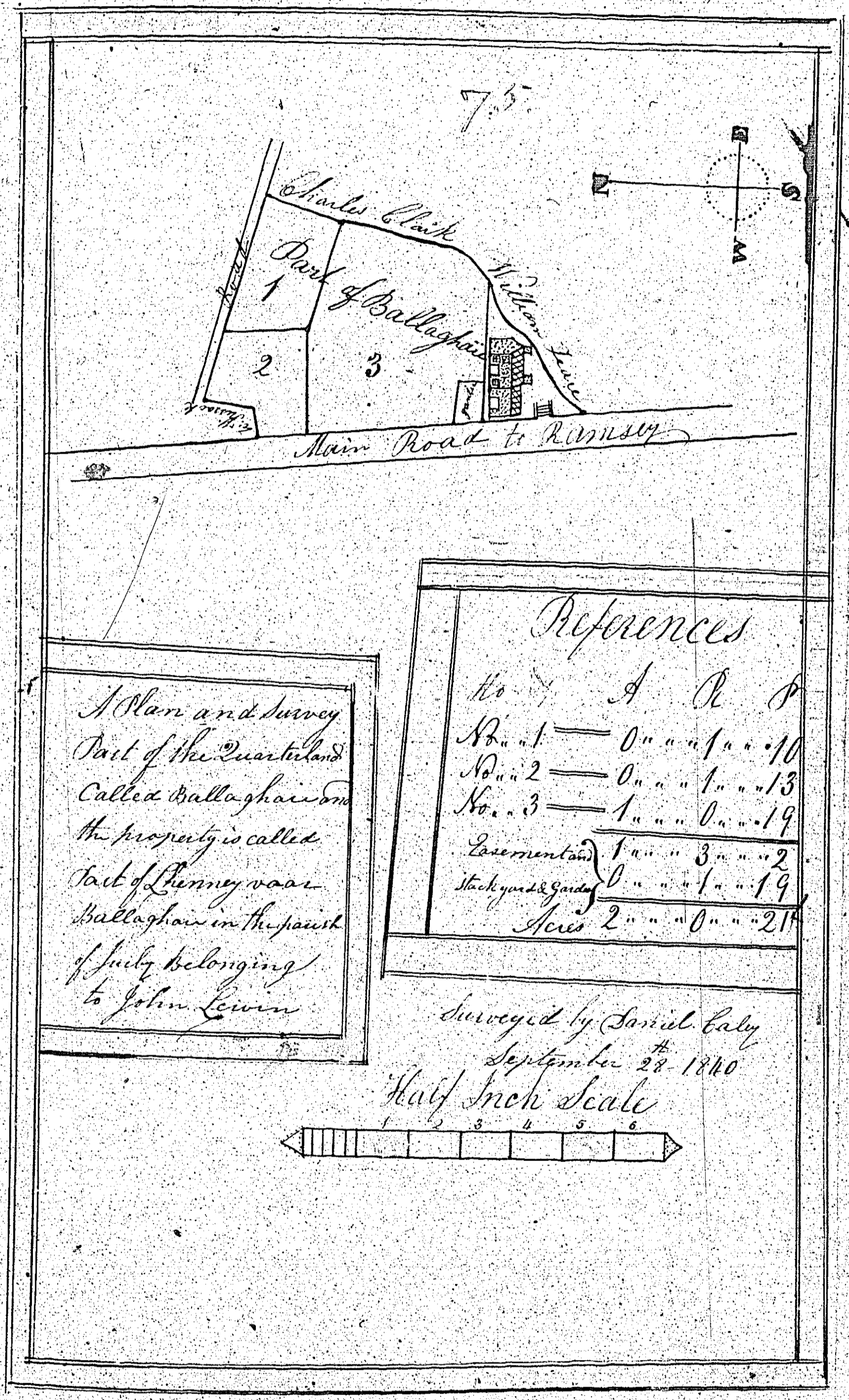

A Plan and Survey
 Part of the Quarelands
 Called Ballaghacross
 the property is called
 Part of Funnymore
 Ballaghacross in the parish
 of July belonging
 to John Lewis

References

No.	A	B	P
No. 1	0	1	10
No. 2	0	1	13
No. 3	1	0	19
Lawrence's	3	2	
Stockyard & garden	0	1	19
Acres	2	0	21

Surveyed by Daniel Galy
 September 28. 1840
 Half Inch Scale

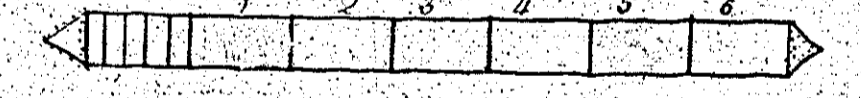

James John James Esq.

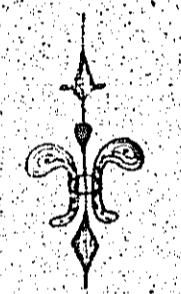

from the first

*A Plan and survey of a
part of Cloaquay in the
parish of York by the property
of William Morris taken
July 17th 1840
by Abel Thorne*

Abel Thorne *Abel Thorne*
A. T. A. T.
1 - 2 - 27 1 - 2 - 27
Abel Thorne

Abel Thorne