

Plan and Survey

WEST NAPPIN

of the property of
Mr. Wm. Dalrymple

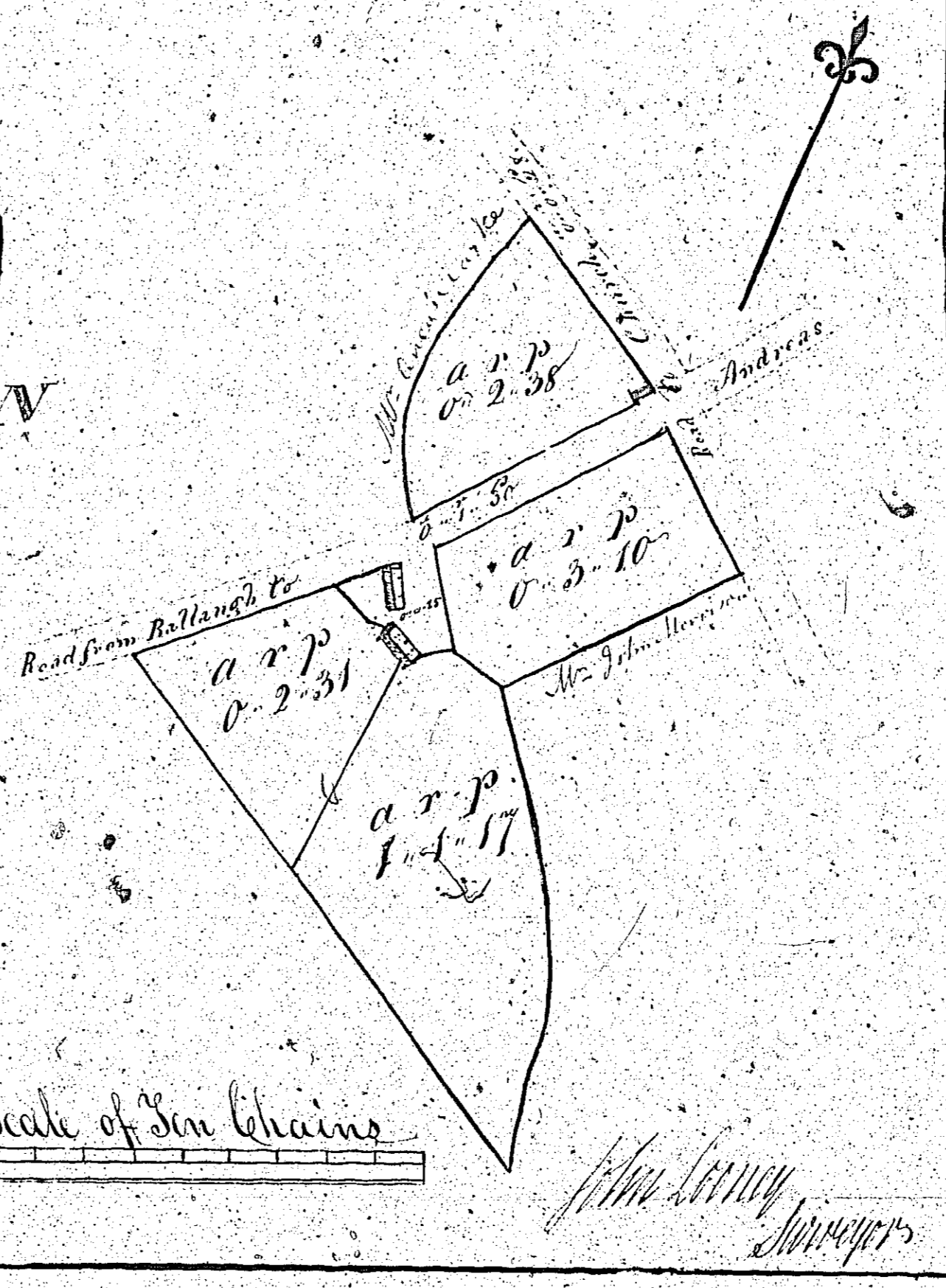

54

Contents

Line of Road	3-3-1
High Road	0-2-18
	4-1-14

Scale of 300 chains

Wm. Dalrymple

Noted

56.

A Plan and Survey of
A part of the Quarterland
of Ballachirrey and parts
of Outback called *Crossquagle*
and *Lochary* accy in
the parish of *ferby* the
property of *W. Henry Kelly*
taken May 6th 1840
by *Abner Hornum*

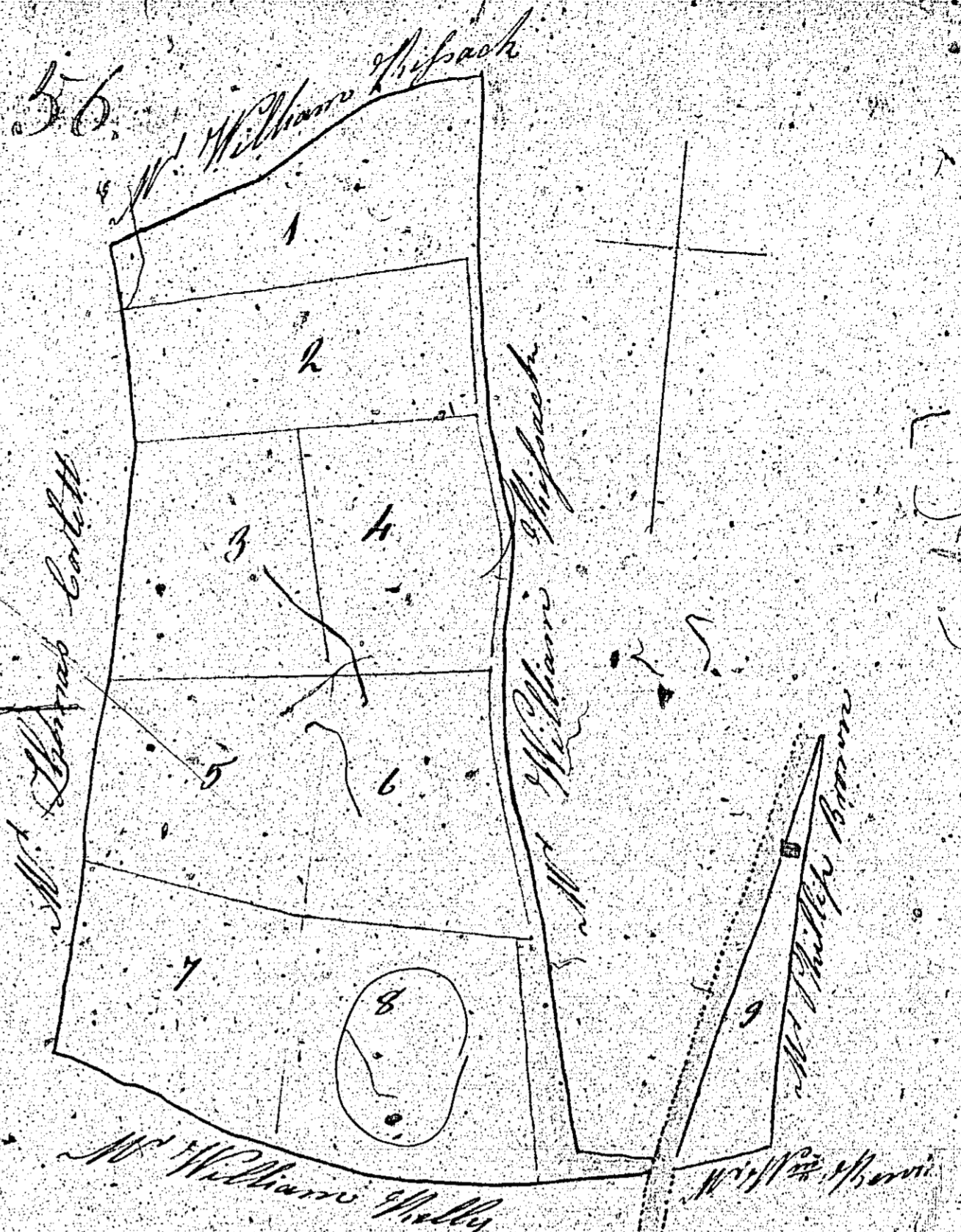

Coordinates

12	A.	B.	C.
1	2	0	09
2	2	0	35
3	2	0	40
4	2	0	42
5	2	0	54
6	2	0	11
7	2	0	35
8	2	1	06
9	2	2	13
10	0	2	15
11	0	2	16
12	0	1	58
13	0	2	20
14	0	2	23
15	0	2	11
16	3	0	36
17	1	2	10
18	2	1	20
Total	20	3	27

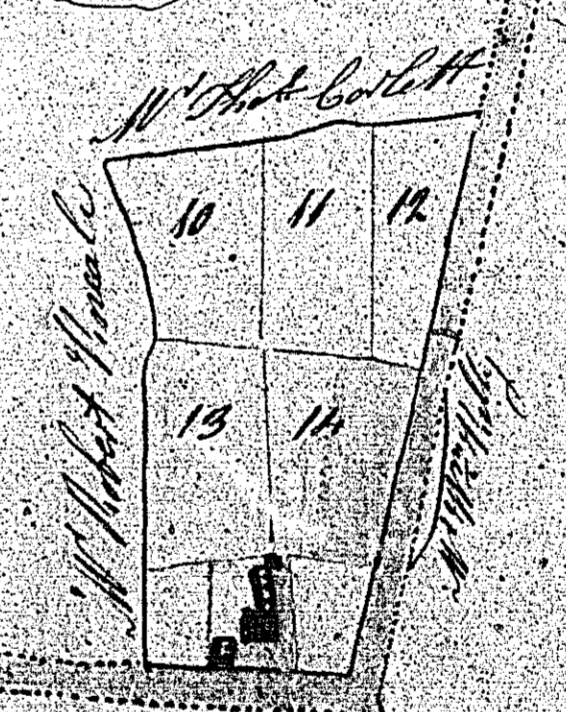

A Note of *Abner Hornum* to *W. Henry Kelly*

A map of the original Survey of the Barracks in Dublin in the year 1780

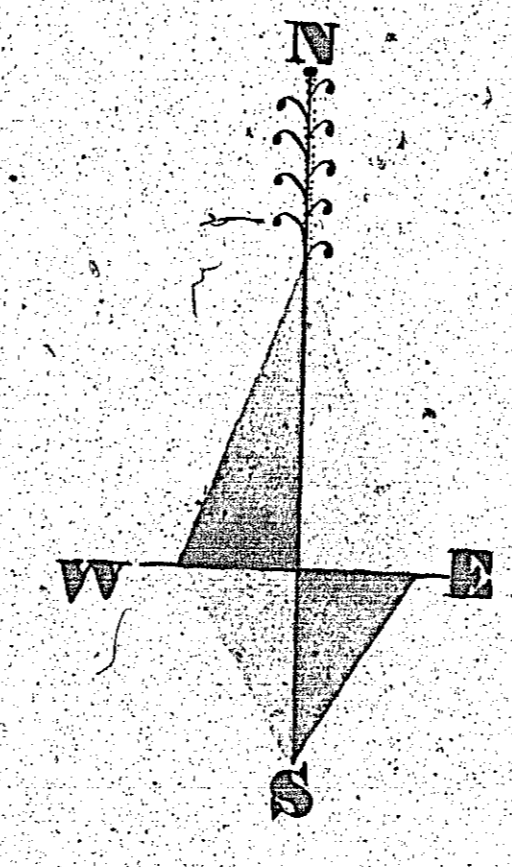

A Part of the Barracks

No.	A	B	P
No. 1	0	1	37
No. 2	2	3	00
No. 3	2	1	19
No. 4	2	0	8
No. 5	1	2	27
No. 6	2	0	0
No. 7	1	3	31
No. 8	2	0	8
No. 9	1	1	37
No. 10	2	1	12
No. 11	1	0	11
Total			19
Total			39
Total			58
Total			1
Total			0

A Part of the Barracks

No.	A	B	P
No. 12	2	1	35
No. 13	1	1	10
No. 14	1	0	3
No. 15	0	3	20
No. 16	0	1	21
Total			6
Total			9

A Part of the Barracks

No.	A	B	P
No. 17	2	1	3
No. 18	1	0	14
No. 19	1	1	1
No. 20	1	3	20
No. 21	1	2	13
No. 22	0	3	26
No. 23	1	3	13
Total			10
Total			9
Total			11
Total			20

The Office of William Kelly is surveyed the
 different ways to make the work more exact and
 the Barracks is made up the different
 ways. First by more accurate surveying
 Copied from a map of the Barracks
 drawn by Mr. Kelly in the year 1780
 I have the work is kept by S. Kelly

A Plan and Survey of a Part of the Barracks and part
 of Malinbeg and part of the Barracks in the Parish of
 St. Mary to belong to William Kelly
 surveyed by Daniel Kelly July 1780

Any Objection to any of the above
 All the above surveys are of the same date

The above plan is a survey of the Barracks
 and part of Malinbeg and part of the Barracks in the Parish of
 St. Mary to belong to William Kelly
 surveyed by Daniel Kelly July 1780

April 1780

Plan of William Hewins Property Surby

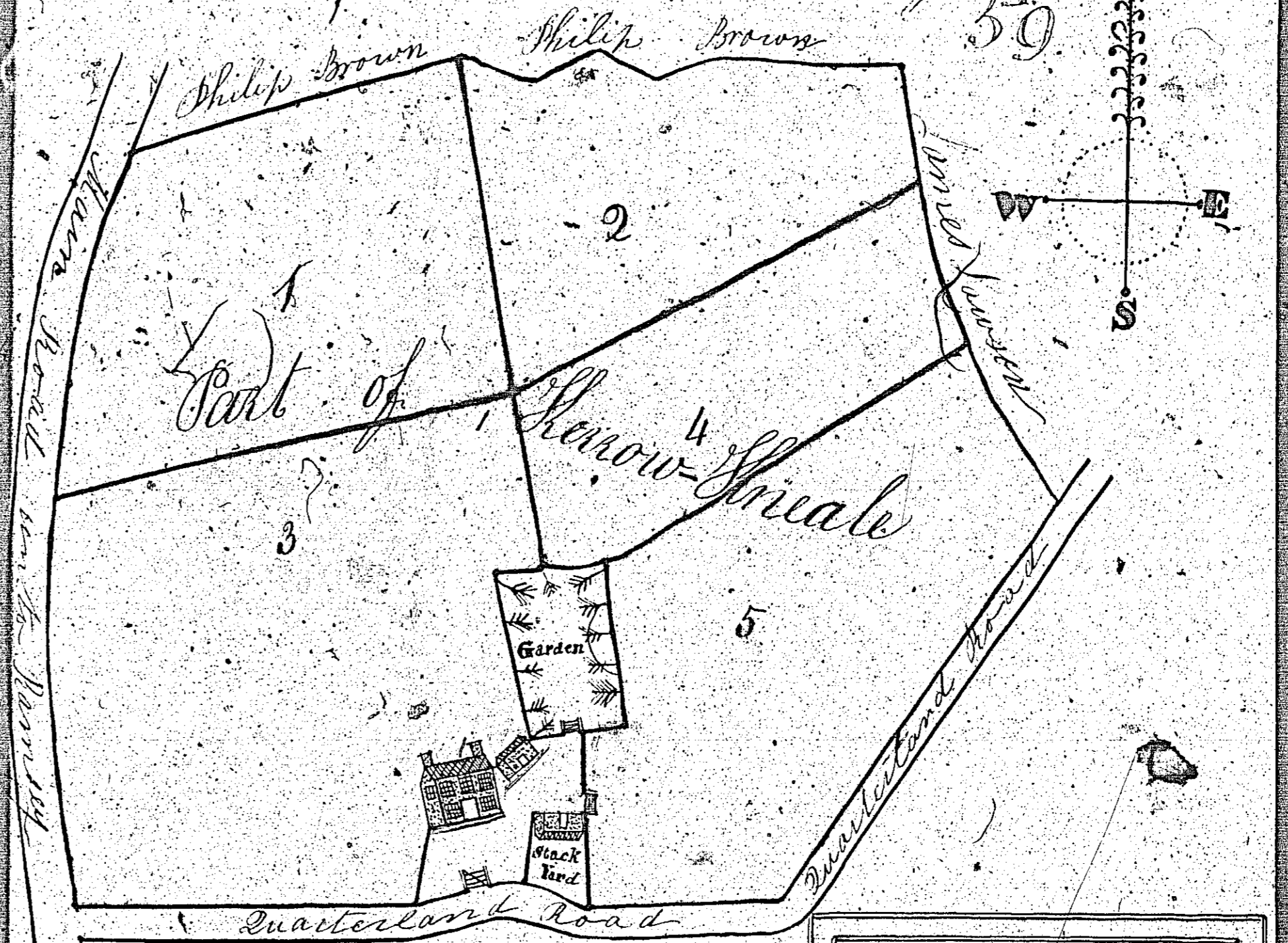

References

A-B-P	
No 1	1 .. 1 .. 23
No 2	0 .. 3 .. 26
No 3	2 .. 0 .. 26
No 4	0 .. 3 .. 18
No 5	1 .. 2 .. 5
Stairment	6 .. 3 .. 18
Stack yard and garden	0 .. 2 .. 3
Wh. Wood	7 .. 1 .. 21

A Plan and Survey of Part of a Quarterland Called Horn-wineale and another parcel of Land Called Ballacurry the parish of Surby the property of William Hewins

Surveyed by Daniel Daly Parly Past Schoolmaster and the Calculations thereof is made up by Logarithms September 29 1840

Three Quarters of an Inch Scale

1	2	3	4	5	6	7	8	9	10	11	12	13	14	15	16
1	2	3	4	5	6	7	8	9	10	11	12	13	14	15	16
1	2	3	4	5	6	7	8	9	10	11	12	13	14	15	16