

198
 Plan of part of the Estate of BALLA-LIGG the property of M^r. S. G. G. G.
 situate in the parish of CERRAN

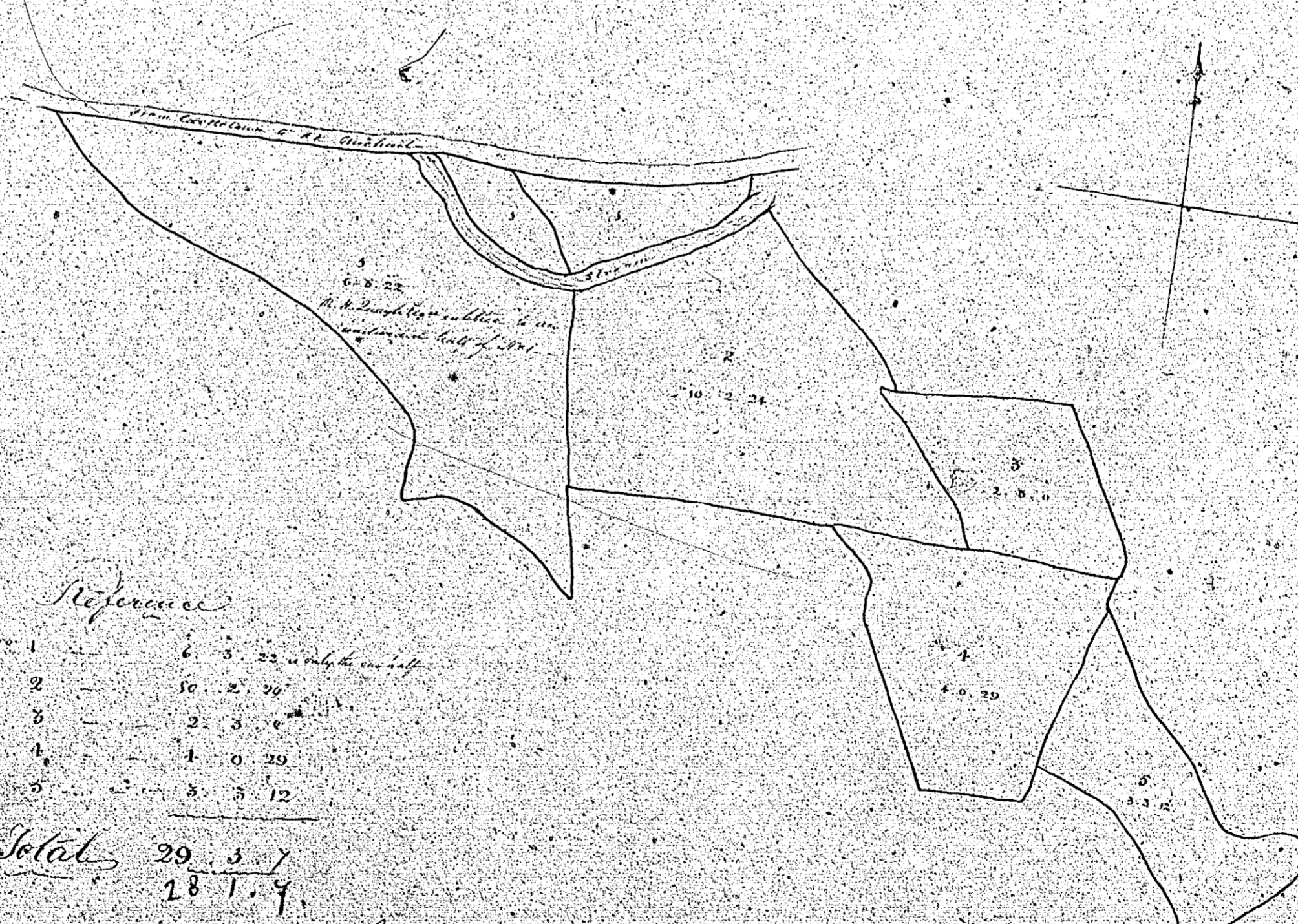

Reference

N ^o . 1	4	5	25	acres
2	10	25	acres	
3	2	3	acres	
4	1	0	acres	
5	3	3	acres	
Totals		29	3	7
		28	1	9

Drawn by *Wm. G. G.*
 from a plan by *J. G. G.*

Scale of 1000 Feet

198

*Plan of the fort of Balla-ligg, the
property of Mr. Ed. Dwyer Esq. situated in the County of
GERMAN*

1799

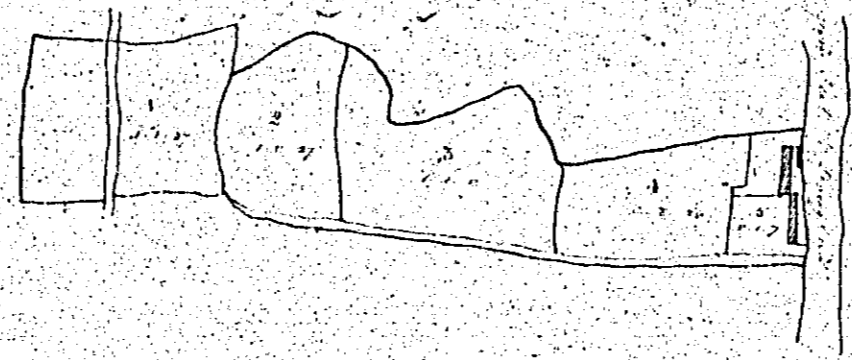

Total 507

Scale of Chains

*Copy of the plan of the fort of Balla-ligg, the
property of Mr. Ed. Dwyer Esq. situated in the County of
GERMAN*

A Plan of the Survey of
 the Township of ...
 ...
 ...

Contents
 ...
 ...
 ...
 ...
 ...

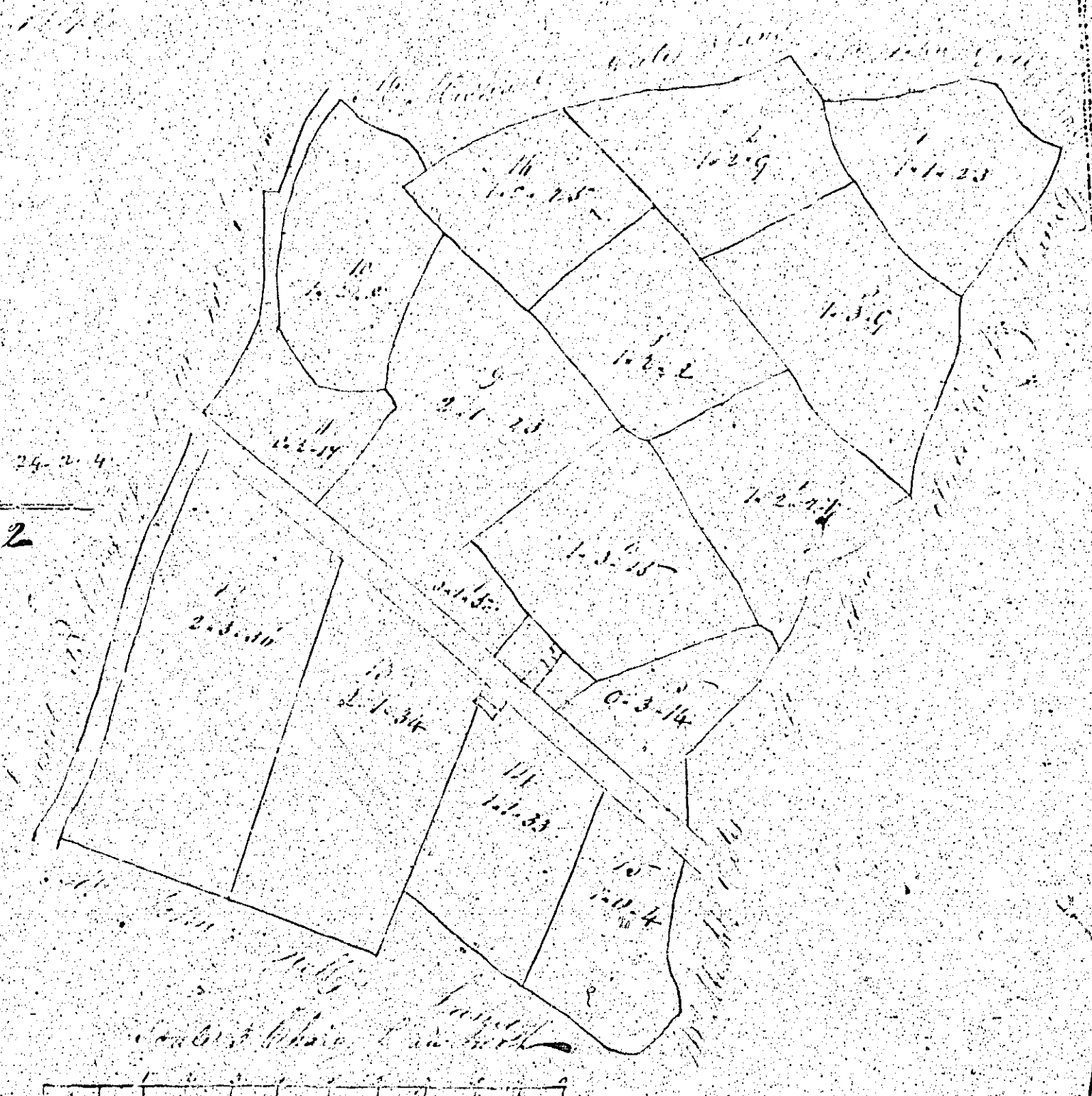
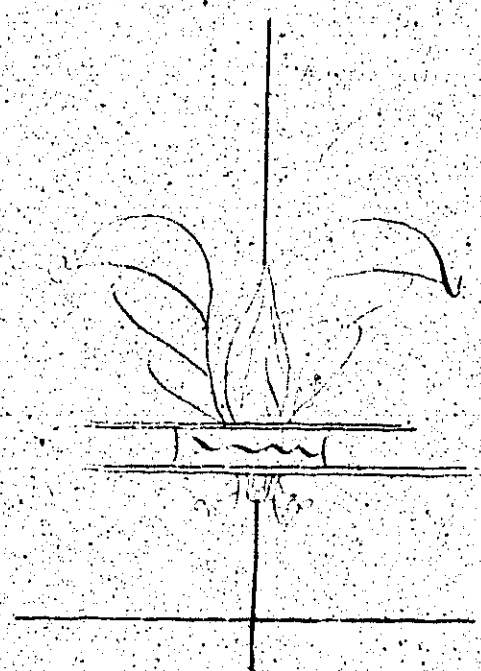

203

There is no plan
numbered 202

roy. museum. groningen
A. H. G. van

