

132

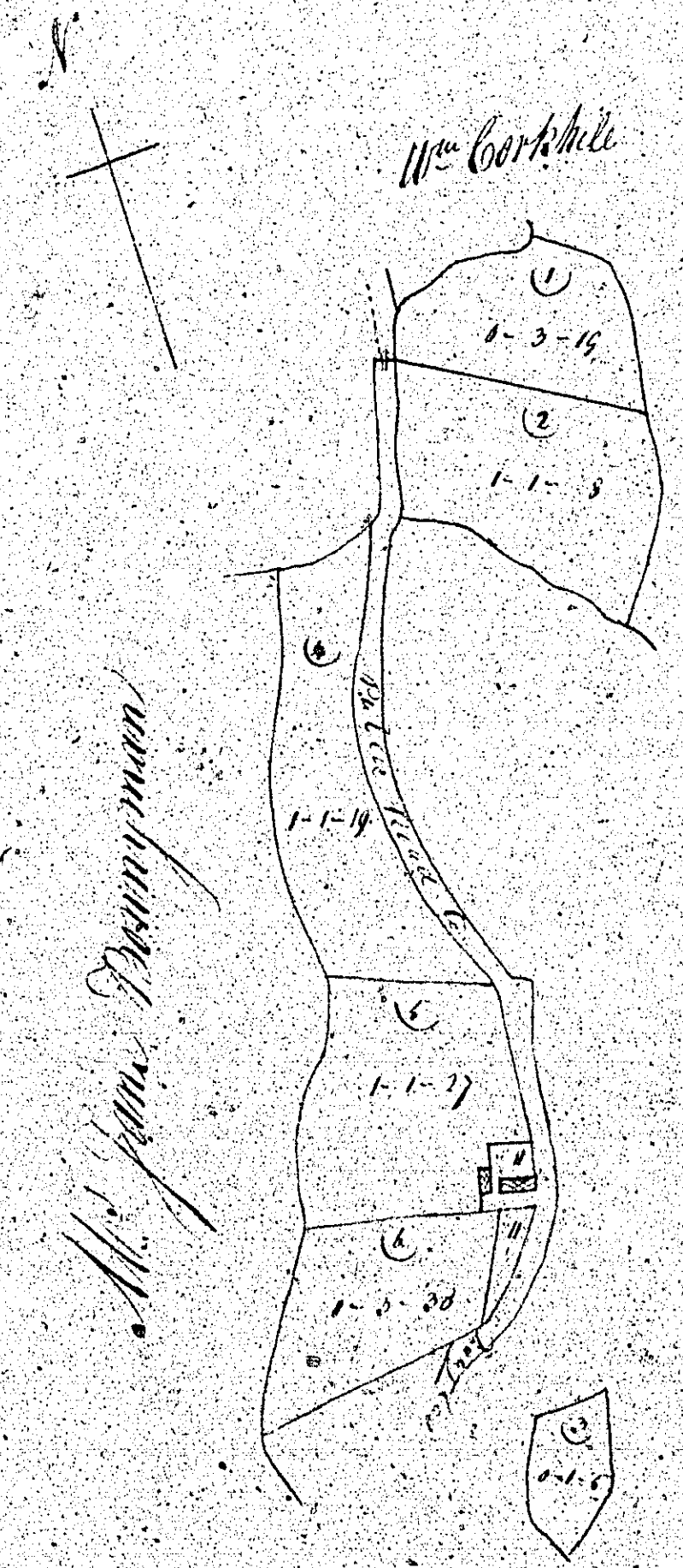

133



Mr. Coakley

Mr. John Martin

Mr. J. Coakley

Mr. John Martin

Plan  
of part of  
Barry Lane  
in the  
Parish of Gorman  
belonging to  
The Hon. Coakley  
July 18th 1840

Refers to	Acres
1	3 1/2
2	1 1/2
3	1 1/2
4	1 1/2
5	1 1/2
6	1 1/2
7	1 1/2
8	1 1/2
9	1 1/2
10	1 1/2
11	1 1/2
12	1 1/2
13	1 1/2
14	1 1/2
15	1 1/2
16	1 1/2
17	1 1/2
18	1 1/2
19	1 1/2
20	1 1/2
21	1 1/2
22	1 1/2
23	1 1/2
24	1 1/2
25	1 1/2
26	1 1/2
27	1 1/2
28	1 1/2
29	1 1/2
30	1 1/2
31	1 1/2
32	1 1/2
33	1 1/2
34	1 1/2
35	1 1/2
36	1 1/2
37	1 1/2
38	1 1/2
39	1 1/2
40	1 1/2
41	1 1/2
42	1 1/2
43	1 1/2
44	1 1/2
45	1 1/2
46	1 1/2
47	1 1/2
48	1 1/2
49	1 1/2
50	1 1/2
51	1 1/2
52	1 1/2
53	1 1/2
54	1 1/2
55	1 1/2
56	1 1/2
57	1 1/2
58	1 1/2
59	1 1/2
60	1 1/2
61	1 1/2
62	1 1/2
63	1 1/2
64	1 1/2
65	1 1/2
66	1 1/2
67	1 1/2
68	1 1/2
69	1 1/2
70	1 1/2
71	1 1/2
72	1 1/2
73	1 1/2
74	1 1/2
75	1 1/2
76	1 1/2
77	1 1/2
78	1 1/2
79	1 1/2
80	1 1/2
81	1 1/2
82	1 1/2
83	1 1/2
84	1 1/2
85	1 1/2
86	1 1/2
87	1 1/2
88	1 1/2
89	1 1/2
90	1 1/2
91	1 1/2
92	1 1/2
93	1 1/2
94	1 1/2
95	1 1/2
96	1 1/2
97	1 1/2
98	1 1/2
99	1 1/2
100	1 1/2

Three Chains to a Furlong

Joseph Blake Surveyor



PROPERTY

in German

belonging to Miss Ann Killey & M<sup>rs</sup> Radcliff

Feb. 1840.

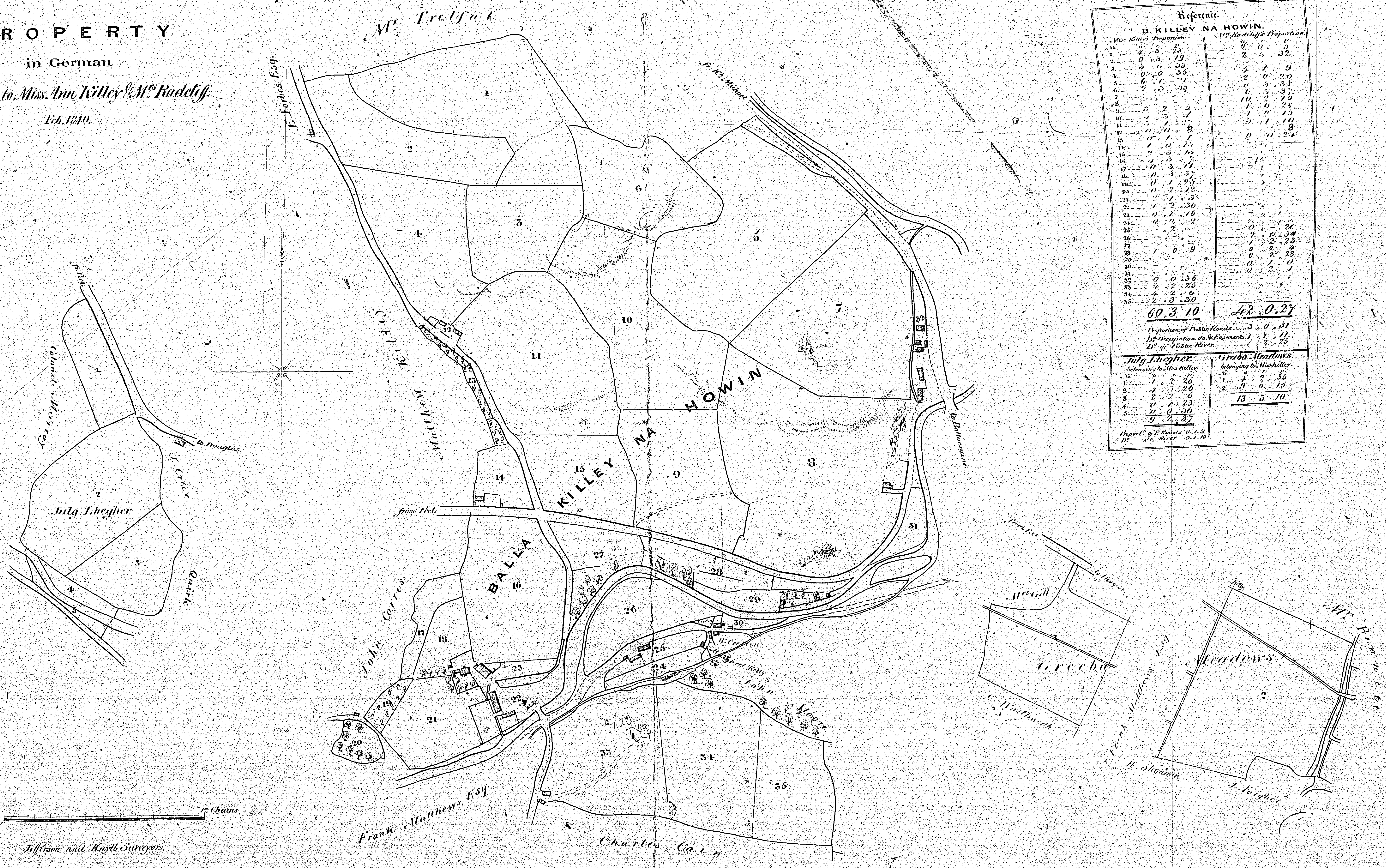

Reference.

B. KILLEY NA HOWIN.	
Miss Killey's Proportion	M <sup>rs</sup> Radcliff's Proportion
1	0 0 0
2	0 0 0
3	0 0 0
4	0 0 0
5	0 0 0
6	0 0 0
7	0 0 0
8	0 0 0
9	0 0 0
10	0 0 0
11	0 0 0
12	0 0 0
13	0 0 0
14	0 0 0
15	0 0 0
16	0 0 0
17	0 0 0
18	0 0 0
19	0 0 0
20	0 0 0
21	0 0 0
22	0 0 0
23	0 0 0
24	0 0 0
25	0 0 0
26	0 0 0
27	0 0 0
28	0 0 0
29	0 0 0
30	0 0 0
31	0 0 0
32	0 0 0
33	0 0 0
34	0 0 0
35	0 0 0
<b>Total</b>	<b>60 3 10</b>

Mrs. Howin's Proportion	
1	0 0 0
2	0 0 0
3	0 0 0
4	0 0 0
5	0 0 0
6	0 0 0
7	0 0 0
8	0 0 0
9	0 0 0
10	0 0 0
11	0 0 0
12	0 0 0
13	0 0 0
14	0 0 0
15	0 0 0
16	0 0 0
17	0 0 0
18	0 0 0
19	0 0 0
20	0 0 0
21	0 0 0
22	0 0 0
23	0 0 0
24	0 0 0
25	0 0 0
26	0 0 0
27	0 0 0
28	0 0 0
29	0 0 0
30	0 0 0
31	0 0 0
32	0 0 0
33	0 0 0
34	0 0 0
35	0 0 0
<b>Total</b>	<b>42 0 27</b>

John Lougher.	
1	0 0 0
2	0 0 0
3	0 0 0
4	0 0 0
5	0 0 0
6	0 0 0
7	0 0 0
8	0 0 0
9	0 0 0
10	0 0 0
11	0 0 0
12	0 0 0
13	0 0 0
14	0 0 0
15	0 0 0
16	0 0 0
17	0 0 0
18	0 0 0
19	0 0 0
20	0 0 0
21	0 0 0
22	0 0 0
23	0 0 0
24	0 0 0
25	0 0 0
26	0 0 0
27	0 0 0
28	0 0 0
29	0 0 0
30	0 0 0
31	0 0 0
32	0 0 0
33	0 0 0
34	0 0 0
35	0 0 0
<b>Total</b>	<b>13 5 10</b>

Mrs. Howin's Proportion	
1	0 0 0
2	0 0 0
3	0 0 0
4	0 0 0
5	0 0 0
6	0 0 0
7	0 0 0
8	0 0 0
9	0 0 0
10	0 0 0
11	0 0 0
12	0 0 0
13	0 0 0
14	0 0 0
15	0 0 0
16	0 0 0
17	0 0 0
18	0 0 0
19	0 0 0
20	0 0 0
21	0 0 0
22	0 0 0
23	0 0 0
24	0 0 0
25	0 0 0
26	0 0 0
27	0 0 0
28	0 0 0
29	0 0 0
30	0 0 0
31	0 0 0
32	0 0 0
33	0 0 0
34	0 0 0
35	0 0 0
<b>Total</b>	<b>13 5 10</b>

Jefferson and Kayl Surveyors.

134 + 135



134 + 135

136

PLAN

Of part of the Quarterland of the Bollaugh  
In the parish of RR. German  
The property of  
Mr. John Kelly.

Reference.

N <sup>o</sup> .	a.	r.	p.
1	0	0	21
2	2	0	15
3	1	2	28
Total Content.			3 3 24

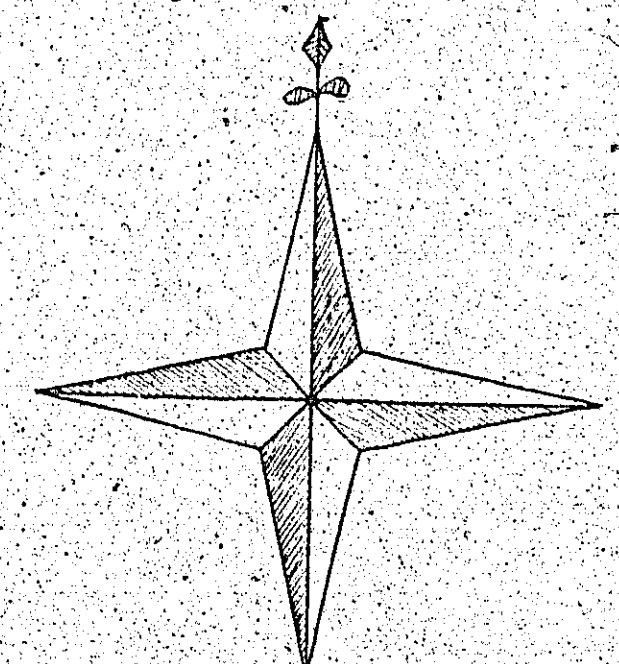
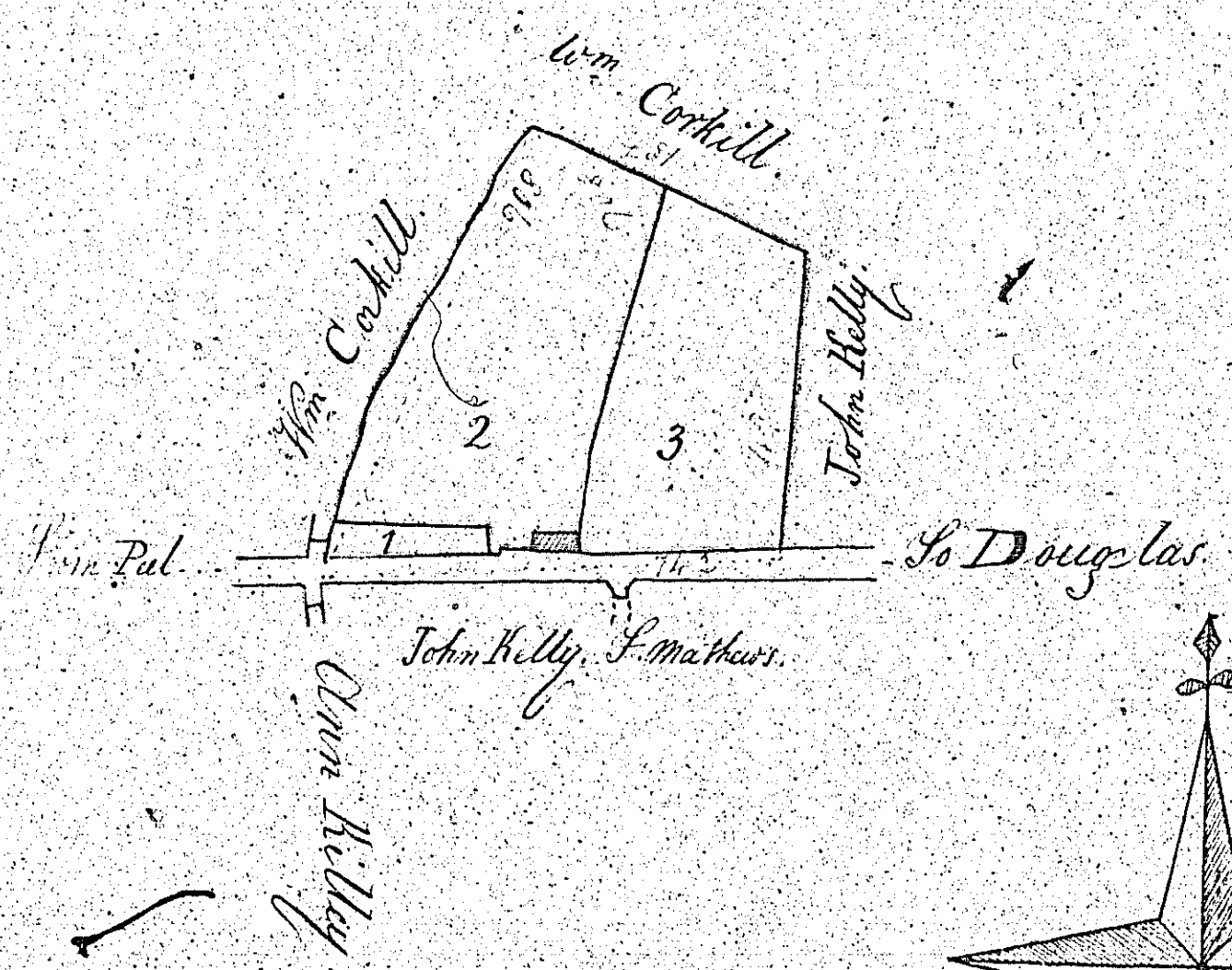

0 1 2 3 4 5 6 7 8 9 10 Chams.

Surveyed July 1840.  
By William Ruzsich  
R.H. German

By William Ruzsich  
R.H. German



130  
DIAN and

137  
A Plan and Survey of Part of  
Kiltevelin in the Parish of Co. Wick  
the property of Mr. John Kelly by  
Daniel Kelly April 23 1840

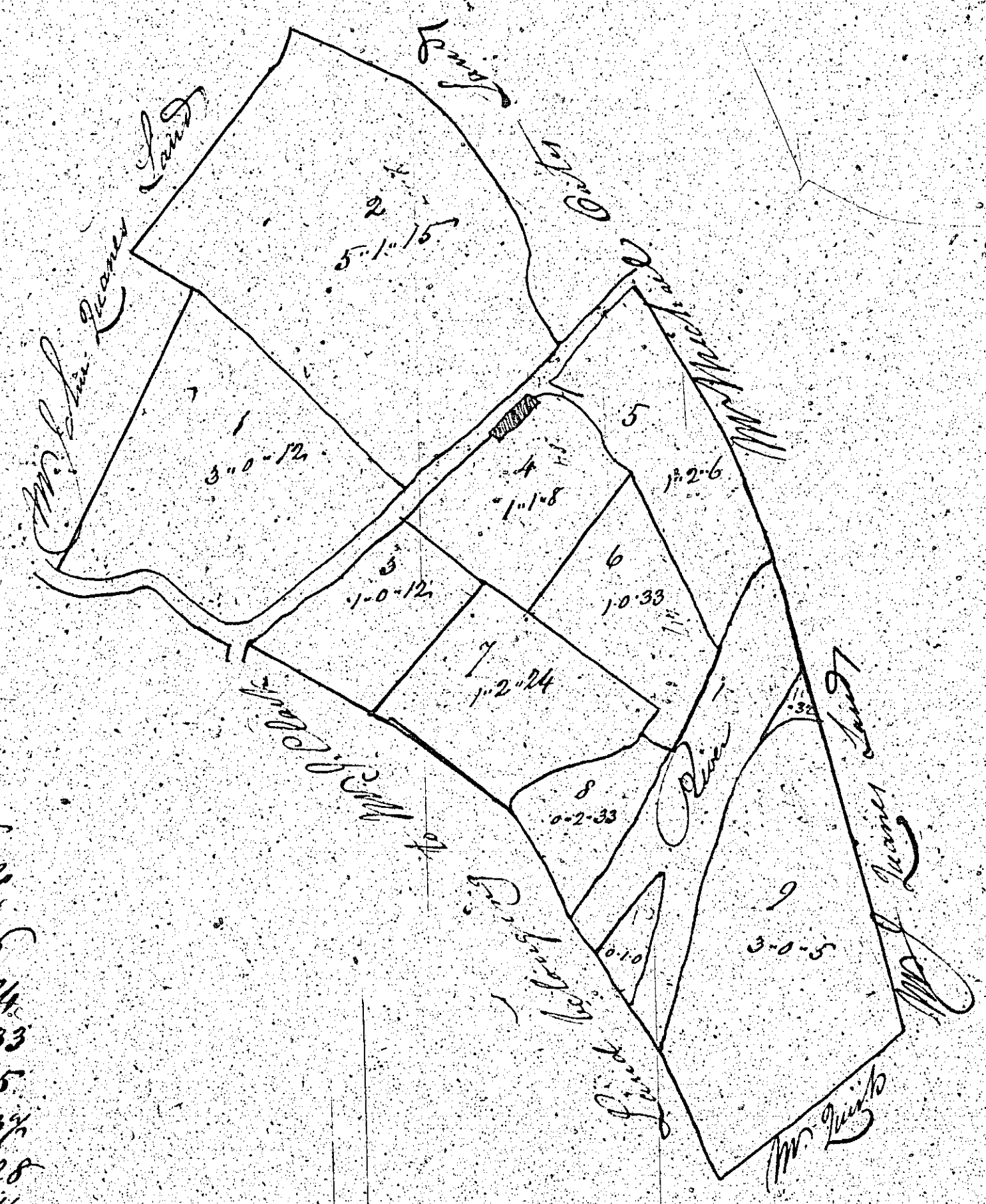
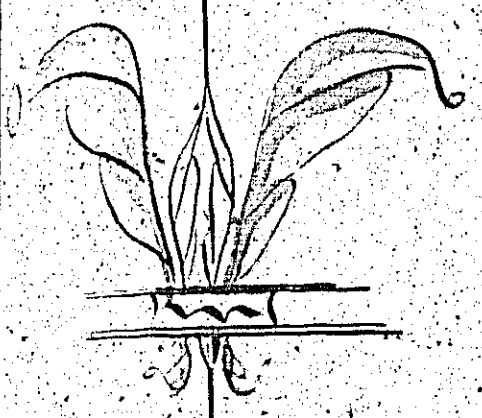

Contents

- 1 3-0-12
- 2 5-1-15
- 3 1-0-12
- 4 1-1-8
- 5 1-2-8
- 6 0-2-33
- 7 3-0-5
- 8 0-1-33
- 9 1-2-28
- 10 2-1-14
- 11 20-2-34

1 0 0  
2 3 1  
3 0 17  
4 0 33  
5 2 8 310

Wm. H. Gorman



130  
**PLAN and Survey**  
 of part of the Quarterland of the River  
 In the parish of St. German  
 The property of  
 Mr. John Kneale.

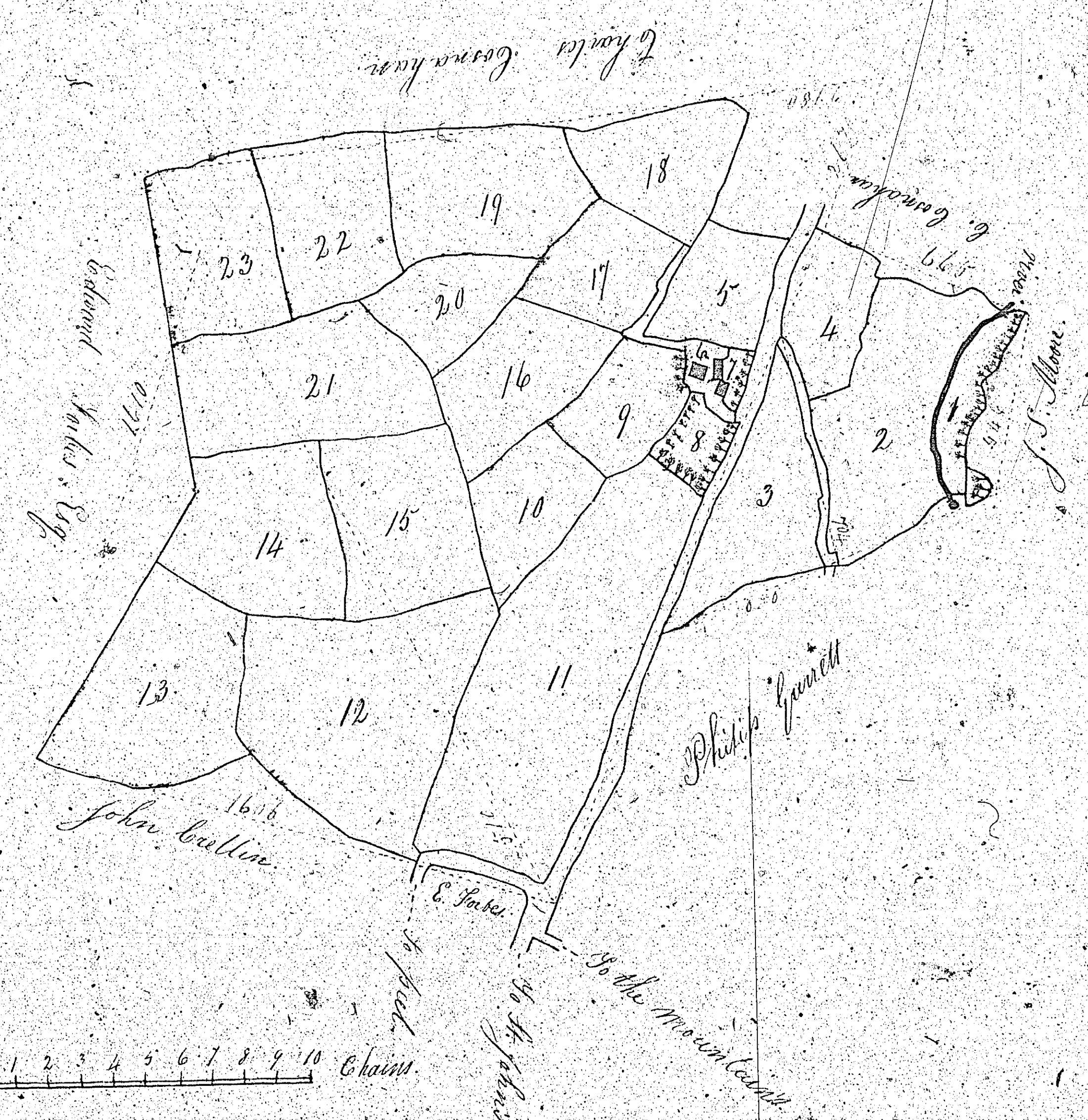

Reference			
No.	Ac.	R.	P.
1	0	2	16
2	2	3	8
3	1	2	37
4	1	0	4
5	1	0	6
6	0	1	21
7	0	0	39
8	0	3	16
9	1	0	10
10	1	0	31
11	5	0	18
12	4	0	16
13	2	3	8
14	2	1	4
15	2	1	1
16	1	2	18
17	1	0	23
18	1	1	35
19	2	0	33
20	1	0	9
21	2	3	1
22	1	3	13
23	1	3	27
Total content.			41 1 32

Surveyed August 1839  
 By William Horsfield  
 H. H. German

By William Horsfield  
 H. H. German



139

# PLAN

Of part of the *Quartland of Ballacrink*  
In the parish of *R.R. Gorman*  
The property of  
*M<sup>r</sup> Matthew Killey*

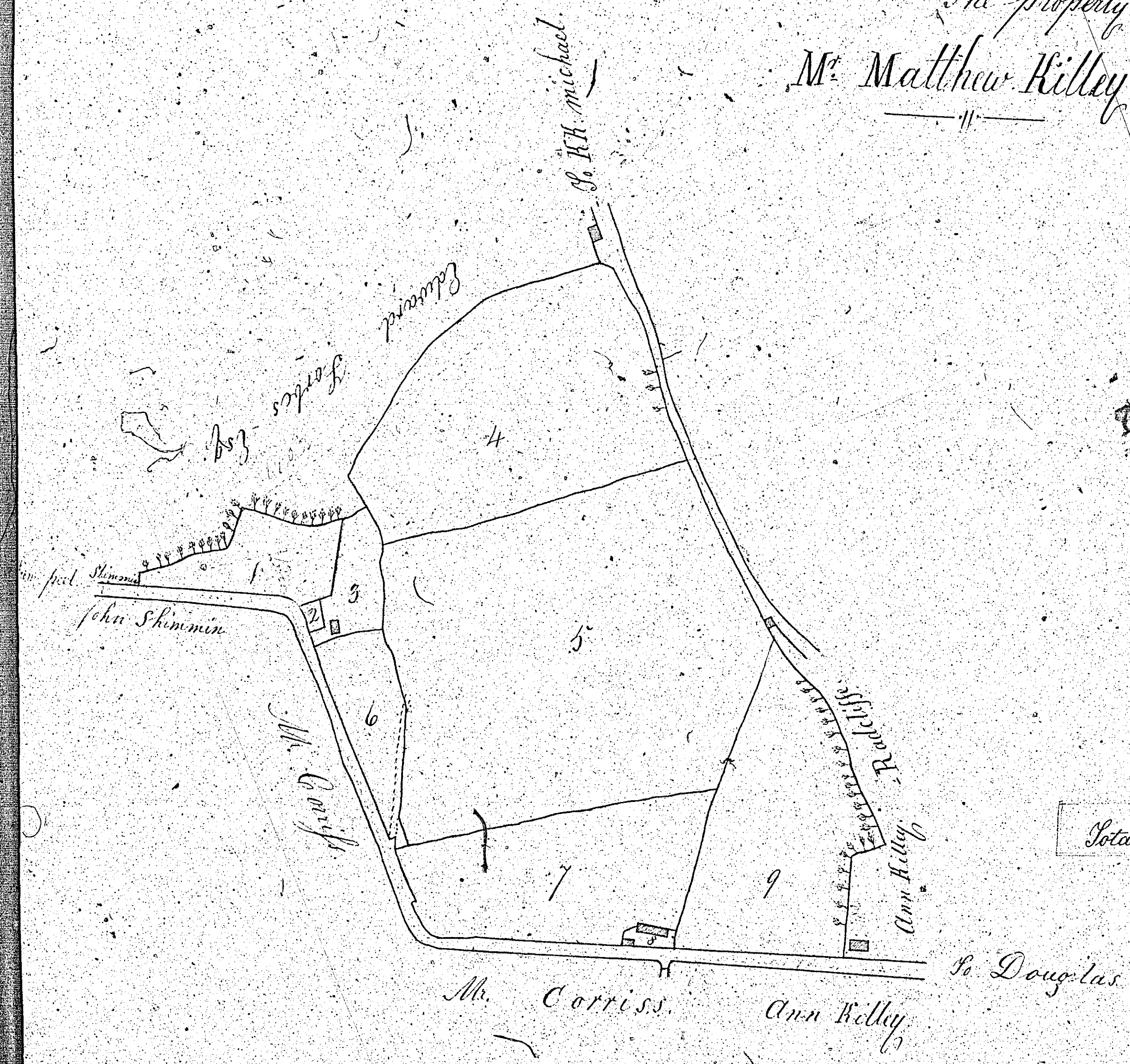

Reference			
No	a.	r.	p.
1	1	1	0
2	0	0	8
3	0	2	7
4	6	0	2
5	11	2	6
6	1	0	10
7	3	3	0
8	0	0	16
9	4	0	13
10	2	2	16
11	1	3	24
Total Content	33	0	11

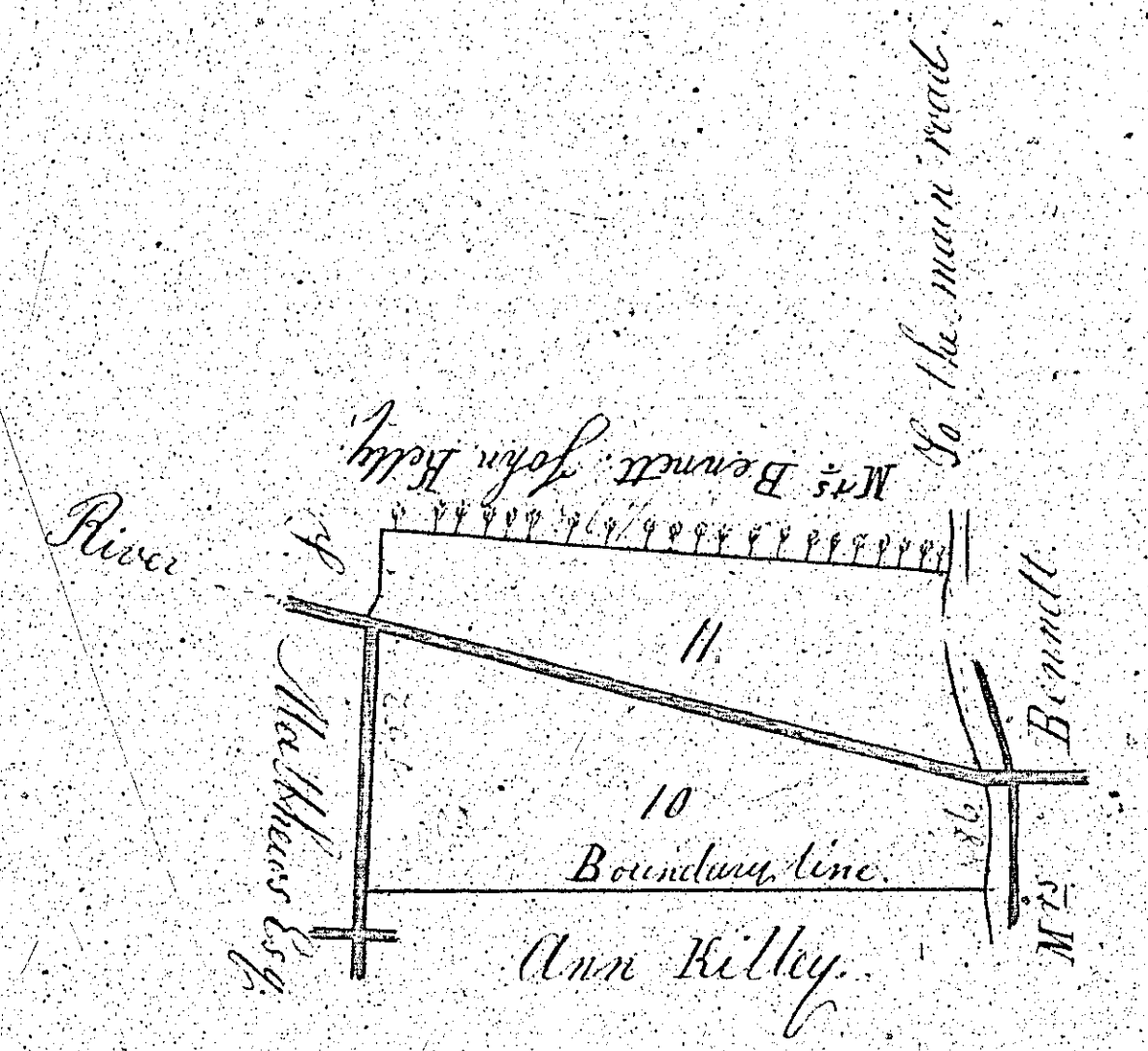

1 2 3 4 5 6 7 8 9 10 Chains

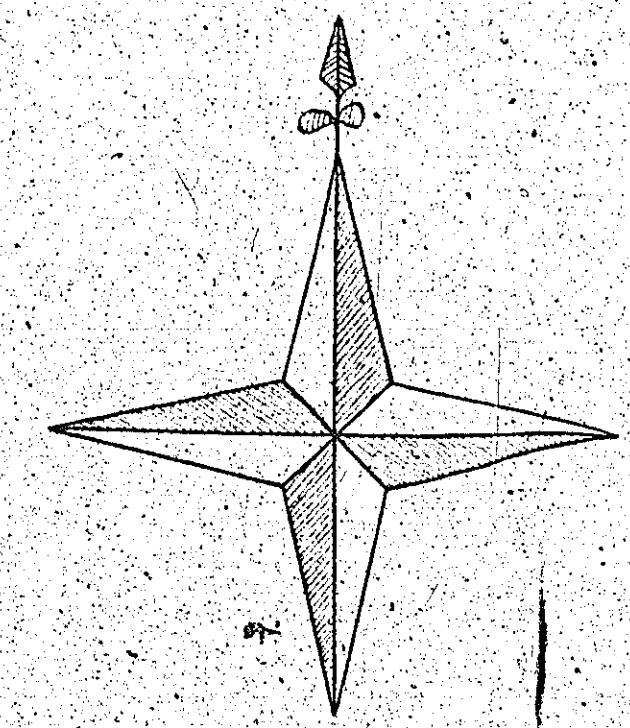

Surveyed July 1840.  
By William Keogh  
R.R. Gorman

By William Keogh  
R.R. Gorman