

Vol. 1
68.

PLAN and Survey
Of part of the Quakerland of Lambell Moor
In the parish of H.H. German
The property of
Mr. Charles Cowley.

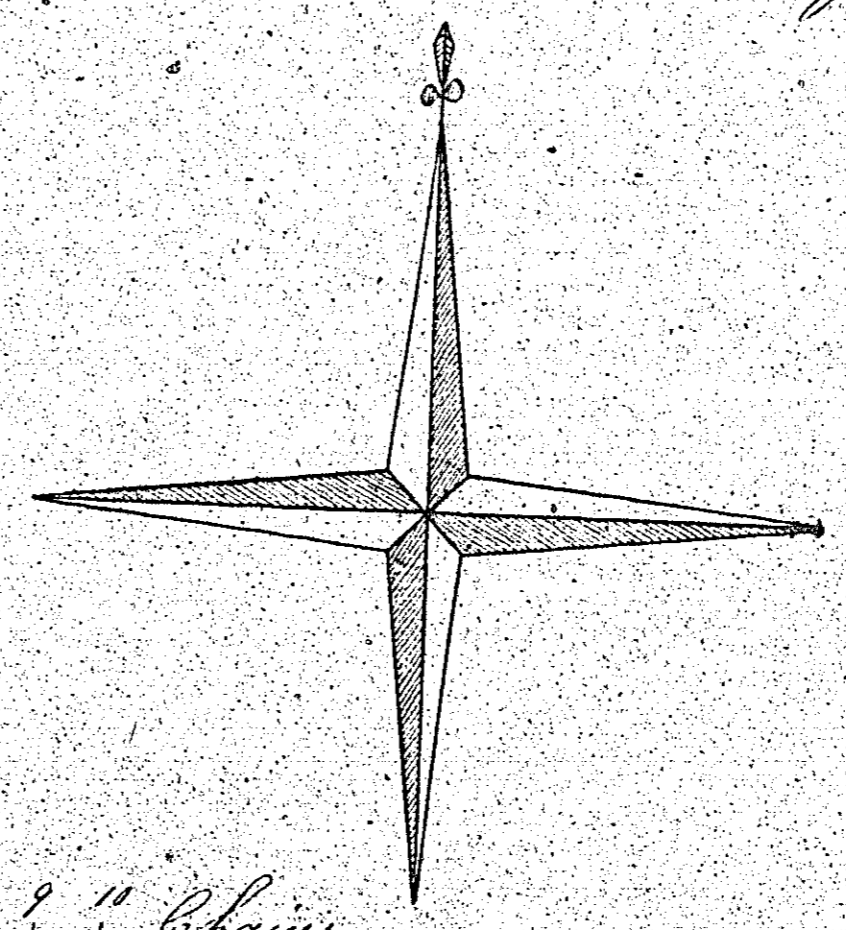
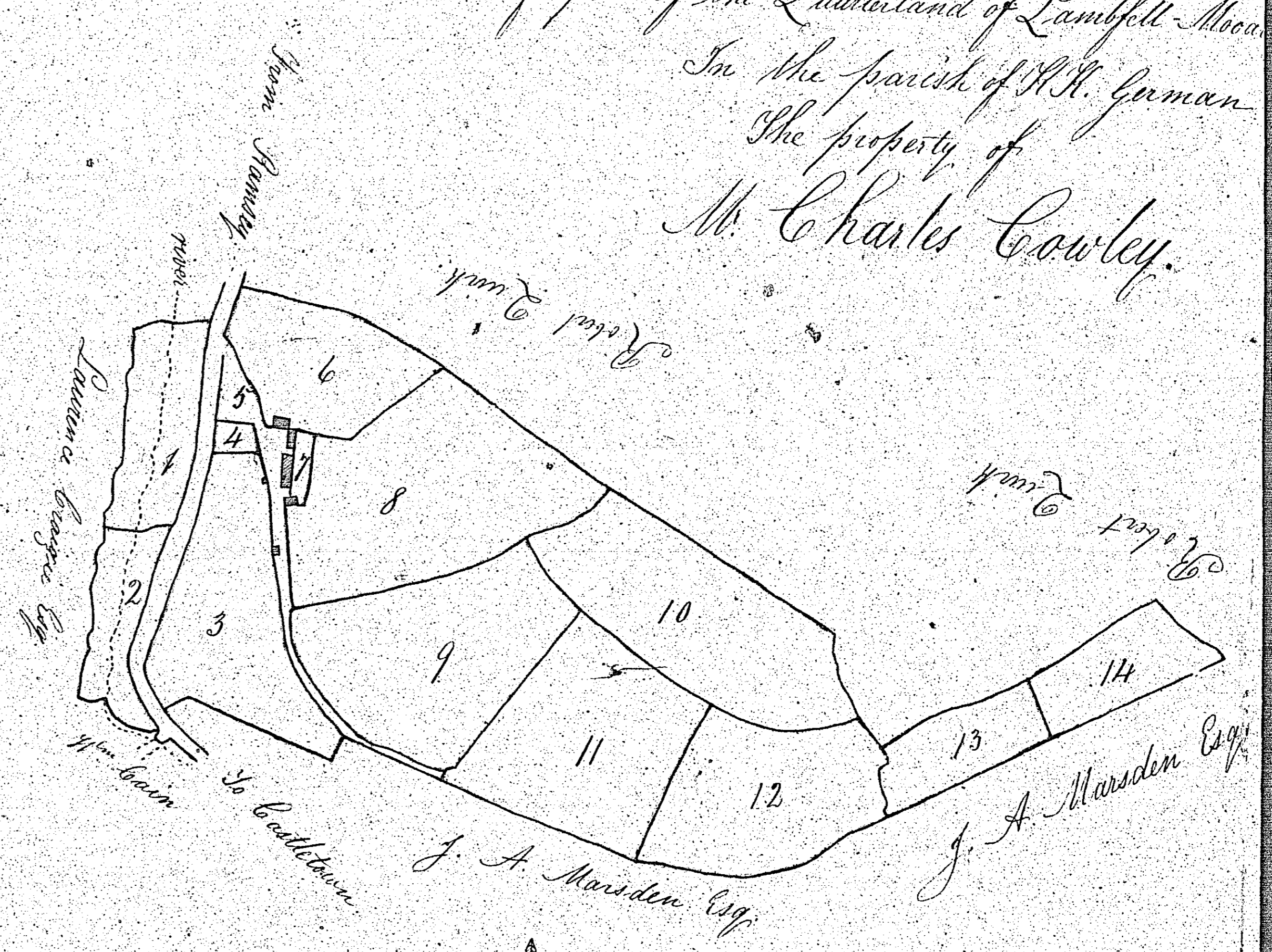

0 1 2 3 4 5 6 7 8 9 10 Chains

Reference			
No	Ac.	R.	P.
1	1	0	31
2	0	3	18
3	2	1	25
4	0	0	17
5	0	2	19
6	1	2	15
7	0	0	16
8	3	2	18
9	3	0	16
10	3	0	4
11	2	3	14
12	2	1	28
13	0	3	38
14	0	3	38
Total Content	23	3	17

Surveyed 1839.
by William Haigh
H.H. German

ISLE OF MAN GOVERNMENT: GENERAL REGISTRY

TITHE PLANS: PARISH OF GERMAN

69 Original coloured

1.30

70 Original coloured (decorative)

In Town

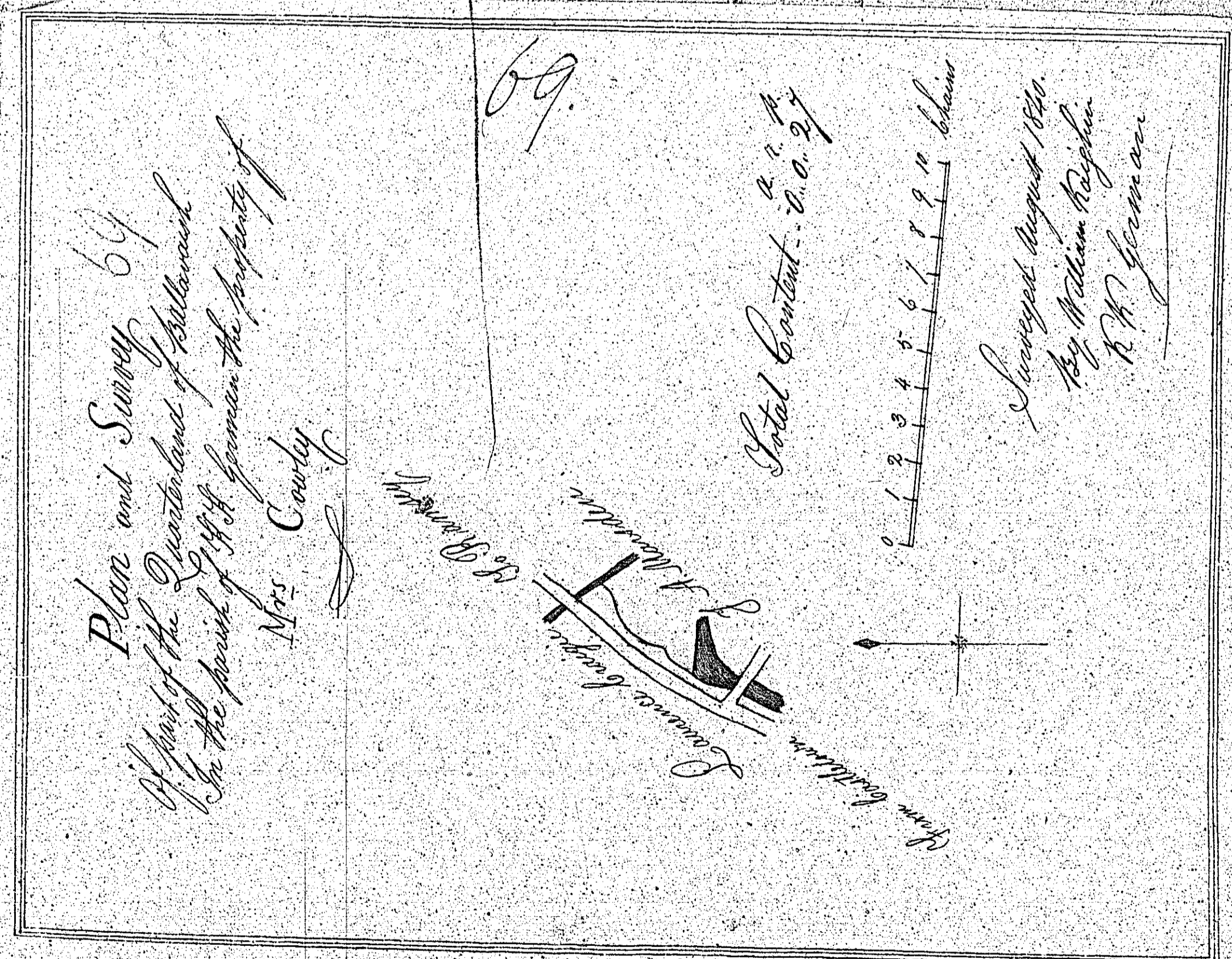

There is no plan
numbered 71

Plan of
Property of
Mr. T. Cotton
adjoining Seal Beach

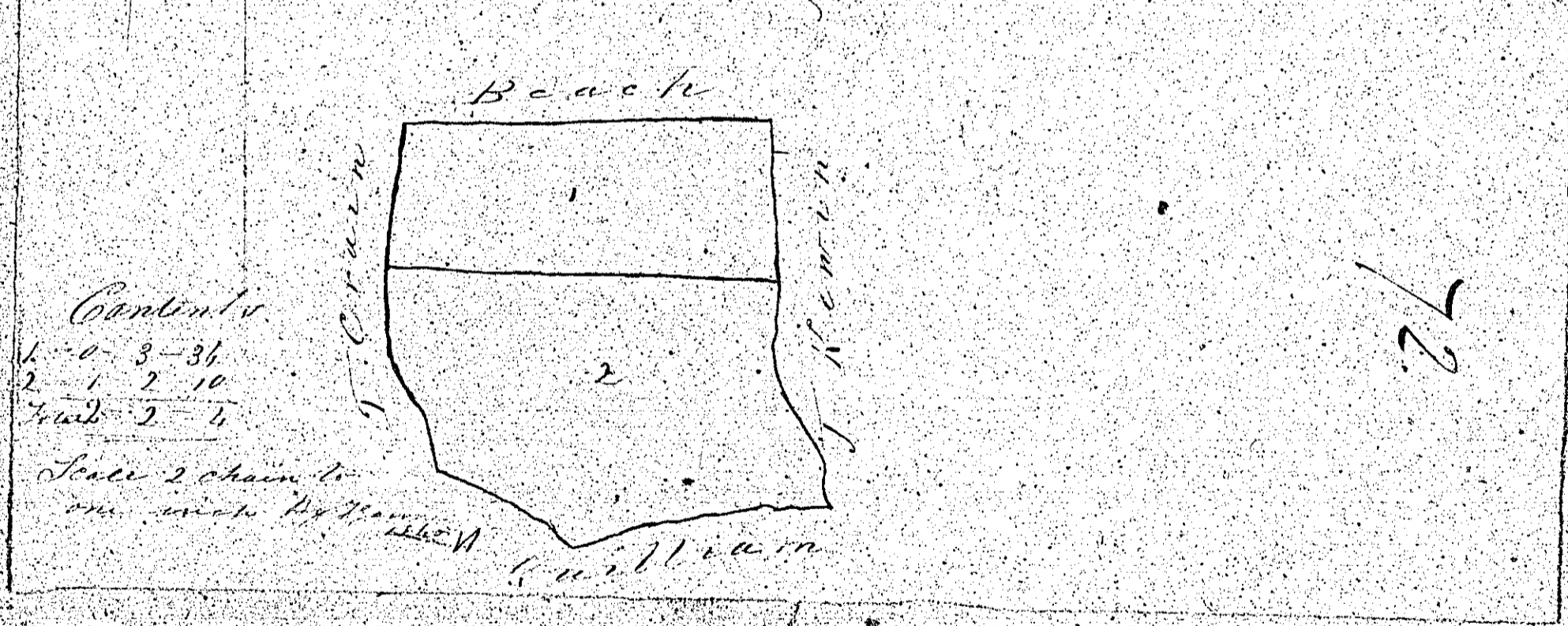

Contents
1. 0 3-34
2. 1 2-10
Total 2-4
Since 2 chains to
... ..

72

W. J. ...

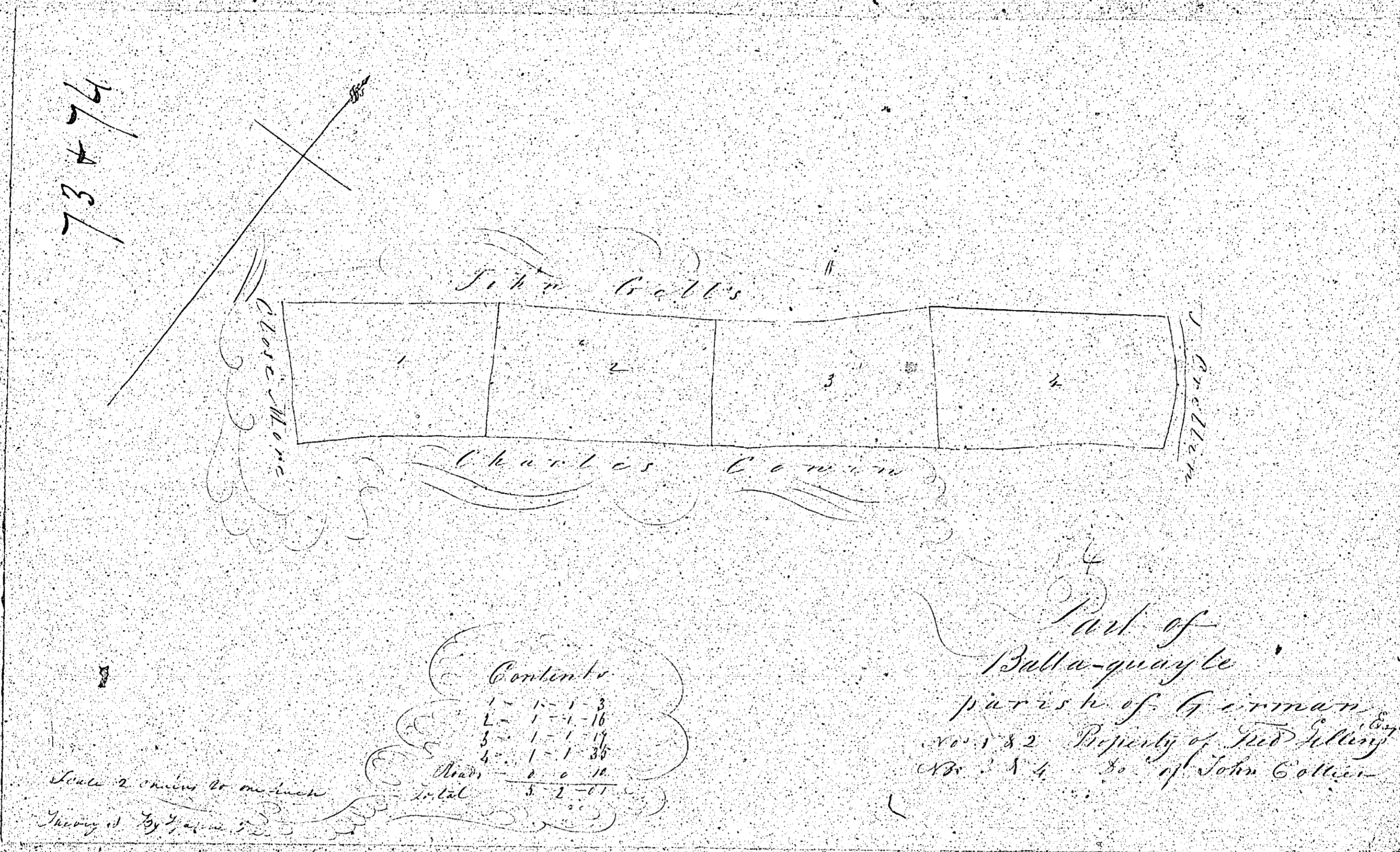

ISLE OF MAN GOVERNMENT: GENERAL REGISTRY

TITHE PLANS: PARISH OF GERMAN

Original monotone

1:30

15
Plan of
Willcroft
Parish of Geismann
Property of Mr. H. Lucas

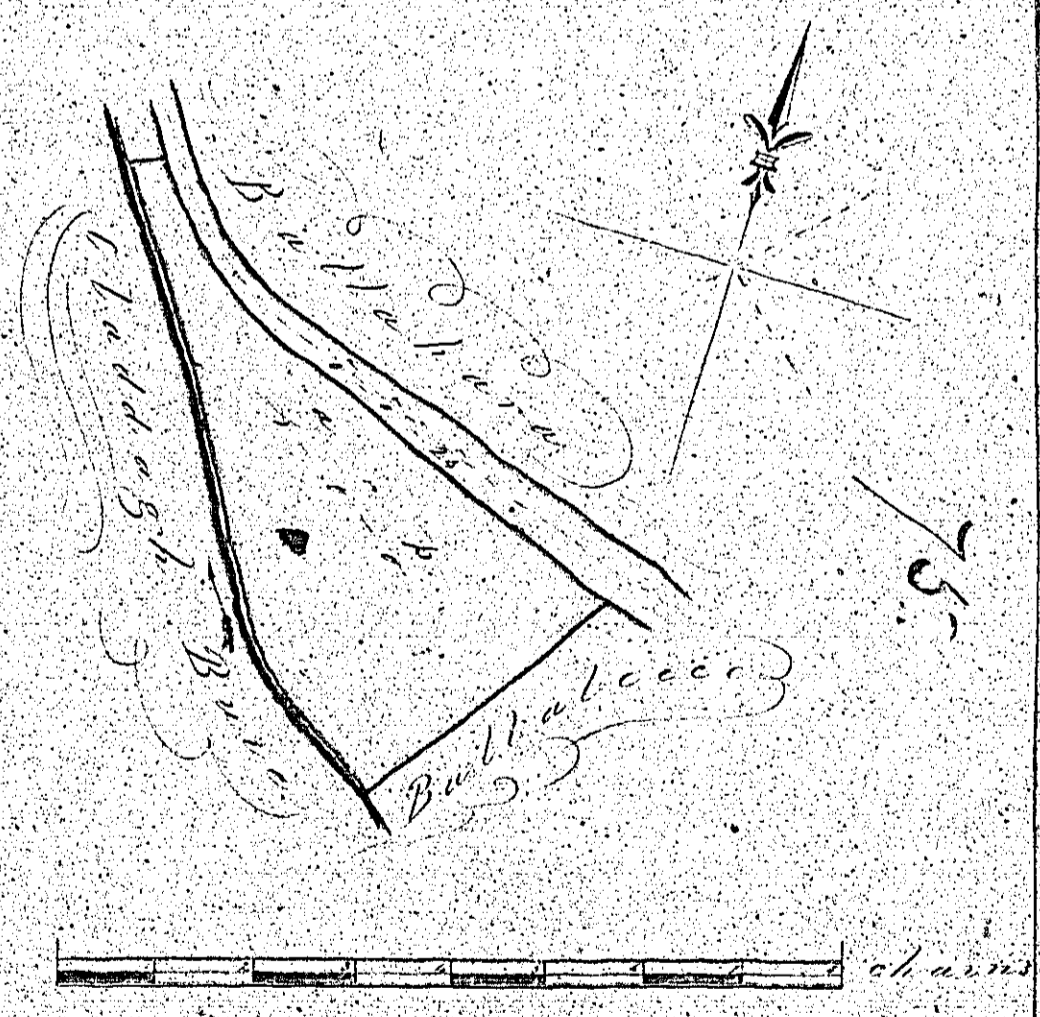

Surveyed By J. Dodd Dec 1840

