

48

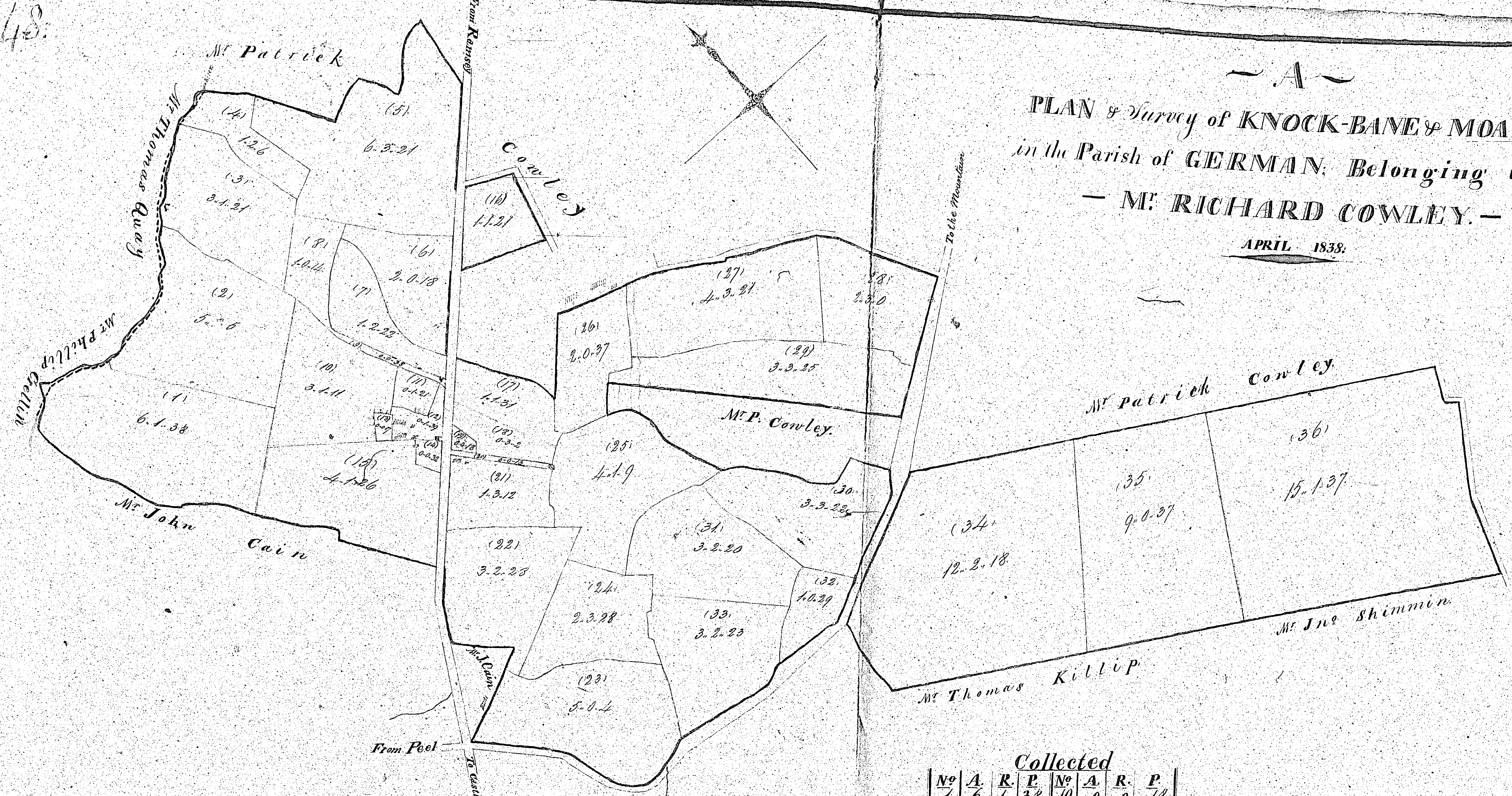

- A -  
 PLAN & Survey of KNOCK-BANE & MOANY  
 in the Parish of GERMAN, Belonging to  
 - MR. RICHARD COWLEY. -

APRIL 1838.

By Wm Cowley  
 Schoolmaster  
 Ballisalla

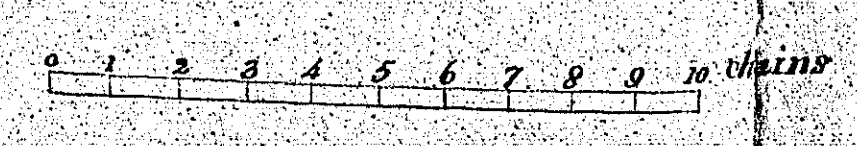

*Collected*

No	A	R	P	No	A	R	P
1	6	1	38	19	0	0	13
2	5	2	5	20	0	0	12
3	3	1	21	21	1	3	28
4	1	2	6	22	3	2	4
5	6	3	21	23	5	0	28
6	2	0	18	24	2	3	0
7	1	2	22	25	1	1	9
8	1	0	14	26	2	0	37
9	0	0	38	27	4	3	21
10	3	1	11	28	2	3	0
11	0	1	21	29	3	3	25
12	0	1	30	30	3	3	22
13	0	0	17	31	3	2	20
14	0	0	32	32	1	0	29
15	4	1	26	33	3	2	23
16	1	1	21	34	12	2	18
17	1	1	31	35	9	0	37
18	0	3	2	36	15	1	37
<b>Total PLAN</b>				122	3	3	4

# Adrian & Surber

of the  
**CROAK-BANE**  
IN THE PARISH OF GERMAN THE PROPERTY OF

**M<sup>r</sup> PATRICK CORREY**  
By Patrick Waddy December 1838



99

	A	B	C
1	0	3	21
2	2	3	30
3	2	1	35
4	1	2	9
5	3	3	18
6	3	1	18
7	2	2	8
8	3	2	28
9	1	2	26
10	4	0	20
11	2	3	27
12	2	2	30
13	3	3	31
14	2	3	31
15	2	2	20
16	3	1	17
17	2	2	2
18	2	0	34
19	3	1	10
20	1	1	10
21	1	3	35
22	2	2	4
Public Road	1	3	33
Total	108	3	23
	113	0	33

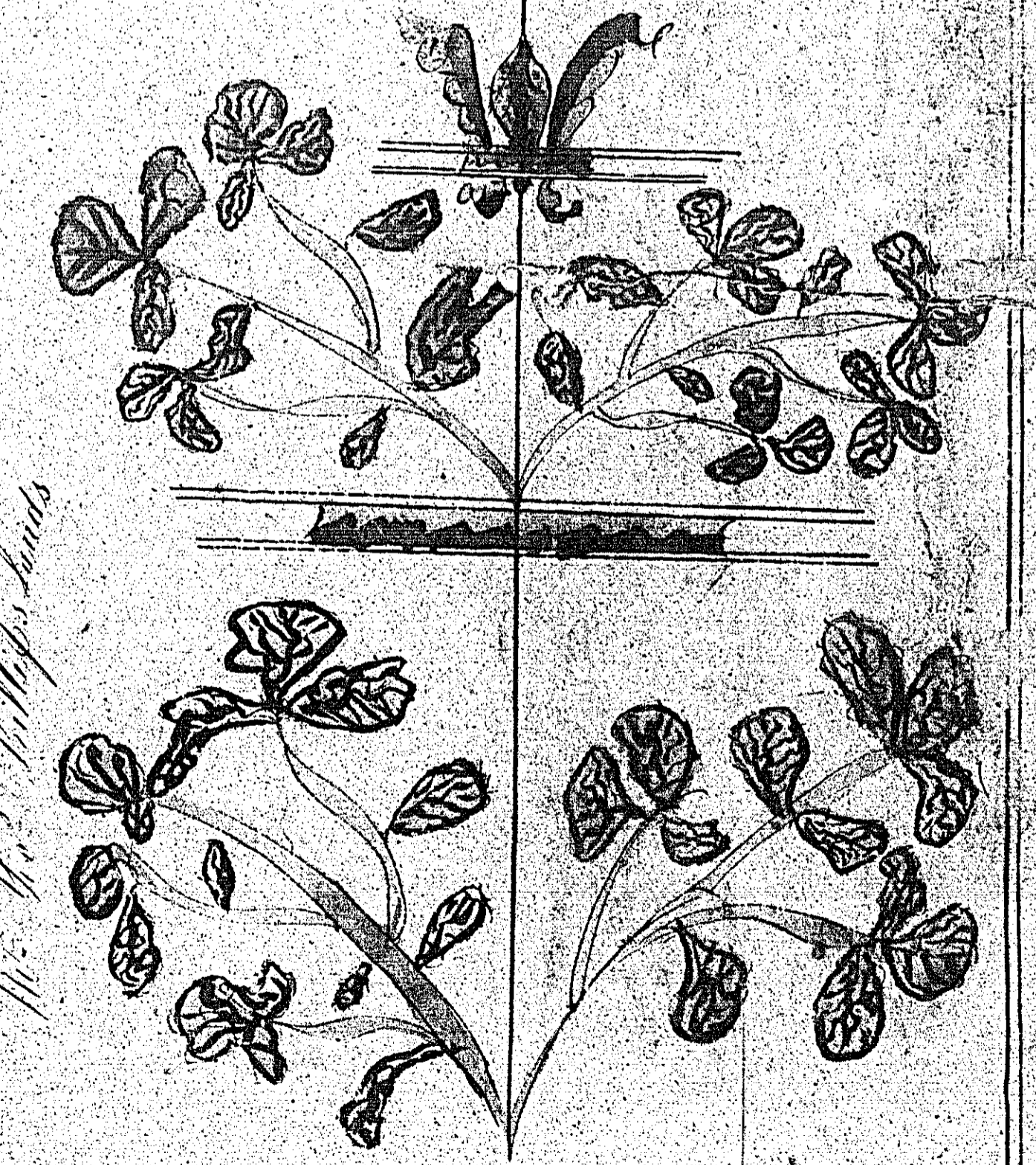

Scale of Chain

50.

Plan and Survey  
 of part of the Quarters of Corvally and Mooney.  
 In the parish of St. K. German  
 The property of  
 Mr. John Cain.

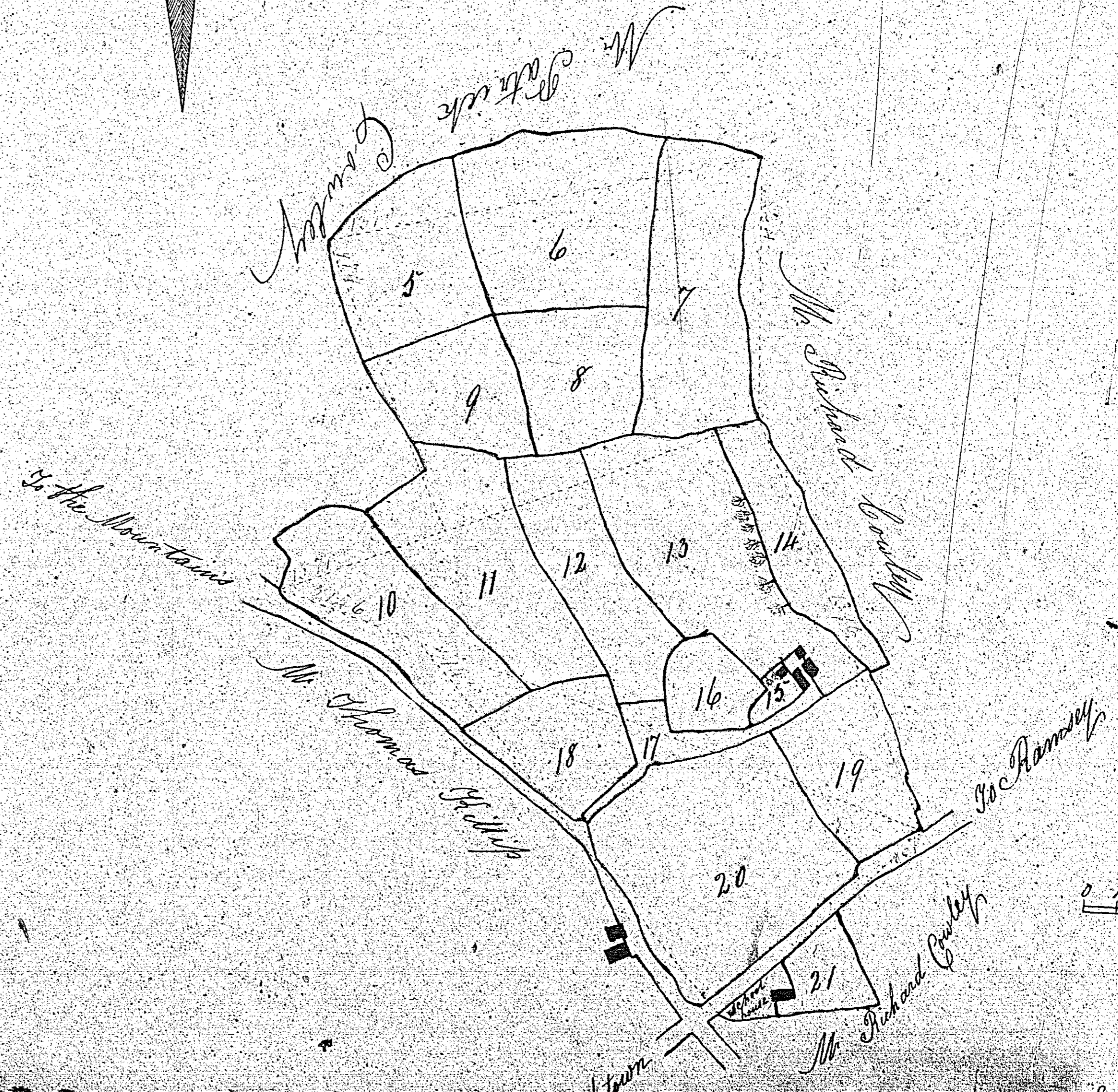
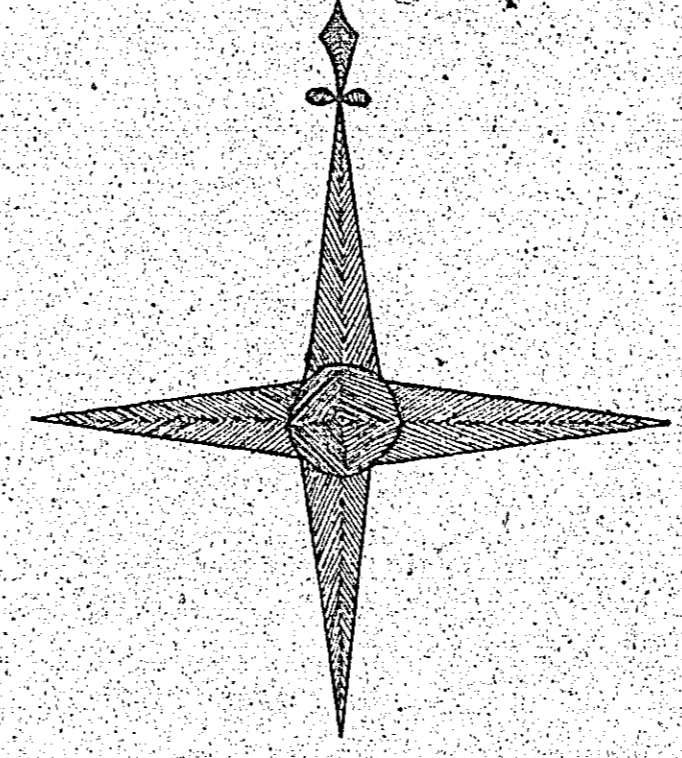
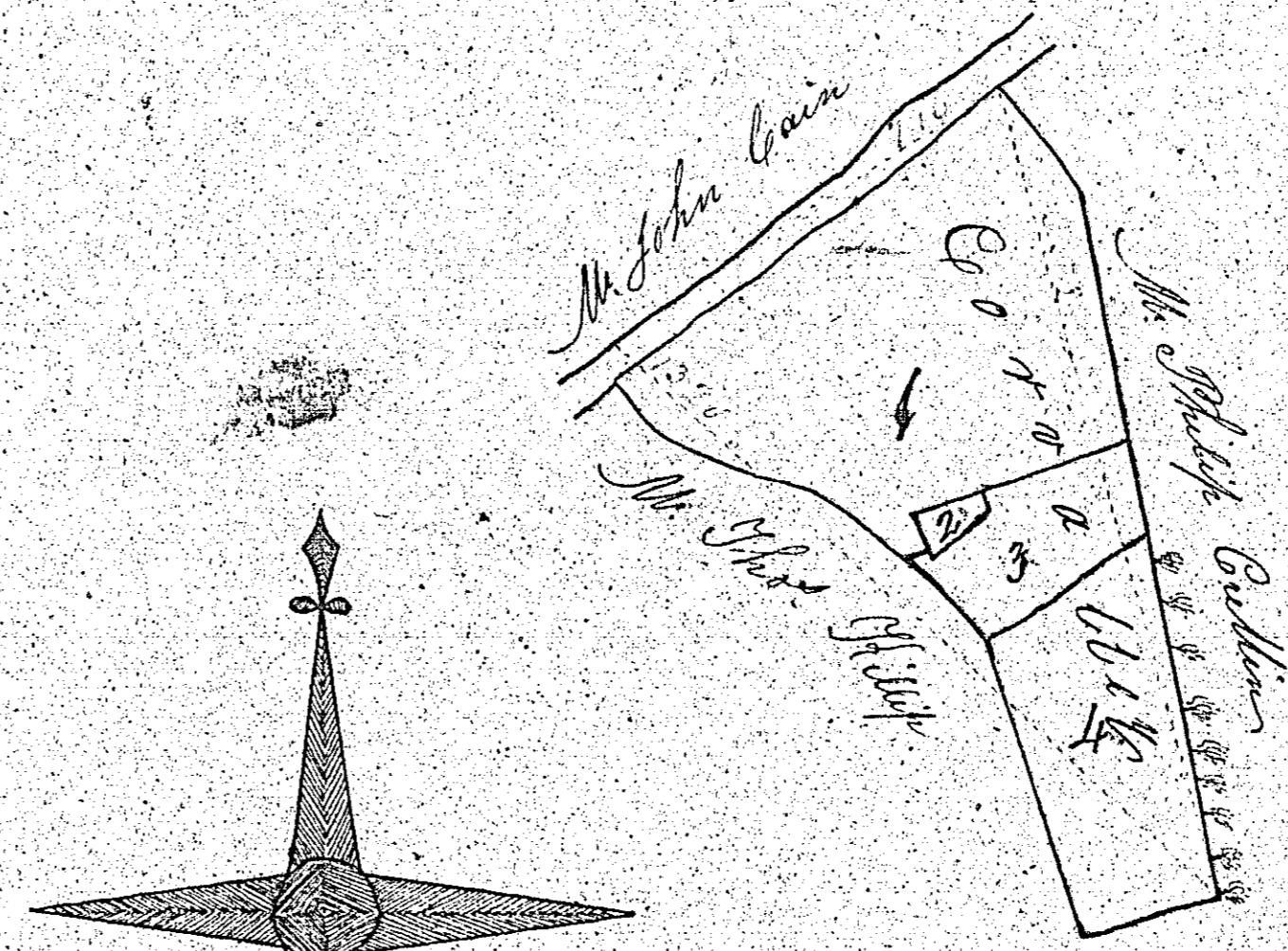

Reference			
No.	A.	R.	Per.
1	3	1	17
2	0	6	18
3	0	2	18
4	1	1	17
5	2	0	17
6	3	0	17
7	2	3	17
8	1	2	16
9	1	1	16
10	2	1	16
11	2	2	16
12	1	1	16
13	3	1	16
14	1	1	15
15	0	0	17
16	0	2	17
17	0	2	17
18	1	1	17
19	1	2	18
20	4	0	22
21	0	2	16
Total Content			37 0 5

0 1 2 3 4 5 6 7 8 9 10 Chains

Surveyed & Bound 1820  
 by William Gullen  
 St. K. German

# PLAN

Of Cottage land in the Parish of R.R. German, called Dreeclang.  
The Property of  
Catherine Crellin

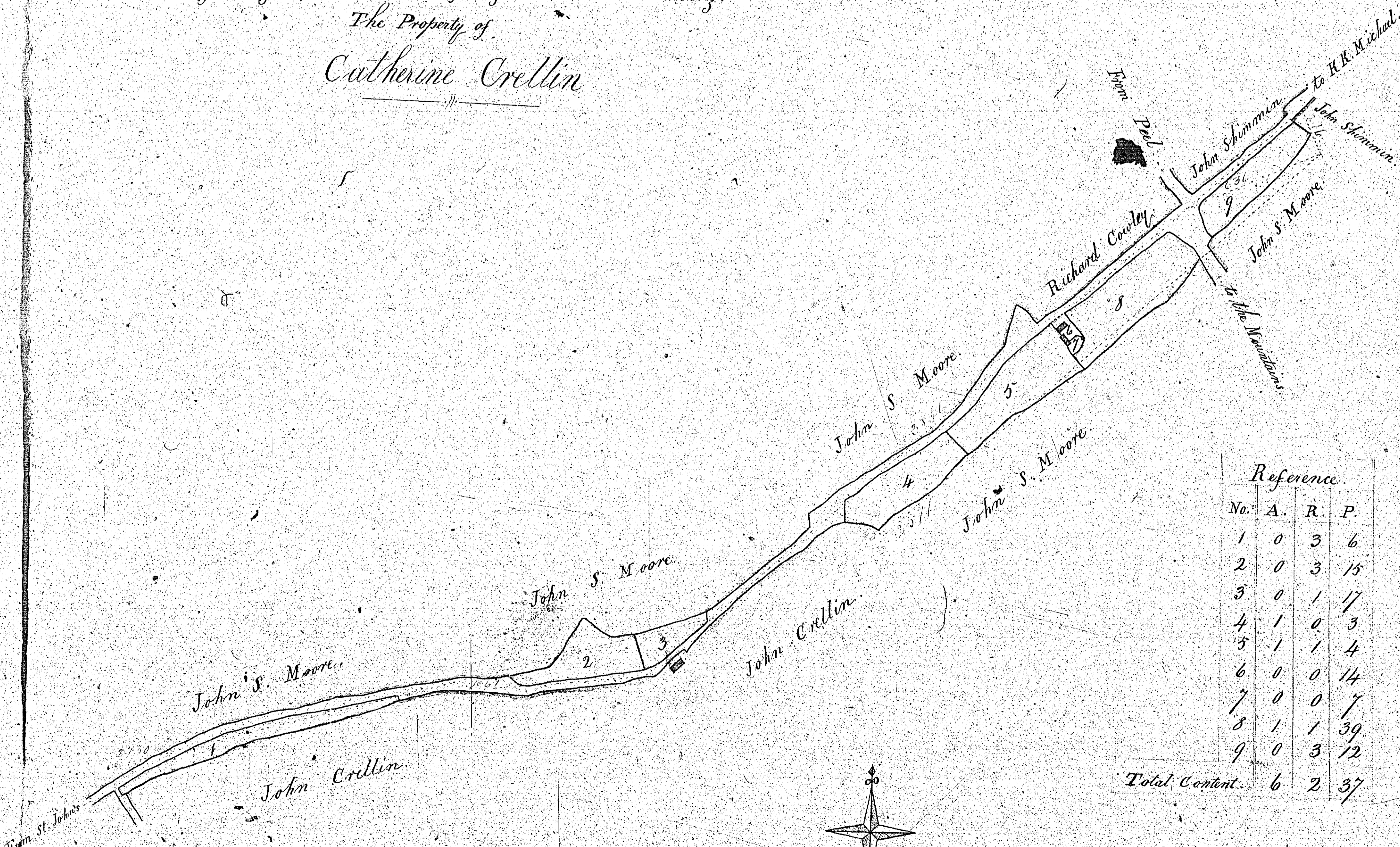

Reference			
No.	A.	R.	P.
1	0	3	6
2	0	3	15
3	0	1	17
4	1	0	3
5	1	1	4
6	0	0	14
7	0	0	7
8	1	1	39
9	0	3	12
Total Content			
	6	2	37

0 1 2 3 4 5 6 7 8 9 10 Chains.

Surveyed July 1840.  
By William Kain  
R.R. German

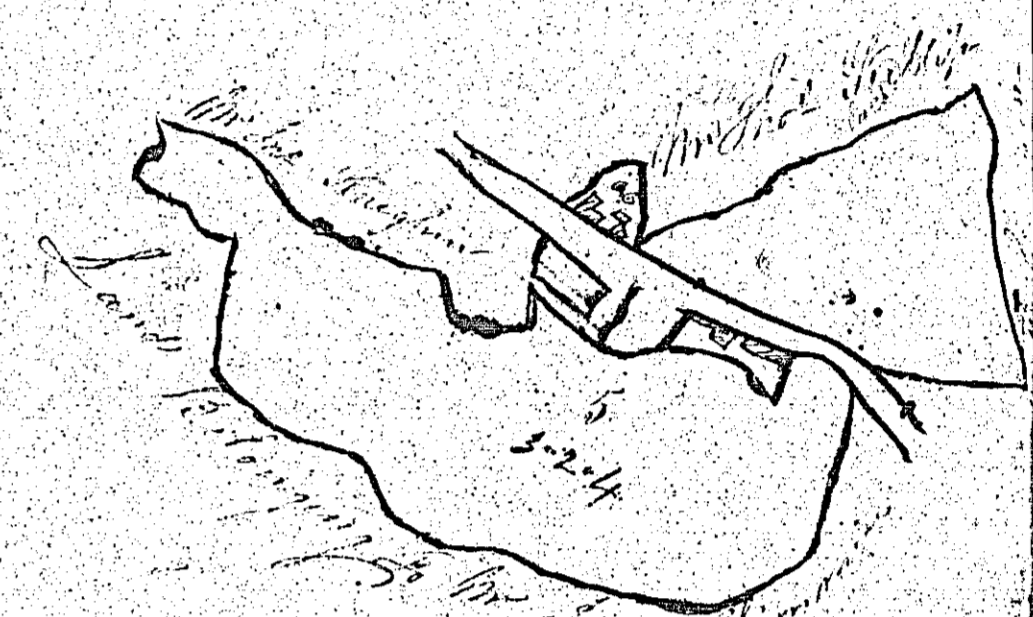

A Plan & Survey of part of  
 Ballabaghin in the Parish of German  
 the property of Mr. August Collier  
 by Robert Hillier Esq. Nov 26 1839

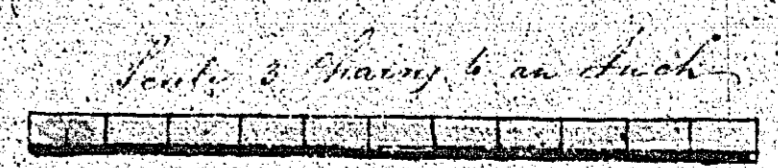
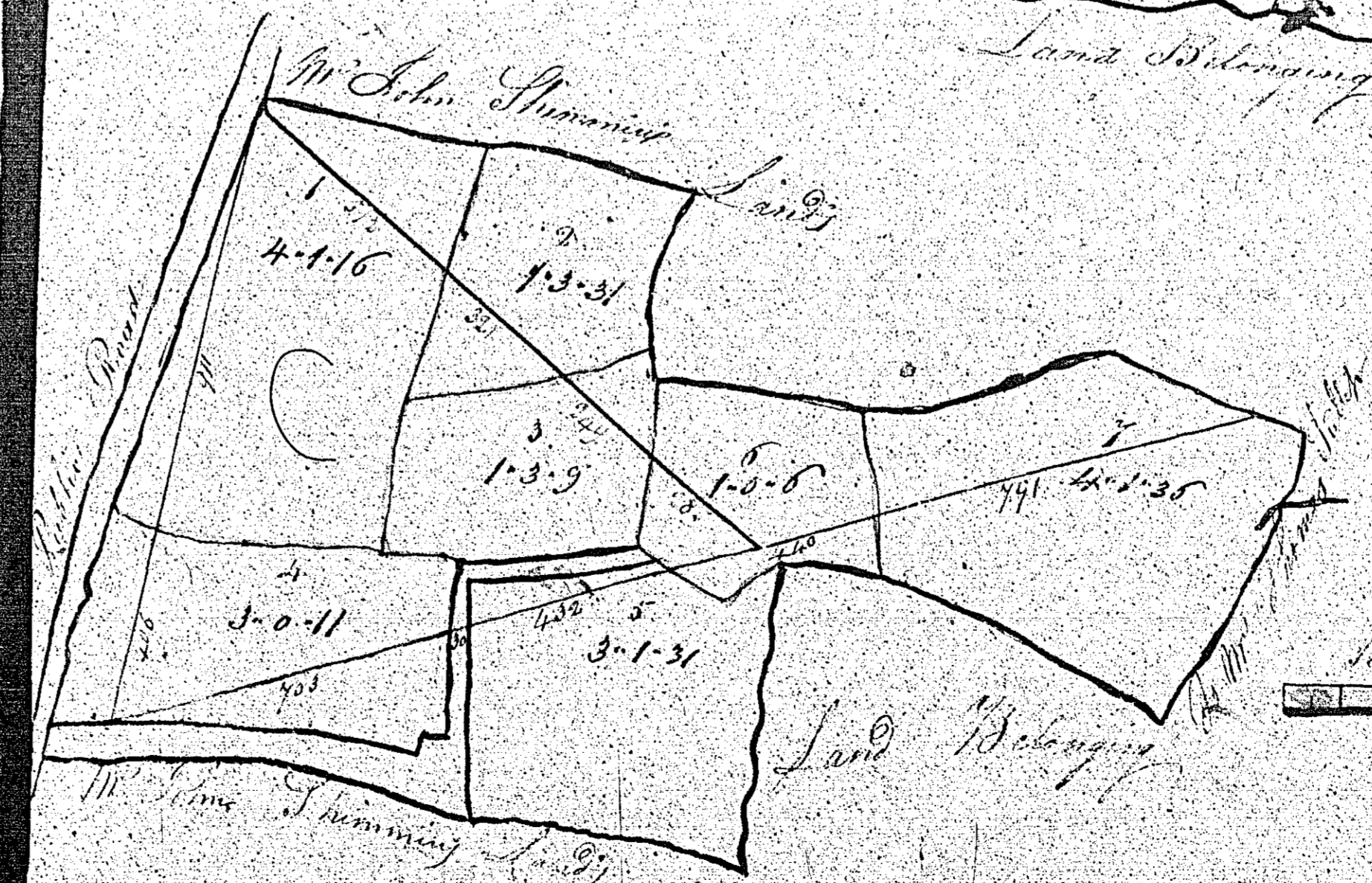
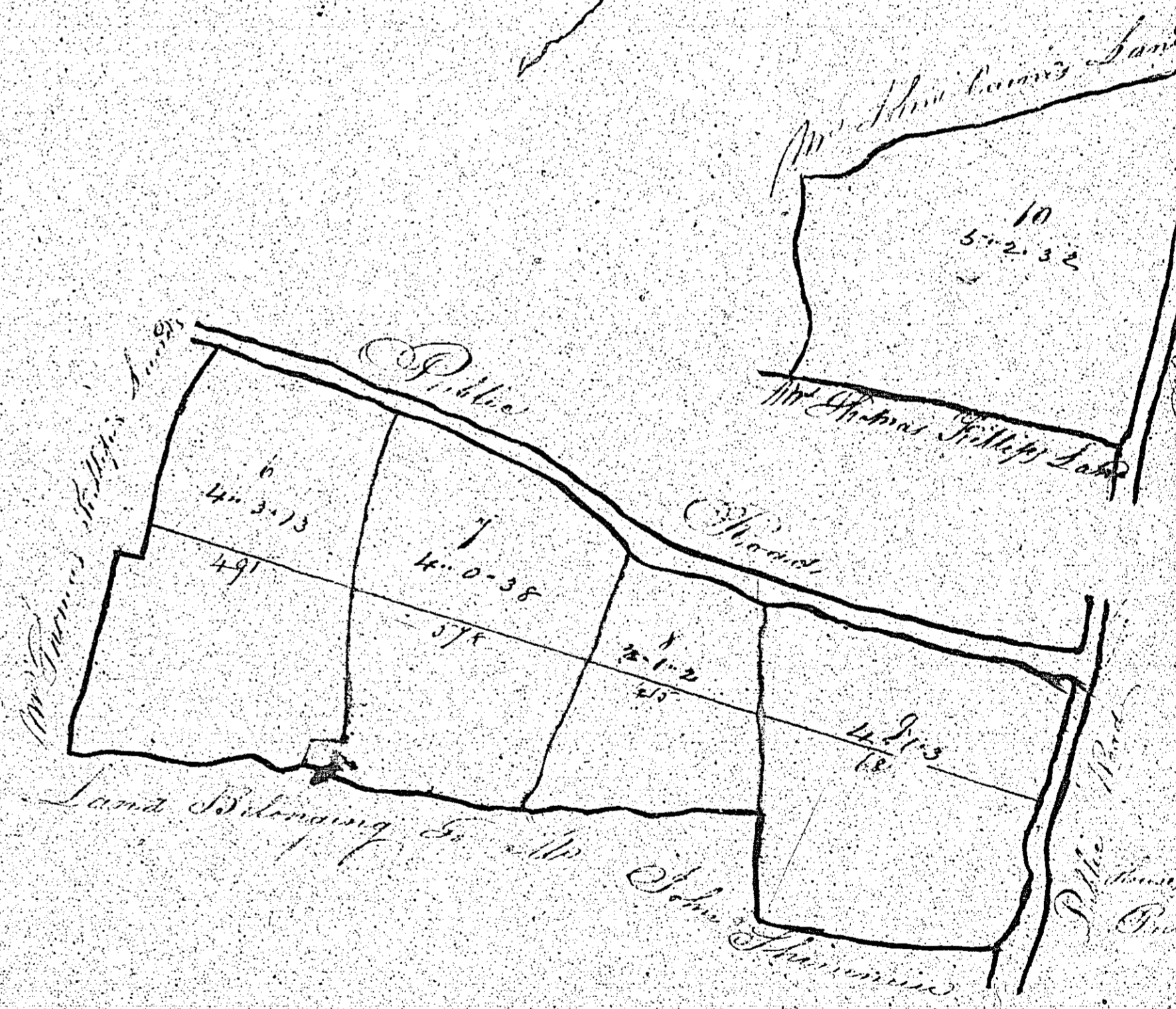

1	4-1-16
2	1-3-31
3	1-3-9
4	3-0-11
5	3-1-31
6	1-0-6
7	4-1-38
8	1-0-17
9	0-1-30
Total 37-1-33	
Total 37-1-33	
Total 37-1-33	

Notes  
53-54-55 (1834-35)

Map of the Town and Survey of Washburn  
in the County of Lincoln  
prepared by  
The Hon. and Majest. Collier  
By Statute 10th Victoria 29th 1839

Scale of Chain and Link  
1" = 100' = 1000 Links

Reference			Reference		
No.	Ac.	R.	No.	Ac.	R.
1	2	5	10	2	5
2	2	10	11	3	2
3	0	9	12	3	0
4	0	17	13	1	1
5	1	6	14	3	0
6	2	3	15	1	2
7	2	33	16	2	2
8	2	33	17	3	0
9	0	35	18	2	2
10	3	11/2	19	1	3
11	1	35 1/2	20	2	2
12	5	8	21	3	2
13	3	22	22	1	3
14	9	32	23	2	2
15	3	12	24	4	3
16	2	26	25	9	0
17	2	26	26	3	2
18	2	24	27	2	2
19	1	32	28	2	1
20	1	32	29	1	0
21	5	31	30	5	0
22	1	11/2			
23	1	35 1/2			
24	78	1			

