

Contents

No.	Acres	Roods	Poles
1	1	1	1
2	3	0	10
3	1	1	12
4	3	2	0
5	4	1	30
6	3	2	0
7	3	0	20
8	0	2	4
9	1	2	18
<hr/>			
	28	4	35
<hr/>			
	10	1	0
	11	0	3
<hr/>			
	4	1	36
<hr/>			
	28	4	35
<hr/>			
Total	29	5	34

Plan of an Estate lying in the parish of K. German being part of the quarterland of Ballinacorney, the property of Charles Cain

June 1839  
Surveyed and Drawn by Hugh Connell School Master at Ballinacorney  
Wm. A. German

an acre to be dedicated to the use of this Minister's office

17.

There is no plan  
numbered 16

PLAN and Survey of Meadow LAND  
 Situate in greeba and Belonging to the Estate of  
**BALLIGG** in the parish of  
**KK. GERMAN** the property of  
**MR. JOHN CRELLIN**

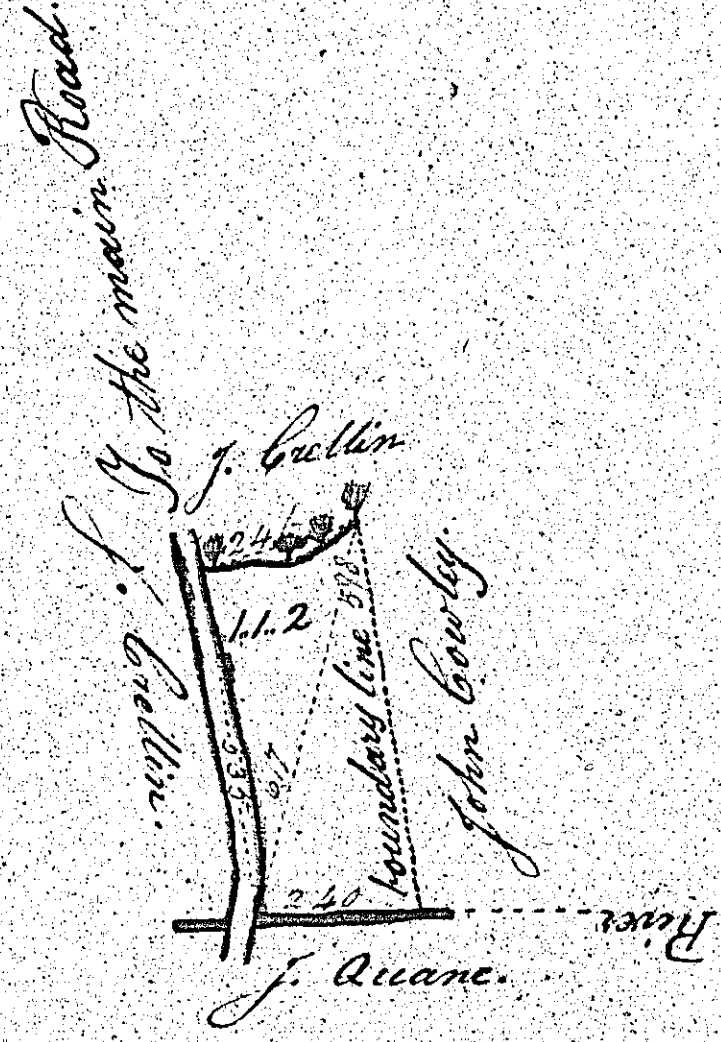
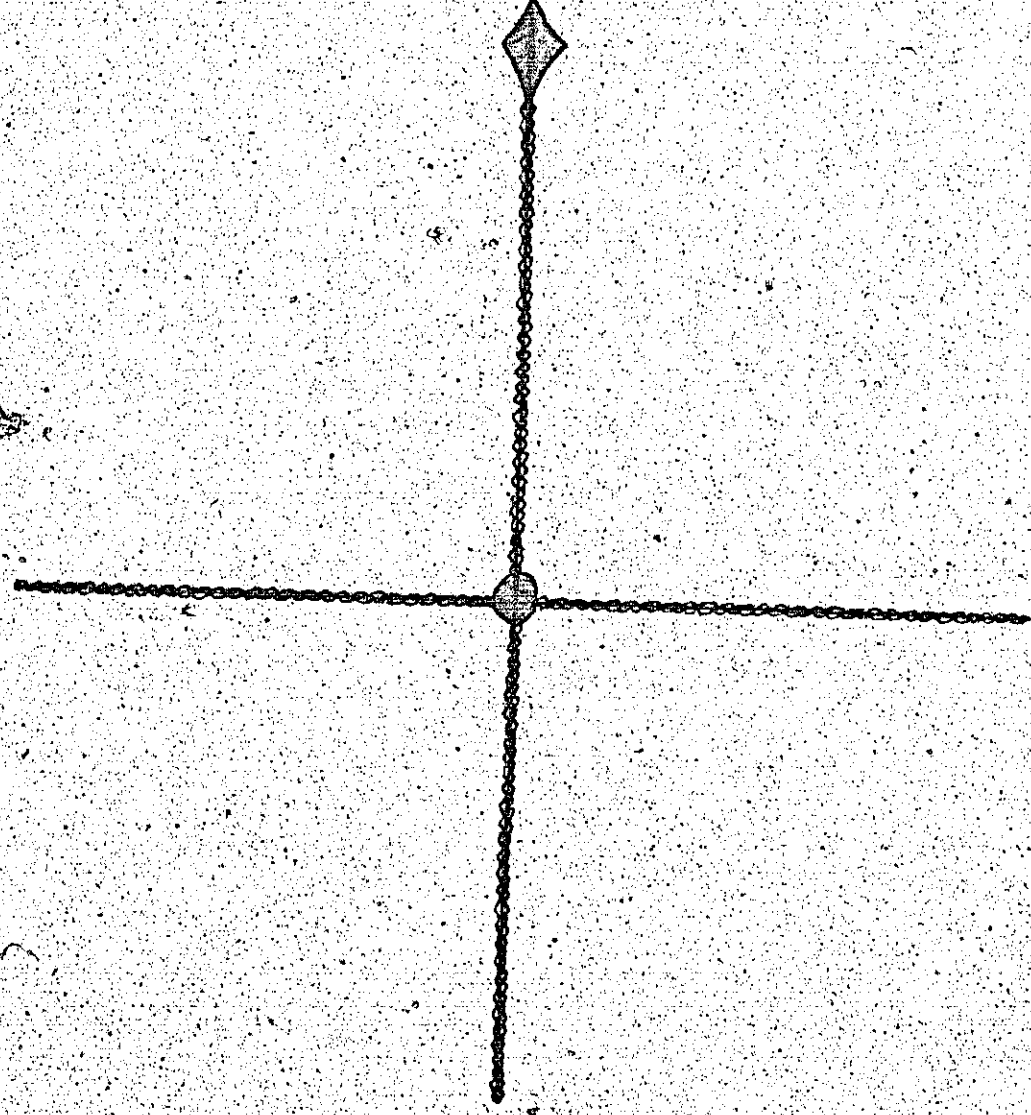

Total Content of meadow <sup>a. r. p.</sup> 1. 1. 2

Total Content of Road and River <sup>a. r. p.</sup> 0. 0. 19

0 1 2 3 4 5 6 7 8 9 10 Chains

Surveyed November 1839.  
 By William Haighin  
 for Mr. German.

ISLE OF MAN GOVERNMENT: GENERAL REGISTRY

TITHE PLANS: PARISH OF GERMAN

Original coloured

1:30

PLAN AND SURVEY  
OF  
GRONK BEECK QUARTERLAND  
THE PROPERTY OF  
**MESSRS J AND C CRELLIN**  
GERMAN  
BY DANIEL CRELLIN BALLAGHAGHAN 1838

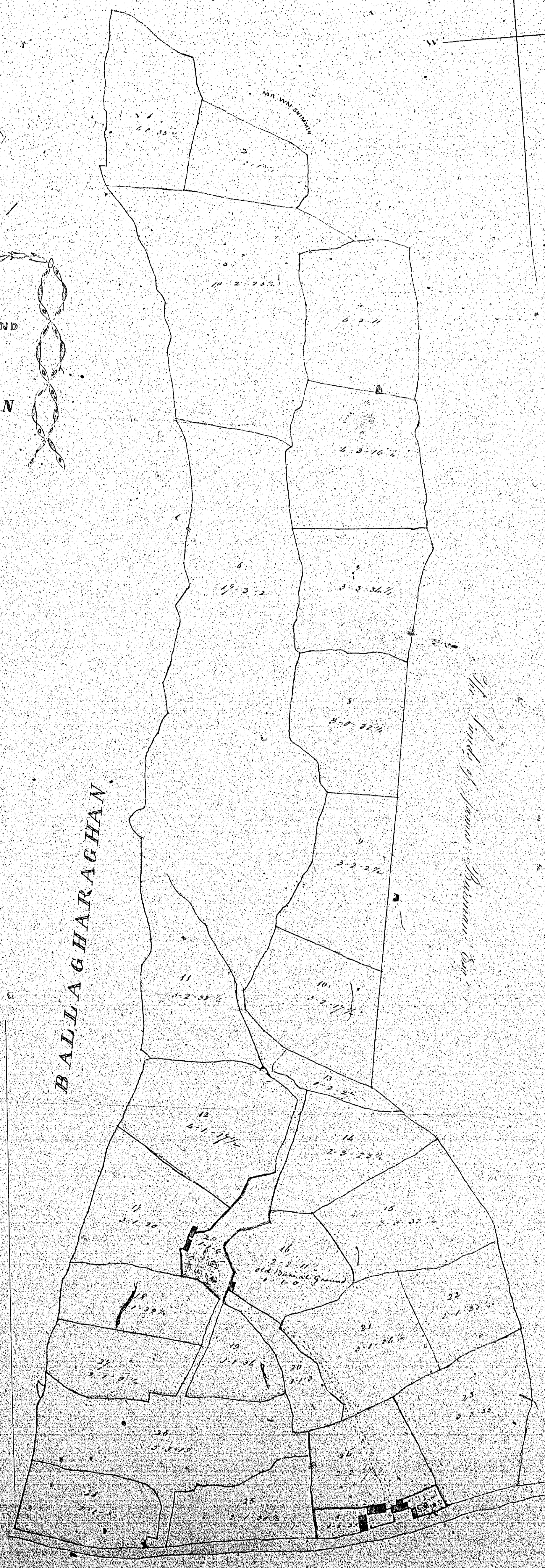

	A	R	P
1	2	0	0.50
2	2	0	0.50
3	2	0	0.50
4	2	0	0.50
5	2	0	0.50
6	2	0	0.50
7	2	0	0.50
8	2	0	0.50
9	2	0	0.50
10	2	0	0.50
11	2	0	0.50
12	2	0	0.50
13	2	0	0.50
14	2	0	0.50
15	2	0	0.50
16	2	0	0.50
17	2	0	0.50
18	2	0	0.50
19	2	0	0.50
20	2	0	0.50
21	2	0	0.50
22	2	0	0.50
23	2	0	0.50
24	2	0	0.50
25	2	0	0.50
26	2	0	0.50
27	2	0	0.50
28	2	0	0.50
29	2	0	0.50
30	2	0	0.50
31	2	0	0.50
32	2	0	0.50
33	2	0	0.50
34	2	0	0.50

18.

Handwritten note at the bottom right of the map area.

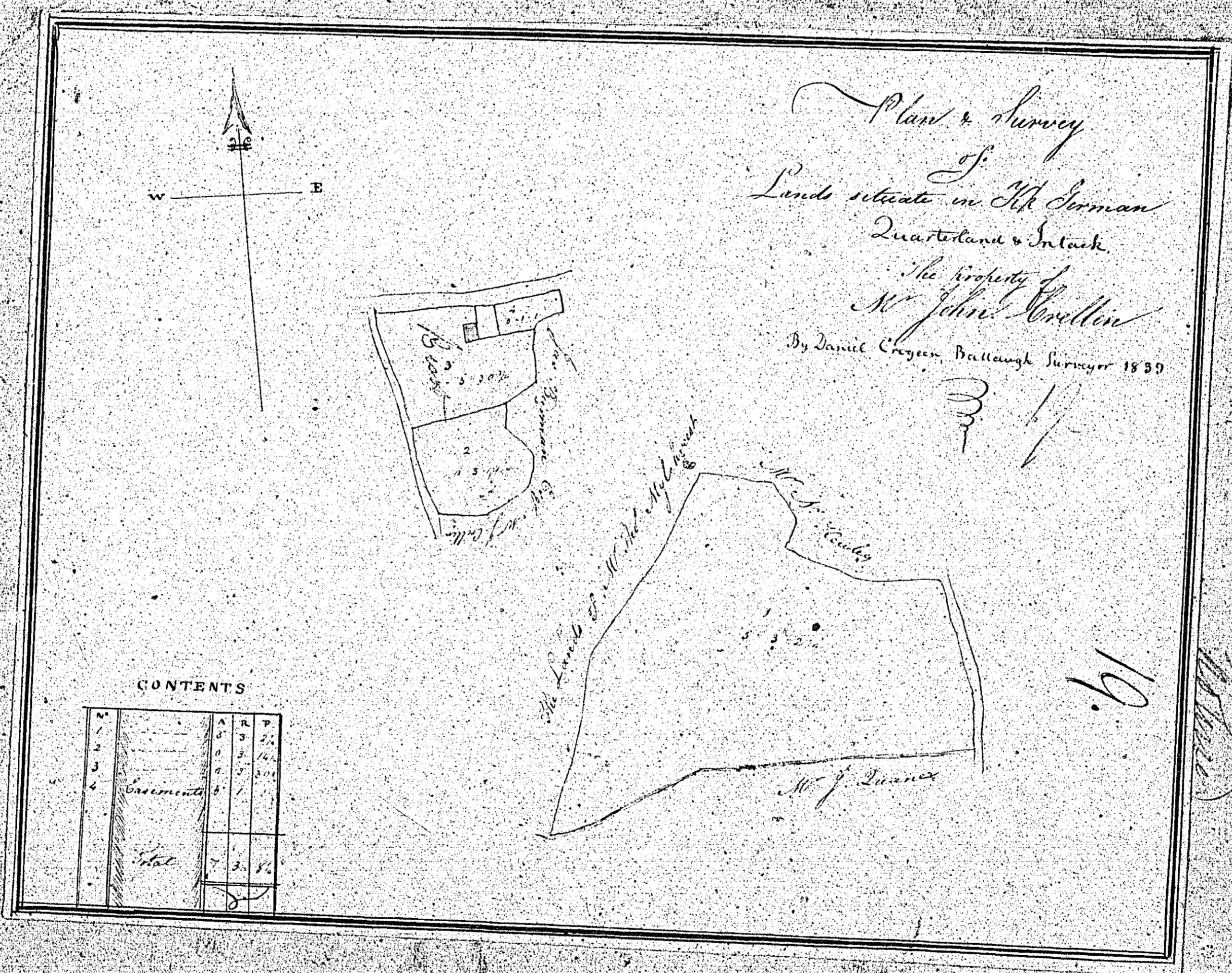

PLAN and Survey of Woods LAND  
situate near Ballacormie and belonging to the Estate of  
BALLALIGG in the Parish of KK-GERMAN  
The property of  
M. JOHN CRELLIN

PLAN and Survey of Meadow LAND  
 Situate near Ballacraane and belonging to the Estate of  
 BALLALIGG in the parish of KK: GERMAN  
 The property of  
 M<sup>r</sup>. JOHN CRELLIN

20.

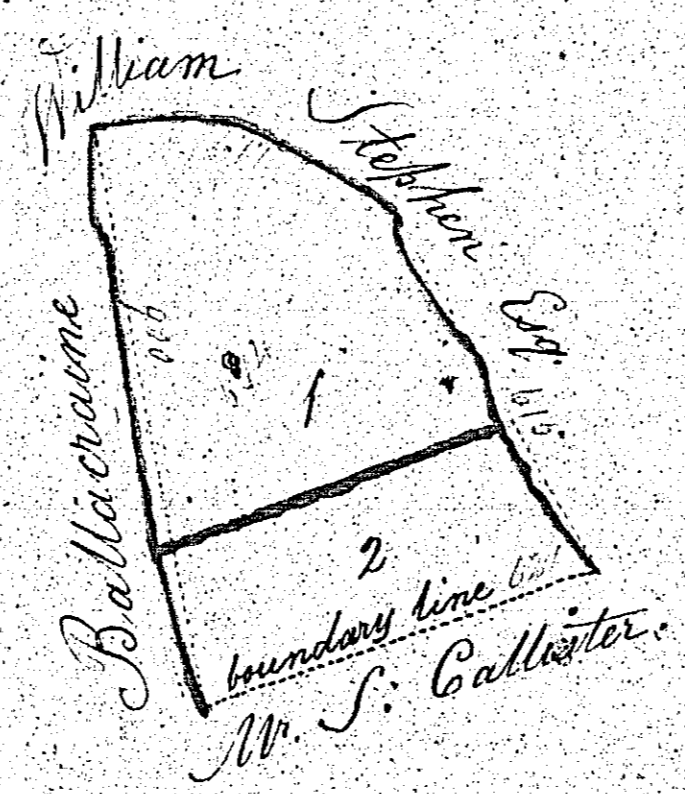
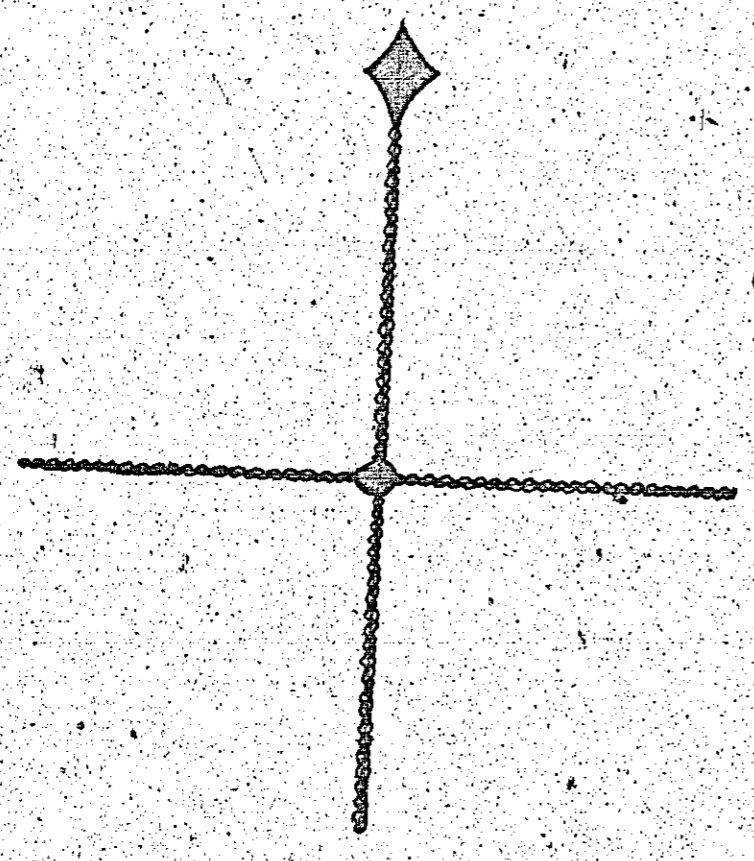

Reference

No	a.	r.	p.
1	2	2	15
2	1	1	35
Total 4 0 10			

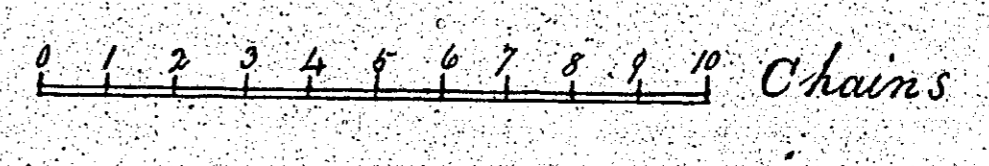

Surveyed November 1839  
 By William Haighin  
 New N.H. German.

ISLE OF MAN GOVERNMENT: GENERAL REGISTRY  
 TITHE PLANS: PARISH OF GERMAN  
 Original coloured (decorative) 1:30