

95

M

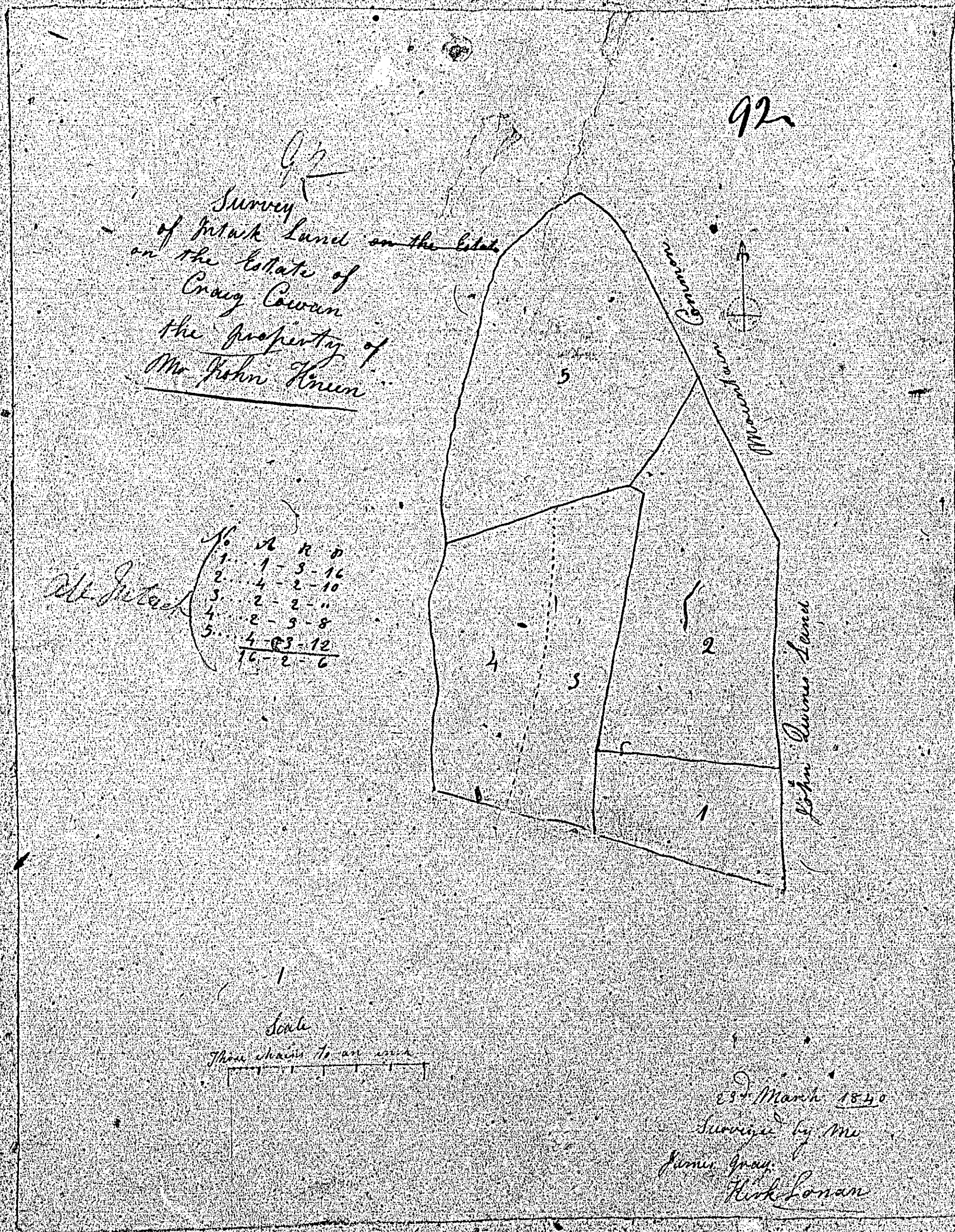



95

111



93

Survey  
 of a half town  
 and the divisions  
 on the block of  
 Craig Green  
 Clerk Briddon  
 the property of  
 Mrs. Catherine Mann

$$\begin{array}{r} 40 \\ 20 \\ \hline 60 \end{array}$$

Seal  
 James Gray  
 Clerk

25<sup>th</sup> March 1841.  
 Surveyed by me  
 James Gray  
 Clerk

95

M



94  
+ 94  
94  
Plan of house & garden  
Part of Court House  
Belonging to  
Mr John Kelly  
April 1840 N. York

95  
Plan

At the Union Mills



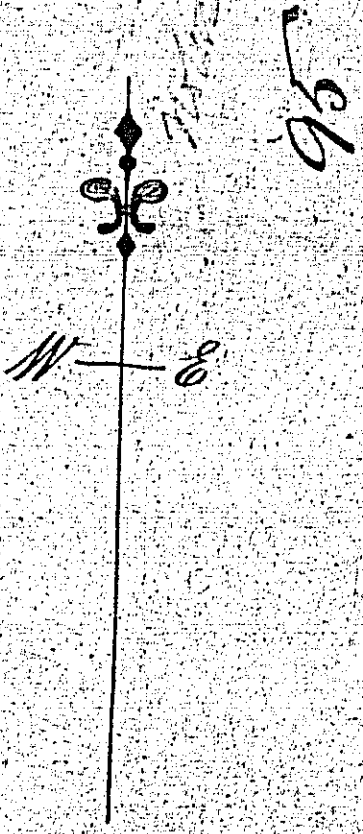

*A Plan of  
a part of  
Ballawittin  
in the Parish of  
Braddan  
the property of  
Miss Ely Kelly*

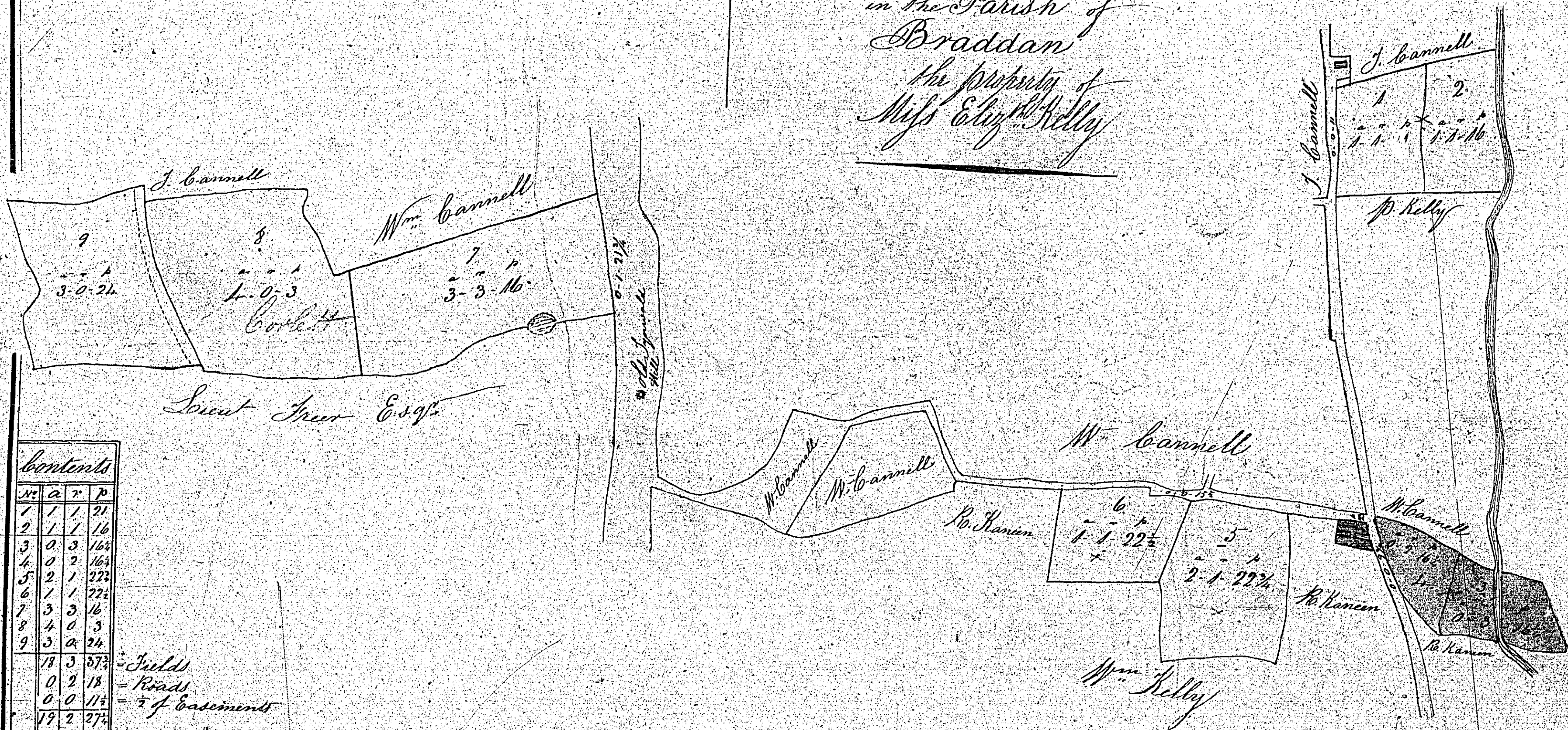

*Contents*

No.	Ac.	R.	P.
1	1	1	21
2	1	1	16
3	0	3	16
4	0	2	16
5	2	1	22
6	1	1	22
7	3	3	16
8	4	0	3
9	3	0	24
18	3	5	7
0	2	1	8
0	0	1	1
12	2	2	7

*Fields*  
*Roads*  
*of easements*

*Scale of 3 chains to One Inch*

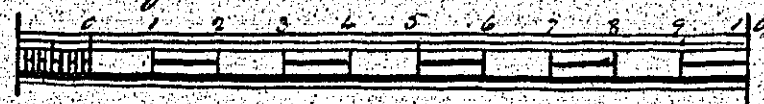

*No. of Easements  
Being 6. R. Hanon  
and 6. E. Kelly*

*J. Sewell Surveyor  
1839*

ISLE OF MAN GOVERNMENT: GENERAL REGISTRY

TITHE PLANS: PARISH OF BRADDAN

Original coloured

1:30



96  
 A Plan and Survey  
 of a Garden Dwellinghouse  
 and out offices at the  
 Strand part of Cosen Lane  
 in the Parish of Bradenham  
 the property of  
 William Kelly  
 Surveyed by  
 Tho<sup>o</sup> Corlett  
 17<sup>th</sup> Decem<sup>r</sup>  
 1840

96

20 paces from Bradenham

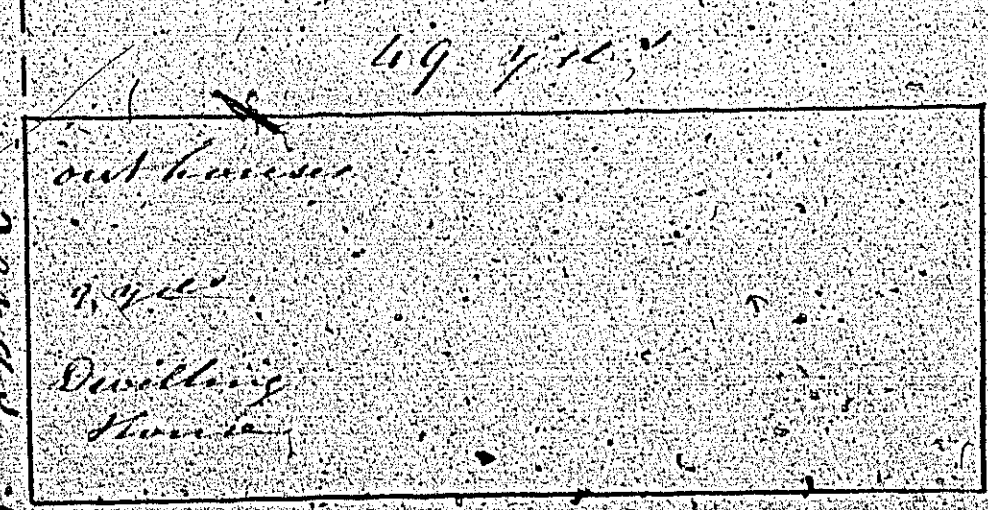

Scale 10 20 30 40 Paces