

93.

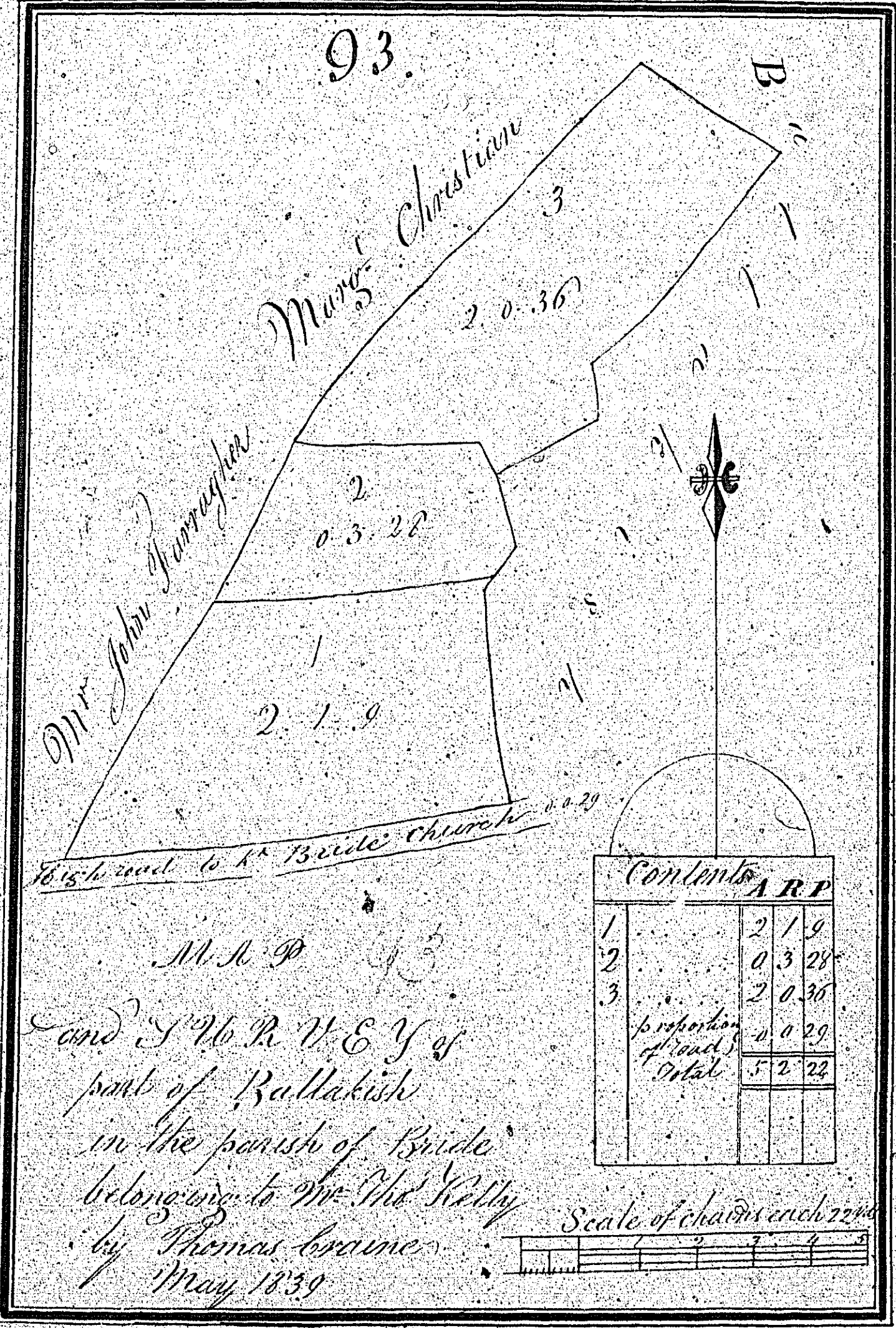

Contents		AR P
1		2 1 9
2		0 3 22
3		2 0 36
	proportion of road	0 0 29
	Total	5 2 22

M. N. P. 13
 and J. N. R. N. E. Y. of
 parts of Ballakish
 in the parish of Bride
 belonging to Mr. M. Kelly
 by Thomas Craune
 May 1839

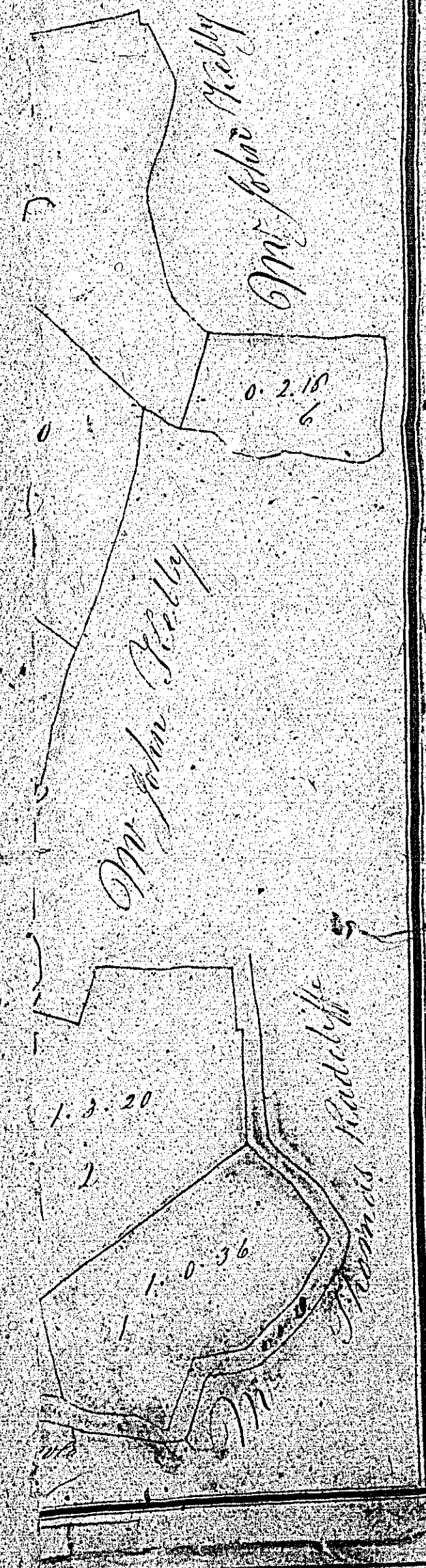

No. 95
 and S. W. R. T. & Y. of
 part of Ballycarnad
 in the parish of Bride
 the property of
 Mr. John Kelly
 by Thomas Evans
 May 28th 1839

Mr. W. Moran

0.1.11

5

1.3.30

11

1.1.25

7

1.0.38

3

2.0.2

6

32.0.0

9

Contents	ac	r	q
1	2	0	2
2	1	1	26
3	1	0	58
4	1	3	10
5	0	1	18
6	0	2	23
Total	7	2	19

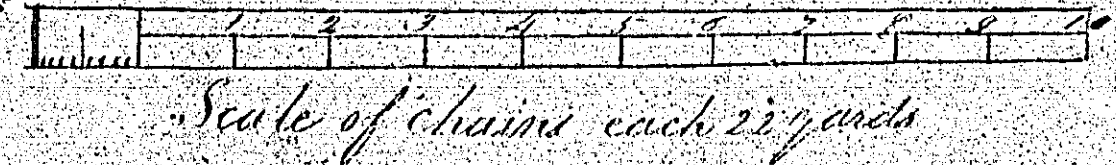

Shelag
 in
 Bride
 belong to
 Tho. Kelly
 May 1839

95

1120

99

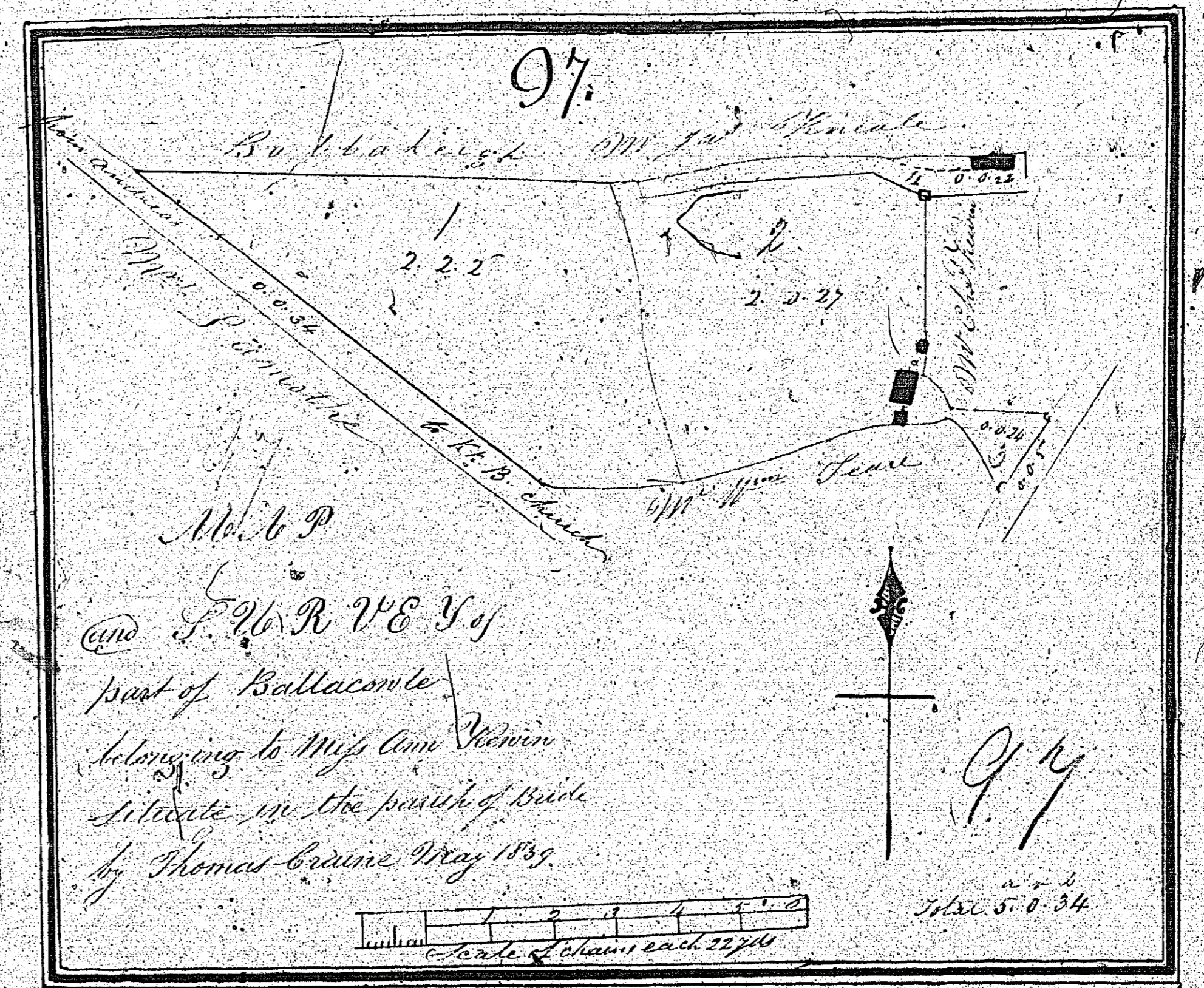

97
Shelag
in
Bride
belong to
Tho. Kelly
May 1839

Not used

Contents

1	2-1
2	3-32
3	2-2-35
4	3-2-12
5	2-4-34

Contents

1	0-0-8
2	0-0-39
3	0-2-36
4	1-0-17
<hr/>	
Sum	2-0-20

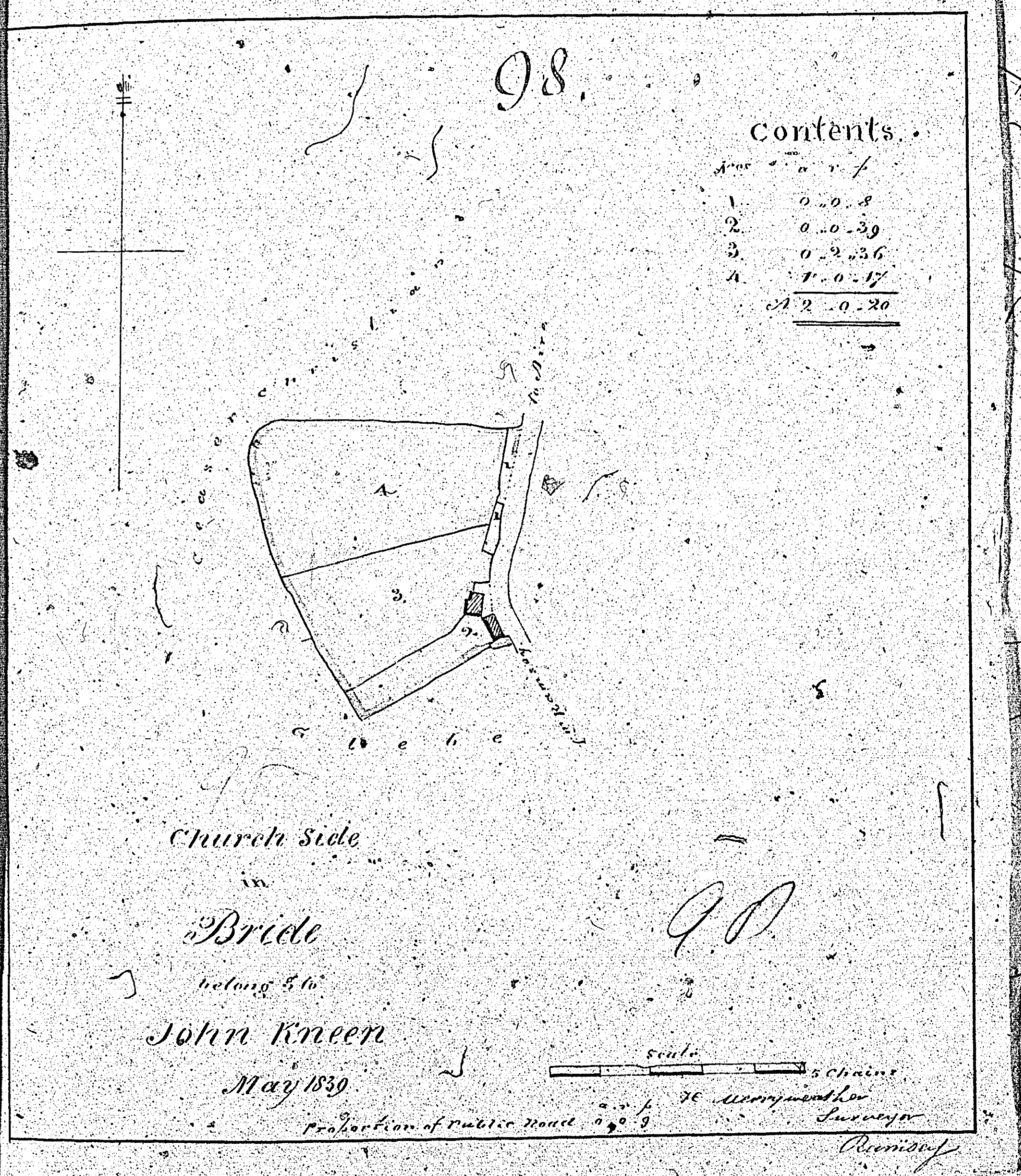

Church side

Bride

belong to

John Kneen

May 1839

Scale 10 chains

Proportion of Public Land 1839

Almond

Shelag

in

Bride

belong to

Thos Kelly

May 1839

St. Mary's

Surveyor

Scale 10 chains