

Plan
of
the Rectory
Parish of Bradban
The Property of
Mr. Tho. Cain.

1	a r b l h	1, 2, 13 - 275
2		1, 1, 27 - 152
3		1, 3, 7 - 215
4		1, 2, 31 - 59
5		1, 1, 17 - 138
6		2, 1, 11 - 535
7		1, 2, 22 - 570
8		2, 0, 16 - 335
9		1, 3, 15 - 93
10		2, 0, 30 - 593
11		1, 3, 36 - 290
12	Upper Old hedge	1, 2, 16 - 177
	below D ^o	0, 1, 36 - 102
13		1, 2, 5 - 205
14		2, 1, 5 - 124
15		2, 0, 23 - 125
	Orchard and plantation	0, 2, 18 - 327
	Contents of fields and garden	28, 1, 15 - 170
	Contents of house and 8 houses	0, 1, 23 - 311
Total Contents		28, 2, 38 - 481

A R P - 1 acre



Tho. Coughlin
The Bradban

PLAN 15
of
BALLAKENNISH
Parish of Braddan
The Property of
MR W. RAINE

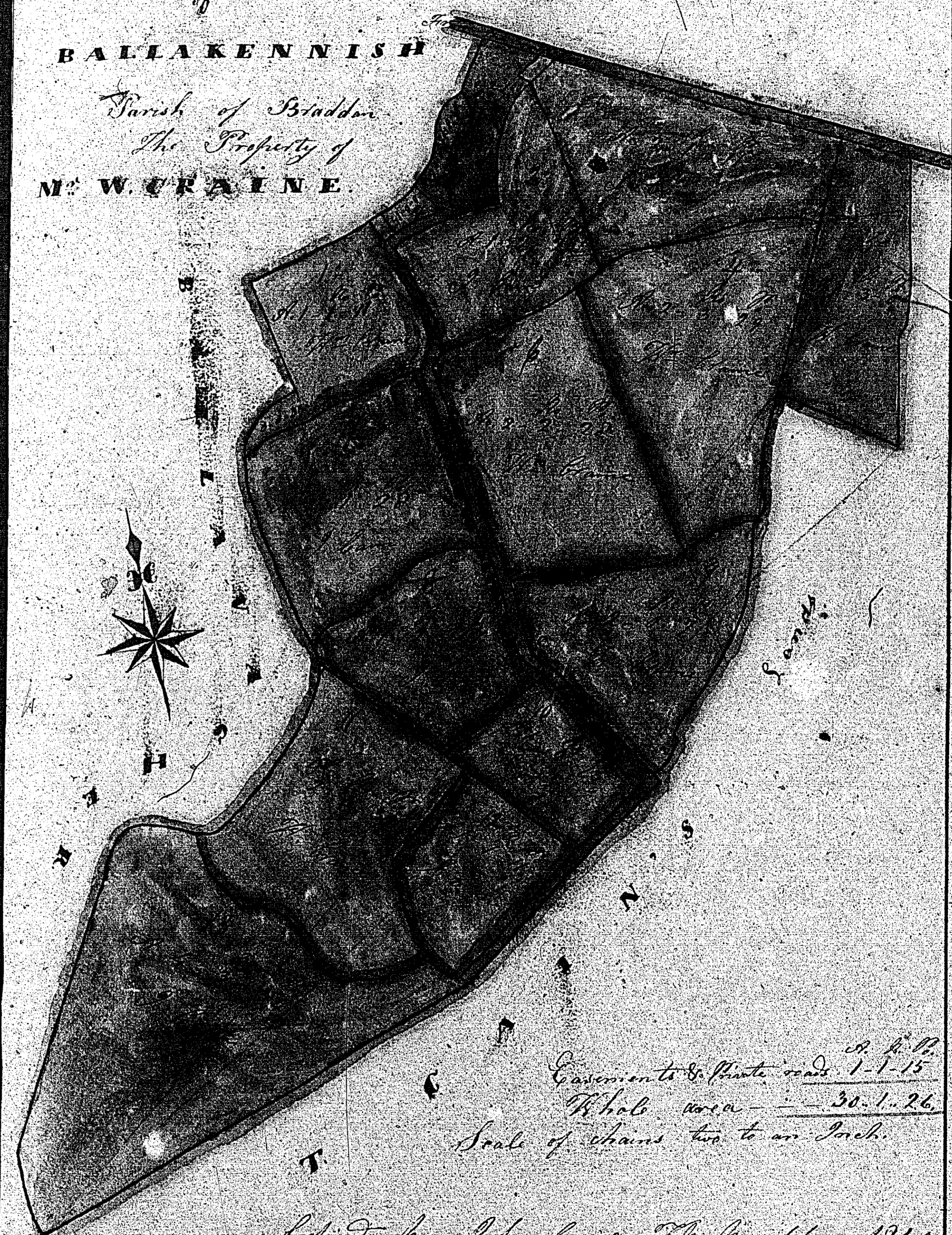

Enclosures & Paths roads 1-1-15
Whole area 30.1.26
Scale of chains two to an Inch.

Copied by John Bruce Esq Braddan 1840

Ballakennish

0.38

Plan
of part of
Ballinint 17
Parish of Braddan
The Property of
Messrs Cowin

17

W. Mountain Land



W. Lower Land

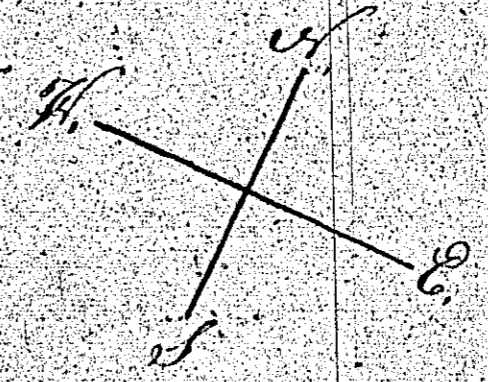

Reference

No.	Acres	R.	P.
1	1	3	6
2	1	2	51
3	1	2	53
4	1	2	36
Arrears	0	0	36
Total	4	0	22

Scale Three to an Inch

J. Lewis W. Braddan 1840

This is right

Handwritten notes and sketches on the right margin, including the number '1107' and some illegible scribbles.

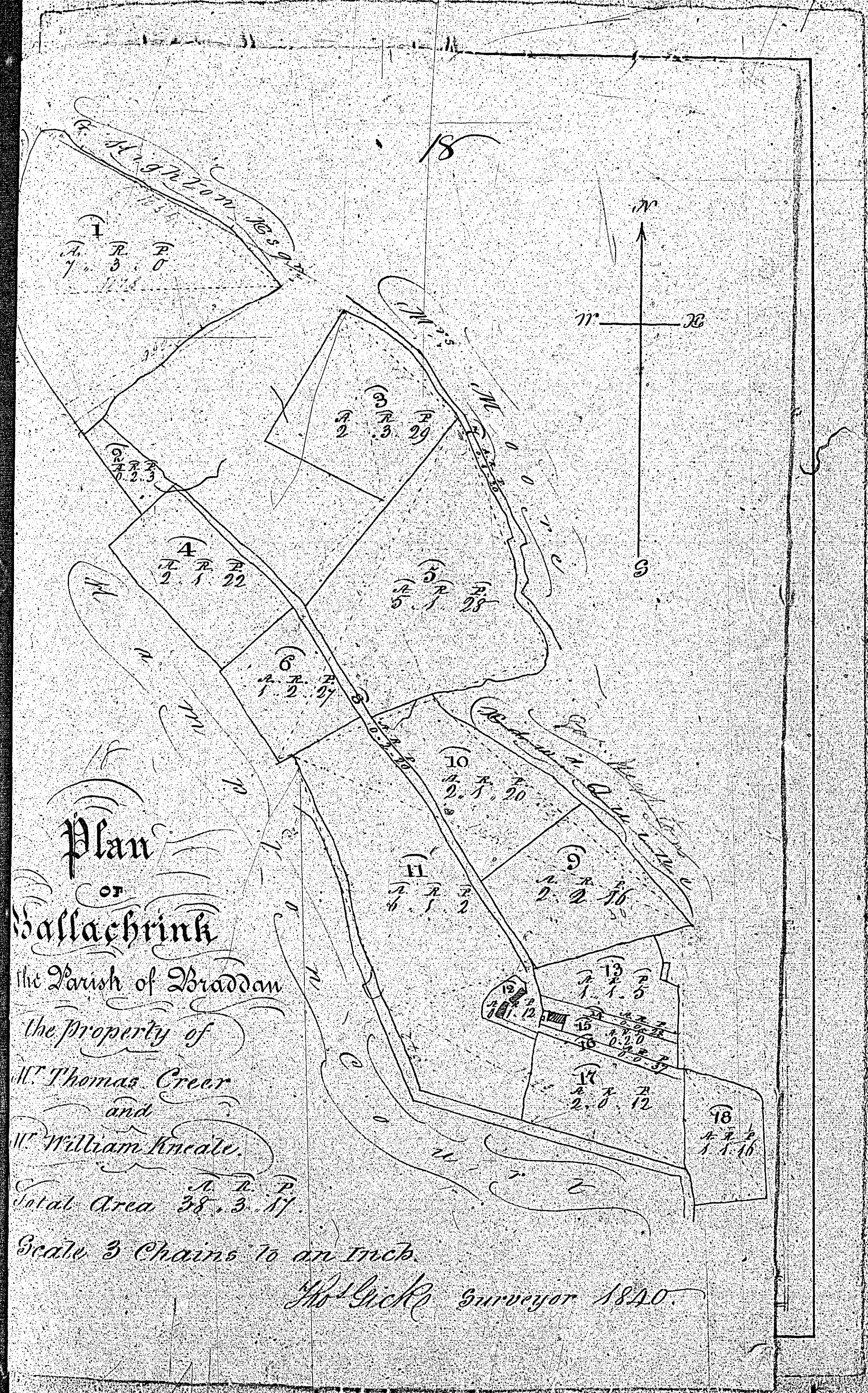

Plan
 of
 Ballachbrink
 the Parish of Braddan
 the Property of
 M^r Thomas Creer
 and
 M^r William Kneale.

Total Area 38. 3. 17.

Scale 3 Chains to an Inch.

J. G. G. Surveyor 1840.

Handwritten notes on the right margin, including the name 'W. G. G.' and other illegible scribbles.

PLAN
of
BALLABUNT 19
Parish of Braddan
The Property of
M^r W. CRAINE.

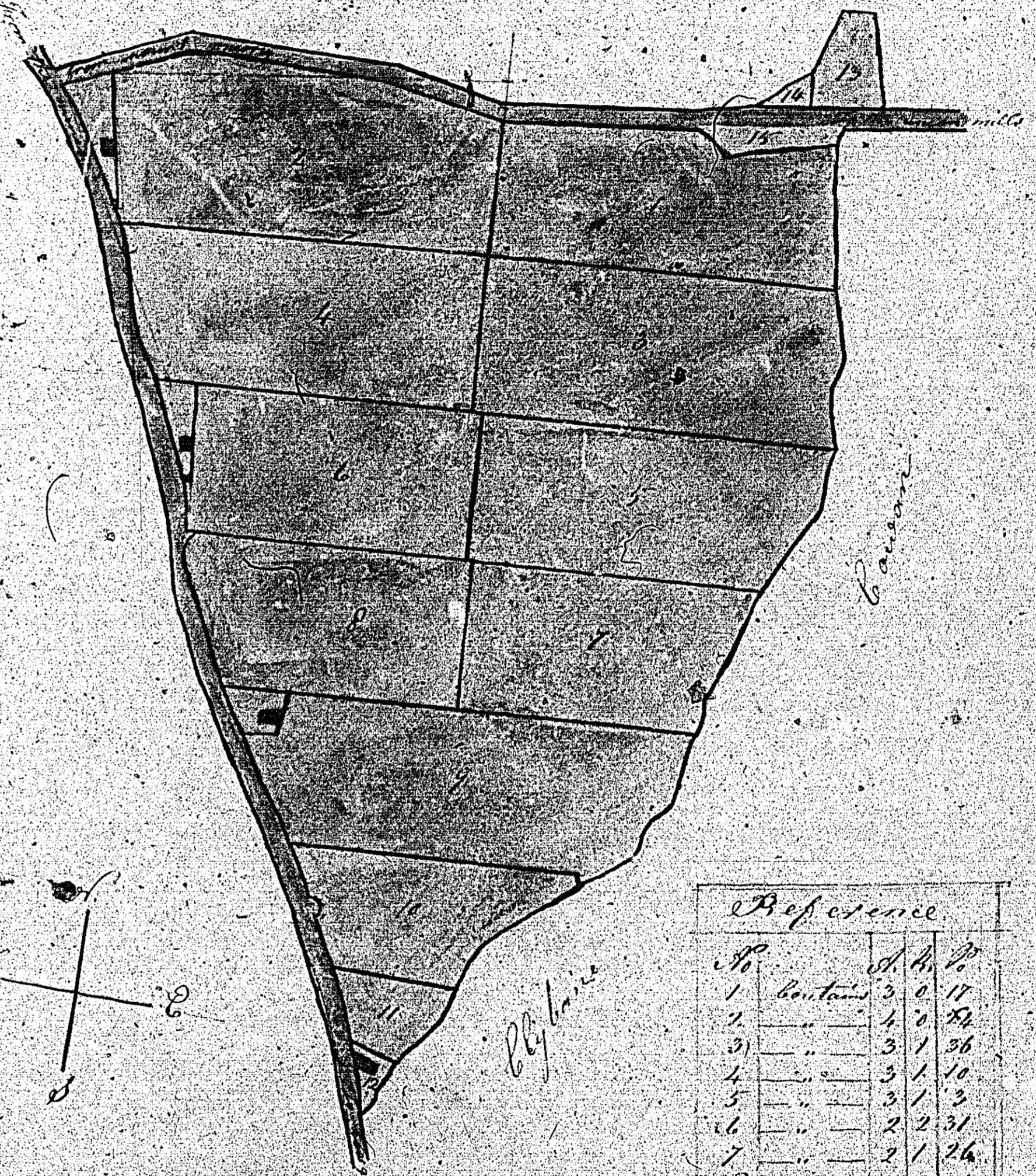

Reference		
No.	Acres	Perches
1	3	0 17
2	1	0 22
3	3	1 56
4	3	1 10
5	3	1 2
6	2	2 31
7	2	1 26
8	2	2 4
9	3	2 35
10	1	3 31
11	0	1 25
12	0	0 17
13	0	1 20
14	0	0 12
15	0	1 0
Grassmud Do.	1	0
Total	22	0 21

Scale of chains three to an inch.

J. Cressett, Surveyor, Braddan, 1839.

Murphy
600 ft
Ballabunt
1839