

ISLE OF MAN GOVERNMENT: GENERAL REGISTRY

TITHE PLANS: PARISH OF ARBORY

- 40 Original coloured (decorative) 1.30
- 41 Original coloured (decorative)
- 42 Original coloured (decorative)
- 43 Original coloured (decorative)
- 44 Original monotone

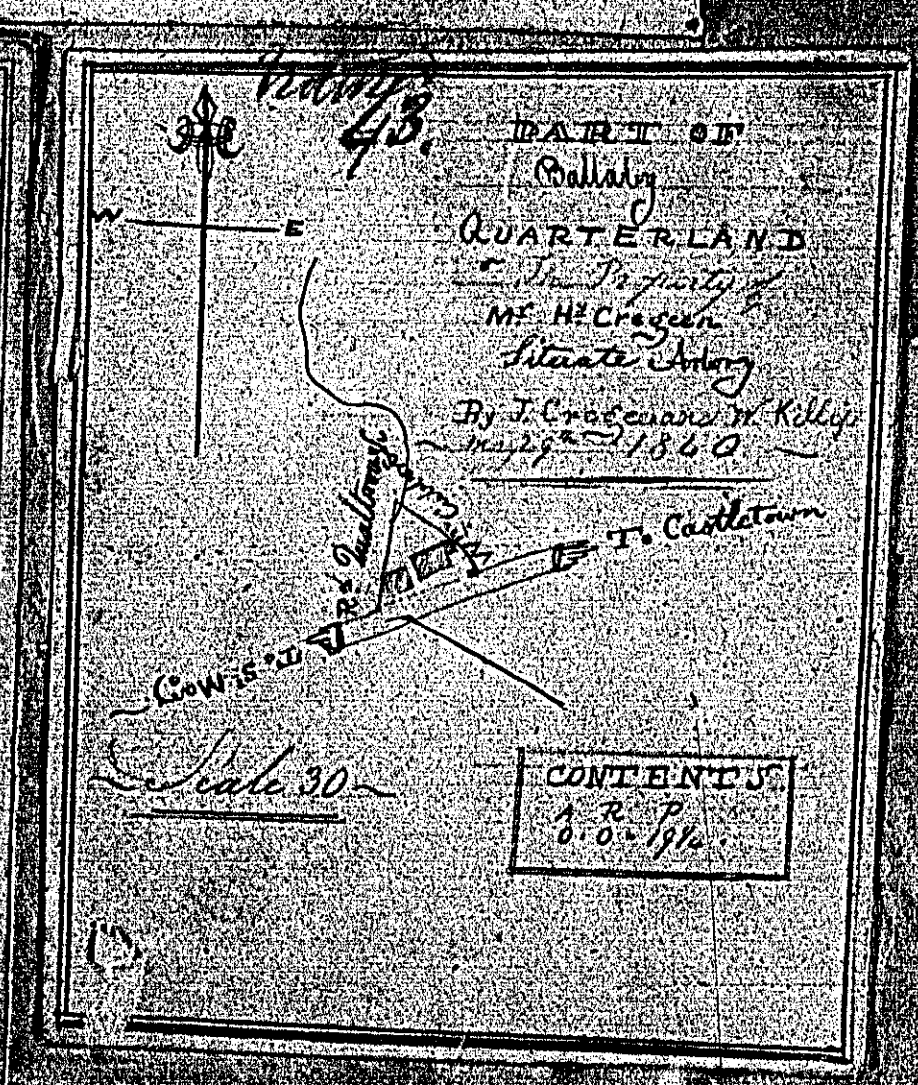
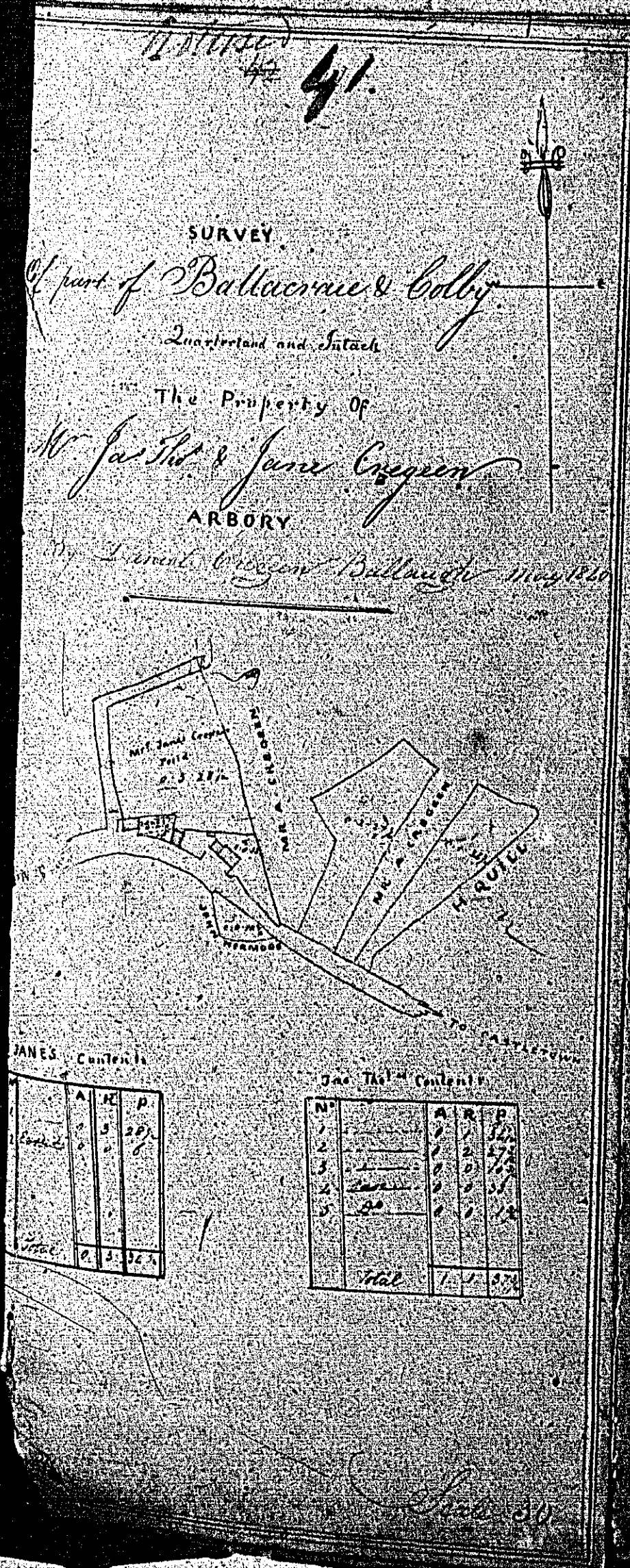
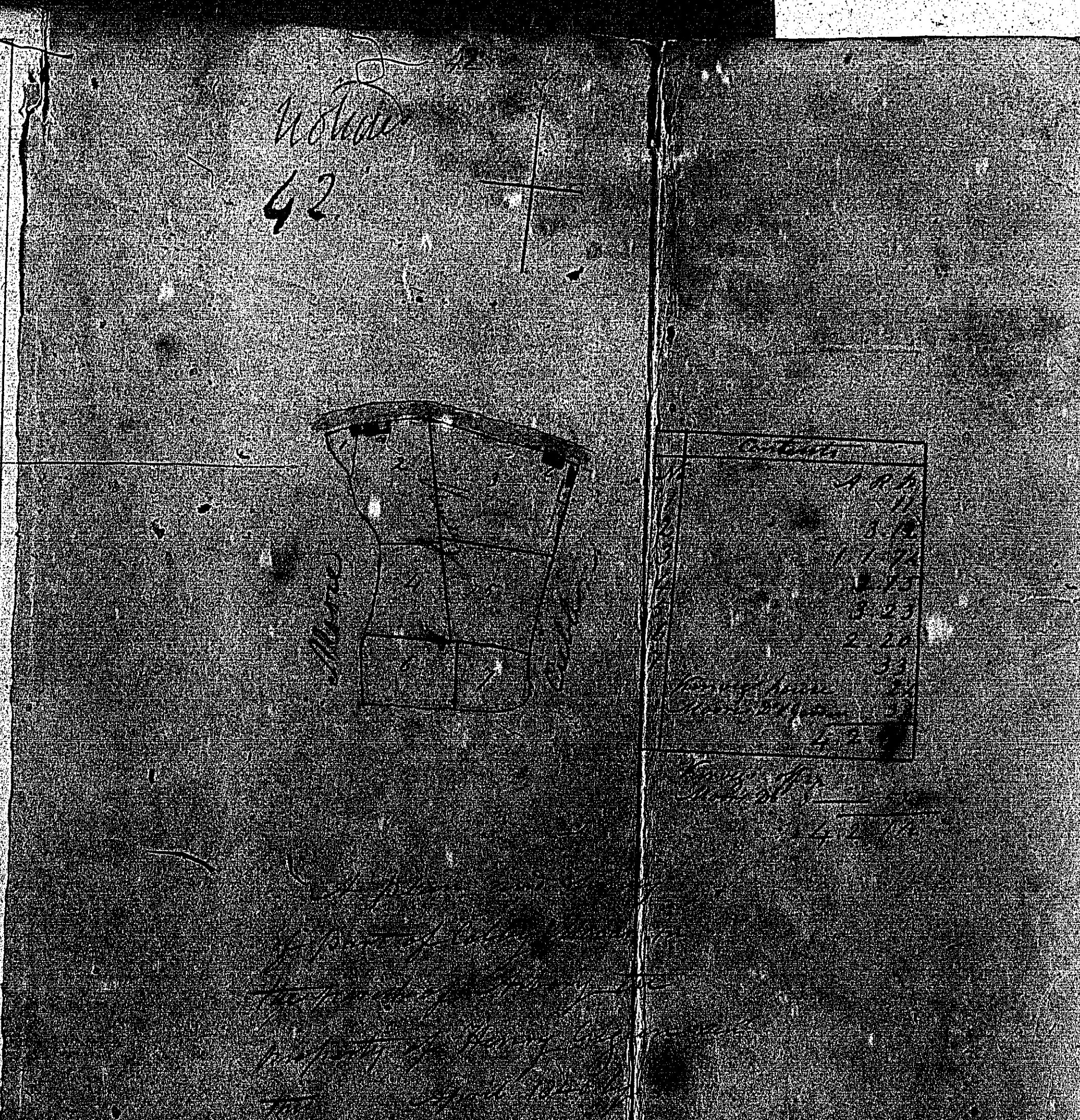
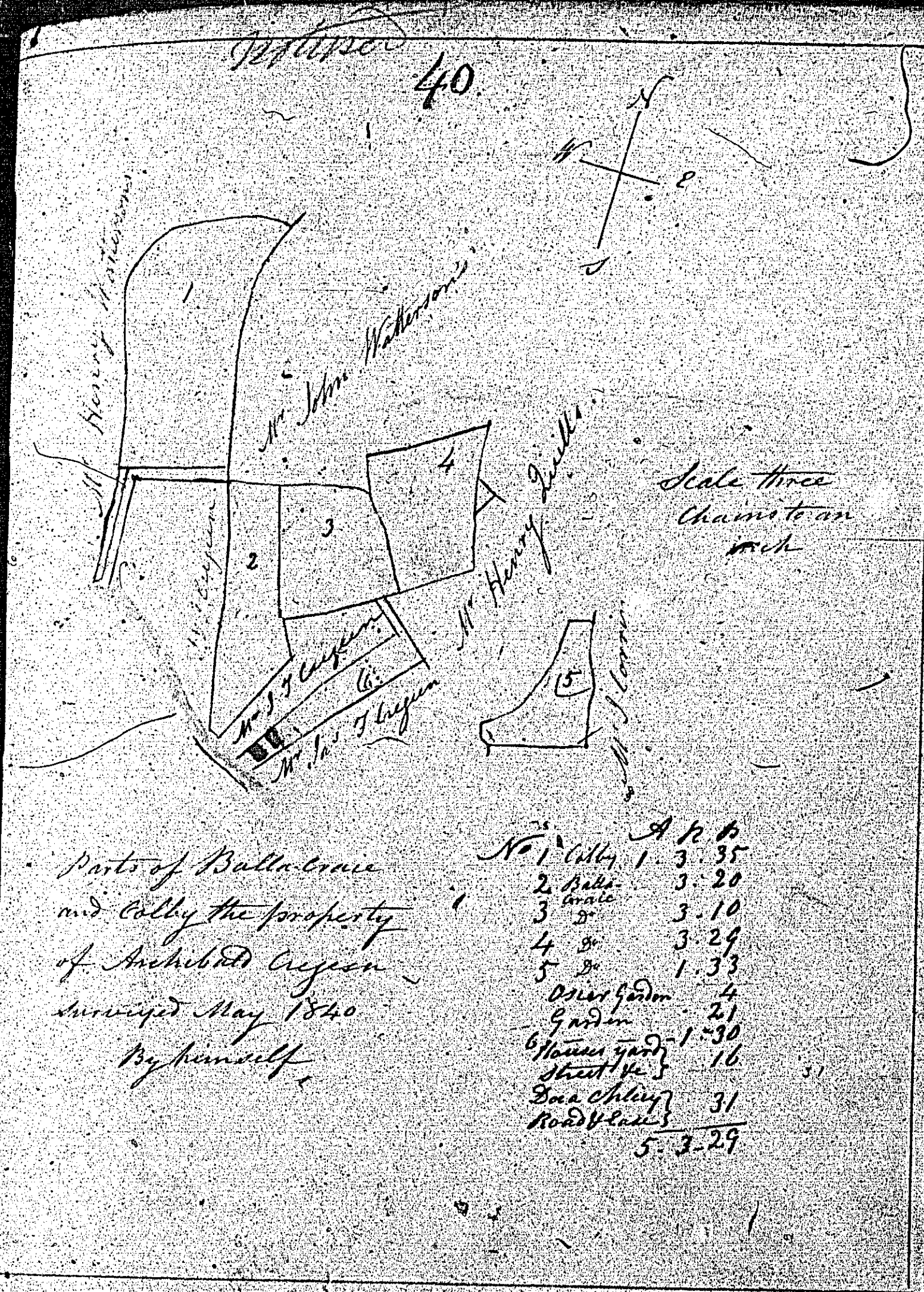

The Mountains

45.7 ~~48~~

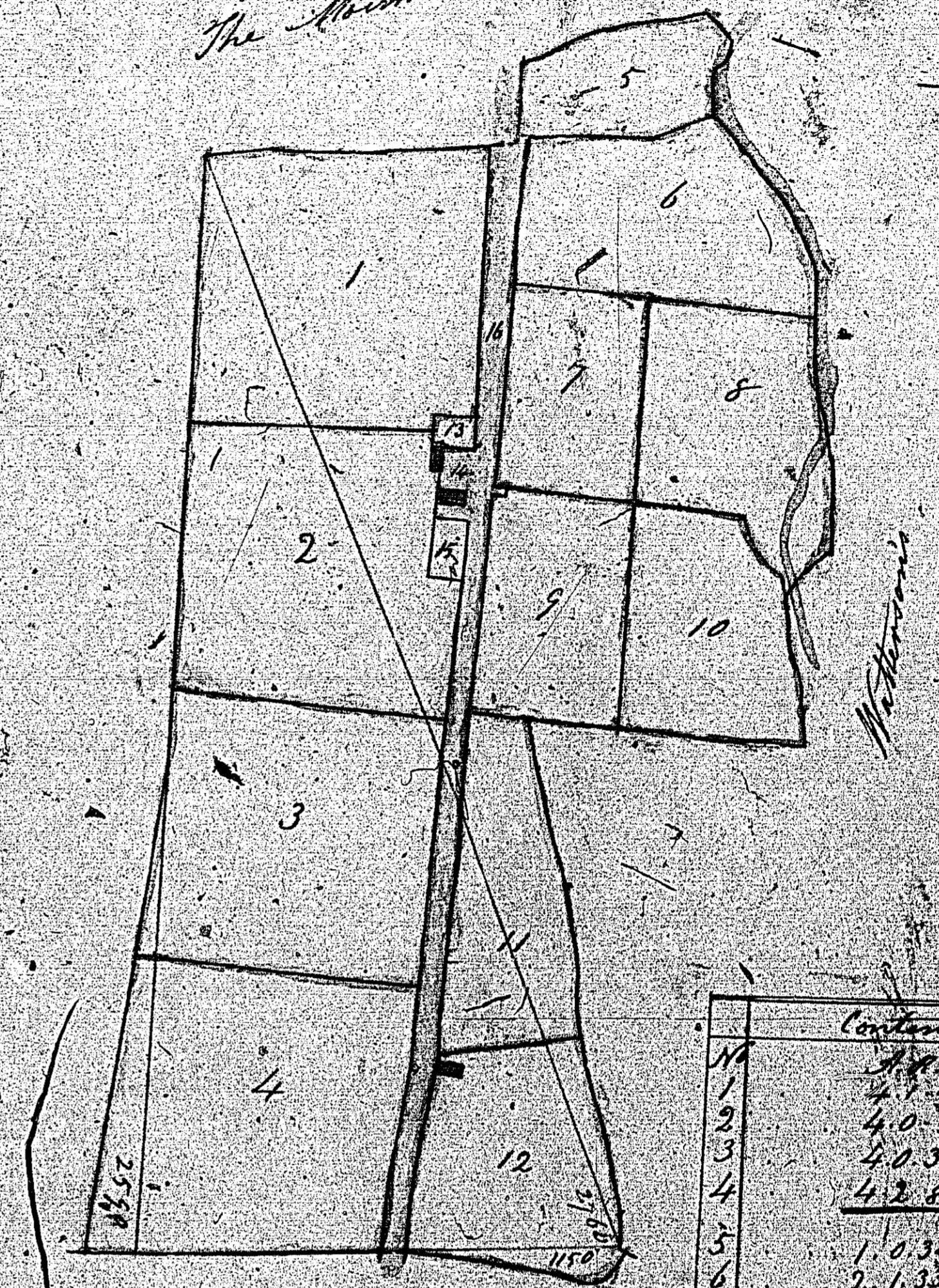

The Mountains or Common

Watercourse

Mr John Gibbons Intack

A plan of
Intack land called
Cringshill in the parish
of Arbury the property
of Arthur Crepin
surveyed by him the 7th
May 1836

Contents	
16	38.0.0
1	2.1.17
2	4.0.5
3	4.0.30
4	4.2.8
5	17.0.20
6	1.0.36
7	2.1.33
8	1.2.24
9	2.1.22
10	1.1.22
11	2.0.2
12	2.1.22
	78.0.35
	33.1.18
13	4.14
14	2.6
15	1.8
16	1.2.2
	35.0.35

John Gibbons to me

No plan numbered

46

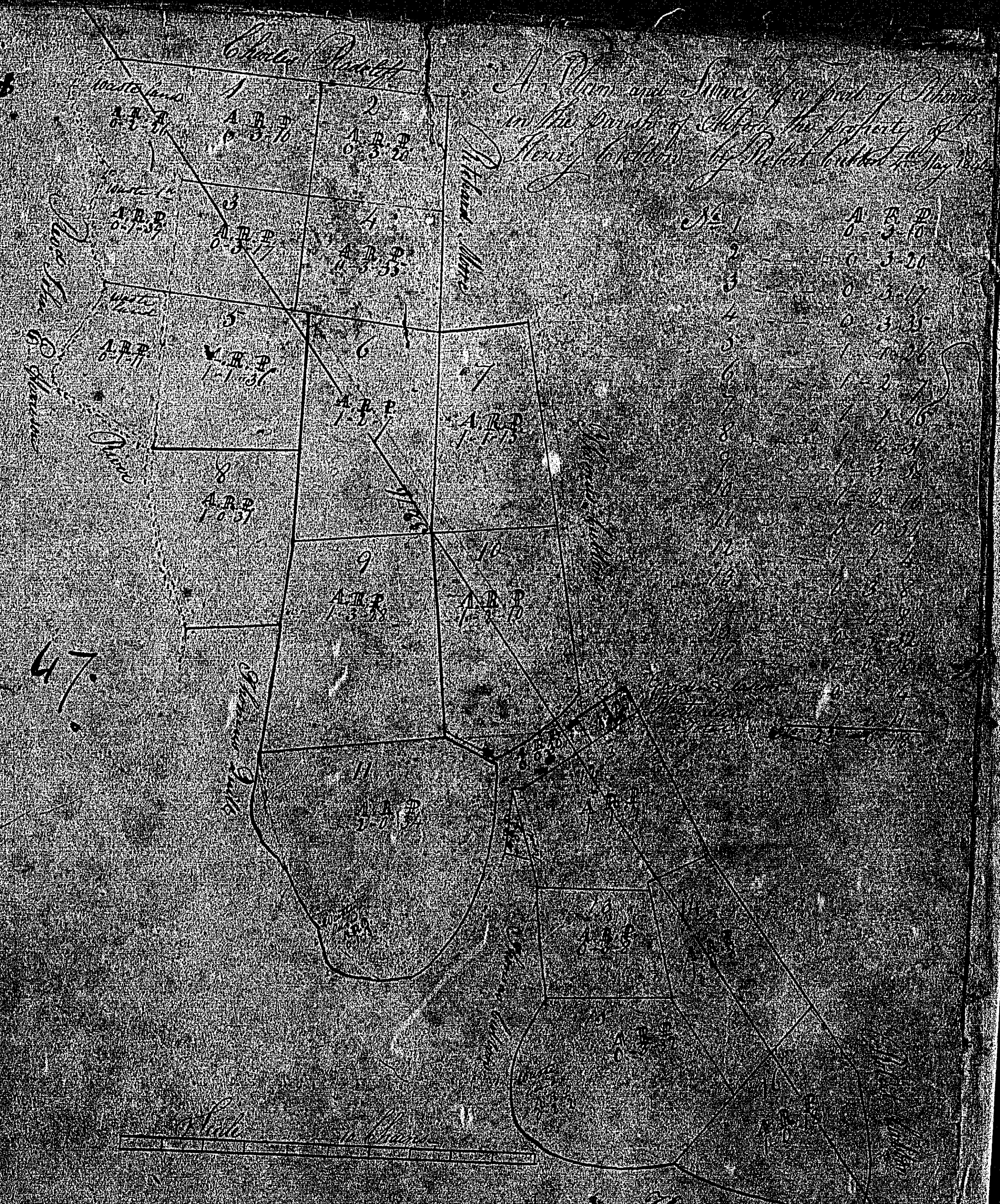

A Plan and Survey of a part of ...

No.	A	B	C
1	0	3	10
2	0	3	50
3	0	3	33
4	0	3	33
5	0	3	33
6	0	3	33
7	0	3	33
8	0	3	33
9	0	3	33
10	0	3	33
11	0	3	33

Scale

Miles ...

No plan numbered

48

ISLE OF MAN GOVERNMENT: GENERAL REGISTRY.

TITHE PLANS: PARISH OF ARBORY

- 49 Original monotone 1.30
- 50 Original monotone
- 51 Original coloured (decorative), marked

49
 A plan of
 House & garden
 in Colby in Arbery
 the property of
 Eliza Cullison
 Surveyed Decr
 1840 by
 A. Cregan

Scale of
 two chains
 to an inch

50
 A plan of
 three pieces of
 property of
 Mr John Cullison of
 Ballinacrossa near
 the parish of Arbery
 Decr 1840
 A. Cregan

Scale of two
 chains to the
 inch

