

Manufacture of
Shank
in the Parish of ...
the property of
Mr. C. ...

271.

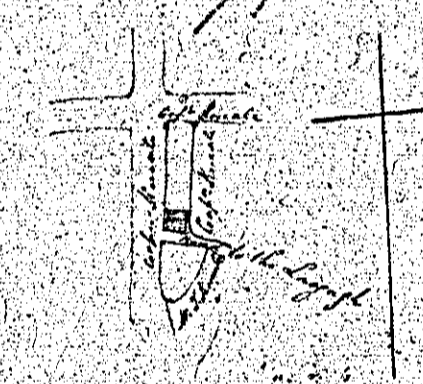

5
6.10
6.13

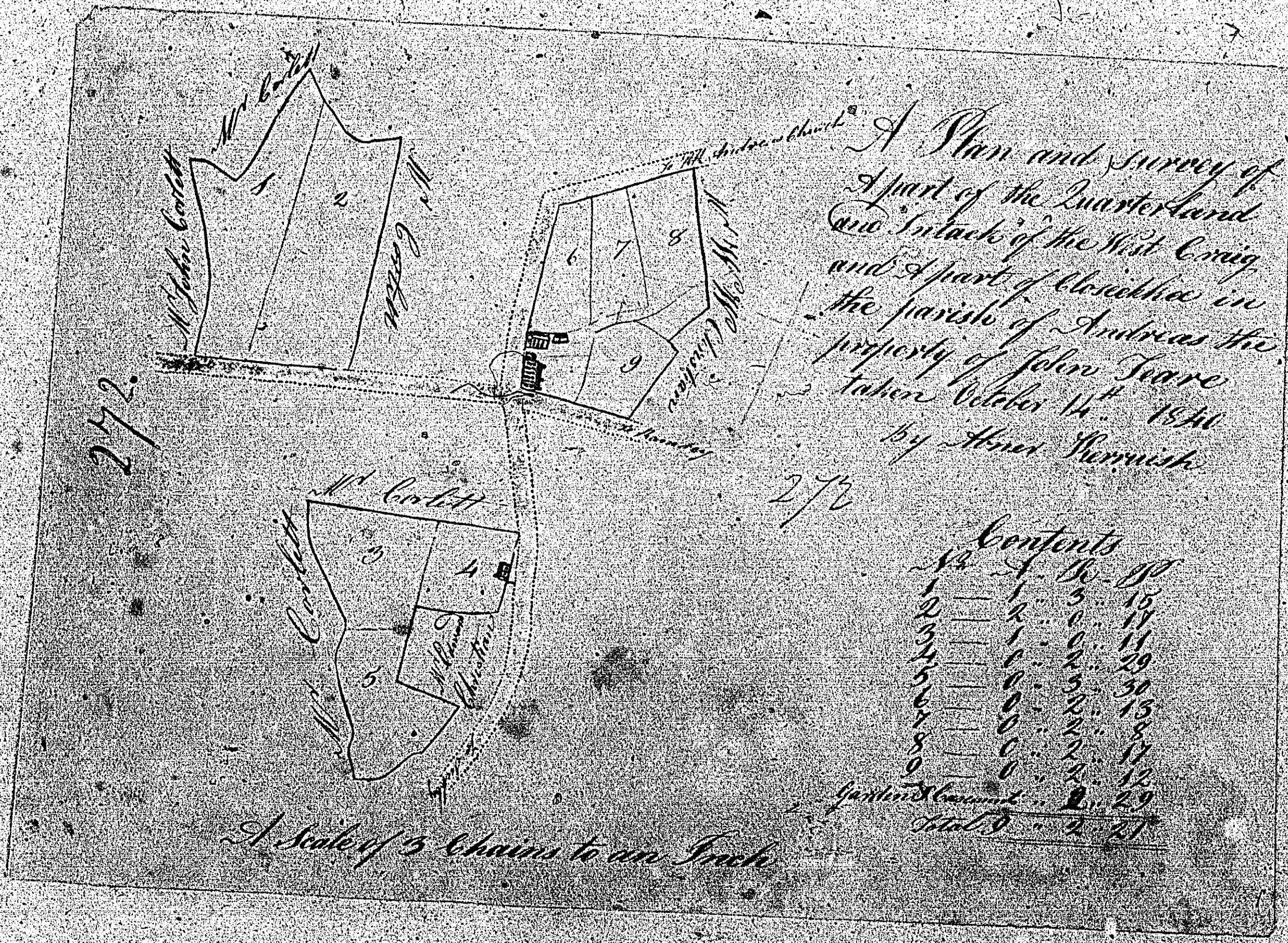

ISLE OF MAN GOVERNMENT: GENERAL REGISTRY

TITHE PLANS: PARISH OF ANDREAS

Original coloured (decorative)

1:30

Handwritten signature or scribble

not used

Plan & Survey 273
 of
 BALLAWHANE
 in the Parish of
 Andreas
 the Property of
 W. Seare Esq.

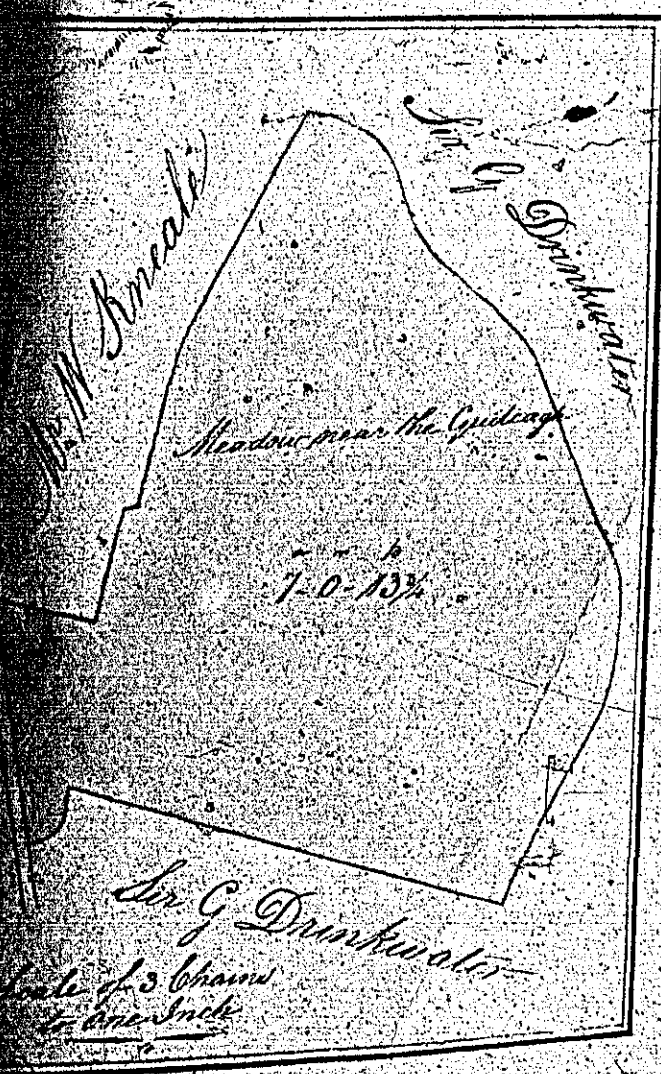
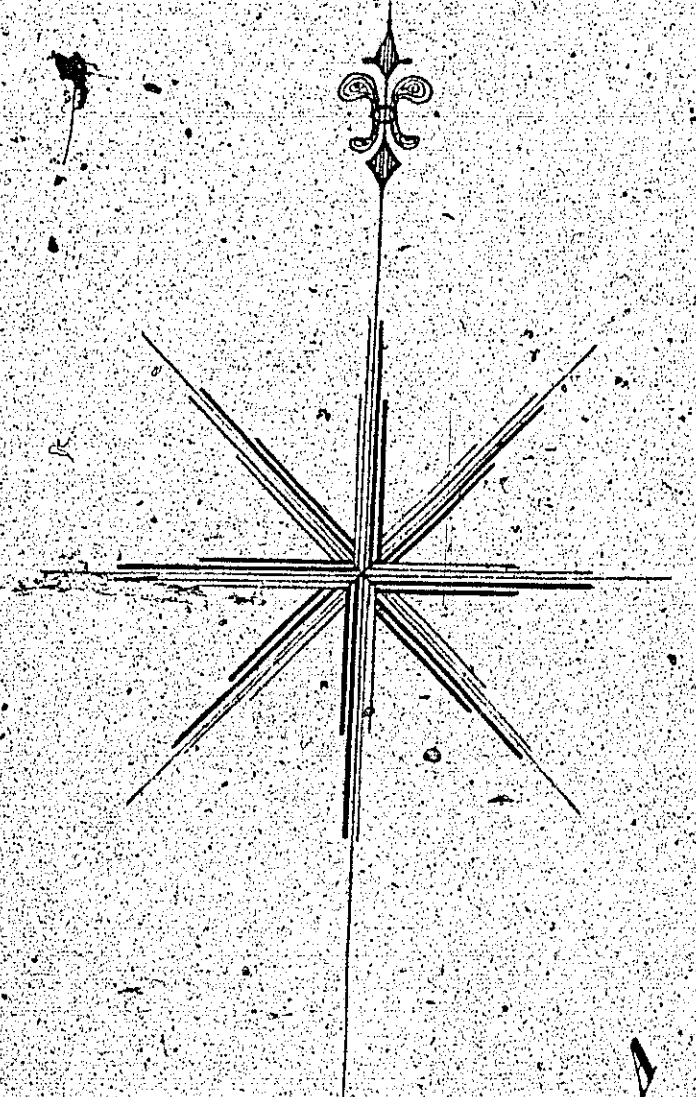

Scale of 4 Chains to One Inch

273

By the Surveyor's Line 800
 Horizontal Line 560

Contents of Meadows

1	1
2	1
3	1
4	1
5	1
6	1
7	1
8	1
9	1
10	1
11	1
12	1
Total	12
Contents of Gardens & Ponds	1
Total Acres	13
Total Measurs	13
Total Meadows	13
Total Plans	13

MAP
and Survey of
PART OF
BALLACUNNER,
and
KNOCKE-NHEAN,

*in the Parishes of Ardara,
the Property of Mr. Conboy
Surveyed by J. M. M. M.*

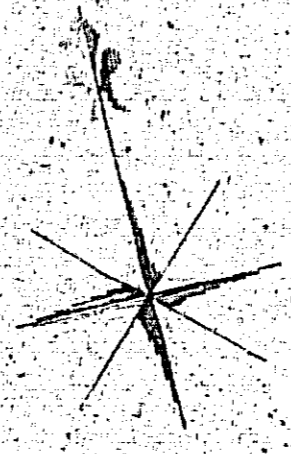

Contents

N ^o	A R P
1	3 2 15
2	6 3 31
3	7 0 13
4	5 2 33
5	7 2 17
6	2 0 30
7	5 0 3
	<u>38 0 27</u>
8	5 2 2
9	6 2 33
10	4 1 35
11	4 3 33
	<u>31 7 33</u>
Ballacunner 38 0 27	
Total 39 7 26	
Lapagh Moan 1 0 0	

3 chains to an inch

274

274

**There is no plan 275
in this volume**

276

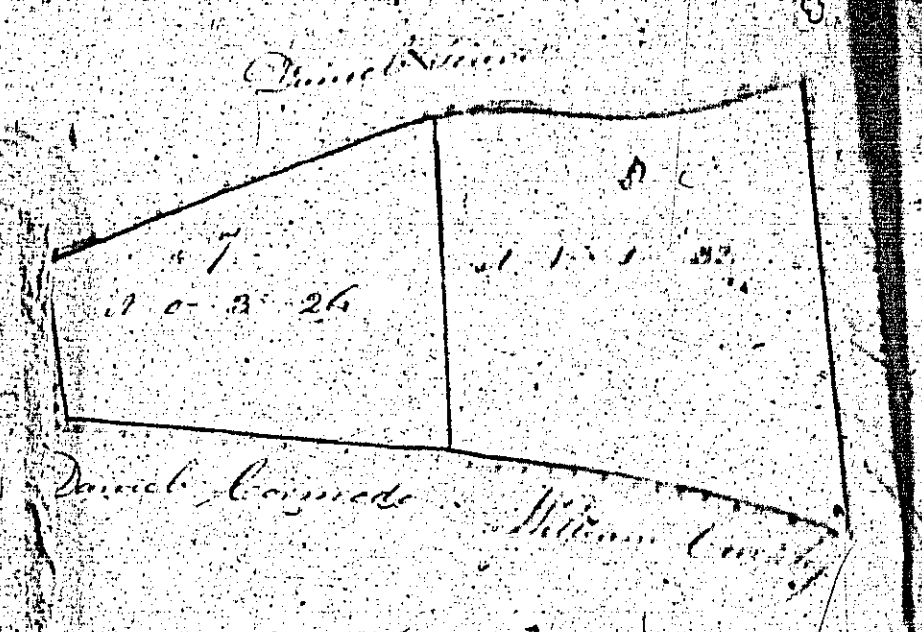
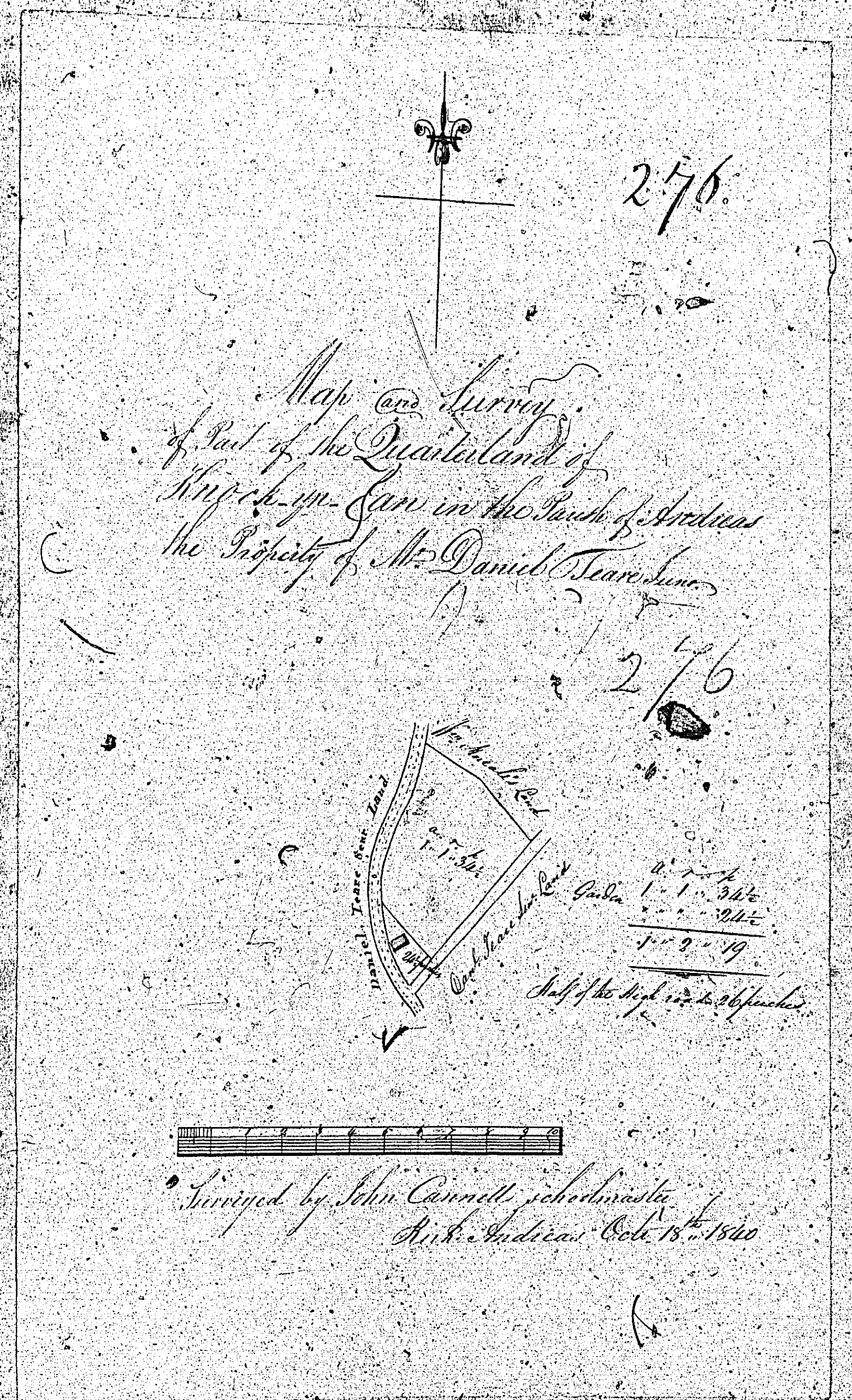

N	S	P
1	1	25
2	1	25
3	1	25
4	1	25
5	1	25
6	1	25
7	1	25
8	1	25
9	1	25
10	1	25
11	1	25
12	1	25
13	1	25
14	1	25
15	1	25
16	1	25
17	1	25
18	1	25
19	1	25
20	1	25
21	1	25
22	1	25
23	1	25
24	1	25
25	1	25
26	1	25
27	1	25
28	1	25
29	1	25
30	1	25
31	1	25
32	1	25
33	1	25
34	1	25
35	1	25
36	1	25
37	1	25
38	1	25
39	1	25
40	1	25
41	1	25
42	1	25
43	1	25
44	1	25
45	1	25
46	1	25
47	1	25
48	1	25
49	1	25
50	1	25

Surveyed by John Cannell, Schoolmaster
King's Andros, Oct. 18. 1840

Surveyed by John Cannell, Schoolmaster
King's Andros, Oct. 18. 1840