

186.

1	0	0	0	0	0	0	0	0	0
1	0	0	0	0	0	0	0	0	0
1	0	0	0	0	0	0	0	0	0
1	0	0	0	0	0	0	0	0	0
1	0	0	0	0	0	0	0	0	0
1	0	0	0	0	0	0	0	0	0
1	0	0	0	0	0	0	0	0	0
1	0	0	0	0	0	0	0	0	0
1	0	0	0	0	0	0	0	0	0
1	0	0	0	0	0	0	0	0	0

186.

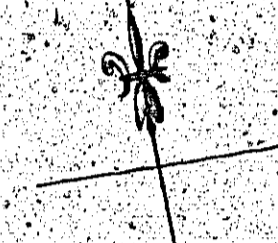

Map and Survey
 of part of the
 District
 of
 Ballisadcliffe in the Parish of Alder
 the property of Miss Mary Luce

0-7-4
 0-1-6 1/2
 0-1-33 1/2
 0-3-0

high road 18 1/2 furlongs

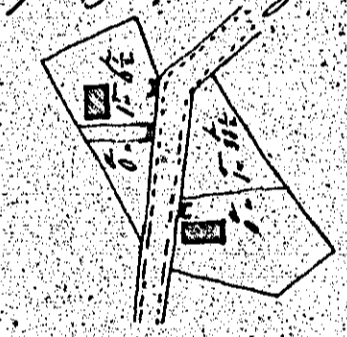

186



Surveyed by John Carnell Schoolmaster
 Cork, Ireland October 1840

183



Surveyed by John Carnell Schoolmaster
 Cork, Ireland October 1840

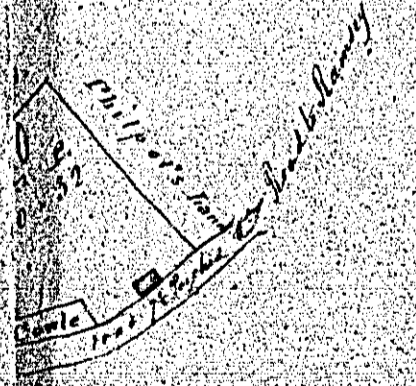

187.

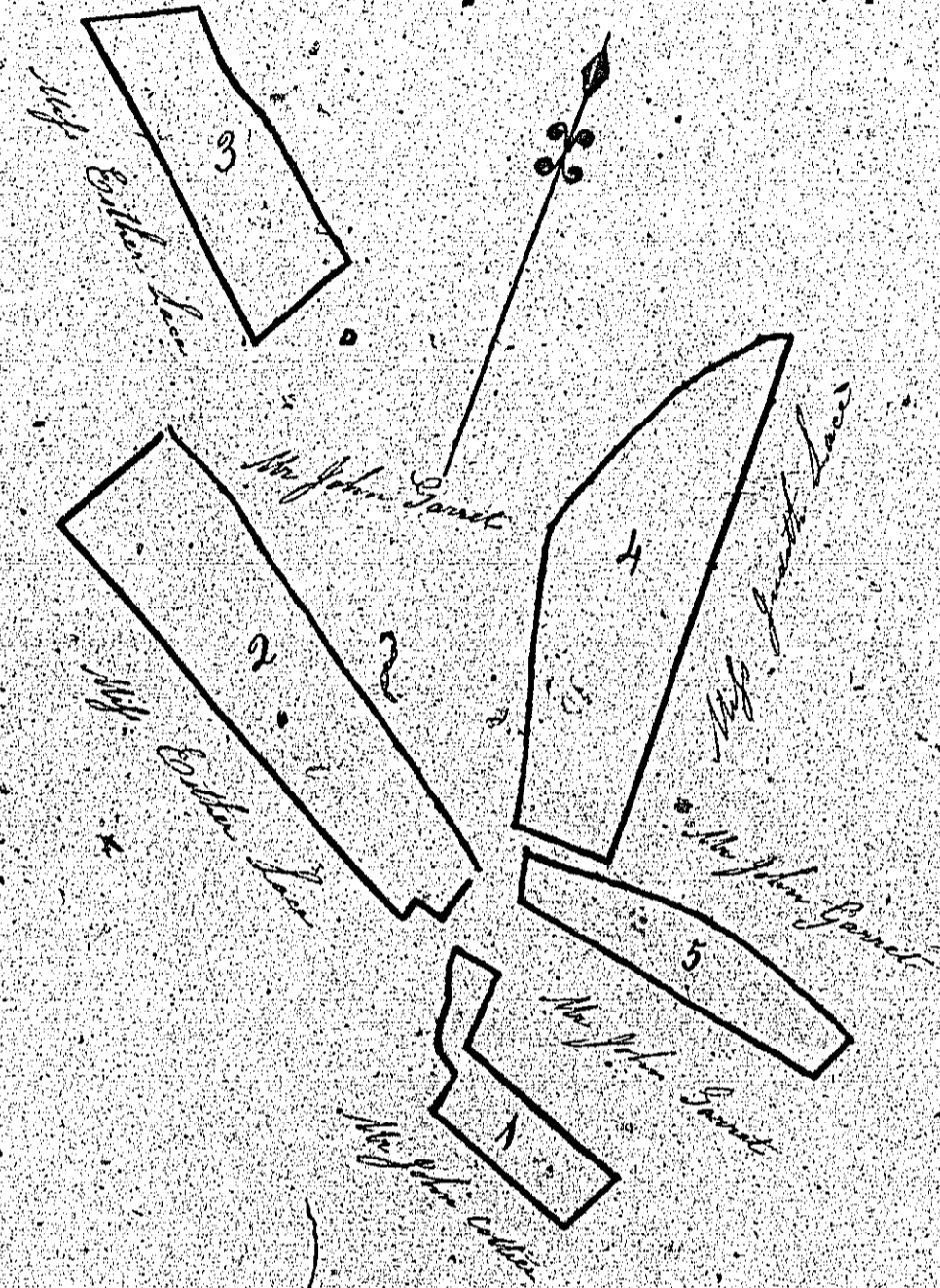

	A.	B.	C.	Yds.
1 st	0	1	26	8.6
2 nd	1	7	2	10.5
3 rd	0	8	9	0.6
4 th	1	2	15	10.1
5 th	0	2	9	1.8
Total	2	3	22	0.8

A Plan and Survey
of part of the Quarterland
of Ballybeg, in the
Parish of St. Andrew,
The property of
Mr. W. Lane

187

Scale of 3 chains to 1 inch

John W. Lane Surveyor Sep. 18. 1839.

1	1	1	1	1	1
2	2	2	2	2	2
3	3	3	3	3	3
4	4	4	4	4	4
5	5	5	5	5	5
6	6	6	6	6	6
7	7	7	7	7	7
8	8	8	8	8	8
9	9	9	9	9	9
10	10	10	10	10	10
11	11	11	11	11	11
12	12	12	12	12	12
13	13	13	13	13	13
14	14	14	14	14	14
15	15	15	15	15	15
16	16	16	16	16	16

183-



Surveyed by John Cannell, Instrumentalist
 Parish of St. Andrew, October 1839

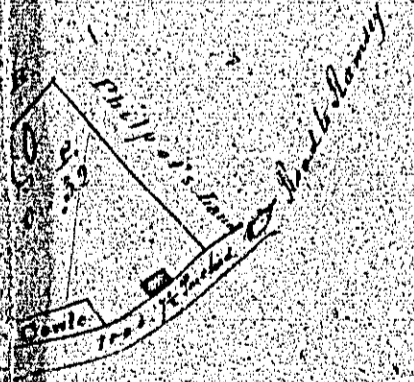

Surveyed by John Cornwell, Esq. in the Parish of Andreas, 1831.

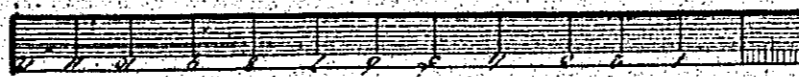

10	10
9	9
8	8
7	7
6	6
5	5
4	4
3	3
2	2
1	1

1831

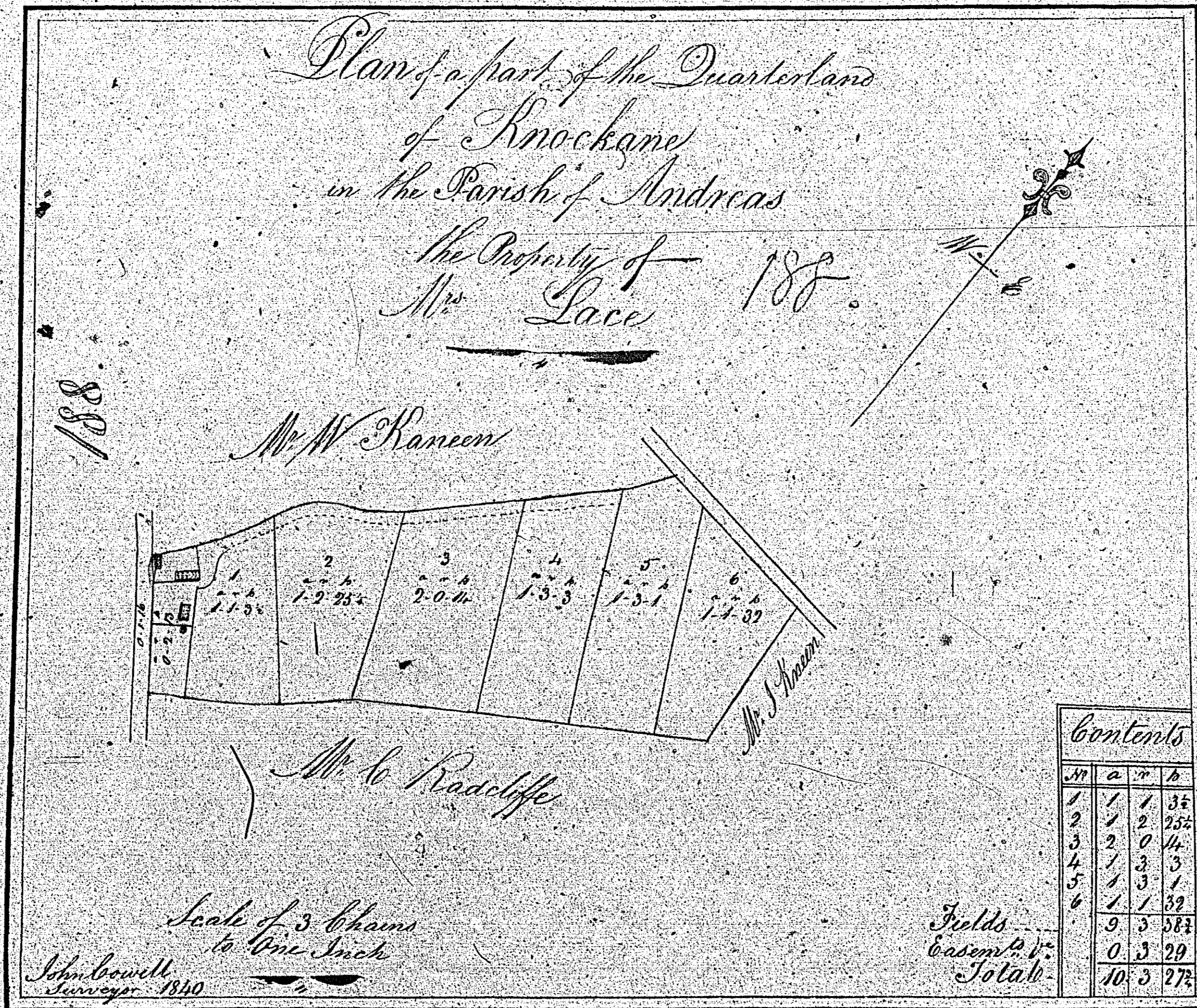

Contents			
No.	a	r	b
1	1	1	35
2	1	2	252
3	2	0	44
4	1	3	3
5	1	3	1
6	1	1	32
Fields			9 3 382
Cases & V.			0 3 29
Total			10 3 272

ISLE OF MAN GOVERNMENT: GENERAL REGISTRY
TITHE PLANS: PARISH OF ANDREAS
Original coloured (decorative) 1:30

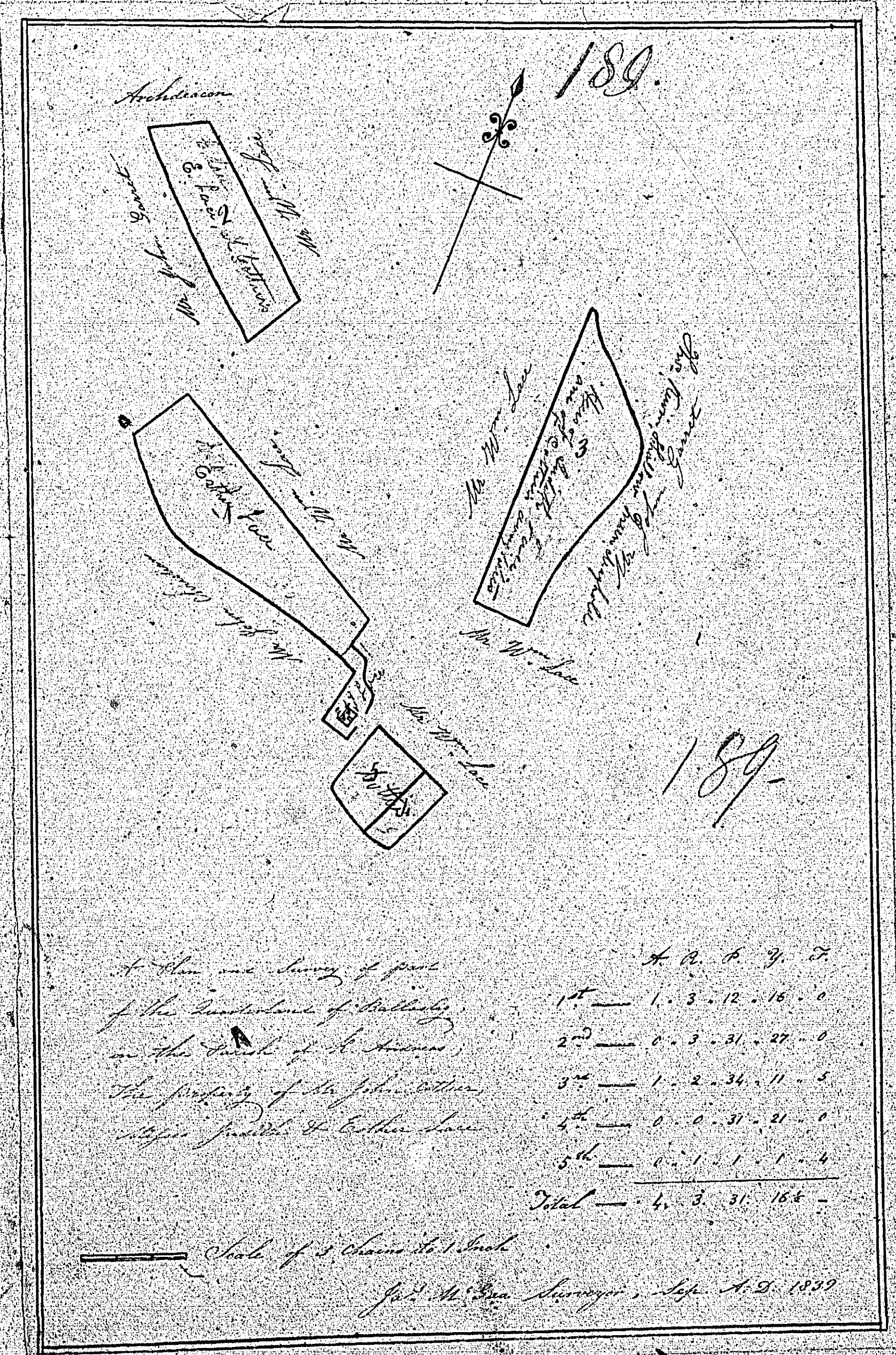

1	2	3	4	5	6	7	8	9	10	11	12	13	14	15	16	17	18	19	20	21	22	23	24	25	26	27	28	29	30	31	32	33	34	35	36	37	38	39	40	41	42	43	44	45	46	47	48	49	50	51	52	53	54	55	56	57	58	59	60	61	62	63	64	65	66	67	68	69	70	71	72	73	74	75	76	77	78	79	80	81	82	83	84	85	86	87	88	89	90	91	92	93	94	95	96	97	98	99	100
---	---	---	---	---	---	---	---	---	----	----	----	----	----	----	----	----	----	----	----	----	----	----	----	----	----	----	----	----	----	----	----	----	----	----	----	----	----	----	----	----	----	----	----	----	----	----	----	----	----	----	----	----	----	----	----	----	----	----	----	----	----	----	----	----	----	----	----	----	----	----	----	----	----	----	----	----	----	----	----	----	----	----	----	----	----	----	----	----	----	----	----	----	----	----	----	----	----	----	-----

183
W. Lee's plan

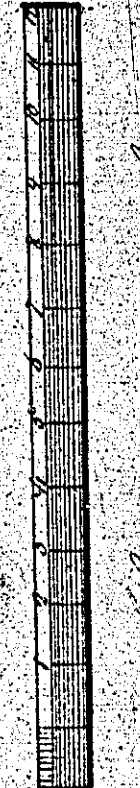

*Surveyed by John Carruth, Johnston
Rich. Anderson, October 1894*

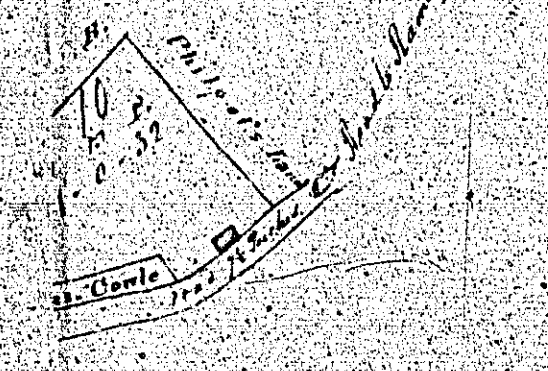

MAP
and Survey of
THE
BALLA-CHERIMS
in the Parish of Andover
the Property of His Noble
Lord, Mylicia's
1834



190.

West of the Quarterland
of Walter's and
Mark's Bets

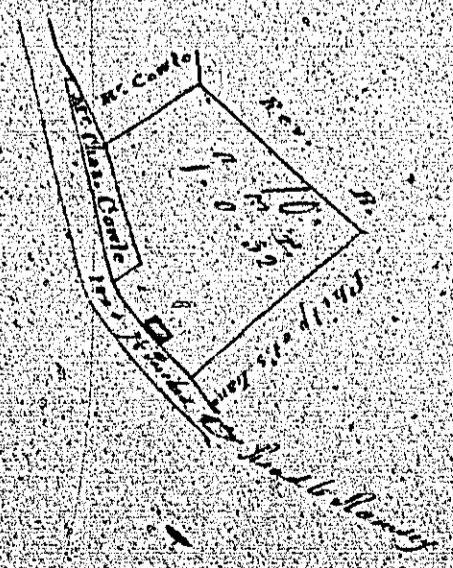

1834
183-

1	2
2	10
3	11
4	19
5	1
6	5
7	2
8	5
9	2
10	5
11	2
12	5
13	2
14	5
15	2
16	5
17	2
18	5
19	2
20	5
21	2
22	5
23	2
24	5
25	2
26	5
27	2
28	5
29	2
30	5
31	2
32	5
33	2
34	5
35	2
36	5
37	2
38	5
39	2
40	5
41	2
42	5
43	2
44	5
45	2
46	5
47	2
48	5
49	2
50	5
51	2
52	5
53	2
54	5
55	2
56	5
57	2
58	5
59	2
60	5
61	2
62	5
63	2
64	5
65	2
66	5
67	2
68	5
69	2
70	5
71	2
72	5
73	2
74	5
75	2
76	5
77	2
78	5
79	2
80	5
81	2
82	5
83	2
84	5
85	2
86	5
87	2
88	5
89	2
90	5
91	2
92	5
93	2
94	5
95	2
96	5
97	2
98	5
99	2
100	5

Surveyed by John Cassell, Schoolmaster
West, Andover, October 1834

190.

10	10	10	10	10	10	10	10	10	10
10	10	10	10	10	10	10	10	10	10
10	10	10	10	10	10	10	10	10	10
10	10	10	10	10	10	10	10	10	10
10	10	10	10	10	10	10	10	10	10
10	10	10	10	10	10	10	10	10	10
10	10	10	10	10	10	10	10	10	10
10	10	10	10	10	10	10	10	10	10
10	10	10	10	10	10	10	10	10	10
10	10	10	10	10	10	10	10	10	10

MS
16

PREVIOUS IMAGE REPEATED



Prepared by John Cannell, Schenectady
Strob. Instrum. October 1896

MS
16