

Vol. 27

Vol. 27

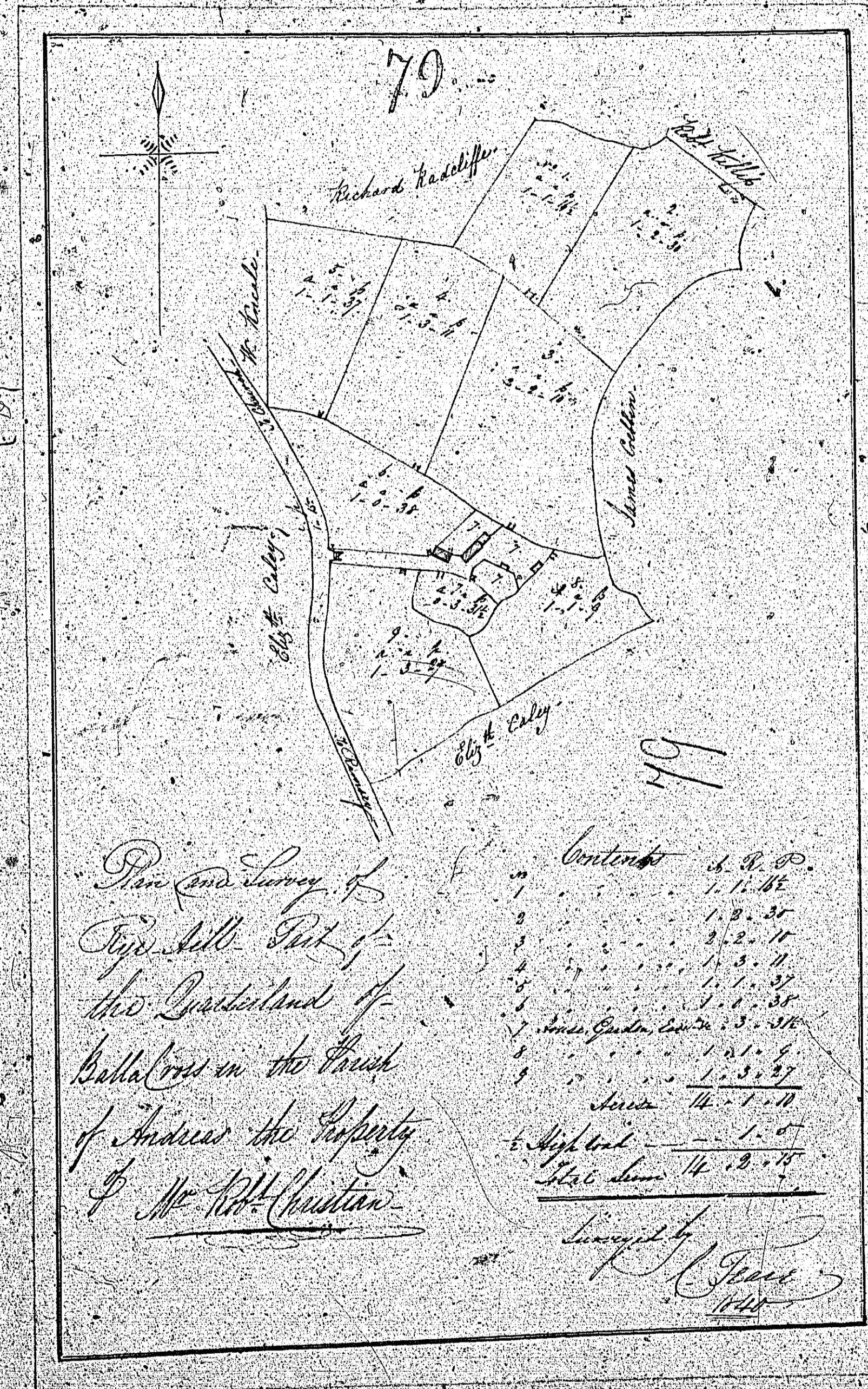

*North*

*L. O. P.*  
*1771*  
*June 7, 1771*

80

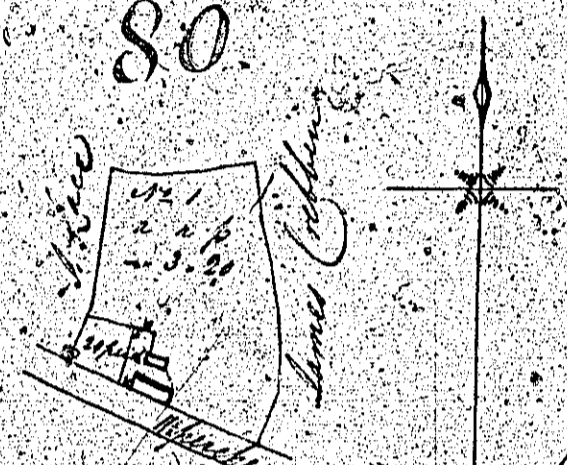

*Plan and Survey of an Island  
and part of the Coastland of  
Hallowickin in the Parish of  
Andree the Property of  
Mr. M. Christian  
Esq. of Hallowickin in the Parish  
of Andree*

*Surveyed by  
J. P. [Signature]*

MAP  
of Parcels of Land  
in the Parish of Andreas  
the Property of Mr John Bamode  
Surveyed by Tho. Martin May 1839

81

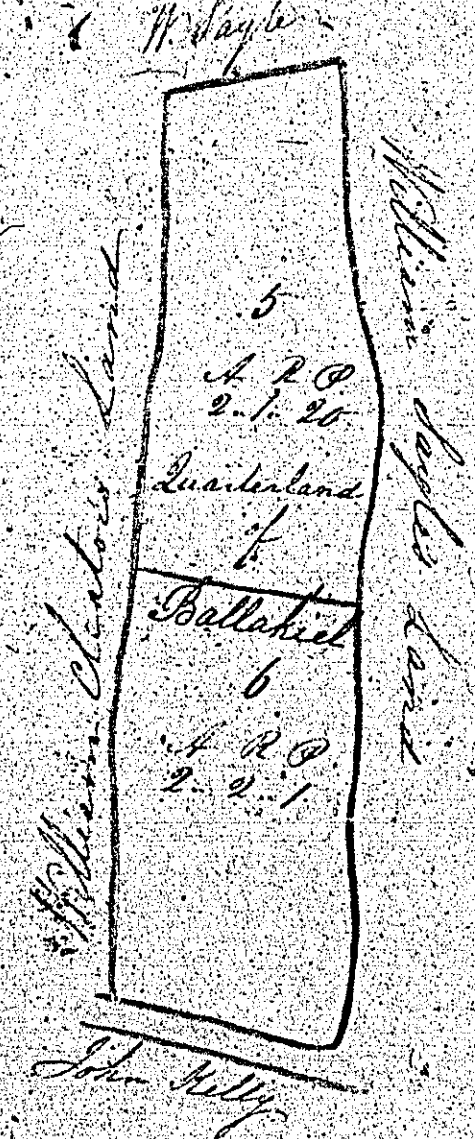
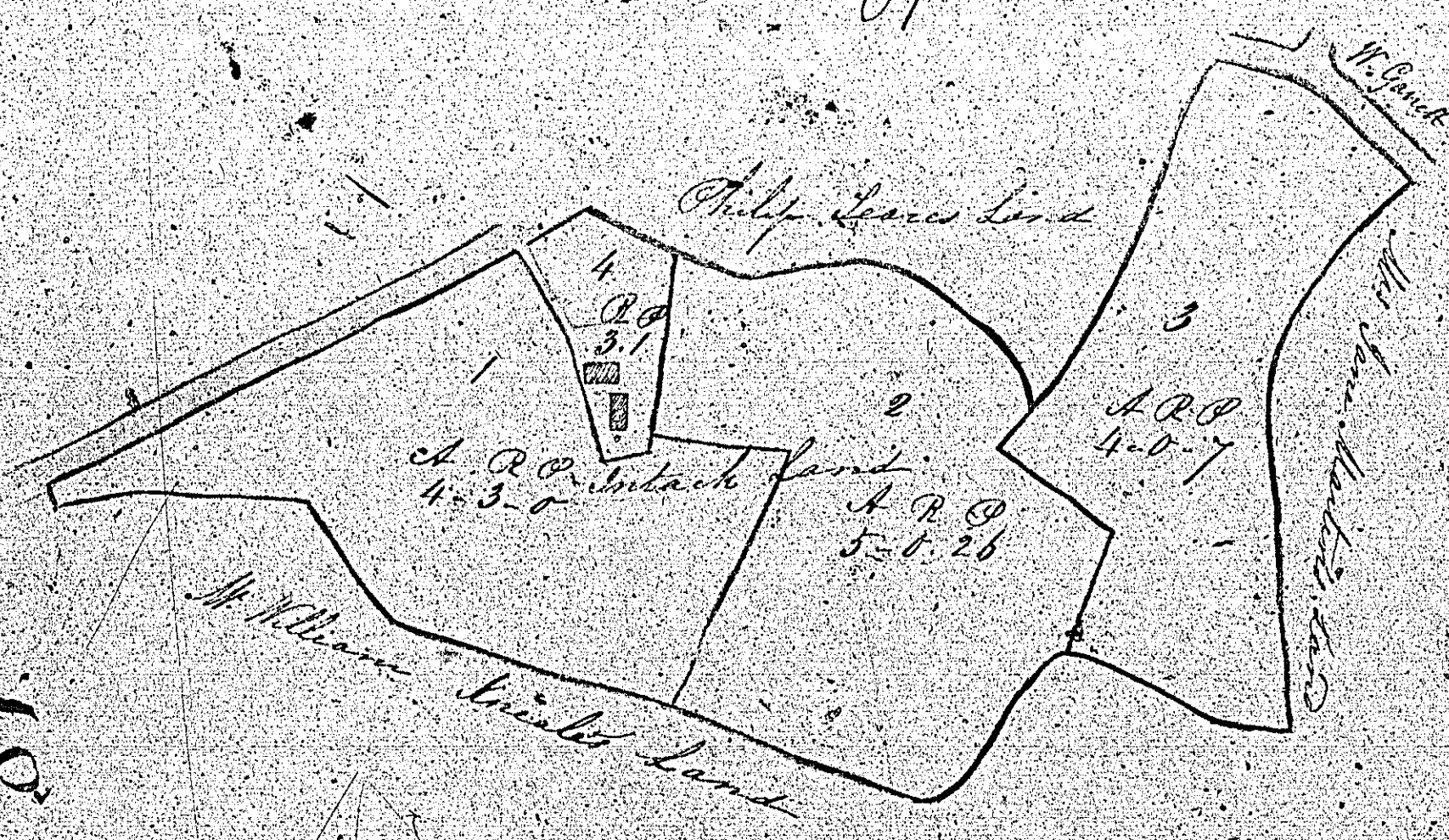

No	Contents	A R P
1		4.3.0
2		5.0.26
3	Intack	4.0.1
4	James Walker's land	2.3.1
5	Philip Leane's	2.1.26
6	William Leane's	2.1
7	Intack	5.3.28
	Sum Rent	20.2.0
	Sum Rent	16.2.18

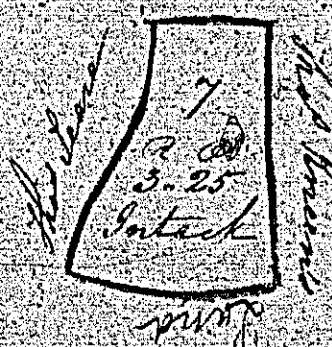
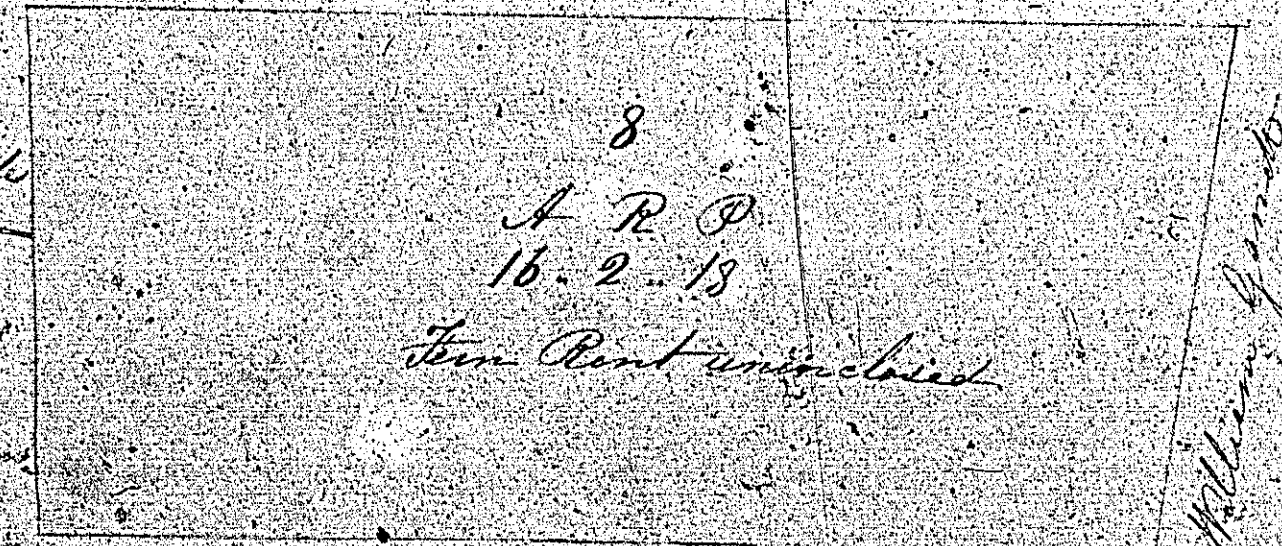

ISLE OF MAN GOVERNMENT: GENERAL REGISTRY  
TITHE PLANS: PARISH OF ANDREAS  
Original coloured (decorative) 1:30

200

A Plan and survey of a part  
of the town of Colchester  
in the parish of Andrews  
the property of Joseph Chantry  
taken by the Rev. Mr. H. H. H. H.

82

W. H. H. H.

A Plan and Survey of  
A part of the Trench of the  
West End in the parish  
of Andover the property of  
Edward Christian taken  
October 21<sup>st</sup> 1840  
By Alfred Hornish

83.

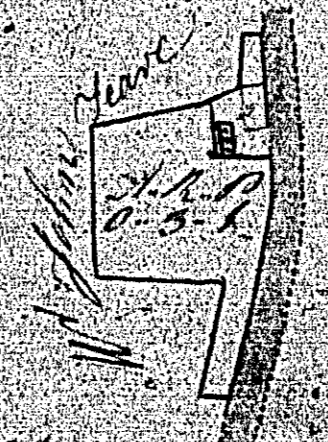

A Scale of 5 Chains to an Inch

ISLE OF MAN GOVERNMENT: GENERAL REGISTRY

TITHE PLANS: PARISH OF ANDREAS

Original coloured (decorative)

1:30

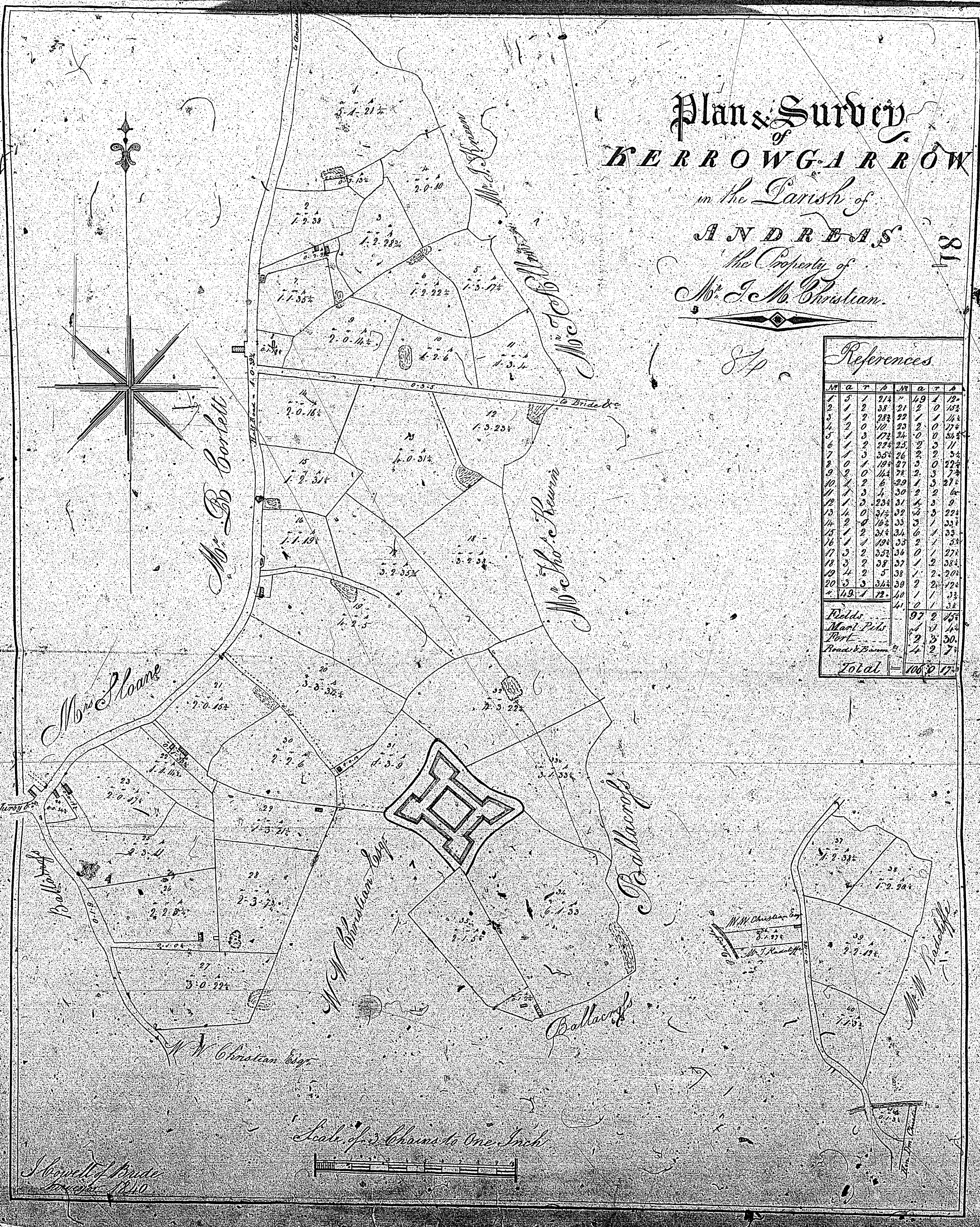

Plan & Survey  
of  
**KERROWGARROW**  
in the Parish of  
**ANDREAS**  
the Property of  
Mr. J. M. Christian.

References

No.	a.	r.	q.	ro.	perches.
1	5	1	2 1/4	21	19
2	1	2	38	22	0
3	1	2	23	25	1
4	1	2	10	24	0
5	1	2	3	24	2
6	1	2	35	26	2
7	1	2	10	24	2
8	1	2	14	29	2
9	1	2	0	1	2
10	1	2	3	30	1
11	1	2	23	31	1
12	1	2	1	32	3
13	1	2	0	32	3
14	1	2	0	33	3
15	1	2	0	34	6
16	1	2	0	35	2
17	3	2	53	34	0
18	3	2	38	37	1
19	4	2	5	38	1
20	5	2	34	39	2
21	10	2	72	40	1
22	1	2	1	41	0
Fields					97
Moor Pits					1
Road					2
Road & Bann					2
Total					100 2 17

Scale of 3 Chains to One Inch

Surveyed by  
J. M. Christian Esq.  
1840