

ISLE OF MAN GOVERNMENT: GENERAL REGISTRY
ASYLUM PLANS: PARISH OF RUSHEN

Original monotone

1:23

(330)

*Ballagawne in Rushen
belonging to F. M. Gawne Esq?*

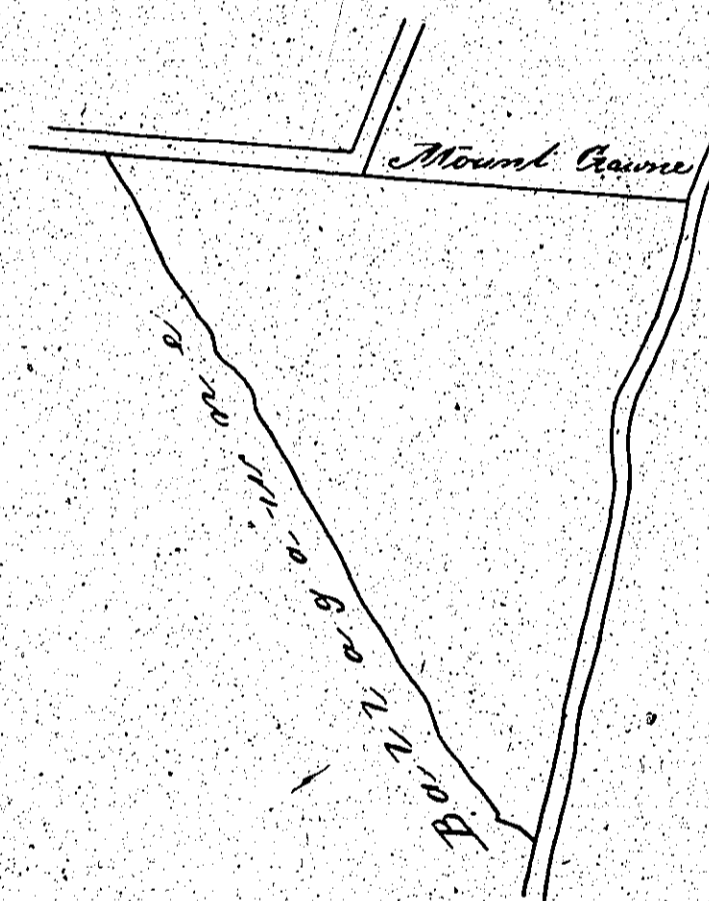

corrected 4. 3. 82

Scale 3 chains to an Inch

*Copied from plan 88 by
James Wood Surveyor 1863*

ISLE OF MAN GOVERNMENT: GENERAL REGISTRY

ASYLUM PLANS: PARISH OF RUSHEN

Original monotone

1:23

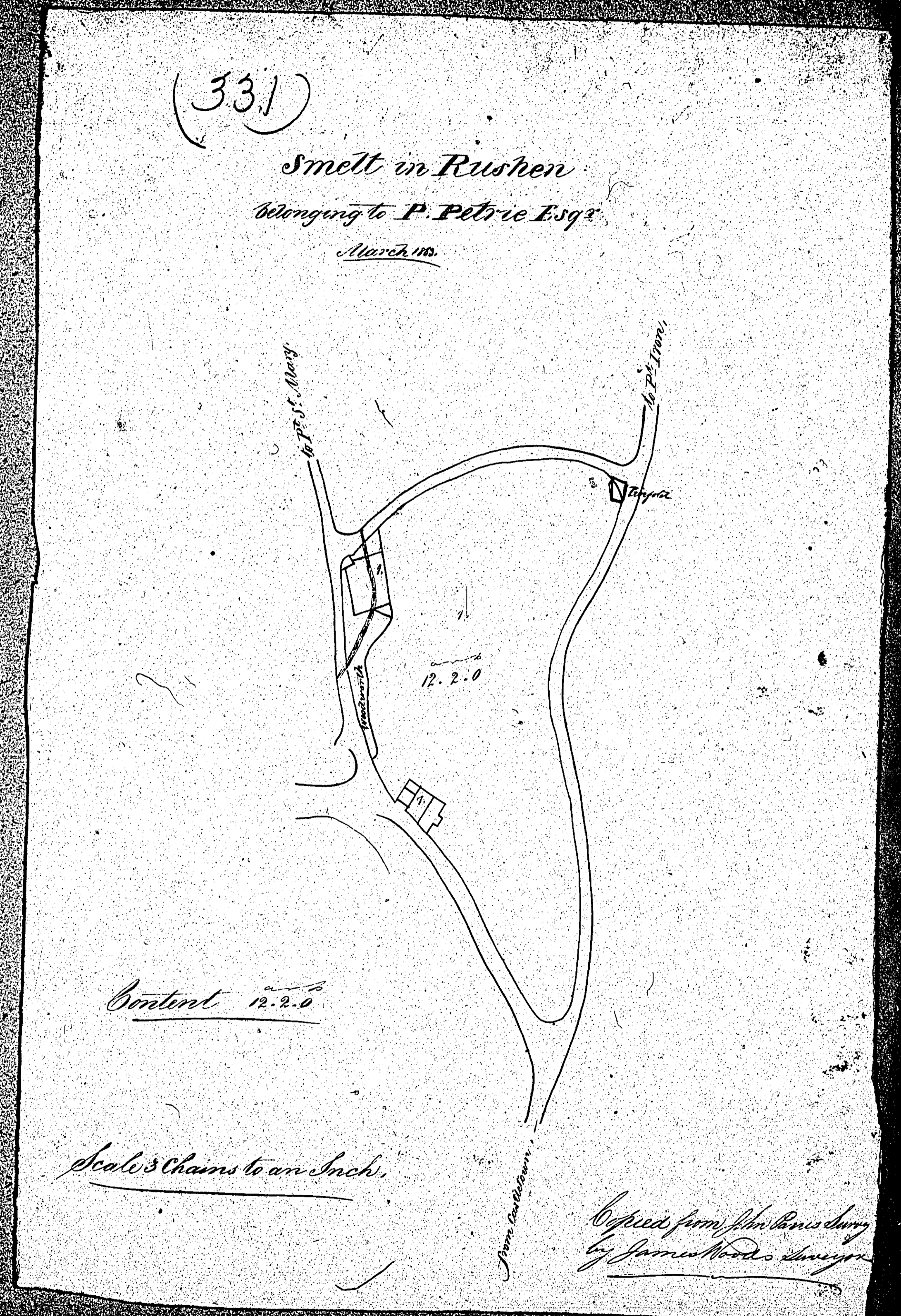

ISLE OF MAN GOVERNMENT: GENERAL REGISTRY

ASYLUM PLANS: PARISH OF RUSHEN

Originals coloured (decorative)

1:23

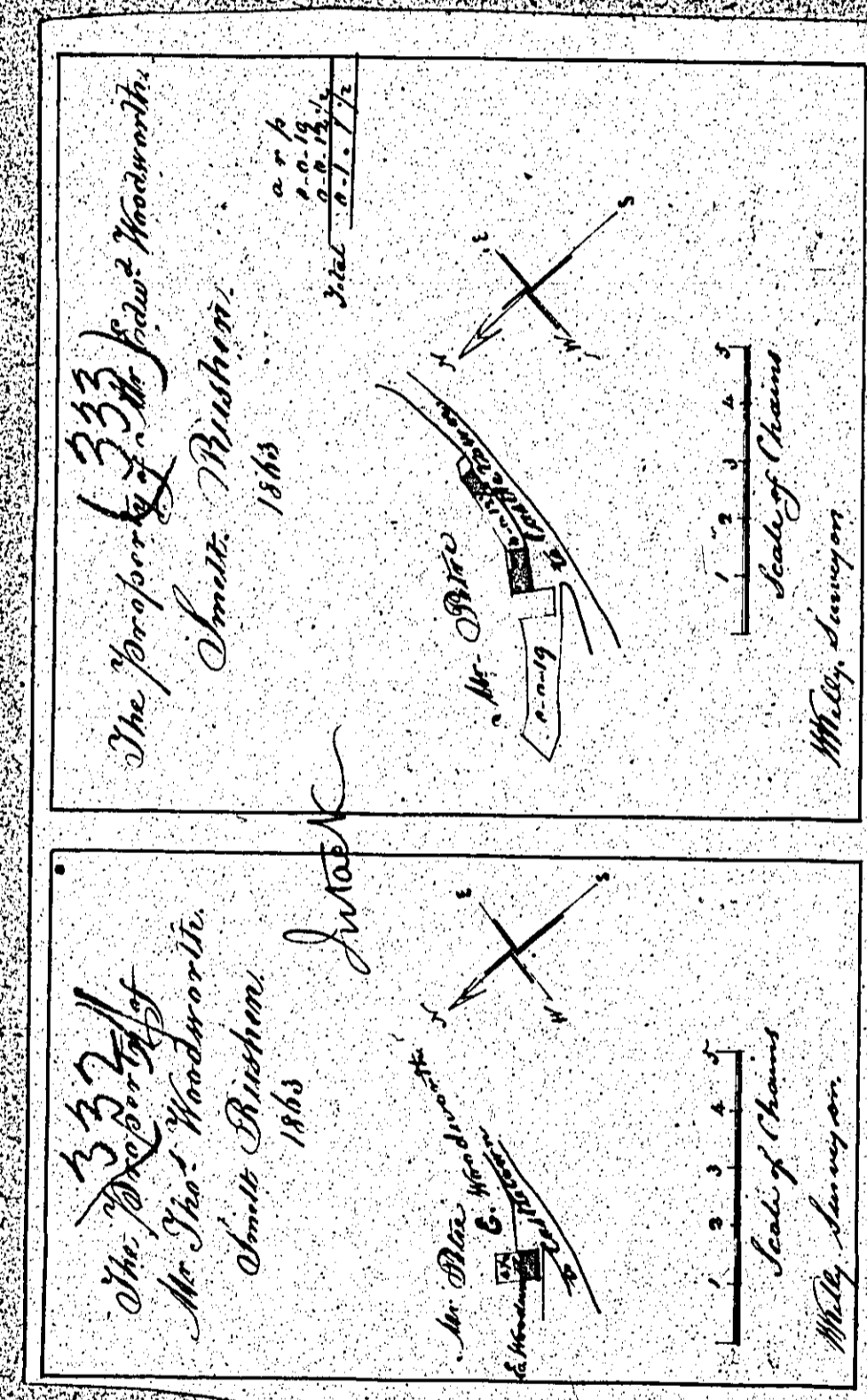

ISLE OF MAN GOVERNMENT: GENERAL REGISTRY

ASYLUM PLANS: PARISH OF RUSHEN

Original coloured

1:23

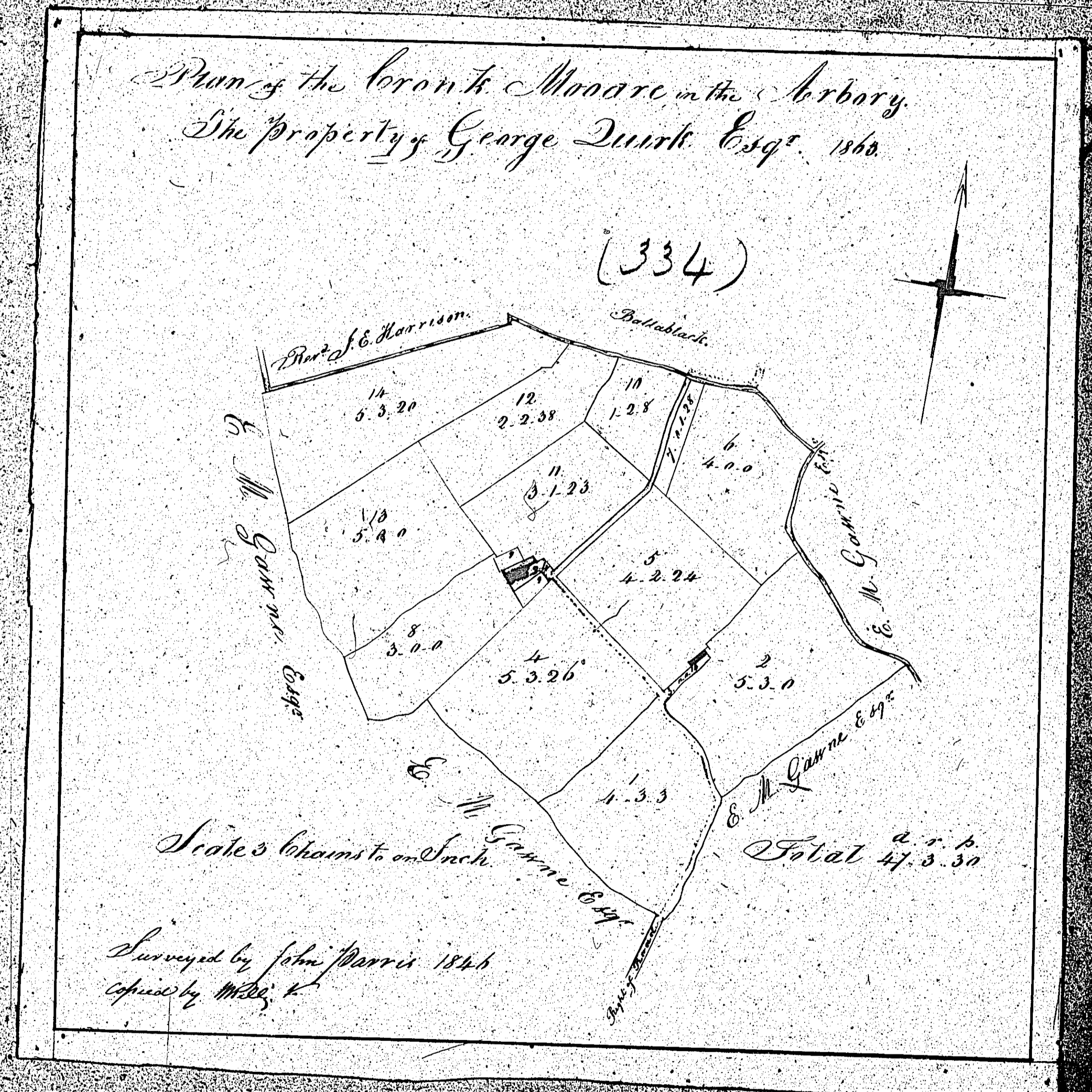

The following plan

is not numbered

but 335 is

pencilled on the back

Property in Rushen,
 belonging to E. M. Gawne Esquire.

March 1863.

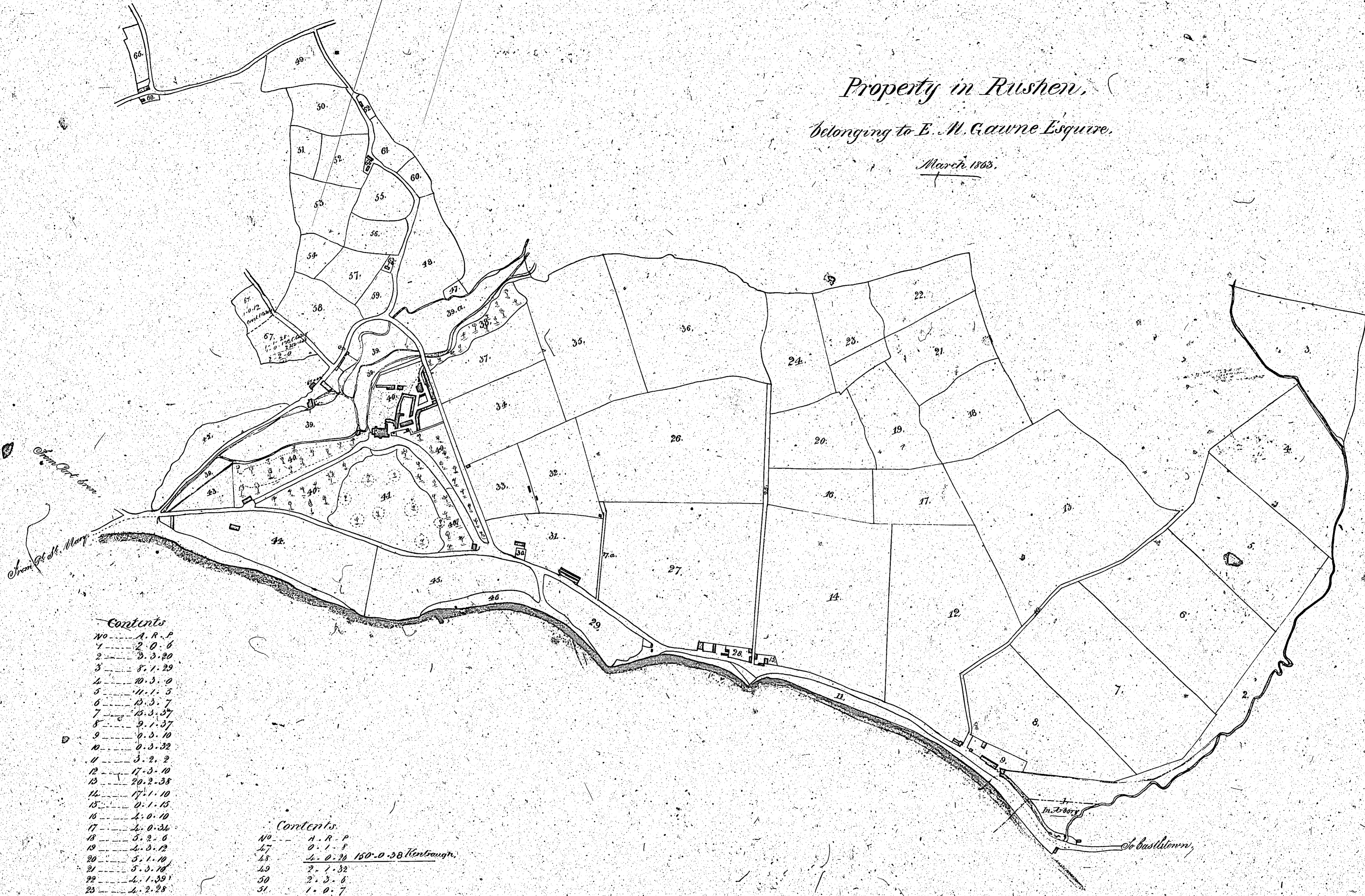

Contents

No.	A. R. P.
1	2.0.6
2	3.3.20
3	8.1.29
4	10.3.0
5	11.1.5
6	13.3.7
7	15.3.37
8	9.1.37
9	0.3.10
10	0.3.32
11	3.2.2
12	17.3.10
13	20.2.38
14	17.1.10
15	0.1.15
16	2.0.10
17	2.0.36
18	5.2.6
19	4.3.12
20	5.1.10
21	5.3.18
22	4.1.39
23	4.2.28
24	4.3.22
25	0.1.25
<i>Strand Hall</i> 181.1.17	
26	17.2.20
27	18.0.0
28	0.1.22
29	2.2.38
30	0.1.0
31	4.3.30
32	4.2.10
33	3.8.1
34	6.0.10
35	11.0.30
36	13.2.27
37	4.2.12
38	1.2.18
39	7.2.2
39a	3.3.36
40	14.3.22
41	8.0.10
42	1.0.35
44	9.2.8
45	7.0.28
46	3.2.30
47a	0.1.0
48	2.3.38
<i>Hentraugh</i> 125.3.4	

Contents

No.	A. R. P.
47	0.1.8
48	4.0.20
49	2.1.32
50	2.3.8
51	1.0.7
52	2.1.15
53	2.2.22
54	1.0.12
55	1.3.26
56	1.2.35
57	2.0.4
58	3.0.20
59	1.0.0
60	0.3.0
61	1.0.6
62	0.0.30
63	0.0.38
64	0.0.18
<i>Orrswale</i> 24.1.16	
65	0.2.33
66	0.0.3
<i>The Level</i> 0.3.2	
<i>Will Croft</i> 2.2.2	

Contents

<i>Strand Hall</i>	181.1.17
<i>Hentraugh</i>	150.0.38
<i>Orrswale</i>	24.1.16
<i>The Level</i>	1.3.14
<i>Will Croft</i>	1.1.30
Total	360.0.35

ISLE OF MAN GOVERNMENT: GENERAL REGISTRY
 ASYLUM PLANS: PARISH OF RUSHEN

Original coloured

1:23

Scale 40 chains to an Inch

Copied and reduced from John Parry's Survey
 for Valuers of Land under the Lunatic Asylum
 Act, by James Woods, Surveyor 1853.