

ISLE OF MAN GOVERNMENT: GENERAL REGISTRY

ASYLUM PLANS: PARISH OF ONCHAN

Original coloured (decorative)

1:23

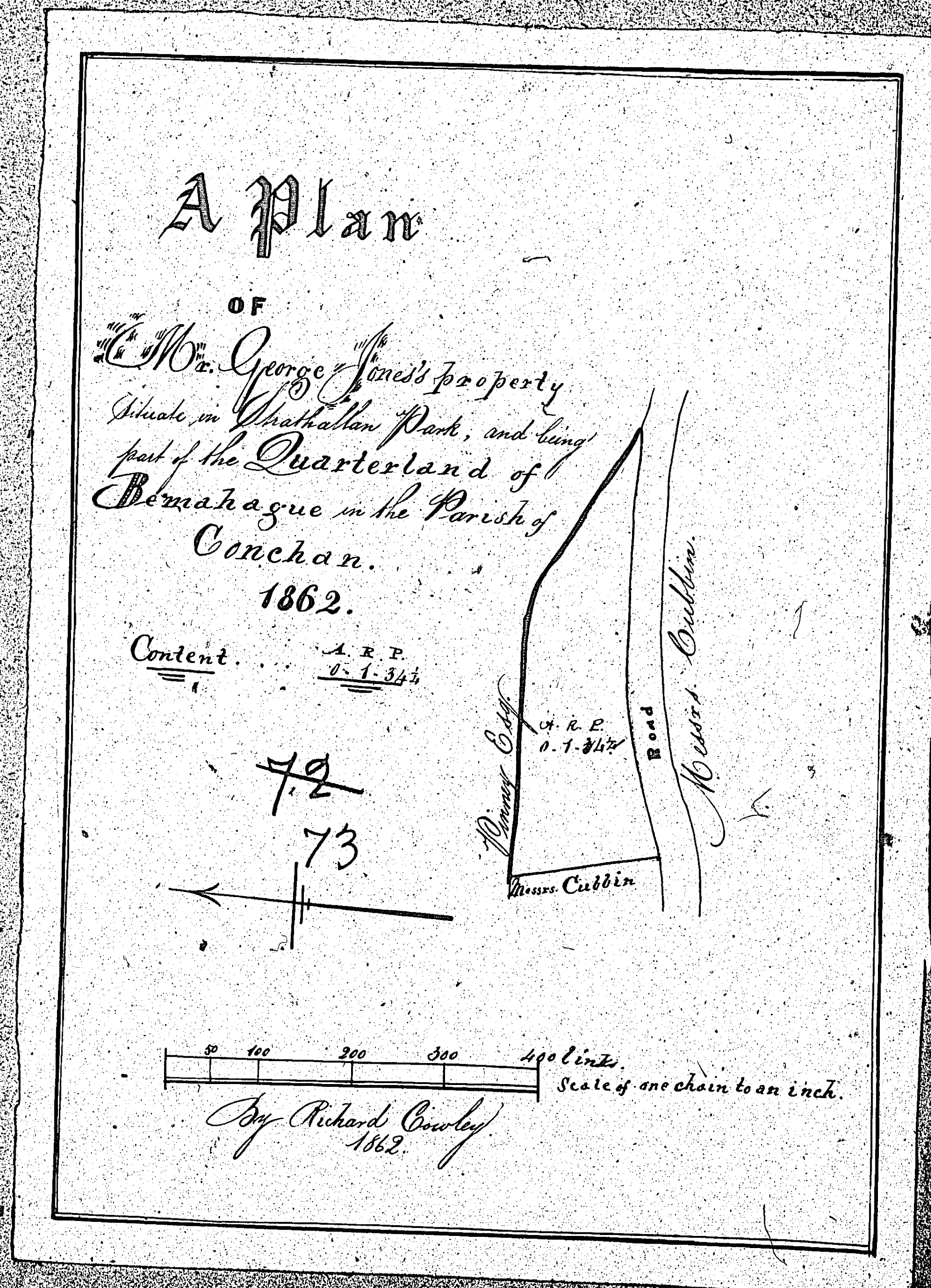

# A Plan

of  
 Messrs. Cubbins property called Srathallan-Park, being part of the  
 Quarterland of Bimahague in the Parish of Conchan - 1862.

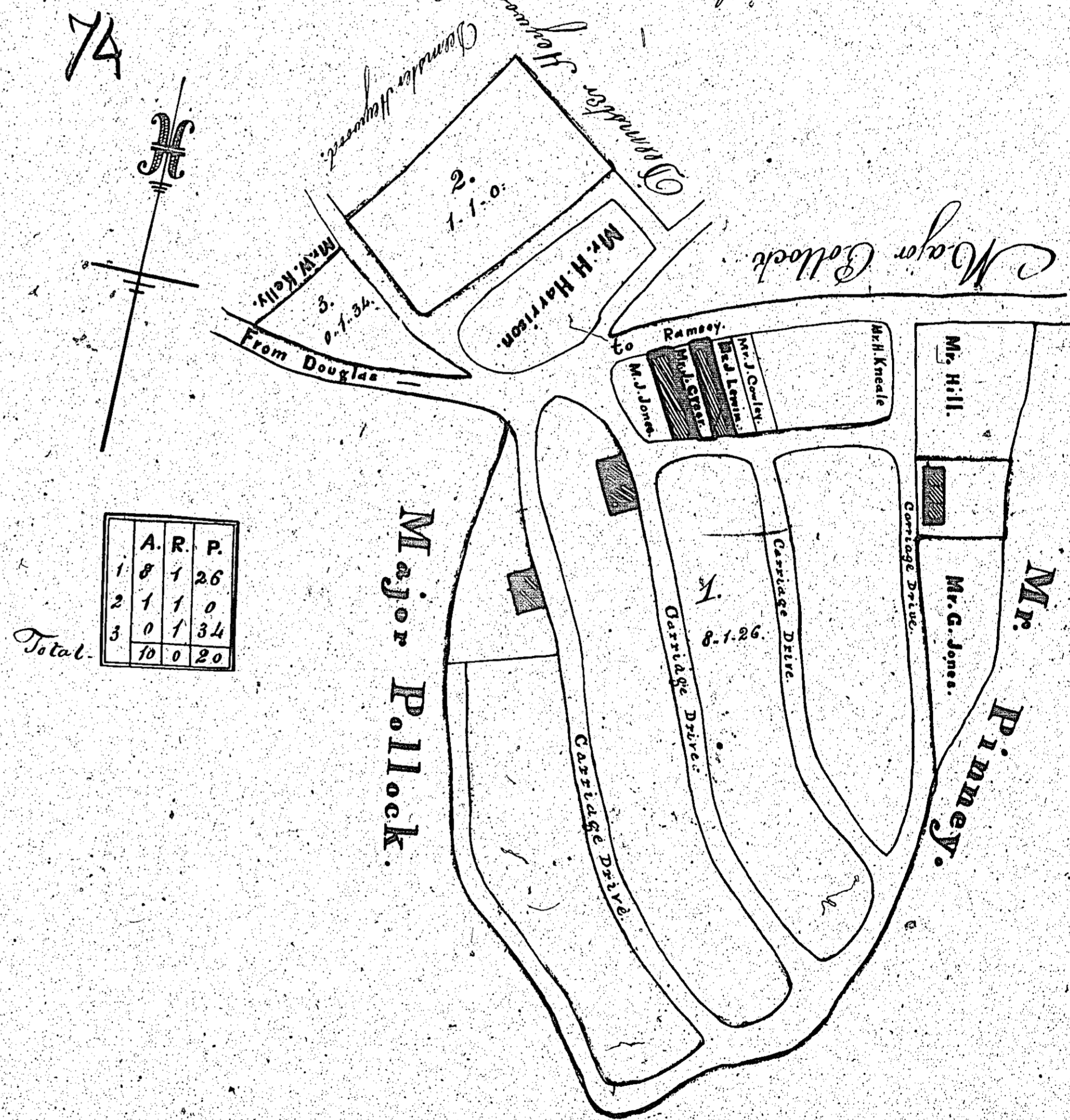

	A.	R.	P.
	1	0	1 26
	2	1	1 0
	3	0	1 34
Total.	6	1	0 20

By Richard Cowley,  
 Surveyor,  
 Conchan.

Scale of 2 chains to an inch.

ISLE OF MAN GOVERNMENT: GENERAL REGISTRY

ASYLUM PLANS: PARISH OF ONCHAN

Original coloured

1:23

ISLE OF MAN GOVERNMENT: GENERAL REGISTRY

ASYLUM PLANS: PARISH OF ONCHAN

1:23

- 75 Original monotone
- 76 Original coloured (decorative)

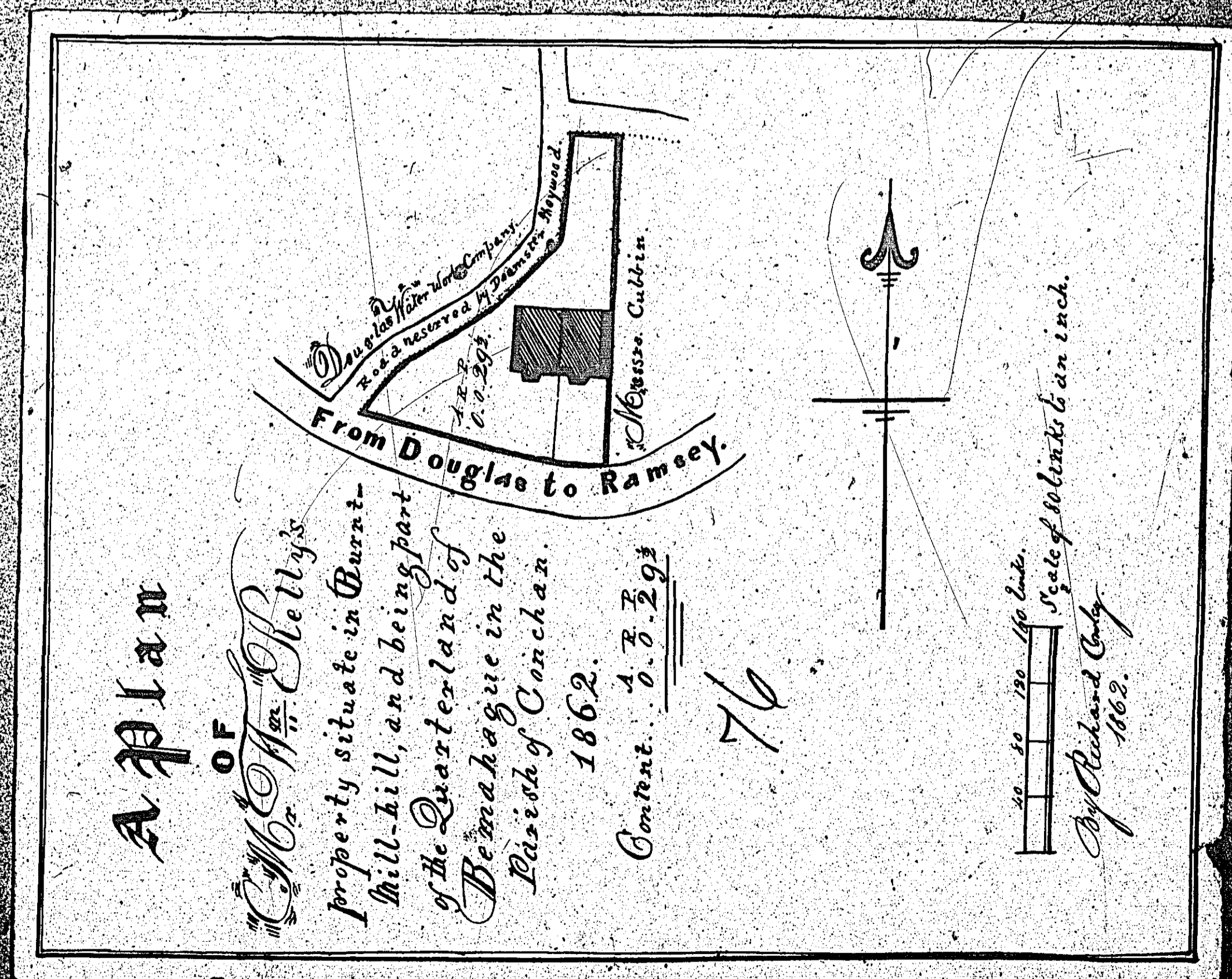
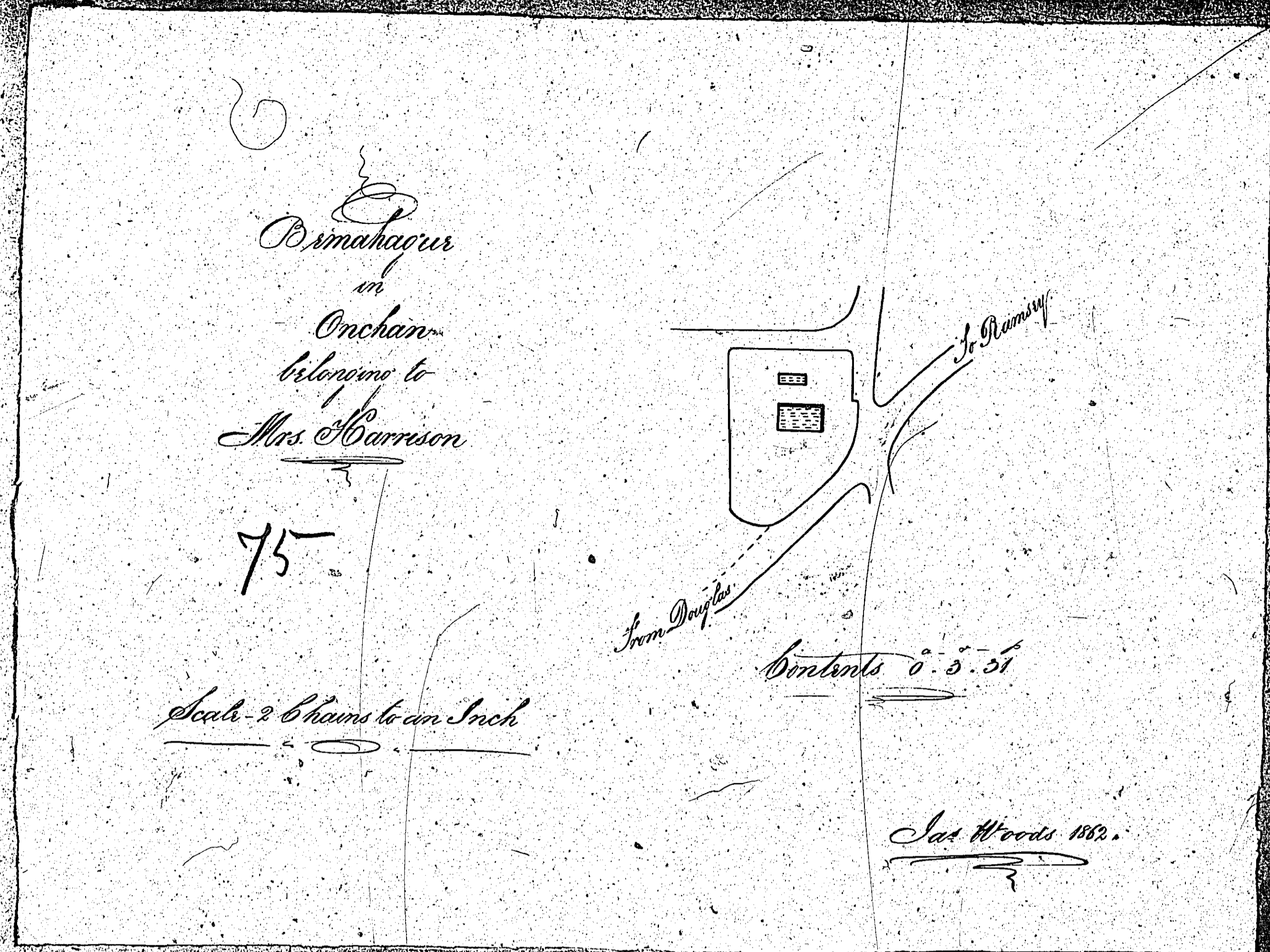

ISLE OF MAN GOVERNMENT: GENERAL REGISTRY

ASYLUM PLANS: PARISH OF ONCHAN

1:23

- 77 Original monotone
- 78 Original coloured (decorative)

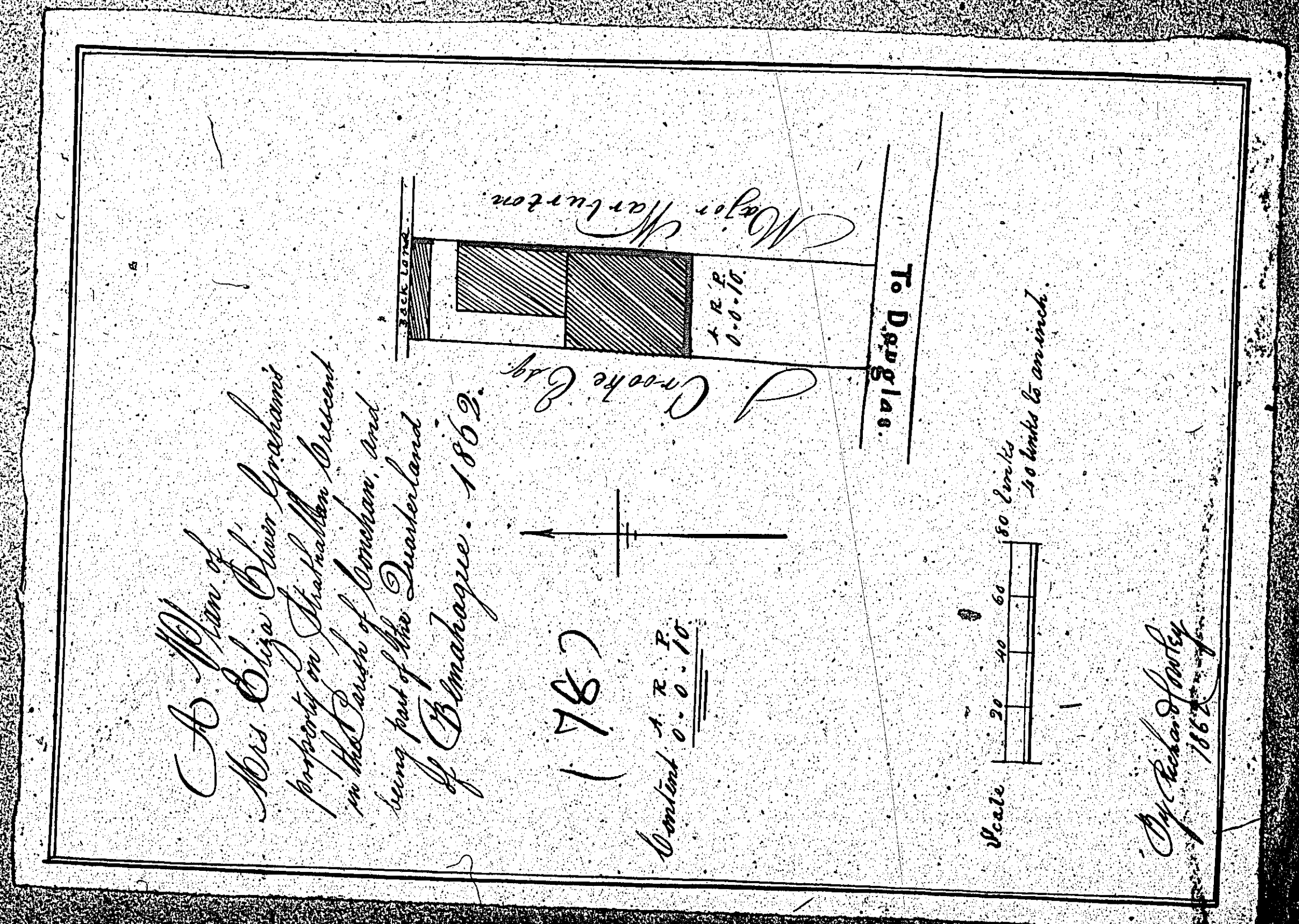
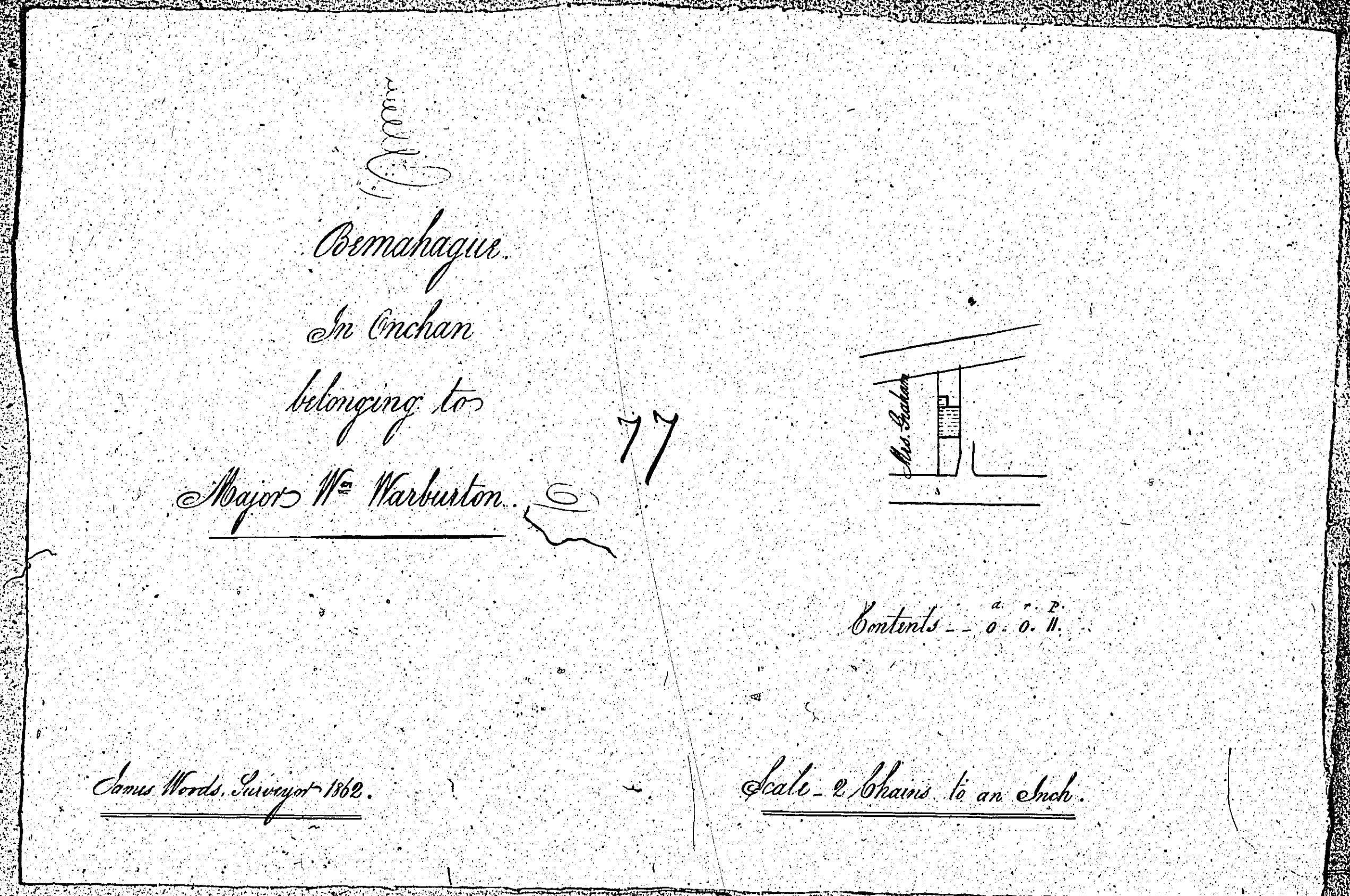

ISLE OF MAN GOVERNMENT: GENERAL REGISTRY

ASYLUM PLANS: PARISH OF ONCHAN

Originals coloured (decorative)

1:23

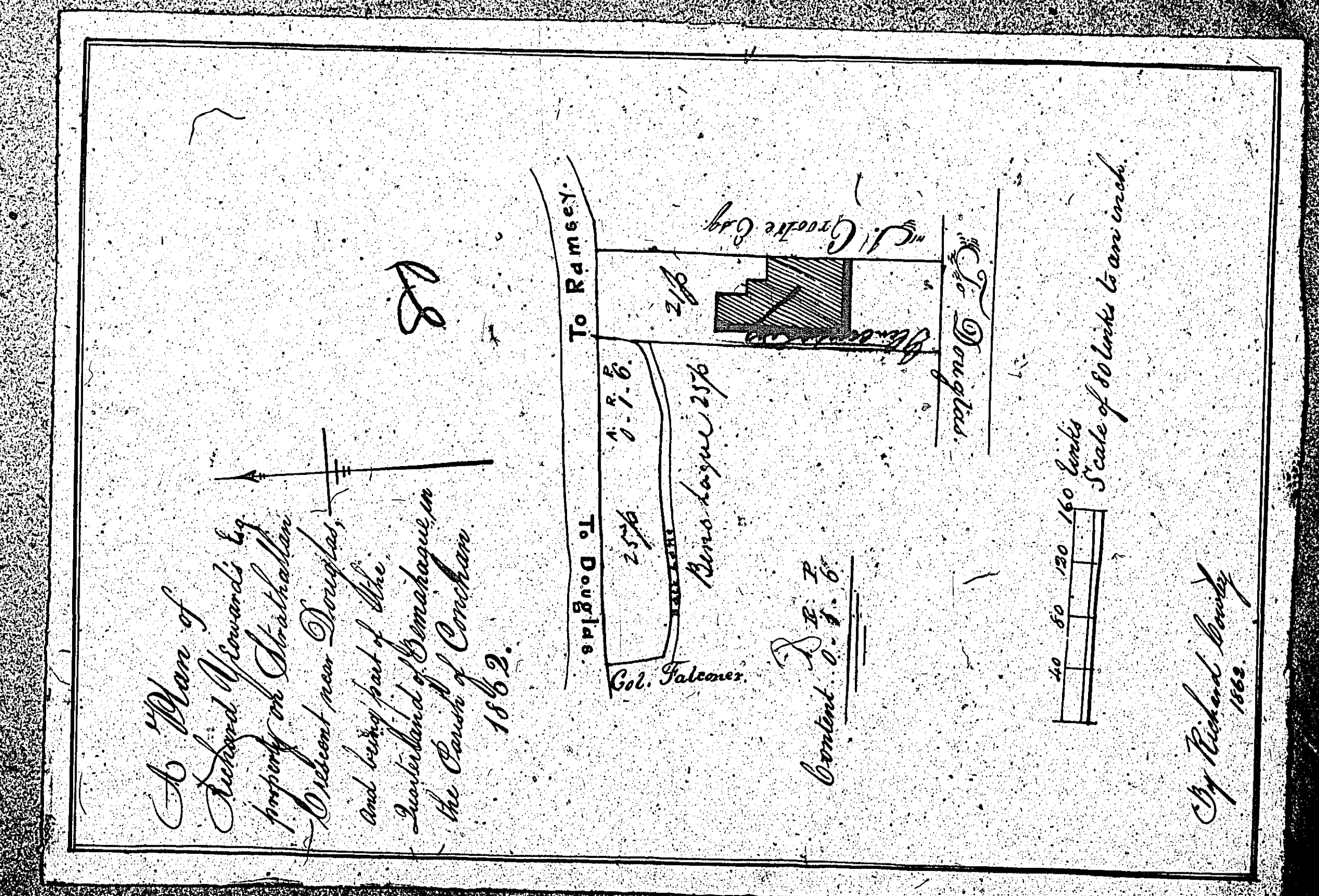
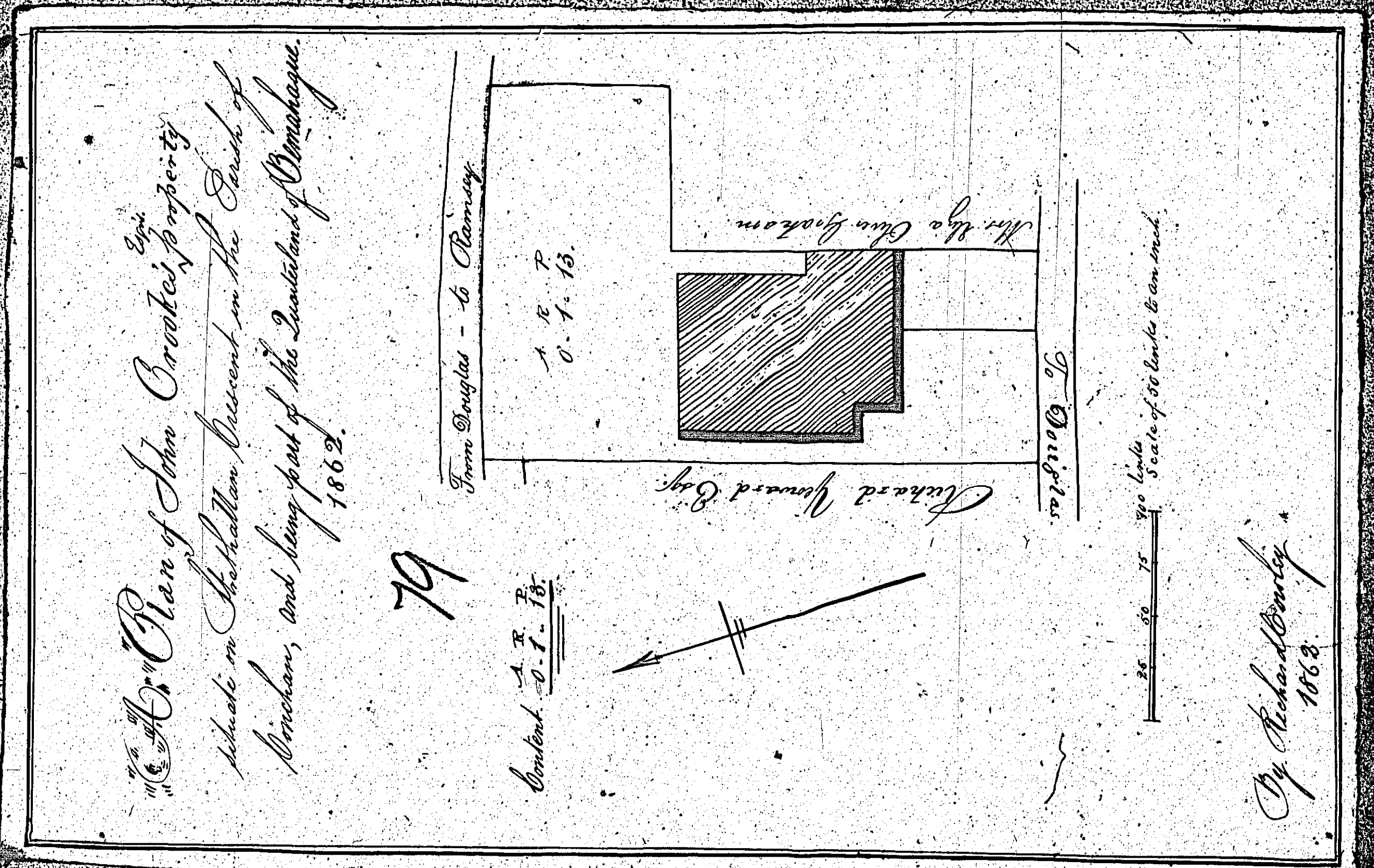

ISLE OF MAN GOVERNMENT: GENERAL REGISTRY

ASYLUM PLANS: PARISH OF ONCHAN

Original monotone

1:23



*Benahague in Conchan,  
belonging to William Dwyer Esq.*

*Scale 1. Chain*

*Contents*

<i>Benahague</i>	<i>113-3-16</i>
<i>Benahague</i>	<i>45-2-17</i>
<i>Benahague</i>	<i>13-1-31</i>
<i>Total</i>	<i>171-0-84</i>

*Note - The area of 171 acres 0 c 84 is the total of the Benahague.*

*Copied from plan 97 of  
Gen. Woods, 1864.*