

Plan 7 is bound
out of sequence
with plan 5

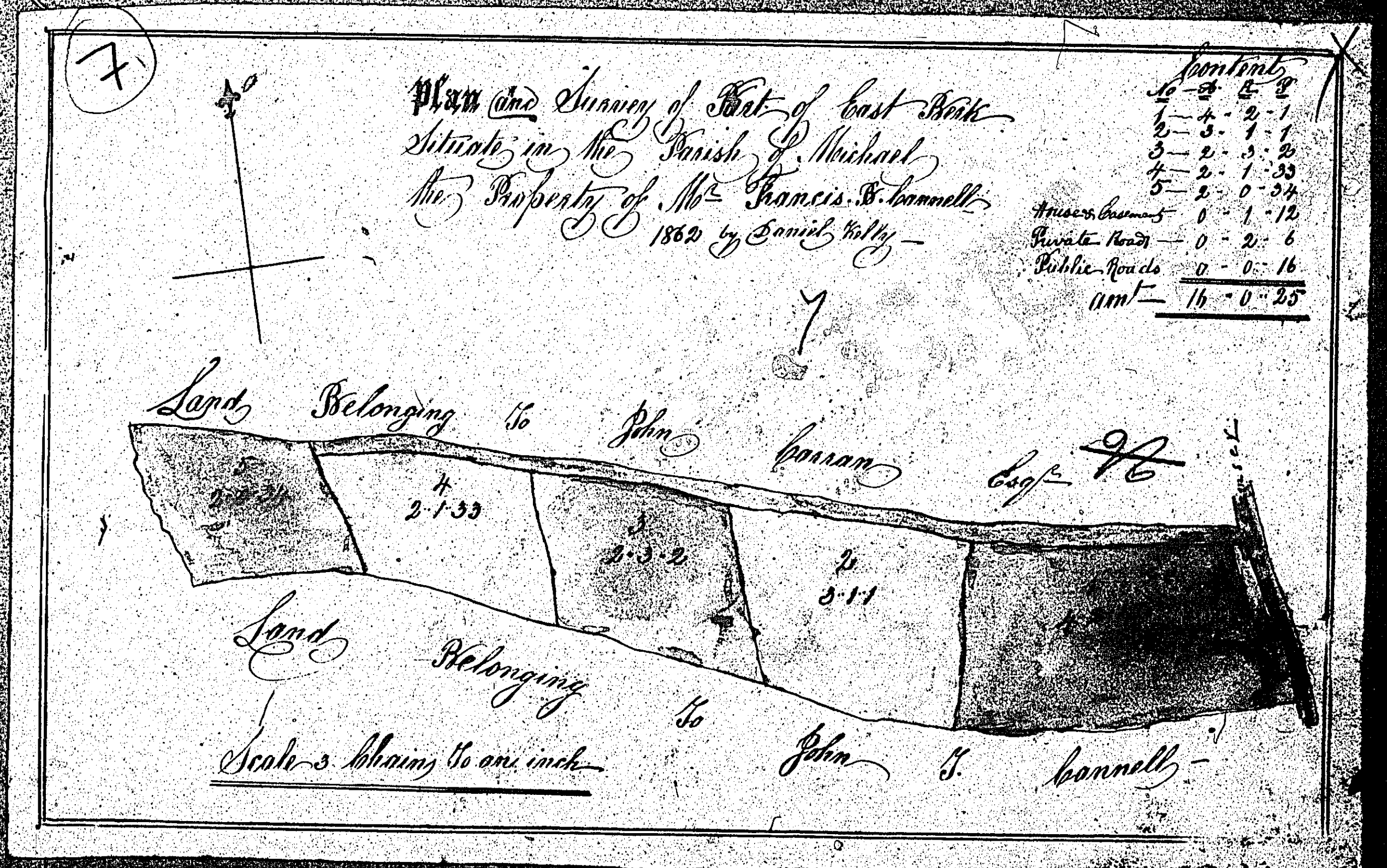
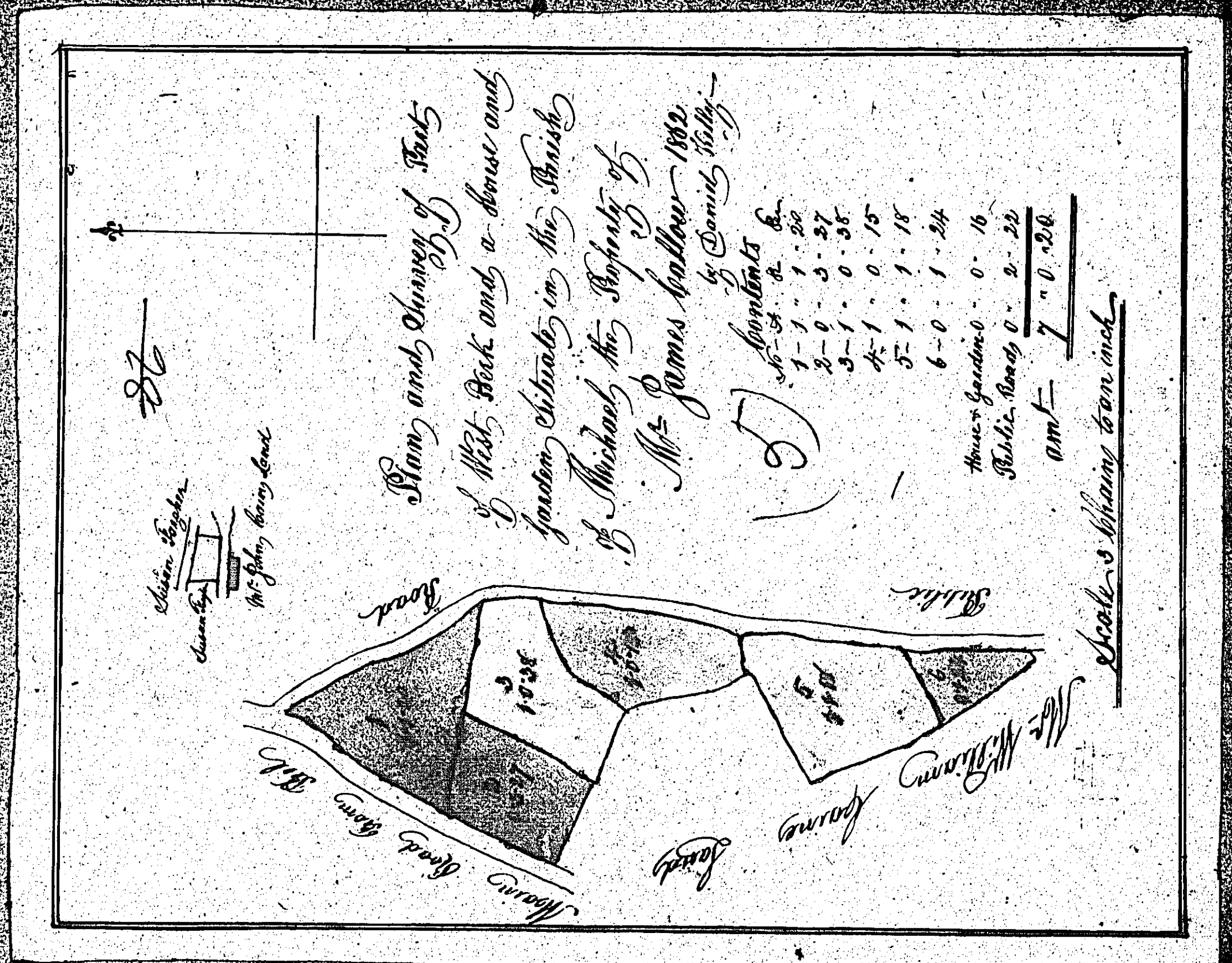

ISLE OF MAN GOVERNMENT: GENERAL REGISTRY

ASYLUM PLANS: PARISH OF MICHAEL

Originals coloured

1:23

ISLE OF MAN GOVERNMENT: GENERAL REGISTRY

ASYLUM PLANS: PARISH OF MICHAEL

Original coloured

1:23

Plan & Survey of Part of West and East Parishes,
situated in the Parish of Michael,
the Property of Mr. John Spinnell,
1860, by David, Esq.

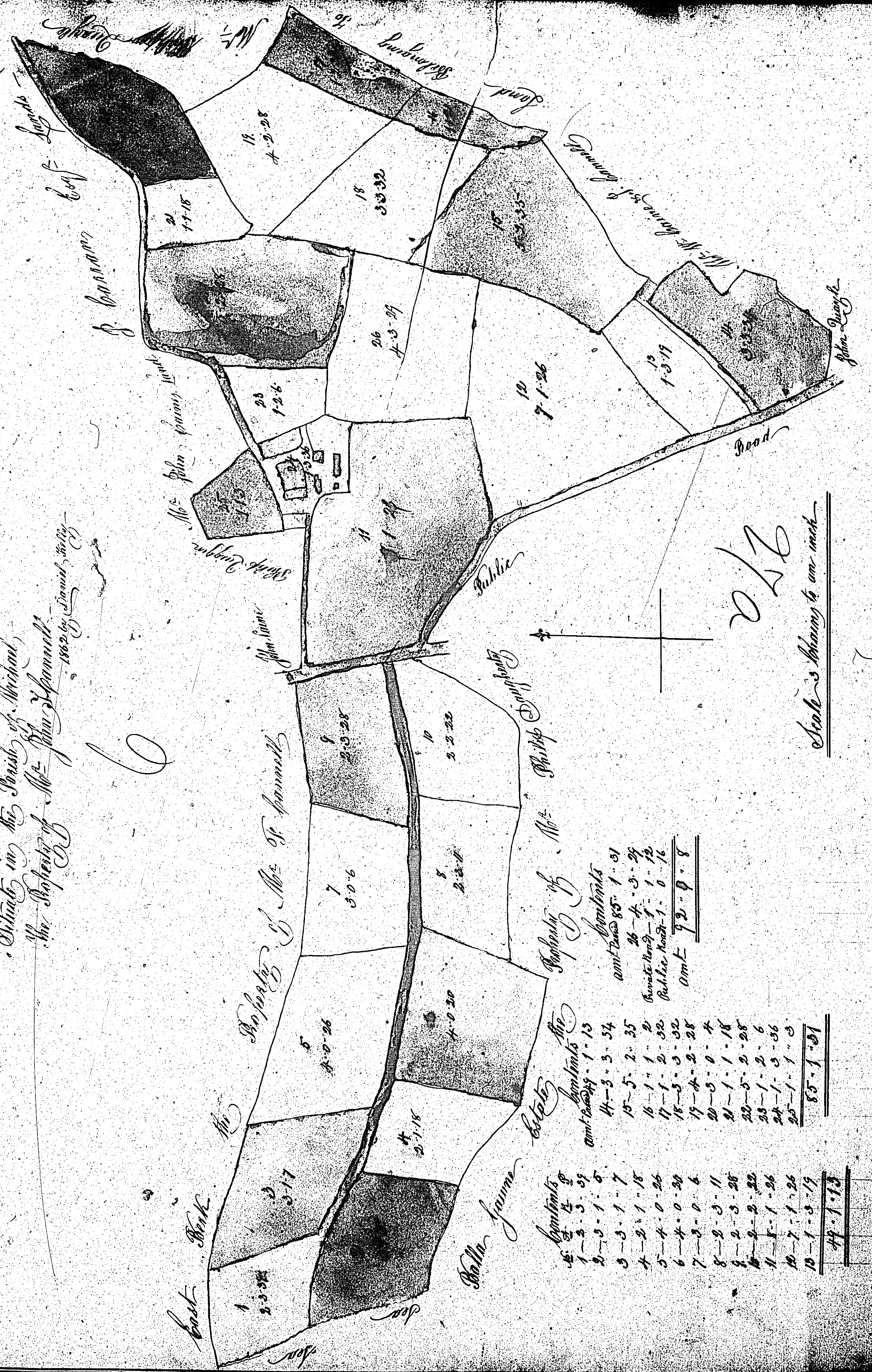

1	2-3-58	15-5-2-35	amt 200-0-0
2	1-18	16-1-1-2	amt 200-0-0
3	3-17	17-1-2-32	amt 200-0-0
4	2-18	18-3-3-22	amt 200-0-0
5	4-0-26	19-4-2-28	amt 200-0-0
6	4-0-20	20-3-0-4	amt 200-0-0
7	3-0-6	21-1-1-18	amt 200-0-0
8	2-2-0	22-3-2-28	amt 200-0-0
9	2-3-28	23-1-2-6	amt 200-0-0
10	3-2-20	24-1-3-36	amt 200-0-0
11	1-1-29	25-1-1-3	amt 200-0-0
12	1-3-19		amt 200-0-0
13	1-3-19		amt 200-0-0
14	2-3-54		amt 200-0-0
15	5-5-25		amt 200-0-0
16	3-3-20		amt 200-0-0
17	1-3-29		amt 200-0-0
18	3-3-20		amt 200-0-0
19	4-2-28		amt 200-0-0
20	3-0-4		amt 200-0-0
21	1-1-18		amt 200-0-0
22	2-3-28		amt 200-0-0
23	1-2-6		amt 200-0-0
24	1-3-36		amt 200-0-0
25	1-1-3		amt 200-0-0
26	4-3-29		amt 200-0-0
27	1-2-6		amt 200-0-0
28	1-1-18		amt 200-0-0
29	1-3-29		amt 200-0-0
30	1-3-29		amt 200-0-0
		85-1-21	

272

Scale's bearing to one inch

ISLE OF MAN GOVERNMENT: GENERAL REGISTRY

ASYLUM PLANS: PARISH OF MICHAEL

1:23

- 8 Original monotone
- 9 Original coloured
- 10 Original coloured

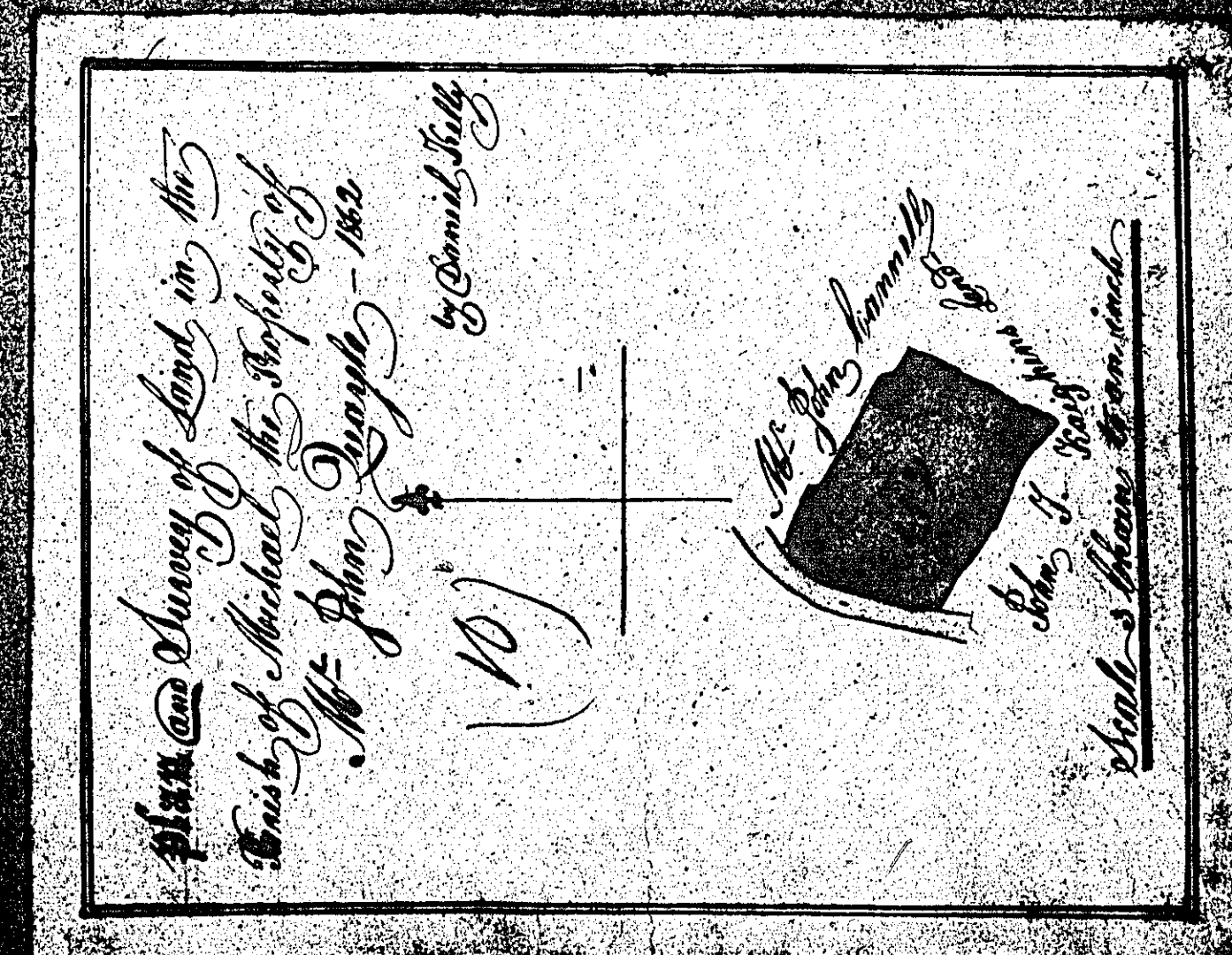
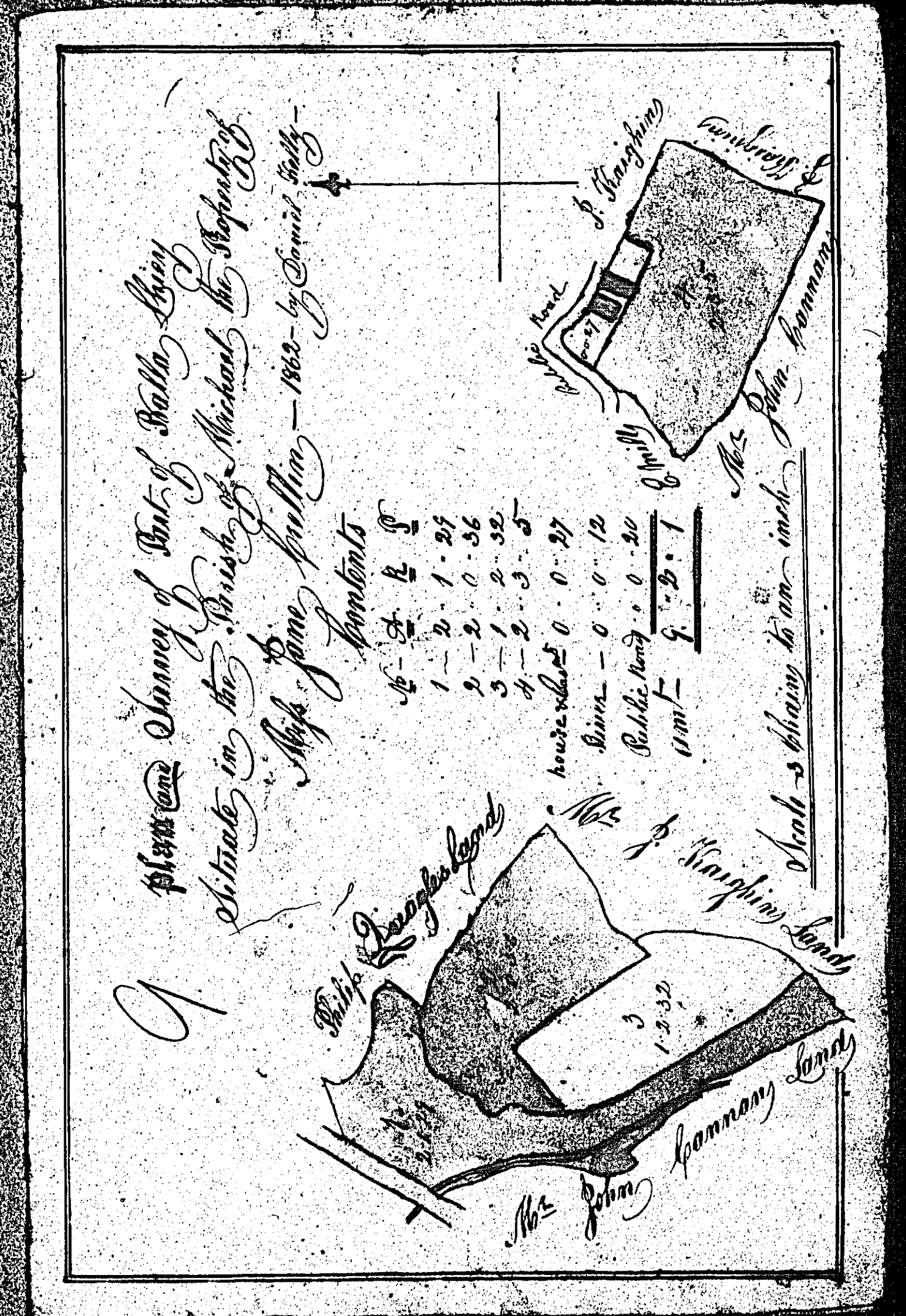
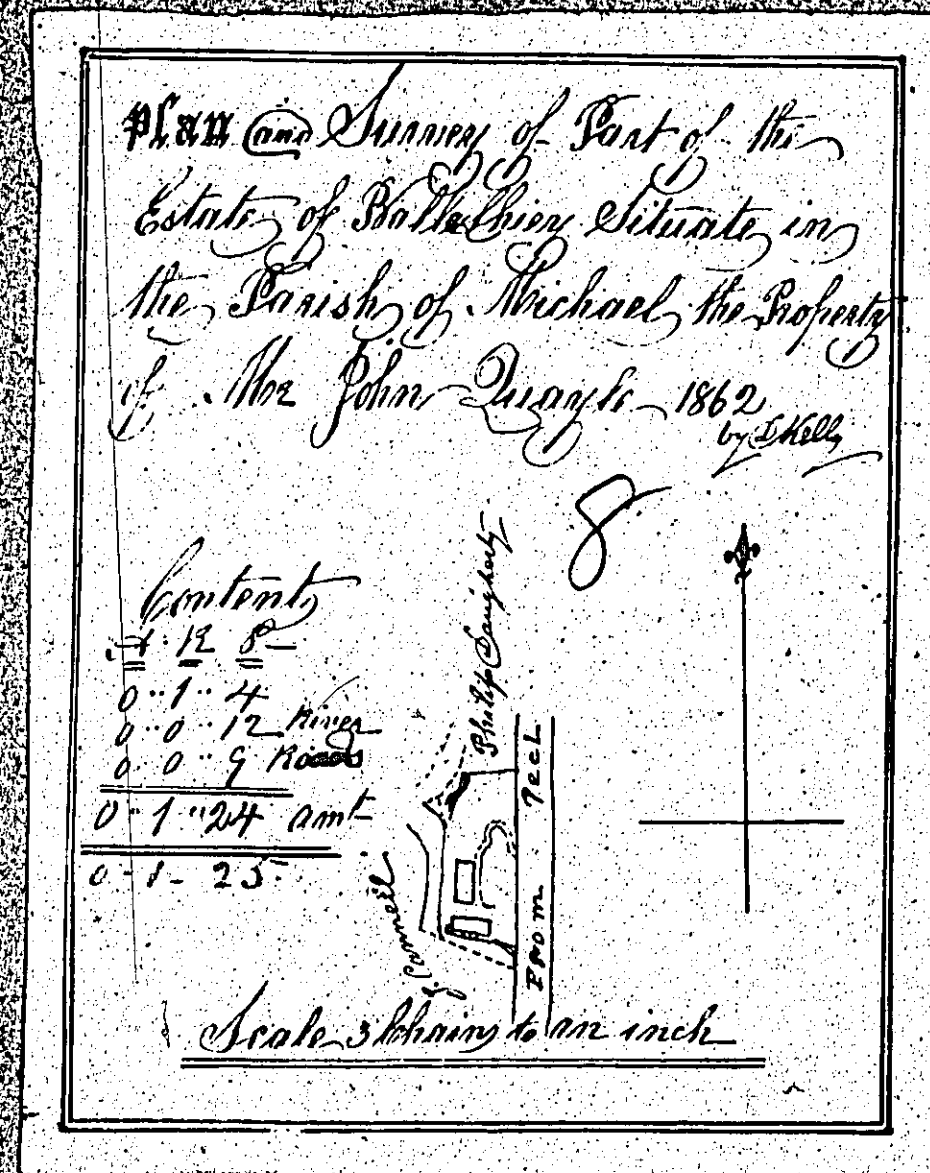

ISLE OF MAN GOVERNMENT: GENERAL REGISTRY

ASYLUM PLANS: PARISH OF MICHAEL

Original coloured

1:23

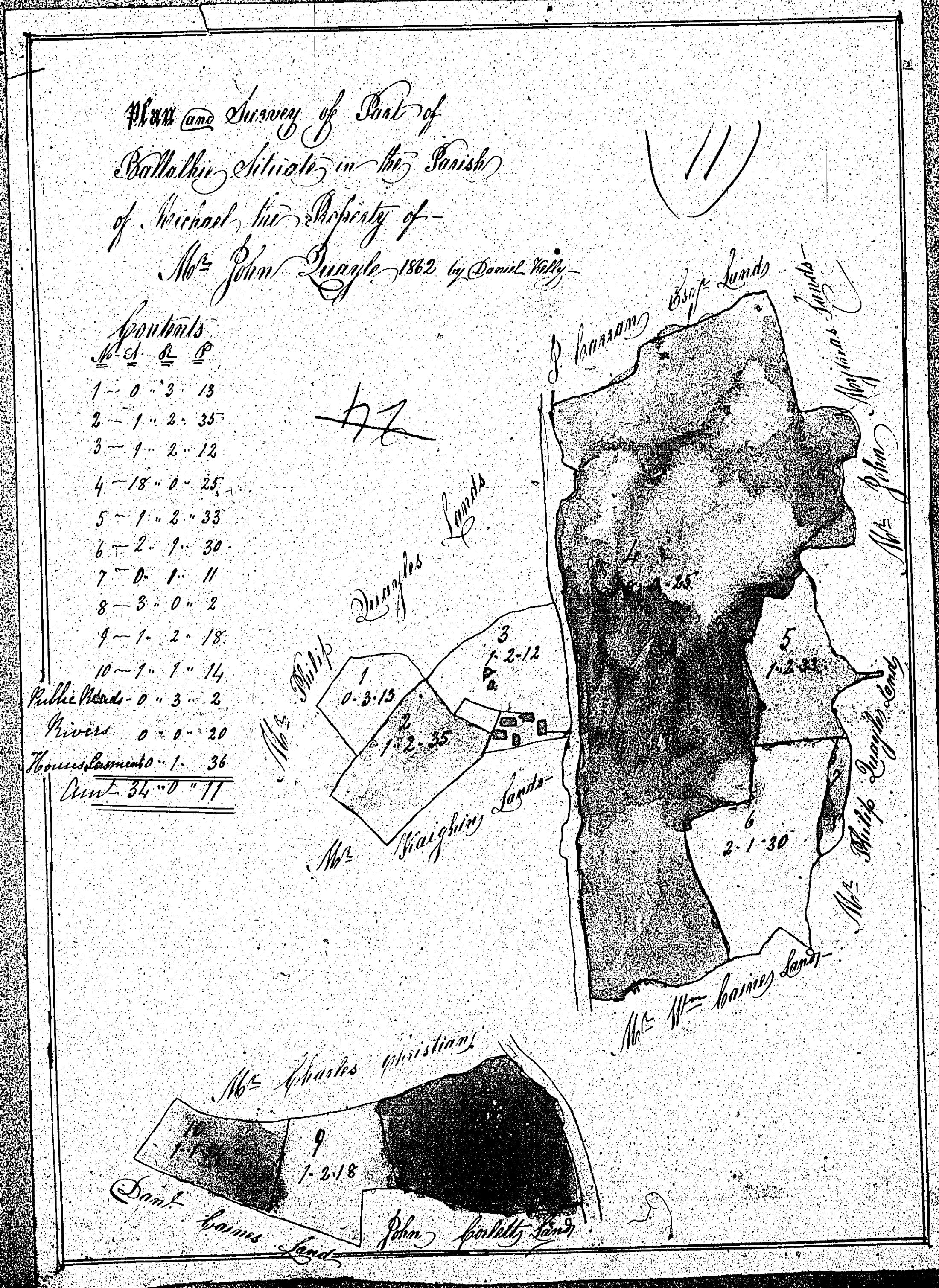

ISLE OF MAN GOVERNMENT: GENERAL REGISTRY

ASYLUM PLANS: PARISH OF MICHAEL

Original coloured

1:23

*Plans and Survey of Part of the Estate of Ballin near
 Glenties in the Parish of Michael the Property of
 Mr. Daniel Quinn - 1852 - by Daniel Quinn*

19

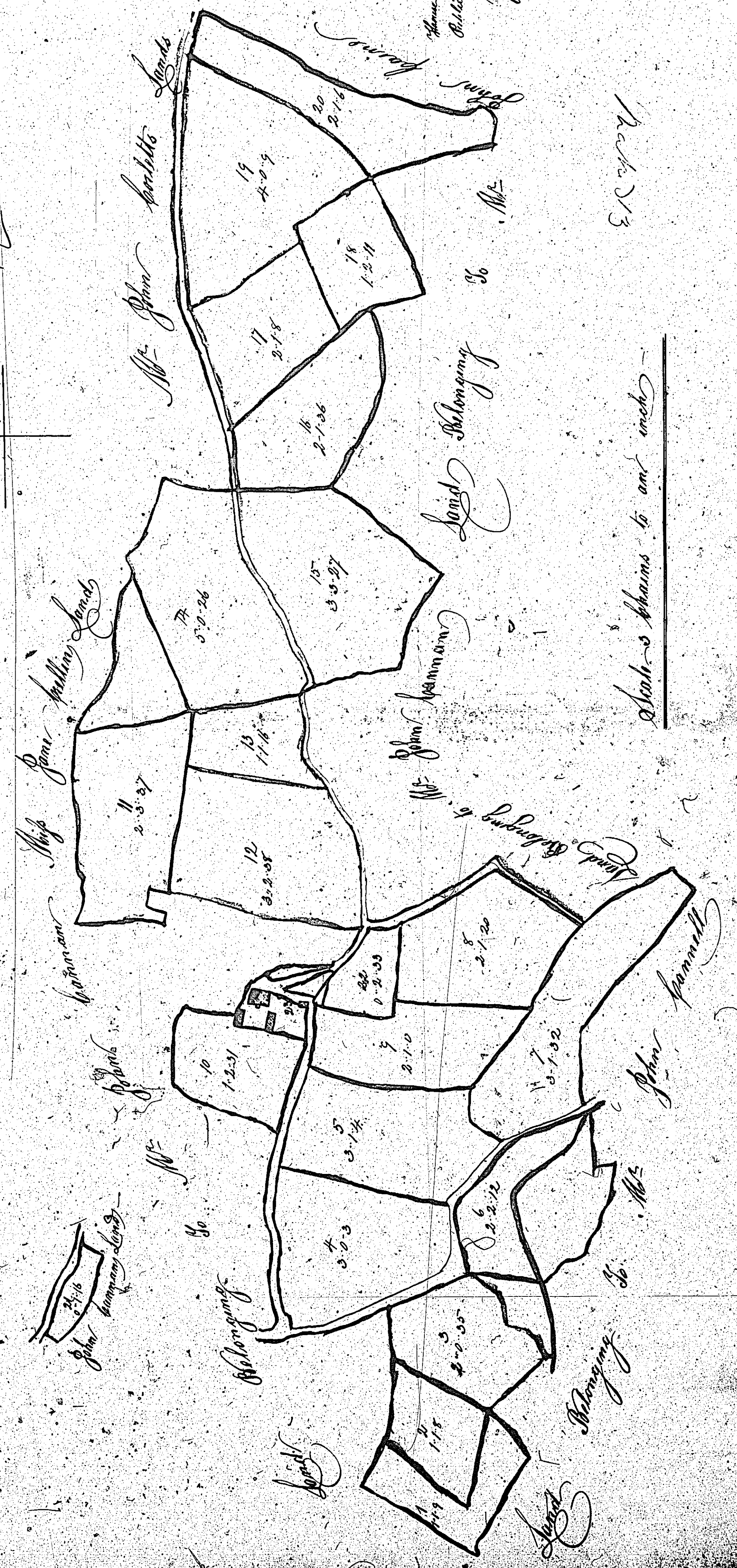

Summation

1	1.1.9
2	1.1.8
3	2.0.35
4	5.0.5
5	5.1.4
6	2.2.12
7	3.1.32
8	2.1.20
9	2.1.0
10	1.2.31
11	2.3.37
12	3.2.35
13	1.1.16
14	5.0.26
15	3.3.27
16	2.1.36
17	2.2.18
18	1.2.11
19	4.0.9
20	2.1.6
21	0.1.16
22	0.2.33
<i>Summation</i> 22 0.2.33	
<i>Other</i> 1.2.16	
<i>Summation</i> 23 1.2.16	
<i>Other</i> 0.1.10	
<i>Summation</i> 24 57.0.2	

Scale 1/3

Scale in chains to and inches

ISLE OF MAN GOVERNMENT: GENERAL REGISTRY

ASYLUM PLANS: PARISH OF MICHAEL

Originals coloured

1:23

12

