

ISLE OF MAN GOVERNMENT: GENERAL REGISTRY

ASYLUM PLANS: PARISH OF MAUGHOLD

Original monotone

1:23

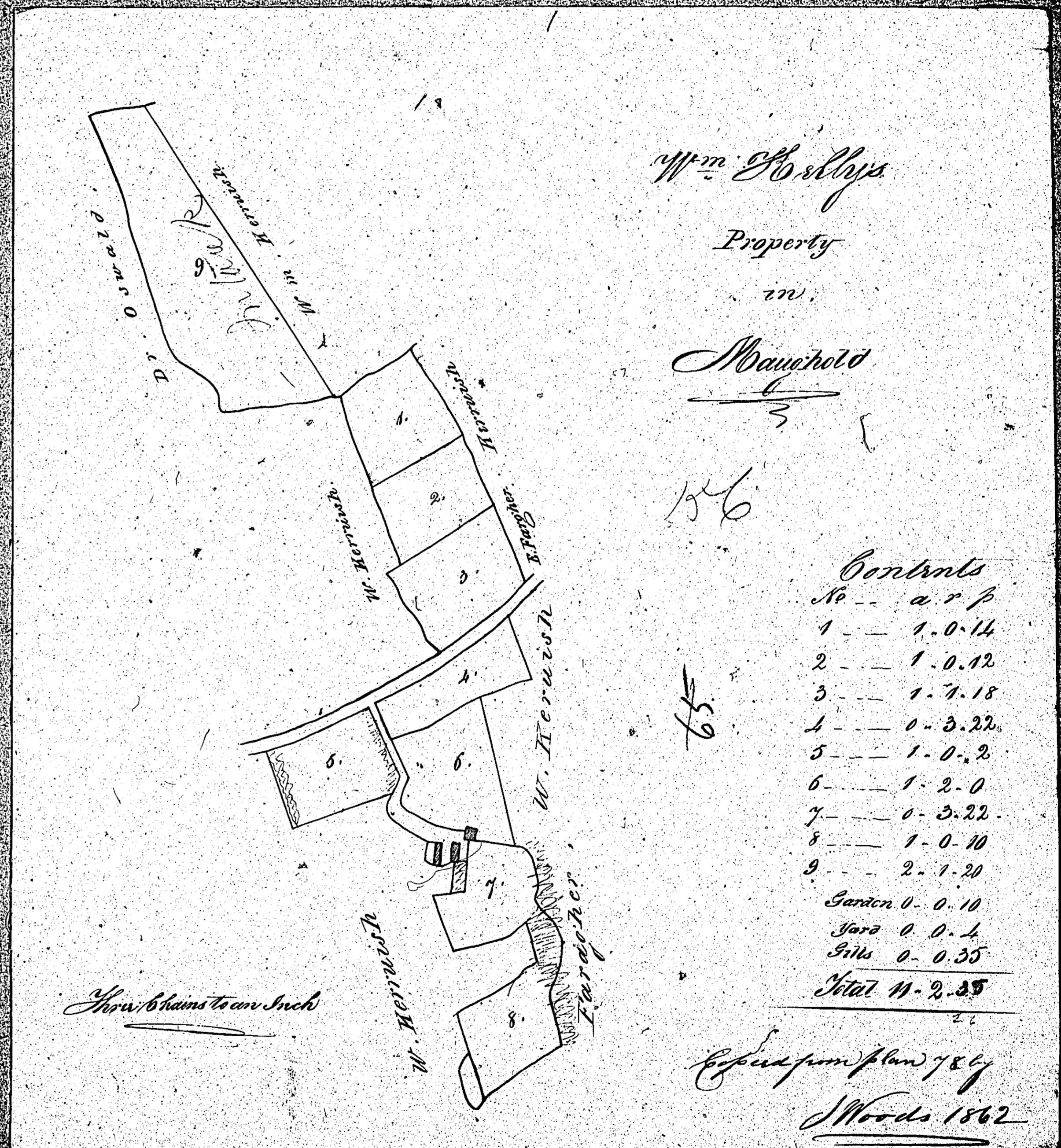

ISLE OF MAN GOVERNMENT: GENERAL REGISTRY

ASYLUM PLANS: PARISH OF MAUGHOLD

Original monotone

1:23

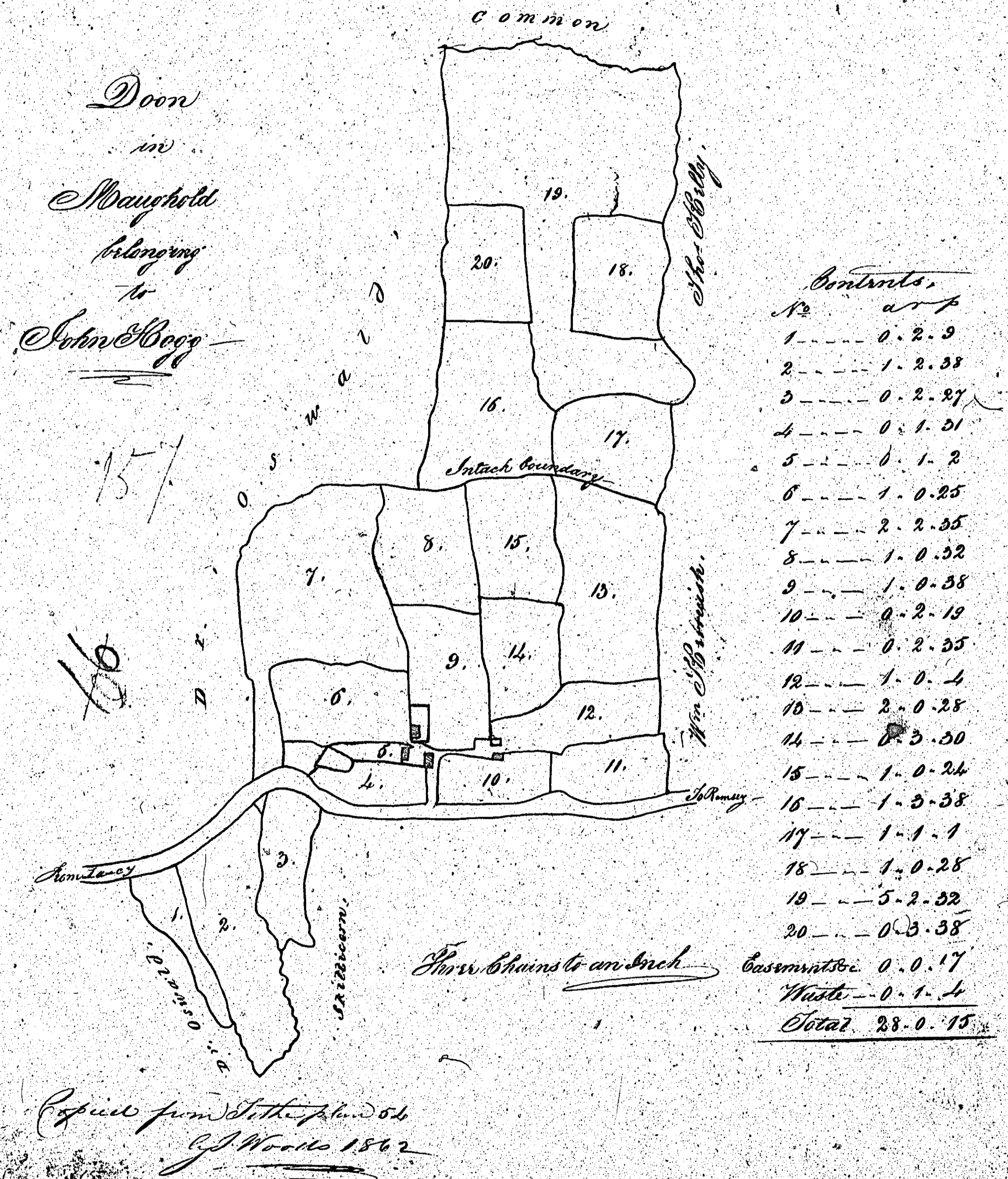

ISLE OF MAN GOVERNMENT; GENERAL REGISTRY

ASYLUM PLANS: PARISH OF MAUGHOLD

Original coloured

1:23

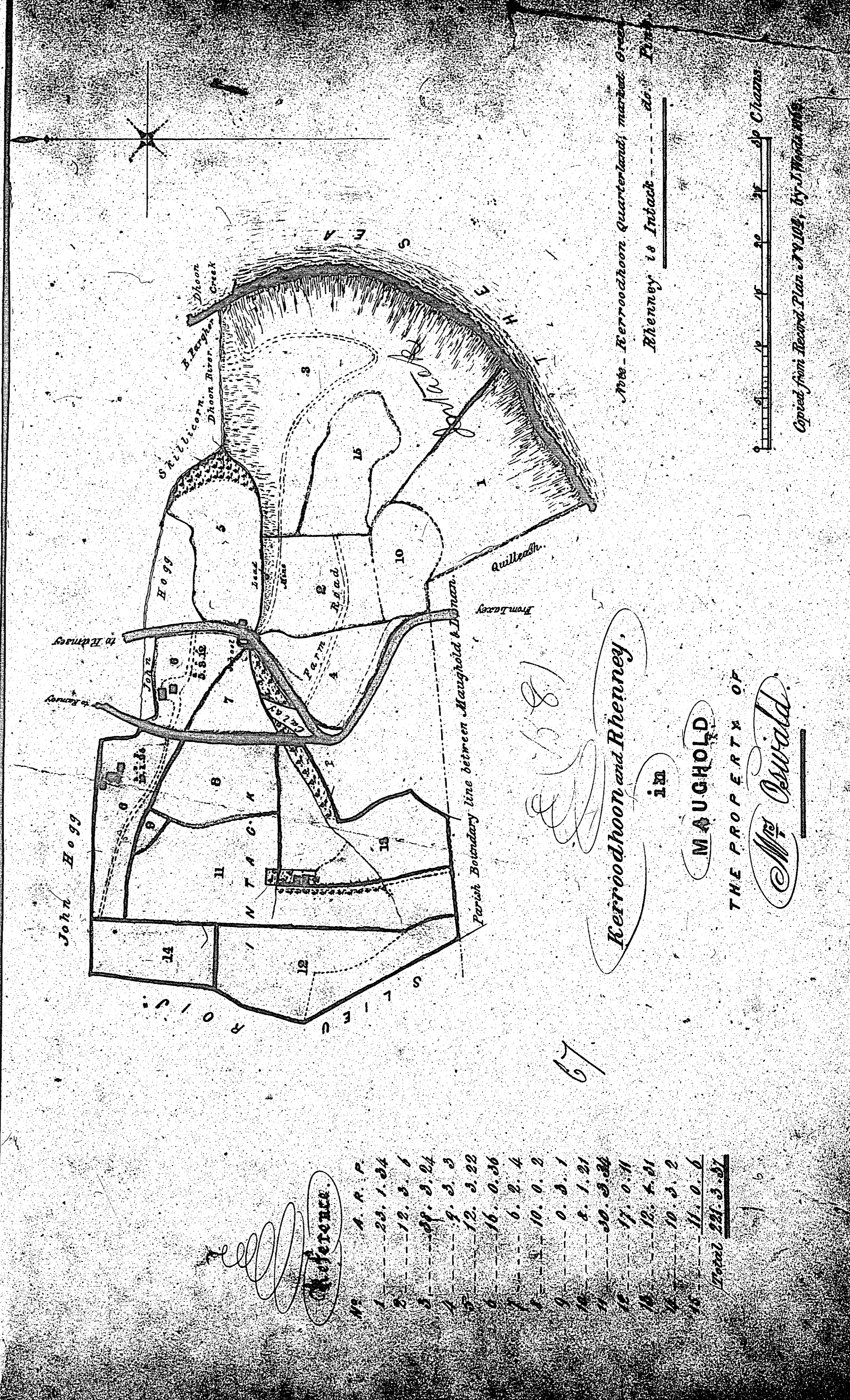

Reference

No.	A. R. P.
1	23. 1. 34
2	12. 3. 6
3	89. 3. 24
4	9. 3. 3
5	12. 3. 22
6	16. 0. 36
7	6. 2. 4
8	10. 0. 2
9	0. 3. 1
10	4. 1. 21
11	50. 3. 24
12	17. 0. 11
13	12. 4. 31
14	10. 3. 2
15	11. 0. 6
Total	221. 3. 37

Kerrwoodhoon and Rhenney.

MAUGHOLD
THE PROPERTY OF
M^{rs} Oswald.

*Miss Kerrwoodhoon Quarterlands, marked Green
Rhenney is Intact*



Copied from Record Plan N^o 102, by J. W. G. 1865

67

ISLE OF MAN GOVERNMENT: GENERAL REGISTRY

ASYLUM PLANS: PARISH OF MAUGHOLD

Original coloured

1:23

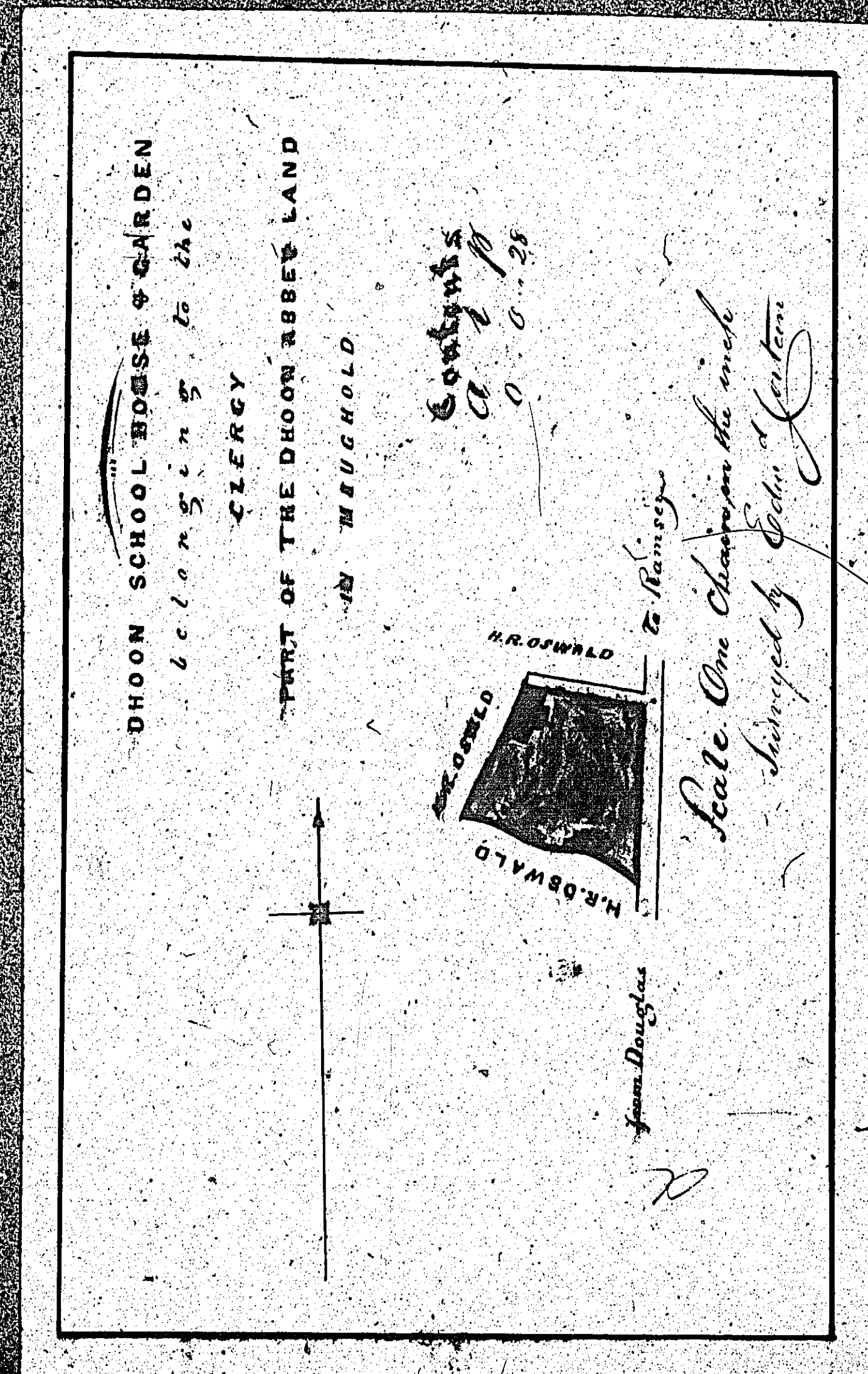

ISLE OF MAN GOVERNMENT: GENERAL REGISTRY

ASYLUM PLANS: PARISH OF MAUGHOLD

Original monotone

1:23

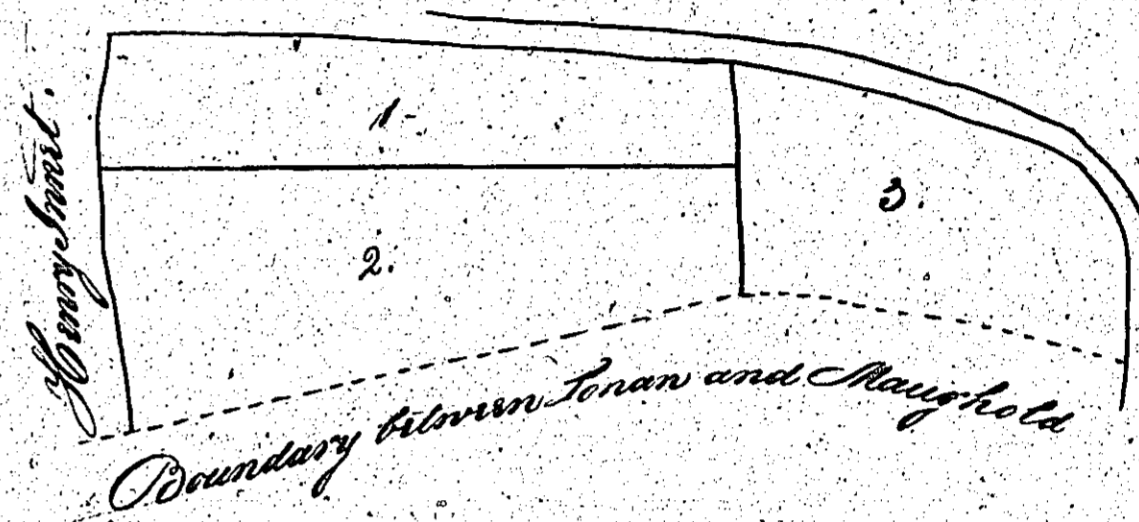

Intro to

in

Maughold

belonging

to
John Bowler

(160)

Contents

<i>No.</i>	<i>date</i>
<i>1</i>	<i>1.2.35</i>
<i>2</i>	<i>3.1.14</i>
<i>3</i>	<i>1.3.35</i>
<i>Total 7-0-4</i>	

Three plans to one sheet

Copied from title plan 103 by
Jas Woods 1872

ISLE OF MAN GOVERNMENT: GENERAL REGISTRY

ASYLUM PLANS: PARISH OF MAUGHOLD

1:23

- 161 Original monochrome
- 162 Original coloured

