

START

APP 4

1 : 2 3

Isle of Man Government: General Registry

**PLANS DEPOSITED IN THE
ROLLS OFFICE
UNDER THE
LUNATIC ASYLUM ACT
1860**

**Bell & Howell, Micromedia Division,
Telford Road, Bicester, Oxon, OX6 0UP**

March 1998

NOTES

The plans have been filmed in their bound state

This will have caused some image distortion particularly where large plans go into the binding gutter and/or have been folded

Many of the larger plans are damaged

Where plans are coloured this has been noted; 'monochrome' indicates a single ink colour which may be black, brown or blue

START OF VOLUME

ISLE OF MAN GOVERNMENT: GENERAL REGISTRY
 ASYLUM PLANS: PARISH OF MAUGHOLD

Original monotone

1:23

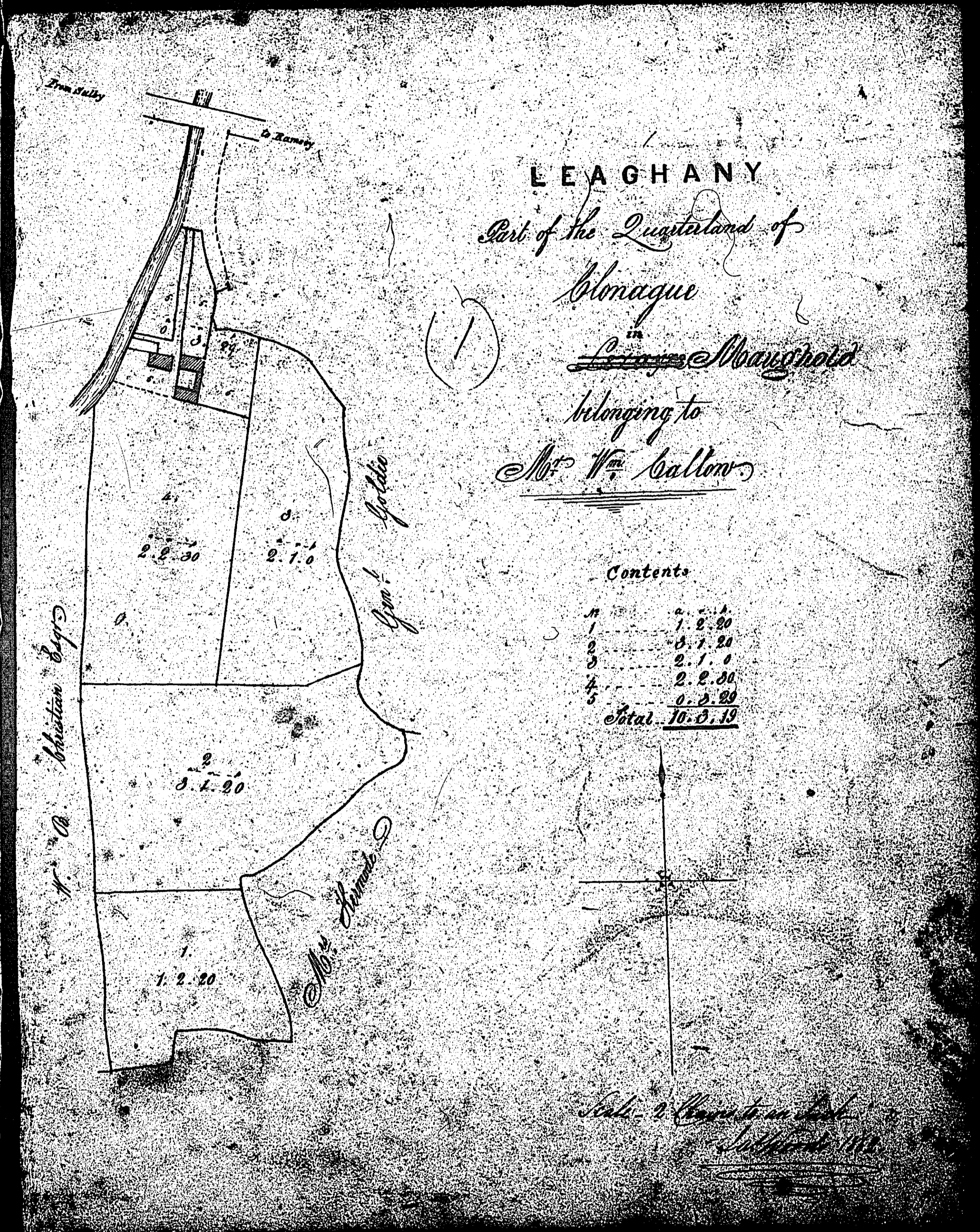

ISLE OF MAN GOVERNMENT: GENERAL REGISTRY

ASYLUM PLANS: PARISH OF MAUGHOLD

Original coloured (decorative)

1:23

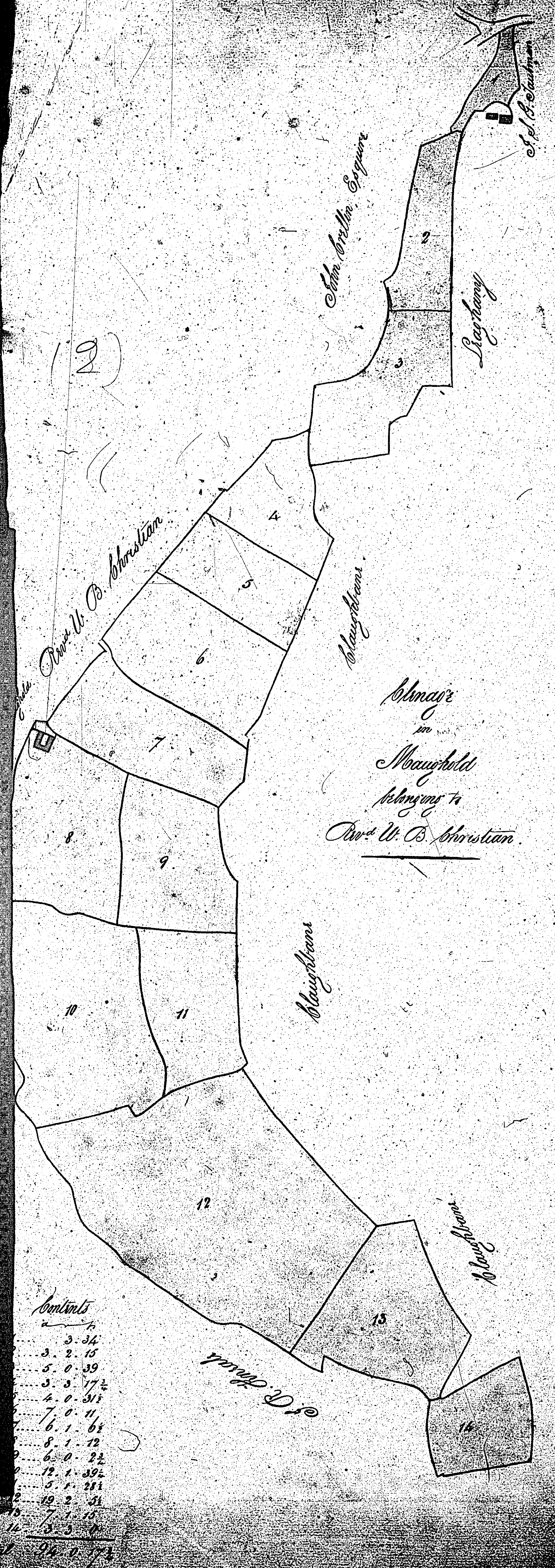

ISLE OF MAN GOVERNMENT: GENERAL REGISTRY

ASYLUM PLANS: PARISH OF MAUGHOLD

Original coloured, marked

1:23

O'LAUGHBANE,

(iii)

Maughold

The Property of

Mrs. Margaret Kennell

(3)

REFERENCE

1	1.0.0
2	1.0.0
3	1.0.0
4	1.0.0
5	1.0.0
6	1.0.0
7	1.0.0
8	1.0.0
9	1.0.0
10	1.0.0
11	1.0.0
12	1.0.0
13	1.0.0
14	1.0.0
15	1.0.0
16	1.0.0
17	1.0.0
18	1.0.0
19	1.0.0
20	1.0.0
21	1.0.0
22	1.0.0
23	1.0.0
24	1.0.0
25	1.0.0
26	1.0.0
27	1.0.0
28	1.0.0
29	1.0.0
30	1.0.0
31	1.0.0
32	1.0.0
33	1.0.0
34	1.0.0
35	1.0.0
36	1.0.0
37	1.0.0
38	1.0.0
39	1.0.0
40	1.0.0
41	1.0.0
42	1.0.0
43	1.0.0
44	1.0.0
45	1.0.0
46	1.0.0
47	1.0.0
48	1.0.0
49	1.0.0
50	1.0.0
51	1.0.0
52	1.0.0
53	1.0.0
54	1.0.0
55	1.0.0
56	1.0.0
57	1.0.0
58	1.0.0
59	1.0.0
60	1.0.0
61	1.0.0
62	1.0.0
63	1.0.0
64	1.0.0
65	1.0.0
66	1.0.0
67	1.0.0
68	1.0.0
69	1.0.0
70	1.0.0
71	1.0.0
72	1.0.0
73	1.0.0
74	1.0.0
75	1.0.0
76	1.0.0
77	1.0.0
78	1.0.0
79	1.0.0
80	1.0.0
81	1.0.0
82	1.0.0
83	1.0.0
84	1.0.0
85	1.0.0
86	1.0.0
87	1.0.0
88	1.0.0
89	1.0.0
90	1.0.0
91	1.0.0
92	1.0.0
93	1.0.0
94	1.0.0
95	1.0.0
96	1.0.0
97	1.0.0
98	1.0.0
99	1.0.0
100	1.0.0



ISLE OF MAN GOVERNMENT: GENERAL REGISTRY

ASYLUM PLANS: PARISH OF MAUGHOLD

Original monotone

1:23

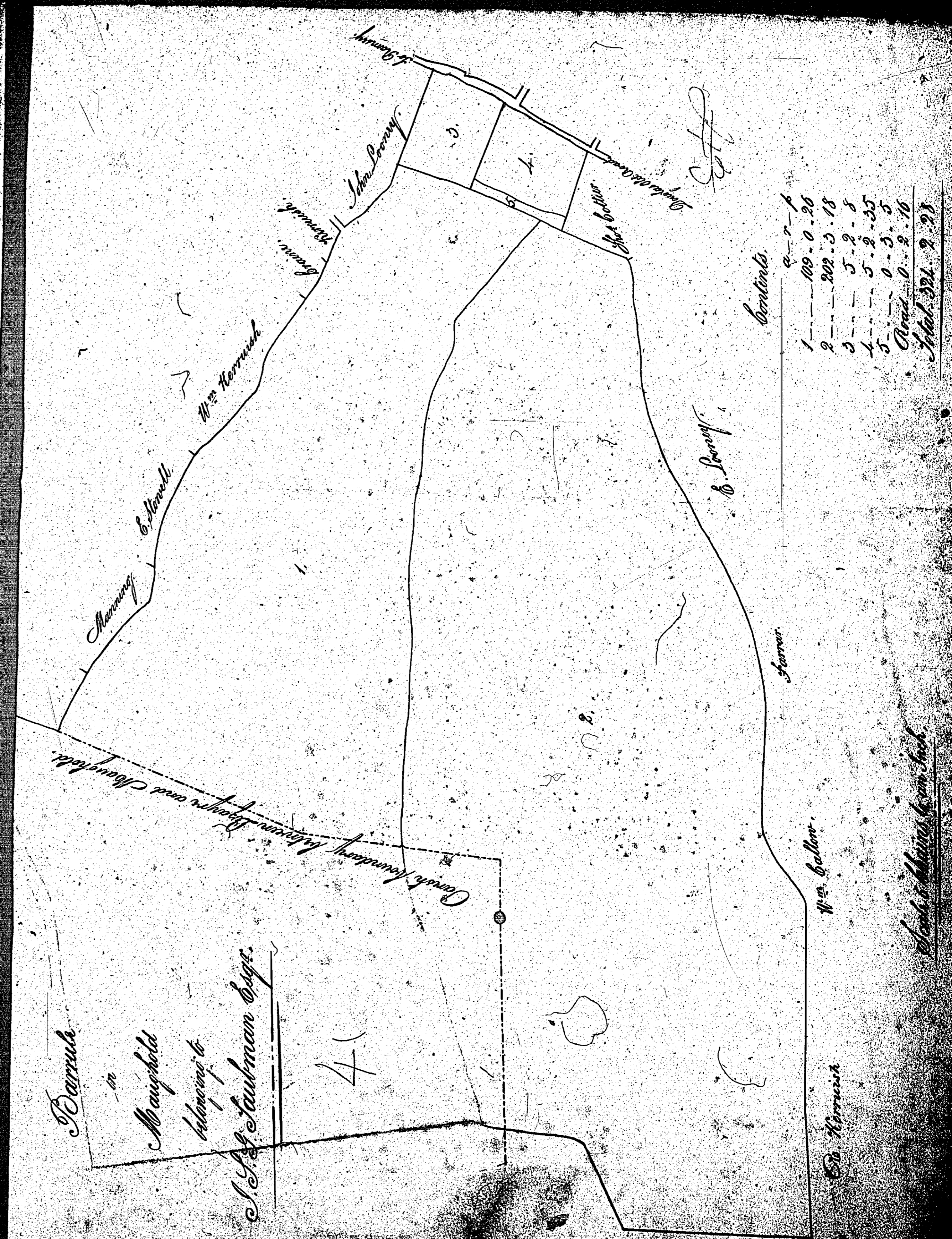

ISLE OF MAN GOVERNMENT: GENERAL REGISTRY
ASYLUM PLANS: PARISH OF MAUGHOLD

Original monotone

1:23

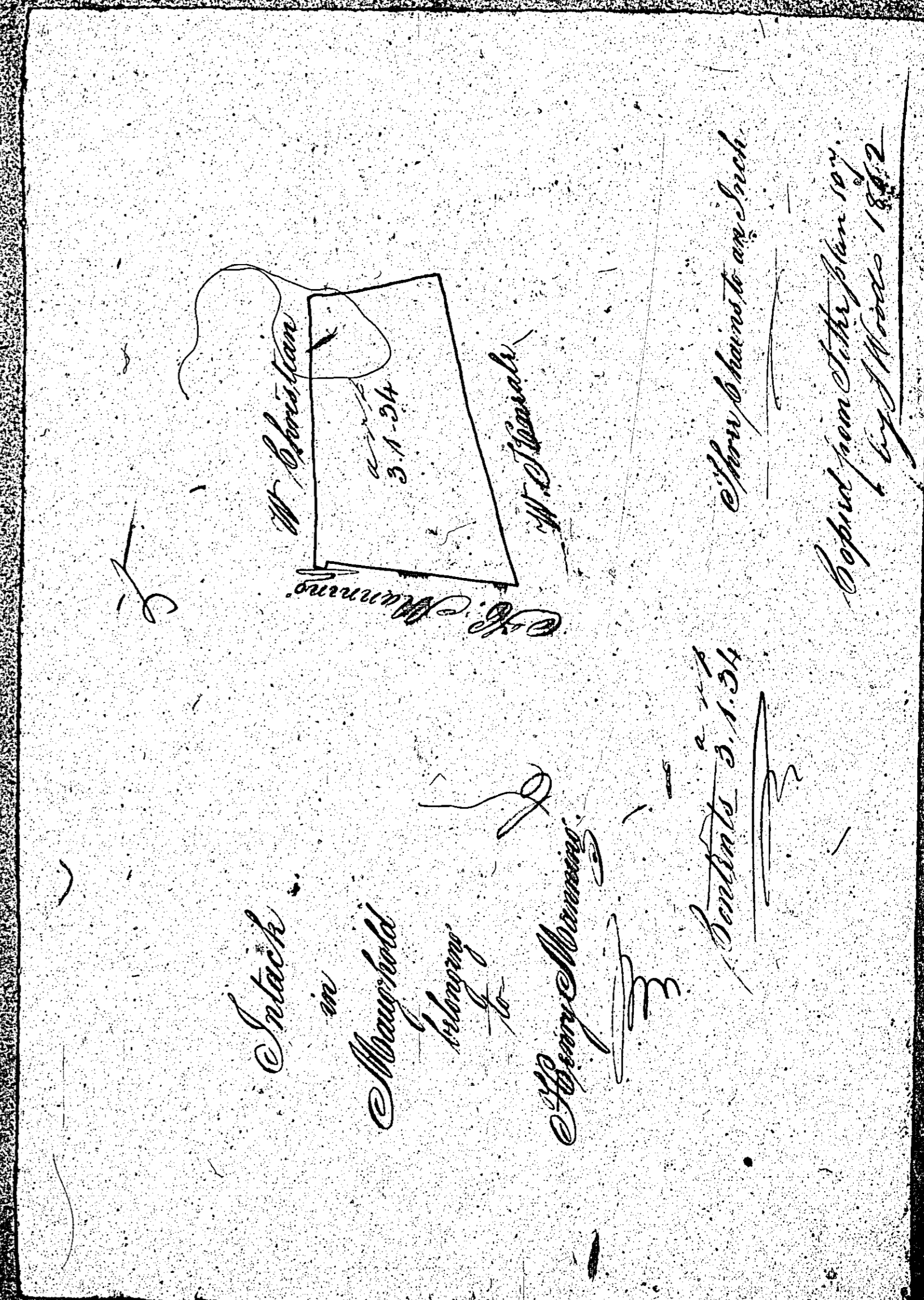

This following plan
is not numbered
but 6 is
pencilled on the back