

ISLE OF MAN GOVERNMENT: GENERAL REGISTRY

ASYLUM PLANS: PARISH OF MALEW

Original coloured

1:23

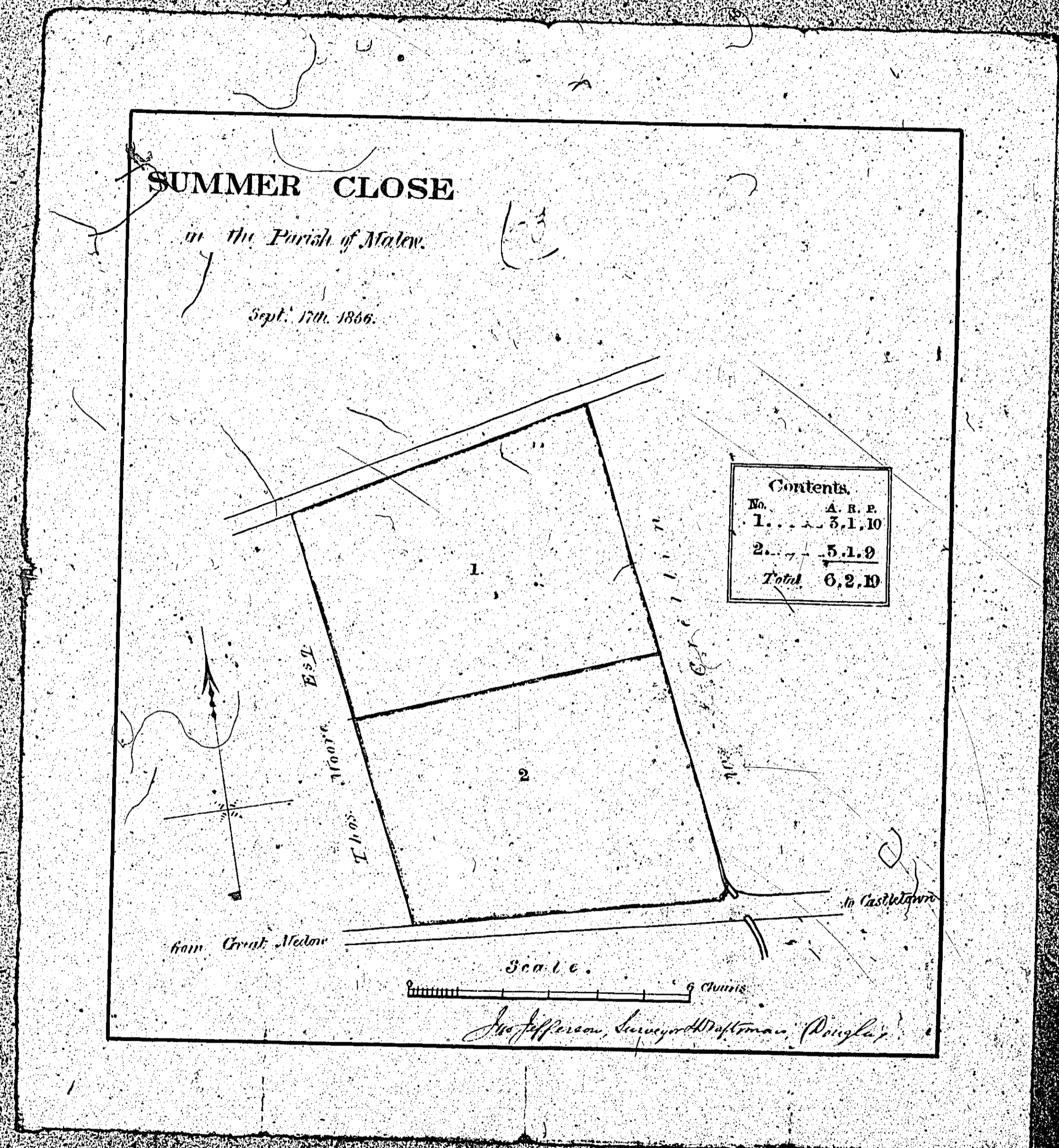

ISLE OF MAN GOVERNMENT: GENERAL REGISTRY

ASYLUM PLANS: PARISH OF MALEW

Originals coloured

1:23

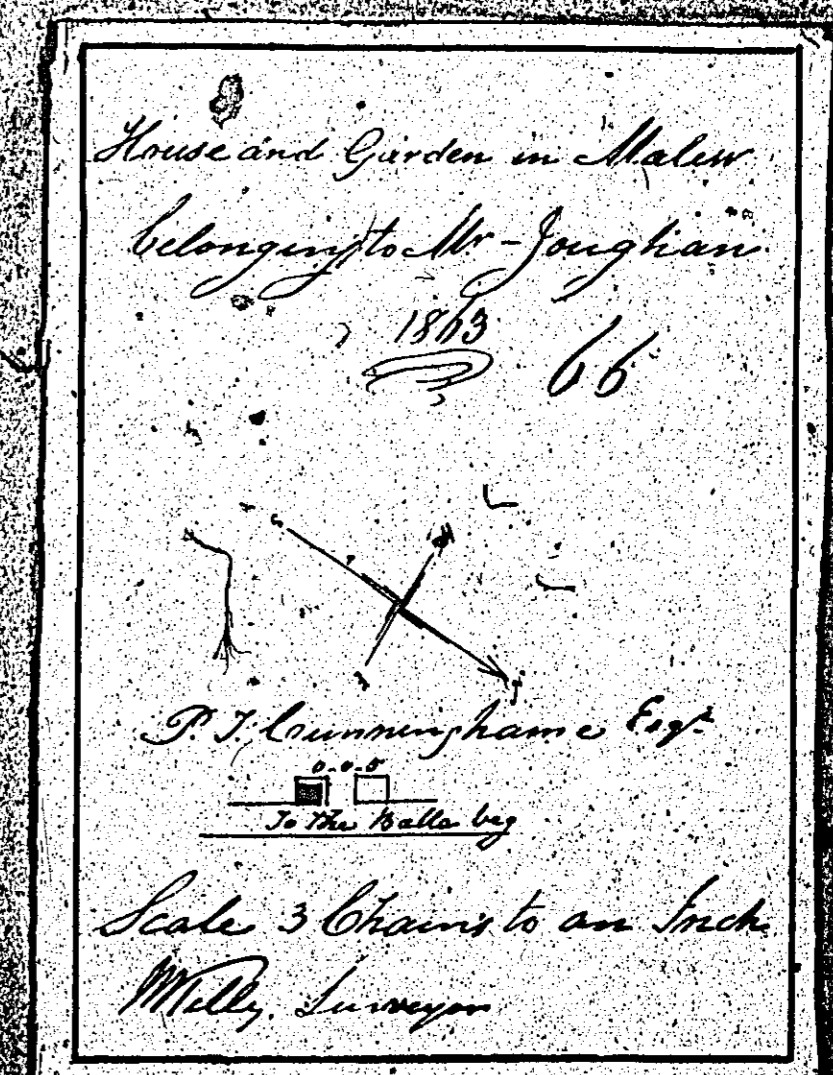
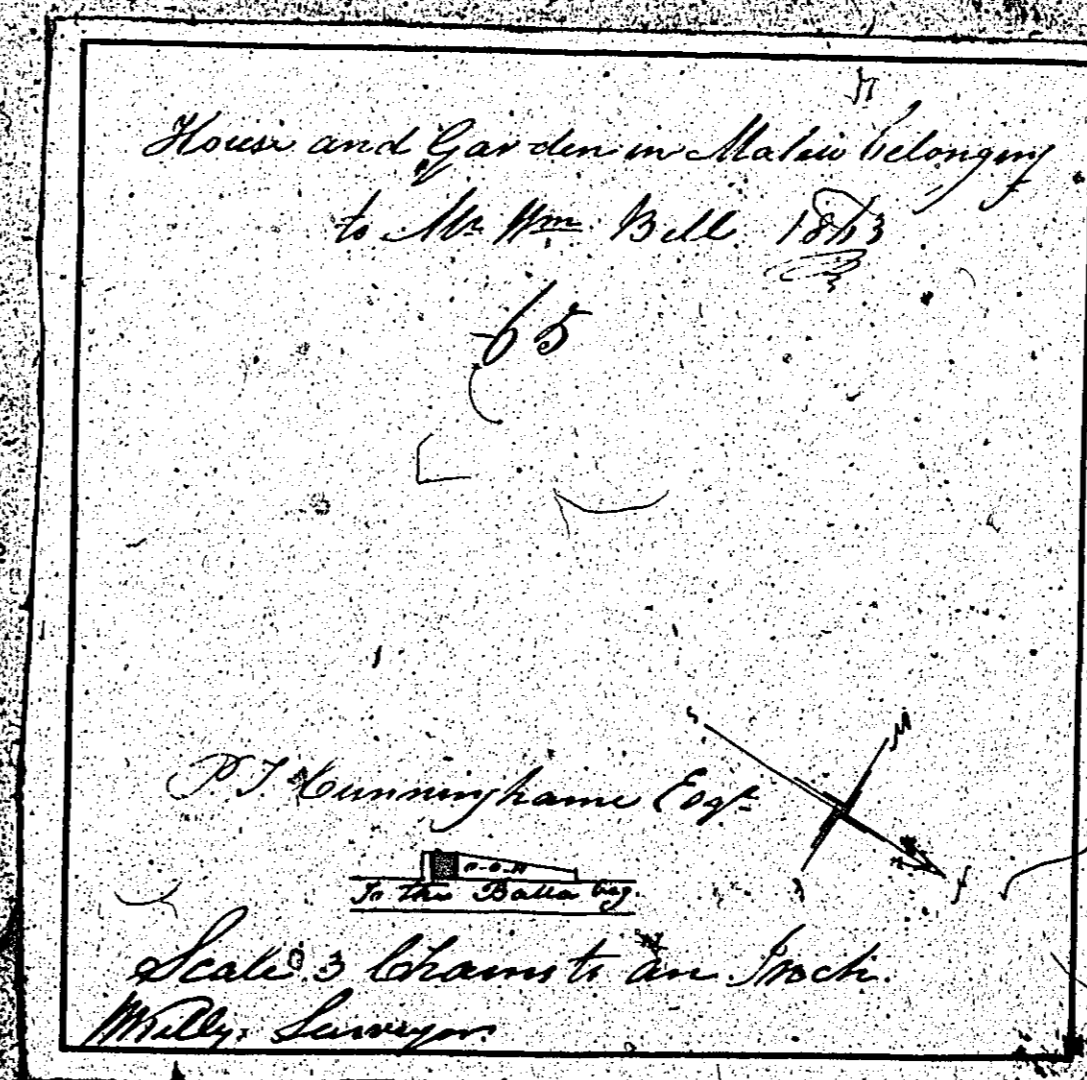
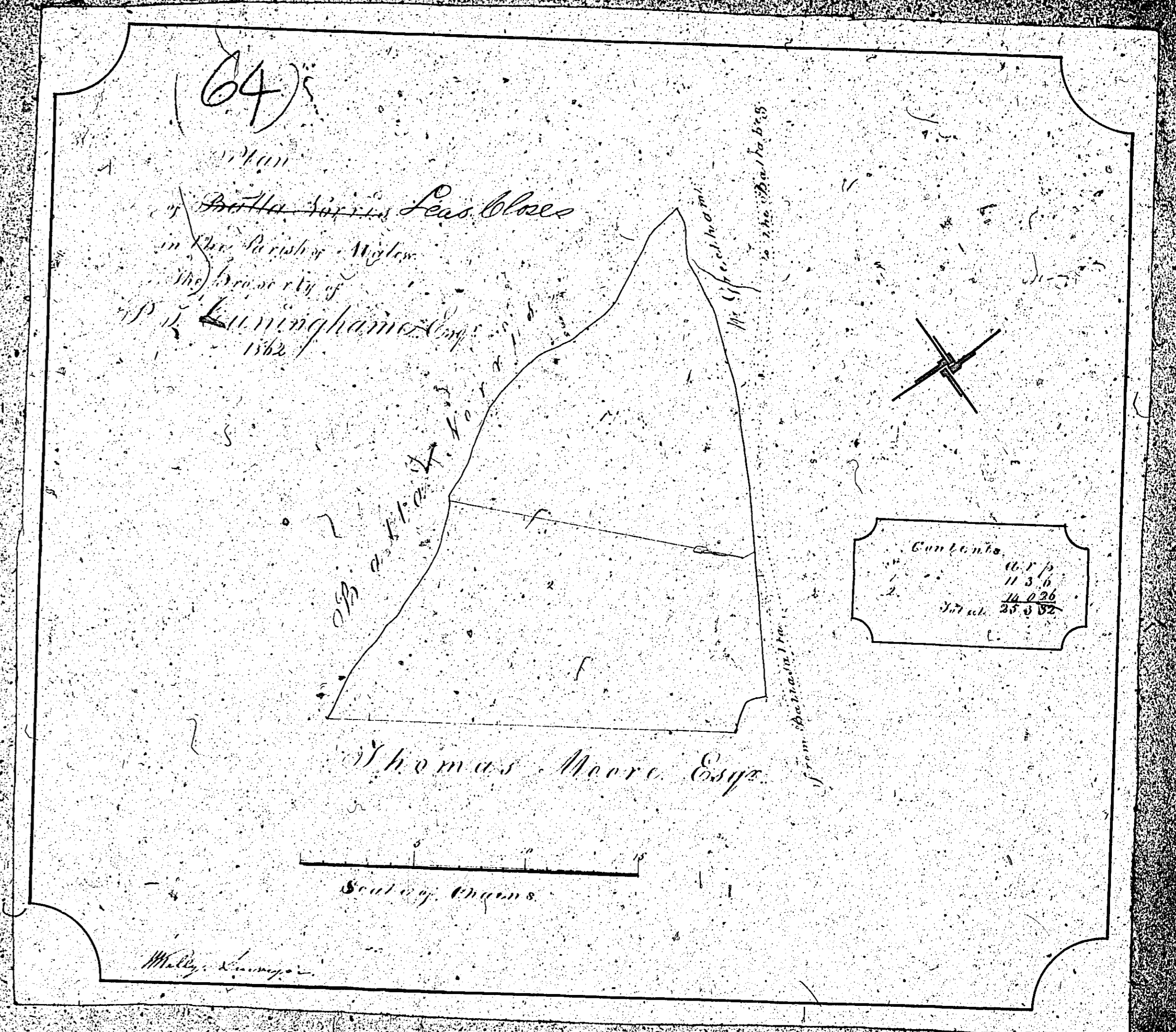

ISLE OF MAN GOVERNMENT: GENERAL REGISTRY

ASYLUM PLANS: PARISH OF MALEW

Original coloured

1:23

*House and Garden, in the
Parish of Malew the property
of Mrs Moore
67. 1863*

P. J. Cunningham

*From original plans in the possession of
Scale 3 Chains to an Inch
Wm. J. Cunningham*

(68)

Plan of the Estates of
Balowne near Skybright Slough field
and the Great Madon
in the Parish of Malew the Property of
Thomas Moore Esq.
1863.

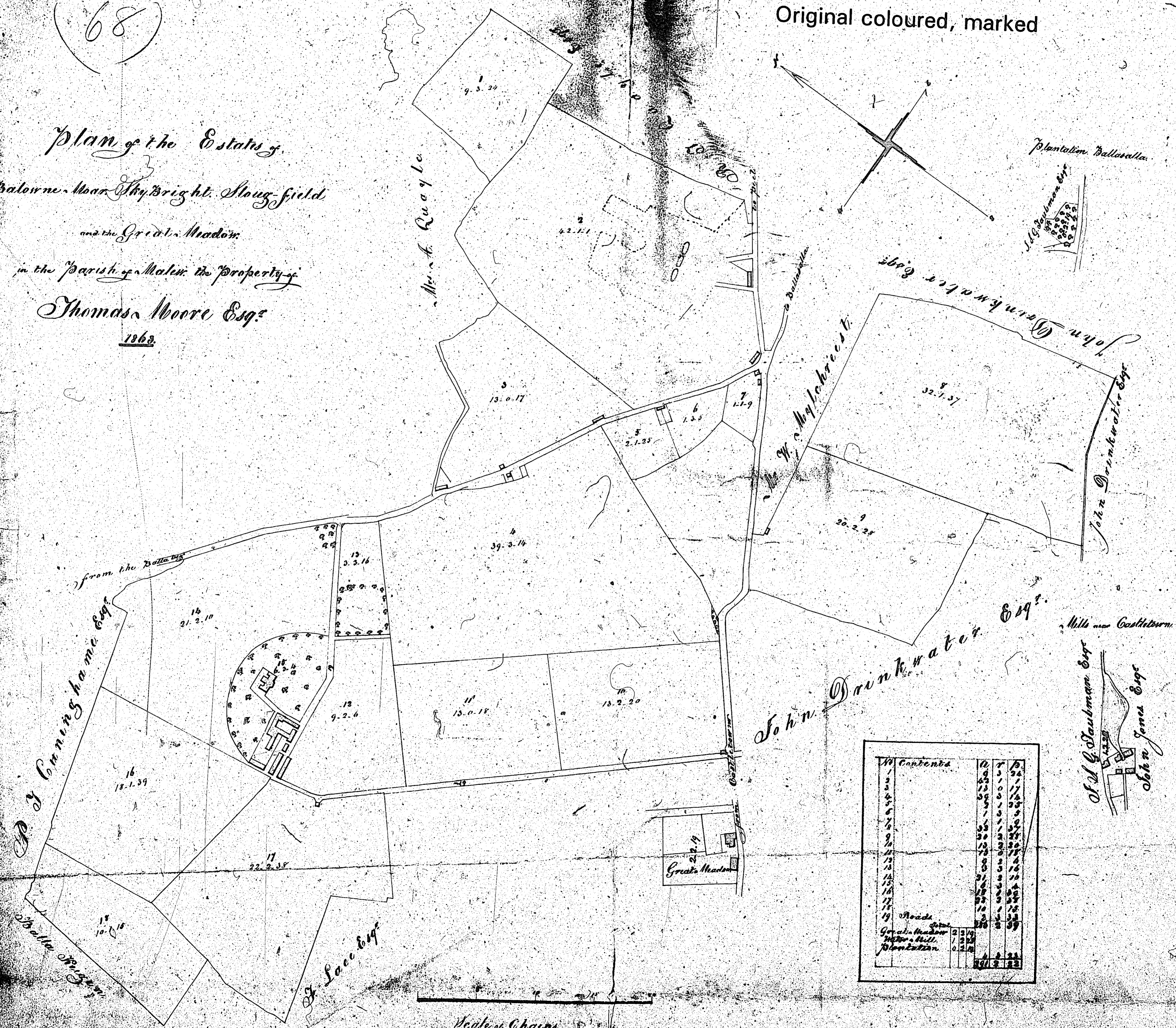

ISLE OF MAN GOVERNMENT: GENERAL REGISTRY
ASYLUM PLANS: PARISH OF MALEW
Original coloured, marked
1:23

No	Contents	Ac	R	P
1		0	3	0
2		0	3	1
3		0	3	1
4		0	3	1
5		0	3	1
6		0	3	1
7		0	3	1
8		0	3	1
9		0	3	1
10		0	3	1
11		0	3	1
12		0	3	1
13		0	3	1
14		0	3	1
15		0	3	1
16		0	3	1
17		0	3	1
18		0	3	1
19	Roads	0	3	1
Total		0	3	1
Great Madon		0	3	1
Mills & Mill		0	3	1
Plantation		0	3	1
Total		0	3	1

Scale of Chains
100

ISLE OF MAN GOVERNMENT: GENERAL REGISTRY

ASYLUM PLANS: PARISH OF MALEW

- 69 Original coloured
- 70 Original coloured
- 71 Original monotone

1:23

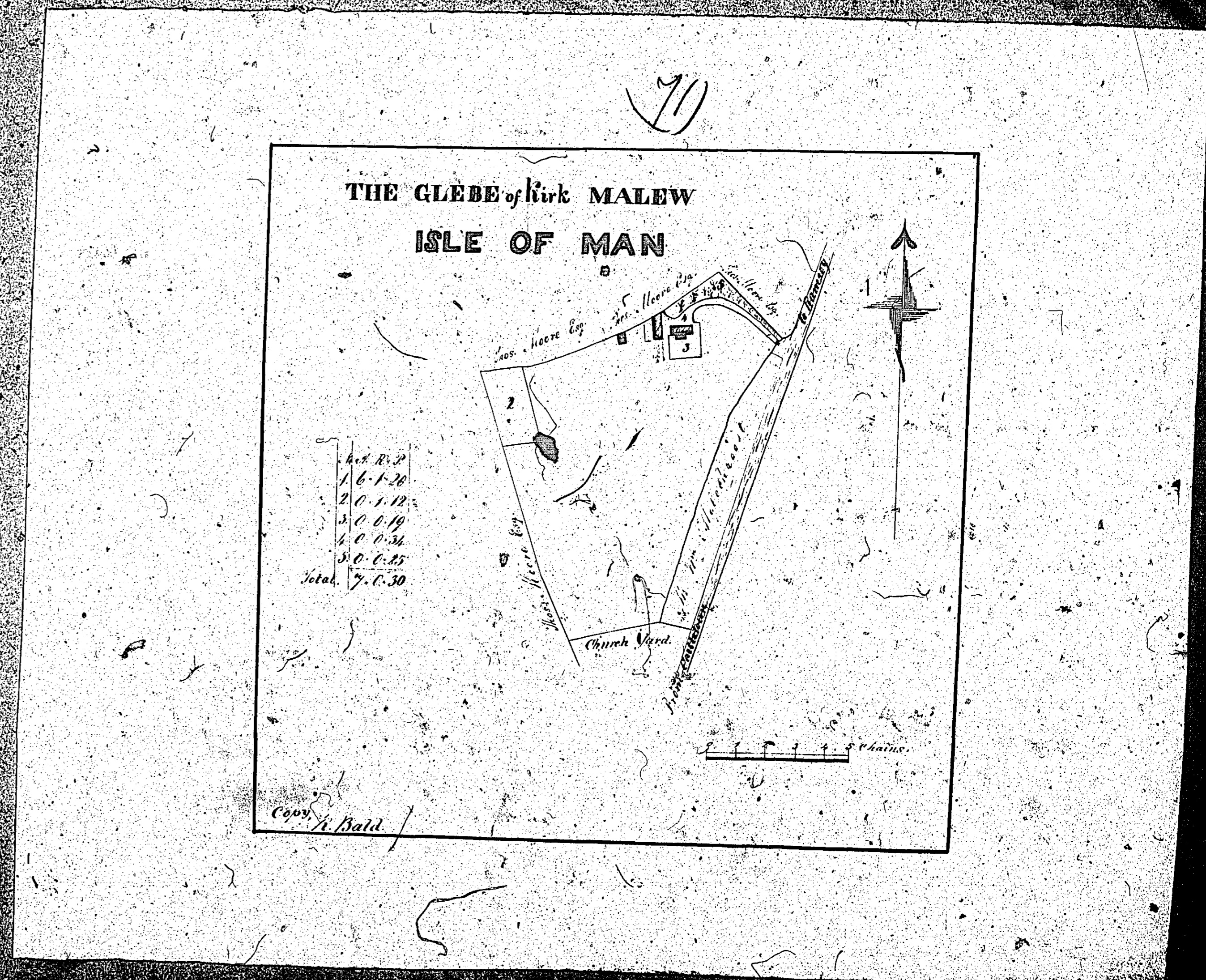
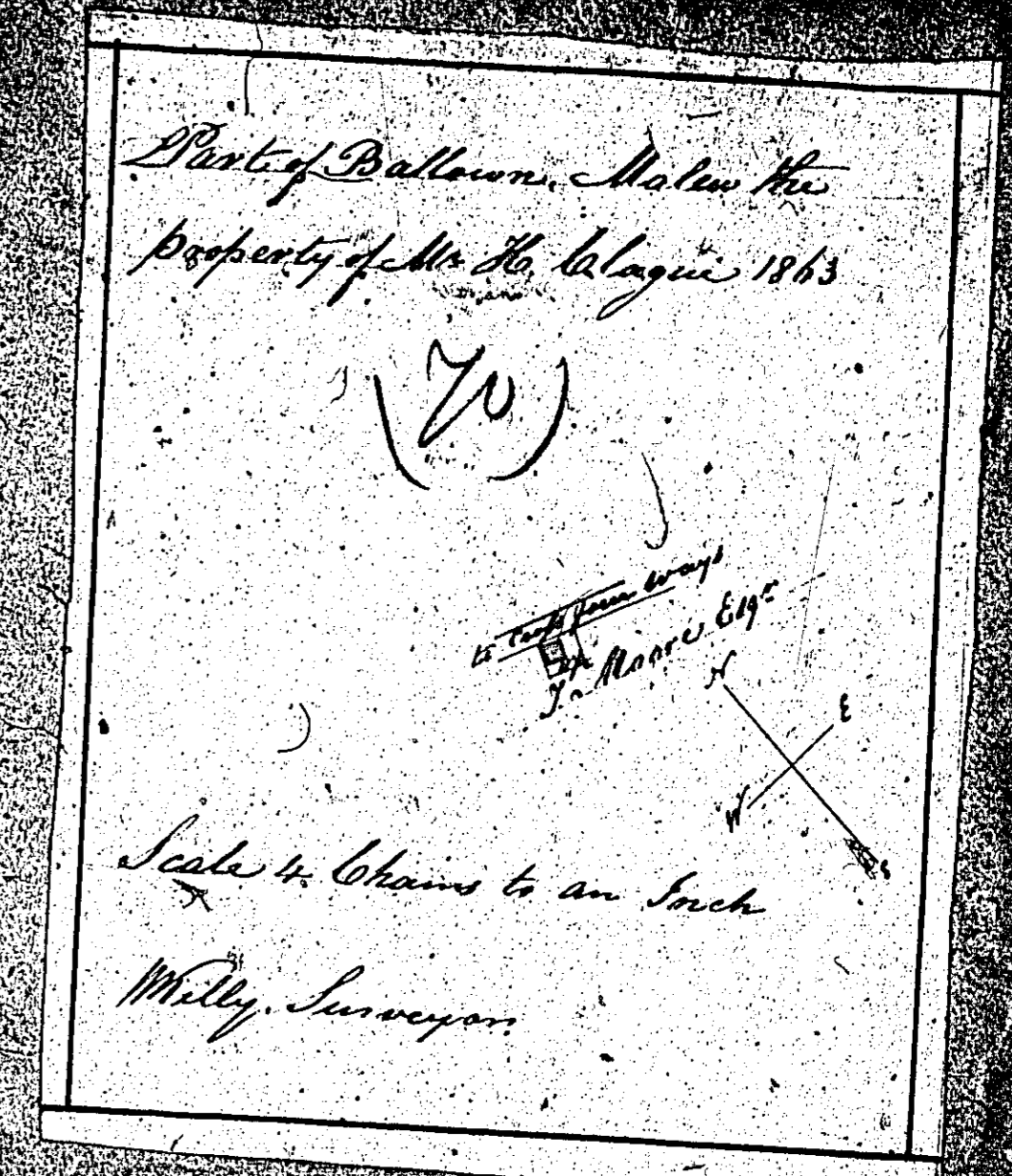
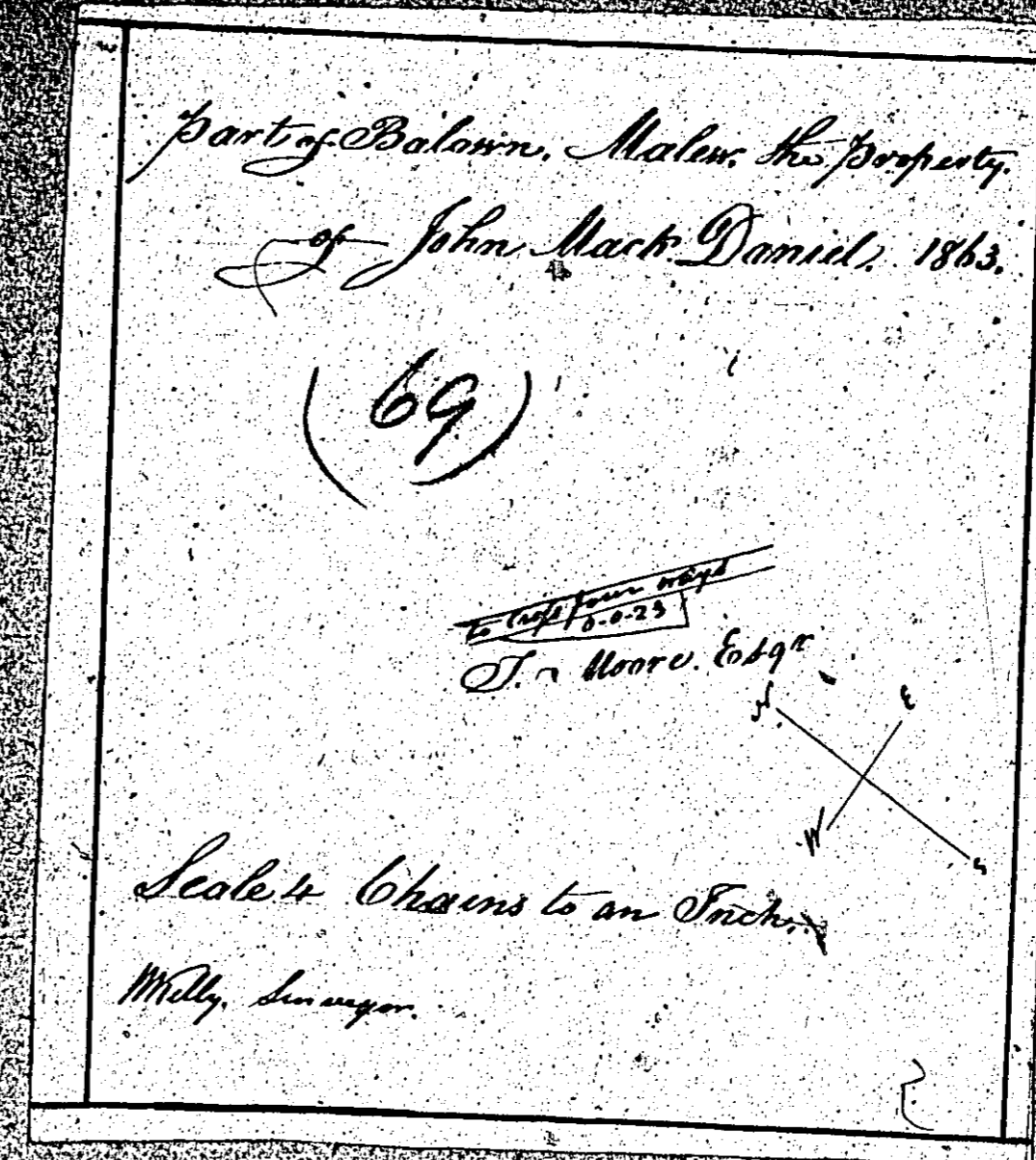

Acres	Rods	Faths
1	6	1
2	0	1
3	0	6
4	0	0
5	0	6
6	0	6
7	0	6
Total	7	7

ISLE OF MAN GOVERNMENT: GENERAL REGISTRY

ASYLUM PLANS: PARISH OF MALEW

Original coloured, marked

1:23

Plan
of Crossfourways
and Balaire,
in the
Parish of Malew
the property of
Mr. William S. Lynch
1862

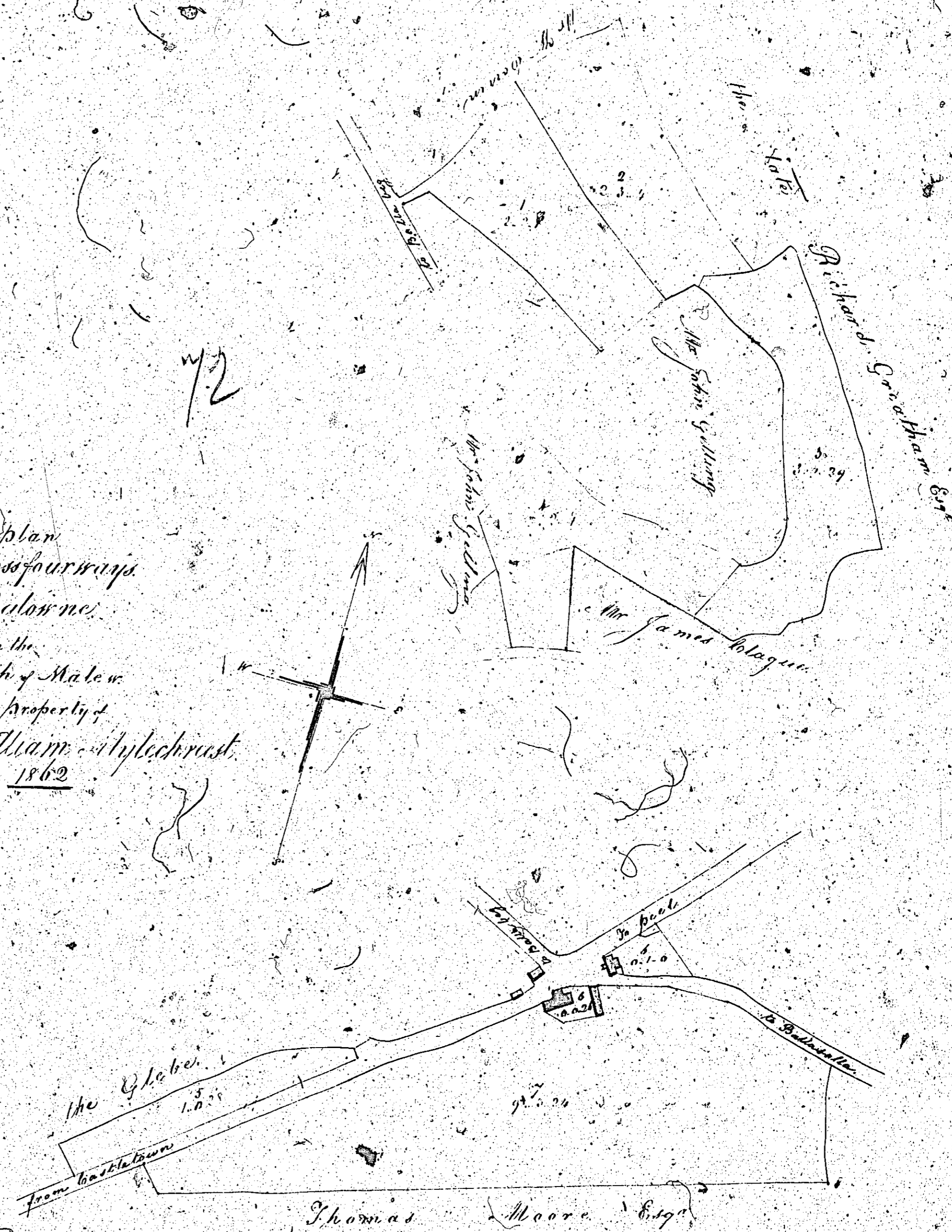

Scale of Chains
1/2 1 1 1/2 2 2 1/2 3 3 1/2 4 4 1/2 5 5 1/2 6 6 1/2 7 7 1/2 8 8 1/2 9 9 1/2 10

Plot 1	2 1/2
Plot 2	2 1/2
Plot 3	2 1/2
Plot 4	2 1/2
Plot 5	2 1/2
Plot 6	2 1/2
Plot 7	2 1/2
Plot 8	2 1/2
Plot 9	2 1/2
Plot 10	2 1/2
Total	25 1/2