

ISLE OF MAN GOVERNMENT: GENERAL REGISTRY

ASYLUM PLANS: PARISH OF MALEW

Originals coloured

1:23

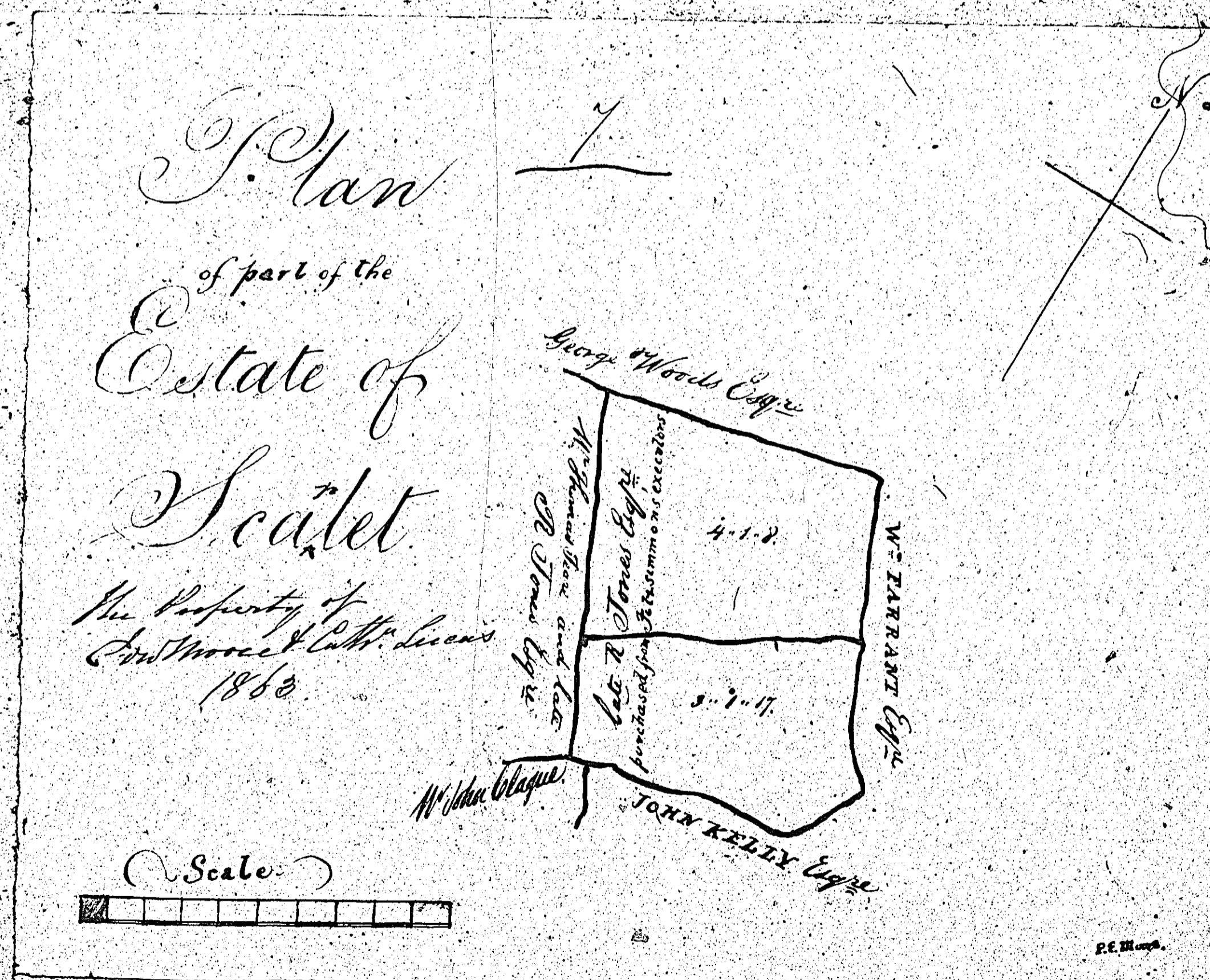
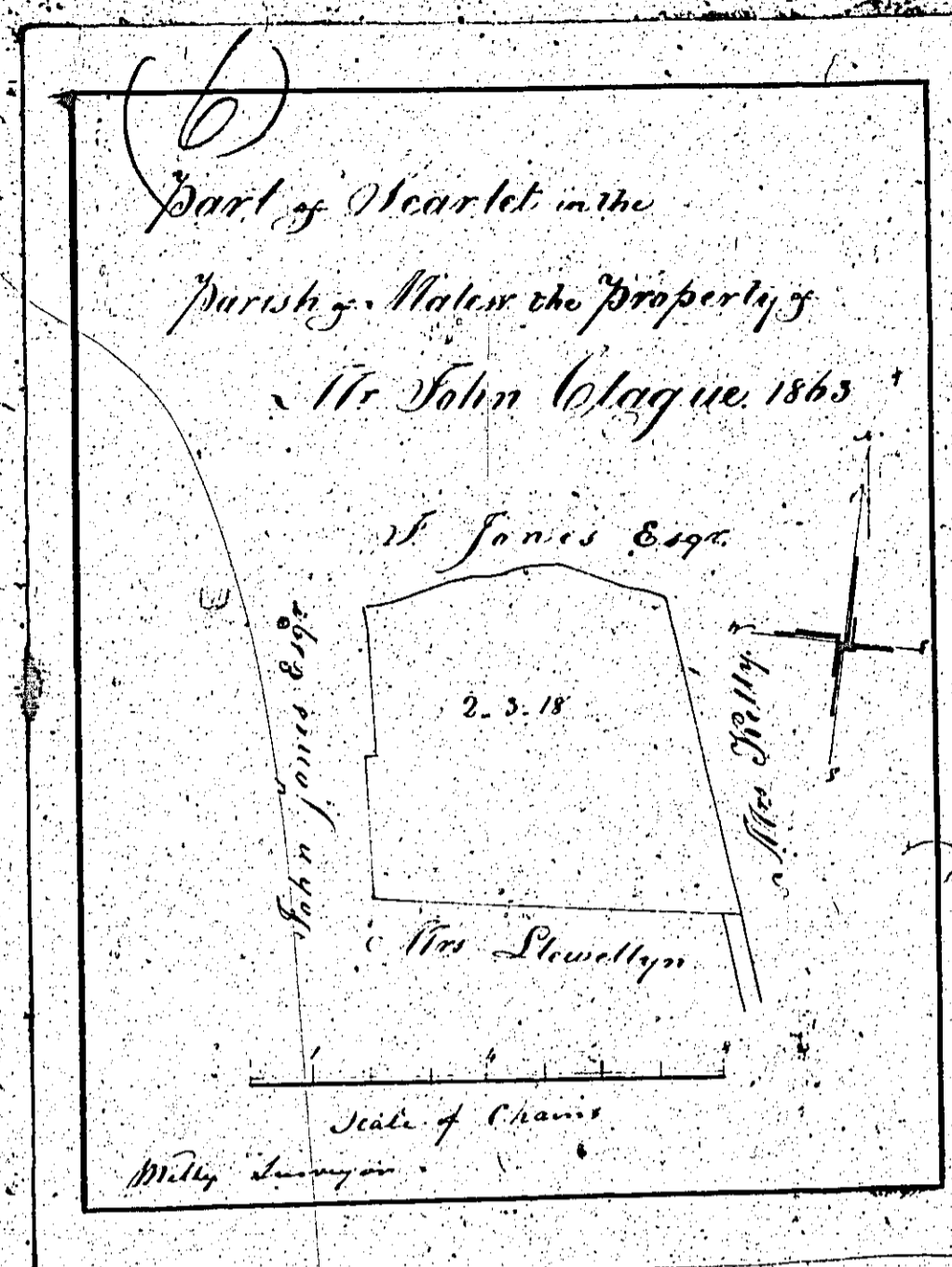



ISLE OF MAN GOVERNMENT: GENERAL REGISTRY

ASYLUM PLANS: PARISH OF MALEW

Original coloured

1:23

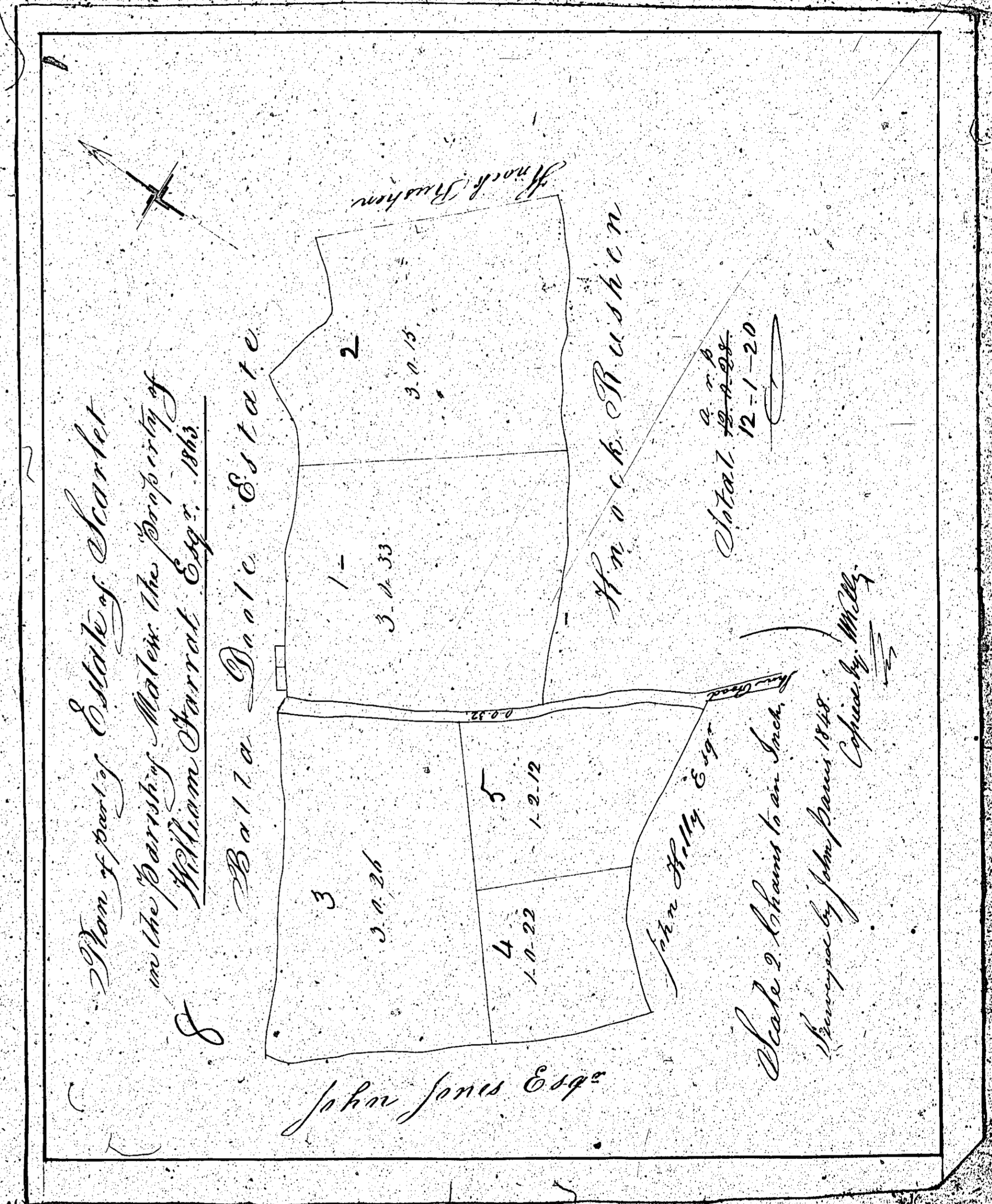



ISLE OF MAN GOVERNMENT: GENERAL REGISTRY

ASYLUM PLANS: PARISH OF MALEW

Original coloured

1:23

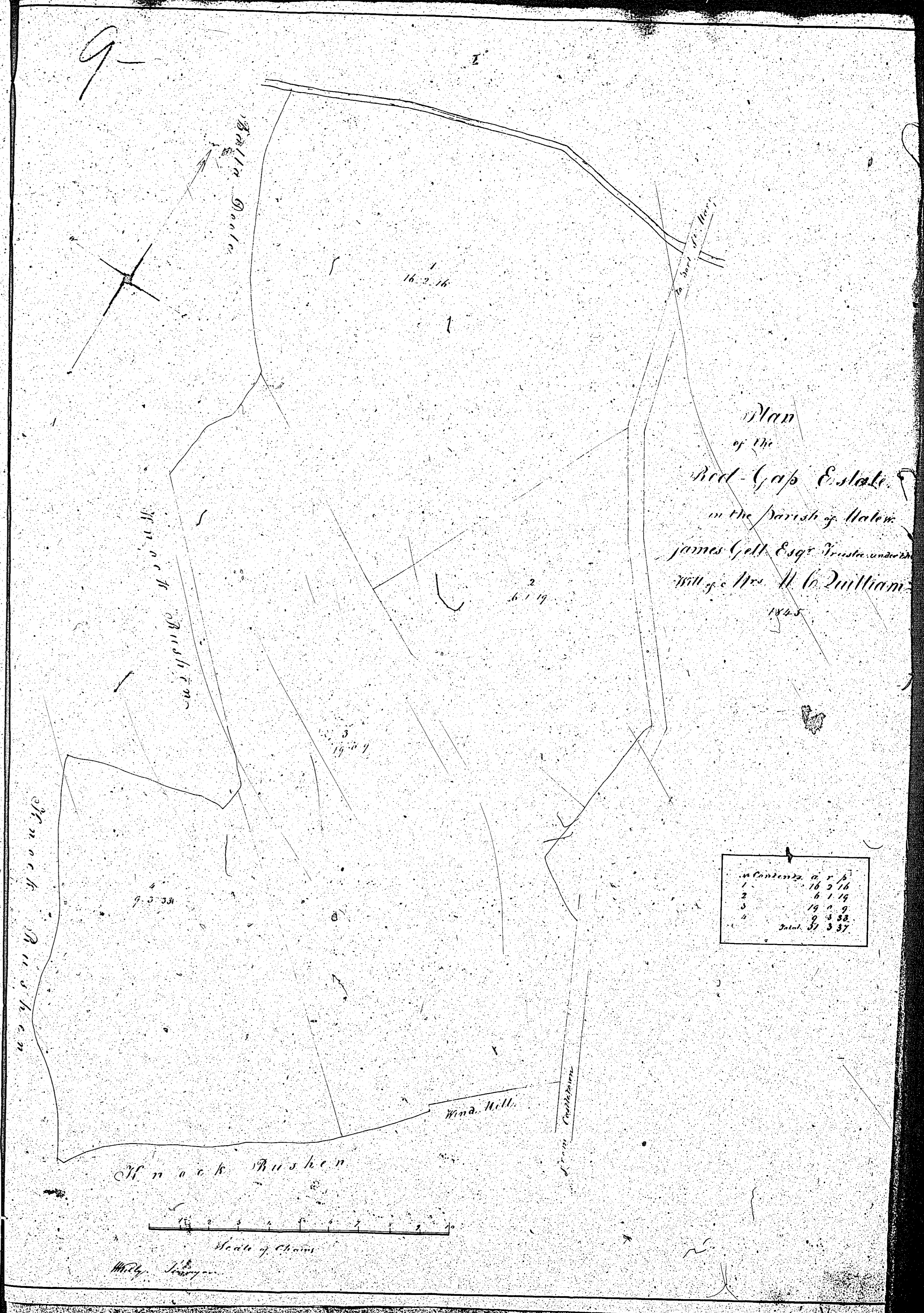



ISLE OF MAN GOVERNMENT: GENERAL REGISTRY  
ASYLUM PLANS: PARISH OF MALEW

Originals coloured

1:23

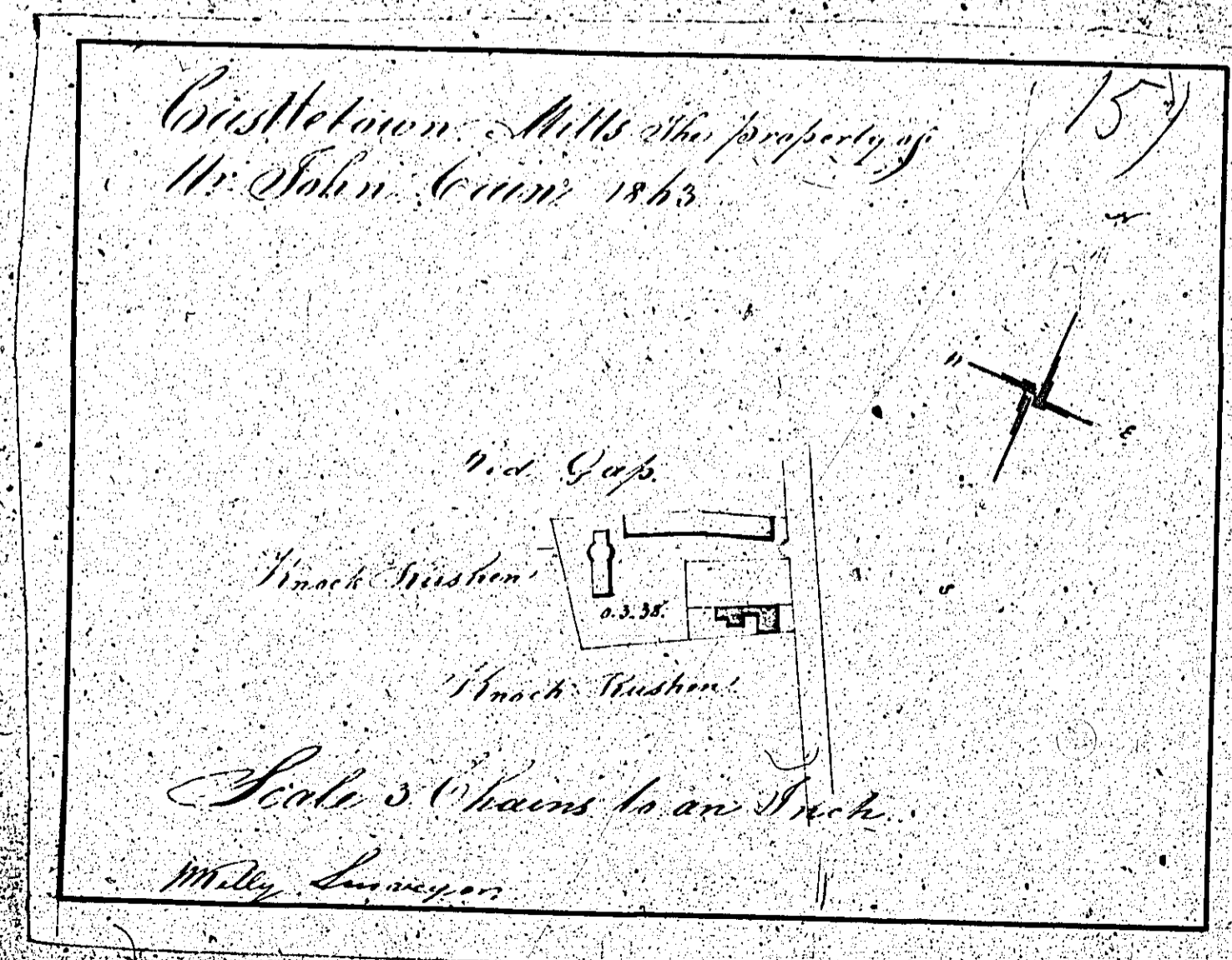
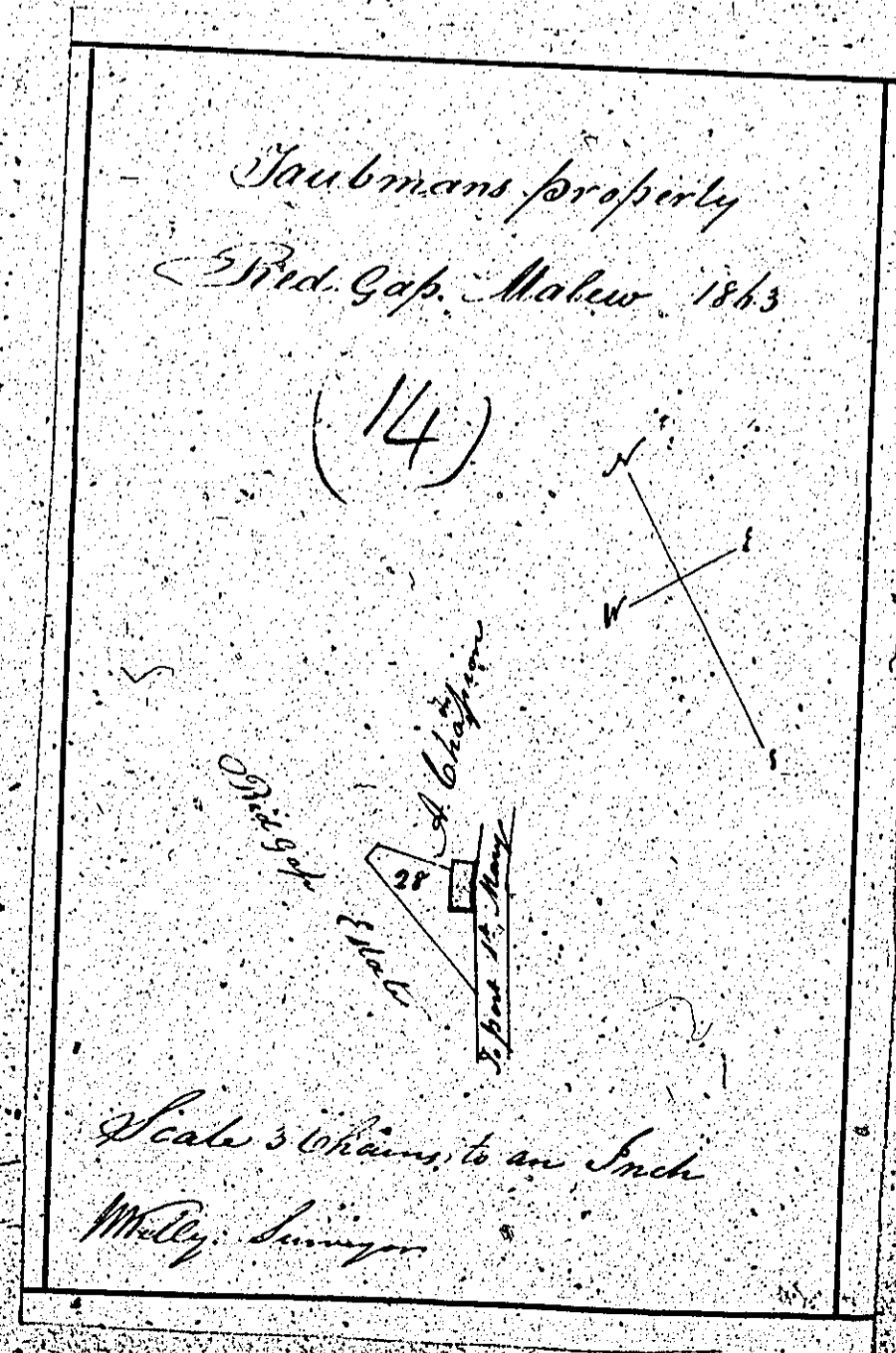
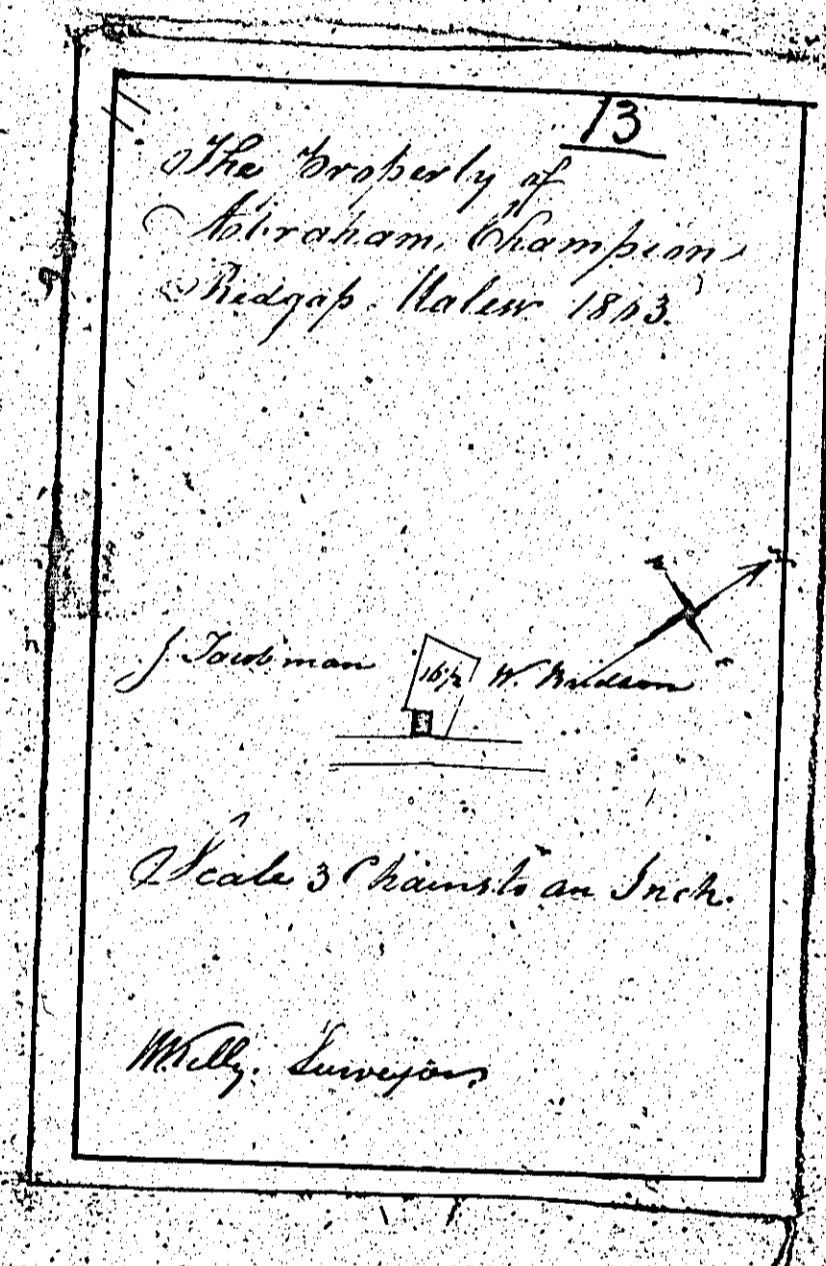
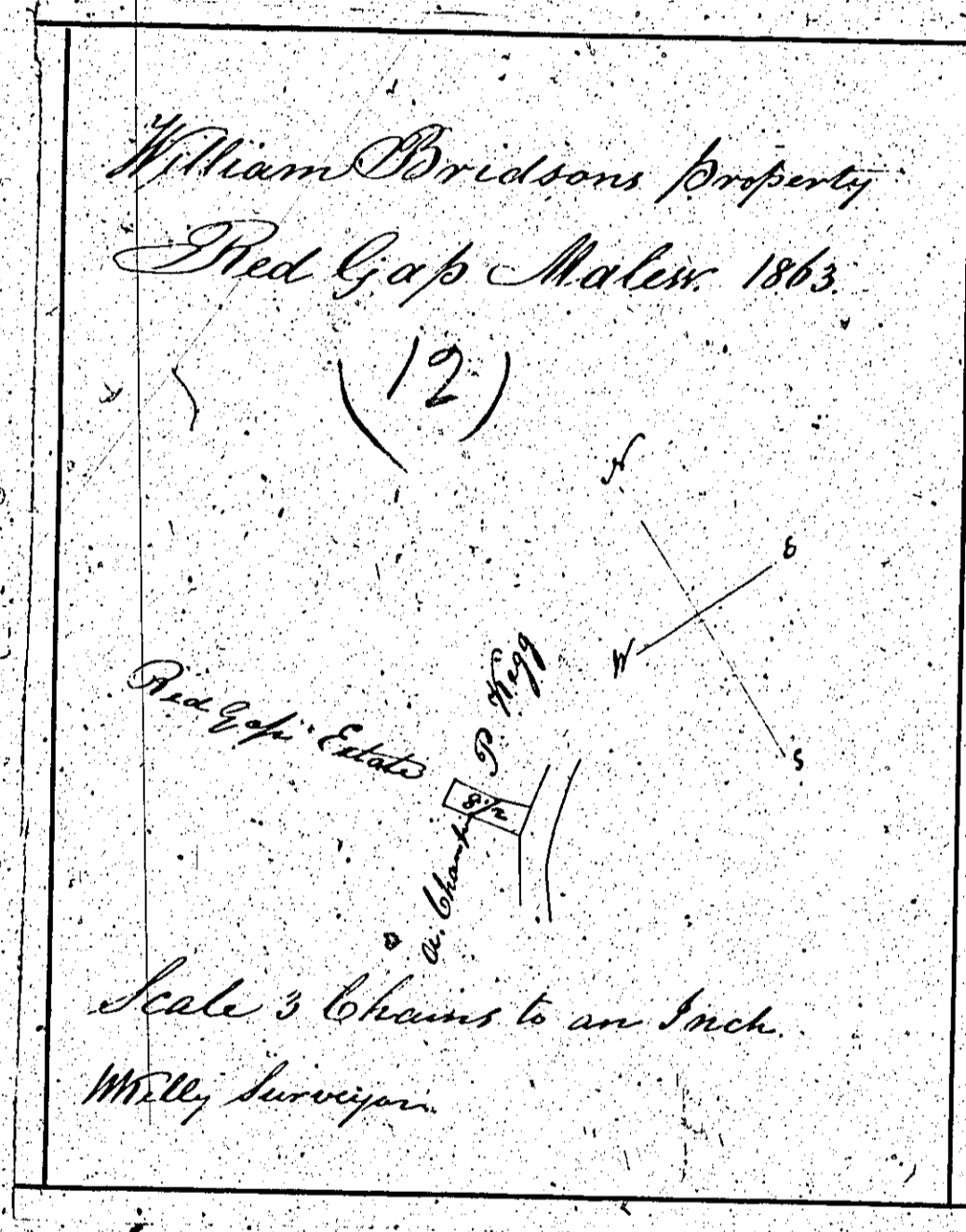
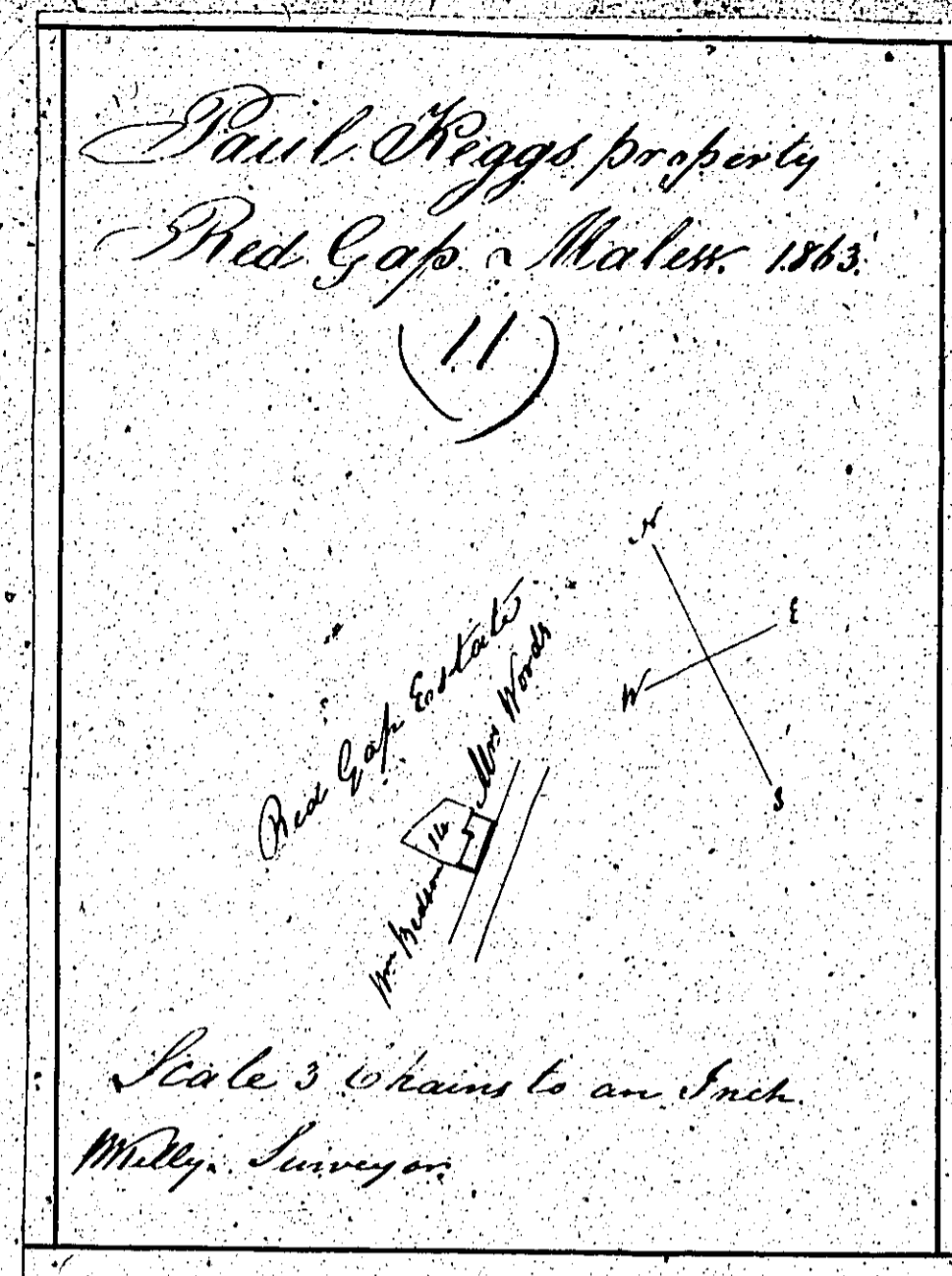
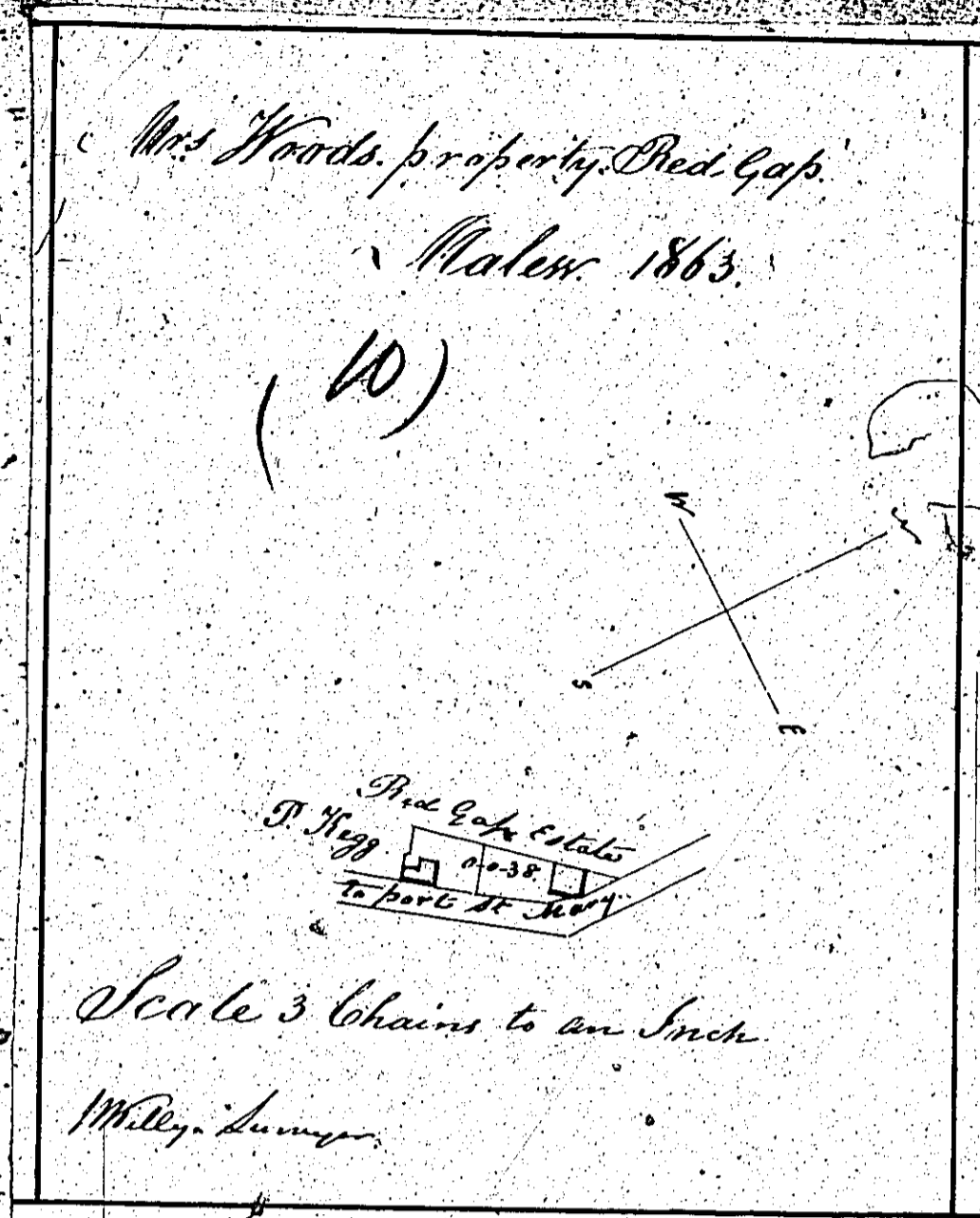



ISLE OF MAN GOVERNMENT: GENERAL REGISTRY

ASYLUM PLANS: PARISH OF MALEW

Original coloured, marked

1:23

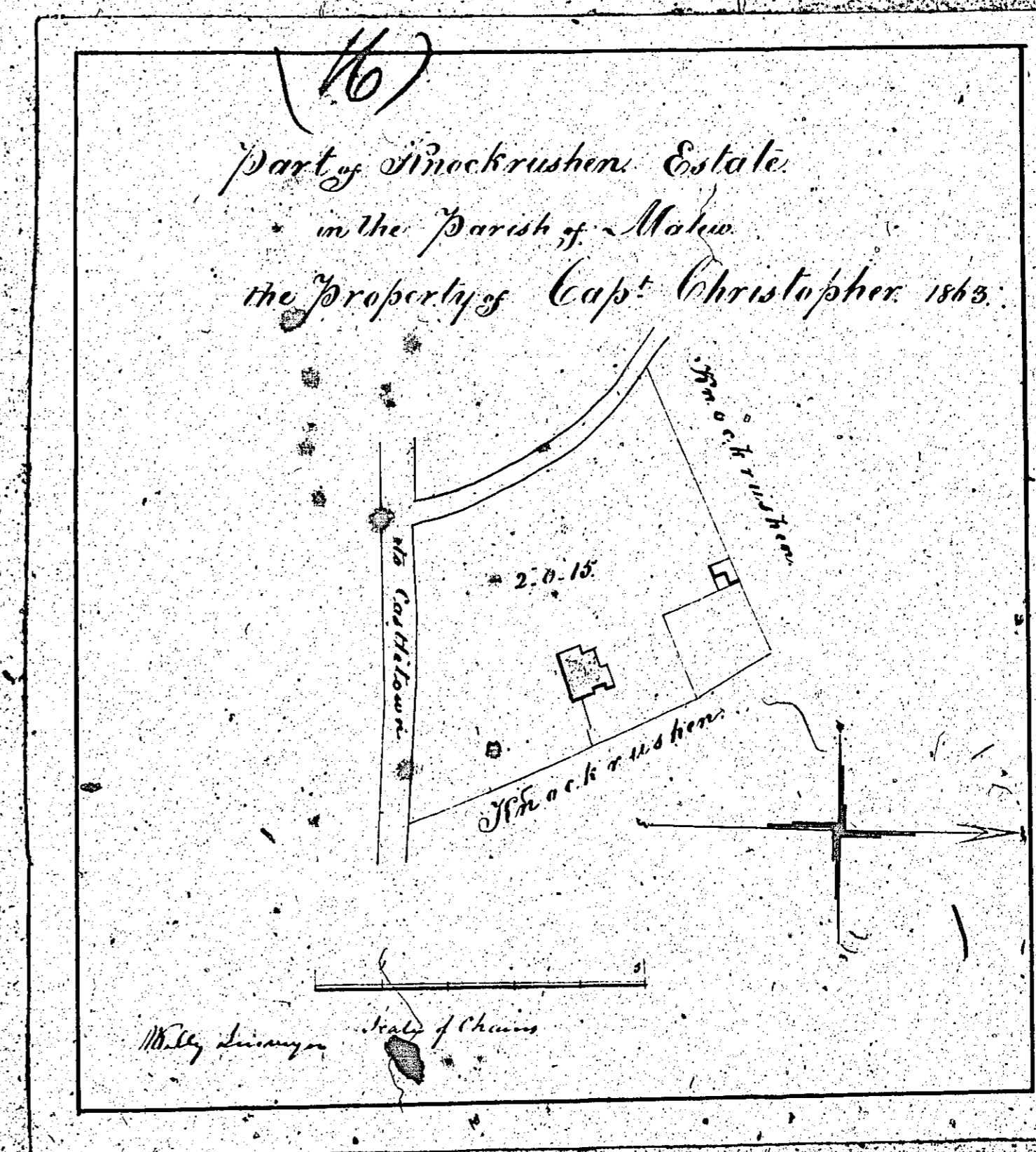



17

PLAN  
of  
KNOCK RUSHEN

in the  
Parish of Malin

the property of

R. LUCAS Esq.  
1852

Contals	Ac. R. p.
1	4.0.20
2	5.1.12
3	3.3.1
4	7.1.16
5	6.0.17 1/2
6	4.3.4
7	4.0.29
8	4.0.35
9	4.0.36
10	7.2.0
11	2.2.24
12	10.3.27
13	8.3.5
14	2.1.10 1/2
15	3.1.17 1/2
16	12.0.31
17	4.2.22
18	10.1.15
19, 19	10.0.0
20	1.0.3
21	1.0.0
22, 22	12.2.11
23	8.3.11
24	4.0.38
25, 25	1.0.0
Total	156.7.13
Product for Taxes	4.1.11
Total for Contals	152.6.3

1:23

ISLE OF MAN GOVERNMENT: GENERAL REGISTRY

ASYLUM PLANS: PARISH OF MALEW

Original coloured

