

ISLE OF MAN GOVERNMENT: GENERAL REGISTRY

ASYLUM PLANS: PARISH OF LONAN

- 64 Original monotone
- 65 Original coloured

1:23

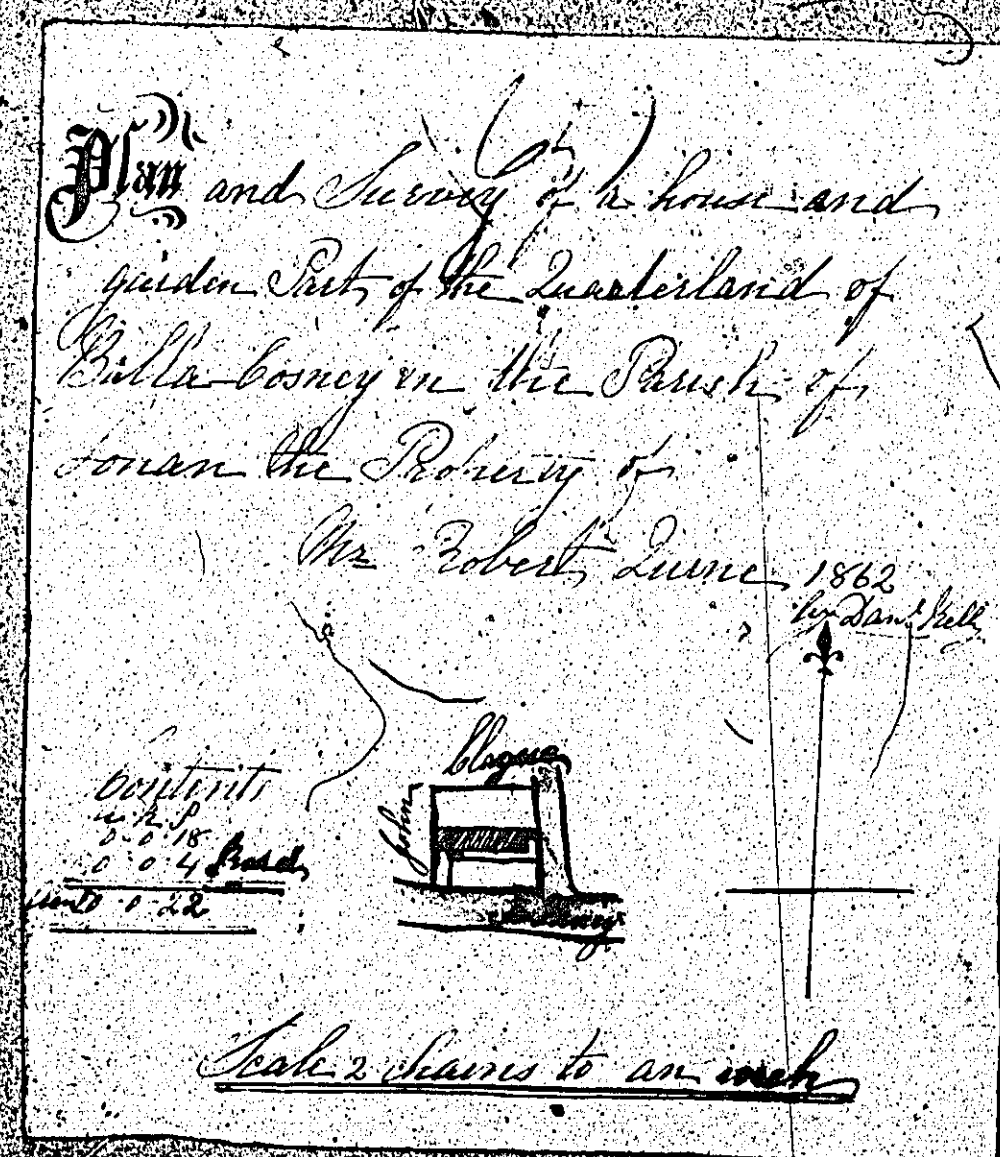
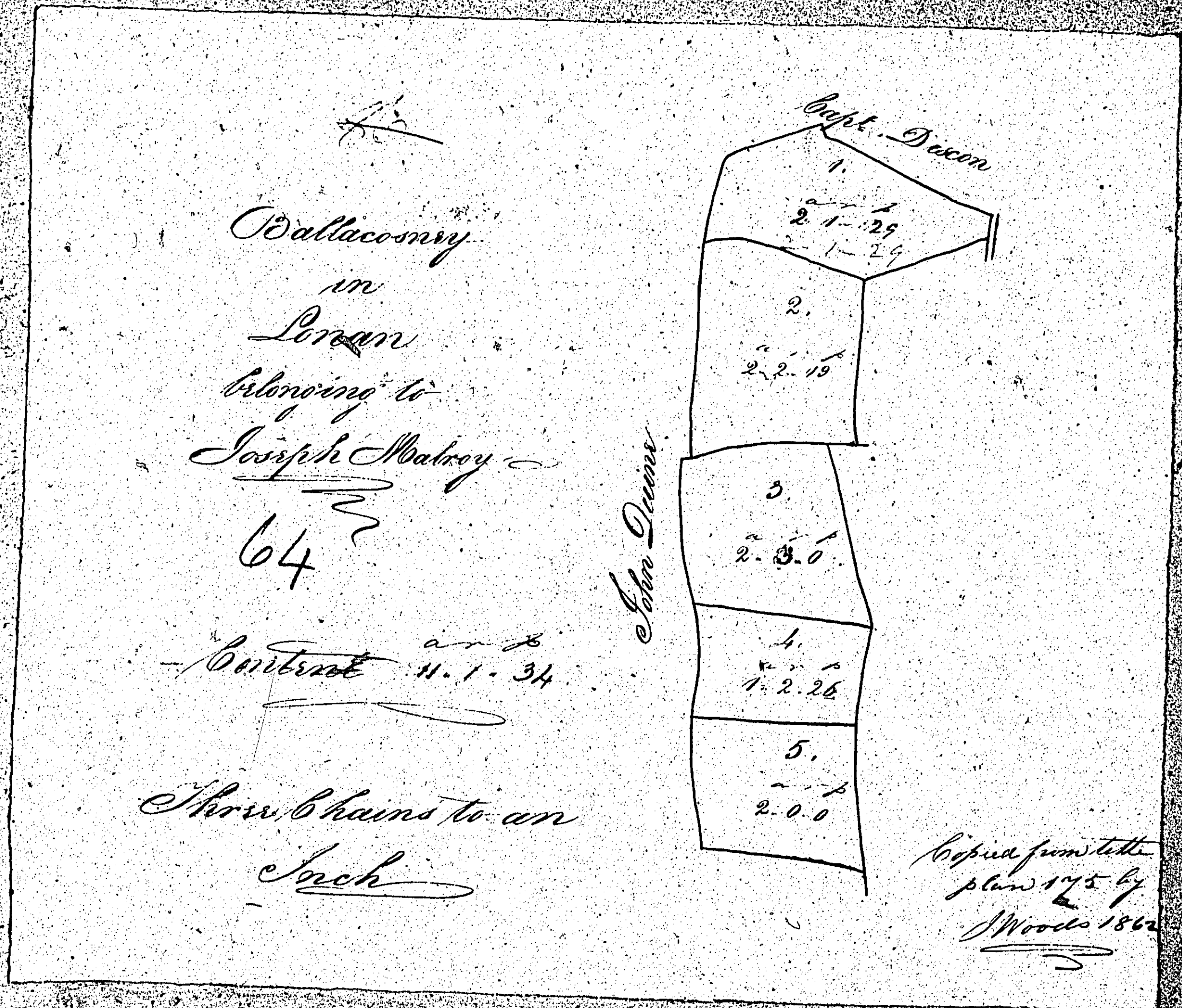

ISLE OF MAN GOVERNMENT: GENERAL REGISTRY

ASYLUM PLANS: PARISH OF LONAN

Originals coloured

1:23

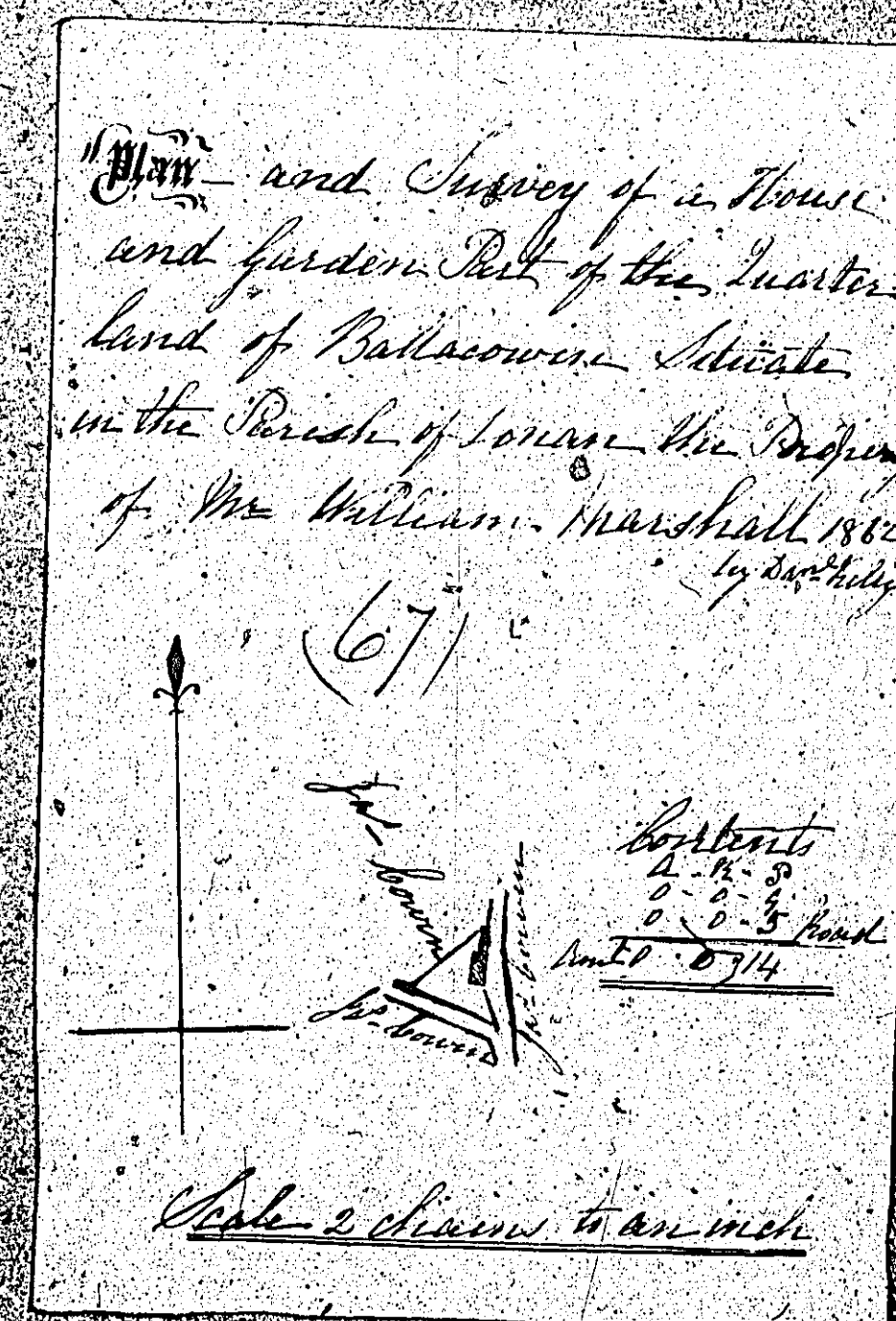
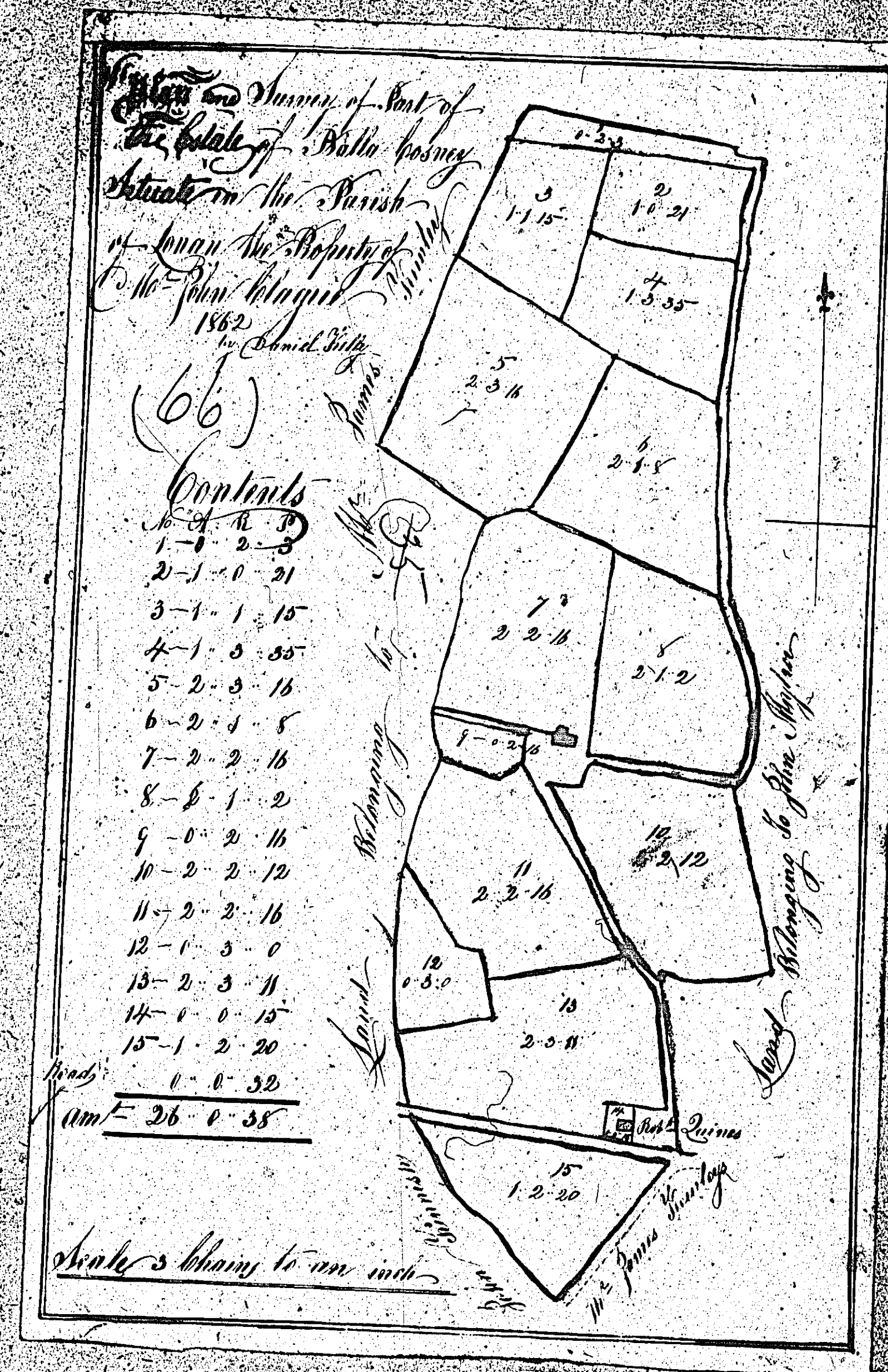

ISLE OF MAN GOVERNMENT: GENERAL REGISTRY

ASYLUM PLANS: PARISH OF LONAN

Original coloured (decorative)

1:23

Map and Survey of the Estate of
 & Rector of Lonan Situate in
 the Parish of Lonan the Property of
 (C) Mr James Owen 1862
 by James Owen Surveyor

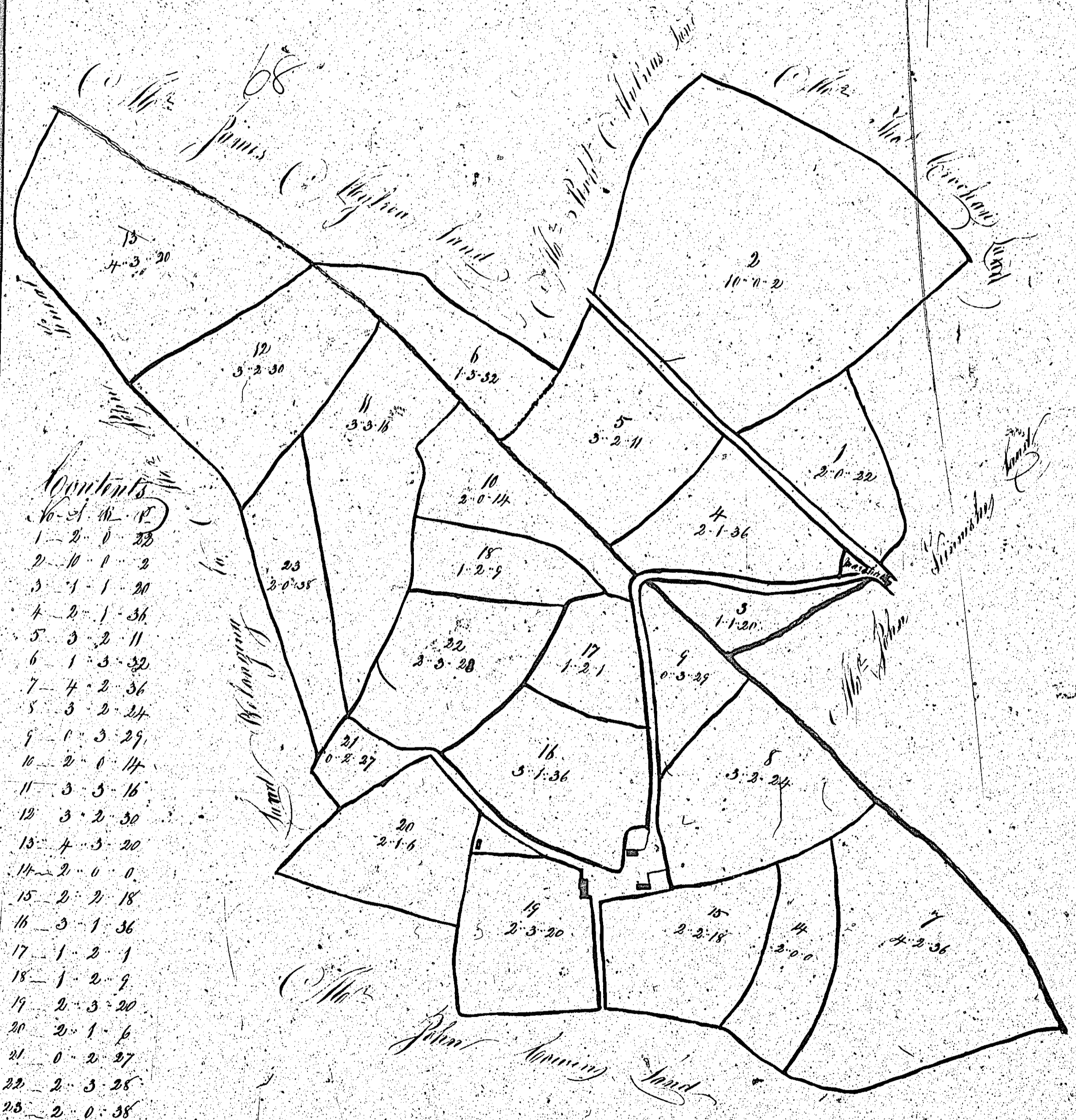

Contents

1	2	0	23
2	10	7	2
3	1	1	20
4	2	1	36
5	3	2	11
6	1	3	32
7	4	2	36
8	3	3	24
9	0	3	25
10	2	0	14
11	3	5	16
12	3	2	30
13	4	3	20
14	2	0	0
15	2	2	18
16	5	1	36
17	1	2	1
18	1	2	9
19	2	3	20
20	2	1	6
21	0	2	27
22	2	3	28
23	2	0	38
<hr/>			
68	2	4	

Scale of 5 chains to an inch

ISLE OF MAN GOVERNMENT: GENERAL REGISTRY

ASYLUM PLANS: PARISH OF LONAN

Original monotone

1:23

69

Moloughhour
in
Lonan
belonging to
John O'neal

Contents

<i>No</i>	<i>ac</i>	<i>r</i>	<i>p</i>
1	4	0	18
2	2	0	19
3	1	1	32
4	5	5	0
5	5	0	3
6	1	0	8
7	3	2	3
8	1	2	11
9	6	1	30
10	0	0	0
11	5	2	35
12	2	1	1
13	3	2	16
14	2	2	24
15	15	2	20
16	6	0	4
17	5	3	32
18	6	2	38
19	1	3	39
20	8	2	22
21	1	1	17
22	1	3	1
<i>Open</i>	1	0	22
<i>Total</i>	102	0	17

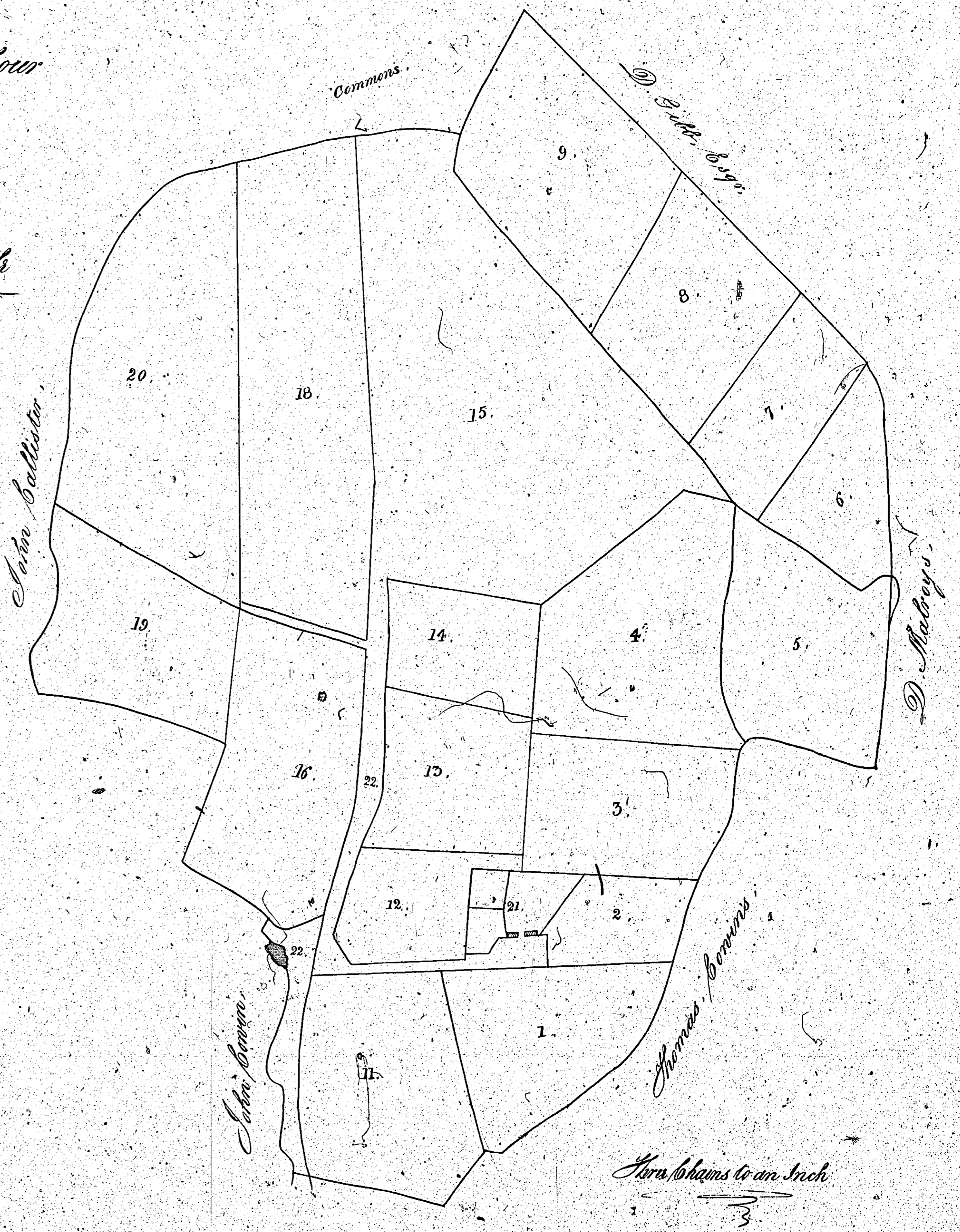

Thomas Corvins

Copied from Record plan 120.
Woods 1862

ISLE OF MAN GOVERNMENT: GENERAL REGISTRY

ASYLUM PLANS: PARISH OF LONAN

Originals monotone

1:23

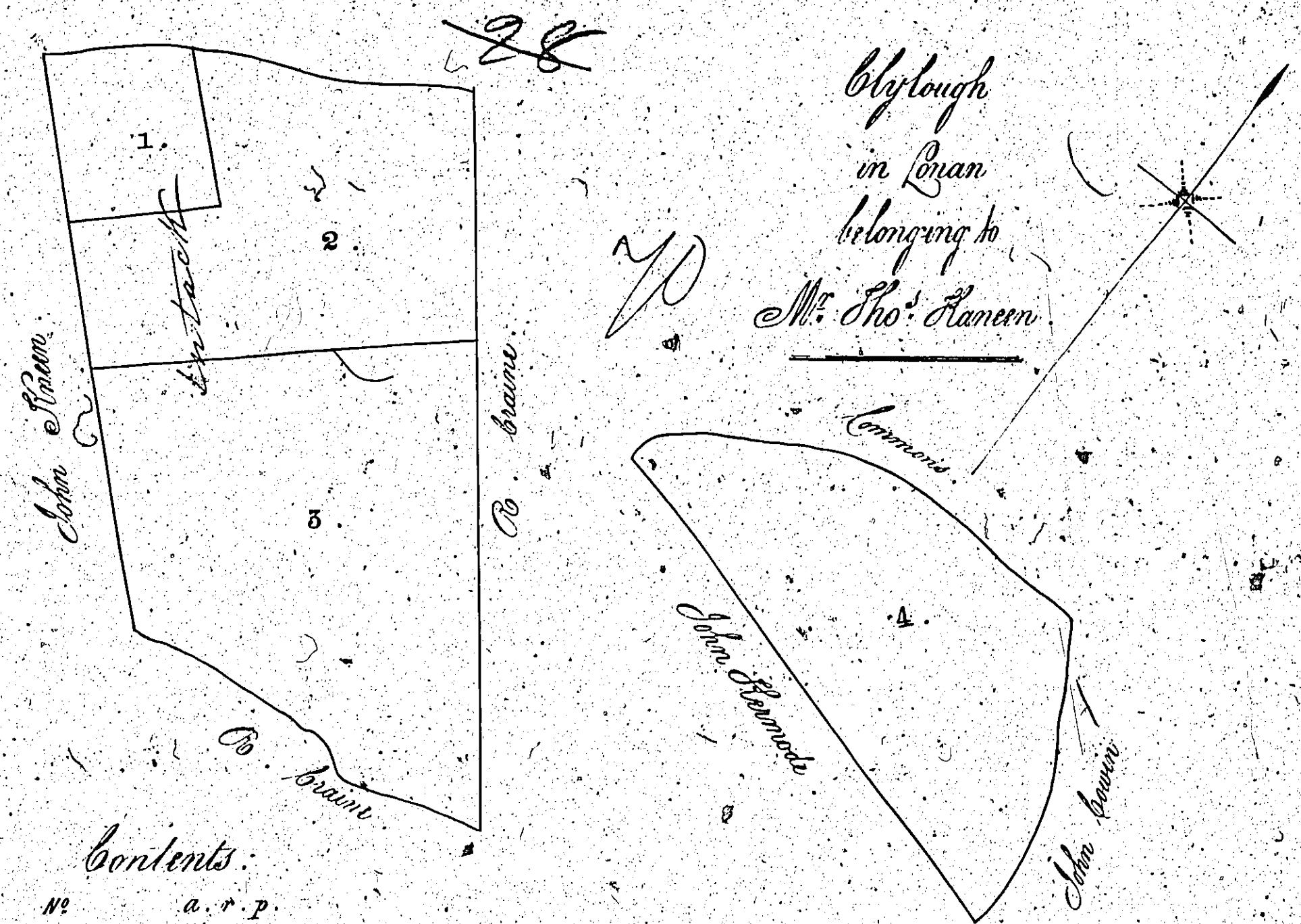

Contents:

No	a. r. p.
1	7. 2. 24
2	5. 1. 2
3	1. 1. 24
4	6. 2. 18
Total	20. 3. 28

Scale
Three Chains to an Inch.
Copied from the Plan N^o 106 & 207, by Jas: Woods, 1862.

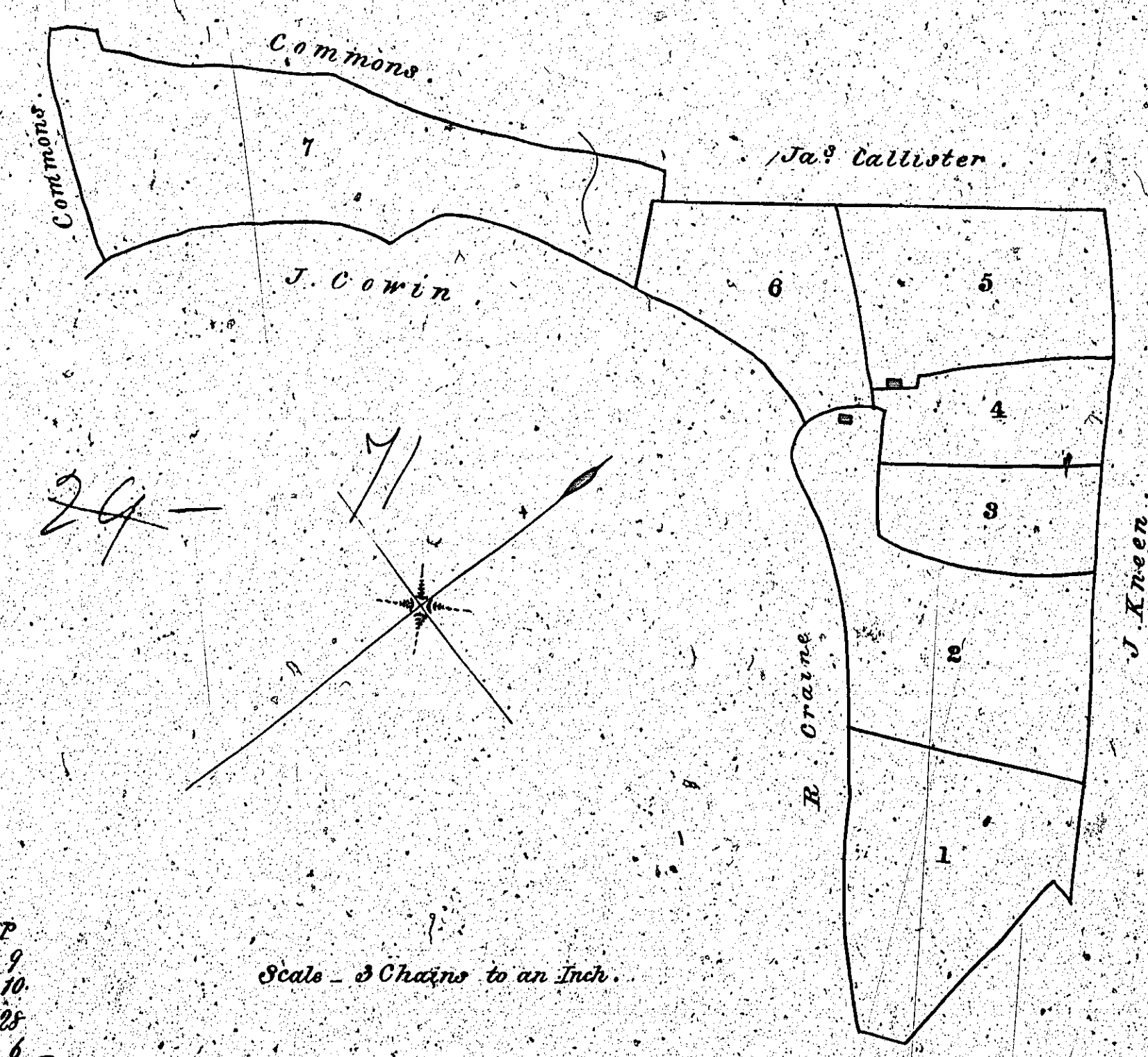

Contents:

No	a. r. p.
1	2. 7. 9
2	3. 0. 10
3	1. 0. 28
4	1. 1. 6
5	2. 0. 16
6	1. 3. 0
7	4. 1. 15
Total	16. 0. 4

Scale - 3 Chains to an Inch.
Copied from the Plan N^o 105, by Jas: Woods, 1862.