

ISLE OF MAN GOVERNMENT: GENERAL REGISTRY
ASYLUM PLANS: PARISH OF LEZAYRE

Original coloured

1:23

407
Plan of the
Vicars Glebe
in the
Parish of Lezayre.

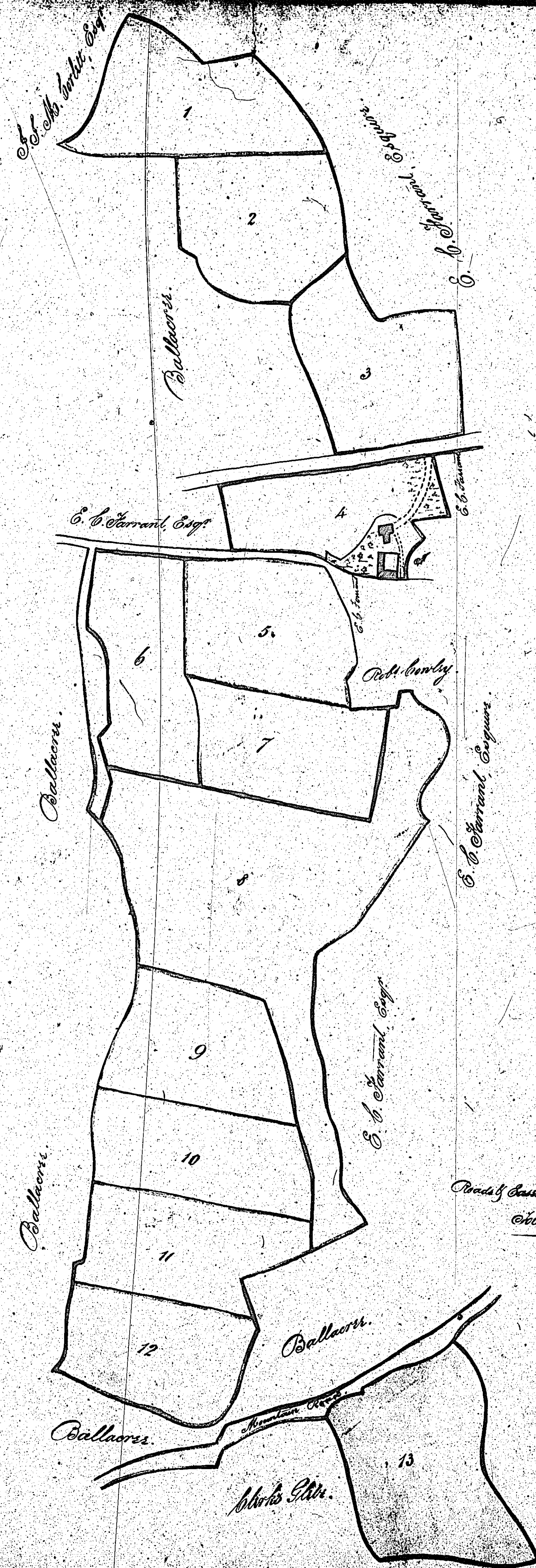

ISLE OF MAN GOVERNMENT: GENERAL REGISTRY
 ASYLUM PLANS: PARISH OF LEZAYRE
 Original coloured 1:23

4 408
 The Estate
 of
 Ballakillman
 in
 Lezayre
 belonging to
 Edw. Stewart Esq.

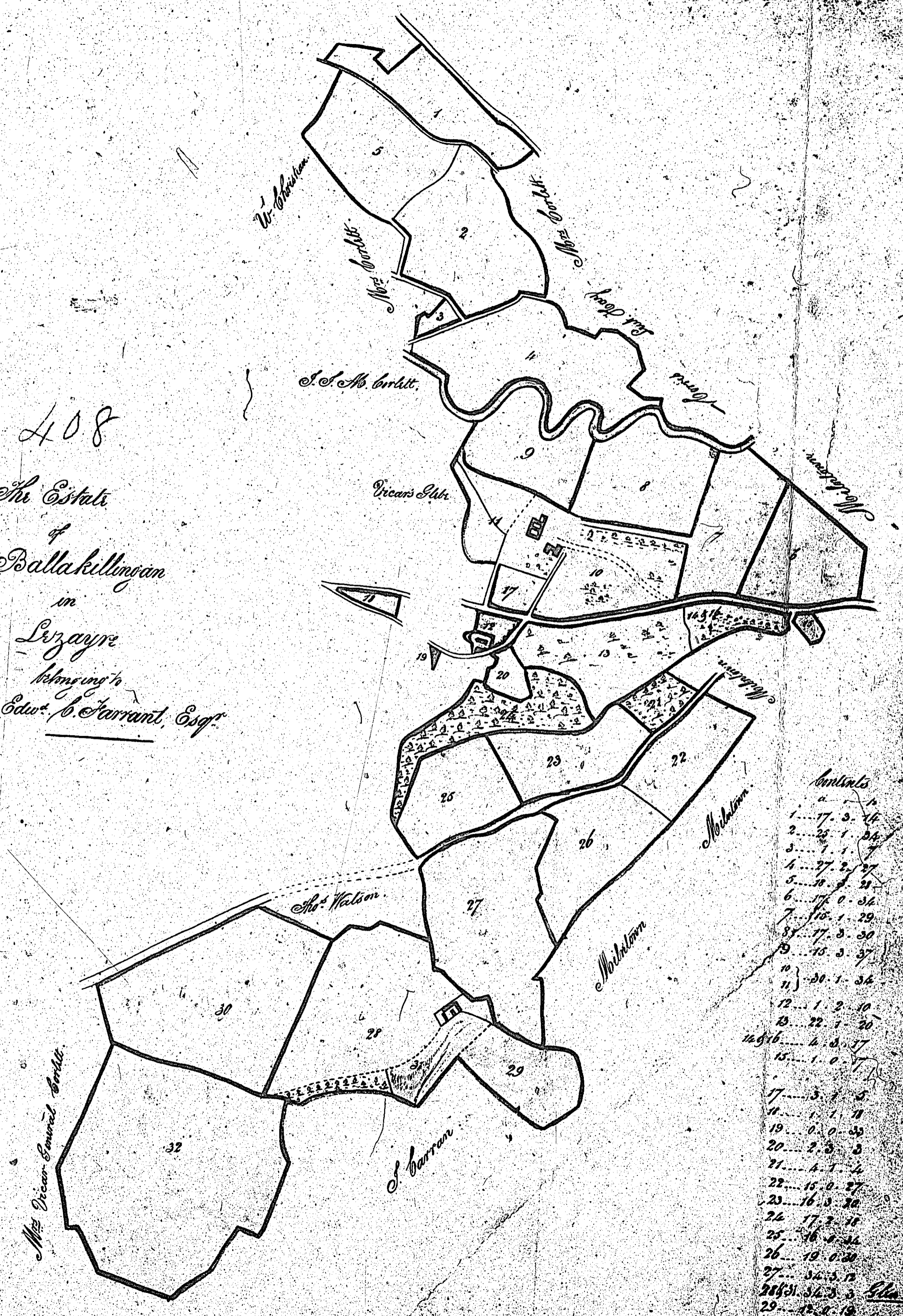

Antals

1	7. 3. 14
2	25. 1. 34
3	1. 1. 1
4	27. 2. 27
5	10. 2. 21
6	17. 0. 36
7	15. 1. 29
8	17. 3. 30
9	15. 3. 37
10	20. 1. 34
11	1. 2. 10
12	22. 1. 20
13	4. 3. 37
14	1. 0. 17
15	3. 1. 5
16	1. 1. 1
17	0. 0. 35
18	2. 3. 3
19	4. 1. 4
20	15. 0. 27
21	16. 3. 30
22	17. 2. 31
23	16. 3. 30
24	19. 0. 38
25	14. 3. 13
26	14. 3. 13
27	14. 3. 13
28	14. 3. 13
29	14. 3. 13
30	14. 3. 13
31	14. 3. 13
32	14. 3. 13

South - Shows to an orchard

ISLE OF MAN GOVERNMENT: GENERAL REGISTRY

ASYLUM PLANS: PARISH OF LEZAYRE

Original monotone

1:23

frame 1 of 2

NEARY
in Lezayre
belonging to
Mr. William Crooke.

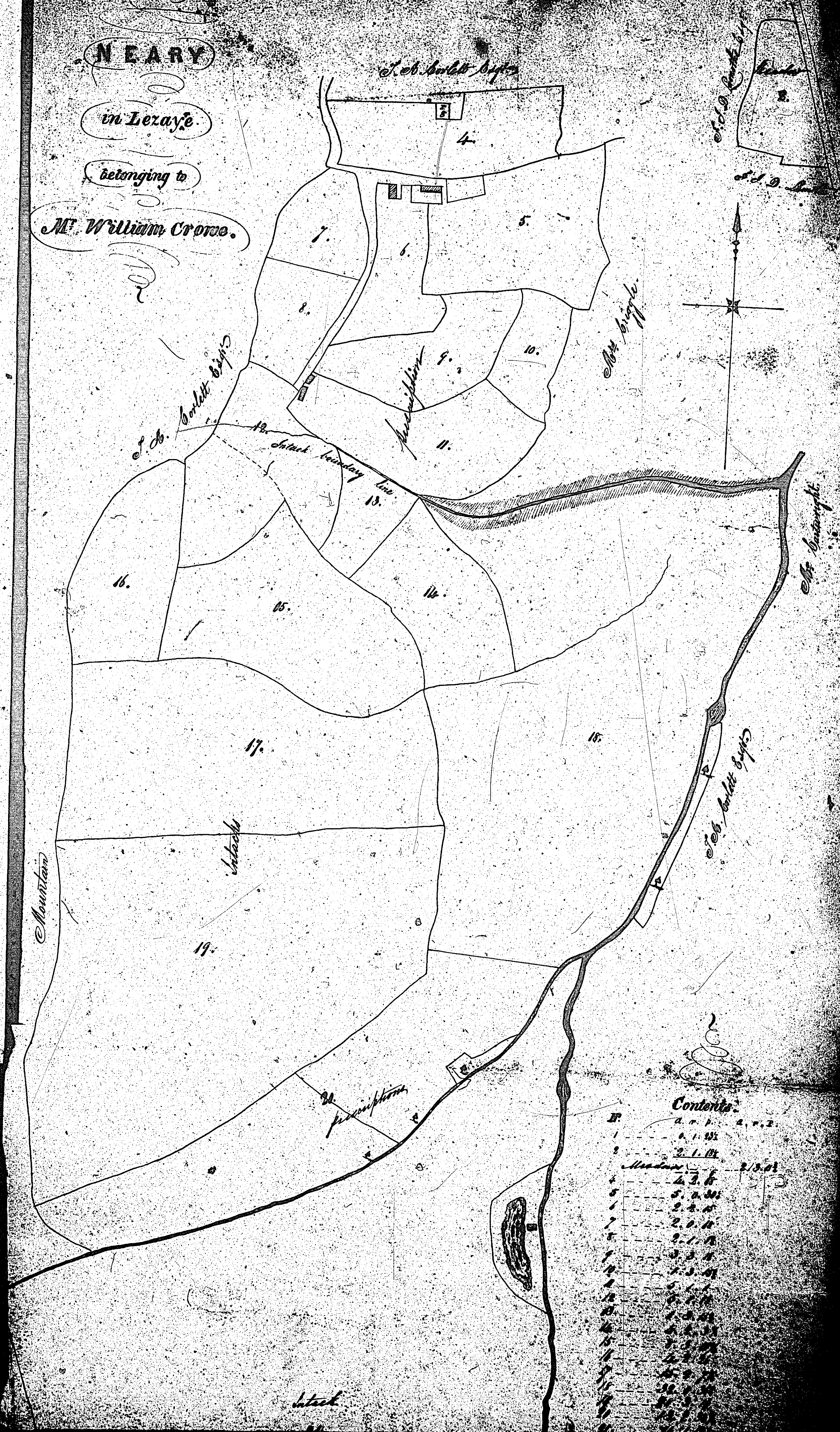

Cholera

Water

ISLE OF MAN GOVERNMENT: GENERAL REGISTRY

ASYLUM PLANS: PARISH OF LEZAYRE

Original monotone

1:23

frame 2 of 2

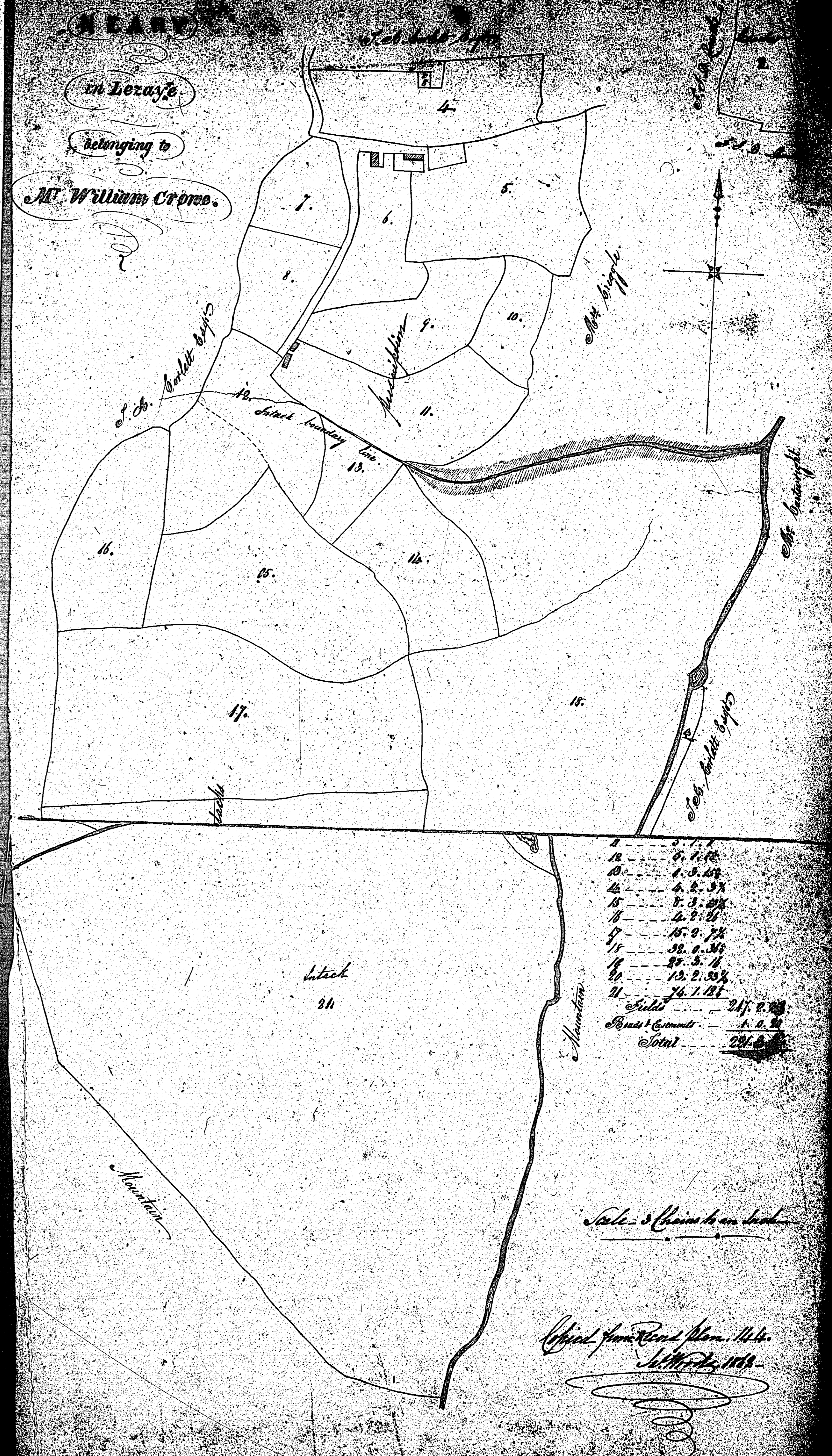

*Middle third &c
marked*

ISLE OF MAN GOVERNMENT: GENERAL REGISTRY

ASYLUM PLANS: PARISH OF LEZAYRE

Original coloured (decorative)

1:23

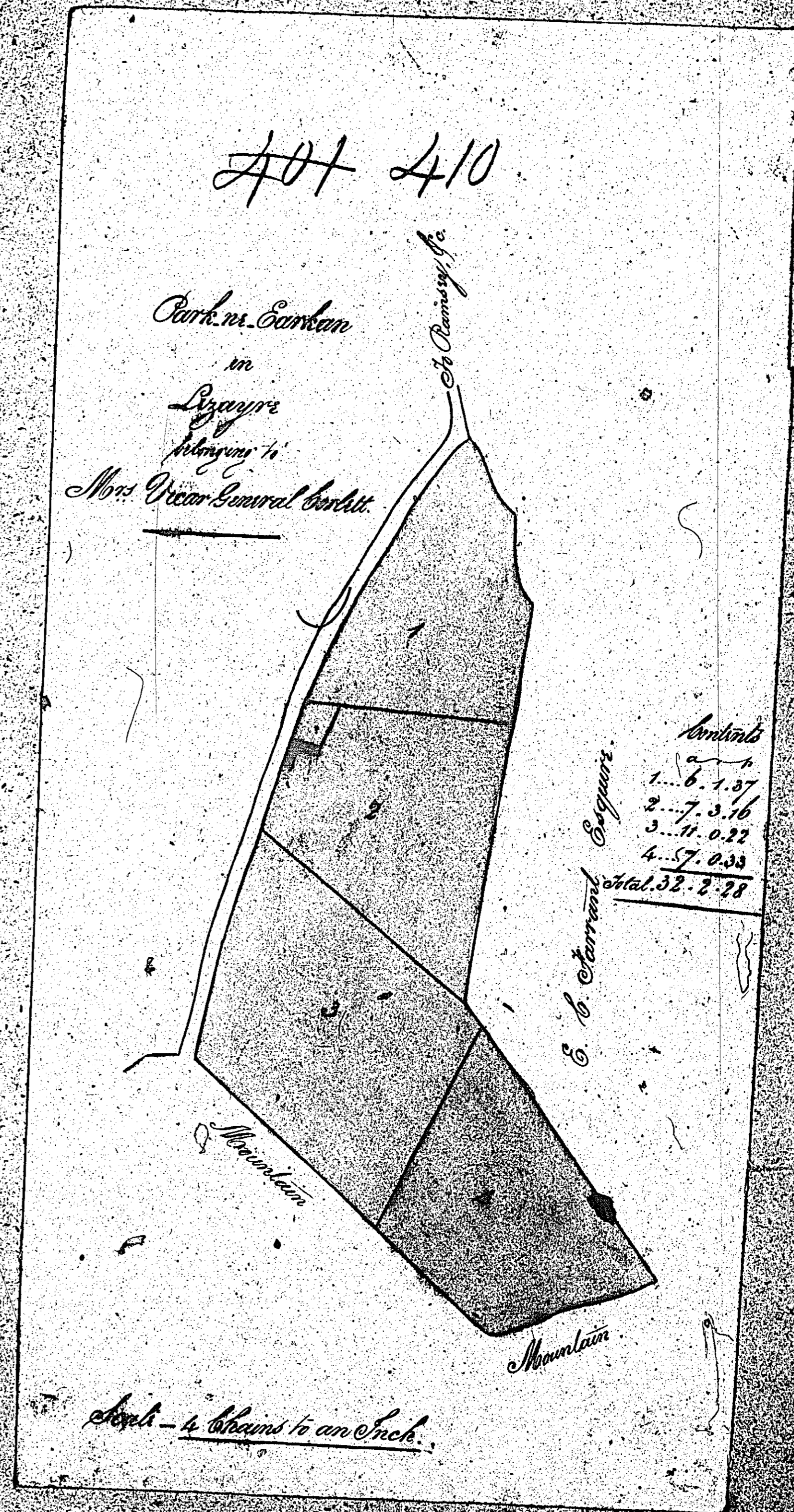

There is no plan
numbered

411