

ISLE OF MAN GOVERNMENT: GENERAL REGISTRY

ASYLUM PLANS: PARISH OF LEZAYRE

- 340 Original coloured
- 341 Original monotone

1:23

340
 Mrs. Isaac Smith Corlett's
 Property at
 Sandy Road
 Lezayre

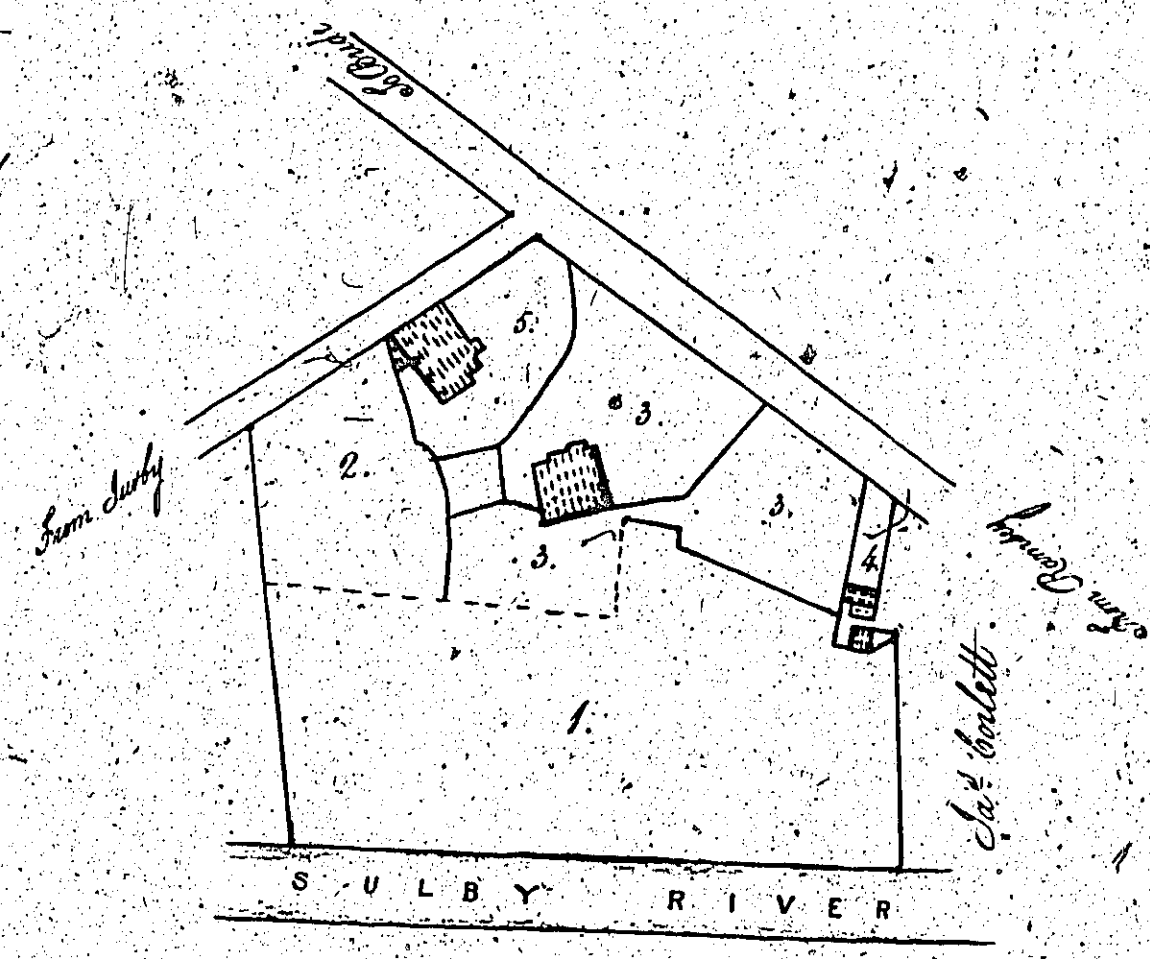

Contents

No.	a.	r.	p.	
1	Down garden	1	2.56	
2	Upper do.	0	1.24	
3	Down front & rear	0	2.65	
4	Stable yard	0	0.55	
5	Cottage	0	0.25	
Chestnut of			0	0.20
Public Road				
Total			3	0.36

C. G. Smith C. G. & Co. 1862.

Scale - 2 chains to an inch.

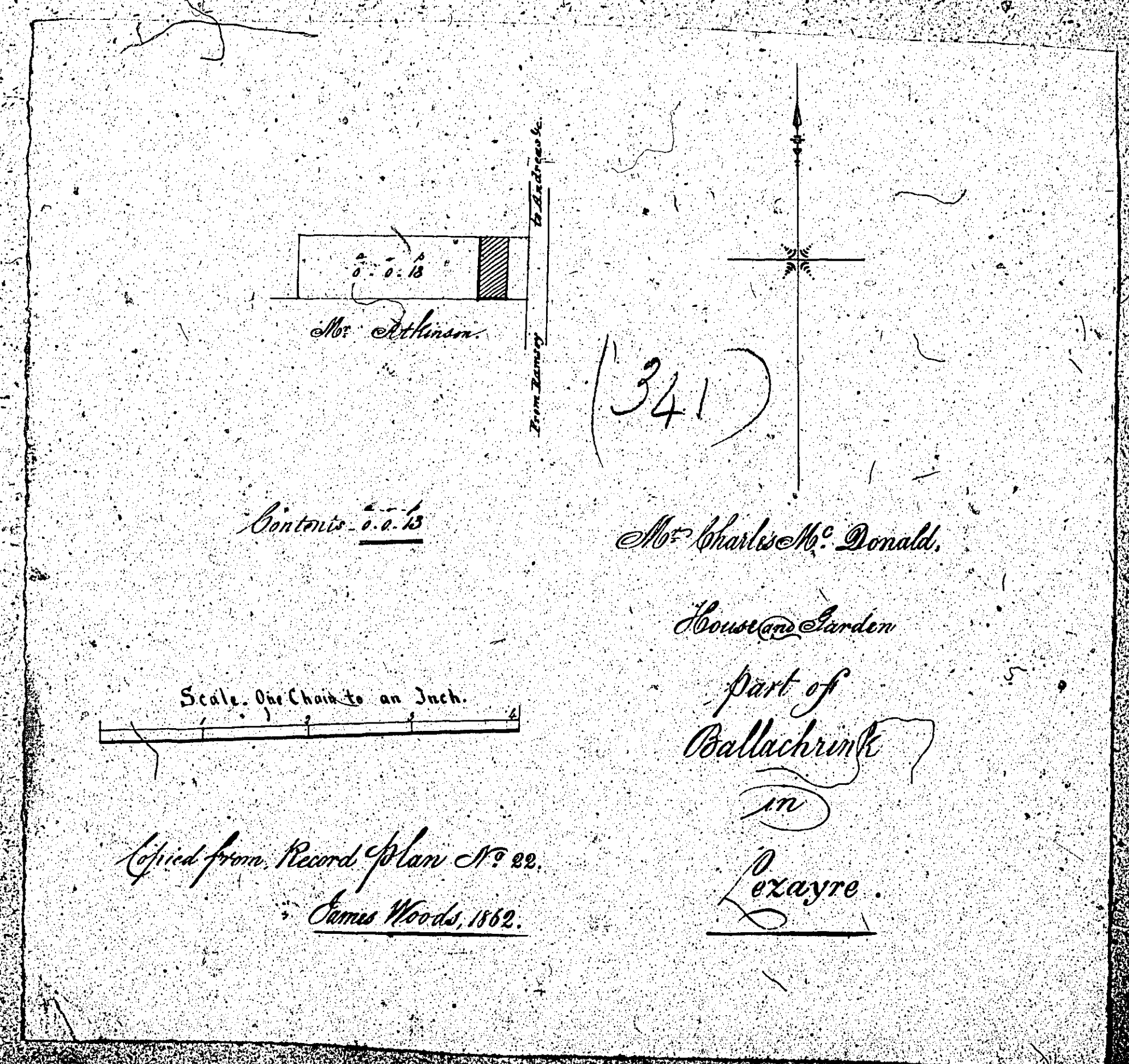

Mr. Johnson
 Contents - 0.0.15

(341)

Mr. Charles M. Donald.

House & Garden
 part of
 Ballachrink
 in
 Lezayre.

Scale. One Chain to an Inch.

Copied from Record plan No. 22.
 James Woods, 1852.

ISLE OF MAN GOVERNMENT: GENERAL REGISTRY

ASYLUM PLANS: PARISH OF LEZAYRE

- 342 Original monotone
- 343 Original coloured

1:23

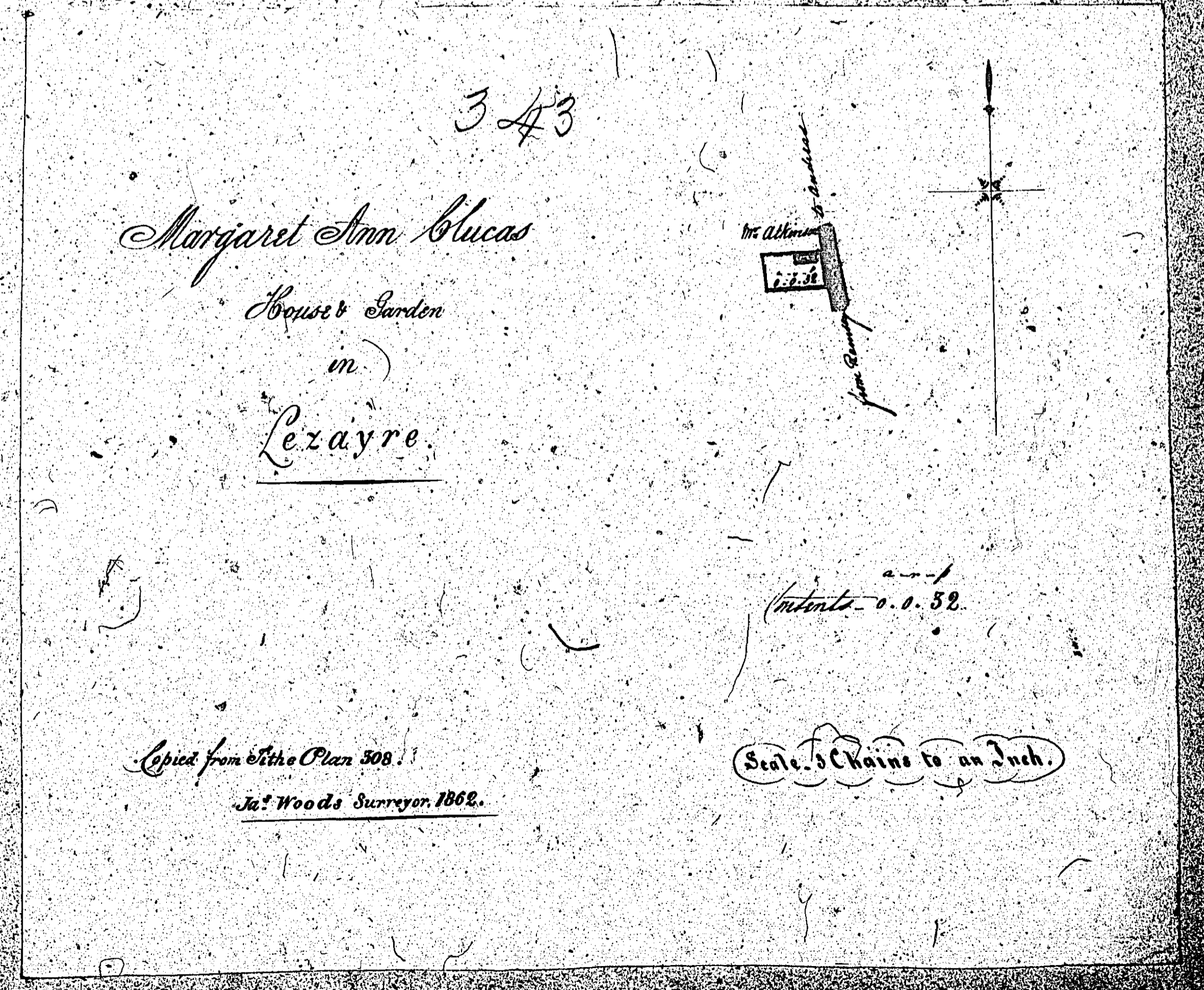
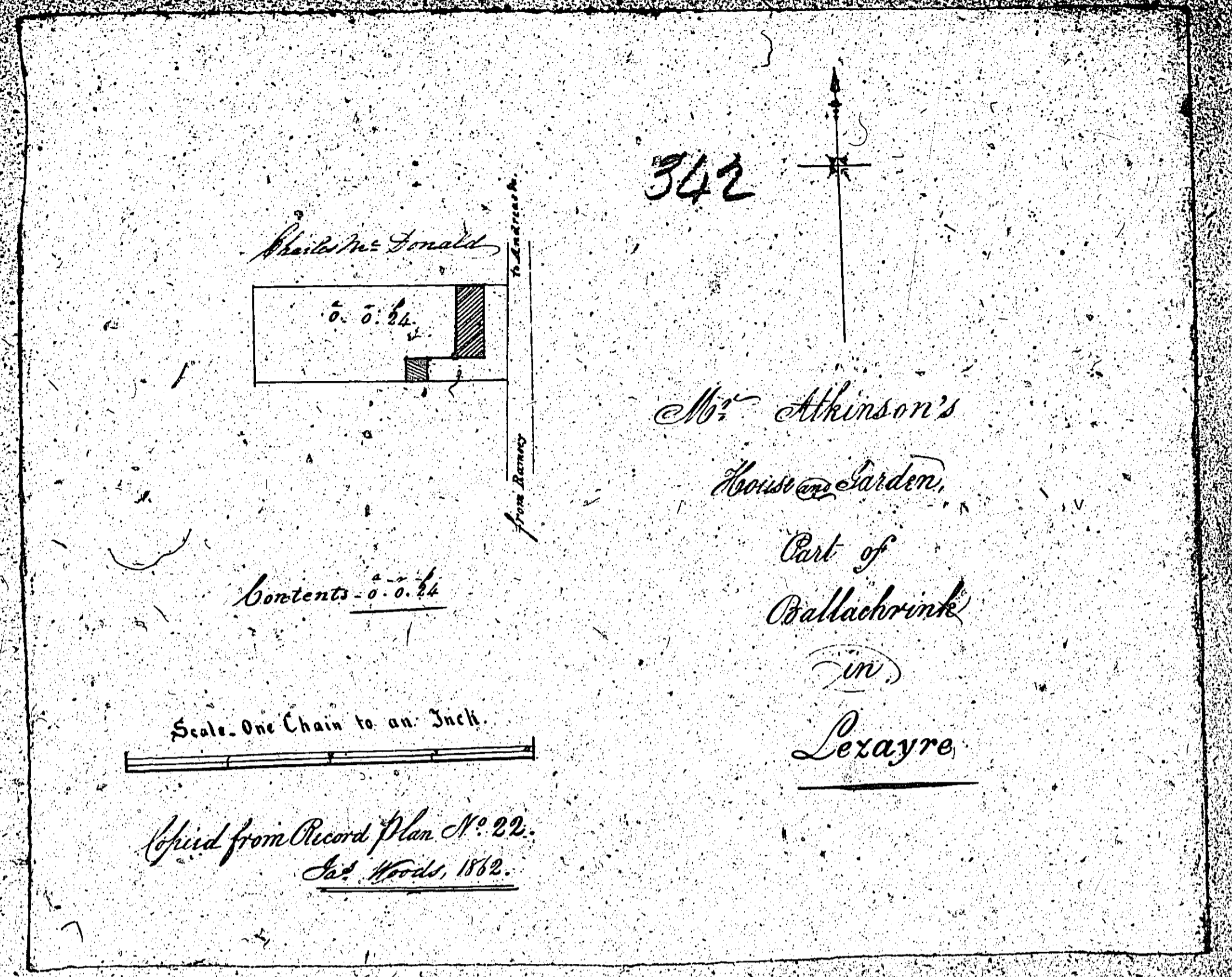

ISLE OF MAN GOVERNMENT: GENERAL REGISTRY

ASYLUM PLANS: PARISH OF LEZAYRE

Originals monotone

1:23

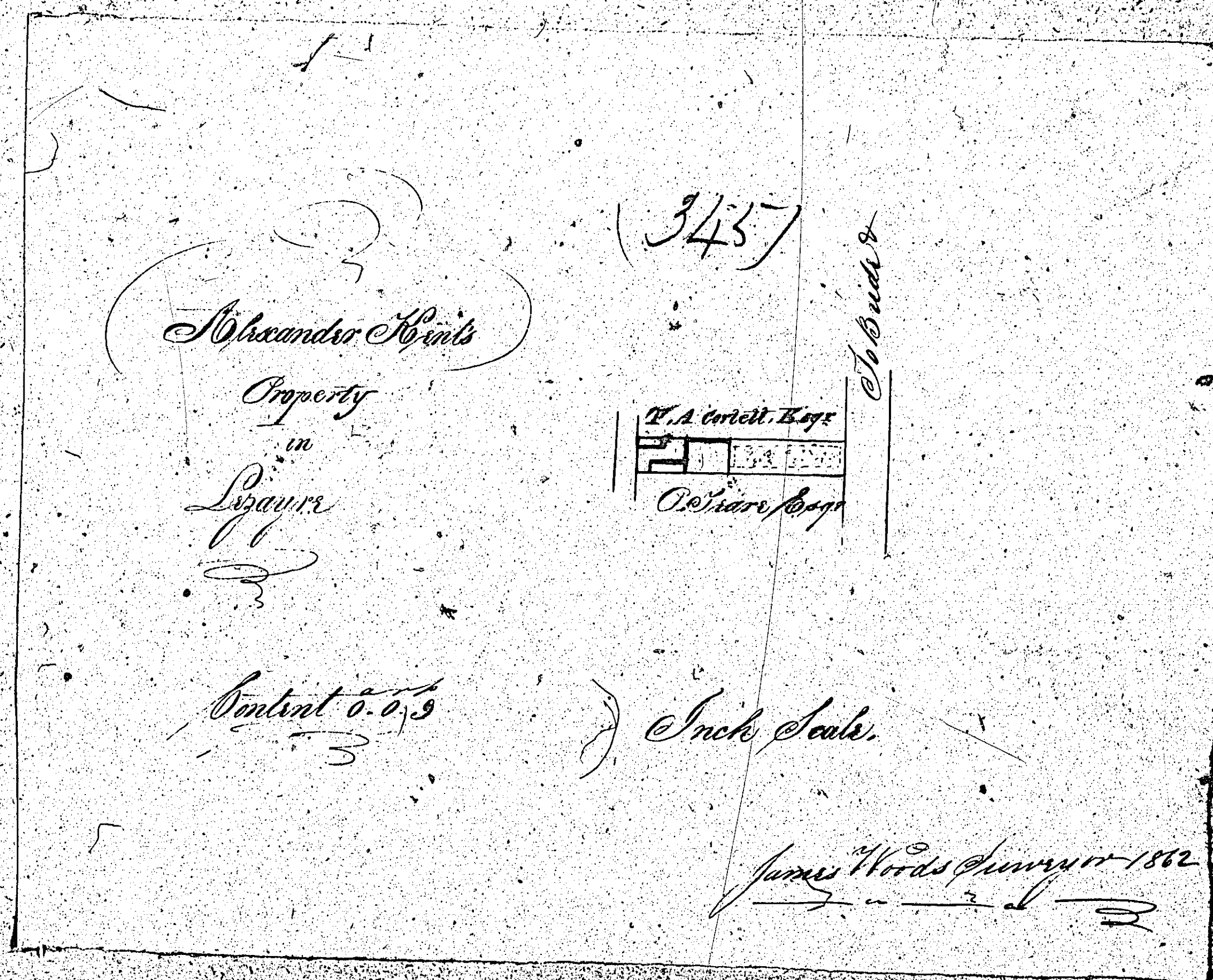
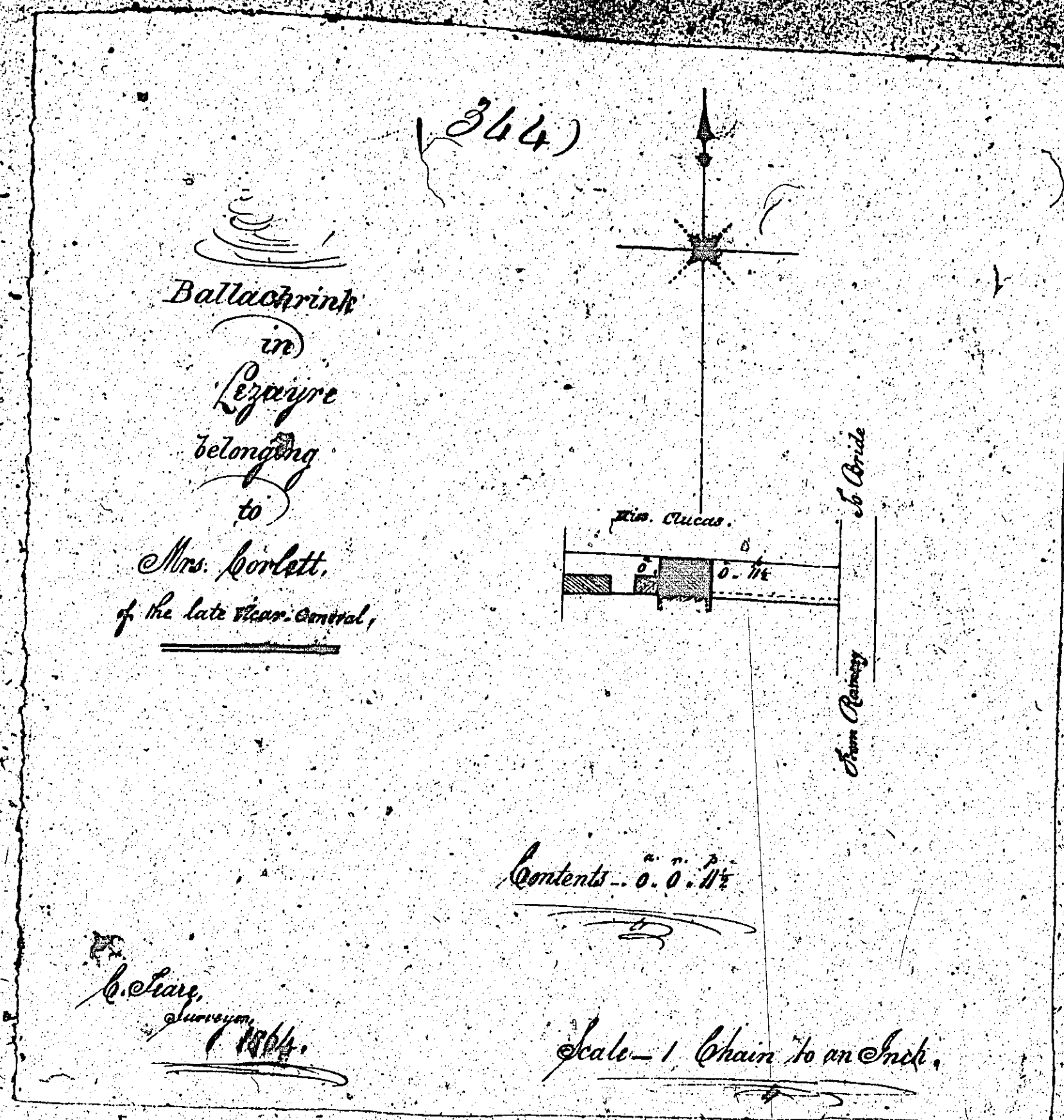

ISLE OF MAN GOVERNMENT: GENERAL REGISTRY
 ASYLUM PLANS: PARISH OF LEZAYRE

Originals monotone

1:23

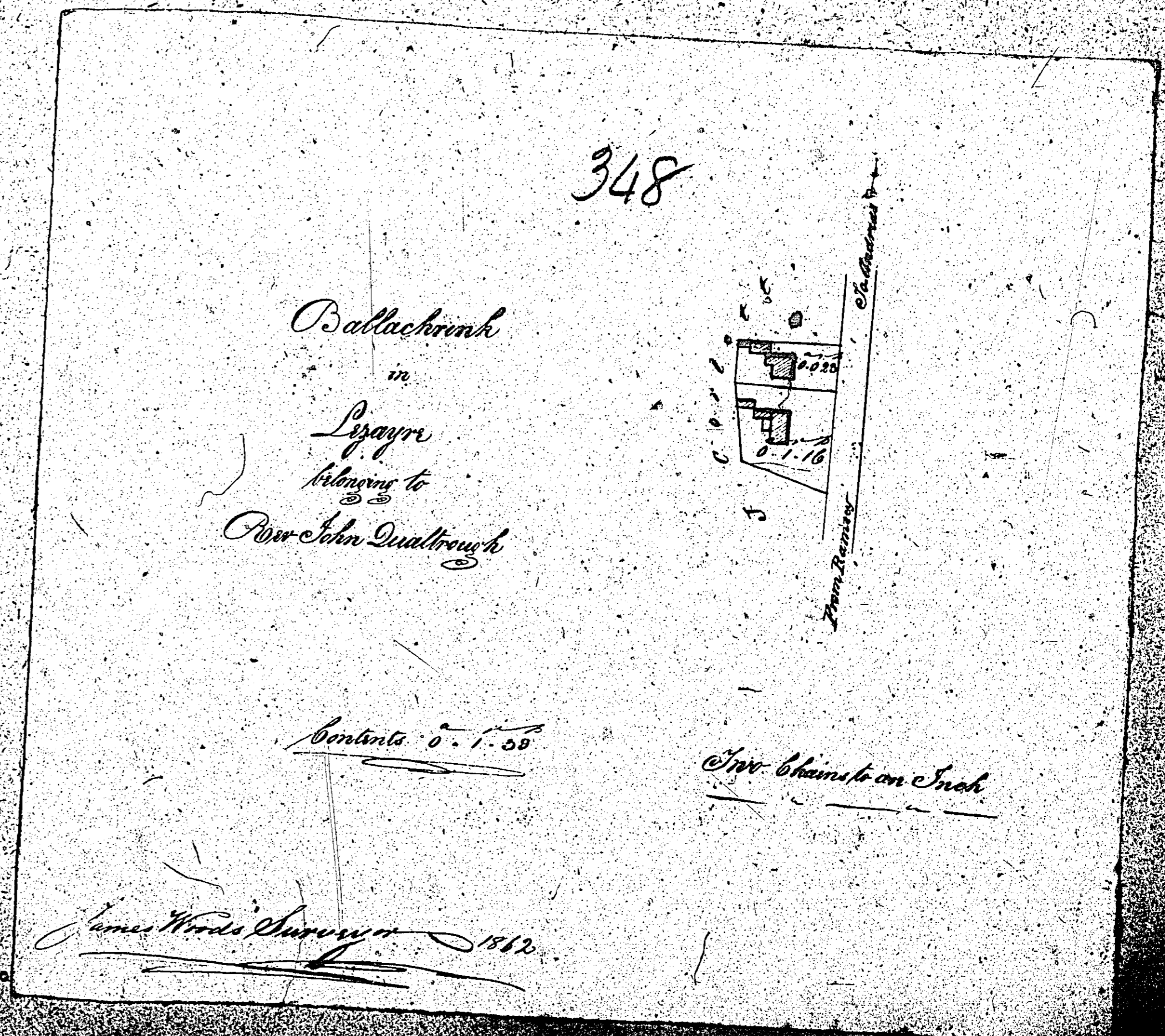
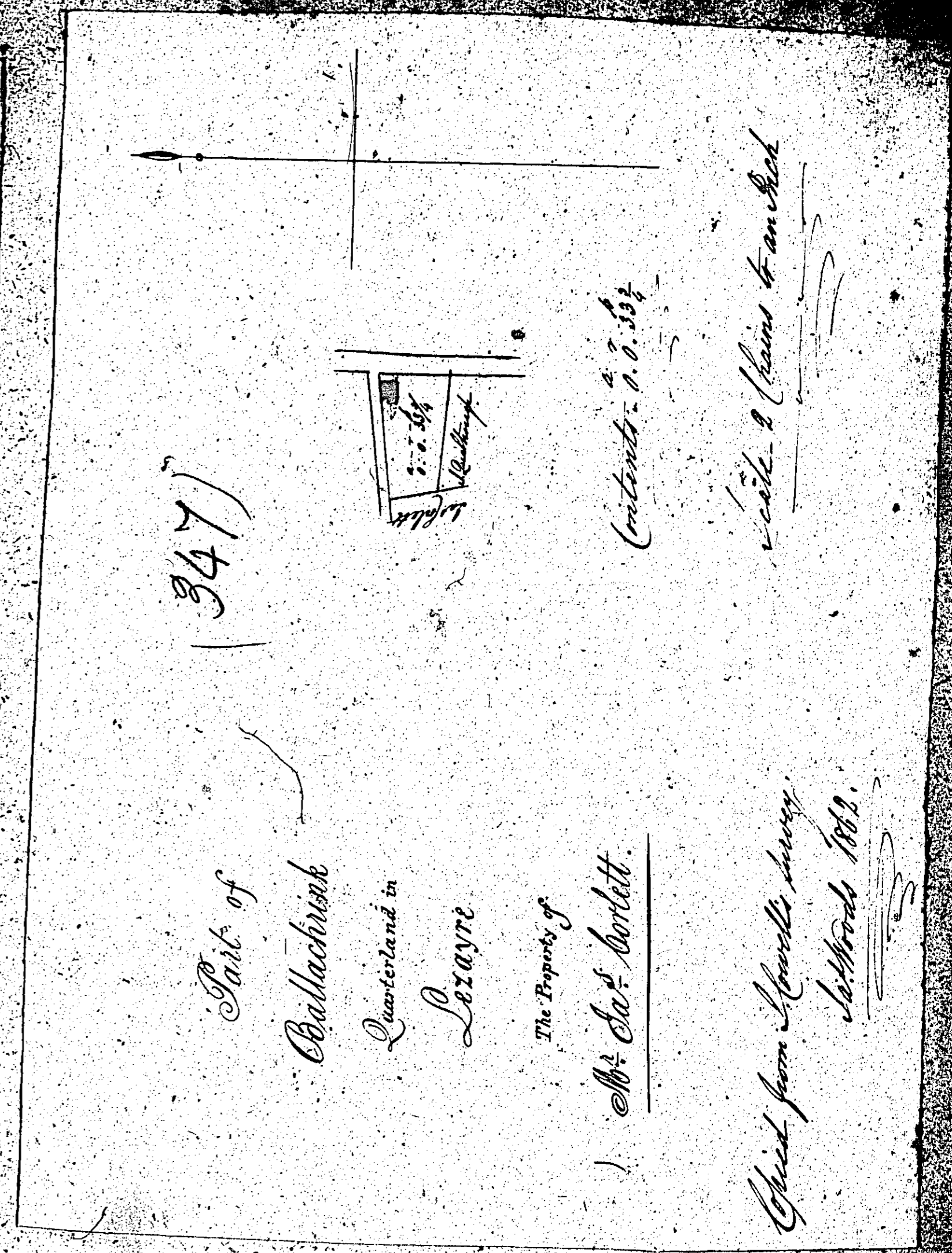
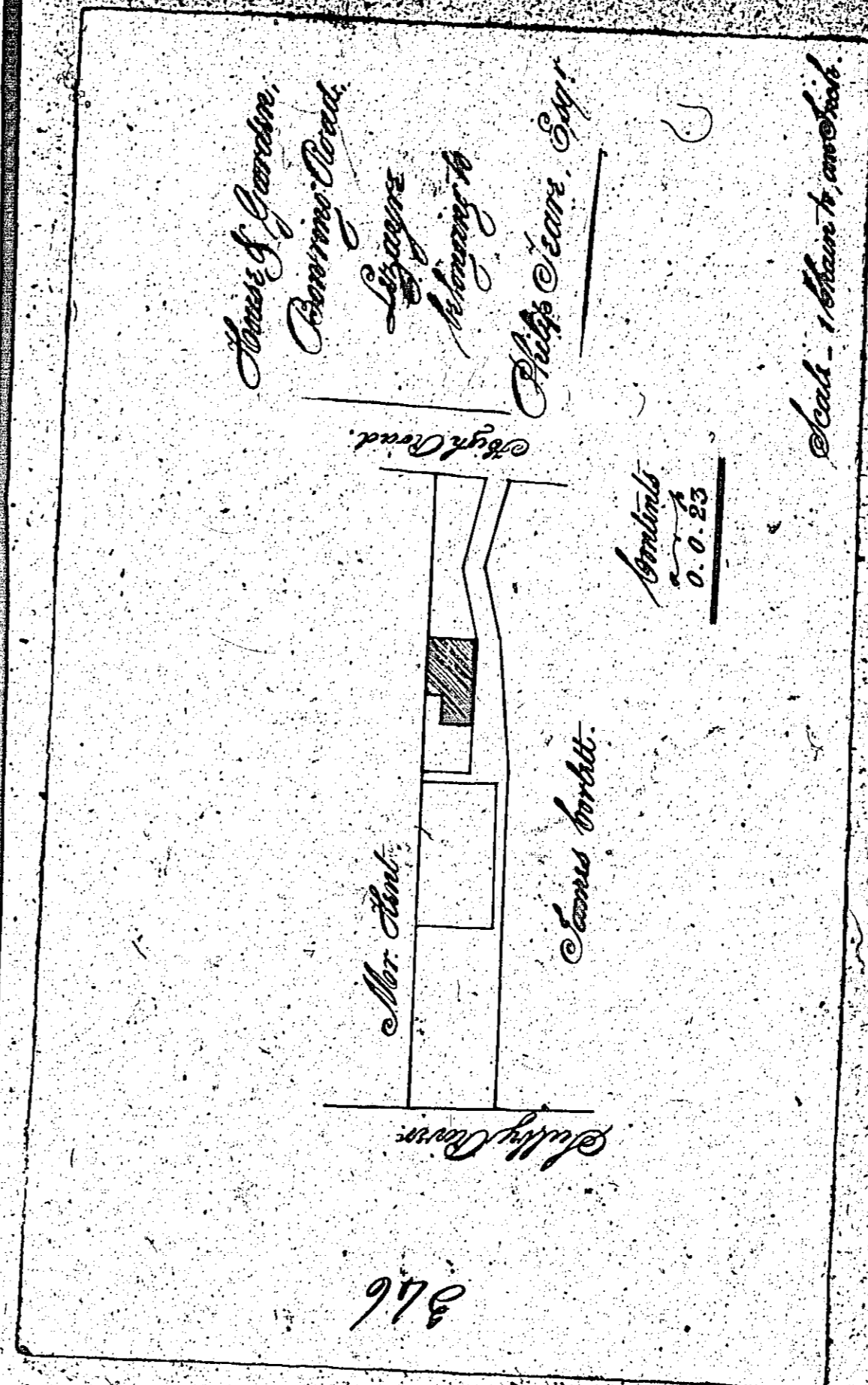

ISLE OF MAN GOVERNMENT: GENERAL REGISTRY

ASYLUM PLANS: PARISH OF LEZAYRE

Original monotone

1:23

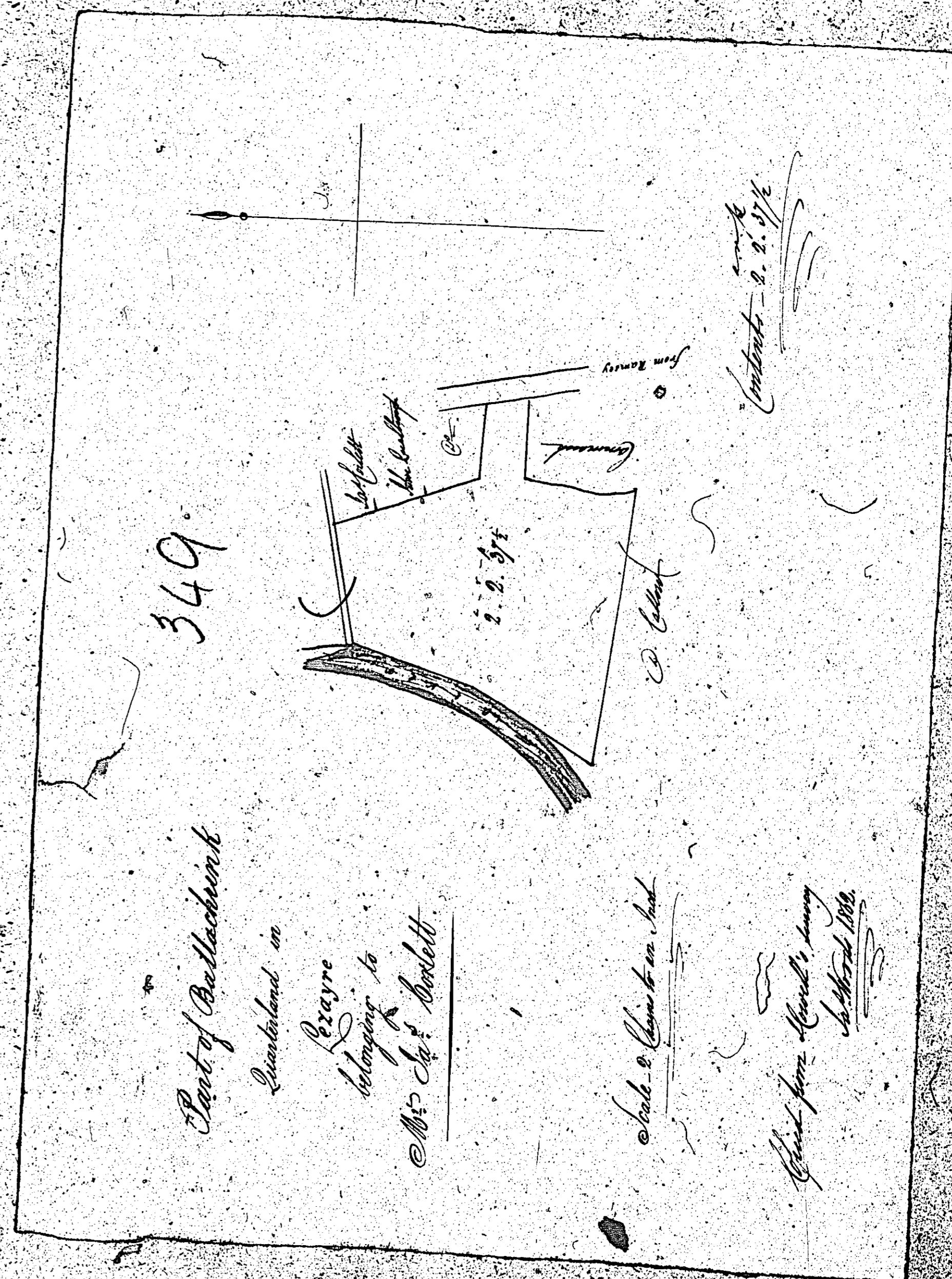

ISLE OF MAN GOVERNMENT: GENERAL REGISTRY

ASYLUM PLANS: PARISH OF LEZAYRE

Original monotone

1:23

