

ISLE OF MAN GOVERNMENT: GENERAL REGISTRY

ASYLUM PLANS: PARISH OF GERMAN

Original monotone

1:23

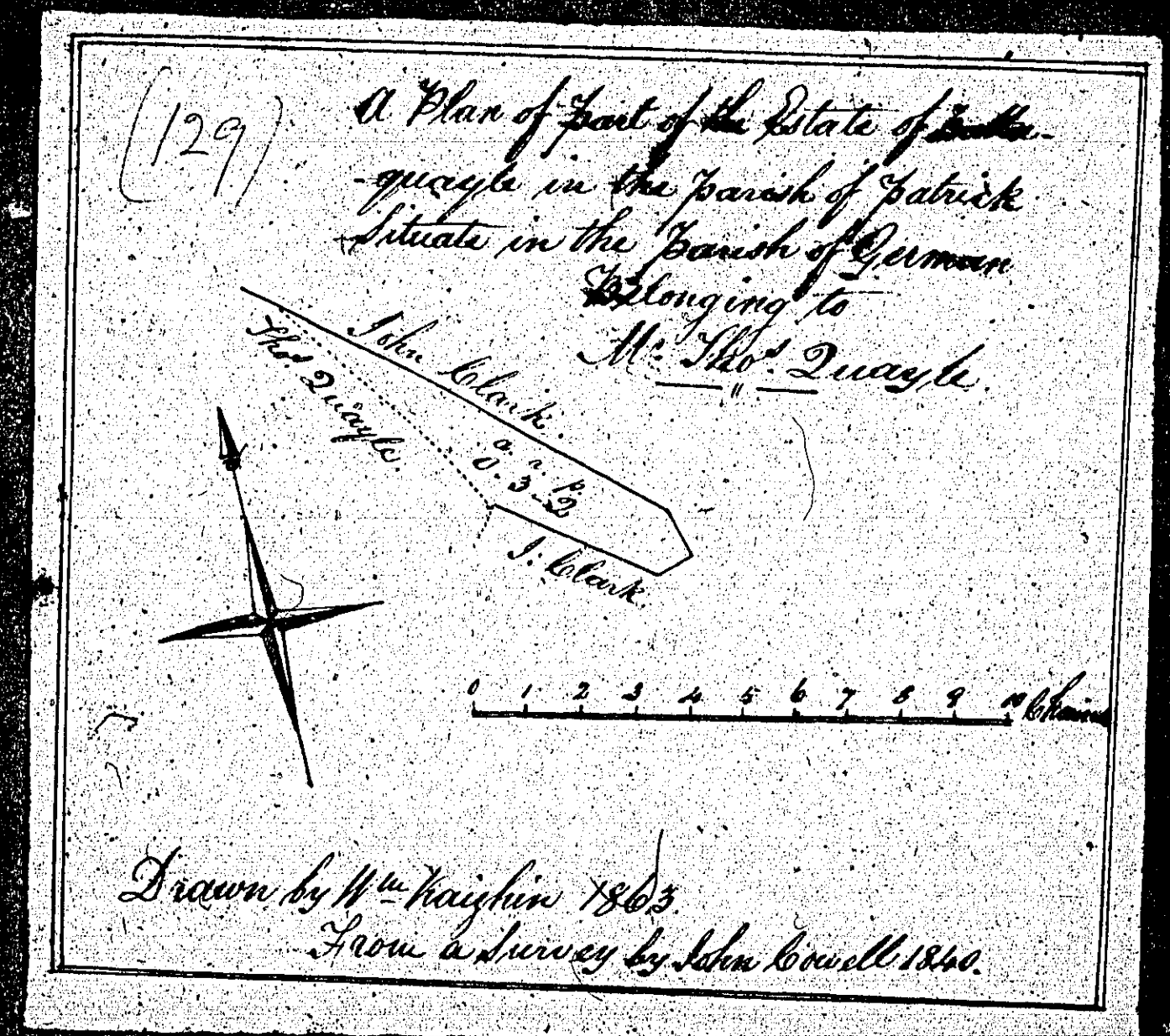

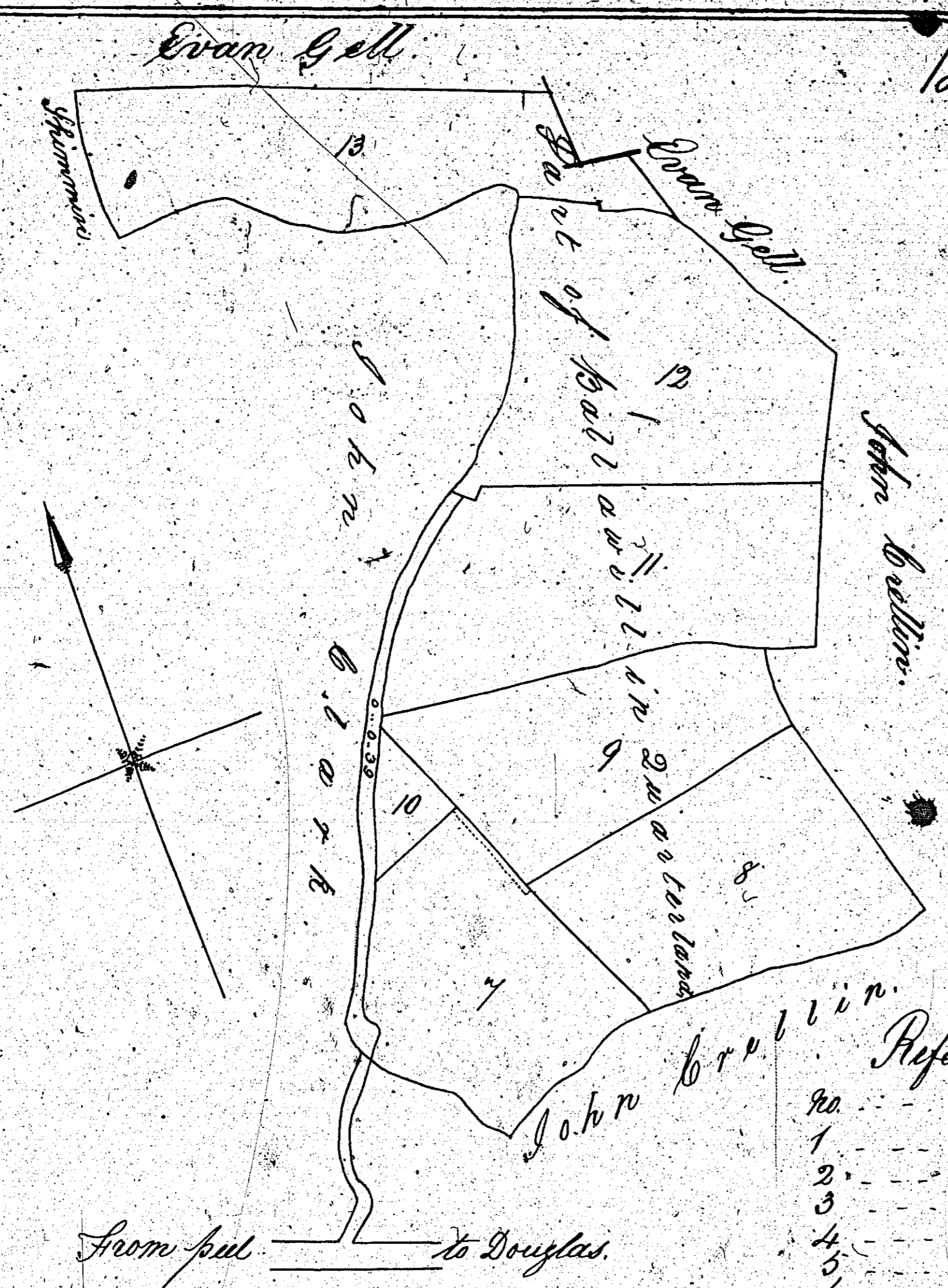

130
 Plan of a part of Ballavillin and Ballaharra
 in the Parish of German. the property of
 W. Robert Duayne.

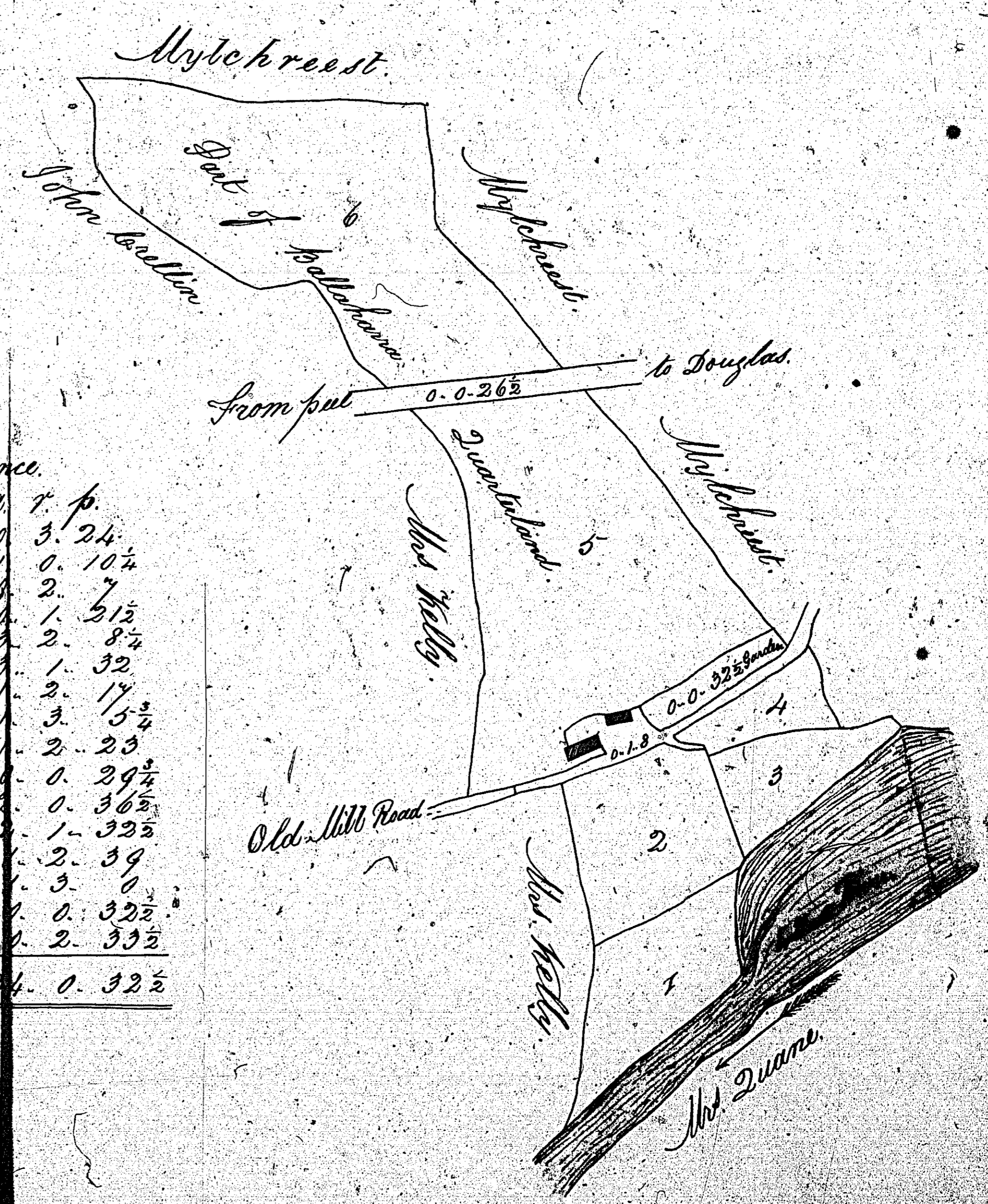

no.	Reference.	r.	p.
1	0.	3.	24 1/4
2	1.	0.	10 1/4
3	1.	2.	7
4	4.	1.	5 1/2
5	3.	2.	8 1/4
6	3.	1.	32
7	1.	2.	17 1/4
8	1.	3.	15 1/4
9	1.	2.	23
10	4.	0.	29 1/4
11	2.	0.	36 1/2
12	2.	1.	32 1/2
13	2.	2.	39
River	1.	3.	0
Garden	1.	0.	32 1/2
Roads	1.	2.	33 1/2
Total	24.	0.	32 1/2

0 1 2 3 4 5 6 7 8 9 10 chains

J. Howell of Bride Surveyor 1840.
 Copied by Wm. Haighin 1863.

ISLE OF MAN GOVERNMENT: GENERAL REGISTRY

ASYLUM PLANS: PARISH OF GERMAN

Original coloured

1:23

A Plan and Survey
of Ballahona
in the Parish of German
the property of
John Mylchrest (a minor)



ISLE OF MAN GOVERNMENT: GENERAL REGISTRY

ASYLUM PLANS: PARISH OF GERMAN

Original coloured

1:23

The following two
plans are both
numbered

132

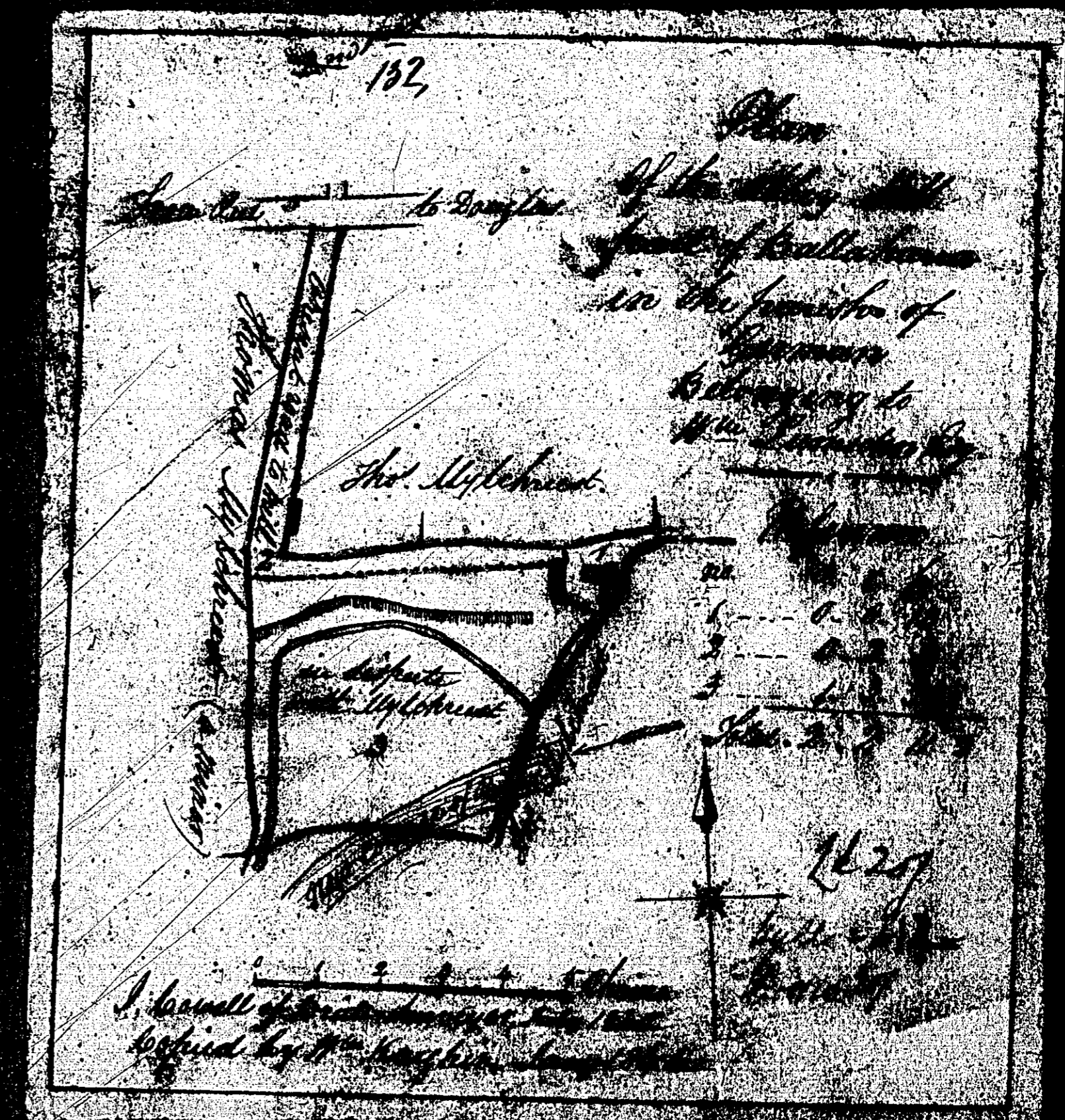

ISLE OF MAN GOVERNMENT: GENERAL REGISTRY

ASYLUM PLANS: PARISH OF GERMAN

Original coloured

1:23

ISLE OF MAN GOVERNMENT: GENERAL REGISTRY

ASYLUM PLANS: PARISH OF GERMAN

Original monotone

1:23

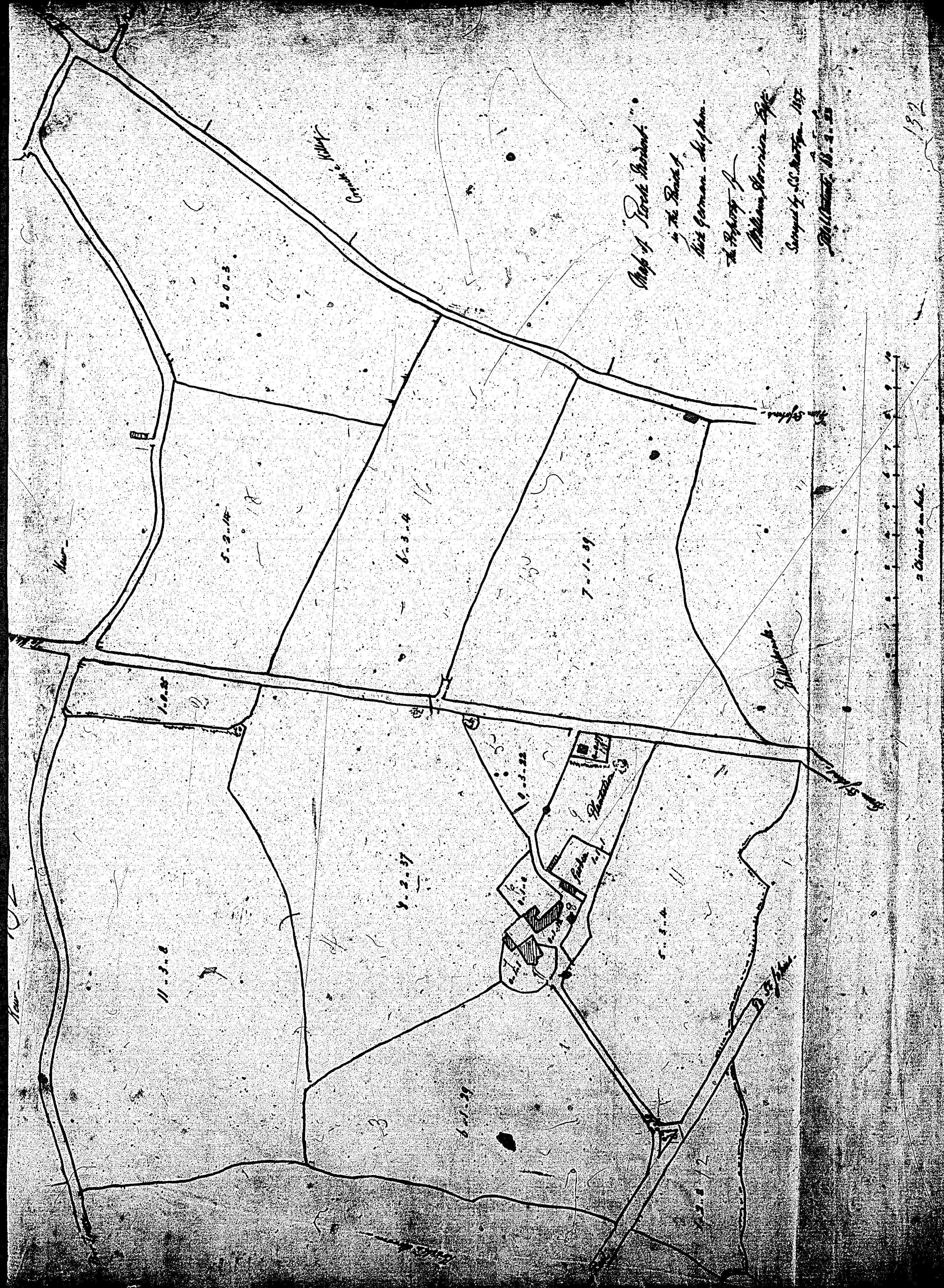

The following plan
 is not numbered
 but 133
 is pencilled on the
 backing

ISLE OF MAN GOVERNMENT: GENERAL REGISTRY

ASYLUM PLANS: PARISH OF GERMAN

Original coloured

1:23

